

## Controls & Features

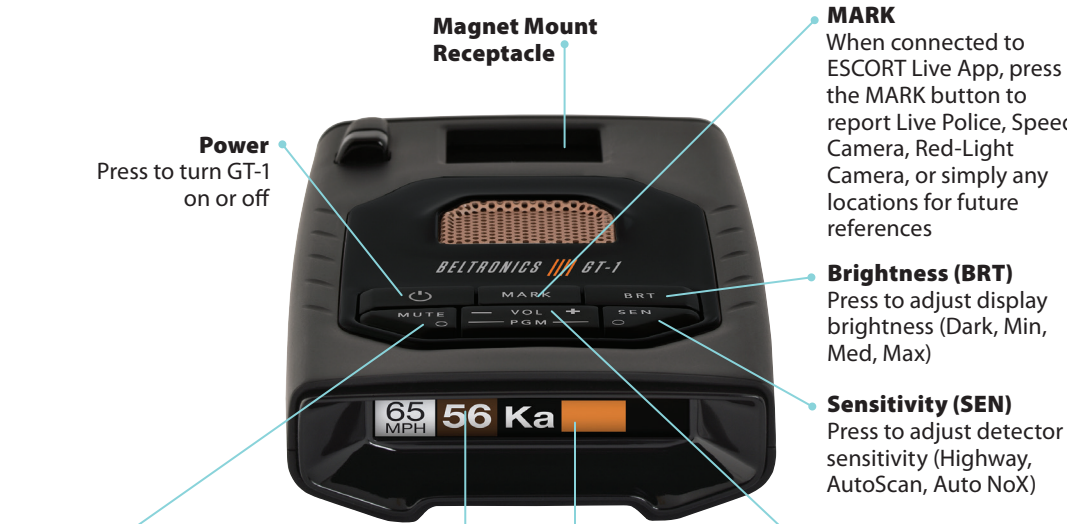

- Power**  
Press to turn GT-1 on or off
- Mute**  
Press to mute an alert. When connected to ESCORT Live App, press three times to lock out a false alert; press twice while receiving a locked-out alert to unlock
- Display**  
Alert Area
- Volume**  
Press and hold + or - to adjust volume
- MARK**  
When connected to ESCORT Live App, press the MARK button to report Live Police, Speed Camera, Red-Light Camera, or simply any locations for future references
- Brightness (BRT)**  
Press to adjust display brightness (Dark, Min, Med, Max)
- Sensitivity (SEN)**  
Press to adjust detector sensitivity (Highway, AutoScan, Auto NoX)

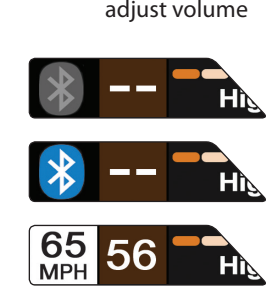

**Important!** Actual speed and live alerts will not be shown on your Beltronics GT-1 if your smart phone does not have good GPS reception.

## Settings & Preferences

Press and hold the MUTE and SEN buttons to access Programming. To exit Programming, simply wait a few seconds without pressing a button. The unit will display **Completed** to confirm your selections.

Press MUTE to go from one category to the next	Press VOLUME + or - to change your setting within a category
User Mode <b>Advanced*</b> <b>Novice</b>	Access and customize all Settings and Preferences in Advanced Mode <i>NOTE: Switch back to Advance mode to view all Preferences</i>
Pilot <b>Scan Bar*</b> <b>Full Word</b>	Scanning Bar with Full Word Full Word: AutoScan, Auto NoX, or Highway
Display Color <b>Copper*/Blue/Green/Red</b>	Set color to match your vehicle's dash display
Meter Mode <b>Standard*</b> <b>Tech</b> <b>Threat</b> <b>Basic</b>	Single band with bar graph of signal strength Single band with numeric frequency Multiple bands with bar graph of signal strengths Simple messages replace bands: <b>Caution</b> (if traveling below cruise alert limit) <b>Slow Down</b> (if traveling above cruise alert limit)
Tones <b>Standard*</b> <b>Mild</b>	Standard Beltronics alert tones Mild doorbell chime alert tones
AutoMute <b>On* / Off</b>	Automatically reduces audio during alert
Units <b>English*/Metric</b>	Units for distance and speed
Language <b>English*/Espanol</b>	Language for voice and text
Voice <b>On* / Off</b>	Voice announcements
Band Enables <b>Default*</b> <b>Modified</b>	Default Settings for North America Customize the bands you want to monitor

Press SEN to go from one band category to the next

Press SEN to go from one band category to the next	Press VOLUME + or - to change your setting within a category
X Band K Band <b>On* / Off</b> <b>On* / Off</b>	Freq: 24.050-24.250 GHz <i>NOTE: When K Band is off, you can select separate segments of the band to turn on or off.</i>
KN1 KN2 KN3 KN4 Ka Band <b>On* / Off</b> <b>On* / Off</b> <b>On* / Off</b> <b>On* / Off</b> <b>On* / Off</b>	Freq: 24.050 - 24.110 GHz Freq: 24.110 - 24.175 GHz Freq: 24.175 - 24.250 GHz Freq: 23.950 - 24.050 GHz Freq: 33.400-36.000 GHz <i>NOTE: When Ka Band is off, you can select separate segments of the band to turn on and off.</i>
KaN1 KaN2 KaN3 KaN4 KaN5 Laser TSR <b>On* / Off</b> <b>On* / Off</b> <b>On* / Off</b> <b>On* / Off</b> <b>On* / Off</b> <b>On* / Off</b> <b>On* / Off</b>	Freq: 33.392 - 33.704 GHz Freq: 33.704 - 33.896 GHz Freq: 33.886 - 34.198 GHz Freq: 34.184 - 34.592 GHz Freq: 34.592 - 34.808 GHz Automatically rejects traffic flow sensors-monitoring false alarms
KaN6 KaN7 KaN8 KaN9 KaN10 <b>On* / Off</b> <b>On* / Off</b> <b>On* / Off</b> <b>On* / Off</b>	Freq: 34.806 - 35.166 GHz Freq: 35.143 - 35.383 GHz Freq: 35.378 - 35.618 GHz Freq: 35.595 - 35.835 GHz Freq: 35.830 - 35.998 GHz

Additional Preference options within ESCORT Live App when connected to Beltronics GT-1

Cruise Alert <b>Off / 20-160 mph</b> <b>20 mph*</b>	Offers double beep alert tones below specified speed
Speed Display <b>On*</b> <b>Off</b>	Displays current speed Displays battery voltage
Units <b>English*/Metric</b>	Units for distance and speed

\*Default Setting

**Notes for Settings & Preferences**  
For descriptions of features and functions available when connected to ESCORT Live, visit Beltronics.com and download the Beltronics GT-1 Owner's Manual.

To restore Beltronics GT-1 to its original factory settings, press and hold **MUTE** and **SEN** while powering on detector. **Restored** message will display, acknowledging the reset.

**Software Updates**  
Beltronics GT-1 is easily updated using our exclusive detector software tools found on our web site. Firmware, or the operating software for the detector, can be updated using these tools.

In order to have access to these updates, please register your Beltronics GT-1 at [www.Beltronics.com](http://www.Beltronics.com). Once registered, you will receive email notifications that updates are now available for your firmware. To handle your software updates you need to connect your Beltronics GT-1 to a computer.

You can connect Beltronics GT-1 to a computer via Micro USB/USB A cable (not included).



The Bluetooth® word mark and logos are registered trademarks owned by Bluetooth SIG, Inc. and any use of such marks by ESCORT is under license.

## Contact Us

**866.468.0322 • Beltronics.com**  
Beltronics USA, Inc.  
5442 West Chester Road, West Chester OH 45069

**Beltronics One Year Limited Warranty**  
**What this warranty covers:** Beltronics USA, Inc. ("Beltronics") warrants your Product against all defects in materials and workmanship.  
**For how long:** One (1) year from the date of original purchase from an authorized Beltronics dealer.

**What we will do:** If a breach of warranty occurs, Beltronics, at its discretion, will either repair or replace your Product free of charge.  
**What we will not do:** Beltronics will not pay shipping charges that you incur for sending your Product to us.

**What you must do to maintain this warranty:** Show original proof of purchase or receipt from an authorized Beltronics dealer.

**Warranty exclusions:** This warranty does not apply to your product under any of the following conditions: 1. The serial number has been removed or modified. 2. Your product has been subjected to misuse or damage (including water damage, physical abuse, and/or improper installation). 3. Your product has been modified in any way. 4. Your receipt or proof-of-purchase is from a non-authorized dealer or internet auction site, including E-bay, U-bid, or other non-authorized resellers. 5. You are not the original purchaser of the Product from an authorized dealer or did not receive it as a gift from the original purchaser of the Product from an authorized dealer.

**To obtain service:** 1. Contact Beltronics (1-800-341-2288) to obtain a Return Authorization Number. 2. Properly pack your Product and include: your name, complete return address, written description of the problem with your Product, daytime telephone number, and a copy of the original proof of purchase or receipt. 3. Label the outside of the package clearly with your Return Authorization Number. Ship the Product pre-paid (insured, for your protection) to: Beltronics USA, Inc., 5442 West Chester Rd., West Chester, OH 45069.

**LIMITATION OF WARRANTY:** The obligations set forth above are Beltronics' sole obligations and your exclusive remedy. Beltronics makes no other express warranty. Any implied warranty of merchantability or fitness for a particular purpose that may be applicable to the Product is limited in duration to the duration of this warranty. Some States do not allow limitations on how long an implied warranty lasts, so the above limitation may not apply to you. BELTRONICS SHALL NOT BE LIABLE FOR CONSEQUENTIAL, SPECIAL OR INCIDENTAL DAMAGES INCLUDING, WITHOUT LIMITATION, DAMAGES ARISING OUT OF THE USE, MISUSE OR MOUNTING OF THE PRODUCT. Some States do not allow the exclusion or limitation of incidental or consequential damages, so the above limitation or exclusion may not apply to you. Beltronics is not responsible for products lost in shipment between the owner and our service center. Other legal rights: This warranty gives you specific legal rights, and you may also have other rights which vary from State to State.

©2018 Beltronics USA, Inc. Beltronics®, GT-1™, Escort Live™, Defender®, AFR®, TrueLock™, SmartShield™, SpecDisplay™, AutoSensitivity™ and ExpertMeter™ are trademarks of Beltronics USA, Inc. Manufactured in the Philippines. Features, specifications and prices subject to change without notice.

FCC NOTE: Modifications not expressly approved by the manufacturer could void the user's FCC granted authority to operate the equipment.

FCC ID: QL4G155  
This device complies with part 15 of the FCC rules. Operation is subject to the following two conditions: (1) This device may not cause harmful interference, and (2) this device must accept any interference received including interference that may cause undesired operation.

# Live life in the passing lane.



App Integration Provides Crowd-Sourced Alerts

**BELTRONICS™ GT-1** Long range radar/laser detection.

Powerful Digital Signal Processor | Instantly clear voice alerts | Convenient magnetic mount system

(Note: Must be paired with ESCORT Live ticket protection App to receive posted speed limit data.)

Quick Reference

## Congratulations



You've purchased the **all-new Beltronics GT-1** which is the one of the most advanced high-performance radar and laser detector on the market. The Beltronics GT-1 provides long-range warning on all radar and laser bands.

Go to [Beltronics.com](http://Beltronics.com) for the full featured Beltronics GT-1 Owner's Manual.

Guía de Referencia Rápida Española traducida y manual con todas las funciones también son disponibles a [www.Beltronics.com](http://www.Beltronics.com)



Beltronics GT-1 features a



new multi-color OLED display. Brilliant



graphics illuminate intuitive icons that

Images shown above appear when GT-1 is connected to your phone and ESCORT Live App.

identify the type of threat at a glance.

## Beltronics GT-1 Features

The Beltronics GT-1 introduces the following state-of-the-art performance and features:

- Long-range K and Ka-band radar performance, including instant-on radar guns.
- Highway, AutoScan, and Auto No X settings.
- Exclusive Threat Mode tracks and displays up to 4 radar signals simultaneously.
- Exclusive Tech Mode provides actual numeric frequency for any radar signal and alert bar.
- The Beltronics GT-1 with built in Bluetooth® technology gives you access to ESCORT's award-winning App, ESCORT Live. Features when connected to ESCORT Live:
  - Our exclusive real-time ticket protection network, which warns you of upcoming alerts received by other users in the area.
  - Our DEFENDER Database, which warns you of verified speed traps, speed cameras, and red light cameras.
  - Our most popular GPS-powered features, including speed-limit data for over-speed alerts, live traffic data for your current location, and manual lock-out to help eliminate false alerts.



**Live Ready!**



## Registration

Follow these steps to register your Beltronics GT-1. You will need the detector's serial number to complete the registration.

- 1 Visit [www.Beltronics.com](http://www.Beltronics.com) and click Product Registration.
- 2 Click the "Registration for all devices" link.
- 3 Follow the onscreen instructions to register your device.

Be sure to write down the username and password you create, as you will need this information to access the ESCORT Live ticket protection App. (You will also receive an e-mail with this information, once you have registered your device.)

*NOTE: GT-1 comes with 1-year free premium subscription to ESCORT Live™.*

## ESCORT Live

**For iPhone:**

- 1 Ensure Beltronics GT-1 power is ON.
- 2 Open the App Store on your iPhone and search for **ESCORT Live Radar**.
- 3 Follow the onscreen instructions to download **ESCORT Live Radar** and then open the App.
- 4 When prompted, enter the username and password you created when registering your product at [Beltronics.com](http://Beltronics.com).
- 5 Press the Settings button  then select **Devices**.
- 6 You should see **GT-1** listed with Not Connected underneath. Press the **GT-1** device entry and when prompted select Pair.
- 7 The Bluetooth icon on the **GT-1** display will appear to confirm that it is paired to your iPhone.

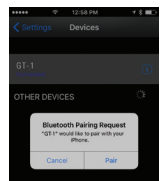

## ESCORT Live *continued*

**For Android based smartphones:**

- 1 Ensure Beltronics GT-1 power is ON.
- 2 On your smartphone go to Bluetooth® Settings and make sure that Bluetooth® is ON.
- 3 Press Scan for devices and wait for the device list to populate, **GT-1** should appear under Available devices.
- 4 Press the **GT-1** device entry.
- 5 The Bluetooth icon on the Beltronics GT-1 display will appear to confirm that it is paired to your smartphone.
- 6 Open Google Play on your smartphone and search for **Escort Live Radar**.
- 7 Follow the onscreen instructions to download **Escort Live Radar** and then open the App.
- 8 When prompted, enter the username and password you created when registering your product at [Beltronics.com](http://Beltronics.com)
- 9 Open the App, walk through the tutorial, and you're ready to hit the road!



## Installation

Beltronics GT-1 comes with a versatile EZ Mag Mount™.

**To mount the detector in your vehicle:**

- 1 Remove backing from StickyCup mount.
- 2 Firmly press StickyCup onto windshield and flip locking clamp to secure.
- 3 Slide the detector onto the mounting bracket until it's fully engaged. The magnet inside holds the detector in place.

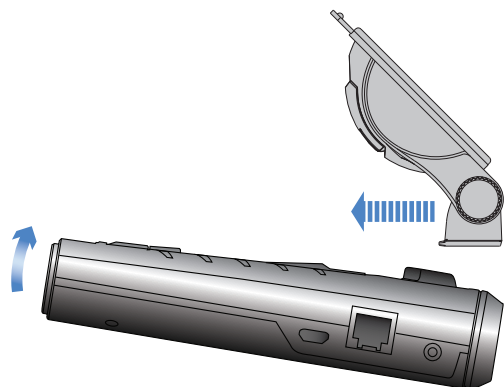

- 4 To adjust view, loosen thumb wheel and adjust angle of mounting bracket. Tighten thumb wheel to secure.
- 5 To remove detector, simply pull the detector device off the mount bracket.
- 6 To remove mount from windshield, release locking clamp and pull tab on top of StickyCup.

**StickyCup Care Instructions:**

To clean your StickyCup, simply rinse under warm water, gently wipe off any debris and allow to air dry.

For optimum detection performance, we recommend the following:

- Using the EZ Mag Mount, mount your Beltronics GT-1 level, and high enough on your front windshield to provide a clear view of the road from the front and rear.

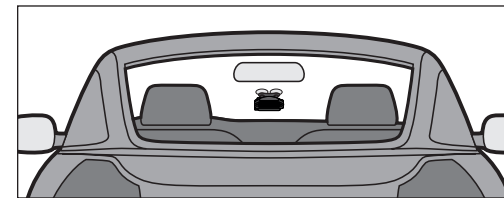

- Mount Beltronics GT-1 away from windshield wipers, other solid objects, and heavily tinted areas that might obstruct the radar antenna or laser lens.

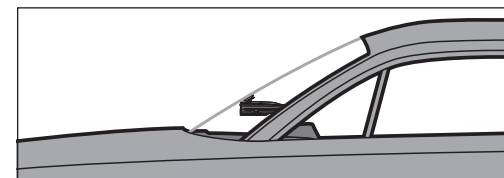

## Controls & Features

**Using GT-1**

- 1 Plug small end of SmartCord into modular jack on GT-1 and large end of SmartCord into your car's lighter/accessory socket.
- 2 GT-1 should power on automatically. If not, press the device's power button.

*NOTE: You can easily access and customize all of your Settings and Preferences by pressing and holding the MUTE and SEN buttons. See Settings and Preferences for details.*

**Using SmartCord**

- Mute Button: Press to mute an alert.
- Alert Light: Lights red when receiving an alert.
- Power Light: Lights green when receiving power.



**Modular Connector**  
Plugs into detector jack

**Lighter Adapter**  
Connects to lighter/accessory socket

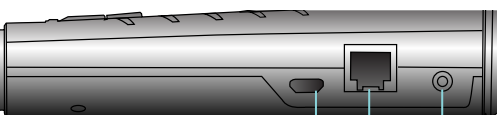

**Earphone Jack**  
Connects to optional 3.5 mm stereo earphone.

**Modular Jack**  
Connects to SmartCord for powering your device

**Micro USB Jack**  
Connects to your computer via Micro USB/USB A cable for downloading software updates

HIGH DEFINITION RADAR PERFORMANCE

2

3

4

5

6

Continued →