

SPECIAL FEATURES

CONGRATULATIONS!

You now own a quality XACT™ Communication product. If you follow the set-up, operation and care instructions in this Owner's Manual, this unit will provide you with years of trouble-free service.

XACT is committed to providing quality products that fit your needs. Please send us your comments and suggestions. Mail them to:

XACT Communication, LLC
105 Madison Avenue
New York, NY 10016

The XGM-950 is the newest generation in personal two-way communications. It's a lightweight, compact two-way communication device that can be used to stay connected with family or friends at parks, shopping malls, sporting events, concerts – virtually any indoor or outdoor activity.

Here are some of its excellent features:

- *22 FRS/GMRS Channels*
- *38 CTCSS Codes*
- *Roger Beep Tone*
- *Up to 10 Mile Range*
- *Auto Squelch*
- *Auto Battery Saving*
- *Internal VOX*
- *Channel Scan*
- *Monitor Function*
- *TX Power Hi/Lo Selection*
- *Backlit LCD Screen*
- *Ni-MH Battery Power Source*

Read this Owner's Manual carefully to get the most out of your TWO-WAY COMMUNICATOR.

NOTE

Maximum range varies based on terrain and environment. It will generally be greater in open fields and shorter within and around buildings or large structures. Bear in mind, this unit may not ensure privacy of communication.

COMMUNICATOR CONTROLS

LCD SCREEN

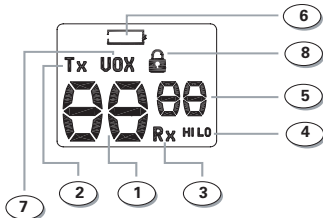

1. Channel Number (1~22) – Changes from 1-22 as selected by user.
2. Transmit Indicator (TX) – Indicates unit is transmitting a signal.
3. Receive Indicator (RX) – Indicates unit is receiving a transmission.
4. Power HI/LO Indicator – Indicates the current TX Power setting.
5. CTCSS Code Number (oF~38) – Changes from oF-38 as selected by user.
6. Battery Level indicator - Indicates the battery is low.
7. VOX – Displays during VOX mode.
8. KEY LOCK Indicator

BUTTONS and CONTROLS

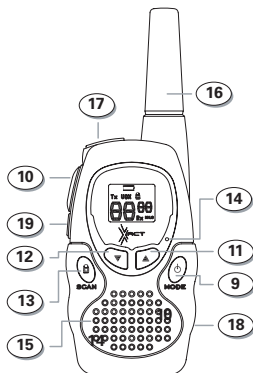

9. POWER/MODE (Multi Function Button) – Press and hold to turn unit ON/OFF. A quick, single press accesses the Menu and Watch mode.
10. TALK (Multi Function Button) – Press and hold to transmit voice communication. Press twice quickly to transmit CALL tone.
11. UP ▲ Button – Adjusts volume level (default), and makes channel and watch adjustments in MENU mode.
12. DOWN ▼ Button – Adjusts volume level (default), and makes channel and watch adjustments in MENU mode.
13. SCAN Button – Press to enter CHANNEL SCAN mode. Press and hold to set KEY LOCK ON/OFF.
14. MIC – Built-in microphone.
15. SPEAKER – Built-in speaker.
16. ANTENNA.
17. HEADSET/ CHARGER (BATTERY CHARGE) JACK.
18. BATTERY COMPARTMENT COVER.
19. MONITOR Button - Press and hold to enter MONITOR mode. Press to start LCD Backlighting.

FCC NOTICE

This device complies with Part 15 of the FCC Regulations. Operation is subject to the following conditions:

- 1 This device may not cause harmful interference.
- 1 This device must accept any interference received, including interference that may cause undesired operation.

IMPORTANT: Changes or modifications to this unit not expressly approved by **XACT™ Products** could void your right to operate this unit. Your COMMUNICATOR is set up to transmit a regulated signal on an assigned frequency. It is against the law to alter or adjust the settings inside the COMMUNICATOR to exceed those limitations. Any adjustment to your COMMUNICATOR must be made by qualified technicians.

SAFETY INFORMATION

- 1 Never open your COMMUNICATOR's case.
- 1 Never change or replace anything in your COMMUNICATOR except the battery.

Your COMMUNICATOR may interfere with TVs or radios, even when operating properly. To determine whether your COMMUNICATOR is causing interference, simply turn it off. If the interference ends, your COMMUNICATOR is causing it. Try to eliminate interference by moving your COMMUNICATOR away from the receiver. If you cannot eliminate interference completely, the FCC requires that you terminate COMMUNICATOR use.

Electromagnetic Interference/Compatibility: Nearly every electronic device is susceptible to electromagnetic interference (EMI) if inadequately shielded, designed, or otherwise configured for electromagnetic compatibility.

- 1 Turn your unit OFF in any facilities where posted notices instruct you to do so. Hospitals or health care facilities may be using equipment that is sensitive to external RF energy.
- 1 Turn your unit OFF when on board an aircraft when instructed to do so. Any use of the unit must be in accordance with airline regulations or crew instructions.

Hazardous Environments: Do not operate the COMMUNICATOR in hazardous environments, explosion or fire may result. Do not operate the COMMUNICATOR near unshielded electrical blasting caps. Under certain conditions, COMMUNICATORS can interfere with blasting operations and may cause an explosion. Turn your COMMUNICATOR to the OFF position to prevent accidental transmission when in a blasting area or in areas posted: "Turn off two-way radios." Construction crews often use remote control RF devices to set off explosives.

SAFETY INFORMATION

NOTE: Areas with potentially explosive atmospheres are often, but not always, clearly marked. They include fueling areas such as below deck on boats; fuel or chemical transfer or storage facilities; areas where the air contains chemicals or particles, such as grain, dust, or metal powders; and any other area where you would normally be advised to turn off your vehicle engine.

Your wireless hand-held portable transceiver contains a low power transmitter. When the TALK button is pushed it sends out radio frequency (RF) signals. This device is authorized to operate at a duty factor not to exceed 50%.

In August 1996, The Federal Communications Commission (FCC) adopted RF exposure guidelines with safety levels for hand-held wireless devices.

IMPORTANT: To maintain compliance with the FCC's RF exposure guidelines, hold the transmitter and ANTENNA at least 2 inches (5 centimeters) from your face and speak in a normal voice, with the ANTENNA pointed away from the face.

Use only the supplied ANTENNA. Unauthorized antennas, modifications, or attachments could damage the transmitter and may violate FCC regulations.

This device complies with Part 15 of the FCC Rules. Operation is subject to the following two conditions: (1) this device may not cause harmful interference, and (2) this device must accept any interference received, including interference that may cause undesired operation.

CARE AND MAINTENANCE

To clean your COMMUNICATOR, use a soft cloth dampened with water. Do not use cleaners or solvents; they can harm the body of the unit and leak inside, causing permanent damage. Use a dry, lint-free cloth to clean the battery contacts. Do not submerge the unit in water. If the unit gets wet, turn it off and remove the battery immediately. Dry the BATTERY COMPARTMENT with a soft cloth to minimize potential water damage. Leave the BATTERY COMPARTMENT COVER off overnight to ensure complete drying. Do not use the COMMUNICATOR until the unit is completely dry.

GETTING STARTED

Battery Installation:

Your XGM-950 COMMUNICATOR is powered by 4 AA size Alkaline BATTERIES or a RECHARGEABLE BATTERY PACK (included). To install and replace the BATTERIES:

1. Release the BATTERY COMPARTMENT COVER located on the rear side of the unit, and remove the COVER from the BATTERY COMPARTMENT.
2. Install the BATTERIES into the BATTERY COMPARTMENT. Be certain to follow the correct orientation in the compartment. A battery installed incorrectly can prevent the unit from operating.
3. Replace the COVER and lock the BATTERY COMPARTMENT COVER into position (you will hear a click).

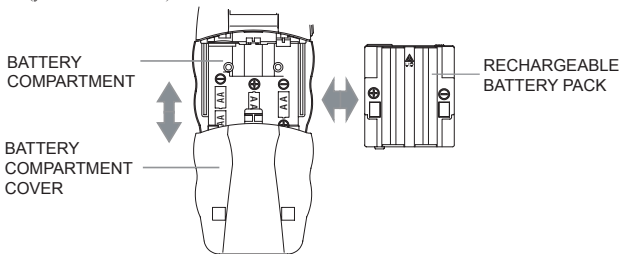

CAUTION

To reduce the risk of personal injury, use only the battery listed in the Owner's Manual. The COMMUNICATOR has a built in POWER SAVER feature for maximum battery life. But when the COMMUNICATOR is not being used, conserve battery power by pressing the POWER/MODE button to turn OFF the unit. Remove the BATTERY if the unit will not be used for a long period of time.

GETTING STARTED

Charging the BATTERY:

Your COMMUNICATOR comes with an DESKTOP CHARGER to charge your Ni-MH BATTERY PACK (included). To charge the BATTERY:

1. Connect the A/C ADAPTER into the DESKTOP CHARGER.
2. Connect the A/C ADAPTER into an A/C wall outlet.
3. Insert the COMMUNICATOR into the DESKTOP CHARGER. The corresponding LED of the DESKTOP CHARGER will be lit to indicate charging. During charging, the LOW BATTERY LEVEL icon will disappear once the BATTERY is fully charged.

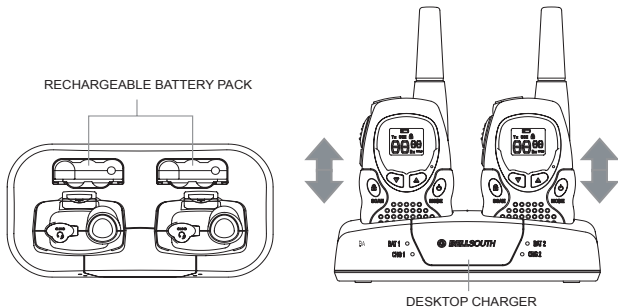

NOTE: The DESKTOP CHARGER can charge 2 COMMUNICATORS and 2 spare RECHARGEABLE BATTERY PACKS simultaneously. Charge the BATTERY for approximately 12 hours before initial use.

NOTE

The COMMUNICATOR comes with internal battery protection; however, during long-term storage, it is strongly recommended that you recharge the BATTERY every 6 months or remove the BATTERY if the unit will not be used for a long period of time.

GETTING STARTED

Your XGM-950 COMMUNICATOR is also capable of charging the Ni-MH RECHARGEABLE BATTERY PACK with an A/C ADAPTER CHARGER (not included) thru the EAR/MIC JACK. You can purchase A/C ADAPTER CHARGER and Ni-MH RECHARGEABLE BATTERY PACK (see accessory order form to order).

To charge:

1. Lift the HEADSET/CHARGER JACK COVER located on the top of your XGM-950 COMMUNICATOR.
2. Connect the A/C ADAPTER CHARGER into an A/C wall outlet.
3. Insert the A/C ADAPTER CHARGER into the HEADSET/CHARGER JACK. During charging, the LOW BATTERY LEVEL icon will disappear once the BATTERY is fully charged.



Battery Level and Low Battery Operation

The Low Battery Level icon will appear on the LCD Screen when the COMMUNICATOR detects that the BATTERY LEVEL is low.

The COMMUNICATOR LOW BATTERY LEVEL icon will blink when a low BATTERY level is detected while in COMMUNICATOR mode. When the COMMUNICATOR is in COMMUNICATOR mode and the BATTERY LEVEL is low, the icon will blink continuously and the TX POWER setting will automatically change from HI to LO (if TX POWER is set to high) when the TALK button is pressed or if VOX is activated. The COMMUNICATOR BATTERY should be recharged at this time,

GETTING STARTED

Removing the BELT CLIP:

Your XGM-950 COMMUNICATOR comes with a BELT CLIP to allow you to clip your COMMUNICATOR on your belt.

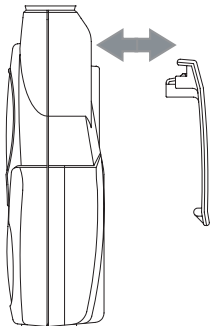

To install the BELT CLIP, simply push the BELT CLIP into the BELT CLIP latch until it locks into place (you will hear a click).

To remove BELT CLIP, press the BELT CLIP lock and pull the BELT CLIP away from the latch.

OPERATION

1. Install the BATTERY in the COMMUNICATOR.
2. Enter COMMUNICATOR mode by pressing and holding the POWER/MODE button for 3 seconds. To exit COMMUNICATOR mode, press the POWER/MODE button for 3 seconds.
3. Check for the LOW BATTERY LEVEL icon on the LCD Screen.
4. Adjust the Speaker Volume to a comfortable level by pressing the UP **S** or DOWN **t** button (default).

Navigating through the Menu

Use the POWER/MODE button to access the advanced features of the COMMUNICATOR. (See pages 9-15 for programming instructions.)

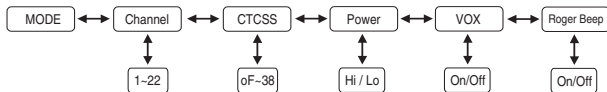

COMMUNICATOR Mode:

The COMMUNICATOR functions as a two-way communication device while in this mode.

1. Press the POWER/MODE button for 3 seconds and a long "beep" will be heard, the COMMUNICATOR's LCD Screen will quickly display all of the COMMUNICATOR's status icons, and the COMMUNICATOR will enter COMMUNICATOR mode and display the current channel. The LCD Display Backlighting will also be lit for approximately 7 seconds.
2. Press the POWER/MODE button briefly (for no longer than 1 second) to enter into CHANNEL CHANGE, CTCSS CODE CHANGE, POWER HI/LO, VOX, ROGER BEEP, and STANDBY/RECEIVE modes in due order. A short "beep" will be heard after every press of the POWER/MODE button.
3. Press the TALK button to exit the MENU mode at any time, or the unit will automatically return to STANDBY mode if no buttons have been pressed for 10 seconds.

NOTE: In order for other people to receive your transmission, they must be on the same channel and CTCSS Code you are currently using. Refer to the "Changing Channels" and "Changing CTCSS Code" section for more information.

Adjusting Speaker Volume (STANDBY/RECEIVE Mode):

1. Press the UP **S** button to increase the Speaker Volume.
2. Press the DOWN **t** button to decrease the Speaker Volume.
3. The Speaker Volume increase/decrease at each Volume increment/decrement.

NOTE: The Speaker Volume setting will not be displayed on the LCD Display.

Transmitting and Receiving a Signal:

The COMMUNICATOR is continuously in RECEIVE/STANDBY mode when the unit is on, in COMMUNICATOR mode, and not transmitting. Changing the position of the COMMUNICATOR may increase the quality and range of the COMMUNICATOR's transmitted or received signals.

1. Press and hold the TALK button to TRANSMIT and the TX icon will appear on the LCD Screen (see "LCD Screen" for details).
2. Hold the COMMUNICATOR about 2~3 inches (5 to 7.5 cm) from the mouth, and speak in a normal tone of voice. Pause momentarily (after pressing the TALK button) before speaking to avoid cutting off the first part of the transmission.
3. Release the TALK button when finished transmitting to return to RECEIVE mode.
4. Receipt of an incoming transmission will be indicated by the appearance of the RX icon on LCD Screen.

Sending a CALL TONE:

Use a CALL TONE to alert the other user when attempting to contact them or use a CALL TONE to signal the beginning or the end of a transmission.

1. Press and quickly release the TALK button twice, the TX icon will be displayed on the LCD Screen and a CALL TONE will be transmitted for 3~5 seconds.
2. The COMMUNICATOR will return to STANDBY mode after completing the CALL TONE transmission.

NOTE: All two-way communicators currently using the same channel and CTCSS Code as the COMMUNICATOR sending the CALL TONE will receive a CALL TONE.

CHANNEL SCAN:

The COMMUNICATOR has 22 channels for communicating with others. CHANNEL SCAN mode performs searches for active signals in an endless loop on the COMMUNICATOR's channels while in COMMUNICATOR mode.

1. Press and release the SCAN button (located on the side of the COMMUNICATOR), a short "beep" will be heard, and the channel number on the COMMUNICATOR LCD Screen will change rapidly until an active signal (channel) is detected.
2. When an active signal (one of 22 channels) is detected, CHANNEL SCAN pauses, keeping the active signal broadcasted 4~5 seconds before resuming CHANNEL SCAN.
3. Press the TALK button to communicate through the active signal channel.
4. When an active signal is detected, but another channel is desired, press the UP **S** or DOWN **t** button to bypass the current channel and continue to search for another active channel.
5. Press the SCAN button to deactivate CHANNEL SCAN mode.

MONITOR FUNCTION:

The COMMUNICATOR has a MONITOR function which will enable you to adjust the volume of your unit when you are not receiving any transmission. It will also enable you to bypass the CTCSS and SQUELCH function to receive weak transmission.

1. To activate the MONITOR function press and hold the MONITOR button (located on the side of the COMMUNICATOR), a "white noise" will be heard. You can adjust the Volume level by pressing the UP **S** or DOWN **t** button.
2. To deactivate the MONITOR function press and hold the MONITOR button while on MONITOR mode. The COMMUNICATOR will return to receive/standby mode.

Changing Channels:

The COMMUNICATOR has 22 channels for communicating with others. To change the COMMUNICATOR's channels while in COMMUNICATOR mode:

1. Enter COMMUNICATOR mode by pressing the POWER/MODE button for 3 seconds a long "beep" will be heard, the COMMUNICATOR's LCD Screen will quickly display all of the COMMUNICATOR's status icons, and the COMMUNICATOR will enter COMMUNICATOR mode and display the current channel.
2. Press the POWER/MODE button momentarily (for no longer than 1 second) to enter the MENU mode. You will hear a "beep" and the channel number will "flash" on the LCD Screen.
3. Press the UP **s** or DOWN **t** button repeatedly (or hold the button to scroll) to increase or decrease the channel number on the COMMUNICATOR's LCD Screen, and a short "beep" will be heard with each channel change.
4. Press the POWER/MODE button again to enter the CTCSS Code mode (refer to the "CTCSS CODE" section below for more information) or press the TALK button to exit to STANDBY mode.
5. Press the POWER/MODE button again to enter the POWER HI/LO mode (refer to the "POWER HI/LO SELECTION" section for more information) or press the TALK button to exit to STANDBY mode.
6. Press the POWER/MODE button again to enter the VOX mode (refer to the "VOX" section for more information) or press the TALK button to exit to STANDBY mode.
7. Press the POWER/MODE button again to enter the ROGER BEEP mode (refer to the "ROGER BEEP" section for more information) or press the TALK button to exit to STANDBY mode.
8. Press the TALK button to exit the MENU mode at any time, or the unit will automatically return to STANDBY mode if no buttons have been pressed for 10 seconds.

Changing CTCSS CODE:

The COMMUNICATOR has 38 CTCSS CODES available. The selected CTCSS Code may be different for each channel. To change the CTCSS Code while in COMMUNICATOR mode:

1. Press the POWER/MODE button twice and the CTCSS CODE icon will flash.
2. Press the UP **s** or DOWN **t** button repeatedly (or hold the button to scroll) to increase or decrease the CTCSS CODE number on the COMMUNICATOR's LCD Screen, and a short "beep" will be heard with each code change.
3. Press the TALK button to exit the MENU mode at any time, or the unit will automatically return to STANDBY mode if no buttons have been pressed for 10 seconds.

NOTE: Selecting the "oF" CTCSS CODE will disable the CTCSS feature. In order for other people to receive your transmission, they must be on the same channel and CTCSS CODE you are currently using.

POWER HI/LO Selection:

The COMMUNICATOR has a TX POWER HI/LO Selection which enables you to set the TX POWER level.

1. Press the POWER/MODE button thrice and the POWER HI/LO icon will flash.
2. Press the UP **s** or DOWN **t** button repeatedly to toggle between HI/LO the TX POWER setting on the COMMUNICATOR's LCD Screen, and a short "beep" will be heard with each setting change.
3. Press the TALK button to exit the MENU mode at any time, or the unit will automatically return to STANDBY mode if no buttons have been pressed for 10 seconds.

NOTE: Channel 8 to 14 does not have POWER HI/LO Selection. The TX POWER will be automatically set to LO at these channels.

Voice Operated Transmission (VOX):

The COMMUNICATOR is equipped with an adjustable VOICE OPERATED TRANSMITTER (VOX), which enables the user to enter the TRANSMIT mode without pressing the TALK button. While in VOX mode, the COMMUNICATOR can be activated to transmit a signal by speaking into the MICROPHONE or by receiving other sounds in the environment. VOX operation is not recommended in a noisy or windy environment.

1. Press the POWER/MODE button four times and the VOX icon will flash on the LCD Screen.
2. Press the UP **S** or DOWN **t** button to turn the VOX feature ON or OFF. When the VOX feature is ON, the VOX icon will be displayed on the LCD Screen.
3. Press the TALK button to return to RECEIVE/STANDBY mode.

For greater privacy and convenience of hands-free transmission, use an Ear Bud (headset) with Microphone (see Accessory Order Form) when using VOX mode.

Connecting the Ear Bud (Headset):

1. Set the COMMUNICATOR to VOX mode.
2. Lift the HEADSET/CHARGER JACK COVER located on the top of the COMMUNICATOR.
3. Insert the plug end of the Ear Bud into the HEADSET/CHARGER JACK. Place the Ear Bud earpieces over and in the ear, and then adjust the location of the MICROPHONE.

Roger Beep Tone Feature:

The COMMUNICATOR is equipped with an adjustable ROGER BEEP TONE feature, which enables the user to send a Beep Tone after every press of the TALK Button. This will notify any receiving unit that the transmission has ended.

1. Press the POWER/MODE button five times and the “rb” icon will appear on the LCD Screen.
2. Press the UP **S** or DOWN **t** button to turn the ROGER BEEP feature ON or OFF.
3. Press the TALK button to return to RECEIVE/STANDBY mode.

Auto Squelch Feature:

The COMMUNICATOR has an automatic squelch system that automatically eliminates weak transmissions and unwanted noise due to terrain conditions and range limitations.

Automatic Power Save Feature:

The COMMUNICATOR has a unique circuit that extends battery life. If the COMMUNICATOR does not detect a transmission within 5 seconds, it automatically switches to POWER SAVE mode. The COMMUNICATOR can still receive transmissions in this mode.

Backlit LCD Screen:

The COMMUNICATOR's LCD Screen will automatically light up for 5 seconds with the short press of the MONITOR button. The COMMUNICATOR's LCD Screen will also light up for approximately 7 seconds everytime the the COMMUNICATOR is turned on.

KEY LOCK Function:

To prevent accidental change of your COMMUNICATOR's settings, the COMMUNICATOR is equipped with a KEY LOCK function.

To activate the KEY LOCK function press and hold the SCAN button for approximately 4 seconds and the KEY LOCK icon will appear on the LCD Display. The SCAN, UP **S** / DOWN **t**, and MODE button will not be functional. An error tone will be heard if these buttons are pressed. The TALK and MONITOR button will still be functional.

To deactivate the KEY LOCK function press and hold the SCAN button for approximately 4 seconds while on KEY LOCK mode and the KEY LOCK icon will disappear on the LCD Display.

TROUBLESHOOTING

PROBLEM	SOLUTION
No power	<ul style="list-style-type: none">• Check the BATTERY. Ensure that the battery is installed properly.• BATTERY may be weak.• Recharge your BATTERY by using the DESKTOP CHAGER or the A/C ADAPTER CHARGER.• The BATTERY may be damaged. Replace old BATTERY with a new Ni-MH BATTERY.
Weak Reception	<ul style="list-style-type: none">• Press the UP S button to increase VOLUME.• The receiving signal may be weak and/or out of range.• Check the ANTENNA position. For optimum performance make sure the ANTENNA is pointing upright.
Cannot change channels	<ul style="list-style-type: none">• To change channels, press the POWER/MODE button until the channel number flashes on the LCD Screen.• Press the UP S or DOWN t button to change channels.• BATTERY may be weak.

PROBLEM	SOLUTION
Range is limited	<ul style="list-style-type: none">• BATTERY may be weak.• Recharge BATTERY if the BATTERY LEVEL indicator is low.• Range varies depending on terrain and environment.• Open fields provide maximum range; steel/concrete structures, heavy foliage, and operation in buildings and in vehicles may significantly limit range.• Check the ANTENNA position. For optimum performance make sure the ANTENNA is pointing upright.
Sound distortion	<ul style="list-style-type: none">• When transmitting, hold the MICROPHONE 2 to 3 inches (5 to 7.5 cm) from mouth and speak normally.• When receiving, lower volume to a comfortable level.• Communicators must be at least 10 feet apart; increase your distance.• Communicators are too far apart. Obstacles interfere with transmission. Talk range is up to 10 miles in clear unobstructed conditions.

SPECIFICATIONS

Channels Available	22 FRS/GMRS Channels and 38 CTCSS Codes
Operating Frequency	UHF 462.5500 - 467.7125 MHz
Power Source	4.8V Ni-MH Battery Pack / 4 AA Alkaline Battery
Output Power (TX)	4W ERP maximum
Battery Life	Varies per user
Range	About 10 Miles

Channel (MHz) and CTCSS Code (Hz) Frequency Chart

Channels 1 thru 14 transmit on FRS frequencies.

Channels 15 thru 22 transmit on GMRS frequencies.

Ch.	Frequency	Ch.	Frequency	Ch.	Frequency	Ch.	Frequency
1	462.5625	7	462.7125	13	467.6875	19	462.6500
2	462.5875	8	467.5625	14	467.7125	20*	462.6750
3	462.6125	9	467.5875	15	462.5500	21	462.7000
4	462.6375	10	467.6125	16	462.5750	22	462.7250
5	462.6625	11	467.6375	17	462.6000		
6	462.6875	12	467.6625	18	462.6250		

Code	Freq.	Code	Freq.	Code	Freq.	Code	Freq.	Code	Freq.
1	67.0	9	91.5	17	118.8	25	156.7	33	210.7
2	71.9	10	94.8	18	123.0	26	162.2	34	218.1
3	74.4	11	97.4	19	127.3	27	167.9	35	225.7
4	77.0	12	100.0	20	131.8	28	173.8	36	233.6
5	79.7	13	103.5	21	136.5	29	179.9	37	241.8
6	82.5	14	107.2	22	141.3	30	186.2	38	250.3
7	85.4	15	110.9	23	146.2	31	192.8		
8	88.5	16	114.8	24	151.4	32	203.5		

Note:

1. * GMRS emergency channel 462.6750MHz.
2. The maximum transmission range will vary depending on the terrain and environment.

CARE AND MAINTENANCE

Damaged ANTENNA:

Do not use any COMMUNICATOR that has a damaged ANTENNA. If a damaged ANTENNA comes in contact with the skin, a minor burn may occur.

Important BATTERY Information:

Only use the battery indicated in this manual. Using another type of battery may substantially reduce operating time.

- If you don't plan on using your COMMUNICATOR for a month or more, be sure to remove the BATTERY because it may leak and damage the COMMUNICATOR.
- Dispose of the BATTERY in the proper manner, according to the federal, state, and local regulations that apply to your area.
- The BATTERY may leak electrolyte if any of the following occurs: if it is mixed with other battery types, if it is inserted incorrectly, if the battery is not replaced, if it is disposed of in a fire, or if an attempt is made to charge a battery not intended to be charged.
- Discard a leaking battery immediately. A leaking battery can cause skin burns or other personal injury.

You can purchase additional batteries (see Accessory Order Form), which can be charged using the COMMUNICATOR. ANY additional charged batteries can be used as backup power during long periods of use of the COMMUNICATOR.

To Order a Replacement Ni-MH Battery Pack or other Accessories Call:

1-800-864-2199

or Log On to the Website: www.getxact.com

WARRANTY

XACT Products

One-year Limited Warranty

This limited warranty sets forth all **XACT™ Products'** responsibilities as they apply to your COMMUNICATOR. There are no other expressed or implied warranties from **XACT™ Products**.

Warranty Service Provided

If you purchased the COMMUNICATOR unit new from a retail vendor, **XACT™ Products** warrants the equipment against defects in material and workmanship for a period of one (1) year from the original date of purchase. This warranty is in lieu of all other express warranties. This warranty takes effect when you purchase the COMMUNICATOR unit and continues for one (1) year unless you sell or rent the unit, in which case the warranty ends.

XACT™ Products disclaims any implied warranty, including the warranty of merchantability and the warranty of fitness for a particular purpose, as of the date of one year from your original purchase of the COMMUNICATOR unit. **XACT™ Products** assumes no responsibility for any special, incidental, or consequential damages.

This warranty gives you specific legal rights and you may have other rights that vary from state to state. Some states do not allow the exclusion or limitation of special, incidental or consequential damages or limitation on how long a warranty lasts, so the above exclusion or limitation may not apply to you.

Warranty Service Not Provided

This warranty does not cover damages resulting from accident, misuse, abuse, improper installation or operation, lack of reasonable care, unauthorized modification, or the affixing of any attachment not provided by **XACT™ Products** with the COMMUNICATOR unit, and/or loss of parts. This warranty is voided in the event any unauthorized person opens, alters, or repairs the unit.

All **XACT™** equipment being returned for repair must be suitably packaged.

XACT™ Products does not warrant that this equipment is compatible with the type of accessory of any particular communicator company or the service provided by it.

WARRANTY

What To Do For Warranty Service

During the first thirty (30) days, a defective product is eligible for over-the-counter exchange at the retailer from whom it was purchased. After thirty (30) days, the defective product should be returned to the authorized service center. The shipping address of the authorized service center is:

U.S. Electronics CONSUMER CENTER
C/O Southern Bonded Warehouse
7137 Southlake Parkway
Morrow, GA 30260

Website – www.getxact.com

Your unit will be repaired or replaced if examination by the service center determines that the unit is defective.

A COMMUNICATOR unit received damaged as a result of shipping will require that you file a claim with the carrier to cover repair costs.

A COMMUNICATOR unit received with missing parts or with damage due to abuse, inadequate packing, or some other noncompliance with this limited warranty will be returned to you C.O.D., freight collect.

NOTE: A COMMUNICATOR received that was not made for XACT™ Products or which is not defective as determined by our test procedures will not be repaired and will be returned to you C.O.D., freight collect.

To Obtain Warranty Service

- Include proof of the date of purchase within the package.
- Prepay all shipping costs to the authorized service center.
- Include a return shipping address within the package.

Please retain your sales receipt, the carton, the packaging materials, and the printed materials. Should you need to return your COMMUNICATOR, the original carton is the best shipping container for the unit.

WARRANTY

For your reference:

Model Number _____

Date of Purchase _____

Name of Dealer _____

Toll Free Customer Service Telephone Number: 1-800-864-2199

FCC Licensing Information:

Channels 1 thru 14 transmit on FRS frequencies.

Channels 15 thru 22 transmit on GMRS frequencies.

Operation on GMRS frequencies requires a license from the federal Communications Commission (FCC).

If you intend to use GMRS channels, information regarding an application for your license can be obtained as follows:

Website – <http://wireless.fcc.gov/prs/genmb1.html>

Tel.: 1-800-418-3676

GMRS LICENSING INFORMATION

Before any station transmits on any channel authorized in the GMRS from any point within or over the territorial limits of any area where radio services are regulated by the FCC, the responsible party must obtain a license for a GMRS system. An individual 18 years of age or older, who is not a representative of a foreign government is eligible to apply for a GMRS license. Application for a GMRS system license is made on FCC Form 605 and you can obtain a copy from the FCC's Web site: <http://www.fcc.gov/formpage.html> or by calling the FCC's Forms Distribution Center 1-800-418-FORM (3676), or from the fax-on-demand by dialing (202) 418-0177. There is a filing fee. For information on fees, see the FCC's Web site: <http://www.fcc.gov/csinfo/feeinfo.html>

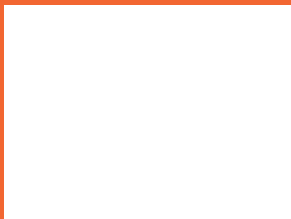

Made in China
BN

www.getxact.com