

Huawei Ascend XT^{2™}



Let's get started



AT&T Eco Rating 2.0 only applies to Huawei Ascend XT^{2™}. For limited factors evaluated visit att.com/EcoSpace. Wireless Emergency Alerts is a registered Trademark and Service Mark of CTIA.

Product meets FCC Radio Frequency Exposure Guidelines - FCC ID: Q1SH1711. This device complies with Part 15 of the FCC Rules. Operation is subject to the following two conditions: (1) this device may not cause harmful interference, and (2) this device must accept any interference received, including interference that may cause undesired operation. Huawei and Huawei Ascend XT^{2™} are trademarks or registered trademarks of Huawei Technologies Co., Ltd. LTE is a trademark of ETSI. 4G LTE not avail. everywhere. Contains Li-ion polymer battery - recycle or dispose of properly. ©2017 AT&T Intellectual Property. All rights reserved. AT&T, the AT&T logo and all other AT&T marks contained herein are trademarks of AT&T Intellectual Property. All other marks are the property of their respective owners.



Optimize Battery Life

On the home screen, touch **Apps > Settings > Battery**.

You can:

- View detailed battery usage statistics.
- Optimize battery use to reduce power consumption.
- Select a suitable power saving mode according to the remaining battery.

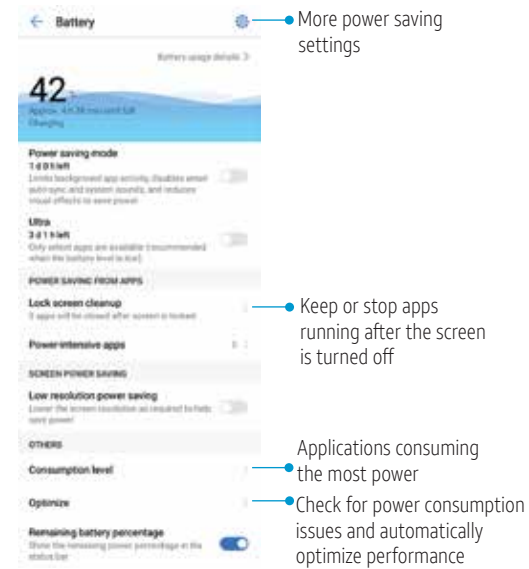

What else is in the box?

- Huawei Ascend XT^{2™}
- Pre-installed SIM
- Li-ion Polymer Battery (non-removable)
- Power Adapter
- USB Data Cable
- SIM Tray Pin

Useful Apps*

AT&T DriveMode
Stay safe while driving. Stop incoming calls and text messages.

AT&T Protect Plus
Backup and access your photos, videos, and contacts. Locate your lost phone or remotely lock it. And live support is seconds away.

AT&T Call Protect
Use the power of the AT&T network to automatically block fraud calls and warn about suspected spam calls.

Setup & Transfer
Transfer your content, setup accounts, and more.

*Compatible device and subscription may be required. Data and messaging rates may apply. Restrictions and limitations may apply. For more app information, go to <https://att.com/shop/apps>.

Find More Information

Manage Your Account with myAT&T

- On your phone: **Apps > myAT&T**
- On the web: att.com/myATT



Compatible device and online account required. Data and messaging rates may apply for download and app usage.

Need More Help?

- On your phone: **Apps > Device Help**
- On the web: att.com/DeviceHowTo



Give us a Call

- 611 from any AT&T wireless phone
- 800.331.0500 or prepaid 800.901.9878



Easily Adjust Settings

Settings Menu

On the home screen, touch **Apps > Settings**.

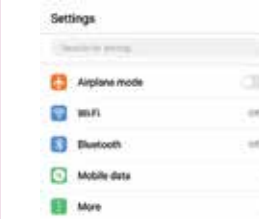

Quick Settings

The shortcuts tab allows for quick access to some of your phone's most used features and can be customized.

1. Swipe down from the status bar.
2. Touch to go to the **Settings** menu.

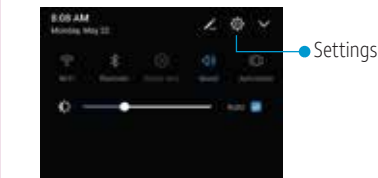

Capture Life's Moments

Take a Picture

1. On the home screen, touch **Camera**.
2. Frame the scene you want to capture.
3. Touch .

Record a Video

1. On the home screen, touch **Camera**.
2. Touch to select **Video**.
 - Touch to start recording.
 - Touch to take a picture while recording.
 - Touch to pause recording.
 - Touch to stop recording.

Share a Picture or Video

1. On the home screen, touch **Gallery**.
2. Select the photo or video that you want to share.
3. Touch , choose a sharing method, and follow the onscreen instructions to share your photo or video.

How to replace the SIM

Install a SIM/ microSD

Follow the instructions below to install a nano-SIM card and microSD card. Then press and hold the **Power button** to turn on your phone.

Your new SIM card is pre-installed. If you are an existing AT&T customer, replace it with your current SIM (see instructions below).

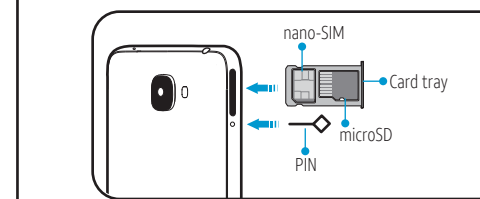

1. To remove the card tray, insert the SIM eject pin included with your phone into the small hole next to the card tray.
2. Insert a nano-SIM card or microSD card into the card tray.
3. Insert the card tray back into your phone in the correct orientation.

Turn on your new phone

Press and hold the **Power button** until the device turns on.

Call Family & Friends

Make a Call

1. From the home screen, touch **Dialer**.
2. Make a call using the keypad, call logs or contacts.



Check Voicemail

1. From the home screen, touch **Dialer**.
2. Touch to check voicemail.

Visual Voicemail

From the home screen, touch **Apps > Visual Voicemail**, and then select a message to play.

Surf & Stream in no time

Connect to Wi-Fi

On the home screen, flick down from the status bar and touch to turn on Wi-Fi. Touch and hold to go to Wi-Fi settings and select a Wi-Fi network.



Use Bluetooth

On the home screen, flick down from the status bar and touch to turn on Bluetooth. Touch and hold to go to the Bluetooth menu in **Settings**.

