

HUAWEI FreeLace

Quick Start Guide

Ghid de pornire rapidă

Appearance

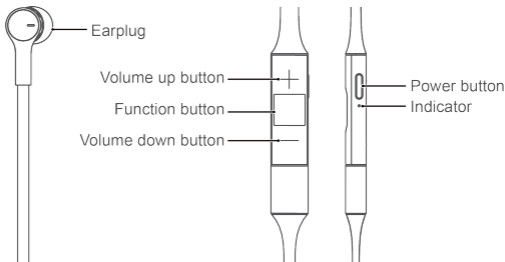

Powering on/off

Press and hold the Power button for approximately 1 second to power on/off (when powering on for the first time, your earbuds will automatically enter Pairing mode by default).

Pairing and automatic connections

Bluetooth pairing

1. Press and hold the Power button for approximately 4 seconds to enter Pairing mode (at this time, the indicator will flash white).
2. Enable the Bluetooth on your phone, then search for the device name "HUAWEI FreeLace" and connect.

Automatic reconnection

Once your earbuds power on, they will automatically connect to the most recently paired device.



Please ensure that the Bluetooth on your phone is enabled, and that your earbuds are within the Bluetooth range of your phone.

Hall magnetic switch

When the switch is closed, the earbuds are disconnected.

When the switch is apart, the earbuds automatically reconnect.

How to use the earbuds

Call mode

Upon receiving an incoming call, press the Function button to answer the call, or press and hold the Function button for approximately 2 seconds to reject the call.

During an ongoing call, press the Function button to end the call.

English

Music mode

Press the Function button to play/pause music playback.

Double-press the Function button to skip to the next song.

Triple-press the Function button to return to the previous song.

Press the Volume up button to increase the volume.

Press the Volume down button to decrease the volume.

Smart mode

In Music or Standby mode, press and hold the Function button for approximately 2 seconds to activate voice assistant on your phone.

HUAWEI HiPair Technology

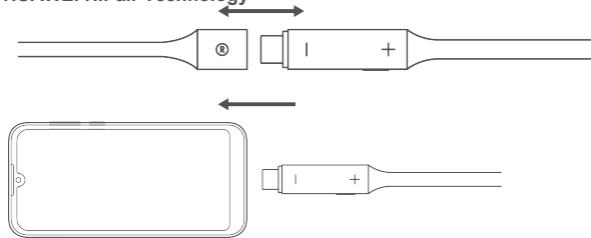

After plugging your earbuds' built-in USB Type-C connector into your phone:

1. If your earbuds are not already paired with your phone, your phone will prompt the pairing via a pop-up window. In this case, following the onscreen instructions on your phone to complete the pairing process (only available on EMUI 9.1 or later).
2. You can quickly charge your earbuds using your phone (Reverse charging required).

Factory reset

Press and hold the Power button for approximately 10 seconds to restore to factory settings. When the indicator flashes red, your earbuds will be restored to its factory settings, clearing all Bluetooth pairing information, and then will restart.

Charging your earbuds

1. Charge via connecting the charger.
The charger can be connected via the USB Type-A to USB Type-C female adapter cable.
2. Charge via connecting your earbuds to your phone.
Connect your earbuds to the USB Type-C port of your phone (Reverse charging required).

Firmware update

If a firmware update is available, you can update your earbuds from your phone (EMUI 9.1 or later) by performing the following:

Go to the **Paired Bluetooth device** screen and touch **Firmware update**, then touch **Check for updates** to check for available updates.

If an update is available, touch **Download and update**, then follow the onscreen instructions to complete the update process.

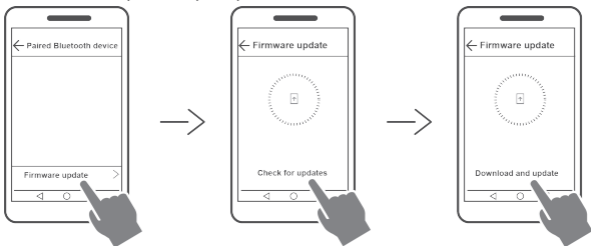

Indicator descriptions

Power on	Steady white for 1 second
Power off	Steady red for 1 second
Automatic connection mode	Flashes white twice every 3 seconds
Pairing mode	Flashes white three times every second
Incoming/outgoing call	Flashes white twice every second
Charging	Flashes red: Low battery level Flashes white: Sufficient battery level Steady white: Fully charged
Low battery	Flashes red twice every 10 seconds

Safety information

Before using the device, read and comply with the following precautions carefully to ensure optimal device performance and avoid danger or violation of laws and regulations.



- To prevent possible hearing damage, do not listen at high volume levels for long periods.
- Do not use the device at locations where the use of wireless devices is prohibited due to potential interference with other electronic equipment, which may cause safety hazards.
- In clinics and hospitals where the use of wireless devices is prohibited, please comply with the regulations and power off the device.
- Some wireless devices may interfere with implantable medical equipment and other medical equipment, such as pacemakers, cochlear implants, and hearing aids. Consult the manufacturer of your medical equipment for more information.
- When using the device, keep it at least 15 cm away from medical equipment.
- When using the earphones to listen to music or make calls, please use the minimum volume necessary in order to avoid damaging your hearing. Prolonged exposure to high volume sounds may result in permanent hearing damage.
- Please reduce your audio volume while driving in order to reduce distractions and avoid accidents.
- Observe all local traffic laws and regulations while using the device. Do not use the device while driving.
- Keep in mind that while driving, safety is your primary responsibility, and avoid engaging in distracting activities.
- The device's wireless signal may interfere with your car's electronic systems. Please contact your car manufacturer for more information.
- Wireless devices may interfere with an aircraft's flight systems. Adhere to in-aircraft regulations and power off the device when required.
- If you use your earphones while performing activities that require your concentration, such as riding a bike or walking in a potentially dangerous area such as near a construction site or railroad, please pay attention to your safety and the safety of those around you. It is recommended that you either lower the volume on your earphones or remove your earphones in order to increase your awareness of your surroundings.
- Avoid dusty, damp, or dirty environments. Avoid magnetic fields. Using the device in these environments may result in circuit malfunctions.
- Keep the device away from appliances with strong magnetic or electrical fields, such as microwave ovens and refrigerators.
- Do not use the device during thunderstorms to avoid any lightning-related damage or injury.

- Use the device at temperatures between 0°C and +45°C, and store the device and its accessories at temperatures between –20°C and +60°C. Extreme heat or cold may damage the device.
- Do not place the device in places that are easily exposed to direct sunlight such as on a car's dashboard or on a window sill.
- Do not place the device near exposed heat or ignition sources (such as heaters, microwaves, ovens, stove fire, candles, and so on).
- Do not place sharp metal objects, such as large pins, near the receiver or speaker of the device. Otherwise, metal objects may be attached, which may cause damage to you.
- The device and its accessories may contain small components. Keep the device and its accessories out of the reach of children. Otherwise, children may damage the device and its accessories by mistake, or swallow the small components, which may result in hazards such as choking.
- The device is not a toy, and children should only use it under adult supervision.
- You can only use device manufacturer-approved accessories for this model number. The use of other accessories may void the device warranty, lead to injury, or violate the related regulations of the country where the device is located. Contact an authorized Huawei Customer Service Center to obtain approved accessories.
- Connecting the device to non-approved or incompatible power supplies, chargers, or batteries is not advised as this may cause fires or explosions.
- Do not disassemble or modify the device, insert foreign objects, or submerge in water or other liquids to prevent leakage, overheating, fires, or explosions.
- Do not drop, squeeze, or puncture the battery. Avoid applying external pressure to the battery as this may cause its electronic circuitry to short or overheat.
- The device is equipped with a non-removable internal battery. Do not attempt to replace the battery yourself to avoid damaging the battery or device or causing fires and explosions. The battery should only be replaced by professional personnel at an authorized Huawei Customer Service Center.
- Ensure that the device and its accessories are dry. Do not attempt to dry the device using an external heating device such as a microwave oven or hair dryer.
- Avoid placing the device or its accessories in environments that are too hot or cold as this may cause device malfunctions or even explosions.
- Stop using the device, close all apps, and disconnect all connected devices before cleaning and performing maintenance on the device.
- Do not use strong chemicals, cleaning agents, or strong detergents to clean the device and its accessories. Instead, only clean the device and its accessories using a clean, soft, and dry cloth.
- Do not place magnetic stripe cards (such as bank cards or phone cards) near the

English

device for extended periods of time as this may damage the magnetic stripe card.

- Please do not disassemble or modify the device and its accessories without prior authorization. Any resulting damage in this case will not be covered by manufacturer's warranty. If the device suffers an error or ceases to function properly, please contact an authorized Huawei Customer Service Center for assistance.
- Avoid disposing the device and its accessories as ordinary household waste.
- Respect local laws on the disposal of electronic products and their accessories and support recycling efforts.
- Some people are allergic to silicone, plastic, metals, and other materials. If you feel uncomfortable after prolonged use of the earbuds, stop using them and consult a doctor.

Disposal and recycling information



The crossed-out wheeled-bin symbol on your product, battery, literature or packaging reminds you that all electronic products and batteries must be taken to separate waste collection points at the end of their working lives; they must not be disposed of in the normal waste stream with household garbage. It is the responsibility of the user to dispose of the equipment using a designated collection point or service for separate recycling of waste electrical and electronic equipment (WEEE) and batteries according to local laws.

Proper collection and recycling of your equipment helps ensure electrical and electronic equipment (EEE) waste is recycled in a manner that conserves valuable materials and protects human health and the environment, improper handling, accidental breakage, damage, and/or improper recycling at the end of its life may be harmful for health and environment. For more information about where and how to drop off your EEE waste, please contact your local authorities, retailer or household waste disposal service or visit the website <http://consumer.huawei.com/en/>.

Reduction of hazardous substances

This device and any electrical accessories are compliant with local applicable rules on the restriction of the use of certain hazardous substances in electrical and electronic equipment, such as EU REACH, RoHS and Batteries (where included) regulations, etc. For declarations of conformity about REACH and RoHS, please visit our web site <http://consumer.huawei.com/certification>.

EU regulatory conformance

RF Exposure

Your device is a low-power radio transmitter and receiver. As recommended by international guidelines, the device is designed not to exceed the limits established by the European Commission for exposure to radio waves.

Statement

Hereby, Huawei Technologies Co., Ltd. declares that this device CM70-L is in compliance with the essential requirements and other relevant provisions of Directive 2014/53/EU.

The most recent and valid version of the DoC (Declaration of Conformity) can be viewed at <http://consumer.huawei.com/certification>.

This device may be operated in all member states of the EU.

Observe national and local regulations where the device is used.

This device may be restricted for use, depending on the local network.

Frequency Bands and Power

- (a) Frequency bands in which the radio equipment operates: Some bands may not be available in all countries or all areas. Please contact the local carrier for more details.
- (b) Maximum radio-frequency power transmitted in the frequency bands in which the radio equipment operates: The maximum power for all bands is less than the highest limit value specified in the related Harmonized Standard.

The frequency bands and transmitting power (radiated and/or conducted) nominal limits applicable to this radio equipment are as follows:

CM70-L	Bluetooth: 2402 MHz-2480 MHz: 11 dBm
--------	--------------------------------------

Accessories and Software Information

Some accessories are optional in certain countries or regions. Optional accessories can be purchased from a licensed vendor as required. The following accessories are recommended:

Batteries: HUA01, AHB380942TPO, AHB380942TPO-01

The product software version is V1.0.0.100. Software updates will be released by the manufacturer to fix bugs or enhance functions after the product has been released. All software versions released by the manufacturer have been verified and are still compliant with the related rules.

All RF parameters (for example, frequency range and output power) are not accessible to the user, and cannot be changed by the user.

For the most recent information about accessories and software, please see the DoC (Declaration of Conformity) at <http://consumer.huawei.com/certification>.

FCC Regulatory Compliance

Certification information (SAR)

This device is also designed to meet the requirements for exposure to radio waves established by the Federal Communications Commission (USA).

The SAR limit adopted by the USA is 1.6 W/kg averaged over one gram of tissue. The highest SAR value reported to the FCC for this device type complies with this limit.

The highest SAR value reported to the FCC for this device type when using it at the head is

CM70-L	0.210 W/kg
--------	------------

And when properly worn on the body is

CM70-L	0.269 W/kg
--------	------------

FCC statement

This equipment has been tested and found to comply with the limits for a Class B digital

English

device, pursuant to Part 15 of the FCC Rules. These limits are designed to provide reasonable protection against harmful interference in a residential installation. This equipment generates, uses and can radiate radio frequency energy and, if not installed and used in accordance with the instructions, may cause harmful interference to radio communications. However, there is no guarantee that interference will not occur in a particular installation. If this equipment does cause harmful interference to radio or television reception, which can be determined by turning the equipment off and on, the user is encouraged to try to correct the interference by one or more of the following measures:

- Reorient or relocate the receiving antenna.
- Increase the separation between the equipment and receiver.
- Connect the equipment into an outlet on a circuit different from that to which the receiver is connected.
- Consult the dealer or an experienced radio/TV technician for help.

This device complies with Part 15 of the FCC Rules. Operation is subject to the following two conditions: (1) this device may not cause harmful interference, and (2) this device must accept any interference received, including interference that may cause undesired operation.

Caution: Any changes or modifications to this device not expressly approved by Huawei Technologies Co., Ltd. for compliance could void the user's authority to operate the equipment.

Responsible Party - Contact for FCC Information only

Huawei Device USA Inc.

5700 Tennyson Parkway, Suite 300

Plano, TX 75024

Main: 214-919-6800

Industry Canada compliance

Certification information (SAR)

This device is also designed to meet the requirements for exposure to radio waves established by the Industry Canada.

The SAR limit adopted by Canada is 1.6 W/kg averaged over one gram of tissue. The highest SAR value reported to the IC for this device type complies with this limit.

The highest SAR value reported to the IC for this device type when using it at the head is

CM70-L	0.210 W/kg
--------	------------

And when properly worn on the body is

CM70-L	0.269 W/kg
--------	------------

IC statement

This device complies with CAN ICES-3 (B)/NMB-3(B).

This device complies with Industry Canada licence-exempt RSS standard(s). Operation is subject to the following two conditions: (1) this device may not cause interference, and (2) this device must accept any interference, including interference that may cause undesired operation of the device.

Le présent appareil est conforme aux CNR d'Industrie Canada applicables aux appareils radio exempts de licence. L'exploitation est autorisée aux deux conditions suivantes: (1) l'appareil ne doit pas produire de brouillage, et (2) l'utilisateur de l'appareil doit accepter tout brouillage radioélectrique subi, même si le brouillage est susceptible d'en compromettre le fonctionnement.

English

Legal statement

Copyright © Huawei Technologies Co., Ltd. 2019. All rights reserved.

This document is for reference only. Nothing in this guide constitutes a warranty of any kind, express or implied.

All pictures and illustrations in this document are for reference only, the actual product may differ from images on the packaging (including but not limited to colors, shape and screen display).

Please visit <http://consumer.huawei.com/us/support/index.htm> for recent updated hotline and email address in your country or region.

The *Bluetooth*[®] word mark and logos are registered trademarks owned by *Bluetooth SIG, Inc.* and any use of such marks by Huawei Technologies Co., Ltd. is under license.

User Software License Agreement

Please read the software license agreement carefully before using the product. By using the product, you indicate that you agree to be bound by the license agreement. If you do not agree with the terms of the license agreement, please do not use the product and software. The product can be returned to the point of sale for a refund.

For agreement content, please visit: <https://consumer.huawei.com/en/legal/eula/>.

Privacy protection

To understand how we protect your personal information, please visit <http://consumer.huawei.com/privacy-policy> and read our privacy policy.

For United States warranty card information, visit

<http://consumer.huawei.com/us/support/warranty-policy/index.htm>.