

tzumi



ProBuds™

True Wireless Earbuds
with Charging Case

FCC ID: QIFE15

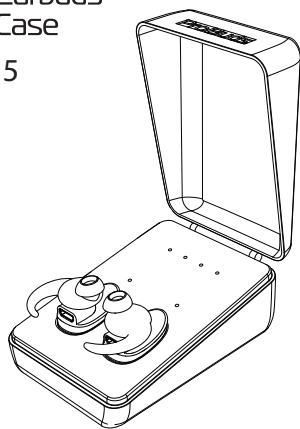

USER MANUAL

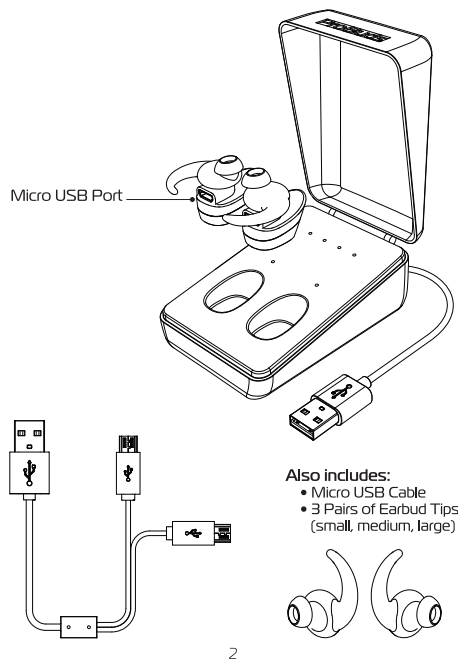

CHARGING THE CHARGING STATION

1. Plug the built-in USB cable of the Charging Station into an active computer USB port or USB AC adapter that is plugged into an active wall outlet.
2. Blue lights will blink to indicate charging has begun, all four lights will remain lit when charging is complete.
3. Once charging station is ready for use, press Power button to turn on.

CHARGING THE EARBUDS

These earbuds have an internal rechargeable battery. The battery must be fully charged prior to use. Charging time is approximately 1.5 hours. Your earbuds cannot be used while charging.

VIA CHARGING STATION:

1. Place earbuds into charging station.
2. Blue light appears when charging has begun. Blue light turns off when charge is complete.

VIA COMPUTER OR AC ADAPTER:

1. Using the provided Micro USB cable, connect the Earbuds (Micro USB port) directly into to an active computer USB port or USB AC Adapter that is plugged into an active wall outlet.
2. Red light appears when charge has begun, blue light appears when charge is complete.

Power / Multi-Function Button
ON/OFF, PLAY/PAUSE
Call Answer, Hang Up

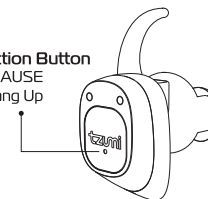

EARBUDS CONTROLS

LISTENING TO MUSIC

- Play music _____ Press multi-function button
- Pause/resume music _____ Press multi-function button
- Power ON/OFF _____ Press and hold multi-function button

MAKING AND RECEIVING CALLS

[MASTER EARBUD ONLY]

You can use your earbuds in various ways for handling calls.

- Answer call _____ Press multi-function button
- End a call _____ Press multi-function button
- Reject call _____ Press and hold multi-function button for 2 seconds
- Redial last call _____ Press twice quickly on the multi-function button
- Switch between calls _____ Press and hold multi-function button to answer second call, or switch back to first call

PAIRING TO BLUETOOTH DEVICE

Make sure the Bluetooth function is available on your electronic device. Specific pairing procedures may vary slightly depending on the device. For detailed information, please refer to your device's User Guide.

- If no device connection is made within 5 minutes of the earbuds being switched on, the earbuds will automatically switch off to save power.
- After successful pairing, devices will remember each other. Therefore, no pairing will be needed next time.

PAIRING BOTH EARBUDS

1. Keep the distance between the device and the tzumi earbuds within 3 feet (for pairing only).
2. Press and hold the multi-function button on both earbuds for a few seconds until you hear prompt "Power on" or see blue lights flashing.
3. You will hear prompts, "Left Channel" on Left Earbud and "Right Channel" on Right Earbud to begin pairing.
4. Activate the Bluetooth function on your device to search for Bluetooth devices. Look for "Tzumi-TWE" in device list displayed and select.
5. You will hear "Sort Connected" from the Master Earbud (RIGHT Earbud-Factory default setting) when connection is successfully made or see blue lights flashing.
6. Only for some electronic devices: Press "YES" or "Enter" key to confirm successful pairing. Blue lights will flash from both earbuds every few seconds.
7. Both earbuds are now ready for use.

SINGLE EARBUD PAIRING

RIGHT EARBUD only [MASTER - Default]

1. Press and hold the multi-function button for a few seconds until blue/red lights flash quickly. Soon you may hear prompt "Pairing."
3. Activate the Bluetooth function on your device to search for Bluetooth devices. Look for "Tzumi-TWE" in device list displayed and select.
4. When successful connection is made you will hear prompt "Sort Connected" or see blue lights flashing.
5. Right earbud is now ready for use.

LEFT EARBUD only

1. Press and hold the multi-function button for a few seconds until blue/red lights flash quickly. Soon you may hear prompt "Pairing."
3. Activate the Bluetooth function on your device to search for Bluetooth devices. Look for "Tzumi-TWE" in device list displayed and select.
4. When successful connection is made you will hear prompt "Sort Connected" or see blue lights flashing.
5. Left earbud is now ready for use.

NOTE:

Factory default setting is RIGHT Earbud as MASTER Earbud. To reset / change MASTER Earbud, hold multi-function button on BOTH earbuds for 6 seconds. When blue/red lights flash quickly, press multi-function button twice on the earbud you want to set as the Master Earbud.

CONNECTING TO OTHER BLUETOOTH DEVICES

NOTE: Your TWE can only be connected to one Bluetooth device at a time.

1. In order to connect to another Bluetooth device, you must first disconnect current Bluetooth device connection.
2. After disconnecting, follow steps for Bluetooth Device pairing to pair your TWE to the new Bluetooth device.

To Power Off Earbuds

Press and hold until red lights show up on both earbuds. Then they will turn off. Store and carry in portable case or carry around loose - magnetized earbuds will stick together.

FAQ / Troubleshooting

- Q: Why does pairing not work?
A: If pairing does not work, power off the earbuds. Press the multi-function button for 10 seconds to eliminate any previous Bluetooth device pairing and try pairing process again.
- Q: Why does TWE not turn on?
A: Make sure TWE is fully charged before using it for the first time. TWE will not turn on if battery level is very low.
- Q: There is no sound during playback.
A: Check the Bluetooth connection between TWE and your device. If connection is not established, please reconnect again and adjust volume level as needed.

BATTERY DISPOSAL:

This product contains a lithium polymer battery. Lithium polymer batteries are environmentally safe when fully discharged. Please refer to your local and state laws for battery disposal procedures.

IMPORTANT SAFEGUARDS

- Do not use this unit for anything other than its intended use.
- Keep the unit away from heat source, direct sunlight, humidity, water or any other liquid.
- Do not expose the device to extremely high or low temperatures, as it may damage the battery.
- Do not operate the unit if it has been wet or moist to prevent against electric shock and/or injury to yourself and damage to the unit.
- Do not use the unit if it has been dropped or damaged in any way.
- Repairs to electrical equipment should only be performed by a qualified electrician. Improper repairs may place the user at serious risk.
- Keep the unit out of reach of children.
- This unit is not a toy.

SPECIFICATIONS	Sensitivity _____	109 +/- 3dB
	Frequency _____	200-20kHz
	Bluetooth Version _____	Bluetooth V4.2
	Standby Time _____	Up to 40 hours
	Charge Time _____	Up to 1.5 hours
	Continuous Play Time _____	2-2.5 hours
Battery _____	Polymer Lithium: 3.7V 40 mAh	

ProBuds tzumi™ Inc. True Wireless Earbuds. Distributed by tzumi Inc. NY, NY, 10016. ©Copyright 2016 tzumi Inc. All Rights Reserved. Made in China. ©Copyright 2016 Bluetooth SIG, Inc. The Bluetooth™ word mark and logos are registered trademarks owned by Bluetooth SIG, Inc. and any use of such marks by tzumi™ is under license. Other trademarks and trade names are those of their respective owners. Subject to change without prior notice.

NOTE: This equipment has been tested and found to comply with the limits for a Class B digital device, pursuant to part 15 of the FCC Rules. These limits are designed to provide reasonable protection against harmful interference in a residential installation. This equipment generates uses and can radiate radio frequency energy and, if not installed and used in accordance with the instructions, may cause harmful interference to radio communications. However, there is no guarantee that interference will not occur in a particular installation. If this equipment does cause harmful interference to radio or television reception, which can be determined by turning the equipment off and on, the user is encouraged to try to correct the interference by one or more of the following

- Reorient or relocate the receiving antenna.
- Increase the separation between the equipment and receiver.
- Connect the equipment into an outlet on a circuit different from that to which the receiver is connected.
- Consult the dealer or an experienced radio/TV technician for help

Changes or modifications not expressly approved by the party responsible for compliance could void the user's authority to operate the equipment. This device complies with Part 15 of the FCC Rules. Operation is subject to the following two conditions:

- (1) this device may not cause harmful interference, and
- (2) this device must accept any interference received, including interference that may cause undesired operation.