

Library Security Pedestal



TAGSYS RFID solutions for Library

L-SP3

Best in class performance solution for library applications, the L-SP3 Security pedestal provides a feature rich platform for RFID security applications.

State of the Art TAGSYS RFIDSP technology (Digital Signal Processing Algorithms) have been integrated to improve overall system performance and reliability.

Offered with a semi-opaque design, LSP3 is the solution for customers looking for a high performance and cost effective RFID security system.



L-SP3 Clear

LSP3 Clear has been designed for environments where aesthetics are a key factor. It couples a sleek profile and high quality acrylic panel with a high performance electronics to achieve a best in breed RFID security system.

LSP3 Clear implements all advanced features offered in TAGSYS Security Pedestal product range including 3D detection, RFIDSP technology, multi-directional people counter and internal Data Base Storage.



L-SP3 GPP (Global Personalization Program)



When **design** and **performance** make **ONE**



LSP3 GPP is the perfect synthesis between design and functionality.

The family offers a complete range of library security pedestals to meet the unique requirements of librarians and architects.

Proposed with three distinctive designs, LSP3 GPP allows the personalization of your solution and ensures the perfect match with library environments and architecture. More than a functional product, LSP3 GPP is a key element of the aesthetical coherence in your library.

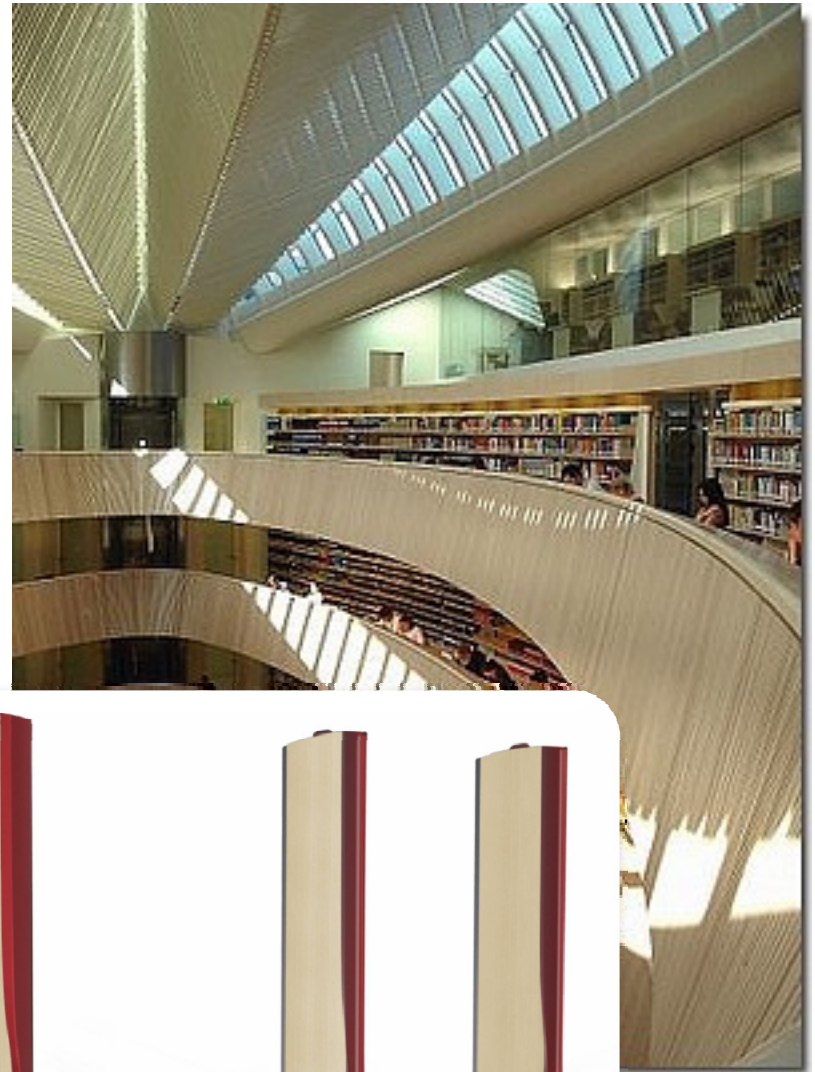

TAGSYS, the world leader in RFID security pedestals, has used its unique expertise in RFID architecture and design to bring LSP3 GPP to libraries world wide. Outstanding 3D detection performances, coupled with functional features such as multi-directional people counter, remote monitoring, network connectivity and external peripherals management makes LSP3 GPP the most desirable tool to secure your library infrastructure. LSP3 GPP enhances the efficiency of your collection management processes and staff operations thanks to statistics and reports delivered via e-Connectware, the TAGSYS RFID Software Platform.

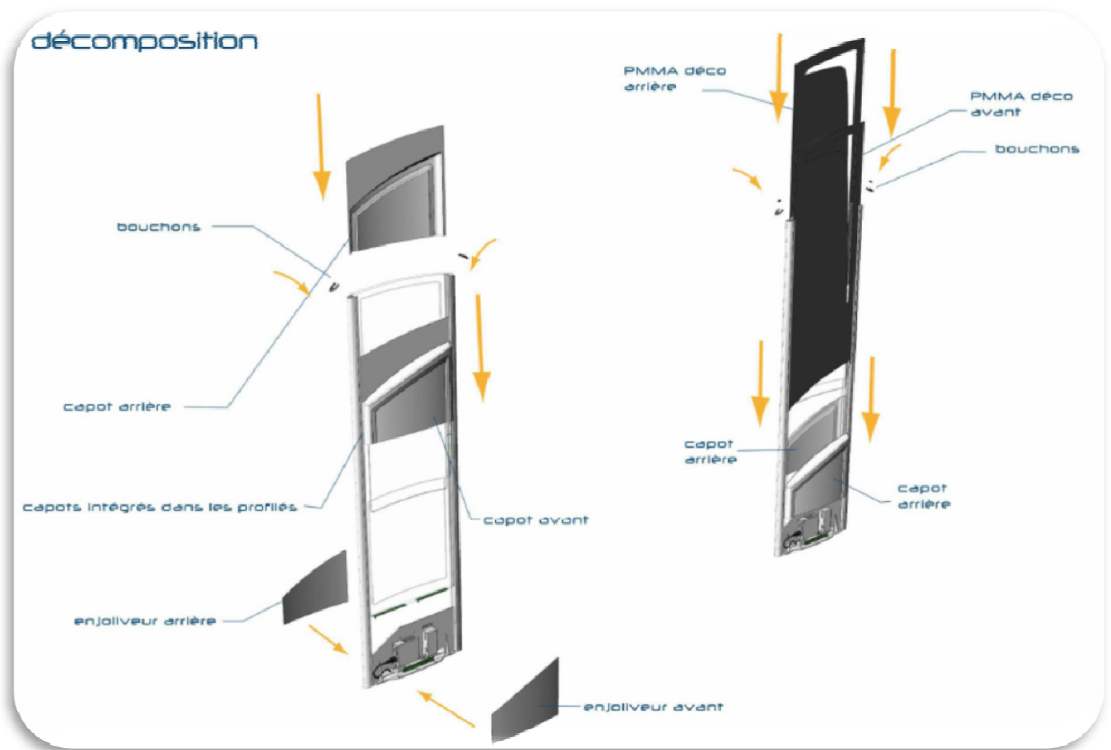

The Auto-Discovery mode and embedded automatic synchronization facilitates easy and efficient installation of up to 9 pedestals and the connection to your private network.

Since your data is critical, the LSP3 GPP features an embedded Data base to store your key data in case of Power Supply Issue.

Opal

Its large transparent panel makes Opal the perfect choice when discretion is a key factor. A large choice of colors are available as well as decorative materials such as metallic and wood finishes.

The clear panel can also be covered with an opaque material to meet specific design demands.

An Ambient light can be added to complete the aesthetical execution.



Suggestion

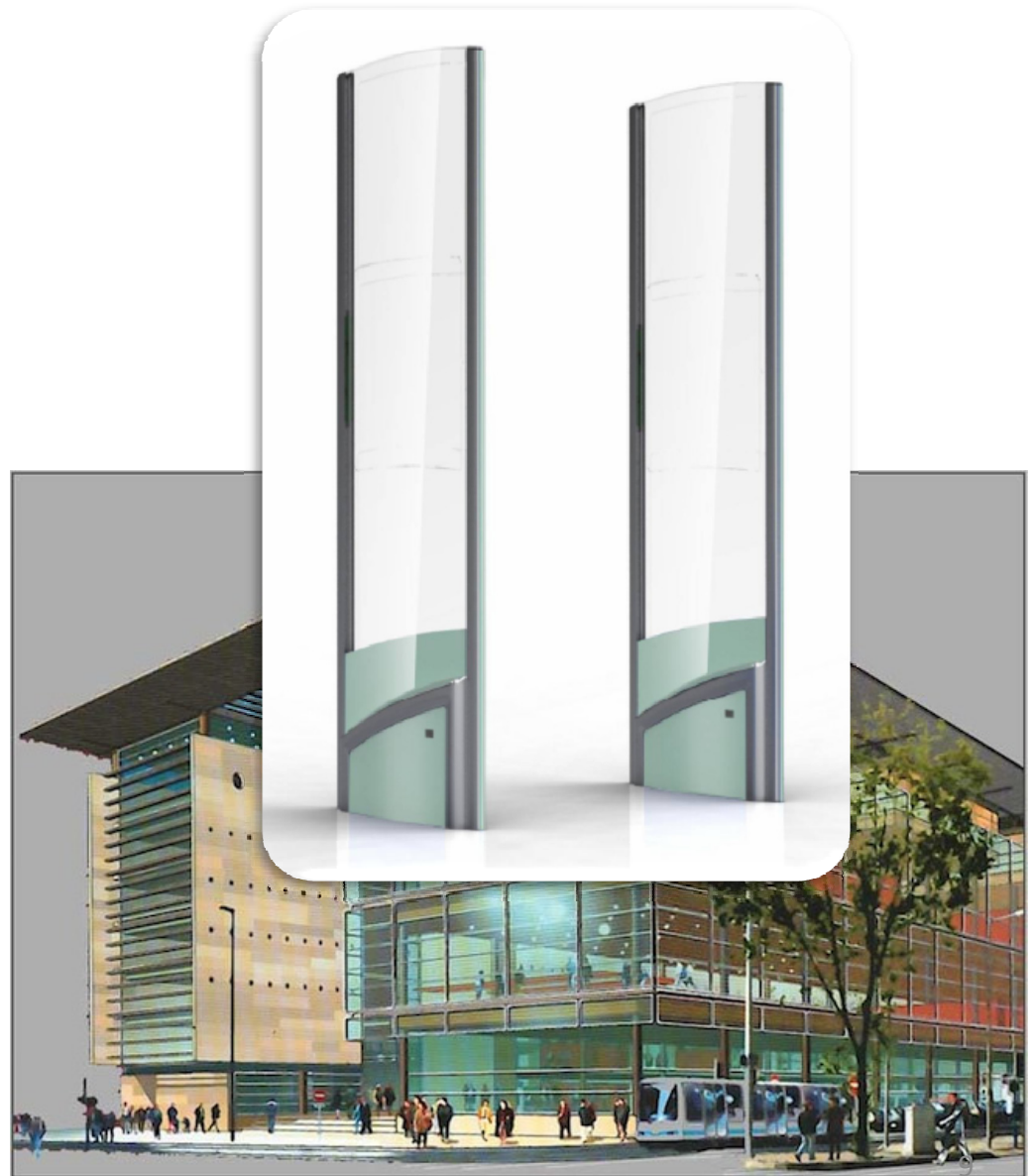

Suggestion



Diamond

This unique design meets both modern environment with its large and clear profiles and more classic architectures with the addition of wood material.



Suggestion



Jade

Curves and vitality characterize the Jade design. Jade offers a high level of customization thanks to its various casing possibilities and a large assortment of colors and materials.



Suggestion



Color and decorative chart

The rich LSP3 GPP Color and Decorative chart offers a wealth of design combination to meet your aesthetical requirement. It is available for Opal, Diamond and Jade models.

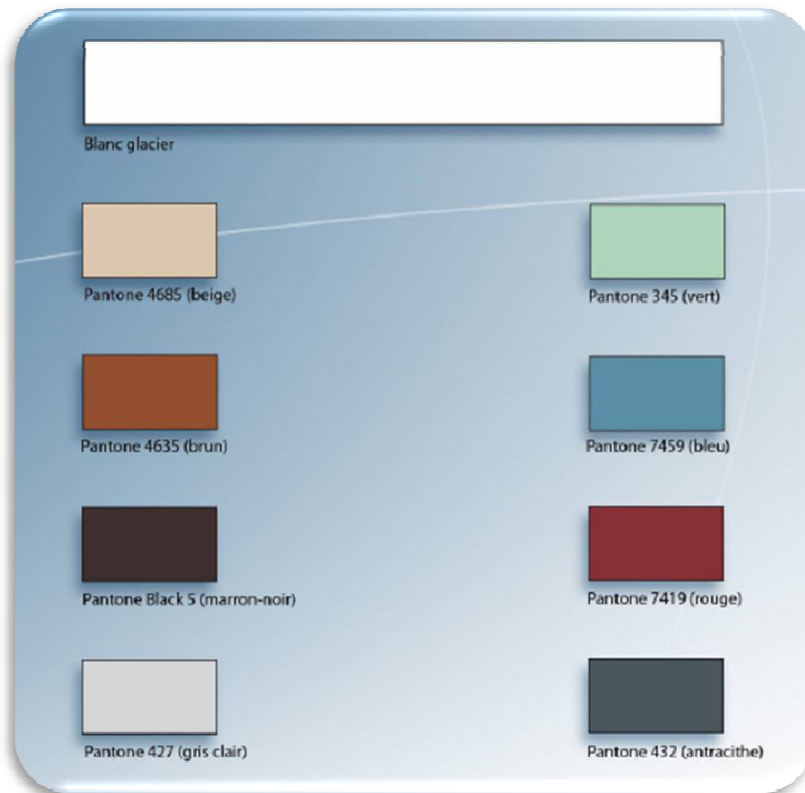

Opal Options



Decorative panel

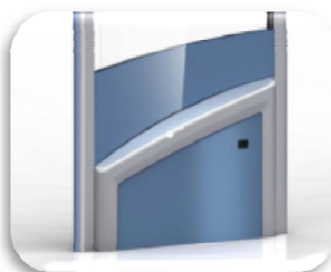

Bi-color Base Panel



Ambient light

Opal

Mono color Base panel	<ul style="list-style-type: none"> ● (Grey) ○ (Other color) ○ (Decorative material)
Bi-color base Panel	○ (Grey and Other color)
Specific Logo	○
People Counter	●
Ambient light	○
Decorative panel	<ul style="list-style-type: none"> ○ (Color) ○ (Decorative Material)

●Serial
○Option

Diamond Options



Side panel color



Decorative panel



Base Panel Color



Ambient light



Diamond

Base panel Color	<input checked="" type="radio"/> (Grey) <input type="radio"/> (Other color) <input type="radio"/> (Decorative material)
Side panel Color	<input checked="" type="radio"/> (Grey) <input type="radio"/> (Other color)
Specific Logo	<input type="radio"/>
People Counter	<input checked="" type="radio"/>
Ambient light	<input type="radio"/>
Decorative panel	<input type="radio"/> (Color) <input type="radio"/> (Decorative Material)

☒ Serial
☐ Option

Jade 1 Options



Decorative panel



Bi-color Base Panel



Ambient light

Jade 1

Mono Color Base panel	<input checked="" type="radio"/> (Grey) <input type="radio"/> (Other color) <input type="radio"/> (Decorative material)
Bi-Color base panel	<input type="radio"/>
Specific Logo	<input type="radio"/>
People Counter	<input checked="" type="radio"/>
Ambient light	<input type="radio"/>
Decorative panel	<input type="radio"/> (Color) <input type="radio"/> (Decorative Material)

☒ Serial
☐ Option

Jade 2 Options



Side panel
color



Decorative panel



Base Panel Color



Ambient light

Jade 2

Base panel Color	<input checked="" type="radio"/> (Grey) <input type="radio"/> (Other color) <input type="radio"/> (Decorative material)
Side panel Color	<input checked="" type="radio"/> (Grey) <input type="radio"/> (Other color)
Specific Logo	<input type="radio"/>
People Counter	<input checked="" type="radio"/>
Ambient light	<input type="radio"/>
Decorative panel	<input type="radio"/> (Color) <input type="radio"/> (Decorative Material)

☒ Serial
☐ Option

Technical characteristics

LSP3, LSP3 Clear and LSP3 GPP implement the best RFID technology for Library application. Advanced features are integrated to facilitate installation, deployment, operation and data management. The following non exhaustive list provides an overview of embedded technologies.

- 3D detection
- Visual and sounding alarm
- RFIDSP technology (Digital Signal processing)
- Auto-discovery mode
- Air or Wire Synchronization
- Multi Direction People counter and Integrated backlit screen
- Remote Monitoring and System Management (Sensors acquisition, firmware upgrade)
- Multi purpose I/O Port with functional modes
- ISO15693 compliant, TAGSYS Legacy Chip compliant
- Support EAS and multiple AFI standard
- Internal Data Base Storage
- Asynchronous Event Notification (Automatic broadcast on network)
- Ethernet connectivity
- Software tools for integration
- Compliant with e-Connectware TAGSYS RFID middleware



Selection guide

	L-SP3	L-SP3 Clear	L-SP3 GPP
3D orientation detection	●	●	●
Multi-directional people counter	●	●	●
RFIDSP technology	●	●	●
e-Connectware compatibility	●	●	●
Opaque design	-	-	●
Semi-opaque design	●	-	●
Clear Design	-	●	●
Color choice	-	-	●
Aesthetic Personalization	-	-	●

TAGSYS reserves the right to change product specification at any time without prior notice

