

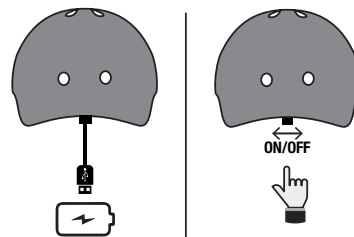

# BLUETOOTH SPEAKER HELMET MANUAL

## 🔌 INSTRUCTIONS FOR USE



1. To recharge helmet, plug USB cord from center back edge of helmet into a power source.
2. Press button on center back edge of helmet to turn on. Sound will play indicating helmet is **ON**.
3. Turn on Bluetooth® discovery mode on music device and connect to Krash! Speaker Helmet. Sound will play indicating helmet is **SYNCED**.
4. Press button on center back edge of helmet to turn helmet off. Sound will play indicating helmet is **OFF**.

## FCC INFORMATION

This equipment has been tested and found to comply with the limits for a Class B digital device, pursuant to Part 15 of the FCC Rules. These limits are designed to provide reasonable protection against harmful interference in a residential installation. This equipment generates, uses and can radiate radio frequency energy and, if not installed and used in accordance with the instructions, may cause harmful interference to radio communications. However, there is no guarantee that interference will not occur in a particular installation. If this equipment does cause harmful interference to radio or television reception, which can be determined by turning the equipment off and on, the user is encouraged to try to correct the interference by one or more of the following measures: • Reorient or relocate the receiving antenna. • Increase the separation between the equipment and receiver. • Connect the equipment into an outlet on a circuit different from that to which the receiver is connected. • Consult the dealer or an experienced radio/TV technician for help. Shielded interface cable must be used with the equipment in order to comply with the limits for a digital device pursuant to Subpart B of Part 15 of FCC Rules. Specifications and designs are subject to change without any notice or obligation on the part of the manufacturer.

a. This device complies with Part 15 of the FCC Rules. Operation is subject to the following two conditions: (1) this device may not cause harmful interference, and (2) this device must accept any interference received, including interference that may cause undesired operation

b. The device radiates radio frequency energy at a level below the United States FCC radio frequency exposure limits. Nevertheless, this device should be used in such a manner that the potential for human contact during normal operation is minimized. For body worn operation, this device has been tested and meets FCC RF exposure guidelines when used with accessory that contains no metal. Use of other accessories may not ensure compliance with FCC RF exposure guidelines.

THE GRANTEE IS NOT RESPONSIBLE FOR ANY CHANGES OR MODIFICATIONS NOT EXPRESSLY APPROVED BY THE PARTY RESPONSIBLE FOR COMPLIANCE. SUCH MODIFICATIONS COULD VOID THE USER'S AUTHORITY TO OPERATE THE EQUIPMENT.

82.55mm x 107.95mm

RQST DATE: R1\_06-05-18  
REV DATE: R3\_06-10-22  
FACTORY: MEI KAI

DESIGNER: G. NAVARRO  
DEVELOPER: R. KITO  
CATEGORY: PACKAGING

CHASSIS: N/A  
BRAND: KRASH  
NAME: BLUETOOTH SPEAKER HELMET MANUAL



C-PREME™