

Size:180x130mm



User Manual

Introduction

RC Dinosaur has the spin and go action plus the unique secondary action for each dinosaur. RC dinosaur has a unique, easy to use controller that lights up when activated, perfect for a preschooler.

Controller

- Unscrew the battery cover on the underside of the handset controller with a Philips screwdriver.
- Insert 2 –AAA batteries with polarities as shown inside battery compartment.
- Replace the battery cover and screw shut.

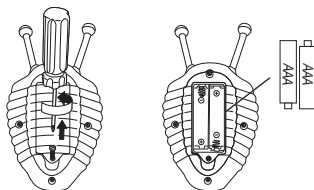

Dinosaur

- Unscrew the battery cover on the underside of the dinosaurs with a Philips screwdriver.
- Install 3 – AAA batteries with polarities as shown inside the battery compartment.
- Replace the battery cover and screw shut.

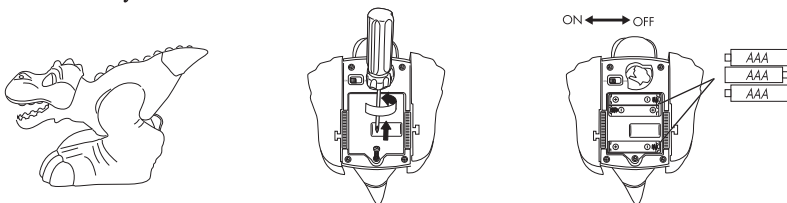

How to operate the dinosaur

- Turn the On/Off switch on the underside of the dinosaur to “ON” position.
- The dinosaur will spin automatically once it is “ON”.
- Press the orange button on the controller, the dinosaur will move forward & each dinosaur has it’s own secondary movement listed as following:
 - * T Rex – mouth opens & closes, legs move back & forth, tail moves left & right.
 - * Triceratops – head moves up & down, legs move back& forth, tail moves left & right.
 - * Brontosaurus – head moves up & down, legs move back & forth, tail moves left & right.

Operation tips and helpful hints

- If your dinosaur starts to lose power, it may experience loss of function and performance. If this happens simply replace batteries in the vehicles and handset.
- Your dinosaur is operated by radio waves. It is possible that the dinosaur may not perform properly due to interference with devices such as cordless phones, hair dryer, radio, walkie-talkie or other radio controlled toys.

Size:180x130mm

Safety Precautions

- Please read instructions thoroughly before operating this vehicle.
- Always select a safe place to play. Never drive your dinosaur on popular streets or in water areas.
- Keep finger, hair and loose clothing away from tires, wheel hubs and motors while the vehicle is switched on.
- Batteries must be inserted while the corrected polarities as shown in the battery compartment.
- Exhausted batteries should be removed from the vehicle and disposed of properly.
- Batteries should be replaced by an adult.
- Please keep the instructions for future reference.

FCC Notice:

This equipment has been tested and found to comply with the limits for a Class B digital device, pursuant to Part 15 of the FCC Rules. These limits are designed to provide reasonable protection against harmful interference in a residential installation. This equipment generates, uses and can radiate radio frequency energy and, if not installed and used in accordance with the instructions, may cause harmful interference to radio communications. However, there is no guarantee that interference will not occur in a particular installation. If this equipment does cause harmful interference to radio or television reception, which can be determined by turning the equipment off and on, the user is encouraged to try to correct the interference by one or more of the following measures:

- Do not mix different brands of batteries
- Do not mix old and new batteries.
- Do not mix alkaline, standard (carbon-zinc), or rechargeable (Nickel-cadmium) batteries.
- Reorient or relocate the receiving antenna.
- Increase the separation between the equipment and receiver.
- Connect the equipment into an outlet on a circuit different from that to which the receiver is needed.
- Consult the dealer or an experienced radio/TV technician for help.

NOTE: Changes or modifications to this unit not expressly approved by the party responsible for compliance could void the user’s authority to operate the equipment.

Toll Free Hot Line: 800-816-1135



Copyright © 2008 Kid Galaxy, Inc.

RC Dino Series

WARNING:
CHOKING HAZARD - Small parts
Not for children under 3 years.