

GO GO AUTO

OPERATING INSTRUCTIONS

Vehicle

- Unscrew battery box door with a phillips screwdriver.
- Remove battery box door from chassis.
- Install 3-AA batteries with correct polarities show inside battery compartment.
- Reattach battery box door.
- Turn switch ON to start the vehicle. ON/OFF switch is located on the bottom of the vehicle.

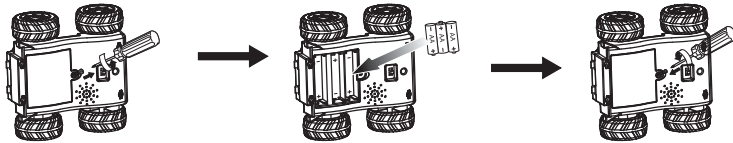

Remote Controller

- Unscrew battery door with a phillips screwdriver to open battery door.
- Install 1-9V battery with polarity as shown inside battery compartment.
- Check to see that vehicle is turned on.
- Press button for forward and turn.

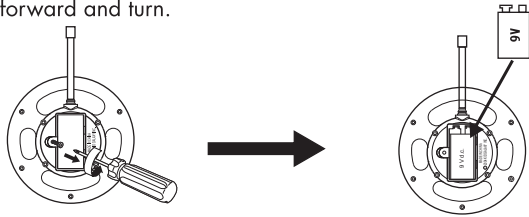

Function



The radio circuitry in your car and remote controller is sensitive. Radio Interference can affect the control of your car. You may have to choose another location to operate your car.

Toll Free Kid Galaxy Hot Line: 800-816-1135

Kid Galaxy®

Copyright ©2011 Kid Galaxy, Inc.

USER MANUAL

Warning: Changes or modifications to this unit not expressly approved by the party responsible for compliance could void the user authority to operate the equipment.

This device complies with part 15 of the FCC Rules. Operation is subject to the following two conditions: (1) this device may not cause harmful interference, and (2) this device must accept any interference received, including interference that may cause undesired operation.

NOTE: This equipment has been tested and found to comply with or limitations of a Class B digital device, pursuant to Part 15 of the FCC Rules. These limits are designed to provide reasonable protection against harmful interference in a residential installation. This equipment generates, uses and can radiate radio frequency energy and, if not installed and used in accordance with the instructions, may cause harmful interference to radio communications.

However, there is no guarantee that interference will not occur in a particular installation. If this equipment does cause harmful interference to radio or television reception, which can be determined by turning the equipment, off and on, the user is encouraged to try to correct the interference by one or more of the following measures:

- Reorient or relocate the receiving antenna.
- Increase the separation between the equipment and receiver.
- Connect the equipment into an outlet on a circuit different from that to which the receiver is needed.
- Consult the dealer or an experienced radio/TV technician for help.
- Do not mix old and new batteries.
- Do not mix alkaline, standard (carbon-zinc), or rechargeable (Nickel-cadmium) batteries.

Go Go Auto Series