

Download the iDevices Connected app.



Remove top unit from base, pull tab.



Press and release the power button.

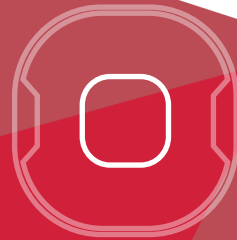

Unit will connect at app launch with Bluetooth® enabled.

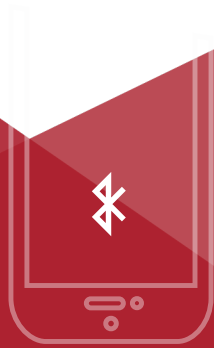

1

2

3

4



Welcome to  
**iGrill<sup>®</sup>mini**

Quickstart Guide



\$10 off \$50 or more with  
**CONNECTME**  
at [iDevicesinc.com](http://iDevicesinc.com)



**In The Box:**  
1 iGrillmini  
1 Meat Probe  
1 Probe Wrap  
1 Coin-cell Battery

**Learn More**

A full user guide is available in-app and online at [iDevicesinc.com](http://iDevicesinc.com).

**Join the Community**

Register your iGrillmini for exclusive news, special offers and community updates.

Warranty information: iDevices covers the iGrillmini with a 1-year Limited Warranty against manufacturing defects. For full details of this policy and its terms, please visit [iDevicesinc.com](http://iDevicesinc.com).

**Need more help?** [support@idevicesinc.com](mailto:support@idevicesinc.com)

CAUTION: Colored probe indicator not intended to be used as heat safety grip.

Warning: Probe NOT dishwasher safe.

**1**  
**Smart LED**  
Indicates when paired, temperature progression and temperature out of range

**2**  
**Probe Insert**  
Single probe insert for meat probe or ambient temperature probe

**3**  
**Magnetized Mounting**  
The magnet allows for convenient mounting on your grill or smoker

**4**  
**2 Viewing Angles**  
Place anywhere on your grill or smoker with dual positioning

**5**  
**Battery**  
Replaceable coin-cell battery CR2032

**6**  
**Battery Cover**  
Twist to remove

**7**  
**Probe Wrap**  
Magnetized for convenient mounting on the back of your iGrillmini

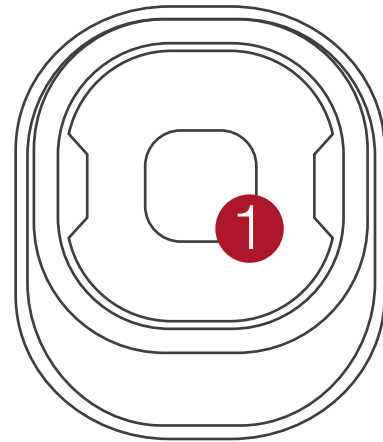

**Connection**



Flashing: Ready to pair  
Solid for 5 secs: Paired

**Peak Preset**



**Range Preset**

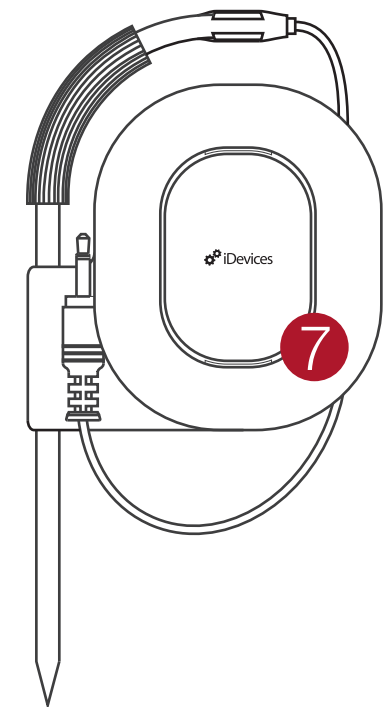
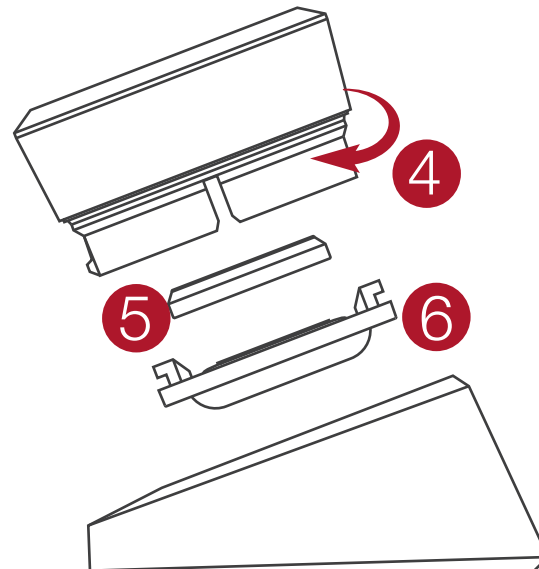
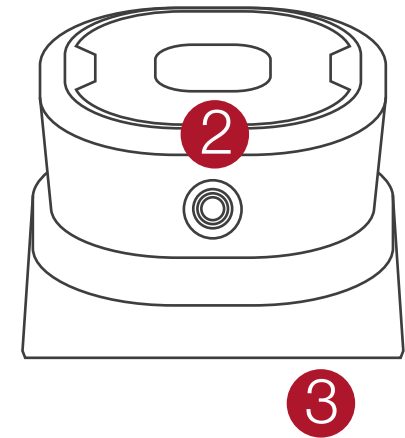
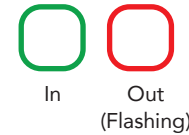

Download the iDevices Connected app.

Remove top unit from base, insert batteries.

Press and hold power for one second.

Unit will connect at app launch with Bluetooth® enabled.



2



3



4

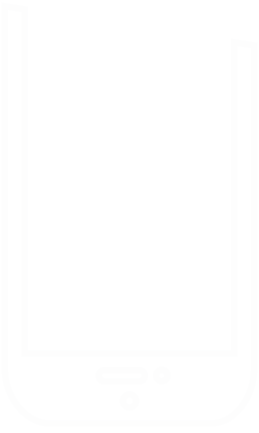

Welcome to Kitchen Thermometer

Quickstart Guide



\$10 off \$50 or more with CONNECTME at iDevicesinc.com

- In The Box:**
- 1 Kitchen Thermometer
  - 2 Meat Probes
  - 2 Probe Wraps
  - 2 AA Batteries

**Learn More**

A full user guide is available in-app and online at iDevicesinc.com.

**Join the Community**

Register your Kitchen Thermometer for exclusive news, special offers and community updates.

Warranty information: iDevices covers the Kitchen Thermometer with a 1-year Limited Warranty against manufacturing defects. For full details of this policy and its terms, please visit iDevicesinc.com.

**Need more help? support@idevicesinc.com**

CAUTION: Colored probe indicator not intended to be used as heat safety grip.

Warning: Probe NOT dishwasher safe.

1

### Smart Display

The display will illuminate once your smartphone/tablet is within range

2

### Probe Inserts

The device has two probe inserts so that you can monitor two temperatures at once

3

### Magnetized Mounting

The magnet allows for convenient mounting in your kitchen

4

### 2 Viewing Angles

Place anywhere in your kitchen with dual positioning

5

### Battery

Requires 2 AA batteries (included)

6

### Battery Cover

Remove to insert batteries

7

### Colored Probe Indicator

Easily identify each probe reading within the app

8

### Probe Wrap

Magnetized for convenient mounting on the back of your Kitchen Thermometer

