

Tx2 antenna: 5350 MHz

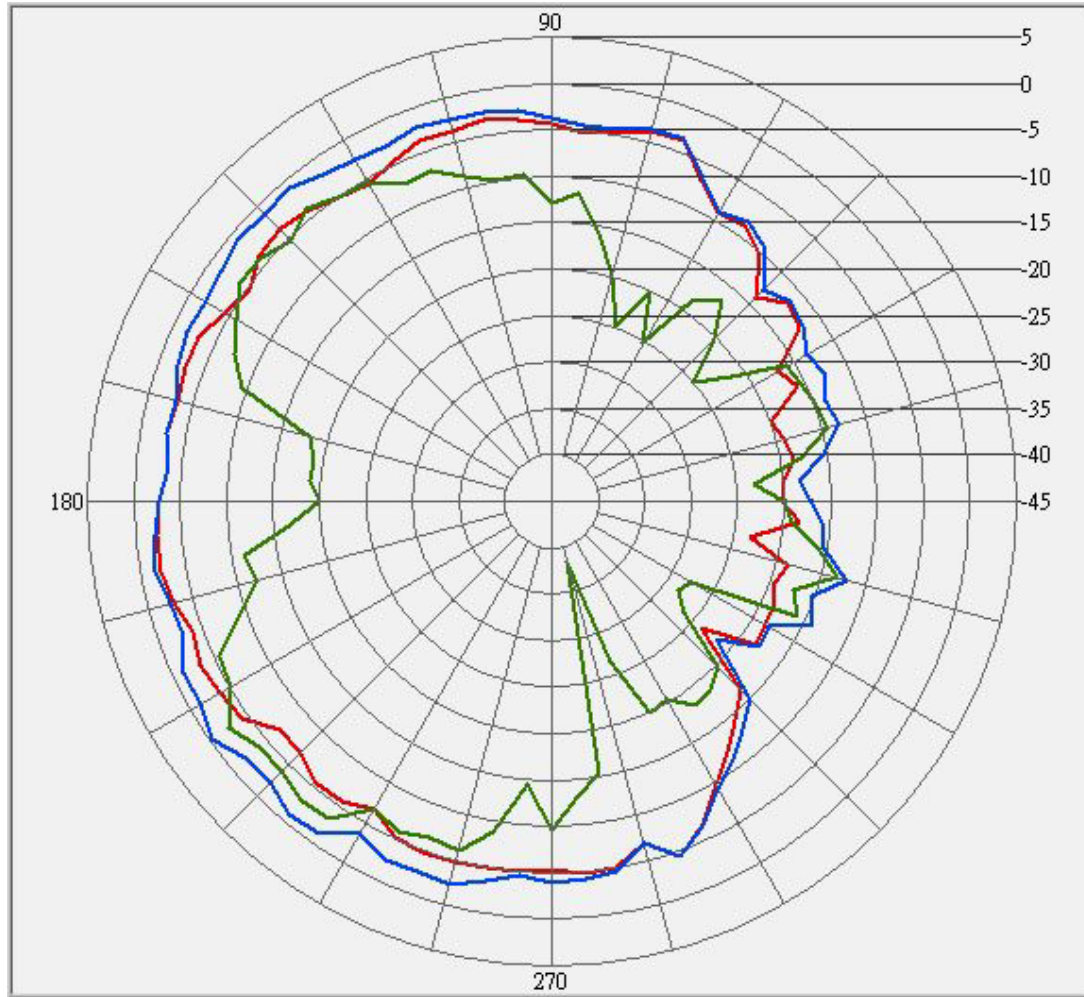

Center Frequency	5350 MHz
Horizontal (dBi) peak	-2.25
Vertical (dBi) peak	-2.62

Tx3 (or Rx3) antenna: 5150 MHz (Plot is not required if 3rd Antenna is receive only)

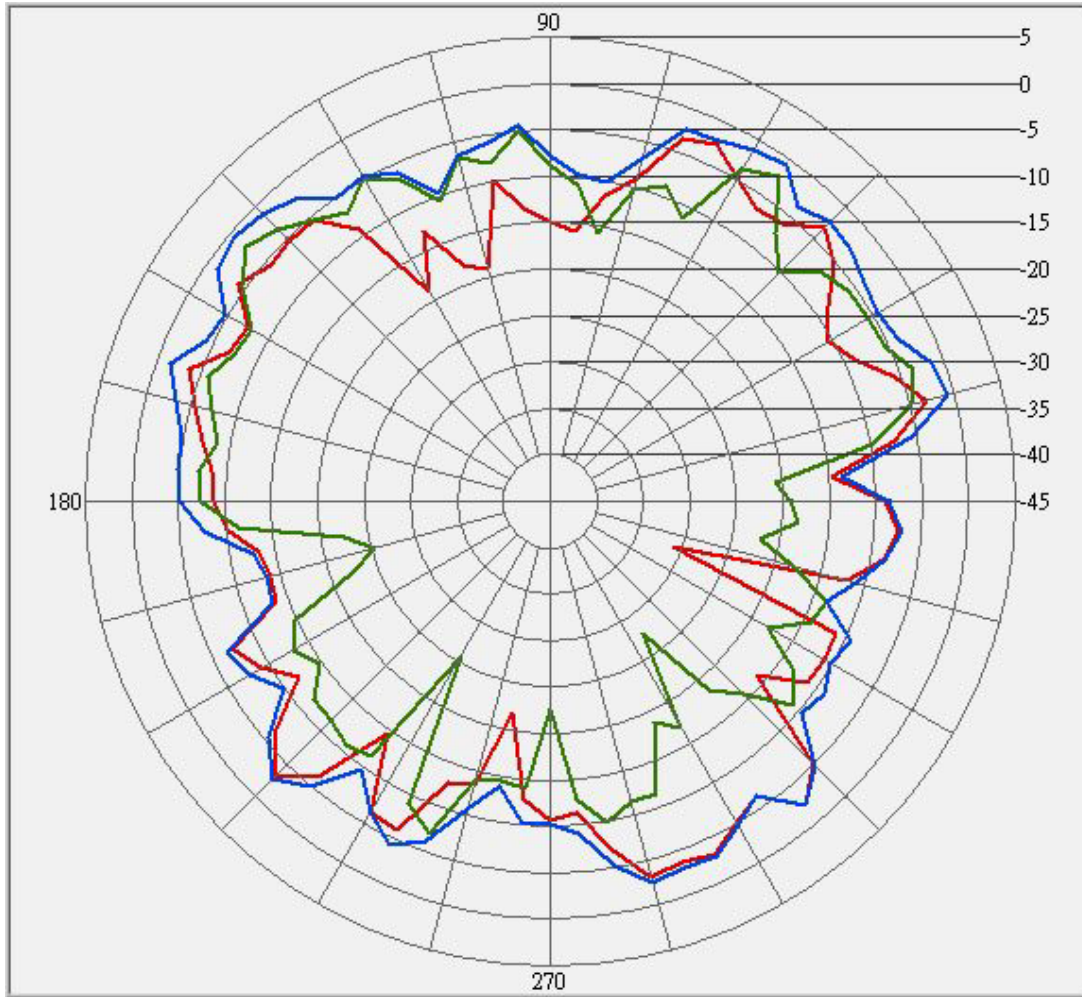

Center Frequency	5150 MHz
Horizontal (dBi) peak	-2.28
Vertical (dBi) peak	-2.28

Tx3 (or Rx3) antenna: 5350 MHz (Plot is not required if 3rd Antenna is receive only)

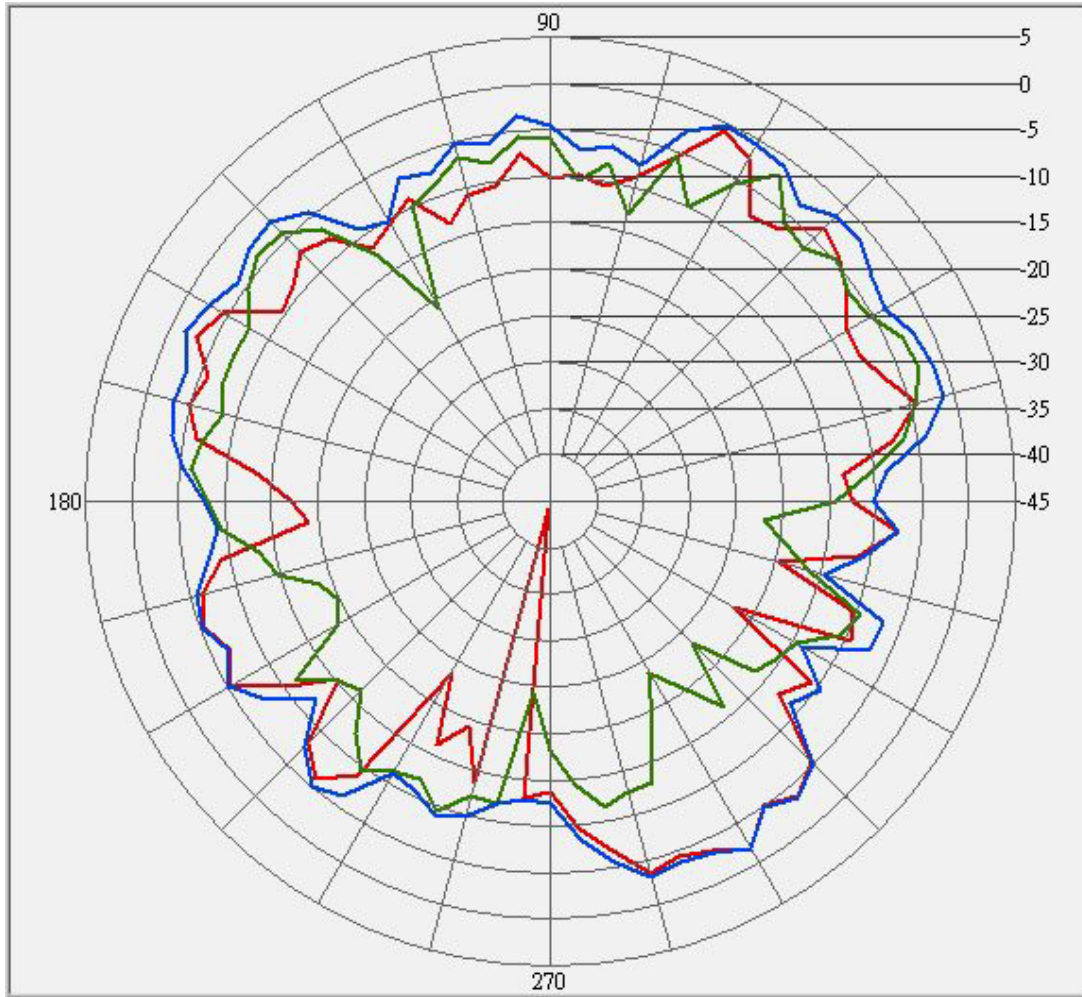

Center Frequency	5350 MHz
Horizontal (dBi) peak	-0.96
Vertical (dBi) peak	-2.07

5470-5875MHz radiation characteristic

Tx1 antenna: 5470 MHz

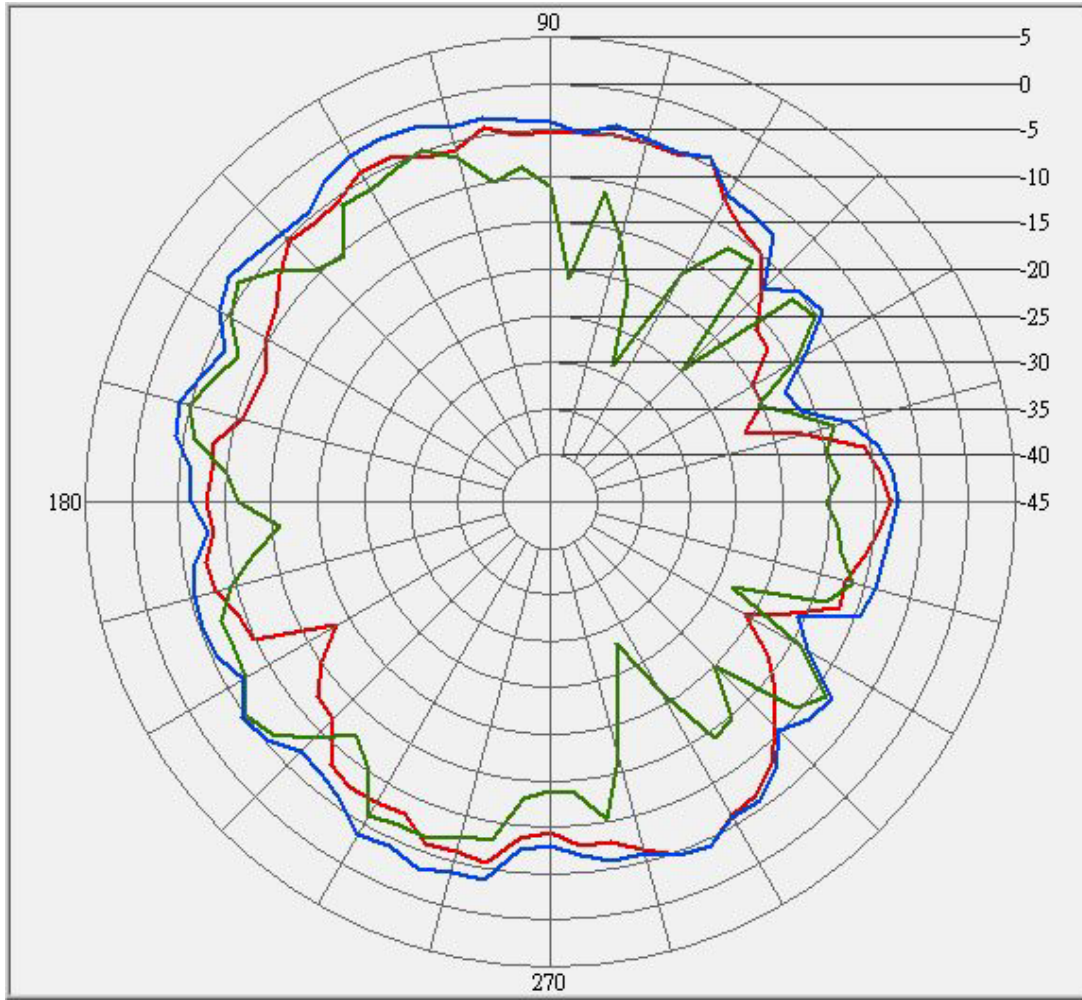

Center Frequency	5470 MHz
Horizontal (dBi) peak	-4.06
Vertical (dBi) peak	-4.04

Tx1 antenna: 5725 MHz

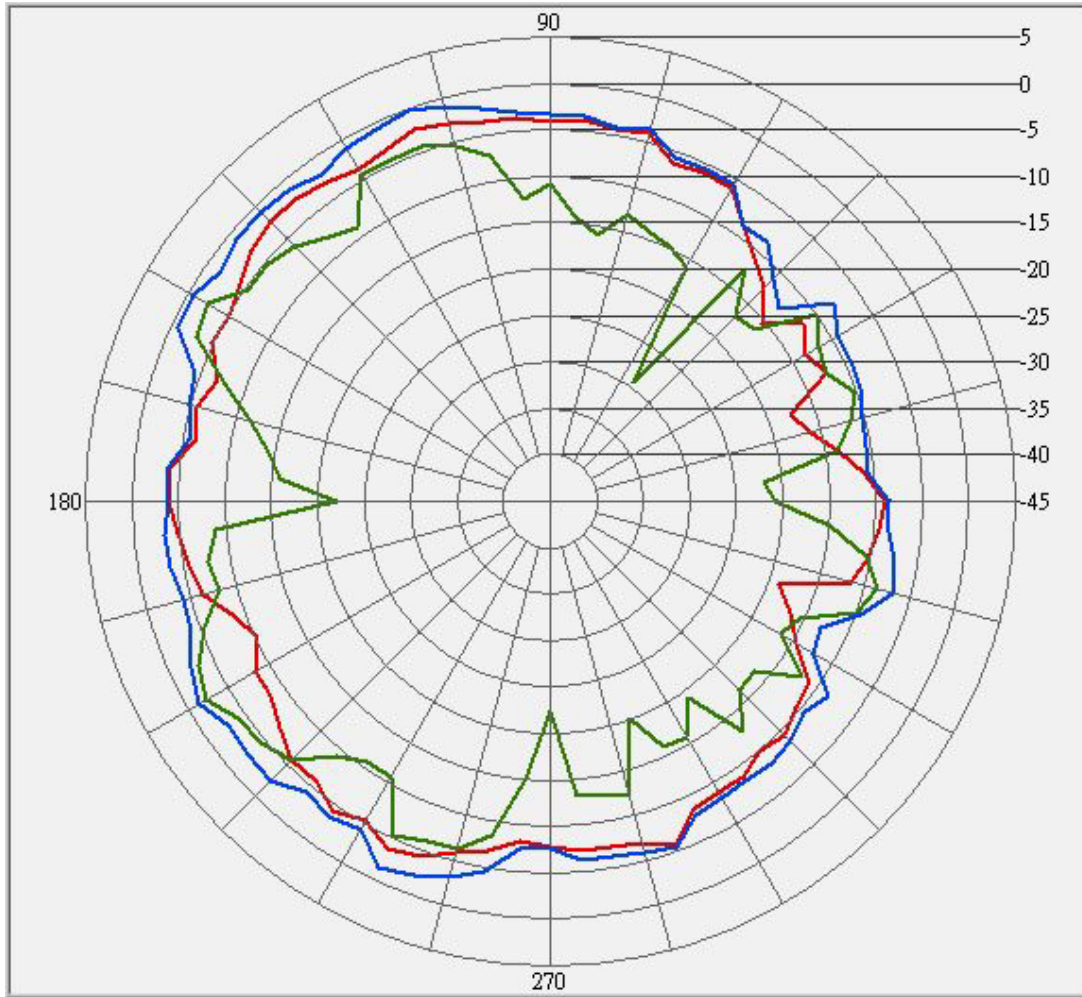

Center Frequency	5725 MHz
Horizontal (dBi) peak	-2.44
Vertical (dBi) peak	-2.30

Tx1 antenna: 5875 MHz

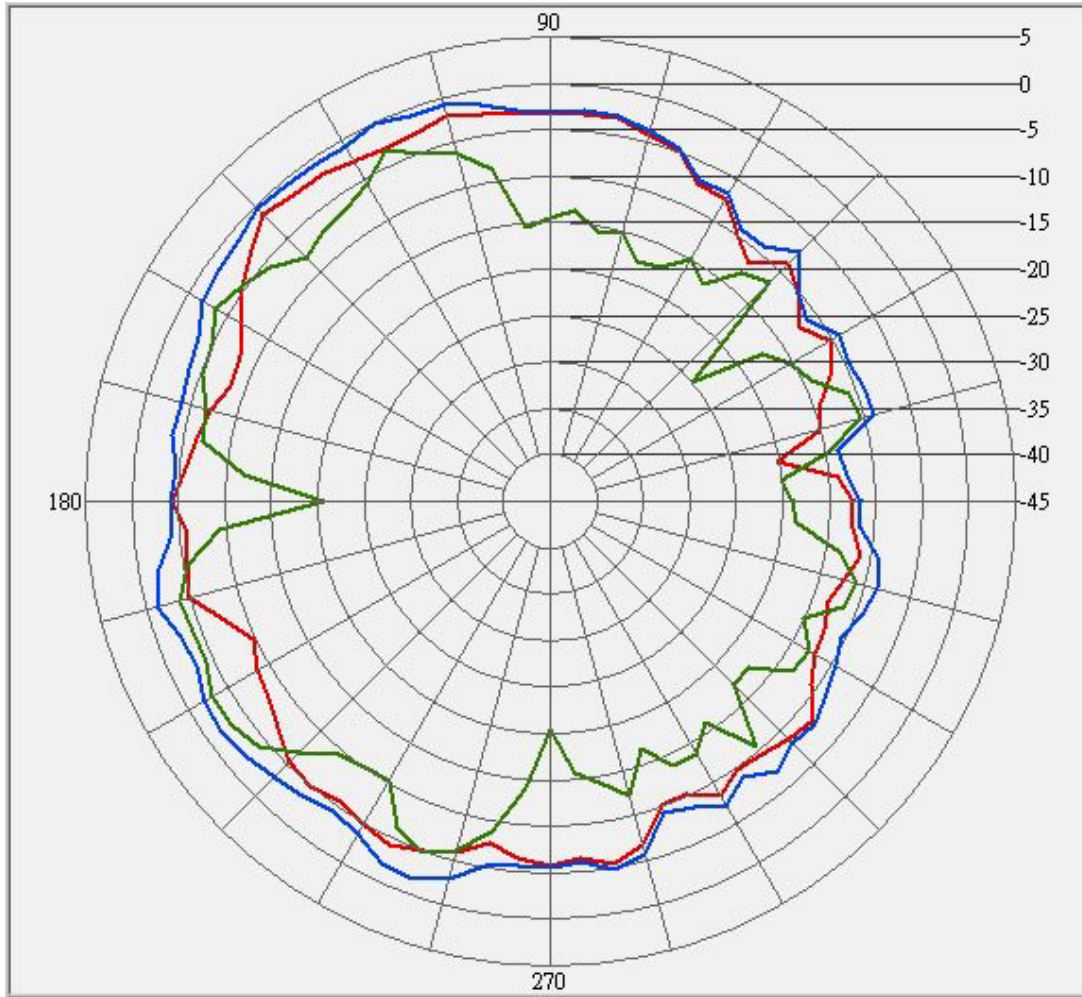

Center Frequency	5875 MHz
Horizontal (dBi) peak	-1.43
Vertical (dBi) peak	-2.99

Tx2 antenna: 5470 MHz

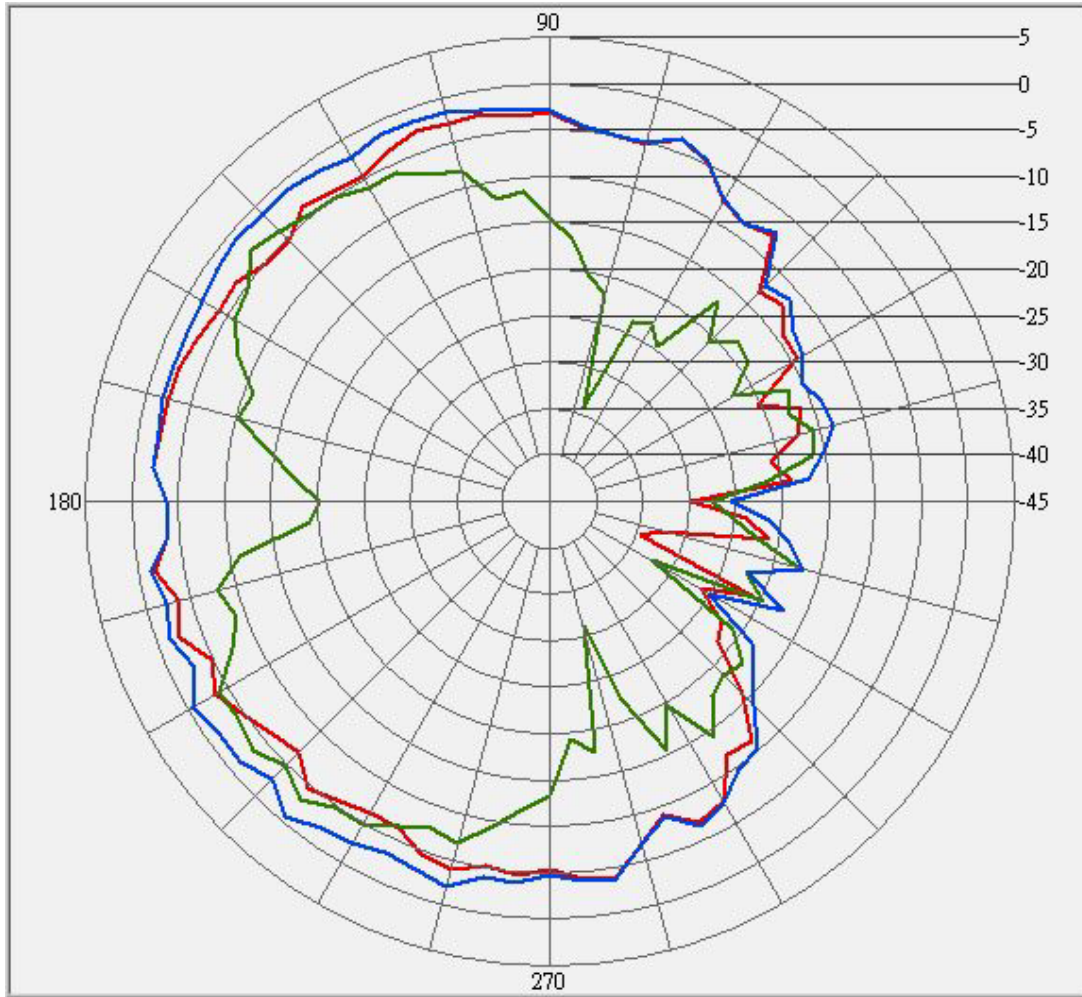

Center Frequency	5470 MHz
Horizontal (dBi) peak	-1.95
Vertical (dBi) peak	-3

Tx2 antenna: 5725 MHz

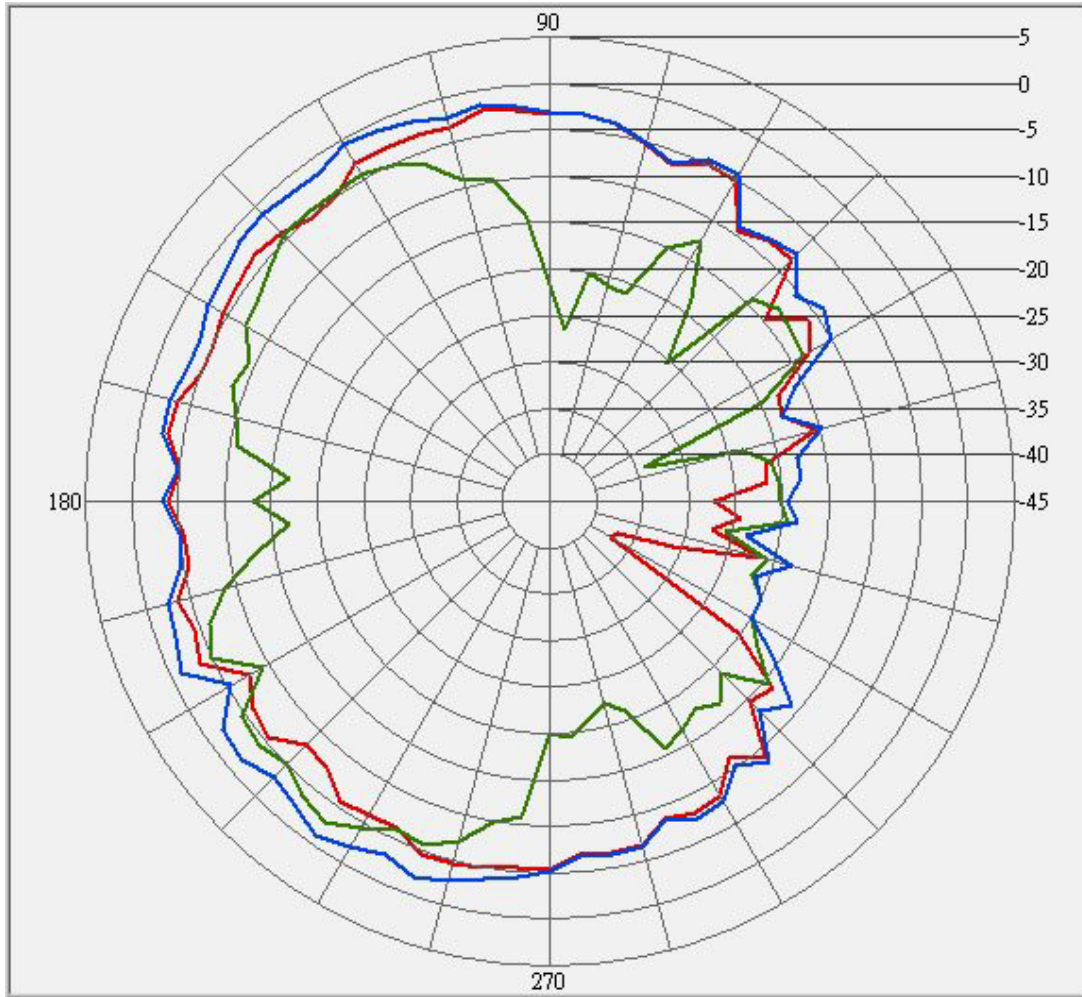

Center Frequency	5725 MHz
Horizontal (dBi) peak	-2.32
Vertical (dBi) peak	-2.9

Tx2 antenna: 5875 MHz

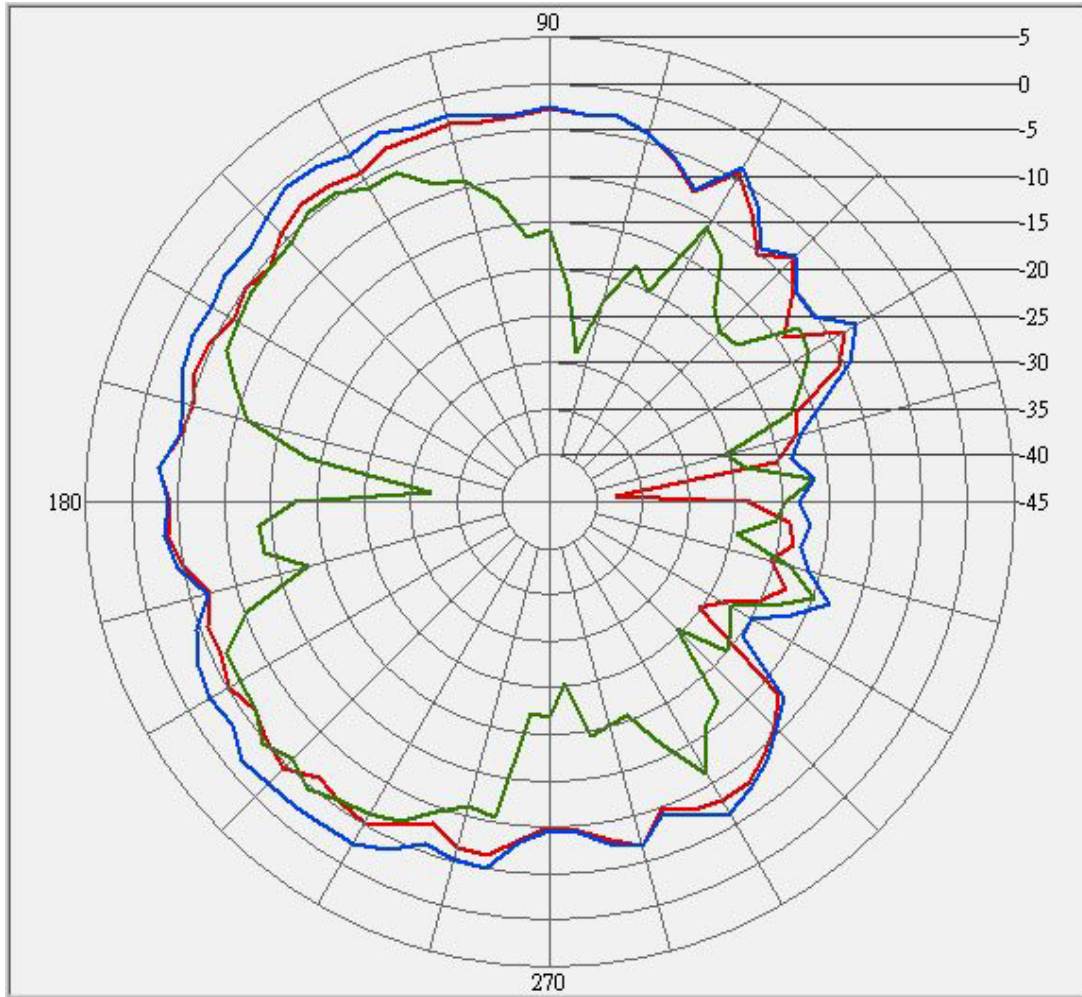

Center Frequency	5875 MHz
Horizontal (dBi) peak	-2.69
Vertical (dBi) peak	-4.44

Tx3 (or Rx3): 5470 MHz (Plot is not required if 3rd Antenna is receive only)

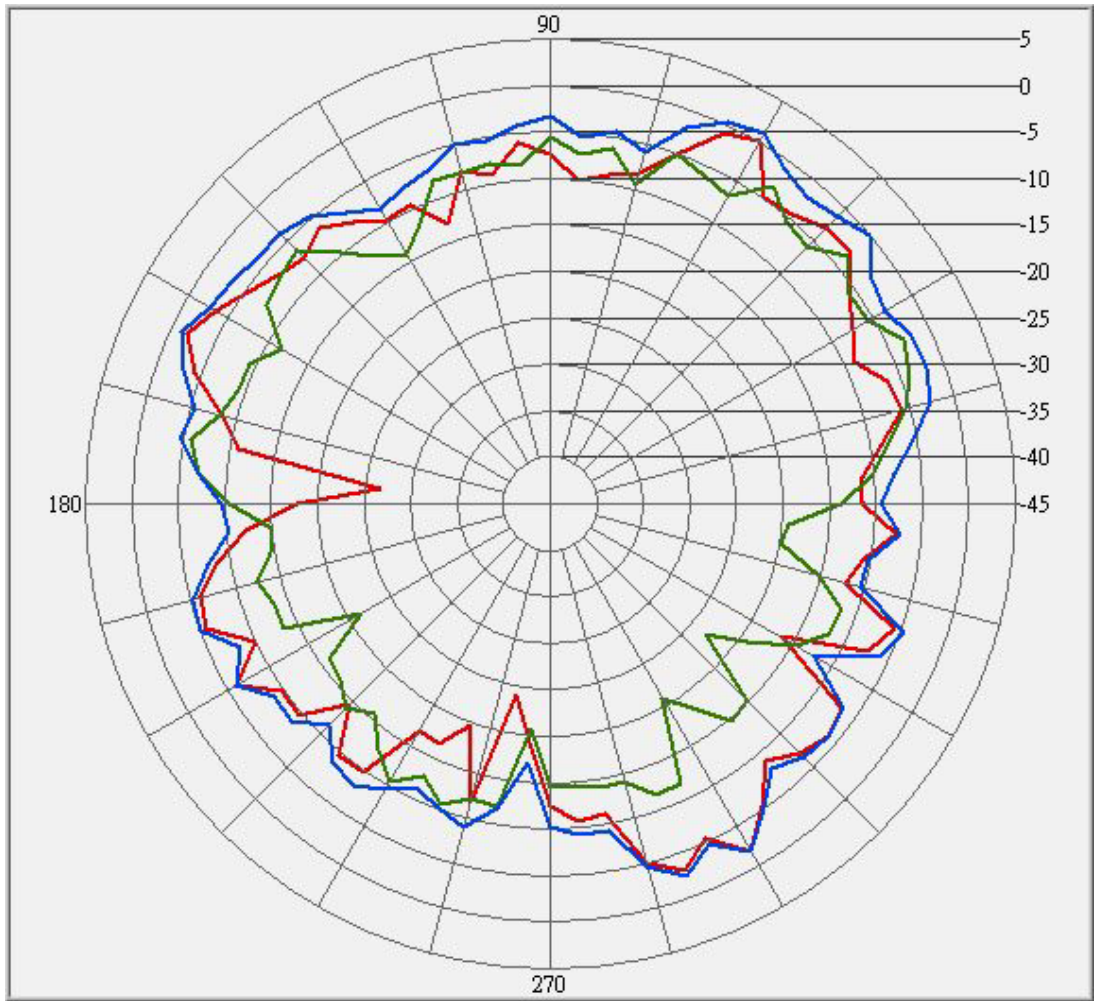

Center Frequency	5470 MHz
Horizontal (dBi) peak	0.09
Vertical (dBi) peak	-3.15

Tx3 (or Rx3) antenna: 5725 MHz (Plot is not required if 3rd Antenna is receive only)

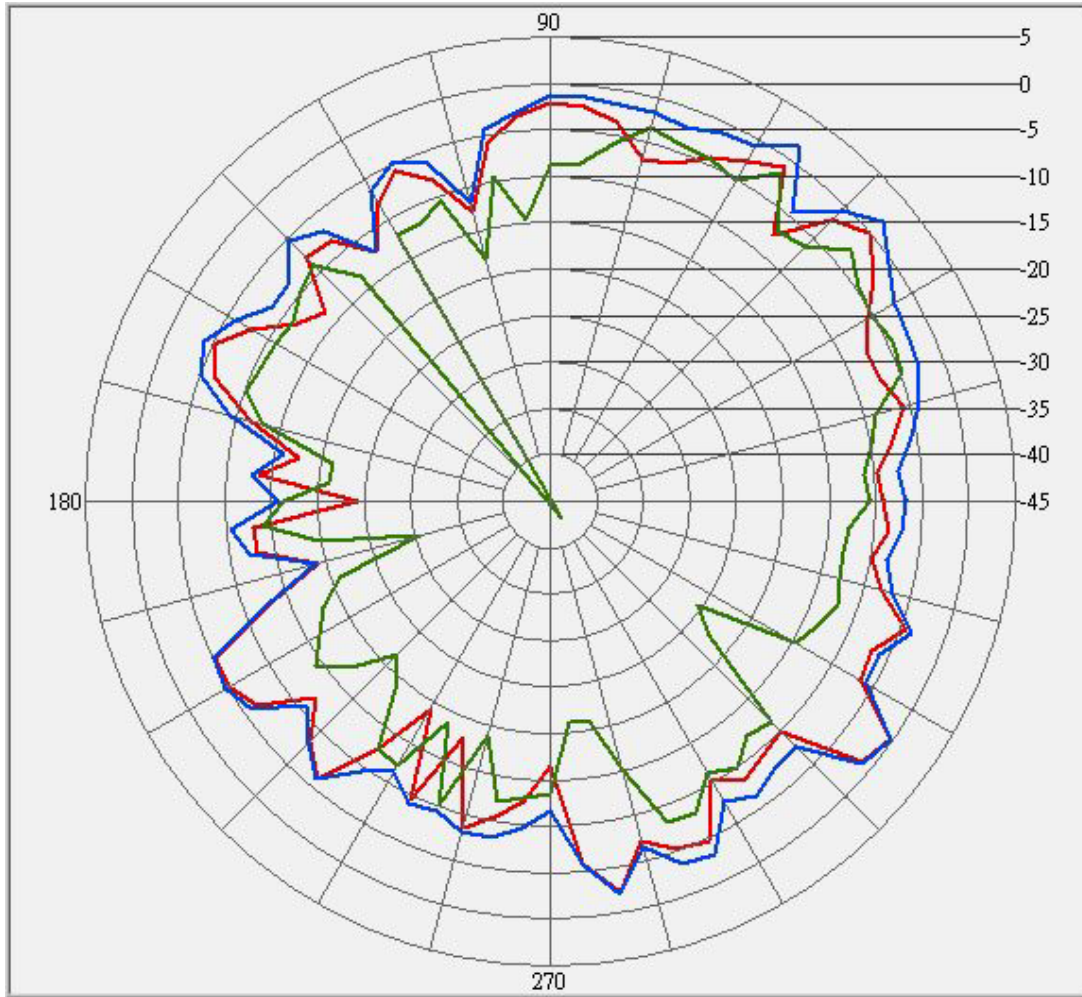

Center Frequency	5725 MHz
Horizontal (dBi) peak	-0.23
Vertical (dBi) peak	-1.71

Tx3 (or Rx3) antenna: 5875 MHz (Plot is not required if 3rd Antenna is receive only)

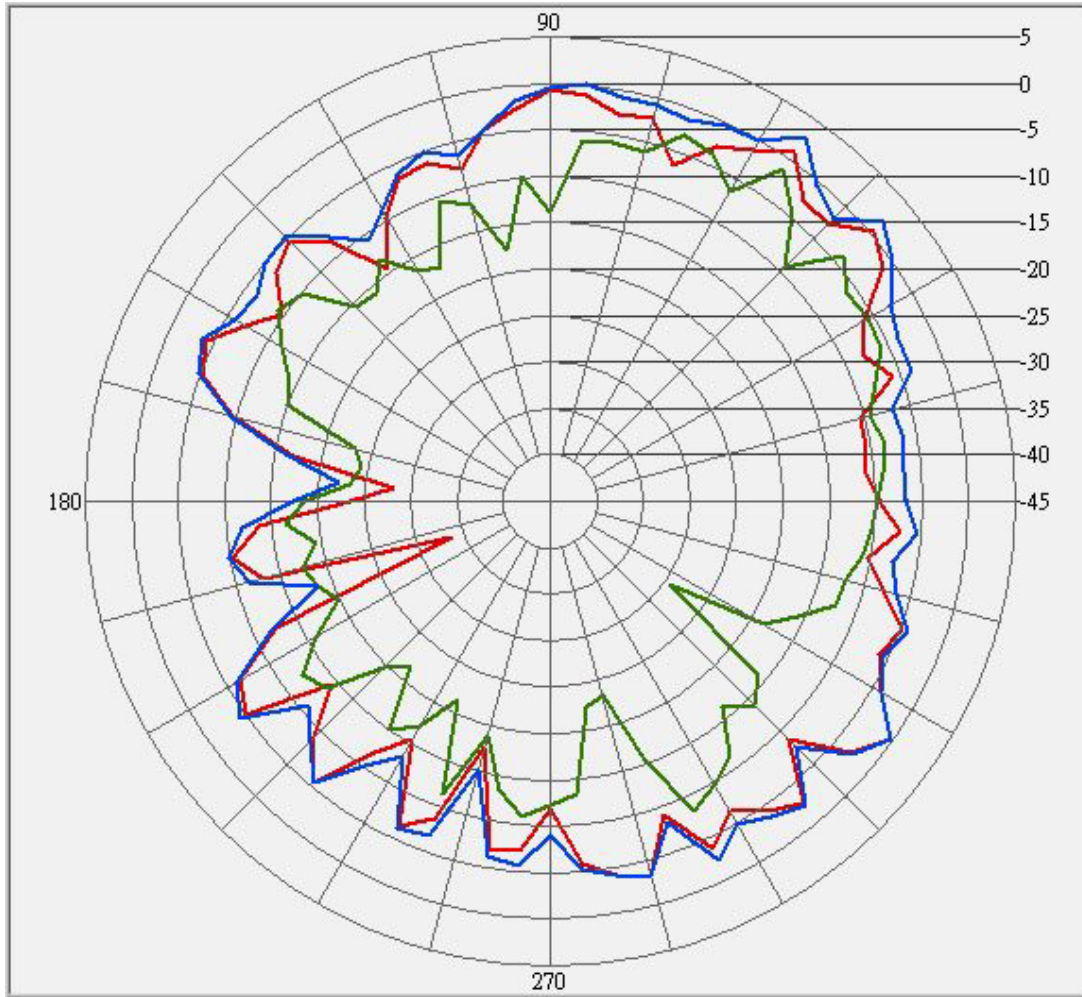

Center Frequency	5875 MHz
Horizontal (dBi) peak	0.88
Vertical (dBi) peak	-1.35

Section 4. Host Platform Information

OEM / ODM Host platform: Dell Pacino

Rating Label Photo:

Section 5. Antenna Host Platform Location Information

Include a **dimensioned photo or dimensioned drawing** of Tx1, Tx2 and Tx3 antenna placements. (Not applicable for receive-only antenna)

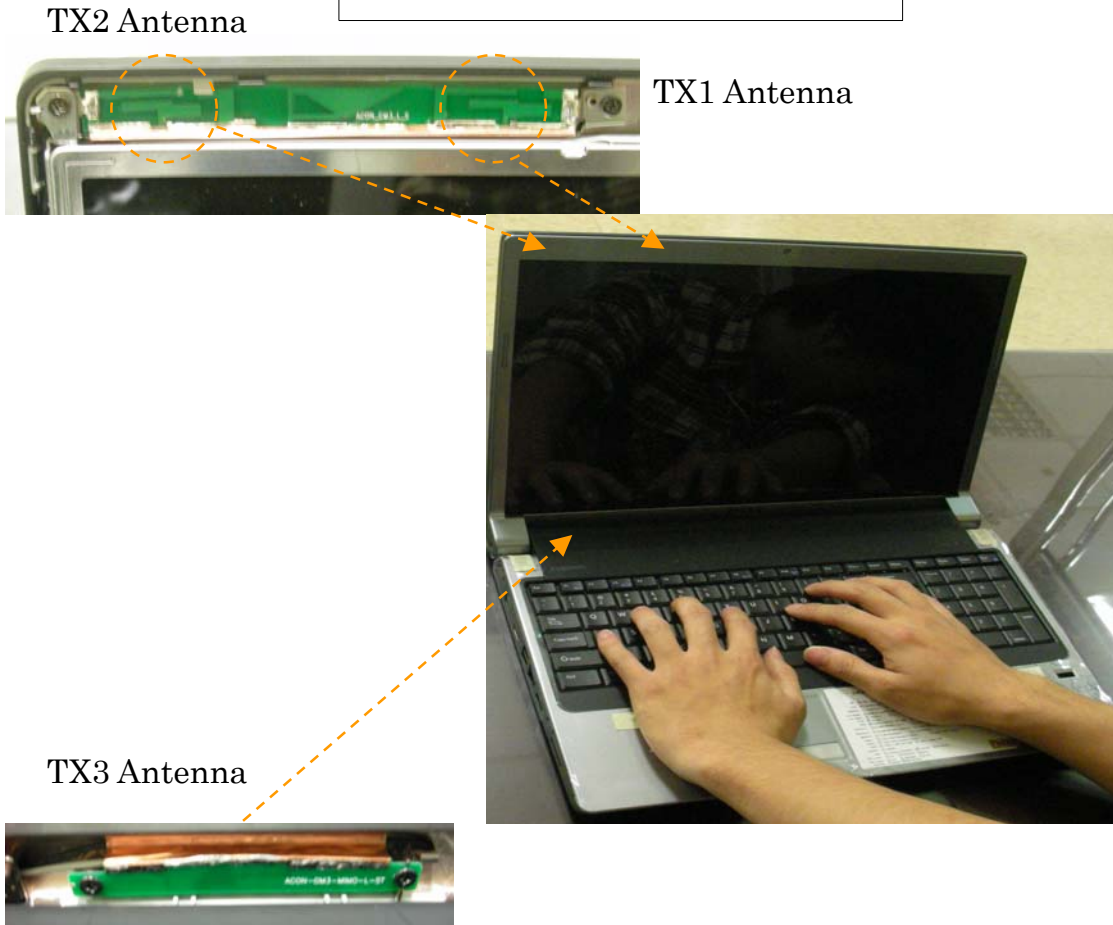
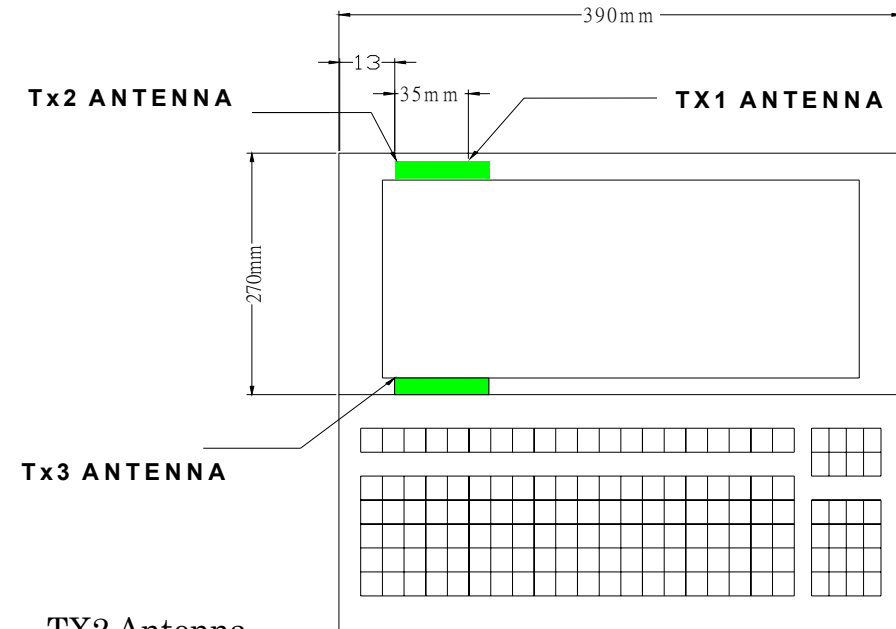

Section 6. Antenna dimensional information for SAR evaluation

Include a **dimensioned photo or dimensioned drawing** showing the distance (mm) between the transmit antennas and the user (excluding hands, wrist, feet, lap/ thigh, and ankle)

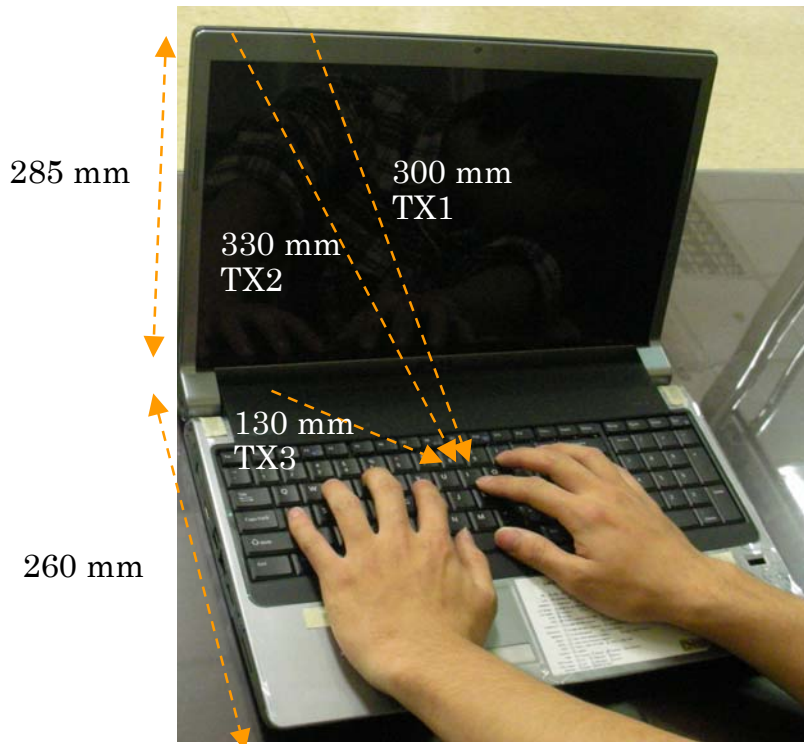
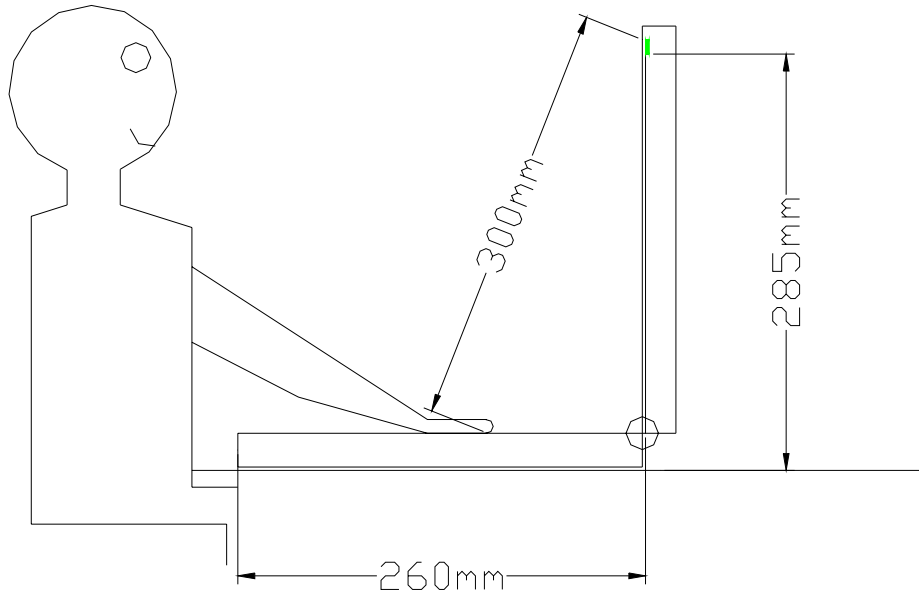

Section 7. Diagram Example of Co-Location Antenna Separation

Include a **dimensioned photo or dimensioned drawing** showing the distance (mm) between **all WLAN transmit antennas** and other co-located radiator transmit antenna such as Bluetooth, WWAN,..

(Note: Due to the evolving rules regarding co-location, each platform will need to be reviewed on a case by case basis)

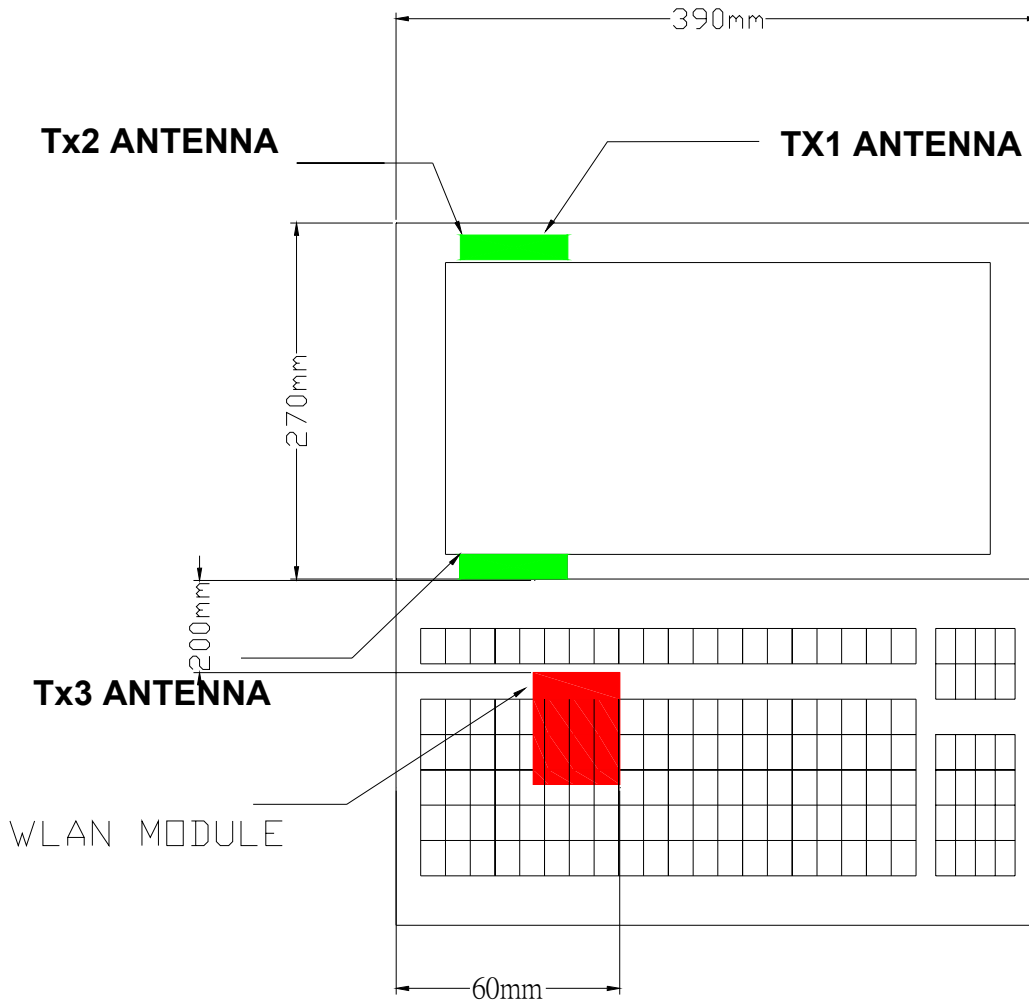

Section 8. Local representative contact information

Local representative contact information is required for regulatory support for target countries below.

	Local company name	Contact name	Phone number	FAX Number	e-Mail Address	Notes
Argentina						
Brazil						
Indonesia						
Israel						
Malaysia						
Mexico						
Singapore						Telecommunication Equipment Dealer License Required
South Africa						
USA, Canada						