



50-00901-00 rev04 - LABEL, COMPLIANCE, PRINT-ON-DEMAND,
RDL-3000

FONT: ARIAL NARROW, FONT SIZE: 8 BOLD

redline [®] communications	 C US 233633	 OMAN-TRA R/0062/11 D080214
FCC ID: QC8-RDL3000A		
IC: 4310A-RDL3000		

2.5 inch

0.75 inch

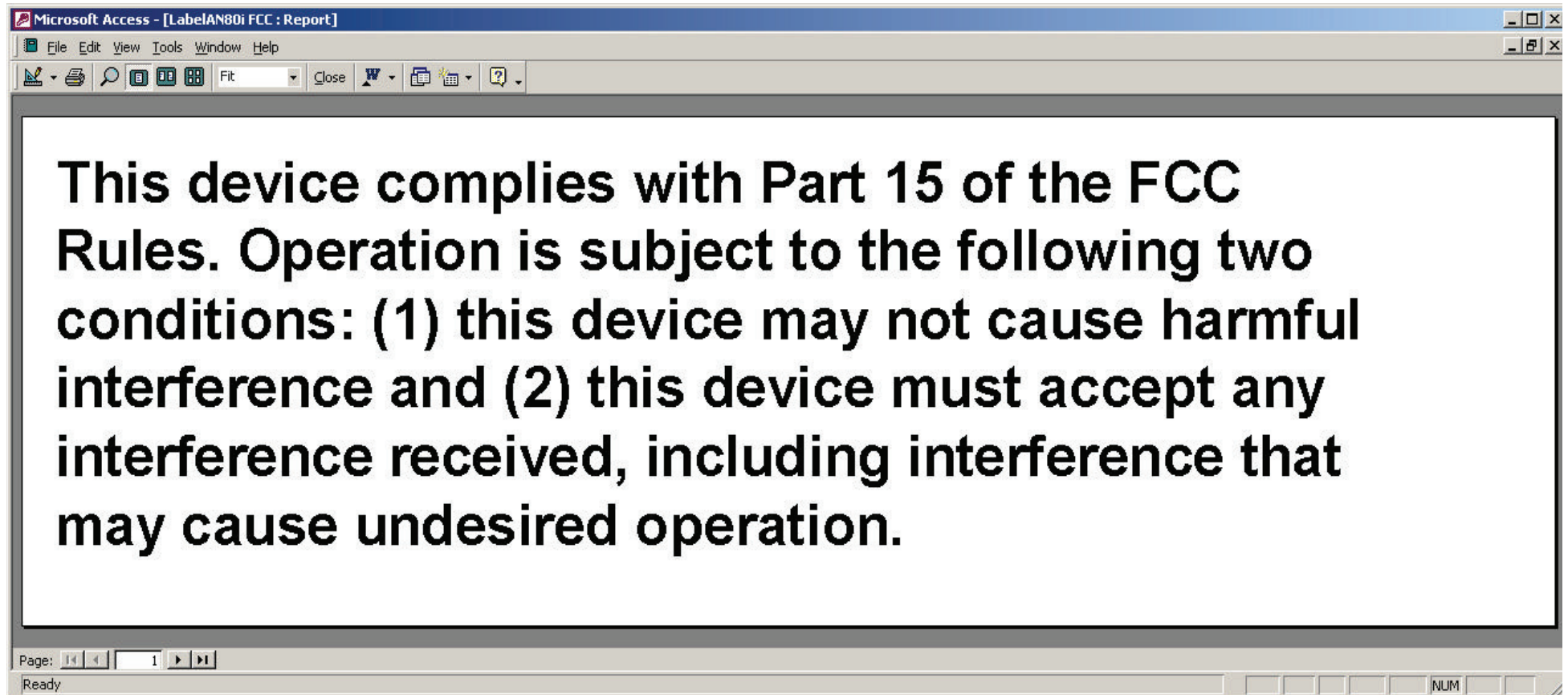

REV	02	CONT NO	80-00302-00	MATERIALS TO BE USED IN THIS DRAWING ARE THE PROPERTY OF REDLINE COMMUNICATIONS INCORPORATED. IT IS ISSUED AS SPECIFIC CONFIDENCE, AND SHALL NOT BE REPRODUCED OR COPIED OR USED AS THE BASIS FOR THE MANUFACTURE OF ANY APPARATUS WITHOUT PRIOR WRITTEN PERMISSION.
REV	01	DESCRIPTION	DATE	
02	REVISED P/N OF ITEM 9	1/11/10		
01	REVISED P/N OF ITEM 23 (INCREASED TORQUE VALUE, ITEM 33)	06/27/10		

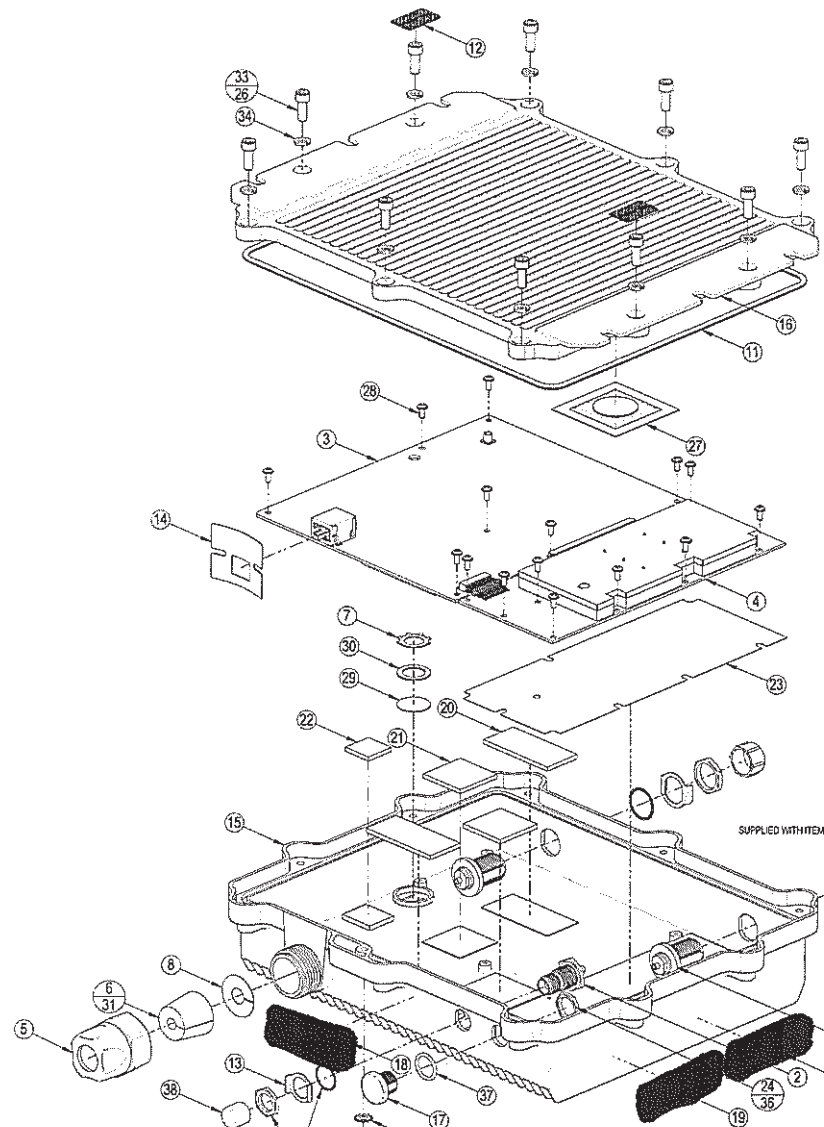

02	REVISED P/N OF ITEM 9	1/11/10
01	REVISED P/N OF ITEM 23 (INCREASED TORQUE VALUE, ITEM 33)	06/27/10
REV	DESCRIPTION	DATE

PARTS LIST				
ITEM	QTY.	PART NO.	DESCRIPTION	NOTES
1	2	30-00313-00	CABLE ASSY, N-TYPE TO MCK, FORMED	CABLE NOT SHOWN
2	1	30-00318-00	CABLE ASSY, GPS JUMPER, TNC TO MCK, 9.50"	CABLE NOT SHOWN
3	1	32-00068-00	ASSY, PCA, DIGITAL, MIMO, RDL-3000	SEE NOTES 9 & 12
4	1	32-00069-00	ASSY, PCA, RF, MIMO, RDL-3000	SEE NOTES 10 & 12
5	1	50-06426-01	CABLE GLAND, NUT, MOLDED, AN-80	THREAD FULLY BY HAND
6	1	50-06427-02	CABLE GLAND, SEAL, MOLDED, AN-60	SEE NOTE 11
7	1	50-06453-00	RETAINING WASHER, .750" OD, X .016" THK., SSSL	SEE NOTE 4
8	1	50-05223-00	WASHER, SLIT, AN-60	
9	1	50-05225-03	LABEL, FCC STATEMENT	
10	2	50-00561-00	WASHER, TAB LOCK, N-TYPE	SEE NOTE 5
11	1	50-00548-01	GASKET, MOLDED, HOUSING, DIE CAST, RF-7800W-QU440	
12	2	50-00720-00	LABEL, TAMPER SEAL, RF-7800W-QU440	SEE NOTE 1
13	1	50-00838-00	WASHER, TAB LOCK, TNC	SEE NOTE 6
14	1	50-00890-00	SHIELD, RJ45 CONNECTOR, RDL-3000	
15	1	50-00882-01	HOUSING, RDL-3000, DIE CAST	
16	1	50-00883-01	COVER, RDL-3000, DIE CAST	
17	1	50-00833-00	HOLE PLUG, THREADED, 1/2-28 UNEF, NYLON	SEE NOTE 8
18	1	50-00900-00	LABEL, PRODUCT ID, RDL-3000	
19	1	50-00901-00	LABEL, COMPLIANCE, RDL-3000	
20	2	50-00902-00	PAD, THERMAL, 2.000" X .938"	
21	2	50-00903-00	PAD, THERMAL, 1.156" X 1.156"	
22	1	50-00904-00	PAD, THERMAL, .718" X .718"	
23	1	50-00520-00	INSULATOR, HOUSING, RDL-3000, 200 GAUGE	
24	1	60-00559-01	JAM NUT, 1/2-28 UNEF	TORQUE 15 in-lb.
25	1	60-00892-00	LOCKWASHER, #10, EXTERNAL TOOTH, SSSL	
26	AS REQD.	60-00163-00	ADHESIVE, LOCTITE 222MS ASSURE THREADLOCKER	SEE NOTE 7
27	1	50-00311-00	HUMIDISORB PACKET, 2" X 2"	SEE NOTE 2
28	15	60-00224-00	SCREW, 4-40 X 1/4, PPHMS, INTERNAL SENS, SSSL	TORQUE 6 in-lb.
29	1	60-00248-00	MEMBRANE, ADHESIVE PRESSURE VENT, WHITE, OPE	SEE NOTES 3 & 4
30	1	60-00249-00	WASHER, FLAT, .750" OD, X .515" ID, X .031" THK., NEOPRENE	SEE NOTE 4
31	AS REQD.	60-00312-00	SILICONE GREASE	SEE NOTE 11
32	1	60-00310-00	SCREW, 10-32 X 5/8, PPHMS, SSSL	THREAD FULLY BY HAND
33	10	60-00347-00	SCREW, 10-32 X 1/2, SHCS, SSSL, BLACK OXIDE	TORQUE 25 in-lb.
34	10	60-00348-00	LOCKWASHER, #10 SPLIT, REGULAR, SSSL, BLACK OXIDE	
35	2	60-00356-00	CAP, PROTECTIVE, THREADED, 5/8-24, RED	THREAD FULLY BY HAND
36	AS REQD.	60-00411-00	ADHESIVE, LOCTITE, ALL PLASTIC	SEE NOTE 8
37	1	60-00436-00	O-RING, SIZE 014, BUNA-N, 70 DURO, SHORE A	
38	1	60-00440-00	CAP, VINYL ROUND, .375" ID, X .500" L, BLACK	

- NOTES: UNLESS SPECIFIED OTHERWISE
- INSTALL ITEM 12 (2 PLACES) BY REMOVING BACKING OF PSA AND ADHERE ON TOP OF ITEM 33. THE SCREW HEAD MUST BE COVERED AS SHOWN.
 - INSTALL ITEM 27 BY REMOVING BACKING OF PSA AND PRESS FIRMLY ONTO THE CENTRAL POSITION OF ITEM 15.
 - INSTALL ITEM 29 BY REMOVING BACKING OF PSA AND ADHERE INTO HOUSING CAVITY AS PER W.L. GORE INSTRUCTIONS FOR INSTALLING ADHESIVE VENTS.
 - INSTALL ITEM 30 AND PRESS ITEM 7 UNTIL IT HAS BOTTOMED OUT ONTO ITEM 30. CARE MUST BE GIVEN NOT TO DAMAGE ITEM 29 DURING INSTALLATION.
 - INSERT LOCKWASHER, ITEM 10 AND NUT. FASTEN NUT TO A TORQUE VALUE OF 25 IN-LB. AFTER NUT IS TORQUED, SEE THAT THE FLATS ARE ALIGNED VERTICALLY. IF NOT, TURN THE NUT COUNTERWISE, UP TO 30° MAX, UNTIL THE FLATS ARE VERTICAL. FOLD THE TABS OF ITEM 10 AS SHOWN IN DETAIL A. CARE MUST BE GIVEN NOT TO DAMAGE THE SURFACE FINISH OF ITEM 15.
 - INSERT LOCKWASHER, ITEM 13 AND NUT. FASTEN NUT TO A TORQUE VALUE OF 20 IN-LB. AFTER NUT IS TORQUED, SEE THAT THE FLATS ARE ALIGNED VERTICALLY. IF NOT, TURN THE NUT COUNTERWISE, UP TO 30° MAX, UNTIL THE FLATS ARE VERTICAL. FOLD THE TABS OF ITEM 13 AS SHOWN IN DETAIL A. CARE MUST BE GIVEN NOT TO DAMAGE THE SURFACE FINISH OF ITEM 15.
 - APPLY ONE DROP OF ITEM 26 ONTO THREADS OF ITEM 33 PRIOR TO ASSEMBLY.
 - PRETREAT THREADS OF ITEM 17 WITH THREADLOCKER ACTIVATOR (INCLUDED WITH ITEM 36). APPLY 2 DROPS OF ITEM 36 TO THE BASE THREADS OF ITEM 17 AND TIGHTEN ITEM 24 TO THE SPECIFIED TORQUE.
 - NO SOLDER WICKING ALLOWED ON THE BOTTOM SURFACE OF ITEM 3. ALL MASKS MUST BE REMOVED FROM THE PCA.
 - NO SOLDER WICKING ALLOWED ON THE BOTTOM SURFACE OF ITEM 4. ALL MASKS MUST BE REMOVED FROM THE PCA.
 - APPLY A THIN FILM OF ITEM 31 TO ALL SURFACES OF ITEM 6.
 - PRE ASSEMBLE ITEMS 3 AND 4 BY CONNECTING THE TWO PCAs TOGETHER. PLACE THIS PCA SUB-ASSEMBLY INTO THE HOUSING, AND LOOSELY FASTEN ALL SCREWS. TORQUE THE SCREWS TO THE NOTED VALUE.
 - UPON COMPLETION AND TEST OF THE ASSEMBLY, THREAD ITEM 35 ONTO THE CONNECTOR AS SHOWN.
 - ALL TORQUE VALUES ARE TO BE WITHIN ±10%.

THIS DRAWING AND SPECIFICATION IS THE PROPERTY OF REDLINE COMMUNICATIONS INCORPORATED. IT IS ISSUED AS SPECIFIC CONFIDENCE, AND SHALL NOT BE REPRODUCED OR COPIED OR USED AS THE BASIS FOR THE MANUFACTURE OF ANY APPARATUS WITHOUT PRIOR WRITTEN PERMISSION.		INTERNAL USE BOM 23-00134-00 N/A N/A	DRAWN M.B. 06/20/10	DATE 06/20/10	
THREADED 	QTY USED ON DO NOT SCALE DIMENSIONS	SHEET 1 OF 1	PART NO. 80-00302-00	REV 02	ASSEMBLY, RDL-3000