

NOTES:

- 1- HARDWARE BAG, #062-510757, CONSIST OF ITEMS #02, 04, 05, 08, 09, 10 AND 11.
- 2- WHEN CABLE ASSY/PCB (ITEM 03) IS POSITIONNED ON PLASTIC HOUSING (ITEM 01) COVER ALL SURFACE OF PCB EXCEPT THE BUZZER TOP FACE WITH EPOXY POTTING COMPOUND (ITEM 06).

REVISIONS					
REV	ECN	DESCRIPTION	FAIT PAR MADE BY	VERIF PAR CHK'D BY	DATE
1	10558	ORIGINAL RELEASE	F.D.	A.P.	18FE 2003
2	10688	RELEASED FOR PILOT	F.D.	A.P.	29AL 2003
3	10701	ITEM #06 WAS EURETHANE GYFTHANE 505519	F.D.	A.P.	12MA 2003

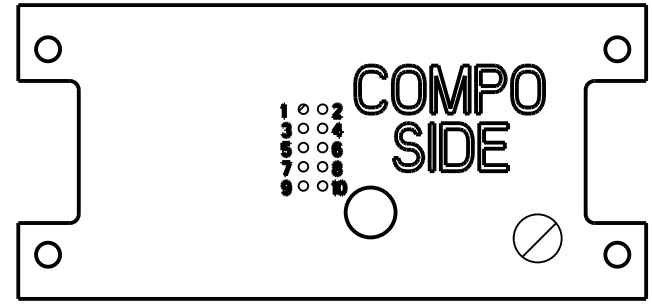
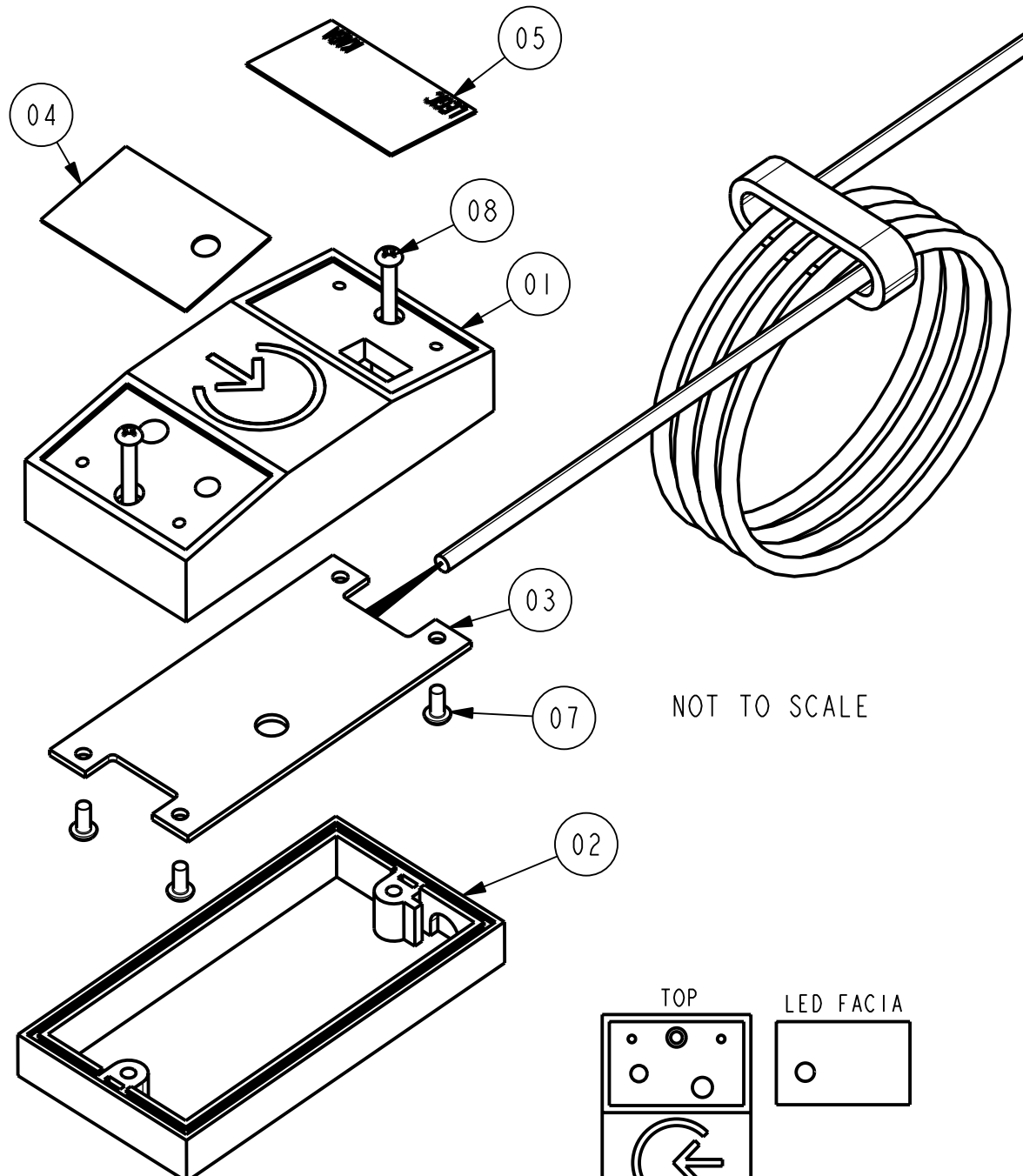

SCALE 1:1

ITEM NO	QTY REQUIRED	CODE D'IDENT IDENT CODE	NUMERO DE PIÈCE OU D'IDENTIFICATION PART OR IDENTIFYING NUMBER	NOMENCLATURE / DESCRIPTION
12	1	-	038-510844	LABEL, KIMPROX LEGIC READER (NOT SHOWN)
11	1	-	E1-PK6-18	POLYBAG 5X6, KANBAN (NOT SHOWN) SEE NOTE #1
10	2	-	999-510754	CONCRETE SCREW ANCHORS (NOT SHOWN)
09	2	-	999-510753	NYLON GRIP PLUGS, "DRY WALL" (NOT SHOWN)
08	2	-	890-510752	MOUNTING SCREW PAN HD PHILLIPS 4- 1 1/4
07	4	-	810-503561	DRIVE STEEL, PHILLIPS, 4-40UNC
06	40	ML	015-510858	EPOXY POTTING COMPOUND (NOT SHOWN) SEE NOTE #2
05	1	-	009-510655-4	FACIA 'LOGO'
04	1	-	009-510655-3	FACIA 'LED'
03	1	-	124-510520-001	CABLE ASSY / PCB
02	1	-	009-510655-2	FRAME "SPACER"
01	1	-	009-510655-1	PLASTIC HOUSING

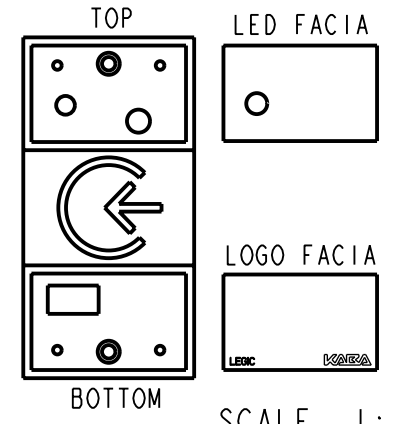

SCALE 1:2

ITEM NO	QTY REQUIRED	CODE D'IDENT IDENT CODE	NUMERO DE PIÈCE OU D'IDENTIFICATION PART OR IDENTIFYING NUMBER	NOMENCLATURE / DESCRIPTION
XXX				DIMENSIONS CRITIQUES CRITICAL DIMENSIONS
				PROJECTION 31em ANGLE THIRD ANGLE PROJECTION
				NE PAS MESURER SUR LE DESSIN DO NOT SCALE DRAWING
				DIMENSIONING AND TOLERANCING AS PER AMERICAN SOCIETY OF MECH ENGINEERS ASME Y14.5-1994
				CE DOCUMENT EST LA PROPRIETE STRICTE DE KABA ILCO. LES DONNEES QU'IL CONTIENT NE PEUVENT ETRE COPIEES OU DIVULGUEES A UNE TIERCE PARTIE SANS LE CONSENTEMENT ECRIT DE KABA ILCO. CE DOCUMENT DEVRA ETRE RETOURNE SUR DEMANDE A KABA ILCO.
				THIS DOCUMENT IS PROPERTY OF KABA ILCO. THE DATA CONTAINED IS PROPRIETARY AND SHALL NOT BE COPIED OR DISCLOSED TO A THIRD PARTY WITHOUT WRITTEN CONSENT OF KABA ILCO. THIS DOCUMENT WILL BE RETURNED TO KABA ILCO UPON DEMAND.
				SANS AUTRES SPECIFICATIONS, LES DIMENSIONS SONT EN POUÇES ET S'APPLIQUENT APRES FINITION. UNLESS OTHERWISE SPECIFIED, DIMENSIONS ARE IN INCHES AND APPLY AFTER FINISH.
				TOLERANCES: SAUF SI SPECIFIEES AUTREMENT UNLESS OTHERWISE SPECIFIED
				FRACTIONS ± 1/64
				DECIMALES - DECIMALS
				.X ± .03
				.XX ± .02
				.XXX ± .010
				.XXXX ± N/A
				ANGLES ± 1°
				METRIQUE METRIC
				DESSINE PAR: DRAWN BY: P. PRIEUR 06DE02
				CONCU PAR: DESIGNED BY: J.G. GINGRAS 06DE02
				VERIFIE PAR: VERIFIED BY: - -
				APPROUVE PAR: APPROVED BY: - -
				MATERIAU / MATERIAL
				NOT APPLICABLE
				FINITION / FINISH
				NOT APPLICABLE
				TRAITEMENT THERMIQUE / HEAT TREATMENT
				NOT APPLICABLE
				FORMAT
				NO PIECE / PART NO:
				NO DESSIN / DRAWING NO:
				B
				120-510520
				AD-510520
				ECH SCALE
				SEE VIEWS
				PG SHT
				I
				DE OF
				I



READER ASSY
KIMPROX LEGIC