



**Wemo Smart Dimmer  
SETUP GUIDE**

**UX ONLY, NOT FINAL  
VISUAL DESIGN**

## Important to know

### **WARNING! Risk of electric shock**

Incorrect installation could be dangerous or illegal. Multiple breakers/fuses may need to be turned off for safe installation. Please call a professional electrician if you are unfamiliar or uncomfortable with electrical work.

### **Wemo Smart Dimmer can only replace single-pole switches.**

If your light can be turned on from two different wall switches, that's a 3-way switch and Wemo Smart Dimmer is not compatible.

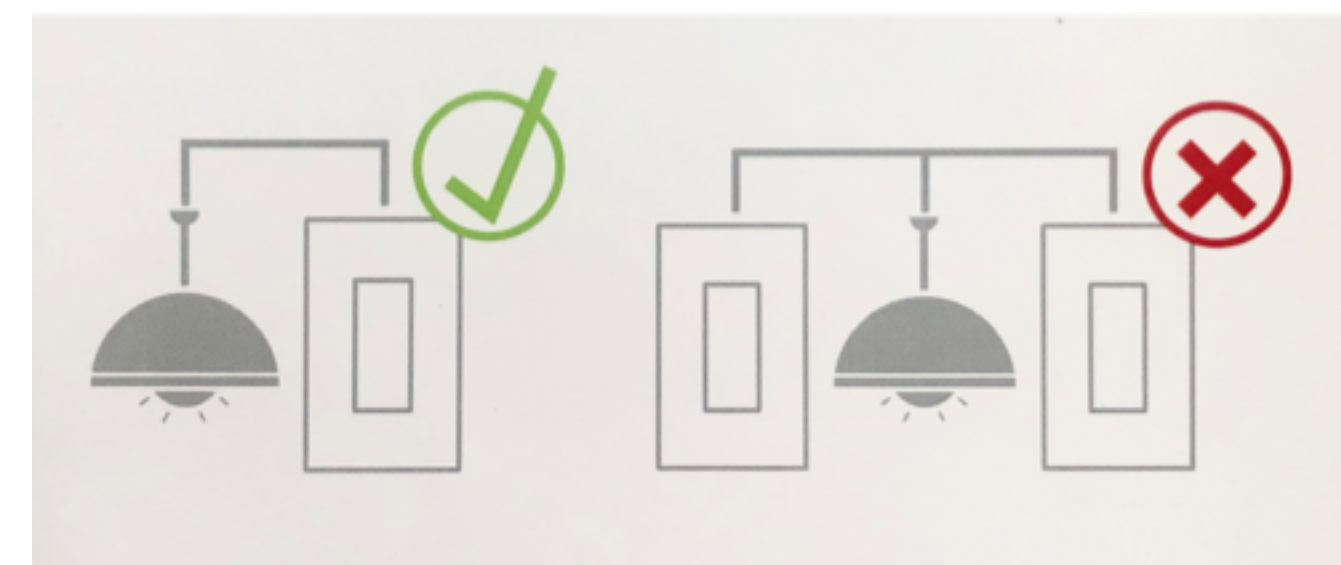

### **Neutral wires are required for setup.**

These wires are typically white and can be found in your electrical box.

**UX ONLY, NOT FINAL  
VISUAL DESIGN**

## What you'll need

### What's included

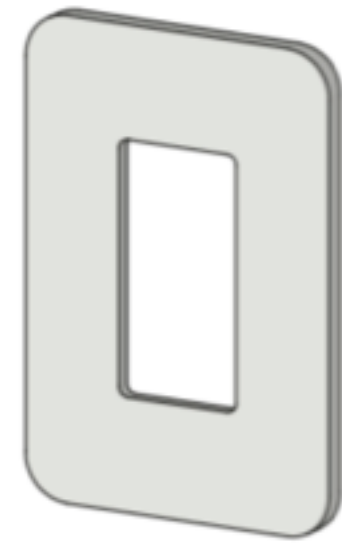

Cover Plate

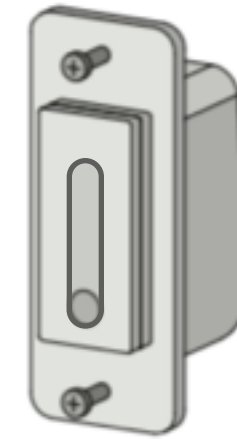

Dimmer and Screws  
(use the provided screws and don't over-tighten)



4 Wire Nuts

### Recommended tools



Phillips screwdriver



Standard screwdriver



Pliers  
(to bend, cut, and strip wires)



Voltage tester

### Compatible light bulbs

All incandescent light bulbs are dimmable, but not all LEDs and CFLs are. Go to [wemo.com/bulbs](http://wemo.com/bulbs) for more information.

### Maximum total wattage



Incandescent

400 Watts

250 Watts for multi-gang

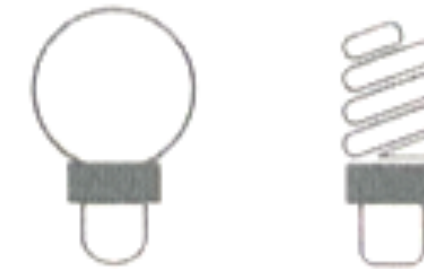

LED and CFL

150 Watts

(Actual Wattage rating, not "equivalent")

### Install where your Wi-Fi signal is strong

- Use your mobile device to test the signal
- Keep your mobile device close to the Dimmer until you finish setup



# Installing your Dimmer

## Installation video



Scan this QR code to watch a video walking through Dimmer installation.

### 1 Turn power off

Shut off power to the switch you're replacing at your fuse panel or circuit breaker.

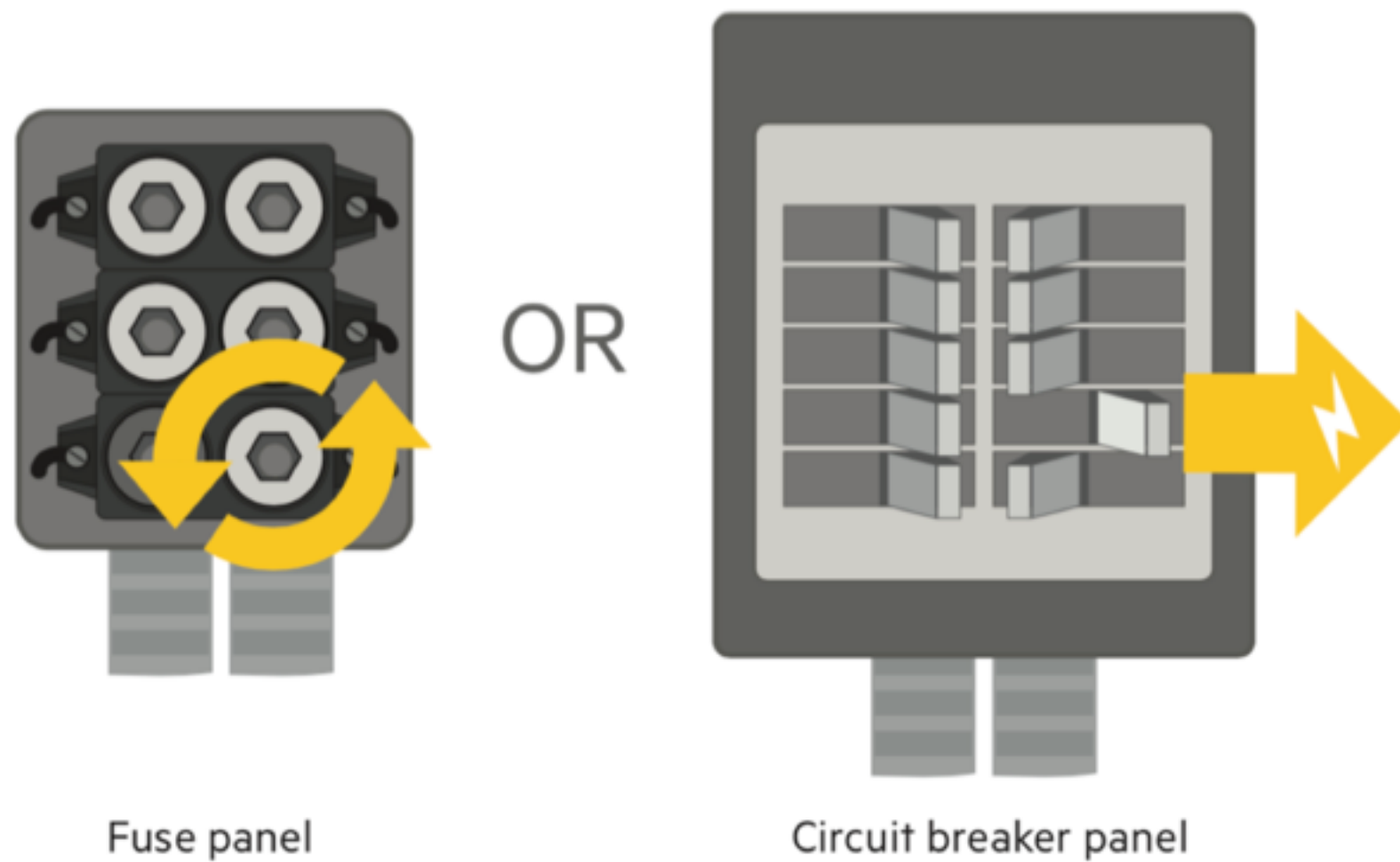

### **WARNING! Risk of electric shock**

Incorrect installation could be dangerous or illegal. Multiple breakers/fuses may need to be turned off for safe installation. Please call a professional electrician if you are unfamiliar or uncomfortable with electrical work.

### Confirm that power is off

Remove the faceplate from the existing switch. Use a voltage tester to test BOTH sides of the switch. You may need to turn off more than one circuit breaker/fuse.

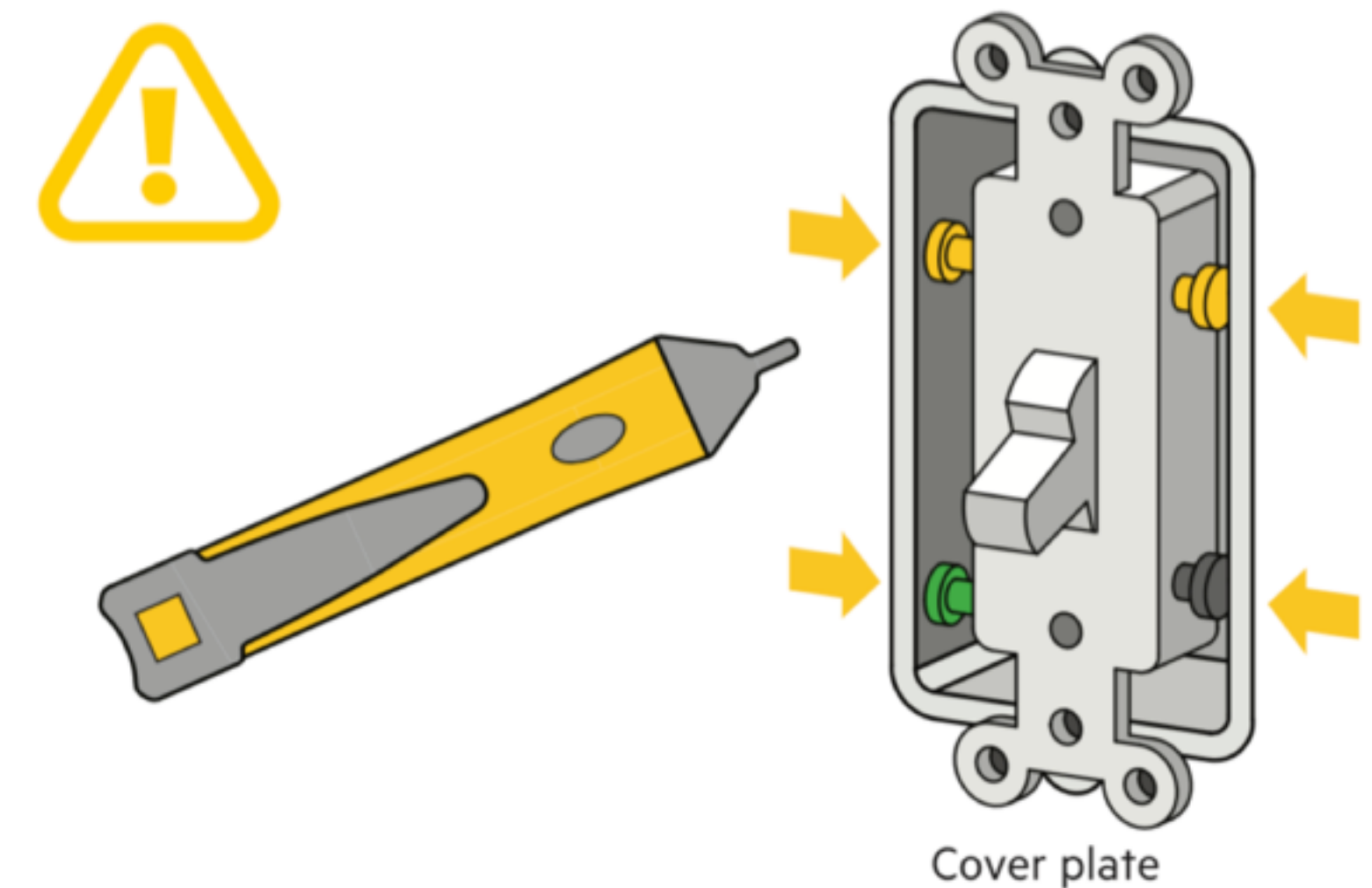

## 2 Identify the NEUTRAL wires

### Pull out existing switch

Unscrew the switch and gently pull it out of the wall.

**Do not remove any of the wires yet.**

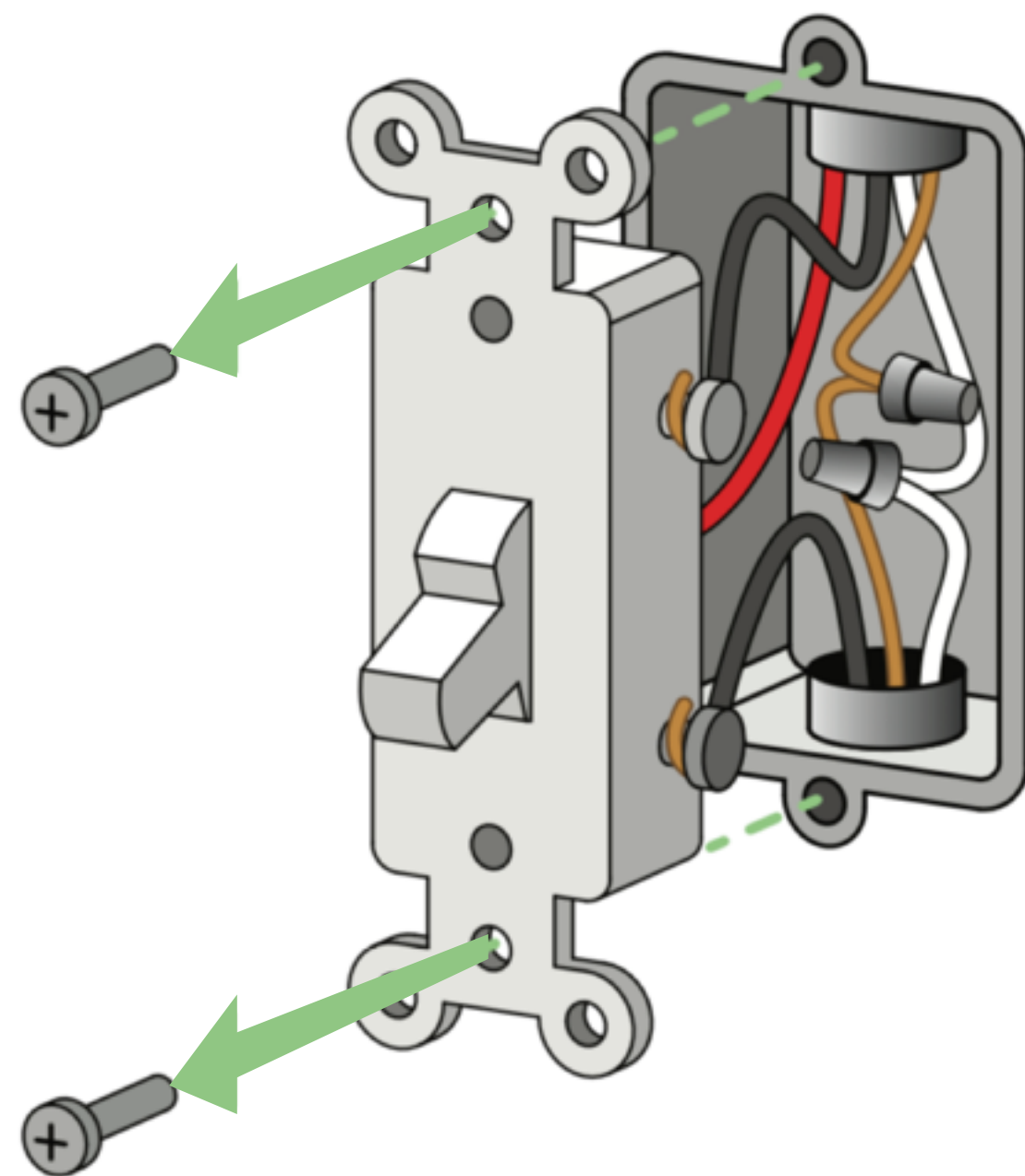

### Find the NEUTRAL wires

Look for NEUTRAL wires (usually white) in the wall. You need these to set up the Dimmer.

NOTE: You may have a different number of neutral wires than shown.

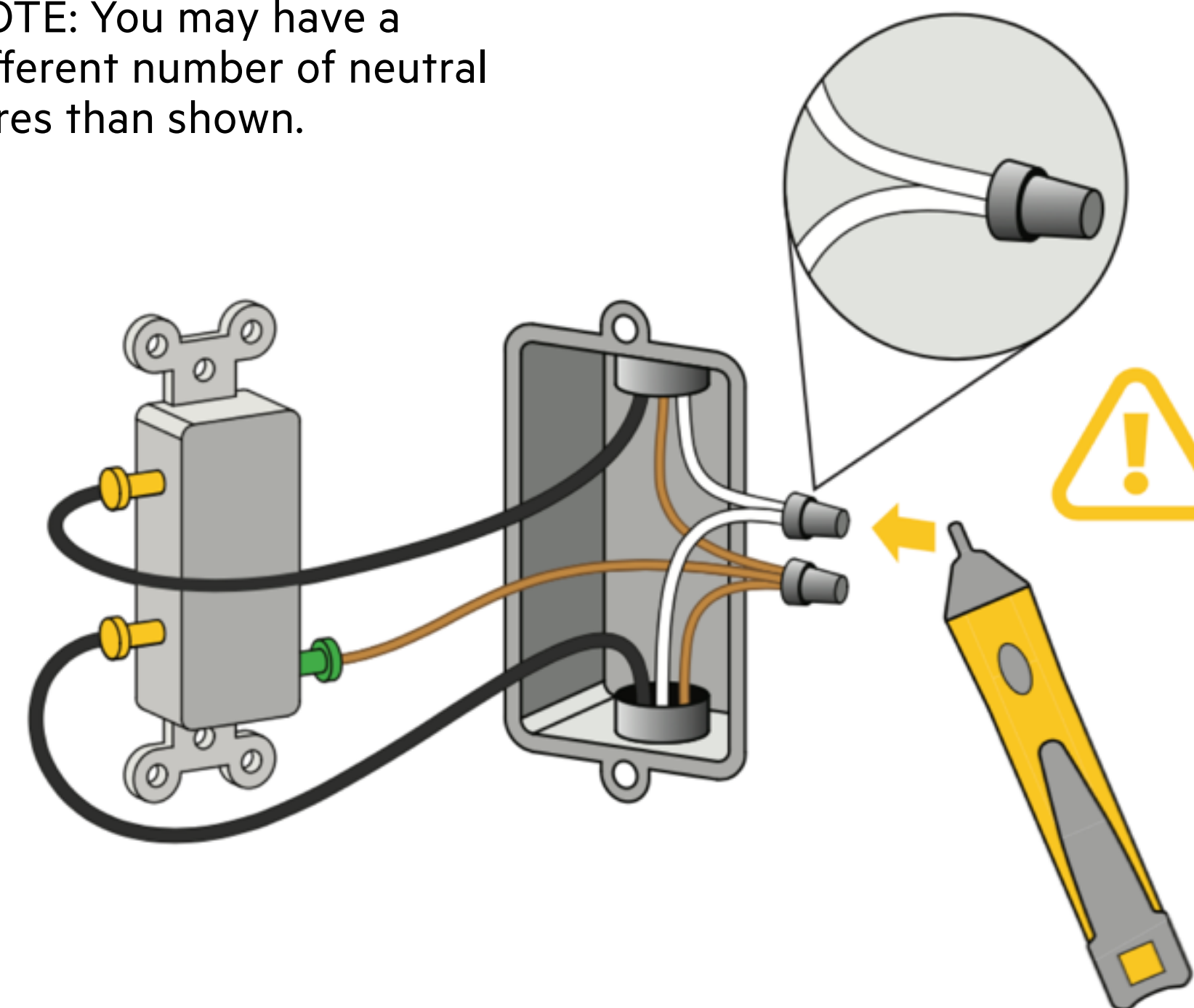

### Test the NEUTRAL wires

Use a voltage tester to check that there is no power in the NEUTRAL wires from neighboring circuits. If necessary, shut off additional circuits until no voltage is found.

### Detach the NEUTRAL wires

Unscrew the wire nut connecting the NEUTRAL wires.

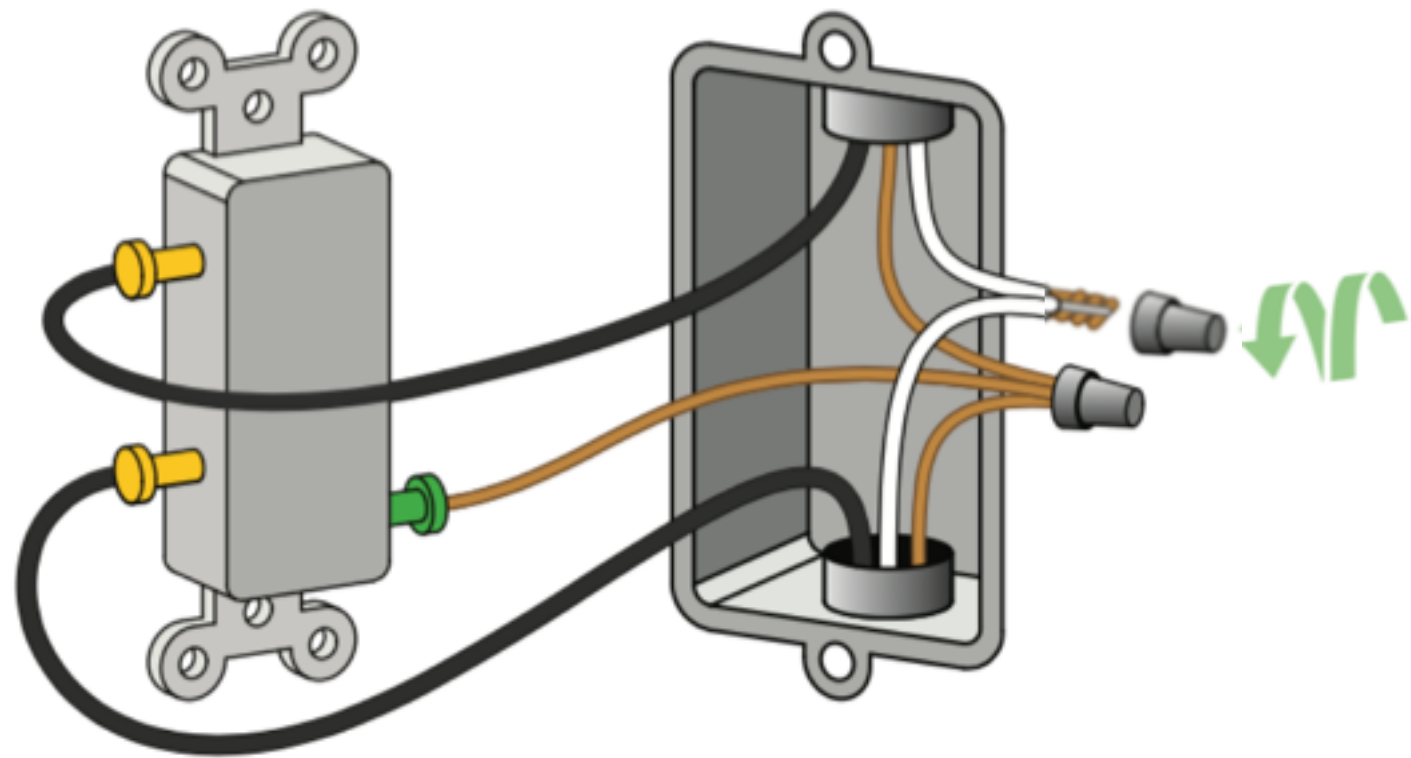

### 3 Identify the GROUND wires

Look for the GROUND wires (usually green or solid copper) and unscrew the wire nut connecting them.

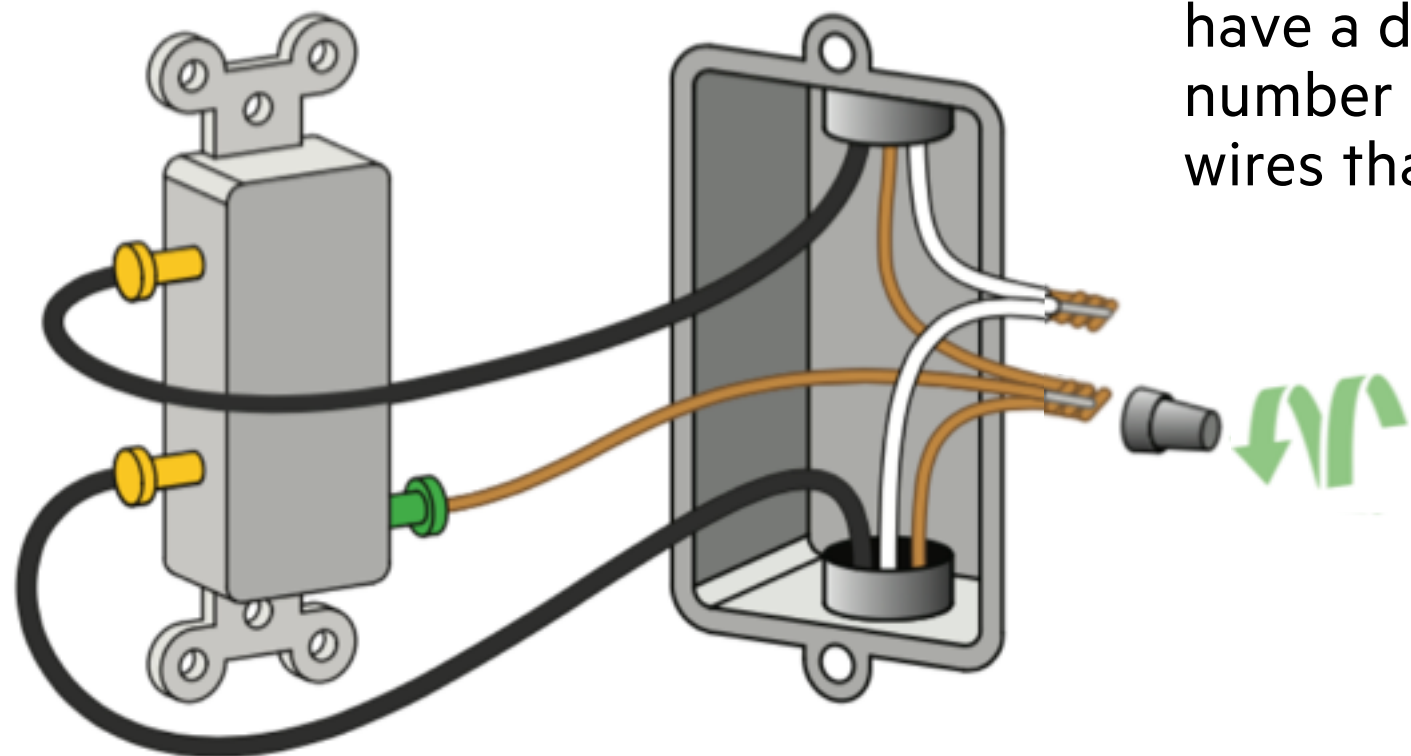

NOTE: You may have a different number of ground wires than shown.

### 4 Identify and label LINE and LOAD wires

Peel off and apply the LINE and LOAD wire labels below. **If you're unsure which wire is which, we'll help you in the next step.**

NOTE: Your existing wires may be in different locations than shown.

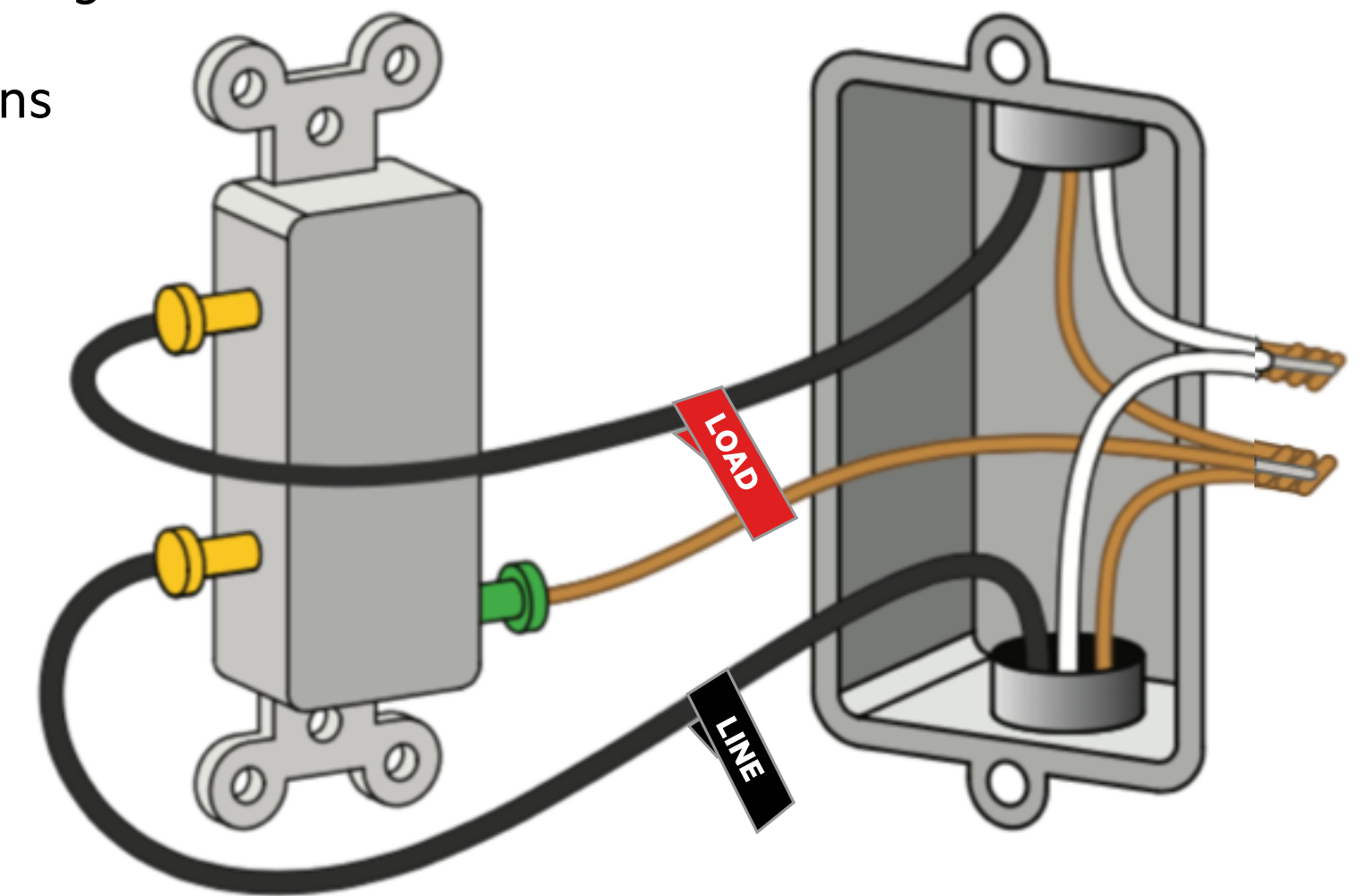

#### Wire labels

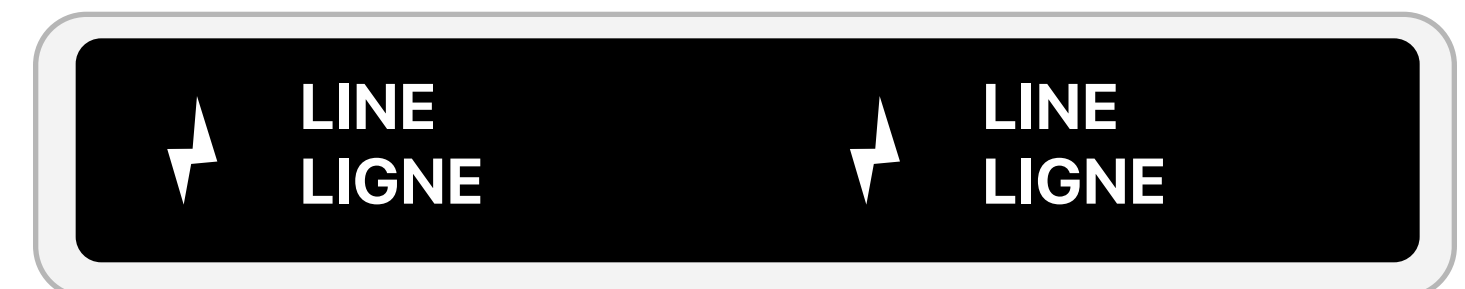



# Help with distinguishing LINE wire from LOAD wire

## Remove existing switch

Detach the remaining wires and remove the existing switch.

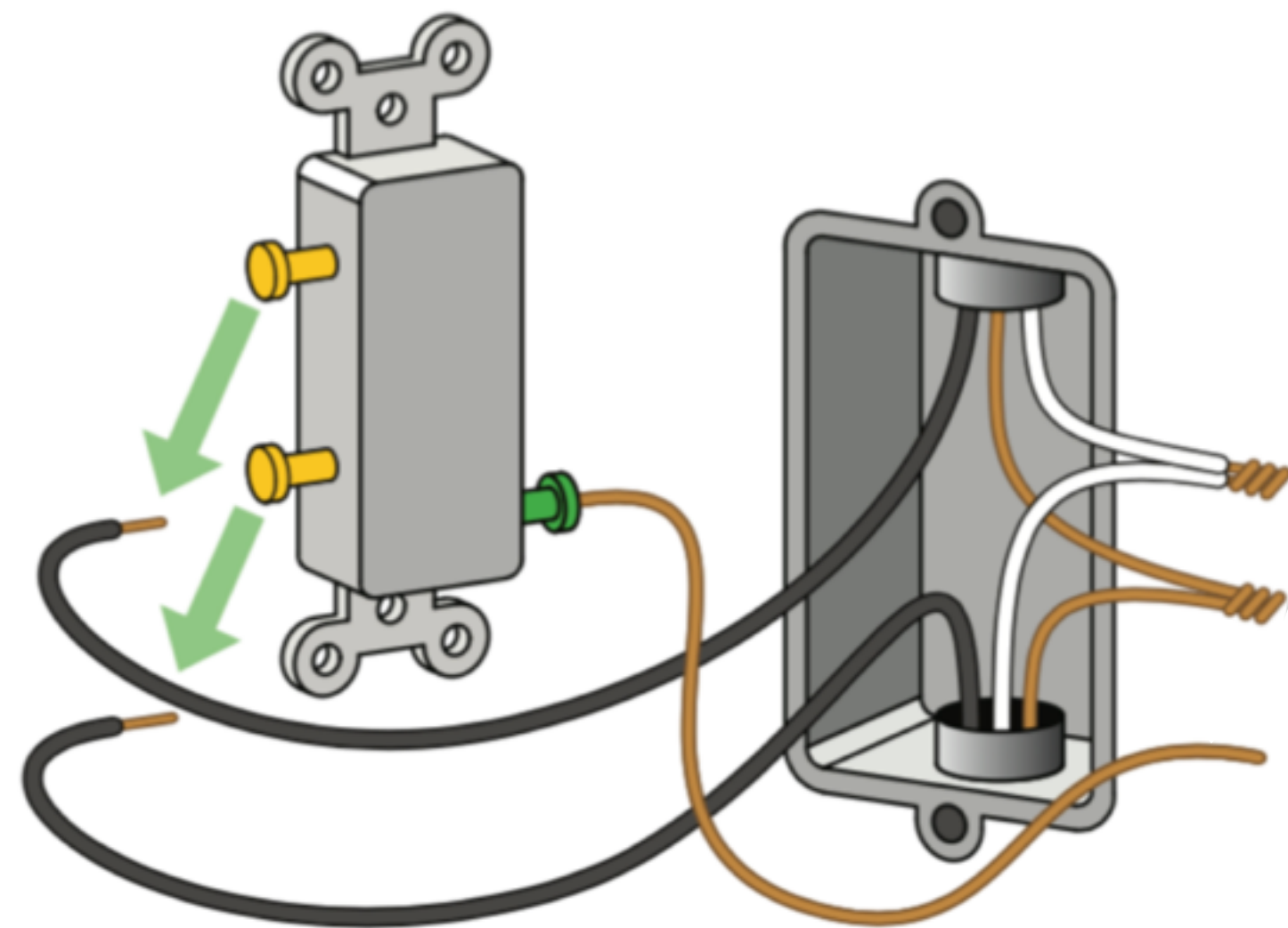

Turn the power back ON ⚠

## Test to identify the wires

Now use a voltage tester to distinguish the wires:

- ⚡ **Line** (typically black): This wire **will be powered** because it carries electricity to the switch.
- ⊖ **Load** (also typically black): This wire **will NOT be powered** because it carries electricity from the switch to your lights.

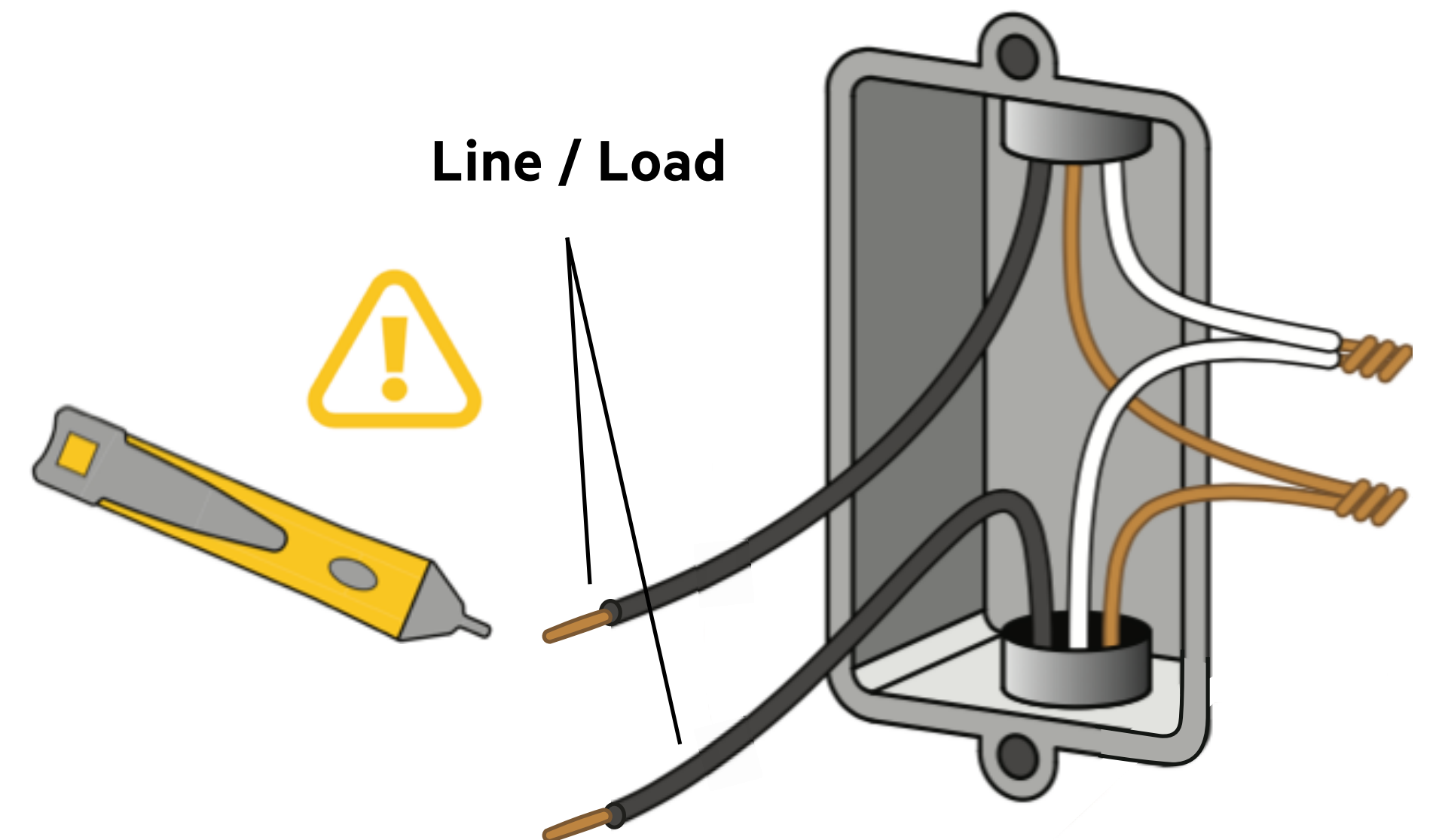

Turn the power back OFF ⚠

## 5 Connect Wemo Dimmer wires



Make sure the power is OFF before proceeding.

### Remove cover plate

After detaching and removing the existing switch, snap the cover plate off of your Wemo Dimmer, and remove the sticker securing the wires.

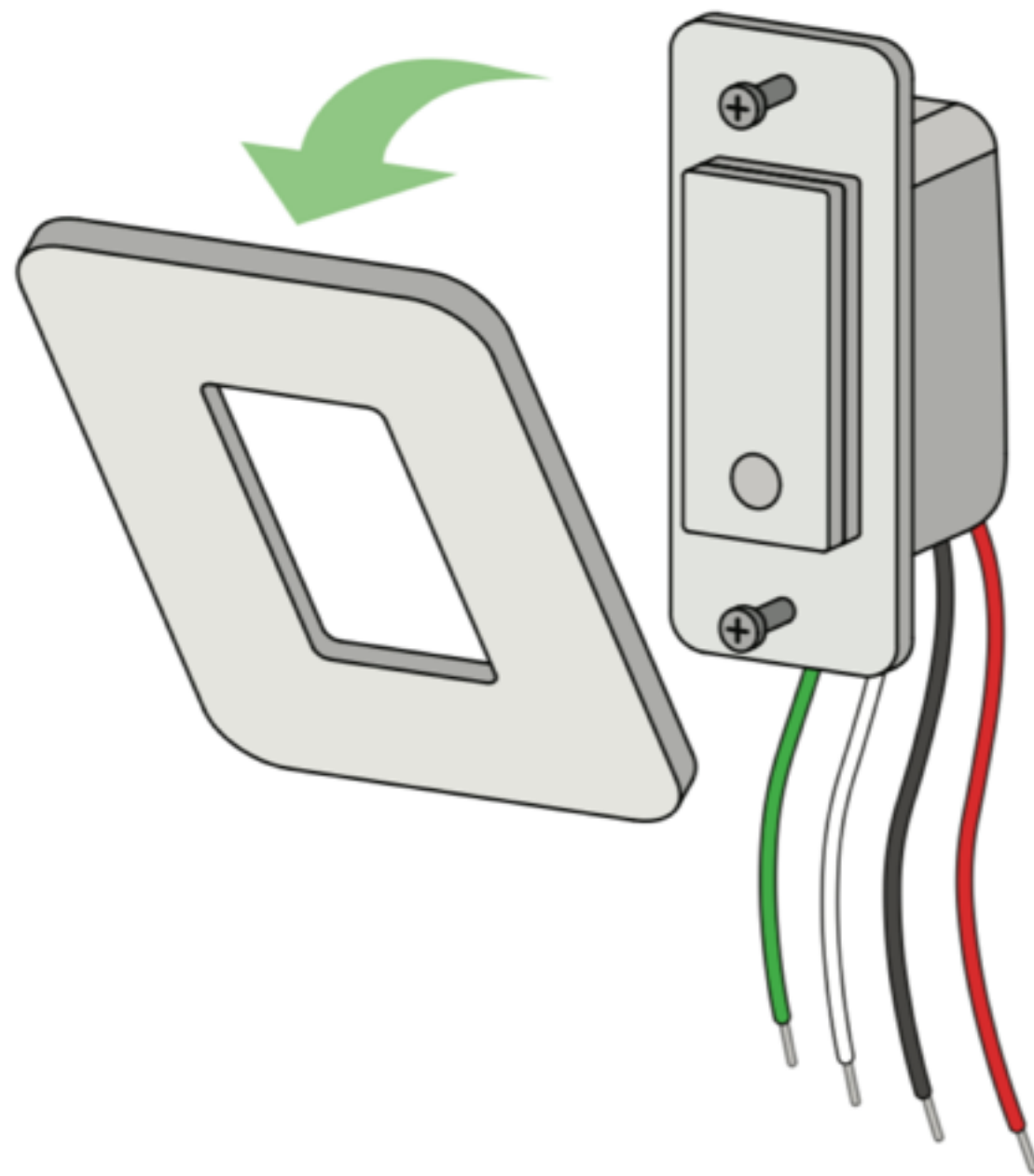

### Connect LINE and LOAD wires

Use a wire nut to connect the **red LOAD wire** on the Dimmer to the LOAD wire in the wall.

Use a wire nut to connect the **black LINE wire** on the Dimmer to the LINE wire in the wall.

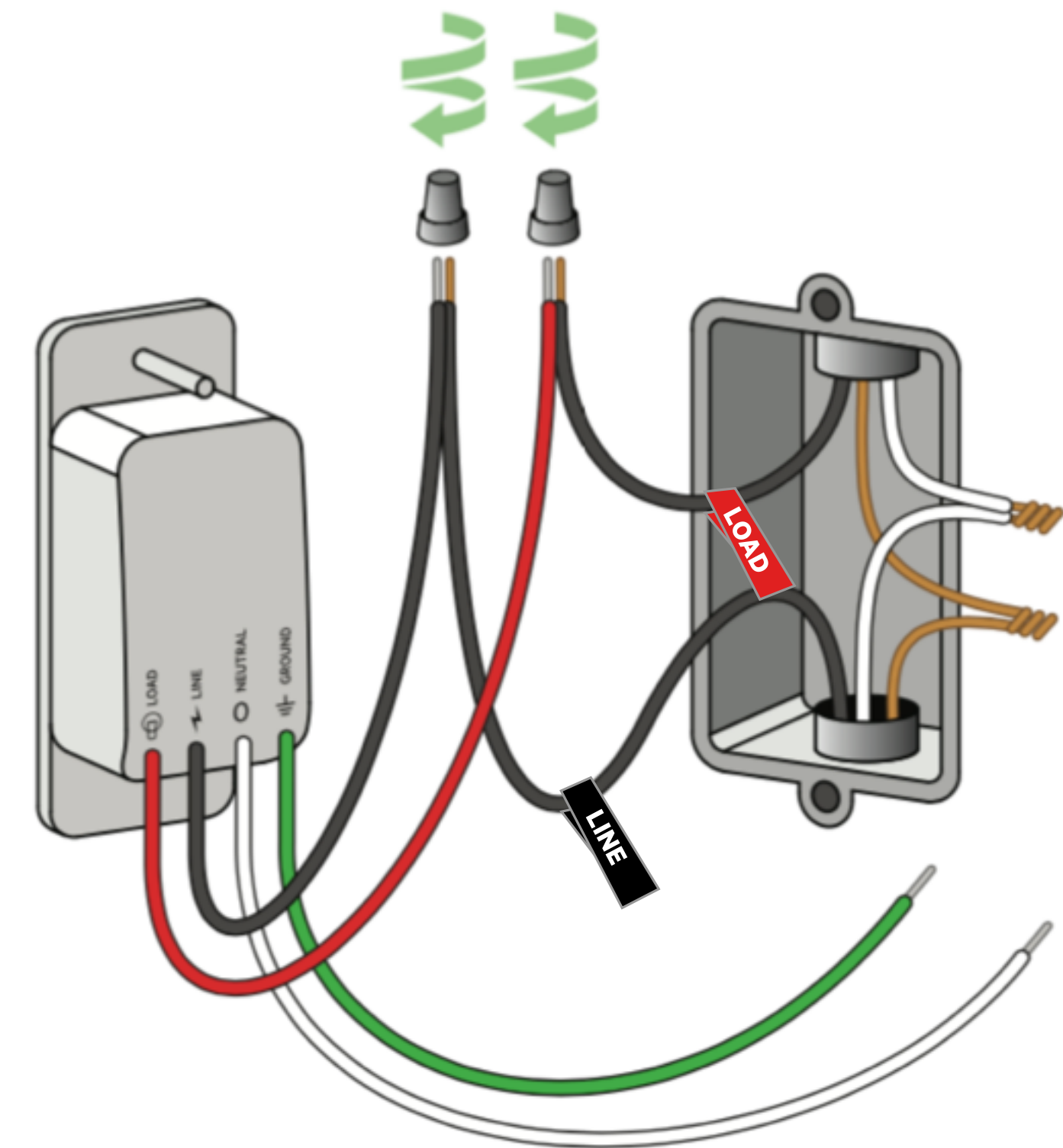

**NOTE:** Your existing wires may be different colors than those shown.



## Connect NEUTRAL and GROUND wires

Use a wire nut to connect the **white NEUTRAL wire** on the Dimmer to the NEUTRAL wires (usually white) in the wall.

Use a wire nut to connect the **green GROUND wire** on the Dimmer to the GROUND wires (usually green or bare copper) in the wall.

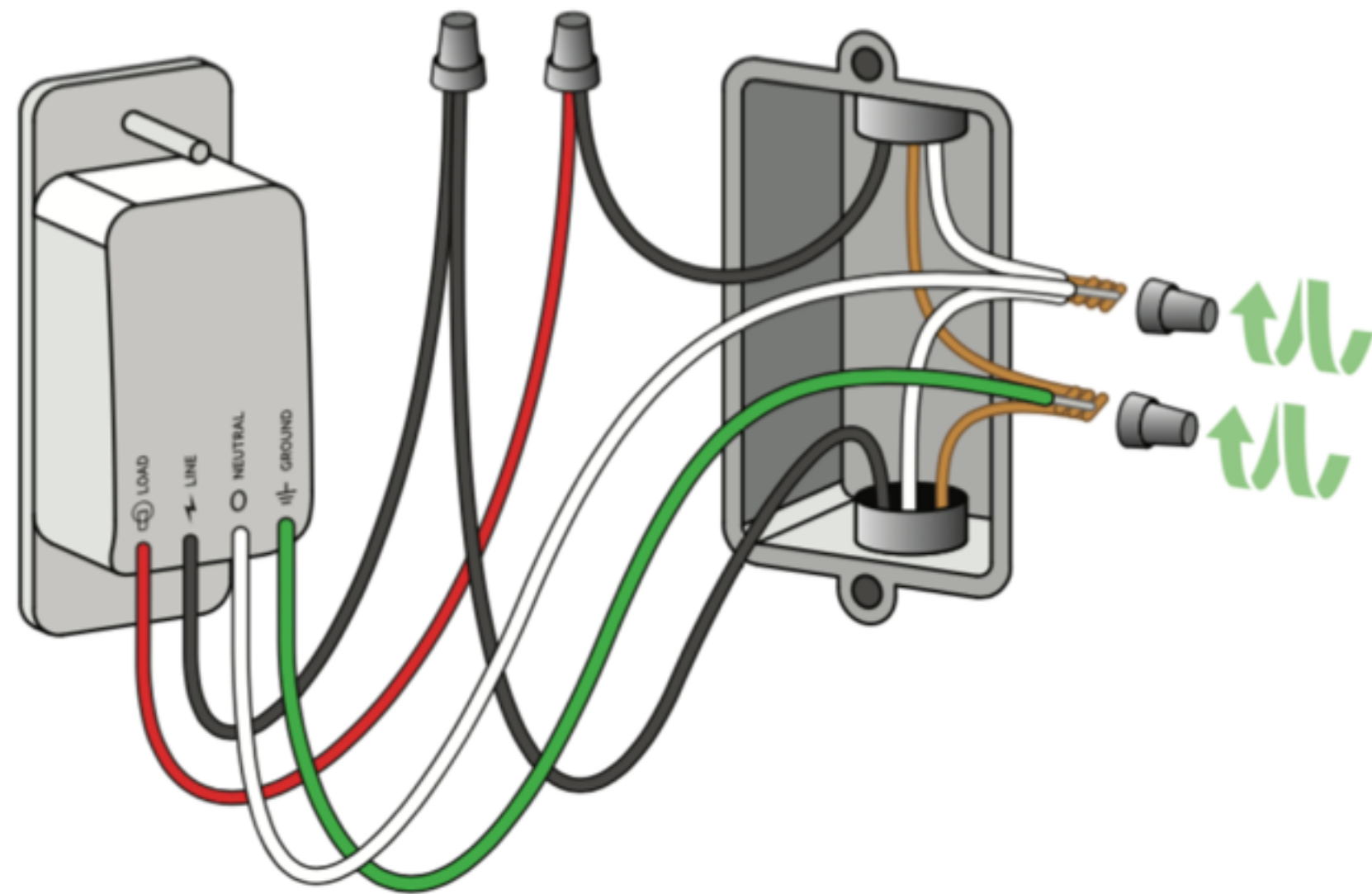

**NOTE: Your existing wires may be different colors than those shown.**

## 6 Install Dimmer into the wall

Almost done! **Tug on each wire nut to make sure they are secure on the wires.**

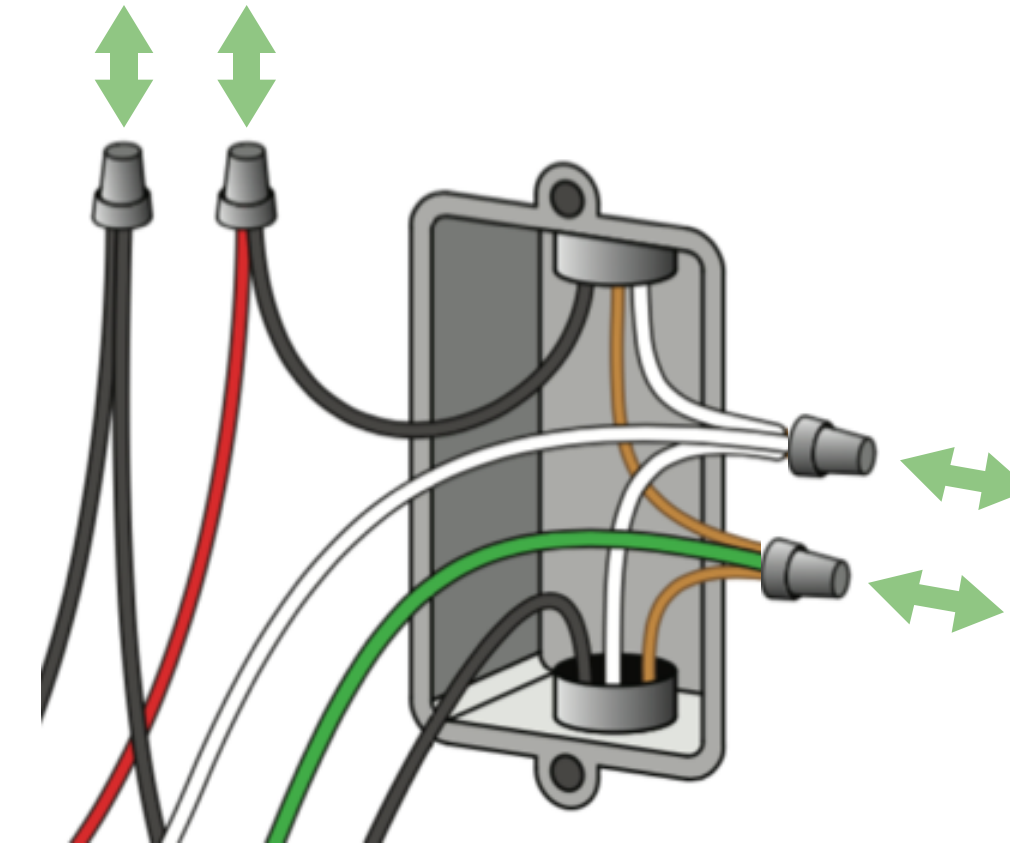

Carefully **tuck wires behind the Dimmer** and insert the Dimmer into the box. It could get crowded in there.

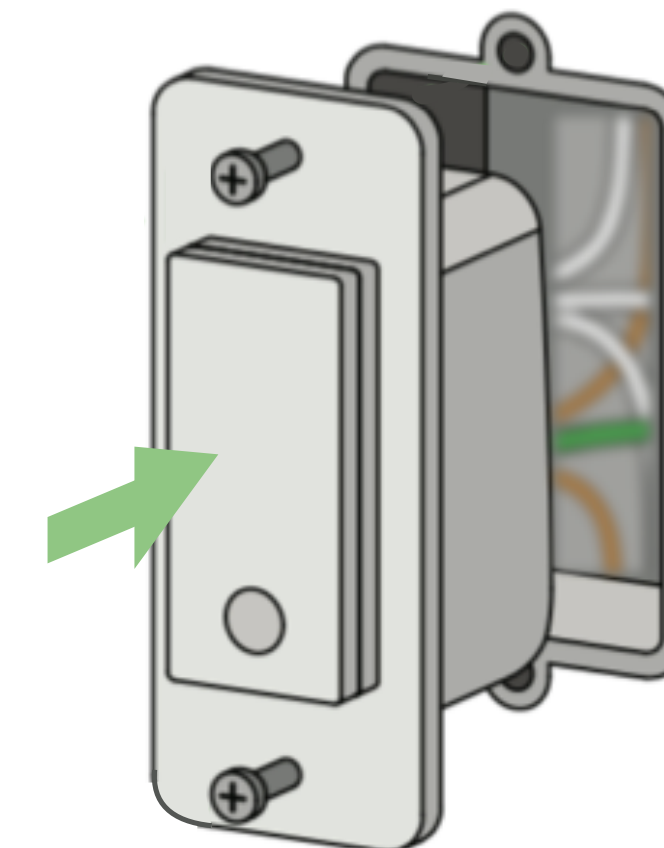

**Screw the Dimmer into the wall.** Be careful not to over-tighten the screws.

NOTE: Before snapping on the cover plate, you'll notice an **8-digit setup code** on the dimmer. You may need this during app setup.

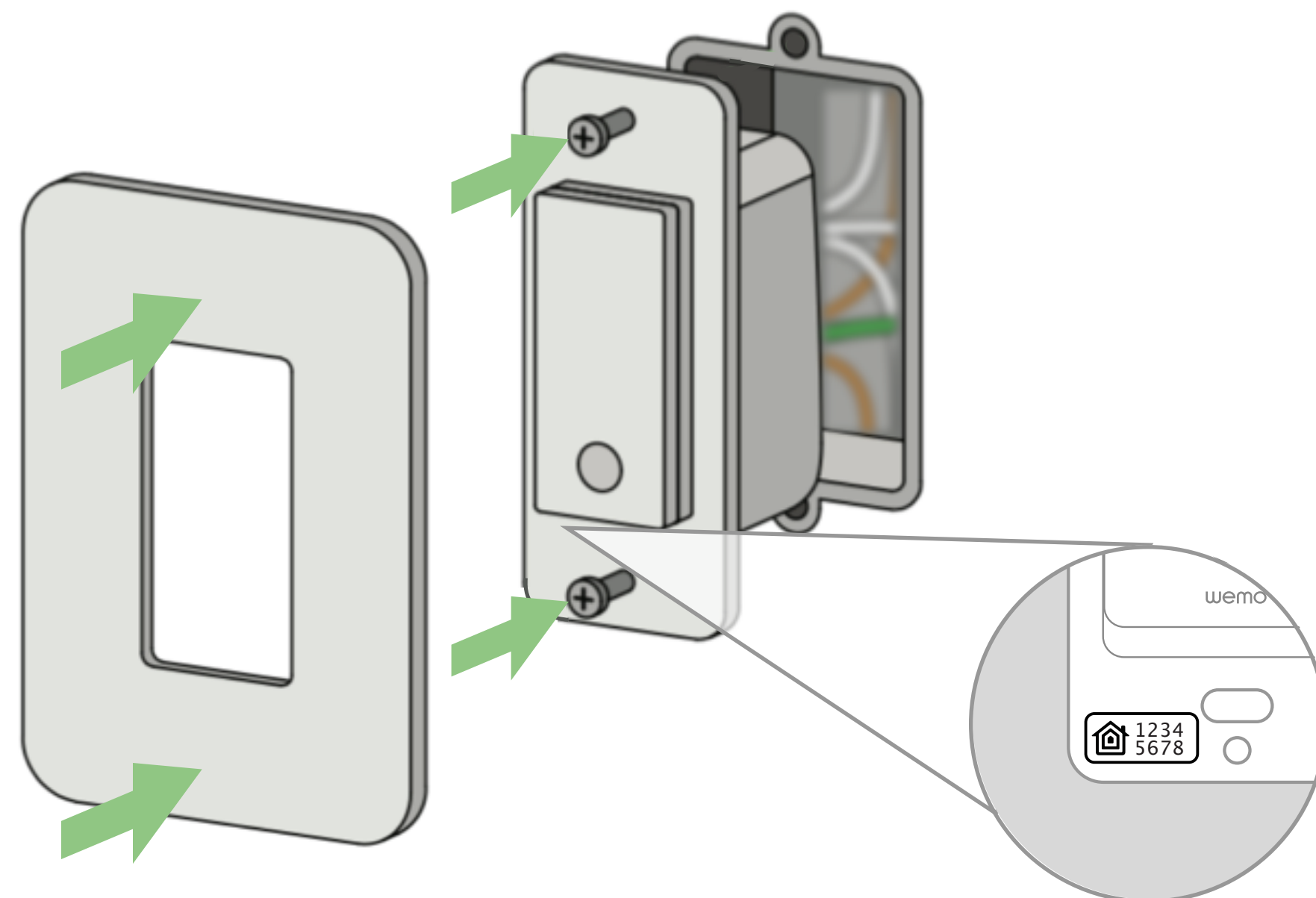

**HomeKit Code**

Finally, **snap the face plate onto the Dimmer.**

# 7

## Turn on power

Turn on power to your Dimmer at your fuse panel or circuit breaker panel.

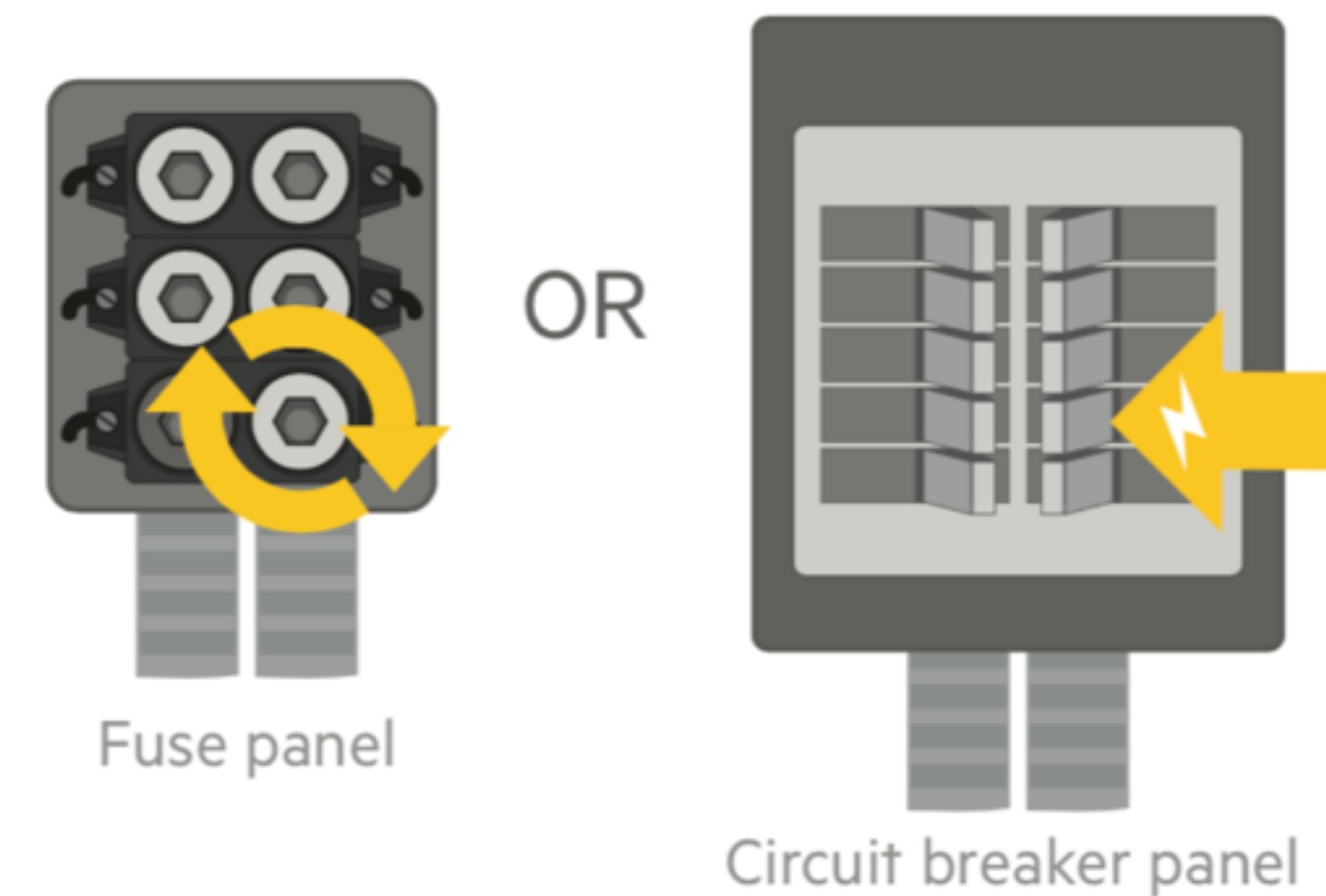

### Physical installation is complete

The light ring on your Dimmer should blink **WHITE** while starting up and **BLUE** when ready for app setup.

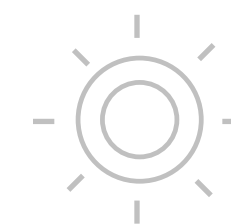

#### **BLINKING WHITE**

Starting up

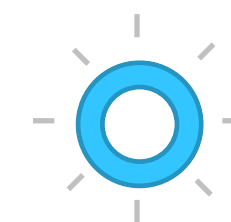

#### **BLINKING BLUE**

Ready for app setup

NOTE: If your Dimmer did not power up, then your load and line wires may be reversed and you need to switch them.

## 8 Go to the app for next steps

### Download and launch the Wemo App



- Create a Wemo account in the app, then **add your Dimmer**.

### Use HomeKit Code if prompted

If prompted, scan or type your Wemo's code below. The 8-digit number should match the code on your Dimmer (behind the faceplate).

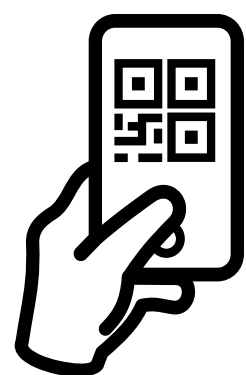

Hang on to this guide. The code may come in handy if you ever need to set up this Wemo again.

## Connecting to other services

Control your Wemos with voice, create groups, and more. Connect to these services in the Wemo App.



## Got questions?

Visit [wemo.com/support](https://wemo.com/support) or call us at **1-844-745-WEMO** for support.

For warranty information, go to [wemo.com/warranty](https://wemo.com/warranty).



