

Blood pressure monitor
part name: label,rating
drwg: HEM-7371T1-AZ

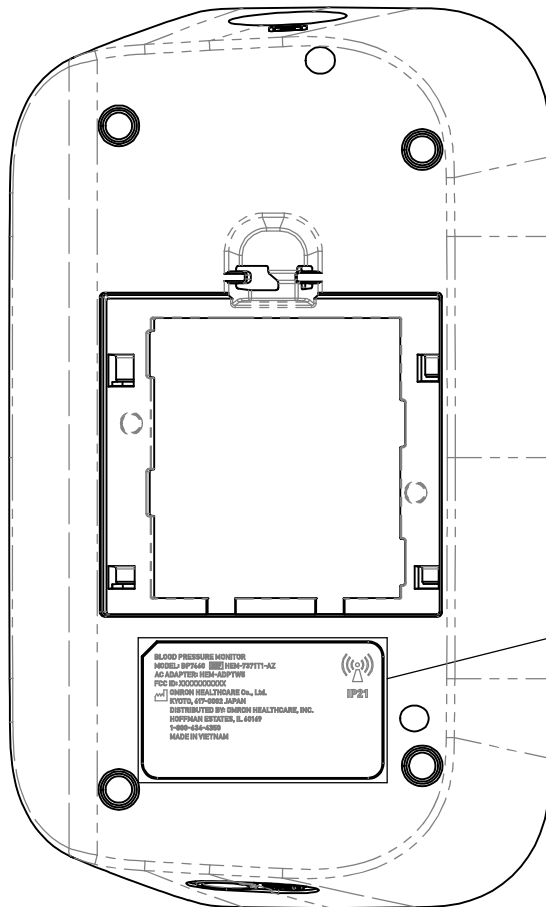

*Due to the size of product, the statement required by FCC 15.19(a) will be printed on users manual.

The FCC Identifier "FCC ID" is 4.0 point or larger.

The labels are laser-engraved, so the letters do not fade easily and the labels themselves do not peel off.

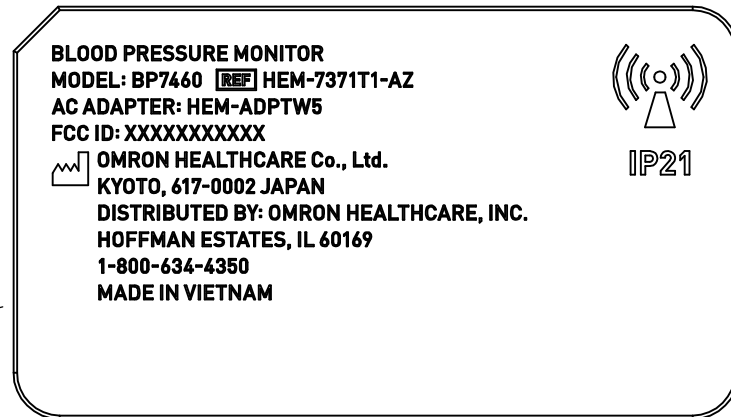

FCC ID: XXX-XXXXXXX will be replaced by FCC ID:Q6ZHEM7382T1.

Blood pressure monitor
part name: label,rating
drwg: HEM-7372T1-AZAZ

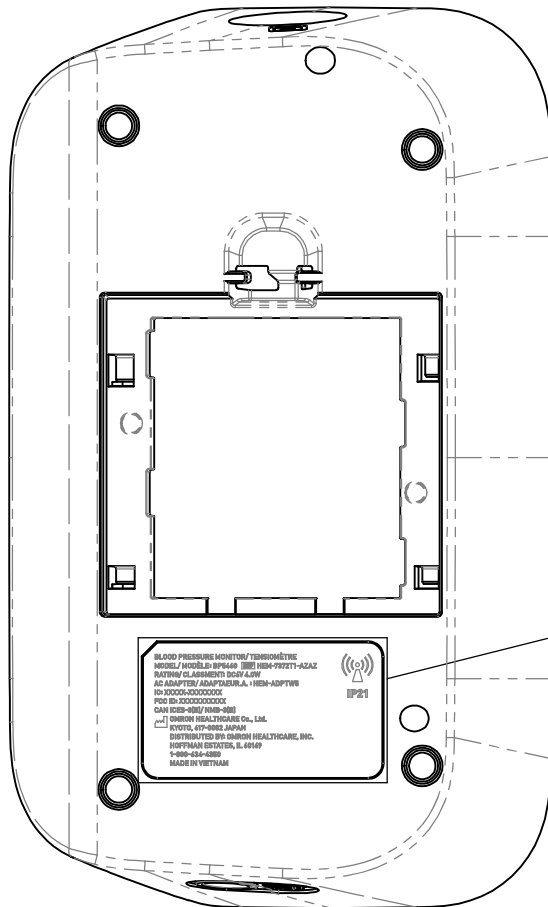

*Due to the size of product, the statement required by FCC 15.19(a) will be printed on users manual.

The FCC Identifier "FCC ID" is 4.0 point or larger.

The labels are laser-engraved, so the letters do not fade easily and the labels themselves do not peel off.

BLOOD PRESSURE MONITOR/ TENSIO MÈTRE
MODEL/ MODÈLE: BP5460 REF HEM-7372T1-AZAZ
RATING/ CLASSMENT: DC6V 4.0W
AC ADAPTER/ ADAPTEUR.A. : HEM-ADPTW5
IC: XXXXX-XXXXXXXX
FCC ID: XXXXXXXXXXXX
CAN ICES-3(B)/ NMB-3(B)
 **OMRON HEALTHCARE Co., Ltd.**
KYOTO, 617-0002 JAPAN
DISTRIBUTED BY: OMRON HEALTHCARE, INC.
HOFFMAN ESTATES, IL 60169
1-800-634-4350
MADE IN VIETNAM

IP21

IC:XXXXX-XXXXXXXX will be replaced by IC:10623A-HEM7382T1.

FCC ID: XXX-XXXXXXXX will be replaced by FCC ID:Q6ZHEM7382T1.

Blood pressure monitor
part name: label,rating
drwg: HEM-7381T1-AZ

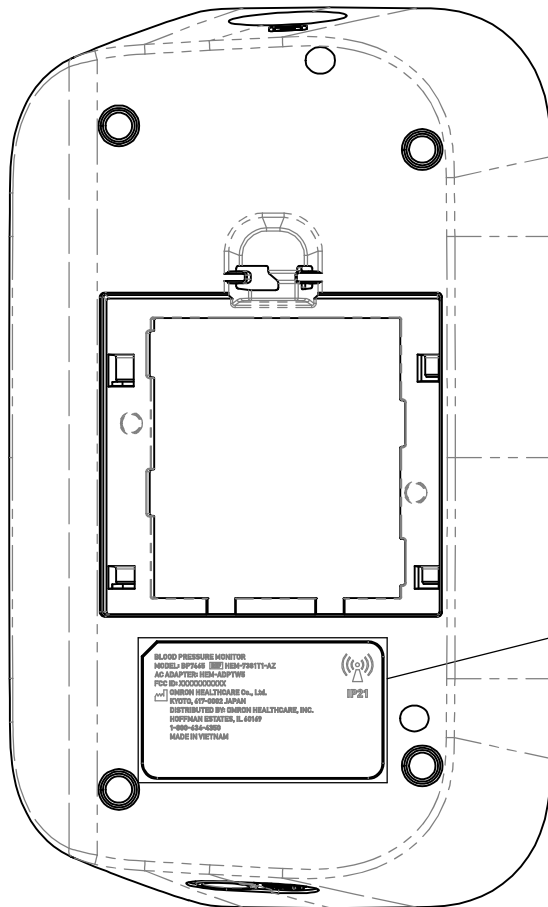

*Due to the size of product, the statement required by FCC 15.19(a) will be printed on users manual.

The FCC Identifier "FCC ID" is 4.0 point or larger.

The labels are laser-engraved, so the letters do not fade easily and the labels themselves do not peel off.

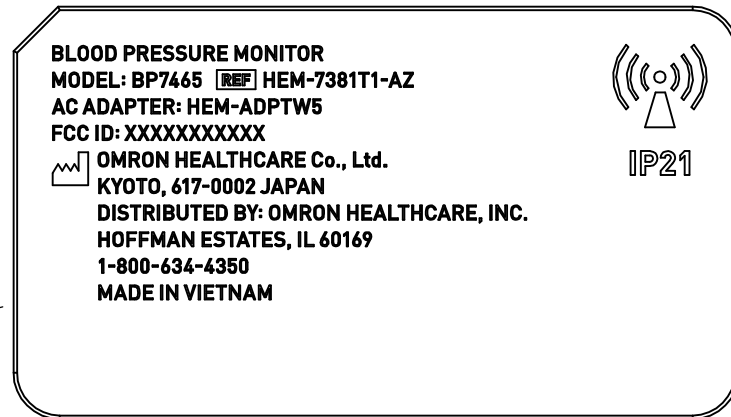

FCC ID: XXX-XXXXXXX will be replaced by FCC ID: Q6ZHEM7382T1.

Blood pressure monitor
 part name: label,rating
 drwg: HEM-7382T1-AZAZ

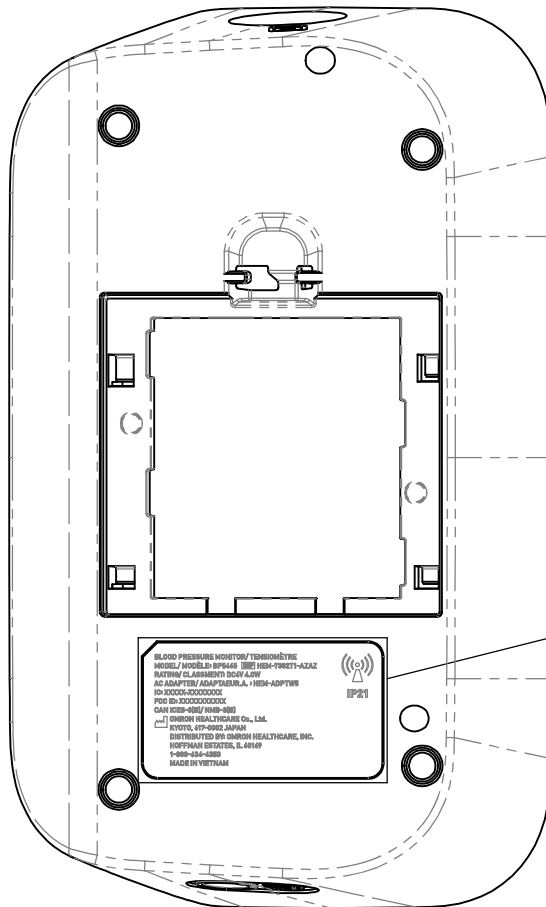

*Due to the size of product, the statement required by FCC 15.19(a) will be printed on users manual.

The FCC Identifier "FCC ID" is 4.0 point or larger.

The labels are laser-engraved, so the letters do not fade easily and the labels themselves do not peel off.

BLOOD PRESSURE MONITOR/ TENSIOMÈTRE
MODEL/ MODÈLE: BP5465  **HEM-7382T1-AZAZ**
RATING/ CLASSMENT: DC6V 4.0W
AC ADAPTER/ ADAPTAEUR.A. : HEM-ADPTW5
IC: XXXXX-XXXXXXXX
FCC ID: XXXXXXXXXXX
CAN ICES-3(B)/ NMB-3(B)

 **OMRON HEALTHCARE Co., Ltd.**
KYOTO, 617-0002 JAPAN
DISTRIBUTED BY: OMRON HEALTHCARE, INC.
HOFFMAN ESTATES, IL 60169
1-800-634-4350
MADE IN VIETNAM

IP21

IC:XXXXX-XXXXXXXX will be replaced by IC:10623A-HEM7382T1.

FCC ID: XXX-XXXXXXXX will be replaced by FCC ID: Q6ZHEM7382T1.

Blood pressure monitor
part name: label,rating
drwg: HEM-7376T1-Z

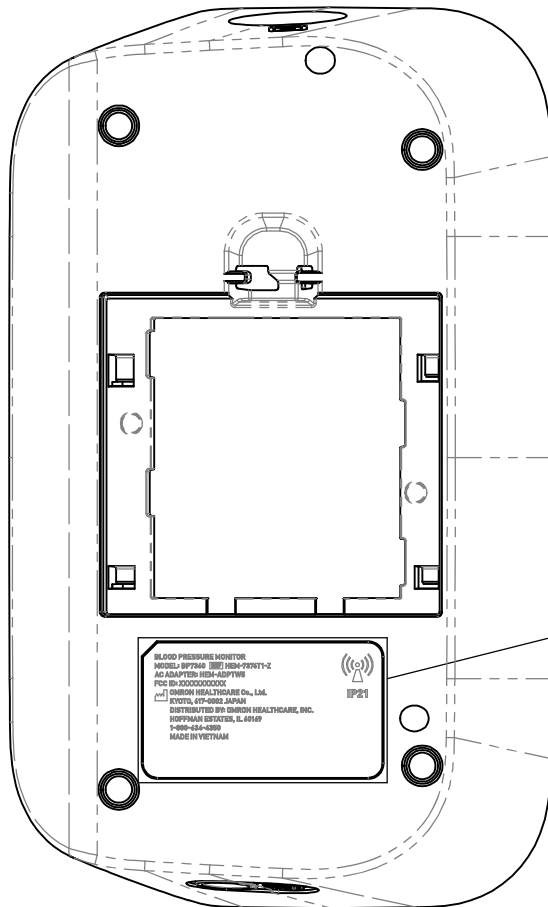



*Due to the size of product, the statement required by FCC 15.19(a) will be printed on users manual.

The FCC Identifier "FCC ID" is 4.0 point or larger.

The labels are laser-engraved, so the letters do not fade easily and the labels themselves do not peel off.

BLOOD PRESSURE MONITOR
MODEL: BP7360  **HEM-7376T1-Z**
AC ADAPTER: HEM-ADPTW5
FCC ID: XXXXXXXXXX

 **OMRON HEALTHCARE Co., Ltd.**
KYOTO, 617-0002 JAPAN
DISTRIBUTED BY: OMRON HEALTHCARE, INC.
HOFFMAN ESTATES, IL 60169
1-800-634-4350
MADE IN VIETNAM

IP21

FCC ID: XXX-XXXXXXX will be replaced by FCC ID: Q6ZHEM7382T1.

Blood pressure monitor
 part name: label,rating
 drwg: HEM-7377T1-ZAZ

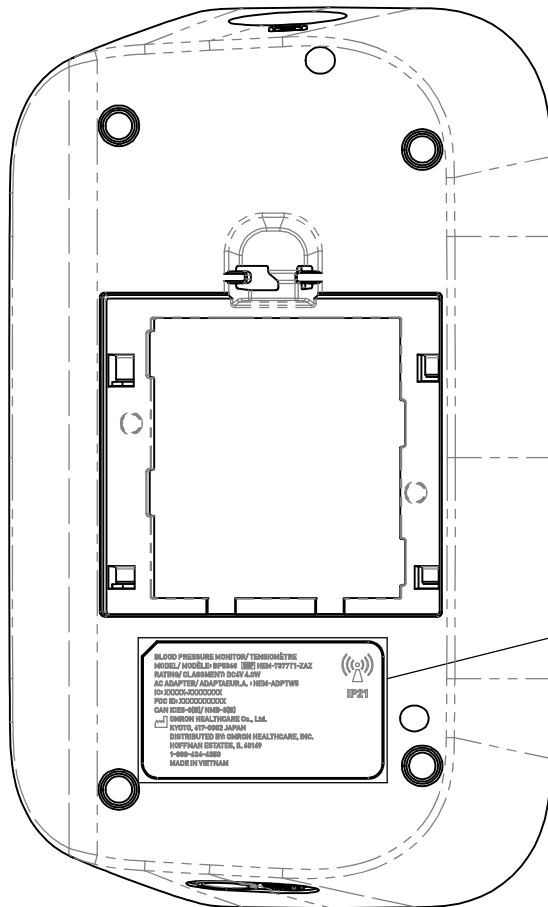

*Due to the size of product, the statement required by FCC 15.19(a) will be printed on users manual.

The FCC Identifier "FCC ID" is 4.0 point or larger.

The labels are laser-engraved, so the letters do not fade easily and the labels themselves do not peel off.

BLOOD PRESSURE MONITOR/ TENSIO MÈTRE
MODEL/ MODÈLE: BP5360 REF HEM-7377T1-ZAZ
RATING/ CLASSMENT: DC6V 4.0W
AC ADAPTER/ ADAPTEUR.A. : HEM-ADPTW5
IC: XXXXX-XXXXXXXX
FCC ID: XXXXXXXXXX
CAN ICES-3(B)/ NMB-3(B)
 **OMRON HEALTHCARE Co., Ltd.**
KYOTO, 617-0002 JAPAN
DISTRIBUTED BY: OMRON HEALTHCARE, INC.
HOFFMAN ESTATES, IL 60169
1-800-634-4350
MADE IN VIETNAM

IP21

IC:XXXXX-XXXXXXXX will be replaced by IC:10623A-HEM7382T1.

FCC ID: XXX-XXXXXXXX will be replaced by FCC ID: Q6ZHEM7382T1.