

ITEM NO.	PART NUMBER	DESCRIPTION	QTY
10	HAS002	REAR HOUSING ASSEMBLY	1
2	IMD001	FACE PLATE	1
3	PLG002	PLUG, SYSCON	1
4	3BT-P8567-00	SCREW	4
5	HAS001	FRONT HOUSING ASSEMBLY	1
6	PLG001	PLUG, AUDIO	1
7	BAT001	BATTERY PACK	1
8	COV002	SCREW COVER	1
9	LAB004	IMEI LABEL	1
10	LAB005	REGULATORY LABEL	1

REVISIONS		
REV.	DESCRIPTION	DATE
A	INITIAL RELEASE	10/21/2010
B	AUDIO PLUG ADDED TO ASSEMBLY	1/15/2011
C	ORINGS REMOVED	2/3/2011
D	ADD LABEL REQUIREMENTS	7/7/2011

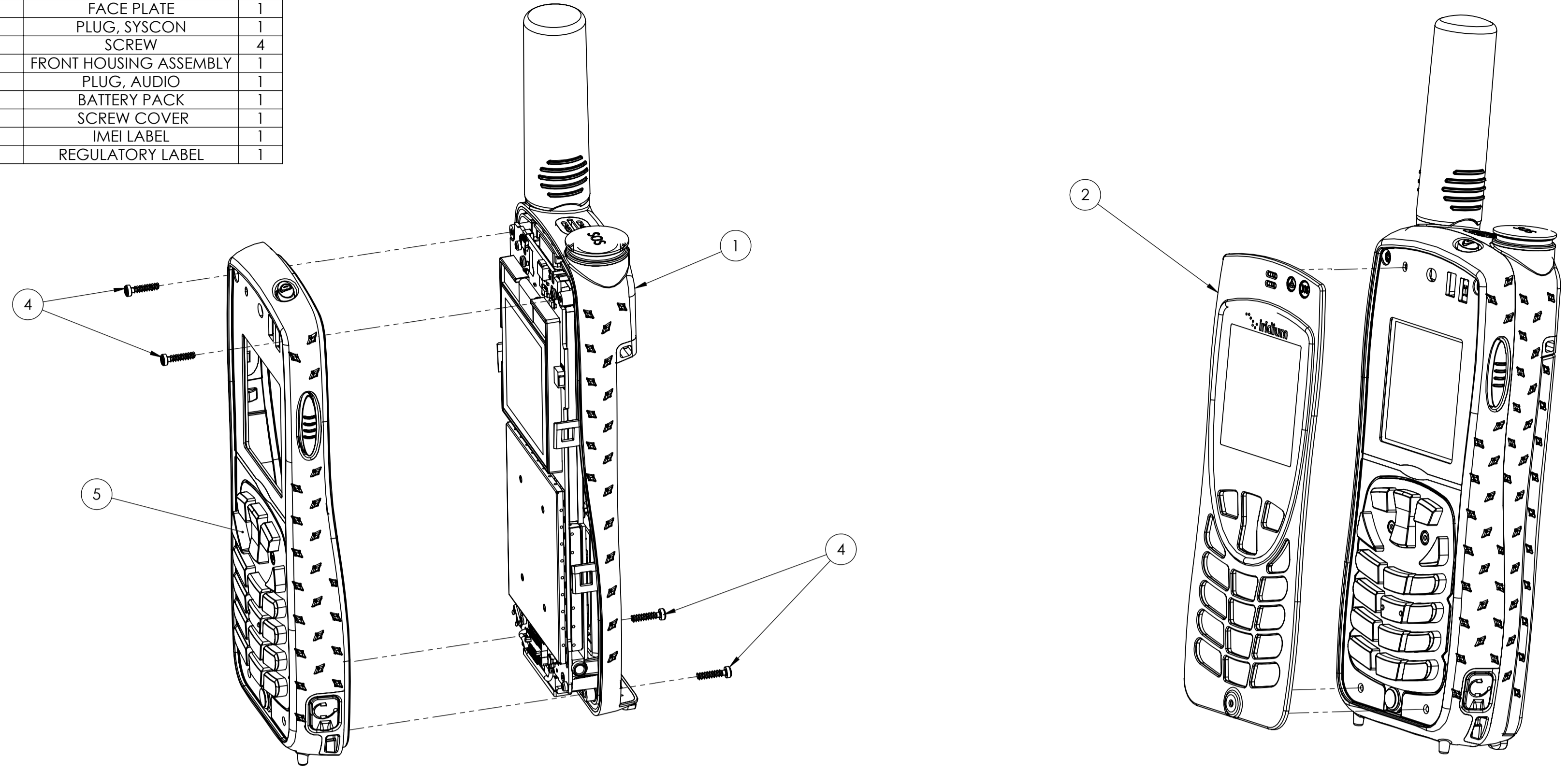

STEP 1. ATTACH HOUSINGS

- ALIGN FRONT (1) AND REAR(2) HOUSINGS AND SNAP TOGETHER
- DRIVE FOUR SCREWS (5) - **SCREW TORQUE 16 N-cm**

STEP 2. ATTACH FACEPLATE

- REMOVE PSA LINER FROM BACK OF FACEPLATE(3)
- USING ALIGNMENT FEATURES PRESS FACEPLATE(3) ON TO FRONT OF PHONE TO ADHERE

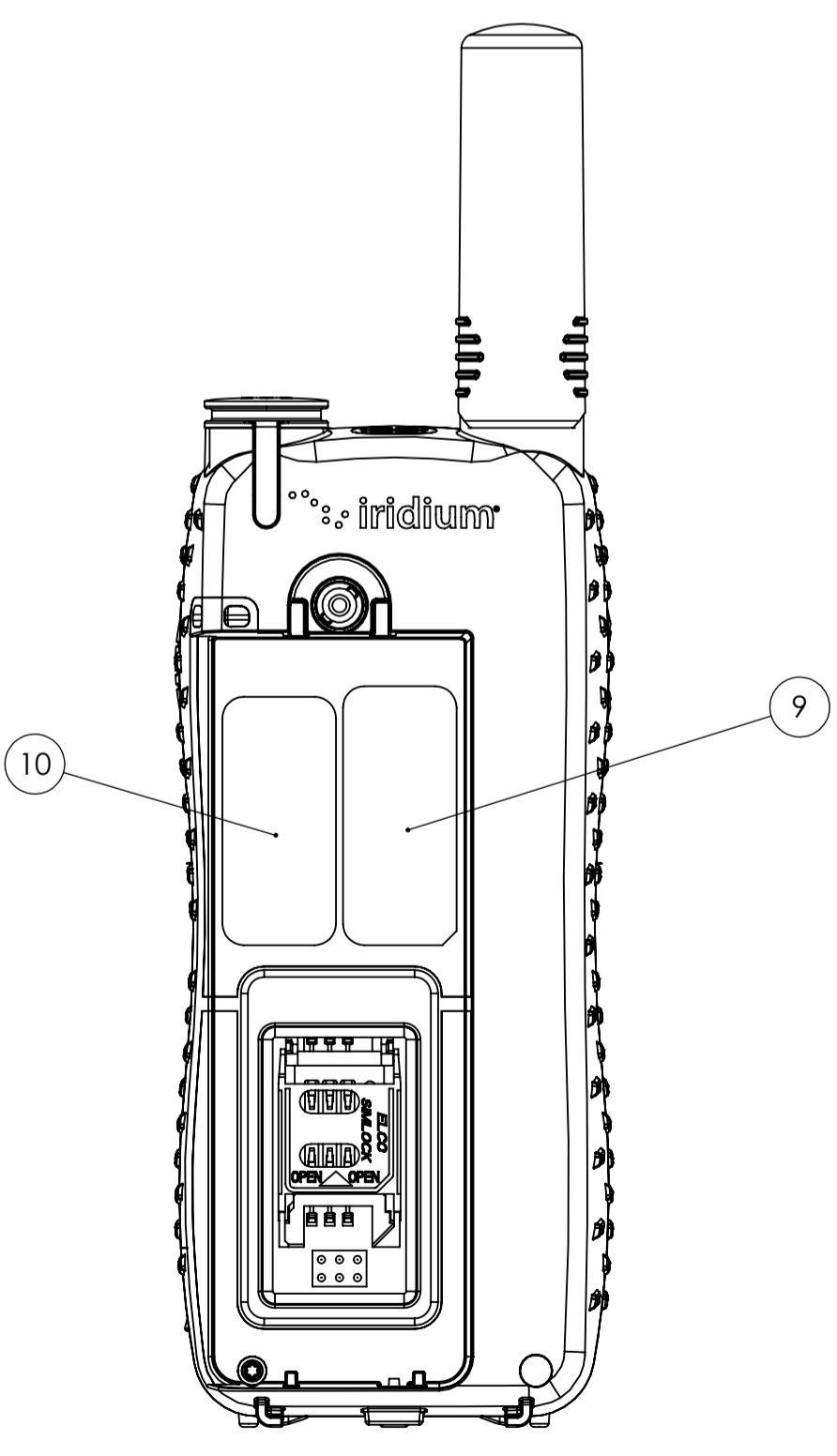

STEP 3. APPLY IMEI AND REGULATORY LABELS

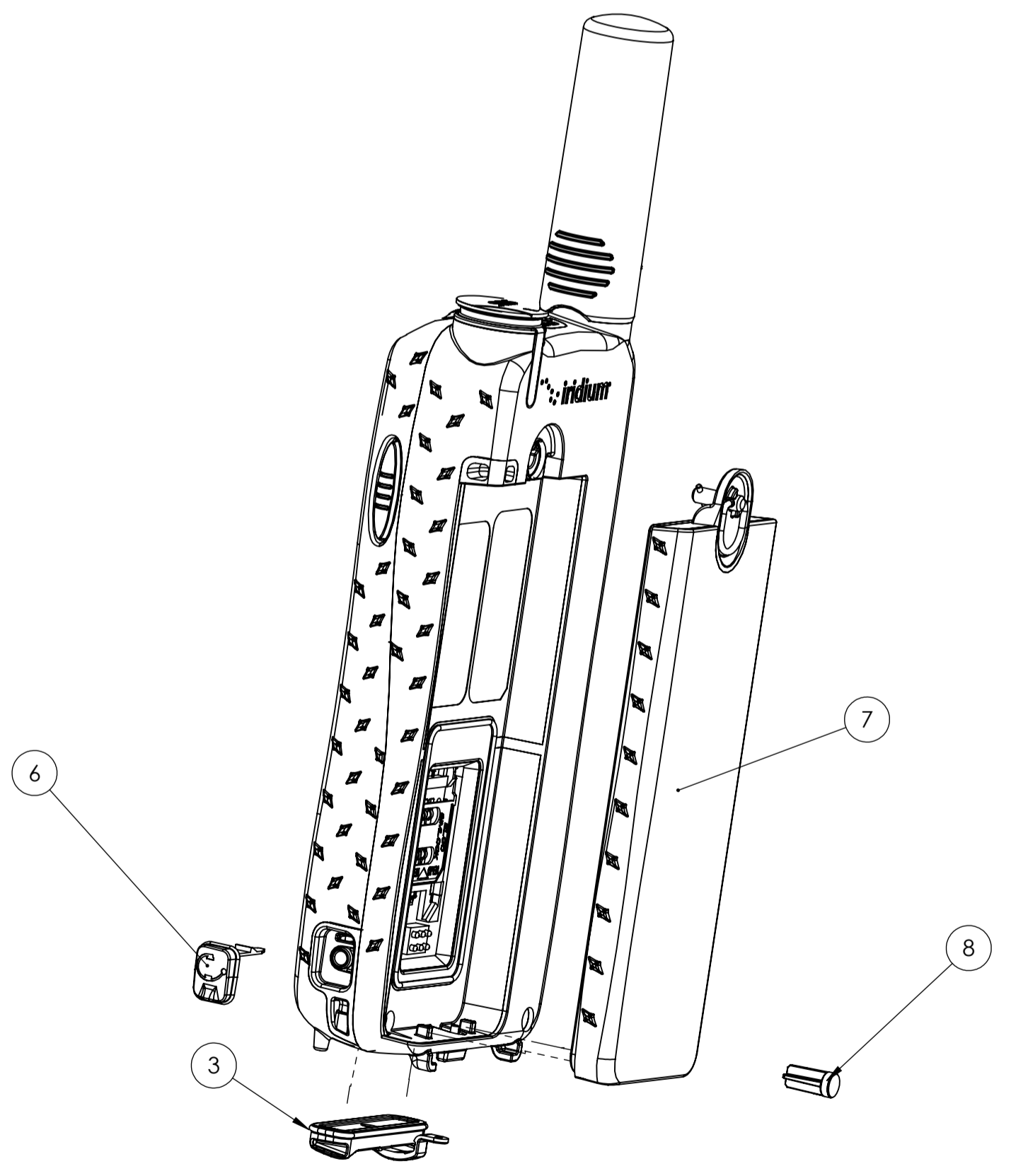

STEP 4. ATTACH BATTERY AND SYSTEM CONNECTOR PLUG

- INSTALL O-RING(6) IN GROOVE AROUND PLUG(4)
- INSERT PLUG INTO SYSTEM CONNECTOR PORT
- INSERT TETHER INTO BATTERY CAVITY OVER POST
- INSERT LOWER END OF BATTERY(7) INTO BACK OF PHONE TO ENGAGE HOOK FEATURES
- ROTATE UPPER END OF THE BATTERY INTO BACK OF PHONE AND SECURE WITH ATTACHED 1/4 TURN FASTENER

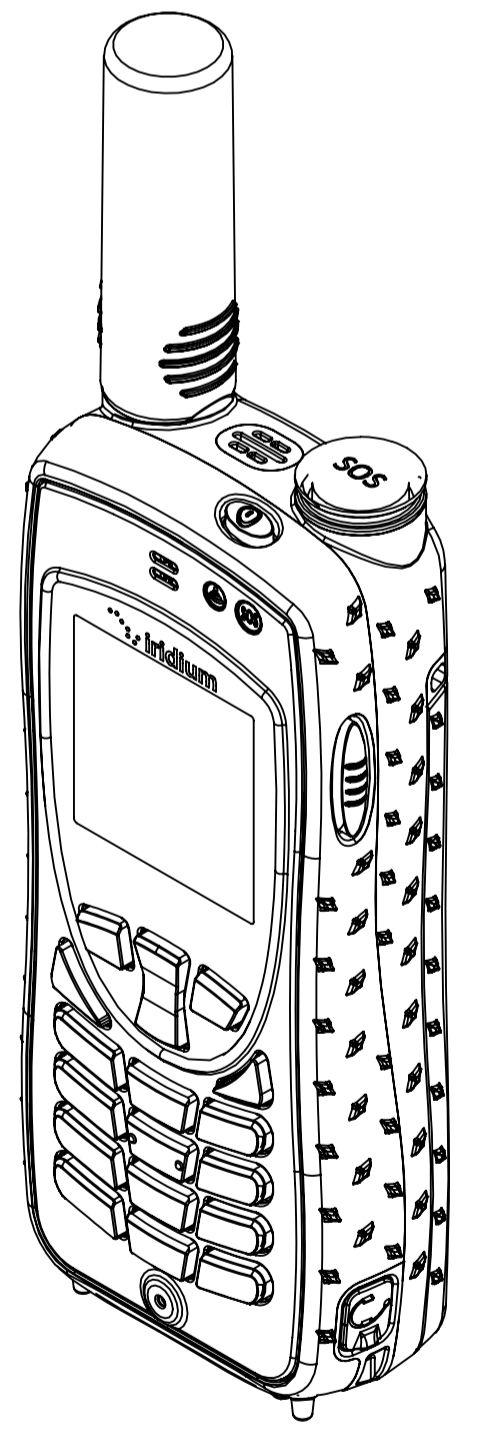

<small>PROPRIETARY AND CONFIDENTIAL</small> <small>THE INFORMATION CONTAINED IN THIS DRAWING IS THE SOLE PROPERTY OF PORTICOS, INC. ANY REPRODUCTION IN PART OR AS A WHOLE WITHOUT THE WRITTEN PERMISSION OF PORTICOS, INC. IS PROHIBITED.</small> 	MATERIAL	N/A				
	THIRD ANGLE PROJECTION		DESCRIPTION			
	TOLERANCES: UNLESS OTHERWISE SPECIFIED	LINEAR DIMENSIONS ± 0.15	ANGULAR DIMENSIONS ± 2°	HOLE TO HOLE ± 0.10	HANDSET ASSEMBLY	
		GEOMETRIC TOLERANCING PER ASME Y14.5m-1994	SCALE 1:1	REVISION D	UNITS mm	SIZE A1
				DOCUMENT NUMBER D-HST001 D	DRAWN BY C.LAIDLAW	
				3D REFERENCE A-HST001 C	ISSUE DATE 7/7/2011	
					SHEET 1 of 1	