

## RADIO OVERVIEW

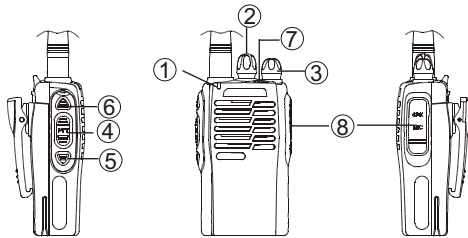

- ① **LED Indicator**  
Lights red while transmitting; lights green while receiving a signal. Flashes red while in low battery power.
- ② **Channel Selector**  
Rotate to select channel 1-16.
- ③ **Power/Volume Switch**  
Turn clockwise to switch on the radio.  
Turn counterclockwise till a click is heard to switch off the radio.  
Rotate it to adjust the volume after turning on the radio.
- ④ **PTT (Push-to-talk)**  
To make a call, press and hold the PTT button, then speak into the microphone in normal voice.  
Release the PTT button to receive a call.
- ⑤ **Monitor Button**  
Press to disable the SQUELCH, and enable the SQUELCH again.
- ⑥ **Channel Annunciation Button**  
Press it in standby state, and the channel number will be annunciated. If press and hold this button, and at the same time switch on the radio again, the type of voice annunciation of

channel number will be changed.

- ⑦ **Emergency Button**  
Press and hold this button for over 2 seconds to activate warning tone. Press it again to exit the emergency alert state.  
**Note:**  
When warning tone sounds, all of the buttons are disabled.
- ⑧ **Microphone/Speaker Jacks**  
For connecting external Microphone/Speaker.

## BASIC OPERATION

### Switch On



Switch on the radio by turning the Power/Volume switch clockwise till a click is heard, then the radio will be in the state of stand by and you will hear a beep if the dealer has set it. And then you will hear voice annunciation of the current channel number.

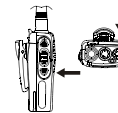

### Adjust Volume

Press the monitor button to listen to the background noise and rotate the Power/Volume switch to adjust volume.

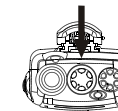

### Select Channels

Rotate the channel selector to select channels. You will hear voice from the speaker while receiving proper signals. If voice annunciation of channel number has been set, the radio will annunciate the current channel number.

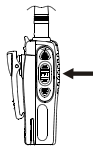

#### Make a Call

To make a call, select the desired channel, press and hold the PTT button, and speak in normal voice. Please keep your mouth 3~8 cm away from the microphone.

#### Receive a Call

Release the PTT button to receive a call. Select the desired channel, adjust the volume to a proper level, and then you can receive others' voice.

## ■ SCAN FUNCTION

(Your local dealer may prohibit this function.)

Only when there are no less than two channels added in the scan list and the scan function has been activated, the radio can start scanning.

#### ● STARTING SCAN

When switching to channel 16, the radio will begin to scan, and pause after receiving signals.

#### ● STOPPING SCAN

When switching to channel 1-15, the radio will stop scanning.

Introduction:

1. Dealer can set the following two ways to restart scanning after its pause:

1) Time-control

The radio will restart scanning after pausing for some time while

receiving signals. The pausing time can be preset from 0.5 to 5 seconds.

2) Carrier wave control

The radio will pause scanning after receiving signals and will restart scanning 3 seconds after the signal disappears.

2. The working channel of the radio will respond to the following channels automatically when pressing PTT button during scanning. The dealer can select one among the following six ways.

1) Last called

When pressing PTT button, the radio will transmit from the last channel that received a call.

2) Last used + currently working channel

When pressing PTT button during the scanning, the radio will transmit from the last channel that received a call. When pressing PTT button during the scanning pause, the radio will transmit from the currently working channel.

3) Selected channel

When pressing PTT button, the radio will transmit from the first channel of the scanning list.

4) Selected channel + currently working channel

When pressing PTT button during scanning, the radio will always transmit from the first channel in the scanning list. When pressing PTT button during the scanning pause, the radio will always transmit from the currently working channel.

5) Priority channel

The radio will transmit signals from the priority channel in the scan list when pressing PTT button.

6) Priority channel + currently working channel

When pressing PTT button during scanning, the radio will always transmit from the priority channel. When pressing PTT button during

the scanning pause, the radio will transmit from the currently working channel.

**Note:**

\* Currently working channel means the channel in which the radio holds on under the following four conditions.

- 1) After receiving the signals, the radio will still stay in the current channel before restarting the scan.
- 2) When receiving signals during scanning, the radio will pause on the current channel and will keep staying on it for 3 seconds after the signals disappear.
- 3) Radio will stay on the current channel when pressing PTT during scanning.
- 4) When the radio transmitting ends by releasing PTT button, within the transmitting pause time preset by the local dealer, the radio will stay in the current channel.

\* Selected channel: The first channel in the scanning list set by the dealer.

\* Priority channel: The prior channel in the scanning list set by the dealer.

\* Only when priority channel has been selected, the options of priority channel and priority channel + currently working channel in Revert Channel are available.

## ■ AUXILIARY FUNCTIONS

### ● TIME-OUT TIMER

Time-out timer can prevent the user from continuously talking overlong and prevent the radio body heating due to continuous longtime transmitting.

If you continuously transmit longer than the time limit preset by the dealer, the radio will stop transmitting and warning tone sounds, and to stop the warning tone please release the PTT button. Pressing the PTT button again will resume transmitting.

### ● BATTERY SAVING

The automatic battery saving function decreases the power consumption when no signal is received and no operation is conducted.

If the battery saving function is activated, 10 seconds after the radio doesn't receive any signals or no operation is being conducted, the radio enters battery saving mode. When a signal is received or any operation occurs, it exits battery saving mode automatically.

### ● LOW BATTERY WARNING

When the battery power goes below a certain value in transmitting, LED flashes red and Low battery warning tone sounds and then the radio stop transmitting. You need to recharge or change the battery.

### ● MONITOR

**Off:** When this function is selected, no operation is performed.

**Monitor Momentary:** Press and hold the monitor button to deactivate the signaling temporarily, and squelch un-mutes. Release it to return to normal operation and squelch mutes.

**Monitor Lock:** Press the monitor button once to deactivate the signaling, and squelch un-mutes. Press it again to return to normal operation and squelch mutes.

**SQ Off:** When there is no signal received, the squelch circuit of the radio will automatically mute the speaker, so you will not hear the background noise. Press the MONI key to force the squelch un-mute.

#### ● CTCSS/DCS

CTCSS/DCS tones may have been pre-programmed on some channels. A CTCSS/DCS tone is a sub-audible tone, which allows you to ignore (not hear) calls from other parties who are using the same channel. The dealer can set CTCSS/DCS tones on radio channels.

When you receive a signal that has a tone different from the one set on your radio, you will not hear the signal. Likewise, signals that you transmit will only be received by the parties whose CTCSS/DCS tones are the same as yours.

#### **Note:**

Using a CTCSS/DCS channel doesn't mean your calls are private. If other parties' CTCSS/DCS tones are identical with yours, they can hear your calls.

#### ● Voice Annunciation of Current Channel Number

If voice annunciation of current channel number has been activated, when pressing the channel annunciation button in stand-by mode, the current channel number will be annunciated in the preset language through the loudspeaker. If turn on the radio with this button pressed, the annunciation language will be changed. Repeat turning on the power with this button pressed, the type of the annunciation language can be changed in sequence “ Chinese Male---English Male---Chinese Female---English Female---No Annunciation” .

#### ● Wired Clone

If wire clone function has been activated, after entering wire clone mode, the radio will not exit the wire clone mode automatically. You have to turn on the radio again to enter the user mode. The operating procedure is as follows:

- 1) Press MONI key to turn on the radio. About two seconds later the red light flashes twice and two beeps sound, and then the radio enters the wire clone mode.
- 2) Press PTT button, and slave radio that is to be sent with cloning data will be in the Open/Prohibition wire clone mode. However, the wire clone setting on the master radio will not change. Press PTT button. If the green light flashes twice and one beep sounds it is in the Open state; if the red light flashes twice and two beeps sound it is in the Prohibition state. When entering wire clone mode, the default setting on the slave cloned radio is wire clone prohibition.
- 3) Press MONI key, the red light flashes and cloning begins. When cloning is finished, red light turns dim.

#### **Note:**

To activate Open/Prohibition Wire Clone mode, short circuit the two points of SELF to switch on the current and enter model setting mode, the manually adjustment and wire clone functions are activated automatically; then to prohibit wire clone function, press MONI key. You can also open or prohibit the wire clone mode by PC programming software.

Once the wire clone function is prohibited, the radio cannot enter wire clone mode. Wire clone prohibition is set as the default when the radio leaves factory.

- **Emergency Alert**

Press the emergency button for more than 2 seconds, and then the radio enters the state of emergency alert: red light flashes, and loud warning tone sounds.

Press the emergency button again to exit the emergency state. In emergency state, any other keys or buttons are inactive.

## ■ TROUBLE SHOOTING GUIDE

NO.	PROBLEM	SOLUTION
1	The radio cannot be switched on or no display after being switched on.	<ul style="list-style-type: none"> <li>● Battery power may be insufficient. Recharge or replace the battery pack.</li> <li>● Battery pack may not be installed properly. Remove the battery pack and install it again.</li> </ul>
2	The battery power consumes quickly after charging.	<ul style="list-style-type: none"> <li>● The battery life is finished; please replace it with a new battery pack.</li> </ul>
3	Cannot talk to or hear other group members .	<ul style="list-style-type: none"> <li>● Make sure the CTCSS/DCS tone is the same as that of your group members.</li> <li>● Out of the effective communication range.</li> </ul>
4	Other voices from non-group members are heard on the Channel.	<ul style="list-style-type: none"> <li>● Change the CTCSS/DCS tone, and make sure to change the tone of all radios in your group.</li> </ul>
5	Communication range is too short.	<ul style="list-style-type: none"> <li>● Make sure the antenna is well connected.</li> <li>● Make sure the antenna is the original one.</li> <li>● Check if the battery power is in normal state.</li> <li>● Ask your local dealer to adjust the squelch level.</li> </ul>

## ■ SETTINGS (set by the dealer)

Model: \_\_\_\_\_

Serial No.: \_\_\_\_\_

### 1) Channels List

CHANNEL	TRANSMITTING FREQUENCY	RECEIVING FREQUENCY	CTCSS/DCS
1			
2			
3			
4			
5			
6			
7			
8			
9			
10			
11			
12			
13			
14			
15			
16			

### 2) The way to restart scanning after its pause:

- Time control
- Carrier wave control

### 3) The way to revert the working channel:

- Selected channel
- Selected channel or currently working channel
- Priority channel
- Priority channel or currently working channel

### 4) Squelch monitor:

- Open
- Close

### 5) Time-out timer:

- Open
- Close

### 6) Automatic scan:

- Open
- Close

## ■ User Safety, Training, and General Information

- READ THIS IMPORTANT INFORMATION ON SAFE AND EFFICIENT OPERATION

BEFORE USING YOUR KIRISUN PORTABLE TWO-WAY RADIO.

### RF Exposure, Operational Instructions and Training Guidelines

To ensure optimal performance and compliance with the occupational/controlled environment RF energy exposure limits in the above standards and guidelines, users should transmit no more than 50% of the time and always adhere to the following procedures:

#### Transmit and Receive

To transmit (talk), push the Push-To-Talk (PTT) button; to receive, release the PTT button.

#### Hand-held radio operation

Hold the radio in a vertical position with the microphone one to two inches (2.5 to 5 cm) away from the lips.

### FCC Compliance

This equipment has been tested and found to comply with the limits for a Class B digital device, pursuant to part 90 of the FCC Rules. These limits are designed to provide reasonable protection against harmful interference in a residential installation. This equipment generates, uses and can radiate radio frequency energy and, if not installed and used in accordance with the instructions, may cause harmful interference to radio communications. However, there is no guarantee that interference will not occur in a particular installation. If this equipment does cause harmful interference to radio or television reception, which can be determined by turning the equipment off and on, the user is encouraged to try to correct the interference by one or more of the following measures:

- Reorient or relocate the receiving antenna.
- Increase the separation between the equipment and receiver.
- Connect the equipment into an outlet on a circuit different from that to which the receiver is connected.
- Consult the dealer or an experienced radio/TV technician for help.

Modifications not authorized by the manufacturer may void users authority to operate this device.

### FCC Licensing Requirements

Your radio must be properly licensed Federal Communications Commission prior to use. Your dealer can assist you in meeting these requirements. Your dealer will program each radio with your authorized frequencies, signaling codes, etc., and will be there to meet your communications needs as your system expands.

#### Safety:

It is important that the operator is aware of and understands hazards common to the operation of any radio.

READ THIS IMPORTANT INFORMATION ON SAFE AND EFFICIENT OPERATION