



User Quick Guide

Kirisun Communication Co.,Ltd.



Kirisun Communication Co.,Ltd.
www.kirisun.com



1. Safety Precaution

Government decrees prohibit the operation of radio transmitters in government areas without permission.

Illegal operation will be punished by fine or arrest. This machine can only be repaired by professional technicians.

Safety Note: It is very important that the user understand the potential danger of using a radio transmitter.

Warning: Please turn off the device in explosive environment (gas, dust, smoke, etc.), for example, when filling the motor vehicle or parking at the gas station.

2. Starting to Use

2.1 Unpacking

Please open the packing box carefully and confirm whether it contains the items listed in the table below. If you find this product and its accessories missing or damaged, please contact your dealer immediately.

Attachments

No.	Item	QTY
1	Repeater	1
2	Battery	1
3	Antenna	1
4	Hand Microphone	1
5	Charger	1
6	AC Power Cord	1
7	User Quick Guide	1

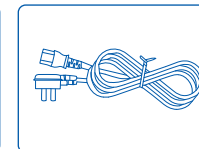
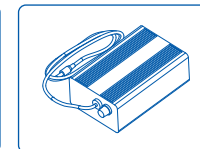
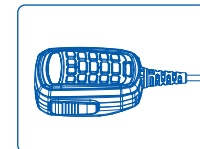
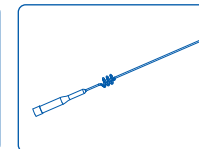
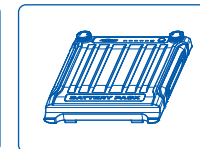

2.2 Preparation

About the Battery

The device is delivered uncharged. Before using the device for the first time, please charge the battery. If the battery is not used for a long time or run out, please charge it before using it again. It is necessary to charge and discharge the battery for two or three times to attain the best performance of it. When you see a warning of low voltage on the device, please charge or replace the battery.

Note:

- ◆ Do not short out battery terminals or discard the battery in fire.
- ◆ When charging the battery installed on the device, please power off the device so that the battery can be charged fully.
- ◆ Please take the device and battery out of the charger when not charging the battery. Continuous charging will shorten battery life.
- ◆ Stop charging the battery if it is fully charged, otherwise its cycles of charging and discharging will be reduced.
- ◆ Try to keep the battery indoors under a temperature of about 25°C. The battery is liable to fail after being kept in a low temperature of below -10°C for a long time.

Under a temperature above 35°C or below -10°C, the discharge capacity of the battery might reduce. This is decided by the physical characteristics of lithium battery.

Battery Level Detection

Press the power detection key for a short time, the power indicator will be on, and 1 to 4 green indicators indicate the power from low to high. When red light is on, it indicates that the power is too low. Please charge in time.

Charging the Battery

- (1) Connect the AC power cord with the charger, and plug the AC power cord plug into the AC power outlet as required.
- (2) Open the "waterproof rubber plug of charging jack" on the top of the battery, and insert the charging plug of the charger into the charging jack on the top of the battery to charge the battery.
- (3) When the battery is not connected, one is red power light and the other is white status indicator. When connected to the battery (i.e. when charging), the two lights are red.
- (4) After charging for about 5 hours, the white status indicator turns green, indicating that the battery is fully charged.

(5) When the status indicator is green, keep charging for about one hour to achieve the best performance of the battery.

Installing the Battery

Align the two hooks at the bottom of the battery back with the corresponding notches at the bottom of the host, and push the battery up obliquely. When the groove around the battery contact is aligned with the convex rib around the host spring pin, compress the battery and the host, and then tighten the two battery locking screws clockwise.

Uninstalling the Battery

If you need to remove the battery, please turn off the host first.

(1) Unscrew the two battery locking screws anticlockwise.

(2) Slightly disconnect the upper part of the battery and push the battery down obliquely. After the two hooks at the bottom of the battery are separated from the host, the battery can be removed.

Connecting the Antenna

Insert the antenna into the antenna connector on the top of the host and rotate the fixed antenna clockwise.

Installing the Hand Microphone

To install the hand microphone, plug the hand microphone (with the direction sign up) into the corresponding interface of the device, and rotate clockwise the cover lock on the plug. When the lock contacts the slot on the device, press it a bit and continue to rotate it until it is tightened.

To uninstall the hand microphone, rotate clockwise the cover lock on the plug to the greatest extent, and then pull out the plug.

3. External View

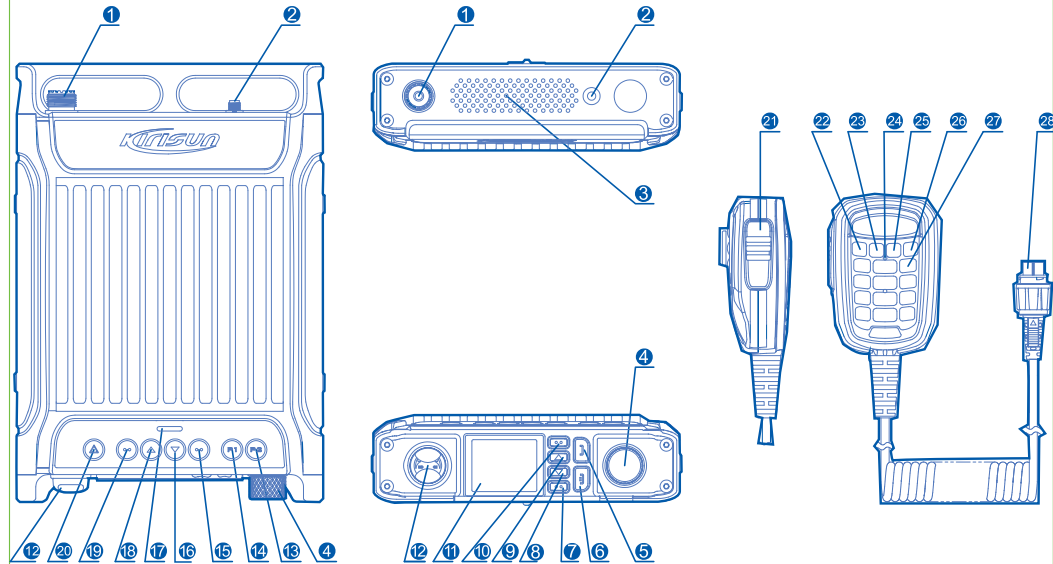

No.	Item	No.	Item
1	Antenna interface	15	Back key
2	GPS antenna interface	16	Down key
3	Speaker	17	LED Indicator
4	Power switch	18	Up key
5	Dial key	19	Menu/OK key
6	On-Hook Key	20	Emergency key
7	Back key (Programmable key P4)	21	PTT key
8	Down key (Programmable key P3)	22	Menu/OK key
9	Up key (Programmable key P2)	23	Up key
10	Menu/OK key (Programmable key P1)	24	Microphone
11	Display screen	25	Down key
12	Programming interface	26	Back key
13	Volume - key	27	Numeric key
14	Volume + key	28	Connector

3.1. Programmable Keys

To cater to your preference, the programmable keys P1, P2 and P3 can be set as shortcut keys through programming by your dealer.

Press: Press down a key and release quickly.

Press and hold: Press down a key and hold for the duration programmed before release. (The duration can be set in programming settings.)

No.	Function	Description
1	Void	No function. The error alert will be heard when the key is pressed.
2	High/Low Power	Switch between high and low power.
3	Monitor	If signaling is transmitted through the current analogue channel, press the key to switch to carrier squelch mode (i.e. cancel signaling). Voice is output when the carrier is matched. Press the key again to go back to the previous state.

4	Squelch On/Off	Enable/disable squelch. It can be used to receive weak signals in an analogue channel.
5	Squelch Level	Adjust signal strength required to receive signals.
6	Scan	Enable/disable scanning. It is used to monitor the communication activities in other channels.
7	LCD Brightness	Press the key to go to the Screen Brightness interface, and adjust the brightness by pressing the Up/Down key.
8	LCD Backlight Type	Press the key to go the Screen Backlight interface, and adjust the backlight duration.
9	Repeater/Talkaround	On a channel allowing relay, enable repeater or talkaround mode.
10	Zone Selection	Press the key to switch to another zone.
11	Home Page	Press the key to return to the home page.

12	Nuisance Delete	Press the key to temporarily remove an unwanted channel, except the selected channel, from the scan list.
13	Scramble/Encrypt	On a channel allowing this function, press the key to enable/disable encryption.
14	Contact	Press the key to go to the Contact interface.
15	Message	Press the key to go to the Message interface.
16	Call Log	Press the key to go to the Call Log interface.
17	Channel Monitoring	Press this key to enable/disable channel monitoring. The function will be disabled if you press the PTT key.
18	Permanent Channel Monitoring	Press this key to enable/disable permanent channel monitoring. This function will not be disabled if you press the PTT key.
19	Tx Interrupt	Press the key to interrupt calls on the current channel, so that the channel will be idle.
20	Public Address 1	Press the key to switch between normal state and audio amplification state. Voice is output through the pin 1 of the rear connector to the audio

		port of a terminal.
21	Public Address 2	Press the key to switch between normal state and audio amplification state. Voice is output through the pin 2 of the rear connector to the audio port of a terminal.
22	External Alarm/Speaker/Lamp	When the device receives an emergency alarm, a call alert or an individual call and no operation is performed during the programmed time, the GPIO interface will output valid level to trigger an alarm on the external alarm device (for example, a speaker or a lamp) connected to the interface.
23	Volume Up	Press the key to turn up the volume.
24	Volume Down	Press the key to turn down the volume.

4. Using the Repeater

4.1 Powering On/Off

In the shutdown state, turn the power switch clockwise to turn on the power of the host, the LCD screen displays the startup screen, the backlight automatically turns on, and the machine sends the startup prompt tone.

In the power on state, turn the power switch anticlockwise to turn off the power of the host.

4.2 Selecting a Zone

An area is a channel group. The device supports a maximum of 248 areas, with a maximum of 128 channels per area.

Follow the procedure below to select an area.

Press the menu key  in the standby interface to go to the menu.

Select an area by pressing the up key  or down key , and then press the OK key .

Displays all areas and indicates the current area.

Press the up key  or down key  to the desired area, and then press the OK key .

The screen prompts "operation succeeded" and then returns to the selected area screen.

4.3 Selecting a Channel

In the standby interface, switch the channel by pressing the up key  or down key .

4.4 Adjusting the Volume

Configure the programmable keys P1 and P2 as volume adjustment keys.

4.5 Single-Frequency Transfer

The single frequency transfer mode can be configured in the channel write frequency.

4.5.1 Configuration Method

Select digital channel in frequency writing software;

Select the channel to be configured for single frequency transfer, and click the ">>" icon at the far right;

Check "single-frequency transfer" in the pop-up channel configuration dialog box.

4.5.2 Using

Directly switch to the channel configured with single-frequency transfer mode.

Note:

The single-frequency transfer channel does not support sending and receiving calls but single-frequency transfer, and works in digital conventional mode.

4.6 Initiating a Call

You can initiate a call by one of the following ways. When the call is initiated, the LED red light will be on and the

LCD will display the call type icon ( indicating individual call,  indicating group call), alias or ID, and

the outgoing call icon .

Make a call to the default contact

If the repeater is preset with a corresponding default contact in each channel, you can press the PTT key to directly send a call to the default contact.

Select a contact and make a call

Enter the "contact" menu, select the "contact list" menu, select other contacts, and press the PTT key to initiate the call.

Dial manually and make a call

Enter the "contact" menu, select the "manual dialing" menu, enter the manual dialing interface, directly enter the ID number of the other party, and press the PTT key to initiate the call.

4.7 Receiving/Reply to a Call

When the interphone receives the call, it will automatically switch to the receiving state. When receiving a call,

the LED is green, and the LCD displays the call type icon ( indicating individual call and  group

call), alias or ID, and incoming call icon , and play the received voice. When waiting for other users to stop calling, you can immediately press PTT to call back the current contact within the call suspension time.

Note:

In order to receive group calls from other users, the device must be set as a member of the group (set through the frequency writing software).

5. Indication
5.1 LCD Indication

Icon Name	Icon	Device State
SSID		No signal
		Number of bars indicates the strength of received signals.
Short Message		Unread message in the inbox.
		Inbox is full. The icon flashes.
		State message received.
Scramble/Encrypt		Analog scrambling or digital encryption is enabled.
Mute		You can adjust the volume to 0 to mute the speaker.
Tx Power		High power
		Low power
Channel Monitoring		Channel is being monitored.
Talkaround		Operate in direct mode.
Emergency Alarm		Operate in emergency alarm mode

GPS		GPS positioning succeeded, and data being received.
		Searching for signals, but cannot receive data.
Scan		The icon rotates during scanning.
		Scanning dwells on the priority channel 1 or 2.
		Scanning dwells on a common channel.
Accessory		An external microphone or speaker is connected.
		The USB port is connected.
Lone Worker		Lone worker function is enabled.

5.2 LED Indicator

Indicator State	Device State
Red light glows	Transmission, upgrade or programming is in progress.
Green light glows	Receiving signals (speech message, text message and data) or it detected activity on the channel.
Orange light glows	In call hang time (in digital mode) or auto reset time (in analogue mode).
Orange light flashes	In emergency state, or missed call alert received, or scanning in progress.

Red light flashes	Receiving emergency alarm, or startup self-detection failed.
Green light flashes	Single-frequency transfer channel in standby state.
Green and red light flashes alternately	Transfer in progress.

6. Maintenance

In order to ensure the good performance of the device and extend its service life, please be familiar with the following contents, so as to better carry out daily maintenance and cleaning of this product.

1. Maintenance

Do not puncture or scratch the device with hard objects.

Please ensure that the device is in a position with good ventilation conditions and heat dissipation, so that all components can work normally.

Do not place irrelevant items near the device so as to ensure effective heat dissipation.

Do not immerse the device in corrosive, solution or water.

2. Cleaning

Please clean the device regularly. Use clean and dry lint free cloth or small brush to wipe off the dust on the device, so as to keep the device clean and prevent poor contact. If the keys, screen and interfaces of the device are dirty, clean them with non-woven fabric after applying neutral detergent to it. Do not use strong corrosive chemicals such as detergents, alcohol, sprays or petroleum preparations. After cleaning, make sure the device is completely dry before using it again.

Note:

Please turn off the power of this device before you clean it.

NOTE :

NOTE :

FCC Warning:

Any Changes or modifications not expressly approved by the party responsible for compliance could void the user's authority to operate the equipment.

This device complies with part 15 of the FCC Rules. Operation is subject to the following two conditions:

- (1) This device may not cause harmful interference, and
- (2) this device must accept any interference received, including interference that may cause undesired operation.

Note: This equipment has been tested and found to comply with the limits for a Class B digital device, pursuant to part 15 of the FCC Rules. These limits are designed to provide reasonable protection against harmful interference in a residential installation. This equipment generates, uses and can radiate radio frequency energy and, if not installed and used in accordance with the instructions, may cause harmful interference to radio communications. However, there is no guarantee that interference will not occur in a particular installation. If this equipment does cause harmful interference to radio or television reception, which can be determined by turning the equipment off and on, the user is encouraged to try to correct the interference by one or more of the following measures:

- Reorient or relocate the receiving antenna.
- Increase the separation between the equipment and receiver.
- Connect the equipment into an outlet on a circuit different from that to which the receiver is connected.
- Consult the dealer or an experienced radio/TV technician for help.

ISED Warning

This product meets the applicable Industry Canada technical specifications. / Le présent matériel est conforme aux spécifications techniques applicable d'Industrie Canada.

This equipment complies with FCC/ ISED radiation exposure limits set forth for an controlled environment. This equipment should be installed and operated with minimum distance 50cm between the radiator& your body.

This transmitter must not be co-located or operating in conjunction with any other antenna or transmitter.

L'appareil est conforme aux limites d'exposition aux rayonnements spécifiées par la FCC / isedc pour les environnements contrôlés. La distance entre le radiateur et le corps doit être d'au moins 50 cm lors de l'installation et du fonctionnement de l'appareil. Cet émetteur ne doit pas coexister ou fonctionner conjointement avec toute autre antenne ou émetteur.