

VOLVO is the registered trademark of Volvo Trademark Holding AB and is used under license to New-Ray Toys Development Ltd.

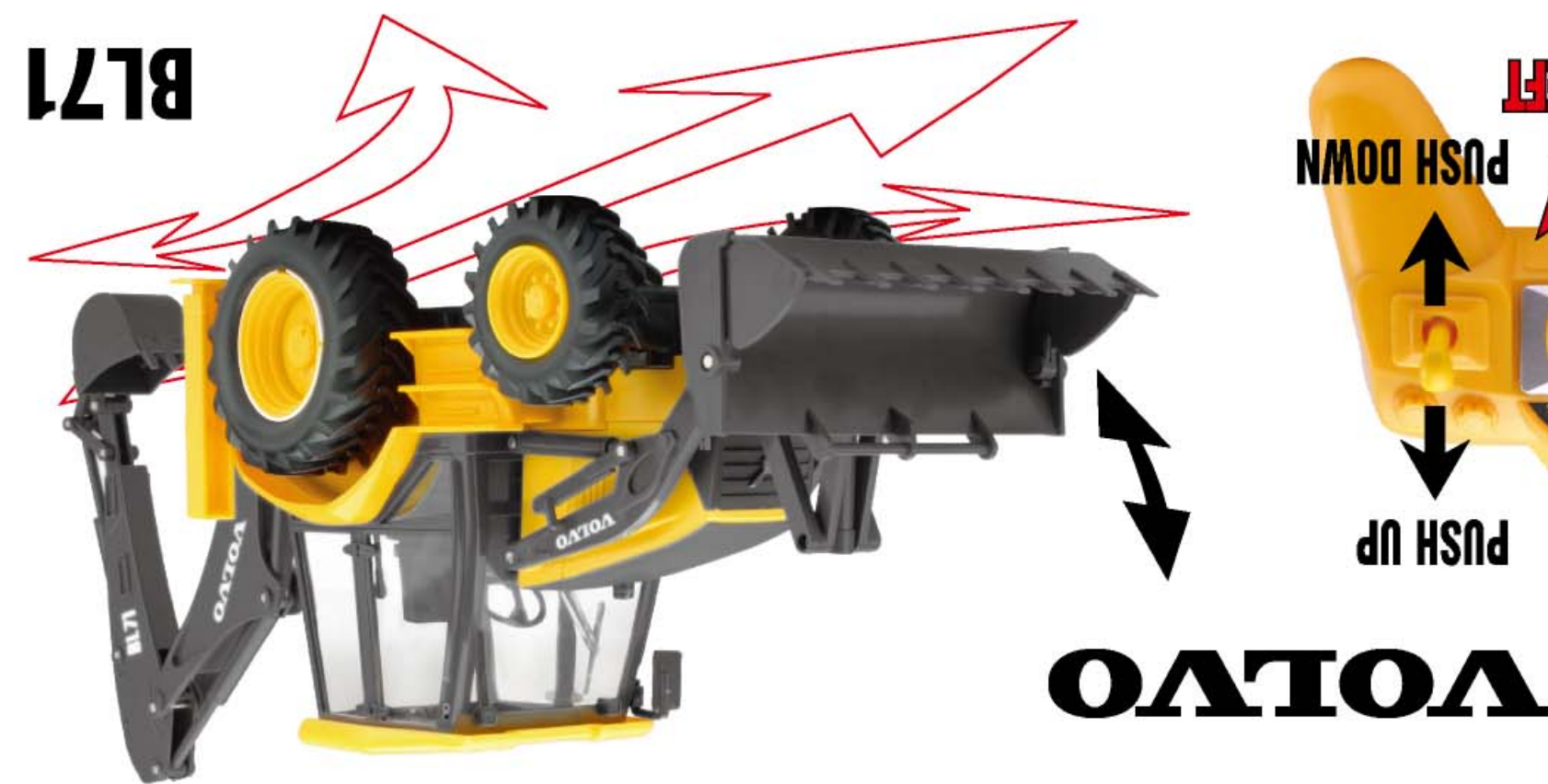

**VOLVO**

VOLVO is the registered trademark of Volvo Trademark Holding AB and is used under license to New-Ray Toys Development Ltd.

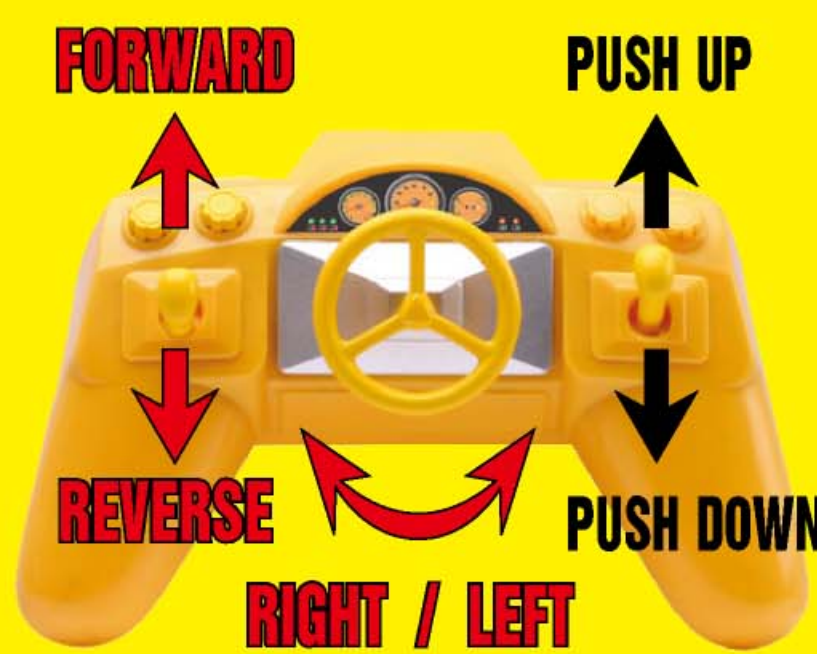

**R / C**



**R / C**



**VOLVO**

VOLVO is the registered trademark of Volvo Trademark Holding AB and is used under license to New-Ray Toys Development Ltd.

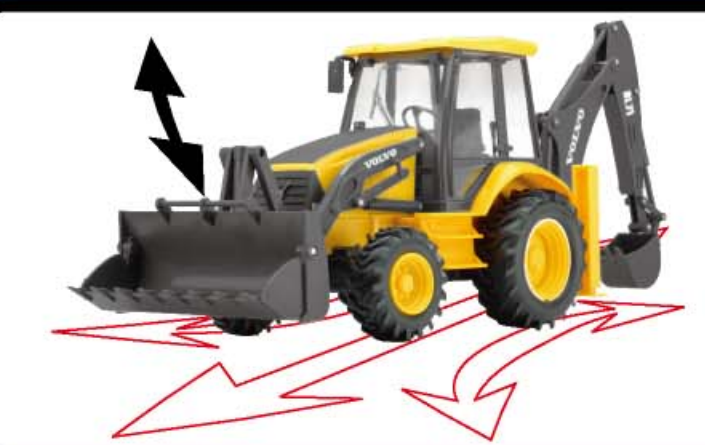

**R / C**

**BL71**

**WARNING:** CHOKING HAZARD—small parts. Not for children under 3 years.  
**ATTENTION:** Risque de suffocation si avalé, contient de petites pièces détachables, non adapté aux enfants de moins de 3 ans.



**1:18 SCALE**



**R / C**

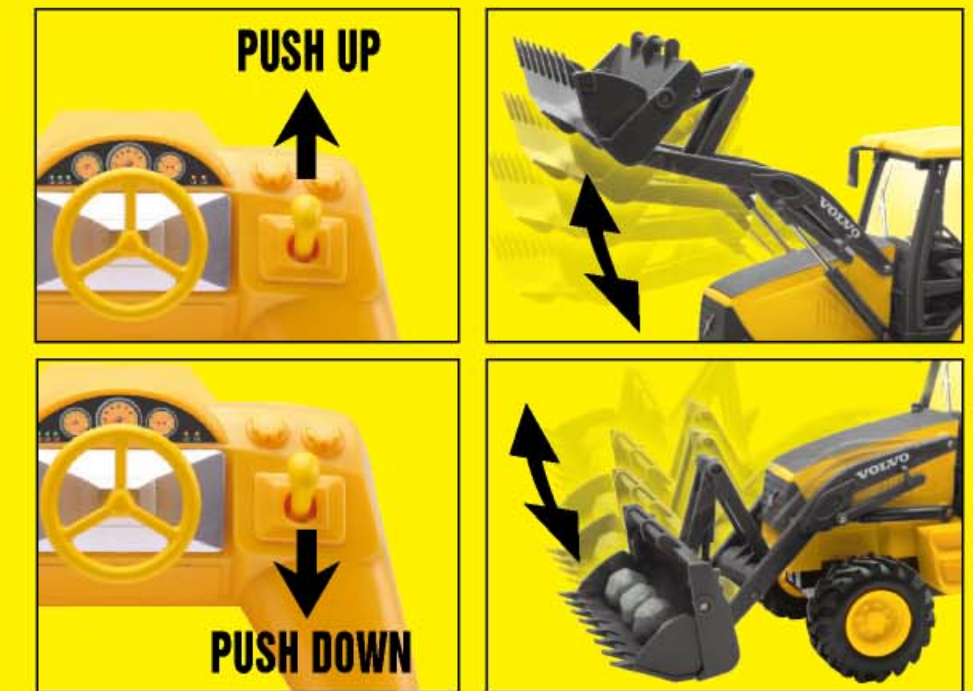

**27MHz**

**VOLVO**

VOLVO is the registered trademark of Volvo Trademark Holding AB and is used under license to New-Ray Toys Development Ltd.

- (W) WARNING! NOT SUITABLE FOR CHILDREN UNDER 3 YEARS OLD DUE TO SMALL SIZE OF COMPONENTS.
- (A) ATTENTION! NE CONVIENT PAS A UN ENFANT DE MOINS DE 36 MOIS. PRESENCE DE PETITS ELEMENTS DETACHABLES POUVANT ETRE AVALES.
- (NL) AWAARSCHUWING! NIET GESCHIKT VOOR KINDEREN ONDER DE 3 JAAR WEGENS KLEINE ONDERDELEN.
- (D) NICHT EIGENDELIJK VOOR KINDEREN ONDER 3 JAAREN GEEGNET WEGEN KLEINER VERSCHLUCKBAARER BESTANDDELE.
- (E) ADVERTENCIA! NO RECOMENDADO PARA NIÑOS MENORES DE 3 AÑOS DEBIDO A LOS COMPONENTES DE PEQUEÑO TAMAÑO.
- (PT) AVISO! NÃO RECOMENDAVEL A CRIANÇAS COM MENOS DE 3 ANOS DEVIDO AO TAMANHO PEQUENO DOS COMPONENTES.
- (RU) АДВАРЕЛ! НЕ АДЕСАЕТ ТИЛ БЕРН УНДЕР ТРЕ АР ПА ГРУНД ВУ КОМПОНЕНТЕРЕНЕ ЛУЛЕ ДУВЕКЕНЕ.
- (C) THE PACKAGING HAS TO BE KEPT SINCE IT CONTAINS IMPORTANT INFORMATION.
- (F) GARDER L'EMBALLAGE CAR IL CONTIENT D'IMPORTANTES INFORMATIONS.
- (A) CONSERVARE LA CONFEZIONE PER FUTURE REFERENZE.
- (NL) BEWAAR DE VERPAKKING, WANT ZE BEVAT BELANGRIJKE INFORMATIE.
- (D) DIE VERPAKKUNG SOLLTE AUFBEWAHRT WERDEN, DA DIE WICHTIGEN INFORMATIONEN DARAUF SIND.
- (E) GUARDE EL EMBALAJE QUE MANTIENE INFORMACION IMPORTANTE.
- (PT) A EMBALAGEM DEVE SER CONSERVADA POIS POSSUI INFORMACOES IMPORTANTES.
- (RU) ИНФОРМАЦИОНЕН СКАЛ СЪДЪРЖИ ВАЖНИ ИНФОРМАЦИИ ЗА НЕПОСРЕДСТВЕНАТА ПОТРЕБА НА ПОСЛЕДИТЕЛИТЕ.
- (C) THE RIGHT IS RESERVED TO IMPROVE OR AMEND SPECIFICATION & COLOR.
- (F) LE DROIT DE MODIFIER LES SPECIFICATIONS ET COULEURS EST RESERVE AU FABRICANT.
- (NL) HET RECHT IS VOORBEHOUDEN OM KLEIJEN EN SPECIFICATIE TE VERBIJTEREN OF TE WIJZIGEN.
- (D) DER HERSTELLER BEHALT SICH VOR, FAHRER UND AUSSTATTUNG ZU VERBISSERN ODER ZU ANDERN.
- (E) TODOS LOS DERECHOS ESTAN RESERVADOS CON EL FIN DE MODIFICAR O RECTIFICAR, AL IGUAL QUE LOS COLORES.
- (PT) RESERVADO O DIREITO DE MELHORAR OU ALTERAR ESPECIFICACOES E CORES.
- (RU) ВЛ ПОРБЕХОДЕР ОД РЕТТЕН ТИЛ АТ ПОРБЕХОДЕР ЕЛЛЕР БЕТТЕ СПЕЦИФИКАЦИОНЕ ОУ ЦВЕТ.
- (C) 1:18 SCALE
- (F) ECHELLE 1:18
- (NL) 1:18 SCHAAL
- (D) MASSSTAB 1:18
- (E) ESCALA 1:18
- (PT) À ESCALA DE 1:18
- (RU) 1:18 СКАЛА
- (C) MADE IN CHINA
- (F) FABRIQUE EN CHINE
- (NL) GEFABRICERD IN CHINA
- (D) HERGESTELLT IN CHINA
- (E) FABRICADO EN CHINA
- (PT) FABRICADO NA CHINA
- (RU) ФАБРИЦИТЕЛТ I КИНА

IMPORTATO DA:  
 New-Ray S.r.l.  
 Via E. Fermi 835  
 21042 Caronno Pertusella (VA)  
 New-Ray France Sarl  
 167, rue Mayousard  
 38430 Moirans  
 New-Ray Toys (CA) Inc.  
 5407 Daniels Street  
 Chino, CA 91710  
 www.newrayusa.com

New-Ray GmbH  
 Im Eichenloch 77  
 66956 Pirmasens  
 New-Ray Toys Co., Ltd.  
 Unit 9, 12<sup>th</sup> Floor, Housatou Centre  
 63 Mody Road, Tsimshatsui East  
 Kowloon, Hong Kong  
 www.new-ray.com  
 ARTICOLO PRODOTTO SENZA L'UTILIZZO DI MANODOPERA INFANTE.  
 ARTÍCULO FABRICADO SIN UTILIZACIÓN DE MANO DE OBRERA INFANTE.

CE 0678



Popak New-Ray Mfg Ltd  
 Dongguan China



- Instructions for battery operated toys**
- 1) Batteries should only be inserted or changed by an adult.
  - 2) Switch the toys to the 'off' position before inserting batteries.
  - 3) Insert batteries correctly in the manner shown elsewhere on the toy or packaging.
  - 4) Only use the same type of battery— do not mix brands or types.
  - 5) Replace all batteries at the same time with new ones.
  - 6) Do not mix old and new batteries.
  - 7) Do not leave batteries in the toy for long periods of time when it is not in use.
  - 8) Do not use rechargeable batteries.
  - 9) Remove exhausted batteries from the toy.
  - 10) Dispose of used batteries safely— do not throw on a fire or attempt to open up the outer case.
  - 11) At all times keep small batteries which could be a choking hazard to children out of their reach.
  - 12) Seek medical advice if a small battery has been swallowed by a child. Batteries are harmful if swallowed.
  - 13) Non-rechargeable batteries are not to be recharged.
  - 14) The supply terminals are not to be short-circuited.

ANR14187913A