

# Motorized Cellular Shade



Model : MCS1-A / MCS1-B

## Safety Precautions

Thank you for your purchase. Please review the instructions carefully before using the product, and save these instructions for future consultation.

- **WARNING!** Important safety instruction: It is critical for your safety and the safety of those around you to follow these instructions. Save these instructions.
- **WARNING!** The drive shall be disconnected from its power source during cleaning, maintenance and when replacing parts.
- The products may contain Lithium-ion batteries; the battery contains flammable materials such as organic solvents. Please read the Important Safety Precautions before using the product.
- Please recharge the batteries every 3-6 months to ensure optimal performance of batteries.
- Product operation is intended for temperatures between 0°C/32°F ~40°C/104°F.
- Please note that the limited warranty will be voided if the product is modified, dismantled or used in any manner other than its intended purpose.
- The accessories, including **Power Rod™**, Remote, Hub, and Repeater are designed to be used with our Motorized Shades. **Do NOT** use them for any other purpose.
- Please make sure the shade route is clear when operating to avoid danger or damage.
- In order to improve the user experience and functionality, the firmware and software of this product will automatically update from time to time. (When the Hub is installed)
- **WARNING!** For the purposes of recharging the battery, only use the detachable supply unit provided with this appliance.  (UHVUU3036-240015SA / UHVUE3036-240015SA / UHVUA3036-240015SA / UHVUK3036-240015SA)
- **Do NOT** disassemble the products or any of their components. They do not contain serviceable parts. Servicing of these products should be referred to qualified personnel.
- This appliance contains batteries that are only replaceable by skilled personnel, trained Norman retailer or electrician.
- **Do NOT** operate the product with wet hands to avoid risk of electrical shock. The product needs to be powered off and disconnected from its power source during cleaning, maintenance and/or replacing parts.
- **Do NOT** operate the shade or swing the **Power Rod™** while charging.
- The product is not to be used by persons such as children, those with reduced physical, sensory or mental capabilities, or those who lack experience and knowledge of the product, unless they have been given supervision or instruction. Children should be advised not to play with the products.
- Do not allow children to play with fixed controls. Keep remote controls away from children. Frequently examine the installation for imbalance, signs of wear or damage to cables, springs and fixings. Do not use if repair or adjustment is necessary.
- **Do NOT** operate when maintenance, such as window cleaning, is being carried out in the vicinity.
- **IMPORTANT:** Please reserve space for connecting the **Power Rod™** while installing the shade, please refer to "Installation" Section for more information.

## Shade & Accessories \_ Battery

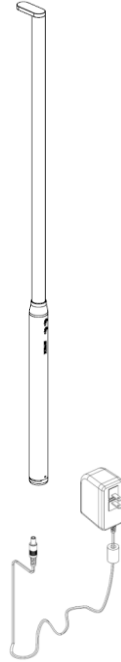

Power Rod™  
(Optional)

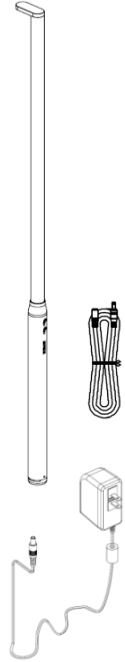

AC Power Rod™  
(Optional)

Remote (Optional)



RC-A01

## Shade & Accessories \_ AC Power

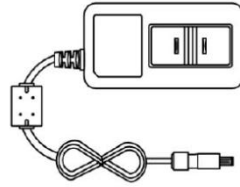
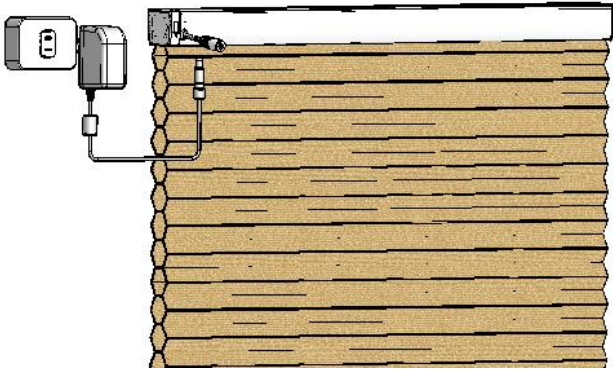

Adapter x 1



Extension cord x 1  
(Optional)

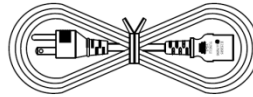
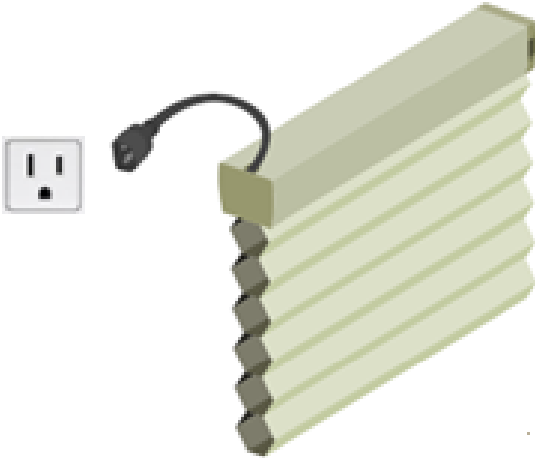

Power Cord x 1

Remote (Optional)



RC-A01

## Installation

**WARNING!** Important safety instructions. Follow all instructions since incorrect installation can lead to severe injury.

Before installing the drive, remove any unnecessary cords or components and disable any equipment not needed for powered operation.

**WARNING!** The installation height will vary according to product type or installation situation and may exceed 2.5m.

### STEP.1 Reserve space before installation

**Battery-powered shade :** with built-in Li-ion battery pack and charging accessories.

**IMPORTANT !** Please reserve a space of maximum height 120mm(5") and minimum depth 150mm(6") for connecting the Power Rod before you install the Wireless MCS system. (Refer to Fig. 2a)

**IMPORTANT !** Please mount the shade bracket horizontally and ensure the installation is not defective, or it may fail to charge the shade with a Power Rod. The shade system installation allows a Maximum 3° tolerance of deflection.

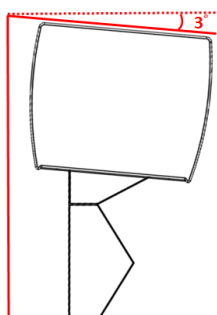
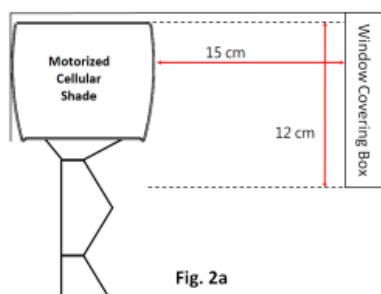

**AC-powered shade :** Make sure to provide proper accessibility to an electrical outlet.

**IMPORTANT !** Wiring and servicing of these products should be referred to qualified personnel.

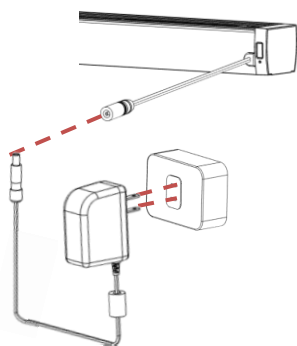

# Installation

## STEP.2 Installation Tools and Components



Save the packaging until the shade is installed and working to your satisfaction.

### Tools

- 1. Level / 2. Measuring Tape / 3. Pencil / 4. Screwdriver
- 5. Power drill (6mm hex or cross-head driver and drill bit)



You will need to use the following fasteners for your particular mounting surface.

Surface	Fastener
Wood	Screw  (Provided, subject to actual product)
Dry wall / Plaster	Wall Anchors, Expansion bolts (Not provided) 
Metal	Sheet Metal Screws (Not provided) 

### Bracket & Component / Hardware

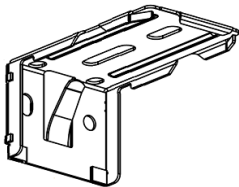

Bracket



31mm(1 1/4")  
Hex Screw



31mm (1 1/4")  
Screw

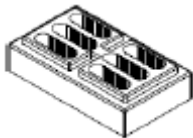

Spacer  
(Optional)



50mm (2") Screw  
(Optional)



63mm (2.5") Screw  
(Optional)



15mm (9/16") Screw  
(Optional)

## Installation

### STEP 3. Mark mounting location

Position brackets 3 15/16" (100mm) from both ends of the head rail. Mark the bracket location on the mounting surface. Proper alignment of brackets will make installation easier.

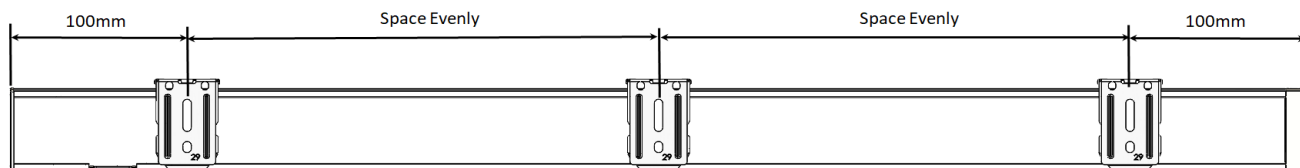

### STEP 4. Bracket Installation

#### Inside Mount

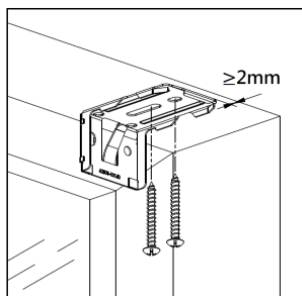
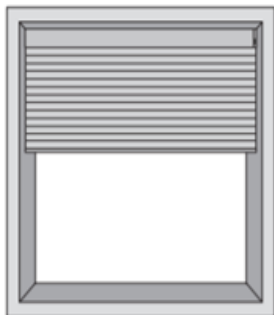

Allocate a minimum distance of 2mm (1/16") from wall to the front of bracket and fix it with screws.

[!] For Shades with light guard at front and back, please allocate a minimum distance of 4mm from wall to the front of bracket and fix it with screws.

#### Outside Mount

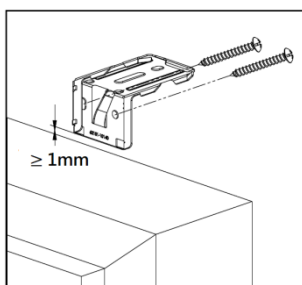
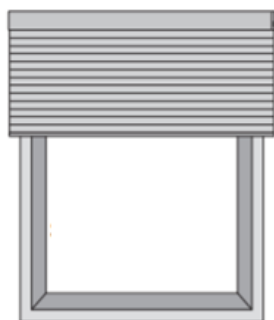

Allocate a minimum distance of 1mm (1/16") from wall to the bottom of bracket and fix it with screws.

#### Semi-inside Mount

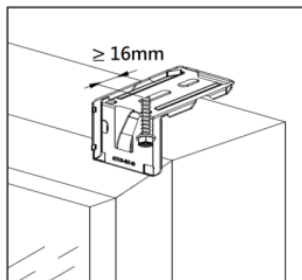
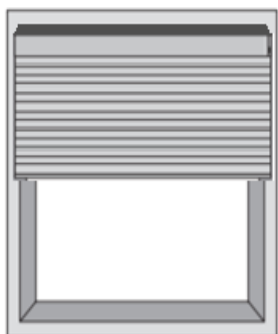

Allocate a minimum distance of 16mm (5/8") from wall to the location of screw and fix it.

## Installation

### STEP 5. Install the shade

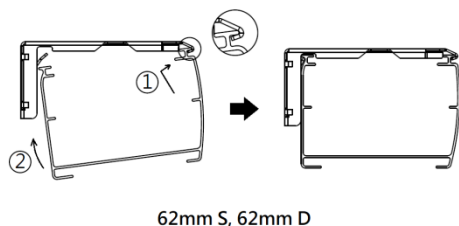
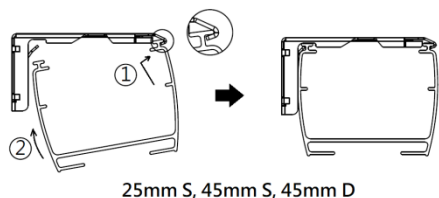

Position the head rail at an angle so that it is hooked to the front of the bracket. Then push it upward at the back to snap into the bracket.

[!] For proper installation, start with attaching the front of the head rail to the bracket.

### ★ Remove the shade

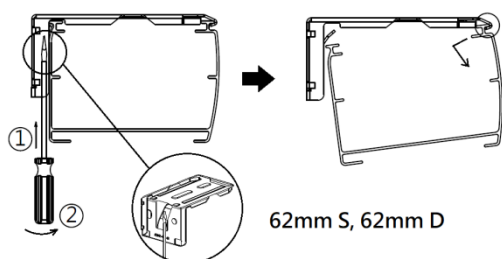
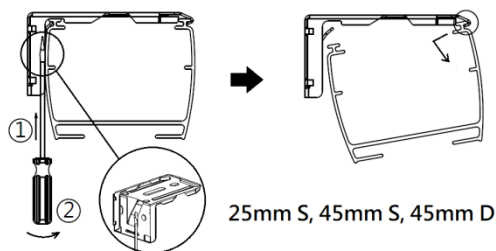

[!] Please fully raise the shade before removing the shade.

Gently press the bracket clip from the back of shade with a flat screwdriver and swing forward to remove the shade from the bracket.



## Setup & Operation

### Battery-powered shade

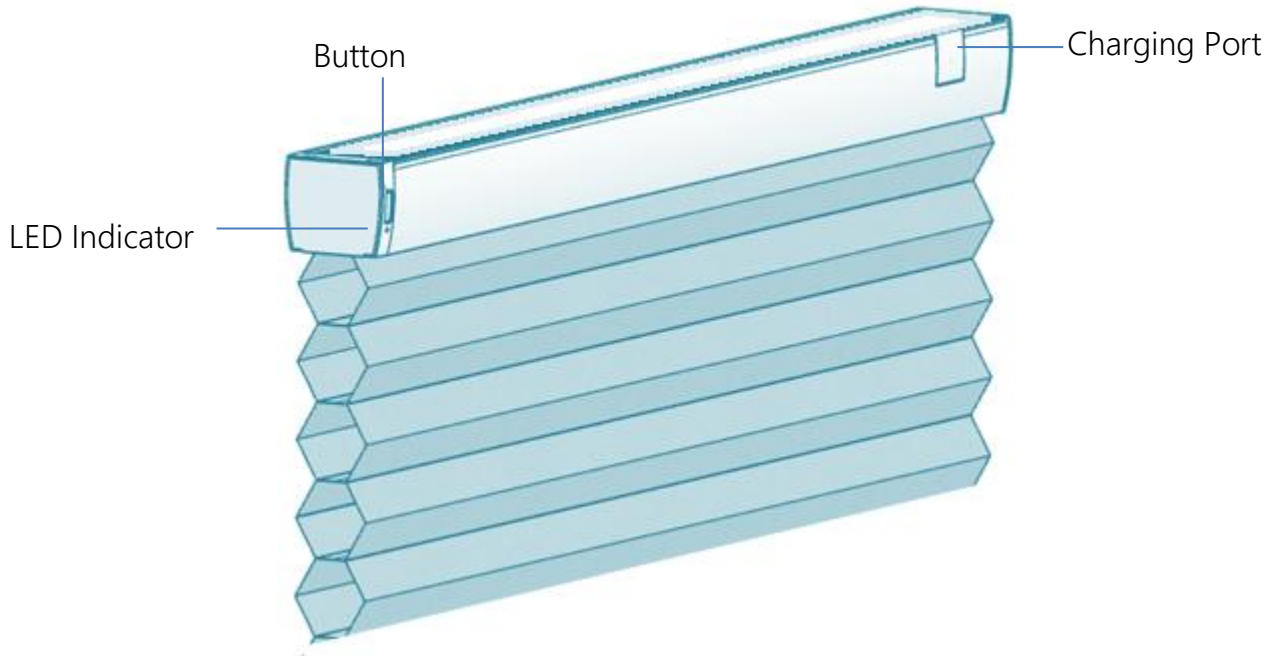

### AC-powered shade

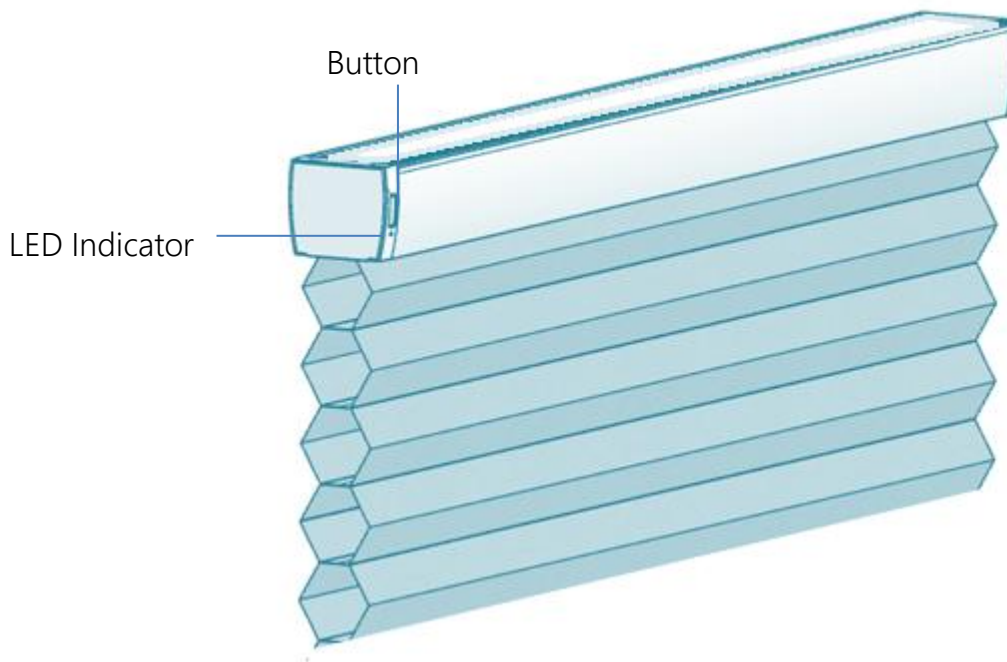

## Setup & Operation

### Power ON / OFF

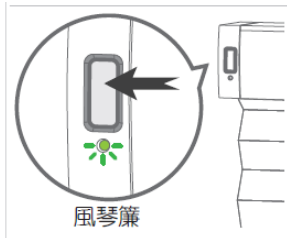

#### Power ON

Hold the shade button for 3 seconds and the green light will flash.

#### Power OFF

Hold the shade button for 3 seconds and the red light will flash.

### Pair shades with a Remote

The shades are already paired with the Remote Control, If needed, please follow the steps to re-assign the shades to another group.

**IMPOTANT!** Please pair only one type of shades in the same group.

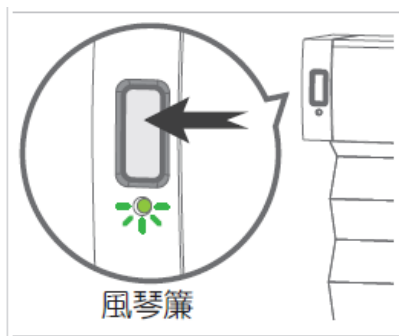

When powered on, press the button 3 times to enter Pairing mode. The green light will start flashing.

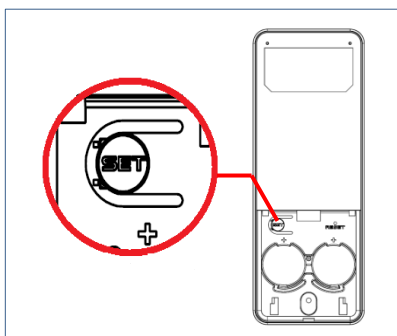

Hold SET for 3 seconds to enter Setup mode. The Group LEDs will start blinking.

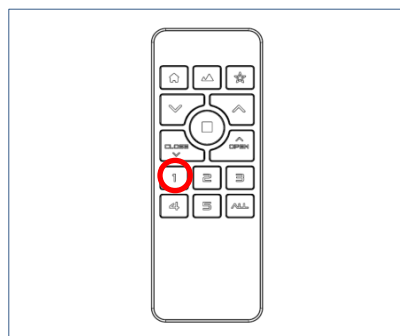

Choose a desired group.  
The selected group number will blink.

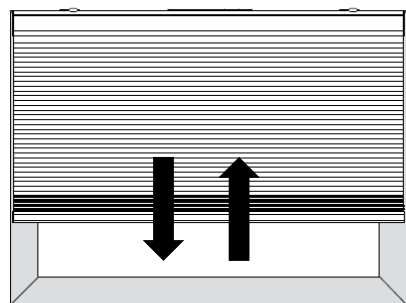

The shade will move up and down to indicate successful pairing. The green light will stop flashing.

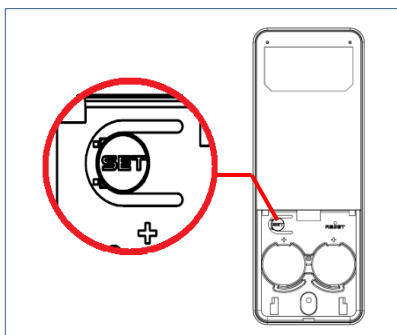

Hold SET for 3 seconds to leave Setup mode. The Group LEDs will stop blinking.  
The device will leave Setup mode automatically after 20 seconds of inactivity.

## Setup & Operation

### Un-pair the shade from Remote control

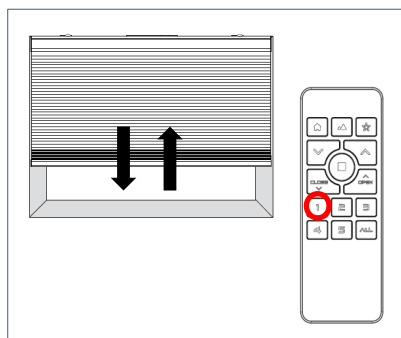

Hold any Group button, the shades assigned to the group will move up and down.

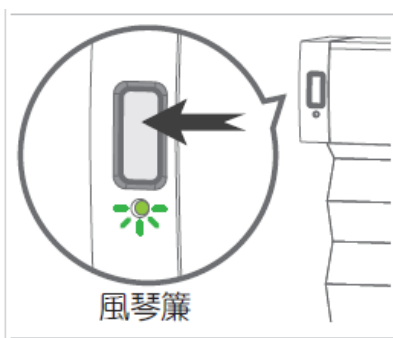

Press the button 3 times to enter Pairing mode. The green light will start flashing.

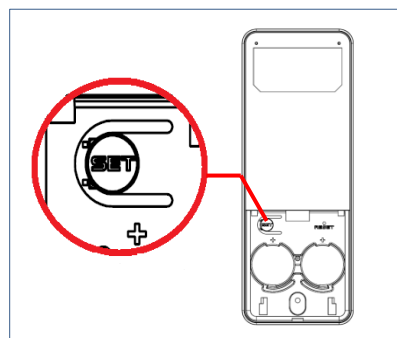

Hold SET to enter Setup mode. The Group LEDs will start blinking.

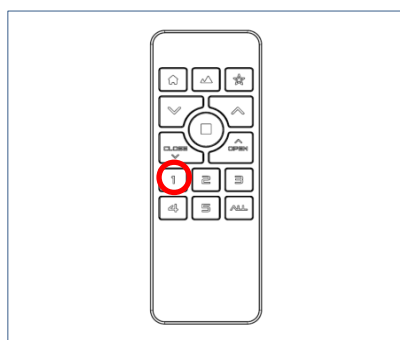

Choose a desired group. The selected group number will blink.

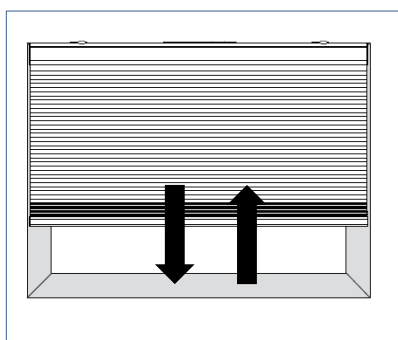

The shade will move up and down 2 times to indicate successful un-pairing. The green light will stop flashing.

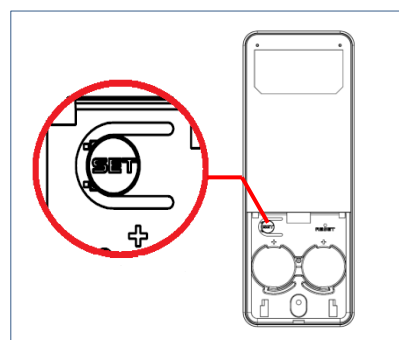

Hold SET for 3 seconds to leave Setup mode. The Group LEDs will stop blinking. The device will leave Setup mode automatically after 20 seconds of inactivity.

## Setup & Operation

**IMPORTANT!** Please setup the positions of a single shade to avoid tampering with the positions of other shades assigned to the same group:

1. Pair the desired shade to any new group alone, then setup the positions via new group, or
2. Power off the other shades in the same group, and setup the positions of the desired shade.

**IMPORTANT!** Top and Bottom positions must be setup for full function of the shades.

**IMPORTANT!** Top, Middle and Bottom positions must be setup for full function of the D&N/TDBU shades.

### Setup Top Position

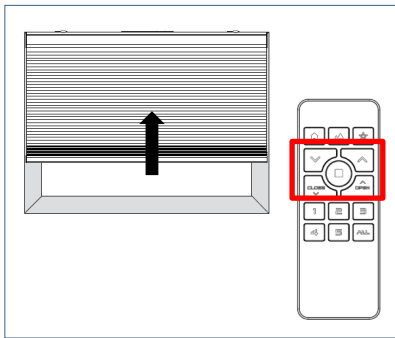

Move the shade to a desired Top position by Remote.

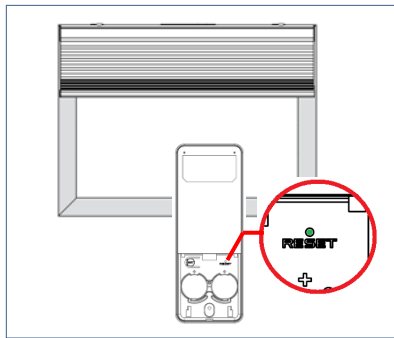

Hold RESET for 1 second.  
The Group LEDs will start blinking.

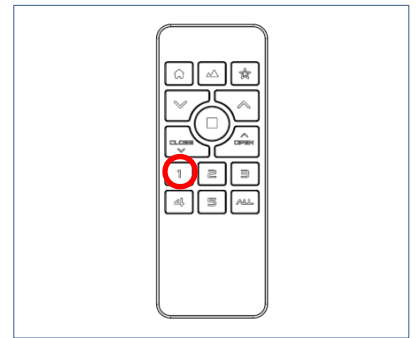

Choose the desired group.

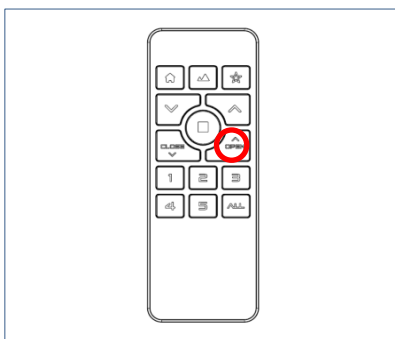

Press **OPEN** to setup the Top position.

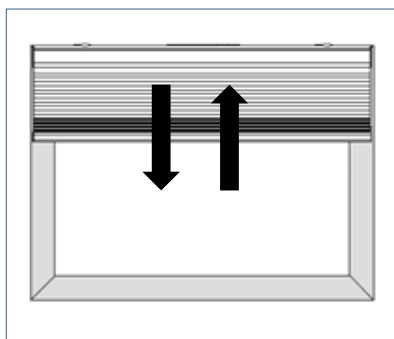

The shade will move up and down to indicate successful setup.

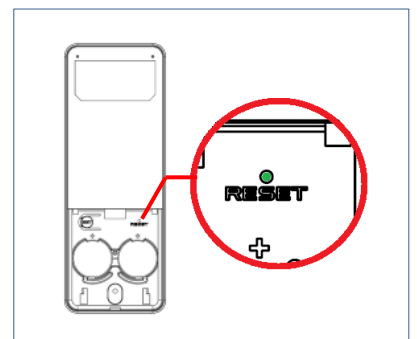

Hold RESET for 1 second. The Group LEDs will stop blinking.  
The device will leave RESET mode automatically after 20 seconds of inactivity.

## Setup & Operation

### Setup Bottom Position

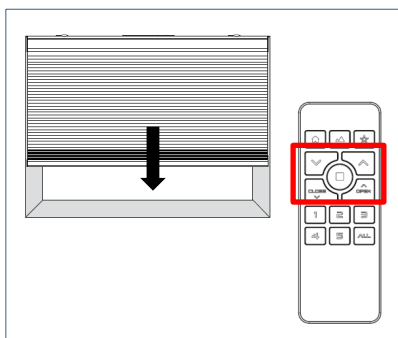

Move the shade to a desired Bottom position by Remote.

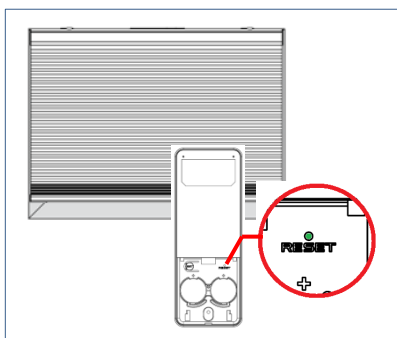

Hold RESET for 1 second.  
The Group LEDs will start blinking.

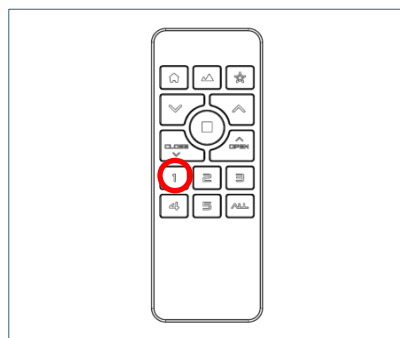

Choose the desired group.

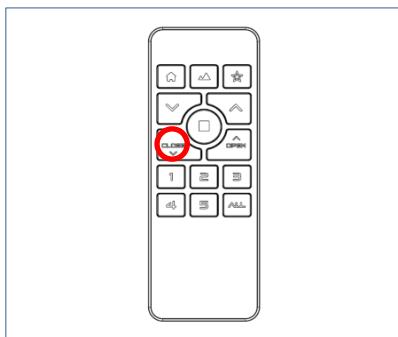

Press **CLOSE** to setup the Bottom position.

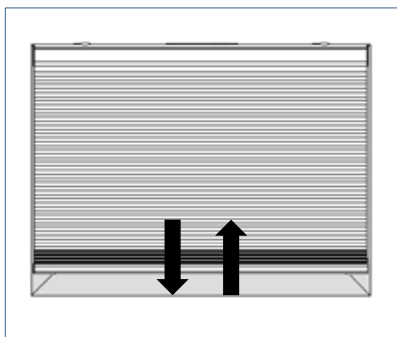

The shade will move up and down to indicate successful setup.

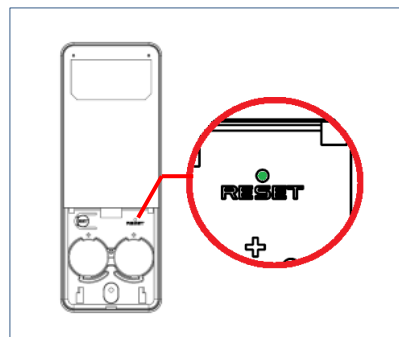

Hold RESET for 1 second. The Group LEDs will stop blinking.  
The device will leave RESET mode automatically after 20 seconds of inactivity.

## Setup & Operation

**IMPORTANT!** Top, Middle and Bottom positions must be setup for full function of the D&N/TDBU shades.

### Setup Middle Position

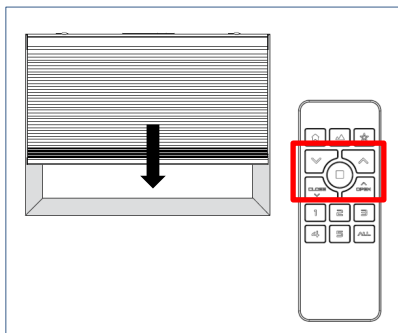

Move the both rails to bottom by Remote.

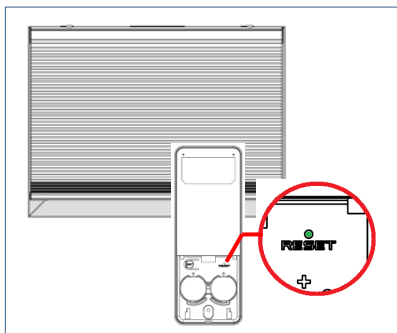

Hold RESET for 1 second.  
The Group LEDs will start blinking.



Choose the desired group.

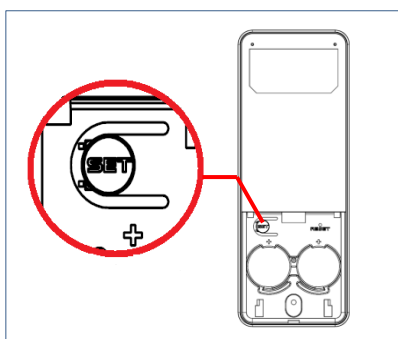

Press SET to setup the Middle position.

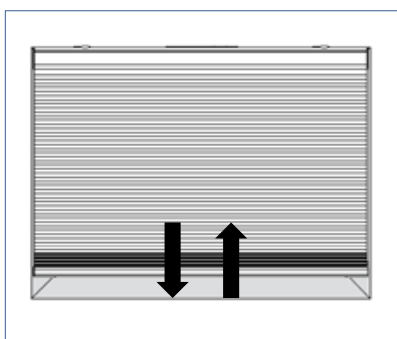

The shade will move up and down to indicate successful setup.

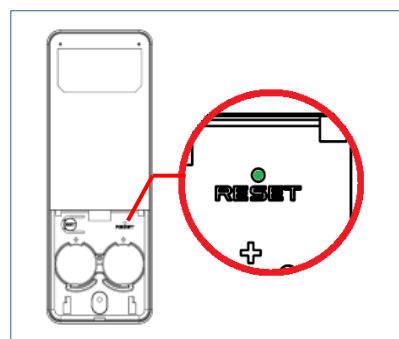

Hold RESET for 1 second. The Group LEDs will stop blinking.  
The device will leave RESET mode automatically after 20 seconds of inactivity.

## Setup & Operation

**IMPORTANT!** All position must be setup before My Favorite setup can begin.

**IMPORTANT!** Clearing any of the positions will disable My Favorite feature.

### Setup / Clear My Favorite

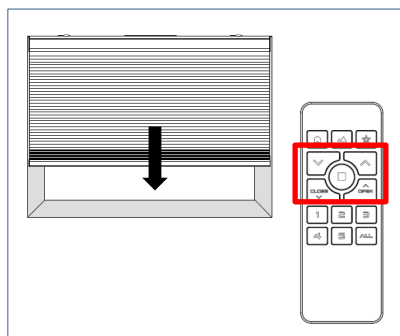

Move the shade to a desired Favorite position by Remote.

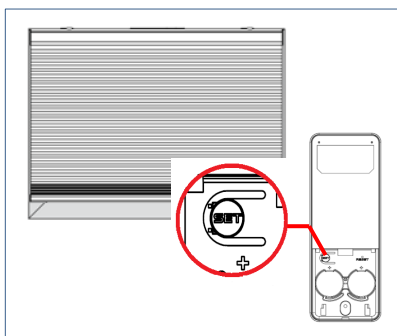

Hold SET for 1 second. The Group LEDs will start blinking.

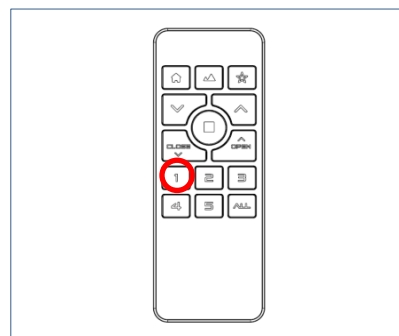

Choose the desired group.

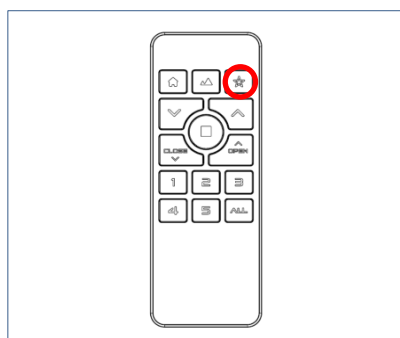

Press ★ to setup My Favorite.

Hold ★ to clear My Favorite (Back to default Favorite)

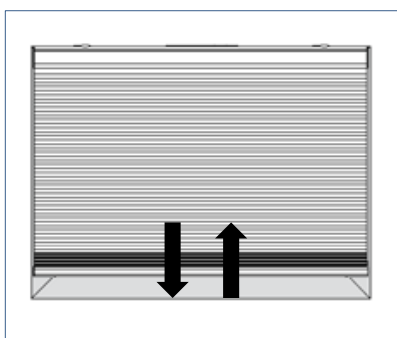

The shade will move up and down to indicate successful setup.

The shade will move up and down 2 times to indicate successful clearing.

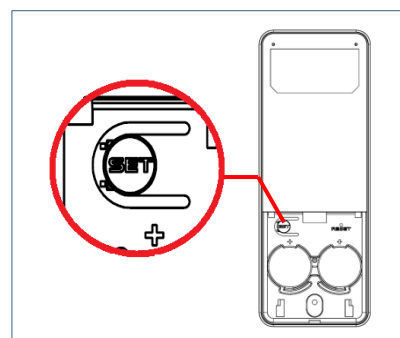

Hold SET for 1 second. The Group LEDs stops blinking. The device will leave RESET mode automatically after 20 seconds of inactivity.

## Setup & Operation

**IMPORTANT!** Please clear the positions of a single shade to avoid tampering with the limits of other shades assigned to the same group:

1. Pair the desired shade to any new group alone, and clear the positions via new group, or
2. Power off the other shades in the same group, and clear the positions of the desired shade.

**IMPORTANT!** Top and Bottom positions must be setup for full function of the shades.

**IMPORTANT!** Top, Middle and Bottom positions must be setup for full function of the D&N/TDBU shades.

### Clear Top / Middle / Bottom Position

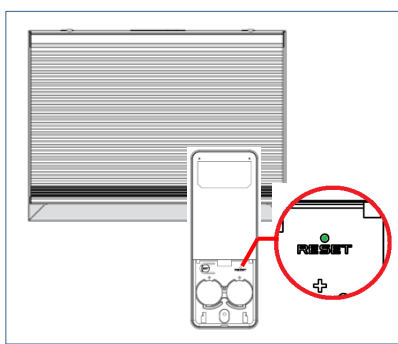

Hold RESET for 1 second.  
The Group LEDs will start blinking.

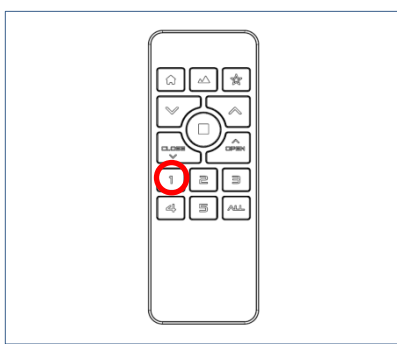

Choose the desired group.

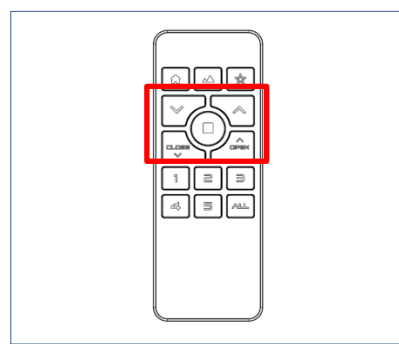

Hold **OPEN** to clear Top position.  
Hold **CLOSE** to clear Bottom position.  
Hold **SET** to clear Middle position.

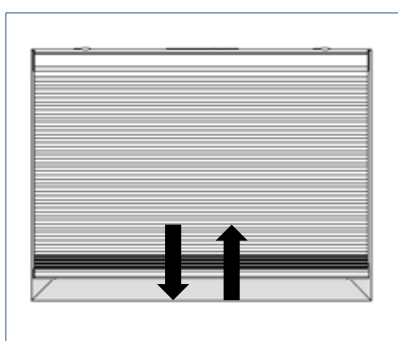

The shade will move up  
and down 2 times to  
indicate successful clearing.

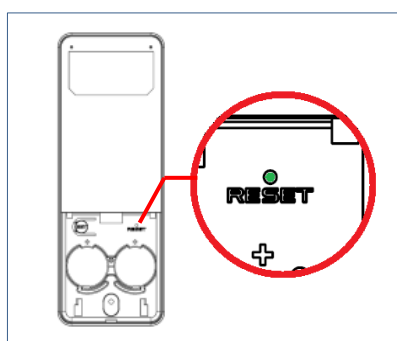

Hold RESET for 1 second.  
The Group LEDs will stop  
blinking.

The device will leave RESET  
mode automatically after 20  
seconds of inactivity.



## Setup & Operation

### Remote control

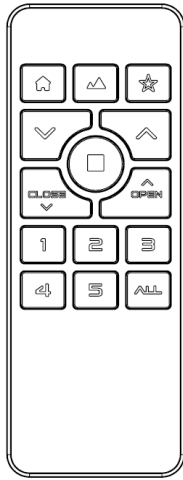

^ / v : Adjust shade position

OPEN : Shade goes up continually

CLOSE : : Shade goes down continually

■ : Stop the shade

山(圖) : Move to Best View

房(圖) : Move to Best Privacy

★ : Move to My Favorite

Press Group(1-5, ALL) : Select a group

Hold Group(1-5, ALL) : Identify the shades in the group

For more Remote model, please visit: [\(網址\)](#)

### Lift (Gesture) Recognition

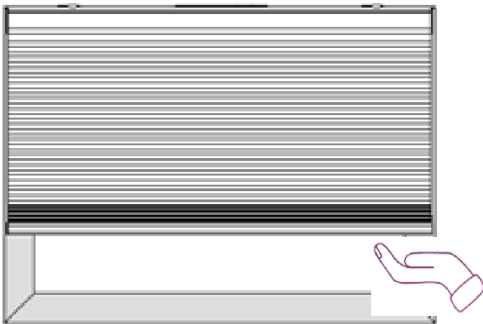

Lift bottom rail to move the shade downwards when the shade is still.

Lift bottom rail to stop the shade while the shade is in motion.

Lift bottom rail again to move the shade upwards.

[!] Not available for D&N / TDBU shades.

### Button control

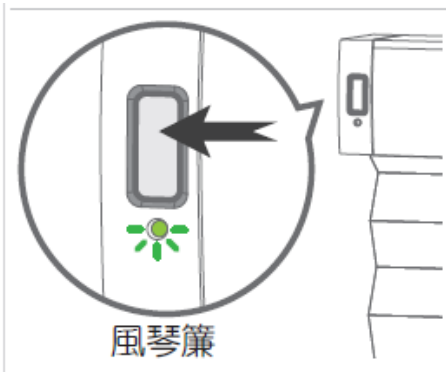

Press the button to move the shade in first direction when the shade is still.

Press the button to stop the shade while the shade is in motion.

Press the button again to move the shade in the opposite direction.

## Setup & Operation

### Calibration

STEP 1. Press the shade button 8 times to enter Setup mode (green light illuminates).

STEP 2. In Setup mode, press the button 2 times (green light blinks).

STEP 3. The shade will execute calibration.

**Note:** Please make sure the shade route is clear and do NOT operate the shade during calibration.

### Clear All Positions

STEP 1. Press the shade button 8 times to enter Setup mode (green light illuminates).

STEP 2. In Setup mode, press the button 4 times (green light blinks).

STEP 3. The shades will move up and down 2 times to indicate successful clearing.

**Note:** This action will clear Top/Middle/Bottom positions, My Favorite and all Scene positions.

### Clear Pairing Data

STEP 1. Press the shade button 8 times to enter Setup mode (green light illuminates).

STEP 2. In Setup mode, press the button 6 times (green light blinks).

STEP 3. The shades will move up and down 2 times to indicate successfully clearing.

Note: This action will clear all pairing data of the shade.

### Hardware Reboot

STEP 1. Hold the shade button for 10 seconds until the red light illuminates.

STEP 2. The shade will reboot.

## Troubleshooting

Problems	Possible Cause	Description
No reaction upon operation	No Signal	Operate the shade by a Remote and check the LED indicator on the shade. Green light blinks : The shade receives signal normally. Red light blinks : Low battery / Over temperature limit Red/Green light blinks : Other problems No light : Not receiving signal / Not paired with a Remote / The shade is powered OFF.
	Low battery of Remote	Please check the Remote LED illuminates and works normally, or replace new batteries.
	Low battery of Shade	Please use Power Rod™ to charge the shade.
	The shade is not paired with the Remote	Hold a Group button and check if the shade goes up and down to indicate it is assigned to the group. If the shade is not paired to any group, please refer to Section "Setup & Operation".
	Over Temperature Protection	The shade might be overheated when the LED indicator on shade blinks red during operation. Please wait at least 30 minutes and operate the shade again. Please refer to the Specification for applicable operating temperature.

## Troubleshooting

Problems	Possible Cause	Description
No reaction upon operation	The Positions are not fully setup.	<p>Press ^/ v on Remote to operate the shade and check if the shade LED blinks green and the shade works normally. If not, the shade positions might not be fully set up for full functionality, please refer to Section "Setup &amp; Operation" to Setup positions.</p> <p><b>IMPORTANT!</b> Top and Bottom positions must be setup for full function of the shades.</p> <p><b>IMPORTANT!</b> Top, Middle and Bottom positions must be setup for full function of the D&amp;N/TDBU shades.</p>
	Other Problems	<p>Re-power ON : Hold the shade button for 3 seconds to power ON/OFF the shade</p> <p>Hardware reboot : Hold the shade button for 10 seconds until the red light illuminates and the shade will reboot.</p> <p>If the problem still exists, please contact your dealer for further assistance.</p>
Positions shift	Abnormal power failure	Abnormal power failure may cause a shift of positions, please refer to Section "Setup & Operation" to Setup new positions.
	Others	Please contact your dealer for further assistance.

## Specification

NO.	Item	Specification
1	Power Source	Battery-powered : Li-ion batteries x3 AC power : 100-240V, 50 / 60Hz
2	Battery operating voltage range	4.2V~3.4V (Single cell)
3	Radio type	2.4G RF
4	Frequency band(s)	2415~2459MHz
5	Maximum Transmit Power EIRP	1.95 dBm
6	Motor type	Brush DC motor
7	Charge type	Power Rod™ (for battery-powered shades)
8	Charging Time	< 3 hours
9	Charging Temperature	5°C/41°F ~ 35°C/95°F
10	IP ranking	IPXX
11	Operating Temperature	0°C/32°F ~ 40°C/104°F
12	Relative Humidity	0% ~ 90% (Non-condensing)
13	Ave. Sound Level @1m	≤ 50 dBA

## Safety Statement

### Federal Communication Commission Interference Statement

This device complies with Part 15 of the FCC Rules. Operation is subject to the following two conditions: (1) This device may not cause harmful interference, and (2) this device must accept any interference received, including interference that may cause undesired operation.

This equipment has been tested and found to comply with the limits for a Class B digital device, pursuant to Part 15 of the FCC Rules. These limits are designed to provide reasonable protection against harmful interference in a residential installation. This equipment generates, uses and can radiate radio frequency energy and, if not installed and used in accordance with the instructions, may cause harmful interference to radio communications. However, there is no guarantee that interference will not occur in a particular installation. If this equipment does cause harmful interference to radio or television reception, which can be determined by turning the equipment off and on, the user is encouraged to try to correct the interference by one of the following measures:

- Reorient or relocate the receiving antenna
- Increase the separation between the equipment and receiver.
- Connect the equipment into an outlet on a circuit different from that to which the receiver is connected.
- Consult the dealer or an experienced radio/TV technician for help.

FCC Caution: Any changes or modifications not expressly approved by the party responsible for compliance could void the user's authority to operate this equipment.

This transmitter must not be co-located or operating in conjunction with any other antenna or transmitter.

### Industry Canada Equipment Standard for Digital Equipment (ICES) –Canada

This Class B digital apparatus complies with Canadian ICES-003. **CAN ICES-3 (B)/NMB-3(B)**  
Cet appareil numérique de la classe B est conforme à la norme NMB-003 du Canada.

### Innovation, Science and Economic Development Canada(ISED) Compliance Statement

This device complies with ISED's licence-exempt RSS standard(s).

Operation is subject to the following two conditions: (1) this device may not cause interference, and (2) this device must accept any interference, including interference that may cause undesired operation of the device.

Le présent appareil est conforme aux CNR d'ISED applicables aux appareils radio exempts de licence. L'exploitation est autorisée aux deux conditions suivantes : (1) le dispositif ne doit pas produire de brouillage préjudiciable, et (2) ce dispositif doit accepter tout brouillage reçu, y compris un brouillage susceptible de provoquer un fonctionnement indésirable.

## Safety Statement

### RED Compliance Statement

Hereby, Nien Made Enterprise Co., Ltd. declares that the radio equipment type MCS1 is in compliance with Directive 2014/53/EU.

The full text of the EU declaration of conformity is available at the following internet address:  
[http://www.XXXXXXXXXXXXXXXXXX\(TBD\)](http://www.XXXXXXXXXXXXXXXXXX(TBD))

This equipment complies with EU radiation exposure limits set forth for an uncontrolled environment.

### Recycling – European Directive 2012/19/EU

This marking indicates that this product should not be disposed with other household wastes. To prevent possible harm to the environment or human health from uncontrolled waste disposal, recycle it responsibly to promote the sustainable reuse of material resources. To return your used device, please use the return and collection systems or contact the retailer where the product was purchased. They can take this product for environmental safe recycling.

### Norman International, Inc.

28 Centerpointe Drive

La Palma, CA 90623

562-236-2600

<https://normanusa.com/>



## Safety Instructions for Lithium batteries

The product may contain lithium-ion batteries; the battery contains flammable materials, such as organic solvents. Mishandling of the battery may cause fire, smoke, or explosion.

### **DANGER**

**Do not immerse the battery in any liquid, such as water, beverages, or other fluids.**

Exposure to liquid may damage the battery or the battery pack. Damaging the battery may generate heat, smoke, catch fire, or explode.

**Do not use or place the battery in or near an open flame, heater or high temperature areas (above 80°C or 176°F) , such as those near a microwave or other cooking appliance.**

Subjecting the battery to high temperature or near electromagnetic radiation may damage the polyolefin separator and can cause short circuit. This may cause the battery to generate heat, smoke, catch fire, or explode.

**About Charging: Do not use unauthorized chargers.**

Only charge the battery within recommended conditions (e.g., temperature range, voltage, and current). Use of an unauthorized charger could cause the battery to generate heat, smoke, catch fire, or explode.

**Do not attach or insert battery with polarity reversed.**

If the battery does not easily fit into the charger or device, check the battery orientation. Do not force the battery into the compartment. If the battery is inserted incorrectly, the battery may generate heat, smoke, catch fire, or explode.

**Do not connect the battery to an AC outlet or DC automotive plug.**

The battery requires a specific charger. If the battery is connected directly to a power outlet, the battery may generate heat, smoke, catch fire, or explode.

**Do not use the battery in equipment for which it was not intended.**

If the battery is used in unapproved applications or systems, the battery may be damaged and generate heat, smoke, catch fire, or explode.

**Keep the battery away from heat and fire.**

Excessive heat will damage the battery and may cause it to generate smoke, catch fire, or explode.

**Do Not** connect the positive (+) and negative (-) terminals with a conductive material. Do not carry or store the battery with any metal objects. If the battery is shorted, it may overheat and the battery may generate heat, smoke, catch fire, or explode.

**Avoid excessive impact to the battery.**

Impact beyond specification may damage the battery. This may cause the battery to leak, generate heat, smoke, catch fire, or explode.

**Do not penetrate the battery with any sharp object.**

If subjected to a hard strike or penetrated by an object, the battery may be damaged, thereby causing the battery to short-circuit. This may cause the battery to generate heat, smoke, catch fire, or explode.



## Safety Instructions for Lithium batteries

### **Do not directly solder to the battery.**

Soldering directly to the battery could melt the separator, damage the fume release vent or other safety mechanisms. This may cause the battery to generate heat, smoke, catch fire, or explode.

### **Do not disassemble the battery.**

Disassembly or modification of the battery may damage the protection circuit. This may cause the battery to generate heat, smoke, catch fire, or explode.

### **Do not charge the battery near high temperature.**

If the battery is charged while exposed to high temperature, the battery's protection circuit may activate and prevent charging, or fail and cause the battery to generate heat, smoke, catch fire, or explode.

## **WARNING**

### **Ingestion**

Keep away from small children.

Keep the battery away from small children. If the battery or any of its component parts is swallowed, seek medical attention immediately.

### **Mixed Use**

Do not mix with other batteries.

The battery should not be used with other batteries having a different capacity, chemistry, or manufacturer. Doing so could cause the battery to generate heat, smoke, catch fire, or explode.

### **Rust, Discoloration and Deformities**

Do not use abnormal batteries.

Immediately stop using the battery if there are noticeable abnormalities, such as smell, heat, discoloration, or deformity. The battery may be defective and could generate heat, smoke, catch fire, or explode with continued use.

### **Charging Time**

Stop charging if the charging process cannot be finished.

If the battery cannot finish the charging process within the specified time, halt the charging process. The battery may generate heat, smoke, catch fire, or explode.

### **Leakage -1**

Do not use a leaking battery near open flame.

If the battery or liquid leaking from the battery has an irritating odor, the battery should be kept away from any open flame. If exposed to an open flame, the battery could ignite and explode.

### **Leakage -2**

Do not touch a leaking battery.

If liquid leaking from the battery gets into your eyes or makes contact with your skin, immediately flush your eyes or skin with clean water and seek medical attention. If left untreated, it will cause significant eye or skin damage.

### **Transport**

Pack the battery securely for transport.

To prevent short-circuit or damage during transport, securely pack the battery in a case or carton.

# Safety Instructions for Lithium batteries

## CAUTION

### Exposure to Direct Sunlight

Do not use or leave the battery in a location exposed to excessive heat, such as in direct sunlight or in a car. Doing so could cause the battery to generate heat, smoke, catch fire, or explode. It may also cause the battery's performance and life to deteriorate.

### Use with other Equipment or Power

The battery pack has a protection circuit. Do not use the battery with other equipment or power as it may damage the protection circuit. If the protection circuit fails, the battery may generate heat, catch fire, smoke, or explode.

### Charging Temperature Range

Only charge the battery between 5°C and 35°C. Charging outside of this temperature range may cause the battery to leak, generate heat, or result in serious damage. It may also cause the battery's performance and life to deteriorate.

### Charging Method

Read the user's manual for proper product charging method.

### First Time Usage

Please contact the supplier if the battery gives off an unusual odor, generates heat, or shows signs of rust prior to its initial use.

### Flammable Materials

Do not charge or discharge near flammable materials. Doing so could result in fire.

### Handling of Exposed Contacts or Conductors

If the battery pack has a system interface consisting of stripped lead wires or exposed contact plates, handle with due care. Temporarily insulate exposed contacts and conductors with an insulator such as polypropylene tape or polyvinylchloride tape. Failure to do so could result in an electrical shock; a short circuit causing the battery to generate heat, smoke, catch fire, or explode; or the combustion of other materials.

### Recycling

When disposing of the battery, recycle it according to local rules and regulations.