

VAULT 2

BLUESOUND®



© Bluesound International. Bluesound, the stylized wordmark and "B" logotype, the phrase "HiFi for a wireless generation", VAULT 2 and all other Bluesound product names and taglines are trademarks or registered trademarks of Bluesound International, a division of Lenbrook Industries Limited. All other logos and services are trademarks or service marks of their respective owners.

15-003

Quick Setup Guide

bluesound.com

Included Accessories



Stereo RCA to RCA Cable



3.5mm Stereo Mini Plug to RCA Cable



120V AC Power Cord



230V AC Power Cord



Ethernet Cable



Mini Jack to Toslink Adaptor

VAULT 2 Streaming Music Player Vault and CD-Ripper

English	4
Français	8
Español	9
Italiano	10
Português	11
Deutsch	12
Nederlands	13
Svenska	14
Русский	15

1

CONNECT FOR SOUND

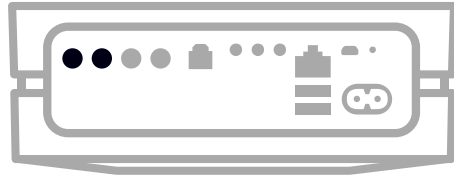
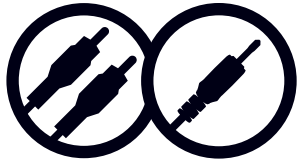

- A Using the RCA to RCA cable provided, connect the VAULT 2 directly to an input on your existing stereo, amplifier or home theatre receiver.
- B Alternatively, using the Mini Plug to RCA cable provided, connect the VAULT 2 directly to your computer, dock player, or bookshelf system.

A digital optical cable (not included) can also be used to connect the VAULT 2 to equipment with a digital optical input.

2

CONNECT TO NETWORK

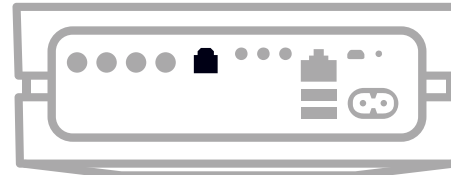
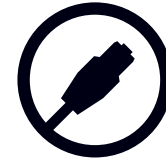

- A Using the Ethernet cable provided, connect one end to the VAULT 2, and the other end directly to your wired home network or router.

3

CONNECT TO POWER

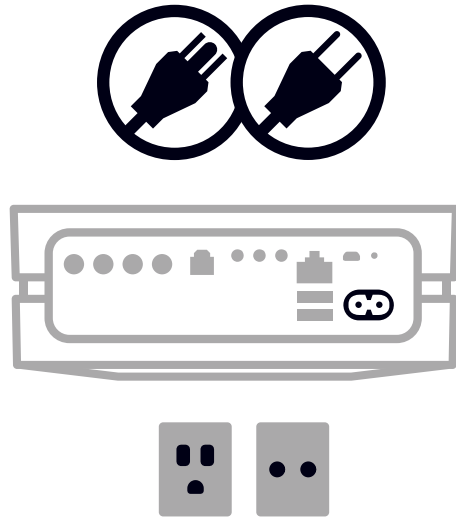

- A Select the AC Power Cord appropriate for your region and plug it into the Player, and then into your wall outlet.
- B The VAULT 2's LED button should turn Solid Green, indicating the Player is in Hotspot Mode and ready to be added to your home WiFi network.

Never force a power cord into a wall outlet. An adaptor may be necessary in certain regions.

4

DOWNLOAD THE APP

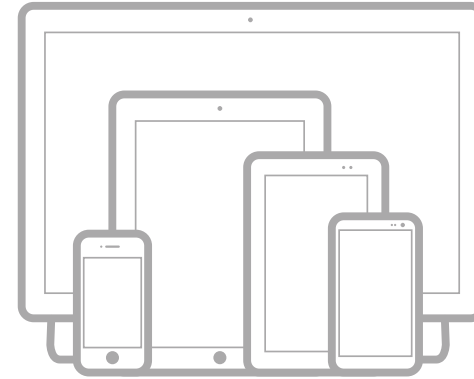

All Bluesound Controller Apps for Apple iOS devices (iPhone, iPad, iPod), Android devices, Kindle Fire, and Windows or Mac desktops are available for download at www.bluesound.com/downloads

Congratulations, your Player setup is complete!

It's time to connect your music. Launch the App for the following playback options.



CONNECT TO MUSIC



Your Music : To play music stored on a computer or NAS device, open the Navigation Drawer by tapping  in the App, choose **Configure Player** from the menu, and select **Configure Network Shares**. Follow the screen prompts, and open every Room in your home to your entire digital music library.

Internet Radio : Simply select **TuneIn** from the **Music Services** menu, and find your favorite radio station. Or, explore and discover the thousands of radio stations streaming live 24/7 from anywhere on the planet via **TuneIn**.

For detailed information, please visit www.bluesound.com