

Item No.: FE

Features:

- 1.No battery required for bell push, with LED NightLight
- 2.32 high quality sounds
- 3.Self-learning function avoid interference
- 4.200m operating range in the open air
- 5.4 level volume control
- 6.Bell push waterproof IP44
- 7.Receiver with EU plug in 220V/60Hz

Installation

The bell push can be mounted on door frame.

Transmitter unit

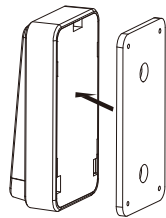
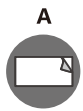
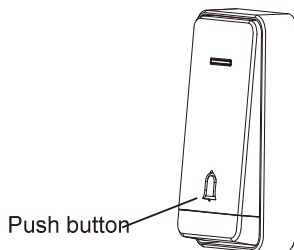

Adhesive Tape

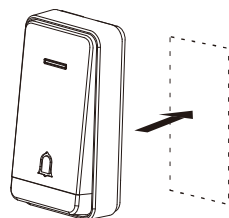
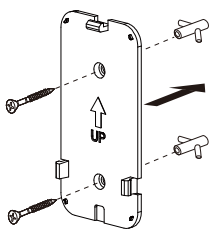
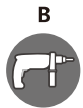

Fig. 1



Screws

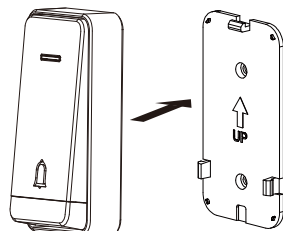

Fig. 2

Receiver unit

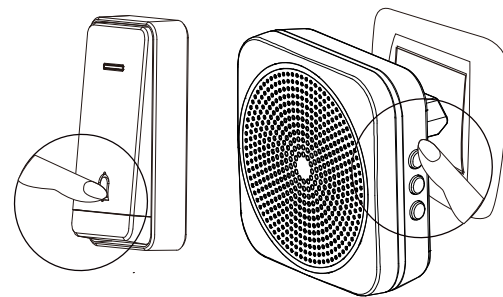
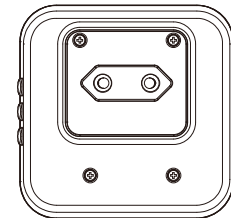
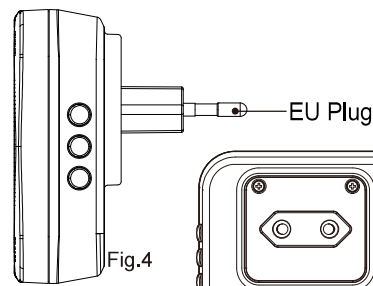
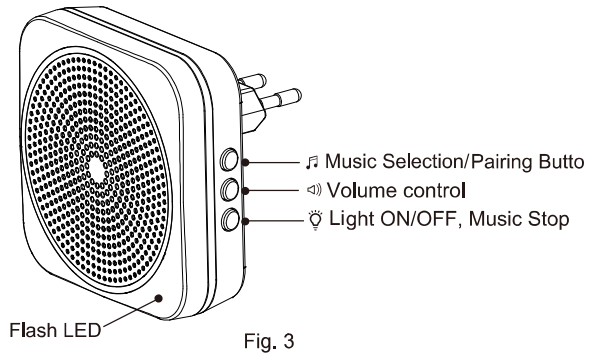

Fig. 5

How to Pairing

- Note: This package is already paired, if there is any disconnection or short range, please follow below setting.
- Hold the receiver's pairing button for 3 seconds until the receiver has "Ding-Ding" sound. Then press the kinetic bell push, then the receiver has "Ding" sound means pairing between the kinetic bell push, and receiver is completed. The receiver will have another "Ding-Ding" sound to exit pairing mode.

This device complies with part 15 of the FCC Rules. Operation is subject to the following two conditions: (1) This device may not cause harmful interference, and (2) this device must accept any interference received, including interference that may cause undesired operation.

Warning: Any changes or modifications to this unit not expressly approved by the party responsible for compliance could void the user's authority to operate the equipment

NOTE: This equipment has been tested and found to comply with the limits for a Class B digital device, pursuant to part 15 of the FCC Rules. These limits are designed to provide reasonable protection against harmful interference in a residential installation. This equipment generates, uses and can radiate radio frequency energy and, if not installed and used in accordance with the instructions, may cause harmful interference to radio communications. However, there is no guarantee that interference will not occur in a particular installation. If this equipment does cause harmful interference to radio or television reception, which can be determined by turning the equipment off and on, the user is encouraged to try to correct the interference by one or more of the following measures:

- Reorient or relocate the receiving antenna.
- Increase the separation between the equipment and receiver.
- Connect the equipment into an outlet on a circuit different from that to which the receiver is
- Consult the dealer or an experienced radio/TV technician for help.