

## Item No.: X - 581P

### Installation

The bell push can be mounted on door frame.  
 The chime can be put on table or put to the strip.

### To change the battery

Remove the battery cover.  
 Bell Push uses 1 x CR2032 3V battery

### Transmitter unit

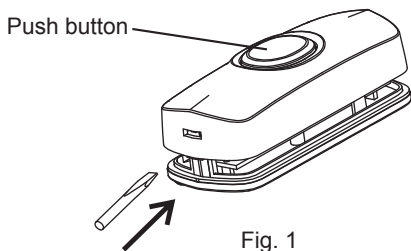

Use flat screw driver to push the hole, to open the cover.

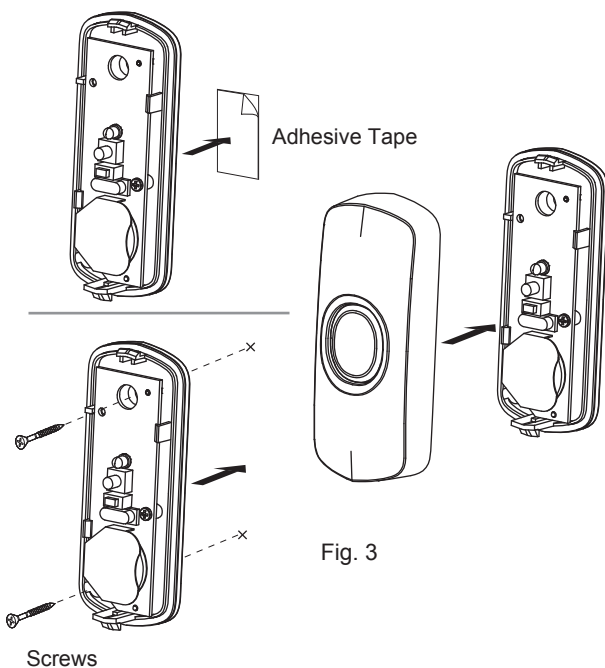
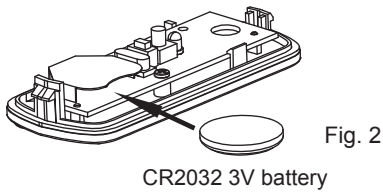

### Receiver unit

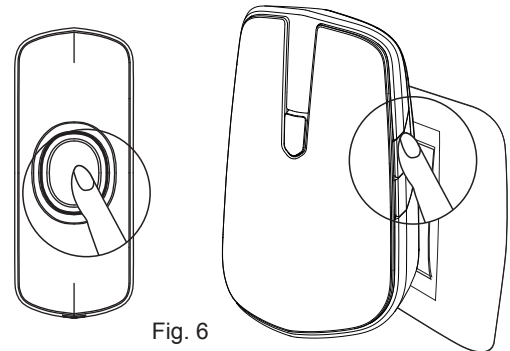
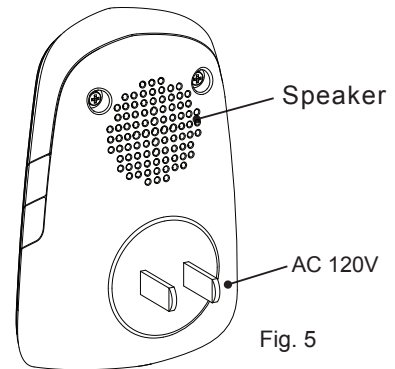
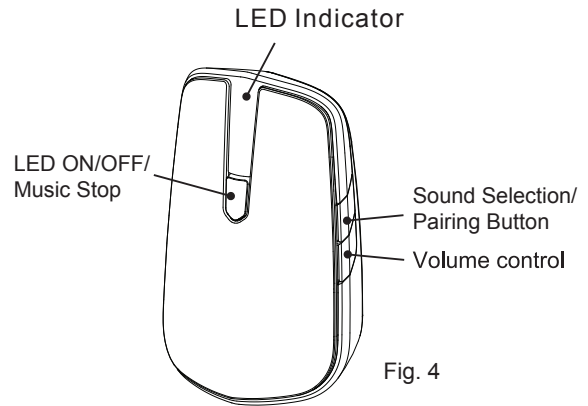

### Replay(Pairing)

- Press the button one time in the receiver, to replay the current sound
- Hold the button for 5 seconds, the receiver will have "Ding-Ding" sounds. Then press the bell push until the receiver has "Ding" means pairing between bell push and receiver is completed. It will have another "Ding-Ding" to exit pairing status.

This device complies with part 15 of the FCC Rules.

Operation is subject to the following two conditions: (1) This device may not cause harmful interference, and (2) this device must accept any interference received, including interference that may cause undesired operation.

Note: This equipment has been tested and found to comply with the limits for a Class B digital device, pursuant to Part 15 of the FCC Rules.

These limits are designed to provide reasonable protection against harmful interference in a residential installation. This equipment generates uses and can radiate radio frequency energy and, if not installed and used in accordance with the instructions, may cause harmful interference to radio communications.

However, there is no guarantee that interference will not occur in a particular installation. If this equipment does cause harmful interference to radio or television reception, which can be determined by turning the equipment off and on, the user is encouraged to try to correct the interference by one or more of the following measures:

Reorient or relocate the receiving antenna.

Increase the separation between the equipment and receiver.

Connect the equipment into an outlet on a circuit different from that to which the receiver is connected.

Consult the dealer or an experienced radio/TV technician for help.

Warning: Changes or modifications to this unit not expressly approved by the part responsible for compliance could void the user's authority to operate the equipment.