

Manufacturer: Zhongshan Camry Electronic Co., Ltd.
Address: Baishawan Industrial Park, Qiwan Road (N),
East District, Zhongshan City, Guangdong Province
Postal Code: 528403
Tel: 0760-88235618
Fax: 0760-88235600
Email: sales@camry.com.cn
Website: www.ifitliving.com.cn

CE **RoHS** 
FCC ID: Q22IF191BI

12iF-001E Ro



iOS Device Accessory —Bluetooth Body Scale



iF191BI User Manual



Made for
 iPod  iPhone  iPad

DEAR USERS:

Thanks for choosing iF191BI bluetooth body scale manufactured by Zhongshan Camry Electronic Co., Ltd. Please read this manual carefully before use. This manual only applies to iF191BI bluetooth body scale.

ABOUT iFIT

iF191BI is a bluetooth scale which helps you to store and keep track of your weight on ipod touch, iphone or ipad. This scale can transmit your weighing data to your ipod touch, iphone or ipad device via bluetooth technology, as well as make graph of your weight results, from which you are able to keep track of the trend anytime. Download iFit Scale software to use bluetooth scale, you will open your first step of weight control. Please note that iFit Scale software is supporting the use of iF191BI scale only.

KEY FUNCTIONS

- Directly check personal weight information through graphs
- Set password to protect personal information and store multi-user data;
- Simple and clear graphs current weight trends, from which you are able to keep track of the change;
- Bluetooth wireless technology;
- Connect with ipod touch, iphone, ipad respectively.
- For more information, please visit: www.ifitliving.com

1. BATTERY INSTALLATION

Name	Illustration	Installation
4x1.5V AAA Battery		AAA battery installation Please install battery according to polarity.

Note: Please use corresponding battery. Please remove battery if it is not in use in a long time (more than three months).

2. REGULAR WEIGHING MODE

After installing battery, place the scale on flat floor. Keep stand still on scale when testing. Then wait for seconds, display shows the same weight reading for approximate a few seconds.

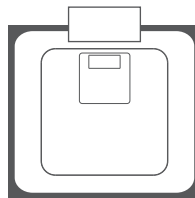

Install battery and place the scale on flat floor. To make sure accuracy, place the scale on a hard, flat floor and avoid carpet and soft surface.

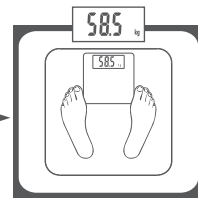

Step on scale slightly (Auto-on) for a while, wait for weight reading display (as shown on graph).

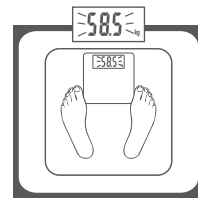

Reading results will flash after weight stabilizing. It shows and lock the result.

3. BLUETOOTH CONNECTION PAIRING

Firstly, please download iFit Scale software from App Store, then step gently onto bluetooth scale platform to switch on. Connect your ipod touch, iphone or ipad through bluetooth with your bluetooth scale.

Set up connection as below:

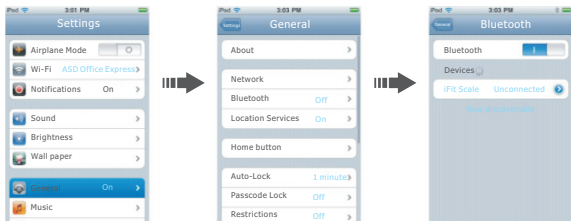

- Click "Settings" on ipod touch, iphone, or ipad and select "General" -- "Bluetooth". If bluetooth is switched off, please press bluetooth button to switch on bluetooth function.
- Click "Device" -- "iFit Scale" to set up bluetooth connection.
- After successful pairing, please starting weighing according to user manual.
- The bluetooth scale can be connected within 5~10 meters covering area after pairing.
- Delete pairing with ipod touch, iphone, ipad: Select "Settings" --- "General" --- "Bluetooth" --- Forget this device"

4.AUTOMATIC SWITCH OFF

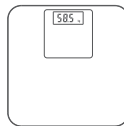

Auto shut-off occurs after display shows the same weight reading for approximate a few seconds, if it is not in use.

5.COMMON WARNING INDICATION

Warning indication	Name	Instructions and methods
Err	OVERLOAD INDICATION	Scale overload the max weight (Max weight is indicated on the scale.) Please step off to avoid damage.
Lo	LOW BATTERY INDICATION	Battery power is low. Please replace new battery.
C	RE-TEST	The weighing reading has error. Please RE-TEST

6.ADVISE FOR USE & CARE

1. DO NOT use the scale in humid, overhydrated, overheat or overcold environment.
2. DO NOT use the scale on tile or slippery floor, lawn, soft mat or uneven floor.
3. DO NOT drop, shock or strike the scale as it is a precise instrument.
4. Keep the scale clean. DO NOT use acid cleaning agent.
5. DO NOT use the scale on a place with intense shake. Keep standing firmly on scale when in use.
6. Test result may be inaccurate after intense sport activity, overfeeding or excessive dehydration.
7. To ensure accuracy, please test at the same time of the sequential days.

Attach: World Health Organization Weight-for-Height chart

Height	Weight (KG) Men	Weight (KG) Women
188	81-92	68-78
184	77-89	66-75
180	74-85	64-71
178	73-82	62-69
174	70-79	59-66
170	67-74	56-64
168	66-72	55-62
164	63-69	52-59
160	60-66	50-56
158	58-64	49-55
154	56-62	47-53
150	54-60	45-51

7.FCC USER GUIDE INFORMATION

Radio Frequency Interference Requirements-FCC

Note: This equipment has been tested and found to comply with the limits for a Class B digital device, pursuant to Part 15 of the FCC rules. These limits are designed to provide reasonable protection against harmful interference in a residential installation. This equipment generates, uses and can radiate radio frequency energy and, if not installed and used in accordance with the instructions, may cause harmful interference to radio communications. However there is no guarantee that interference will not occur in a particular installation. If this equipment does cause harmful interference to radio or television reception, which can be determined by turning the equipment off and on, the user is encouraged to try to correct the interference by one or more of the following measures:

- Reorient or relocate the receiving antenna
- Increase the separation between the equipment and receiver
- Connect the equipment into an outlet on a circuit different from that to which the receiver is connected
- Consult the dealer or an experienced radio/TV technician for help

Radio Transmitters (Part 15)

This device complies with Part 15 of the FCC Rules. Operation is subject to the following two conditions: (1) this device may not cause harmful interference, and (2) this device must accept any interference received, including interference that may cause undesired operation.

Changes or modifications not expressly approved by the party responsible for compliance could void the user's authority to operate the equipment.

FCC RF Exposure Guidelines

Safety Information

Reducing RF Exposure - Use Properly

Only operate the device in accordance with the instructions supplied. This device complies with FCC radiation exposure limits set forth for an uncontrolled environment. In order to avoid the possibility of exceeding the FCC radio frequency exposure limits, human proximity to the antenna shall not be less than 20cm (8 inches) during normal operation.

Hereby, Zhongshan Camry Electronic Co., Ltd. declares that this iF191BI bluetooth body scale is in compliance with the essential requirements and other relevant provisions of Directive 1999/5/EC. The declaration of conformity may be consulted at www.ifitliving.com.cn