

1. BATTERY INSTALLATION AND CHARGING

(1) If it's powered by 4 or 2 pcs AAA batteries, please install as shown below:

First Use: Open the battery cover on the back of scale and put out the insulating strip. Change battery: Open the battery cover on the back of scale, then install the batteries properly according to the pictures shown below.

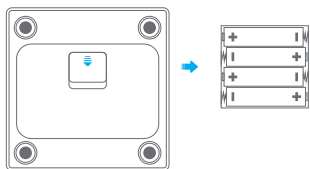

Note: After battery installation, please close the battery cover. Please use corresponding battery. Remove battery if it is not used for a long time (more than three months).

(2) If the scale is with built-in rechargeable battery

1. The scale should be fully charged when firstly used or after long-time stored. Battery symbol flashes during charging and displays constantly when charging is finished. It takes about 2 hours to finish.
2. Please use standard 5V charger with output current equal to or more than 0.5A.
3. Suggest to charge every 3 months if the scale is not used for a long time.



Remark: Battery symbol is shown on LCD during charging. For your safety, please do not use the scale during charging. Only start weighing after charging is finished and removing charger.

2. DOWNLOAD AND SET UP THE APPLICATION

Search "MovingLife" in "App Store" or "Google Play" to download the Application. Or in another most convenient way by scanning the QR code below.



Tips: APP is keeping updating, so it may differ from showed on manual. For the final and accurate information, please check on APP.

3. REGISTERING AND CONNECTING

Open APP "MovingLife", connect the device with APP and submit your personal profile. (Before connection, please make sure Bluetooth is turned on and scale LCD is lighted up)

Note: Please make sure your setted personal information is correct, in order to get accurate measurements.

The LCD is lighted up

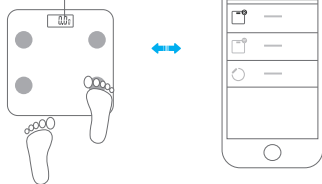

Step gently to turn on the scale

Connect the scale with APP

4. START WEIGHING

Place the scale on hard and flat floor. Stand on the scale with bare feet. The weight reading is stable and flashes, then begins to be transmitted. The scale shuts off after several seconds. APP will show and save all indexes and history record.



Place the scale on hard and flat floor.

Keep your bare feet on the electrodes of scale.

Check the measurement data on APP.

Note:

To make a proper measurement of body fat, please keep your bare feet on the electrodes of scale.

5. BUTTONS FUNCTION & PERSONAL PARAMETERS SETTING

SET :	Turn on the scale and prompt to next parameter.
▲ :	Value up by each interval press. Press and hold the button to have consecutive value added.
▼ :	Value down by each interval press. Press and hold the button to have consecutive value reduced

Note:

1. If the model has no button, please set personal parameters on APP.
2. The buttons are only for visitors and the default user code is 0. You can't set user code on scale, APP will distribute one code automatically. Please set personal parameters on APP.

Parameters can be set in the following range:

Gender	Height	Age
Male/ Female	100~250cm	10~100

6. MULTIPLE USERS SUPPORTED

The scale can be connected with multiple users and each user can save max.15 sets data. Data will be synchronized once APP is switched on.

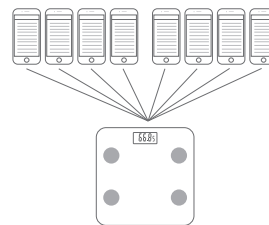

Note: Final user amount depends on the product.

7. LCD ICONS INDICATION

Icons	Indication	Icons	Indication
	Fat%		Hydration%
	Bone		Muscle%

Icons	Indication
	Fat status indication
	Thin
	Slim
	Normal
	Heavy
	Overweight

Note: Only for product with colorful LCD display.

Icons	Indication
0000	Fat Measuring
Err	Over-load Indication
ErrL	Low Fat% Indication
Lo	Low Battery Indication
[Calibration
Errh	High Fat% Indication

8. WEIGHT UNIT SETTING AND SCALE RESTARTING

Please set weight unit on APP or press UNIT button on back of the scale to convert unit.

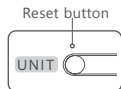

Back of the scale

Note: Please press this button to reset if the scale can't work normally.

ABOUT THE BODY FAT SCALE

The product is a smart body fat scale with a high-precision strain gauge sensor, which can help you to store and keep track of your weight on smart phone. This scale can transmit your weight data to your smart phone via Bluetooth technology, as well as make graph of your weight results, from which you are able to keep track of the trend anytime. Download the App on your phone to use Smart scale, you will start your first step of weight control.

ADVISE FOR USE & CARE

- 1.To ensure the accuracy of the data, it is recommended that each measurement be carried out at the same time of day.Don't use in strong electro-magnetic condition and field with intense shake .
- 2.Stand on the scale steadily and touch the electrodes on the platform with your bare feet. Tip over will lead to a fall when you step on the edge of one side of the scale. Keep standing firmly on scale when in use.
- 3.Do not use the scale in humid, overheat environment.(Temperature range from 5 C to 35 C)
- 4.When the battery runs out, please remove the battery in time to prevent leakage of the battery lead scale body corrosion;
- 5.Do not drop, shock or strike the scale as it is a precise instrument.
- 6.Keep the scale clean. Do not use acid cleaning agent.

USER-FRIENDLY TIPS

The product can be used to weigh and calculate body fat % & hydration % after you set gender/height/age parameters ect. These measurements are only indicative for body fat status.

This product is not for medical treatment and can't be used in any medical institution. Growing children, pregnant women, those with symptoms of edema and those on heart bypass treatment are not suggested to use the product.

FAQ

The software can't obtain weighing results from Smart scale.

- Please confirm the connection sign on the App interface to know the connection status.
- Confirm the Bluetooth is on in your device and the Smart scale is on within the valid range of signal coverage.
- Check whether the battery power is running low, please replace with a new battery.
- Relaunch the application.
- Turn off the Bluetooth and on again, then bridge the Bluetooth connection between scale and smart phone again.

Fail to connect to your device

- Please make sure only one device is setting up connection with the Smart scale.
- Please make sure your device is equipped with Bluetooth 4.0 or above.

LCD has no response

- Please first check the batteries and replace them if necessary
- Repairs may only be carried out by our authorized customer service or dealers.

This device complies with Part 15 of the FCC Rules.

Operation is subject to the following two conditions:

- (1) This device may not cause harmful interference, and
- (2) This device must accept any interference received, including interference that may cause undesired operation.

NOTE: This equipment has been tested and found to comply with the limits for a Class B digital device, pursuant to part 15 of the FCC Rules. These limits are designed to provide reasonable protection against harmful interference in a residential installation. This equipment generates uses and can radiate radio frequency energy and, if not installed and used in accordance with the instructions, may cause harmful interference to radio communications. However, there is no guarantee that interference will not occur in a particular installation. If this equipment does cause harmful interference to radio or television reception, which can be determined by turning the equipment off and on, the user is encouraged to try to correct the interference by one or more of the following measures:

- Reorient or relocate the receiving antenna.
- Increase the separation between the equipment and receiver.
- Connect the equipment into an outlet on a circuit different from that to which the receiver is connected.
- Consult the dealer or an experienced radio/TV technician for help

Changes or modifications not expressly approved by the party responsible for compliance could void the user's authority to operate the equipment.

The product picture is indicative only.
Appearance specifications please in kind prevail.

Manufacturer: Zhongshan Camry Electronic Co., Ltd.
Address: Baishawan Industrial Park, Qiwan Road(N),
East District, Zhongshan City, Guangdong Province
Postal Code: 528403
Tel: 0760-88235622
Fax: 0760-88235600
Email: sales@camry.com.cn

