

PANORAMA™

digital color video monitor



Thank you for purchasing the Panorama™ Digital Color Video Monitor by Summer Infant. This quick start guide will illustrate the few simple steps to get your device up and running.

SET-UP 1

Charge the Handheld

Charge for 4-5 hours.

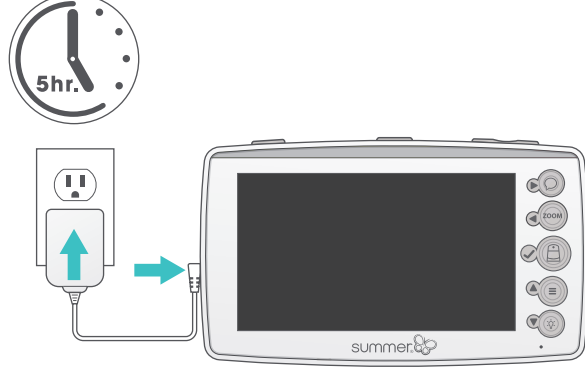

Install the Camera

Plug in camera. Place camera on a flat surface, such as a tabletop, or shelf or mount the camera on a wall using the screw and wall anchor provided.

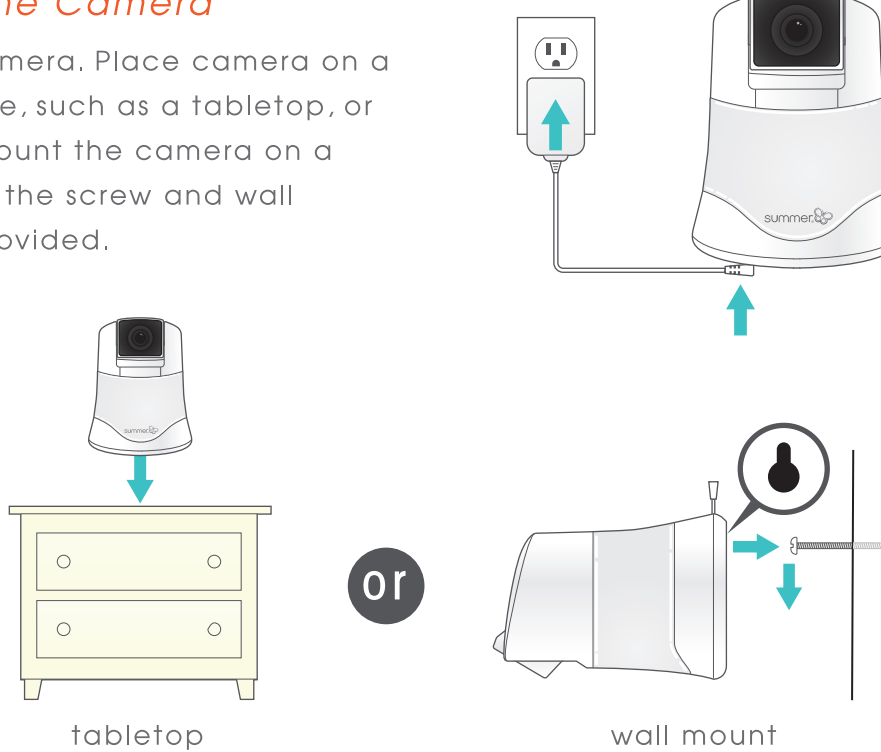

Secure the Camera Cord

NEVER place the camera or cords within 3-feet of the crib. Secure the cord to your wall using the 6 security clips included to keep the cord away from baby's reach.

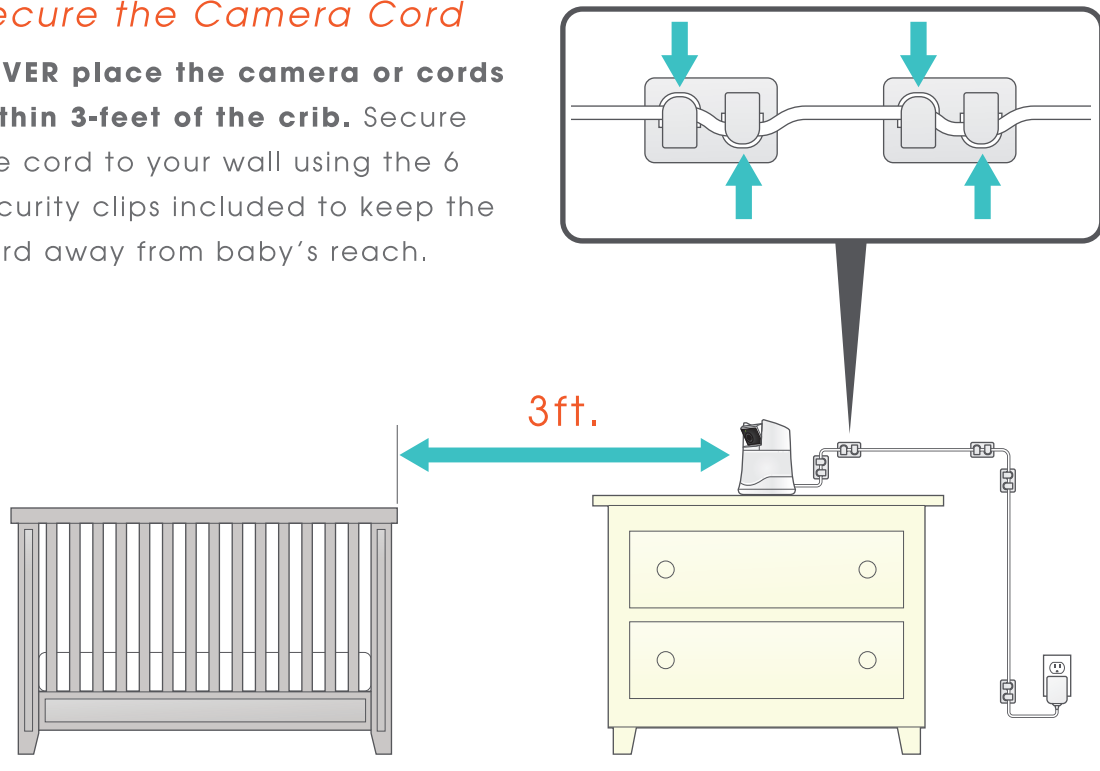

Read all warnings prior to using this product.

⚠ WARNING

STRANGULATION HAZARD: Children have strangled in cords. Keep this cord out of the reach of children (more than 3 ft. (0.9m) away).

Power on the Camera and Handheld

Press the ON/OFF/Nightlight button on the **camera** and hold for 3 seconds. A green light will appear near the lens.

Press and hold the power button on the **handheld** unit for 3 seconds. The handheld will automatically sync with the camera. (The handheld unit and the camera are paired at the factory for privacy reasons. If the handheld and camera are not paired with each other for any reason, see pairing section in the user guide.)



Congratulations! You are now ready to use your Panorama™ Digital Color Video Monitor!

SCREEN ICONS & FUNCTION BUTTONS 2

Screen Icons

- Nightlight On (Red/Blue)
- 71°F Temperature
- Reception
- Current Viewing Camera (1-4)
- Battery Life/ Plugged In

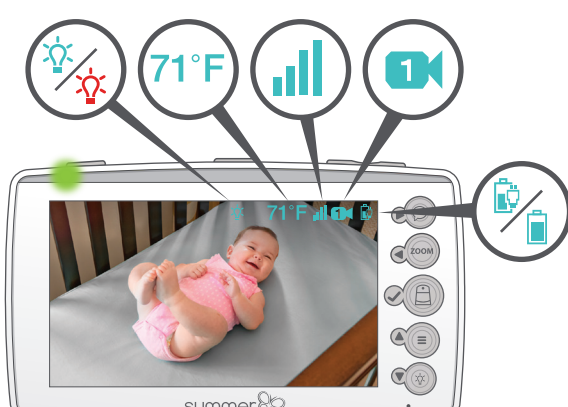

Function Buttons

- Power
- Video
- Volume Control
- Talkback/Navigate Right
- Zoom/Navigate Left
- Camera Control/Enter
- Menu/Navigate Up
- Nightlight/Navigate Down



Pan/Tilt Camera

Press the camera button on the handheld to activate the camera's remote pan and tilt. Use the arrows buttons to pan left/right and tilt up/down. Press the camera button again to exit pan mode.

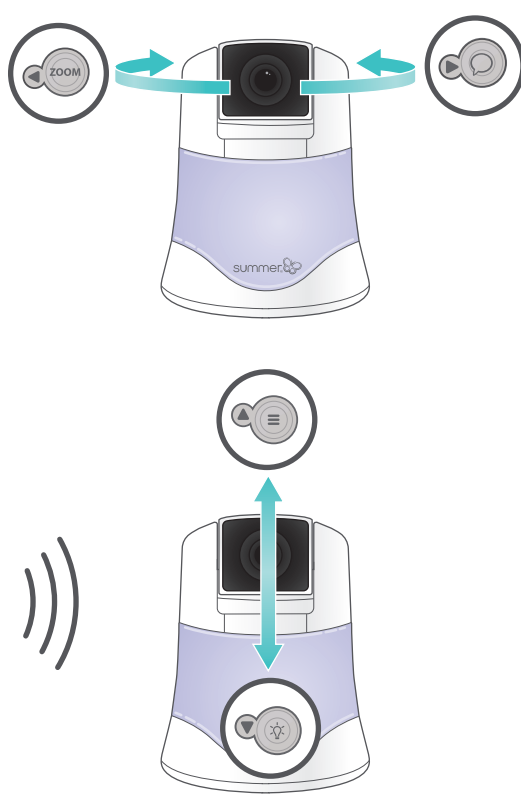

Nightlight

Press the nightlight button on the handheld to activate the soft glow nightlight on the camera. The light will glow blue. Blue light acts as a soothing soft glow nightlight. Nightlights are comforting to little ones, especially toddlers who become scared in a pitch black room.

The nightlight can be turned on or off from the camera by pressing the ON/OFF/Nightlight button.

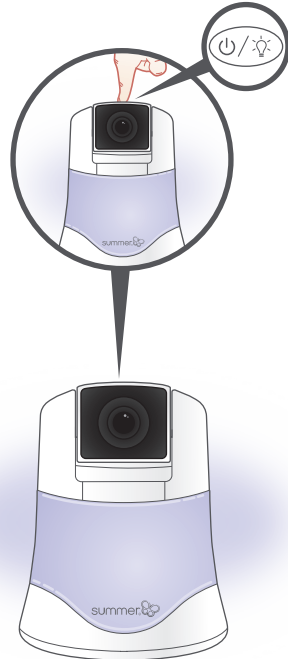
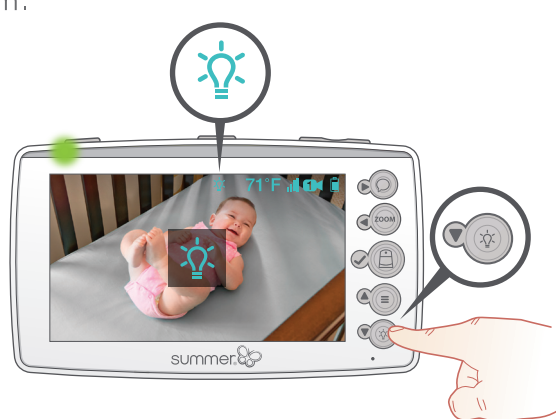

Press the nightlight button again to change the nightlight color to red. Red light helps soothe infants to sleep. This color is prominent in the sunset, nature's very own way of telling your little one it's time to go to sleep. An added bonus: young baby's find red light soothing as it is a familiar color to them- it's the only color light your baby was able to see in the womb.

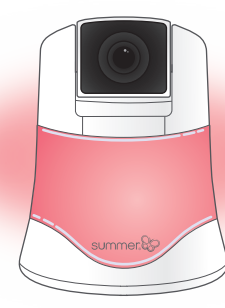
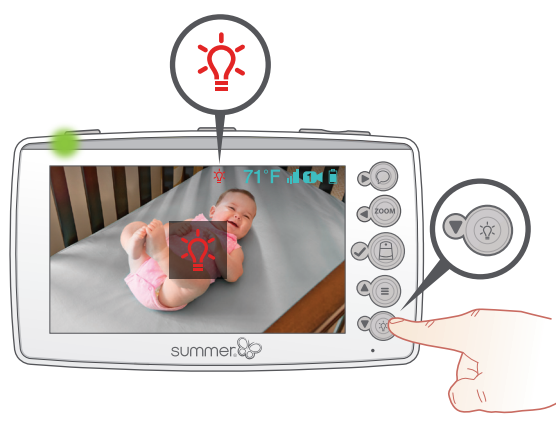

Zoom

Press the zoom button to magnify the screen. Press the button again to zoom out.



Talk-back

Press and hold the talk-back button to activate the talk-back feature. Release the button to end talk-back mode.

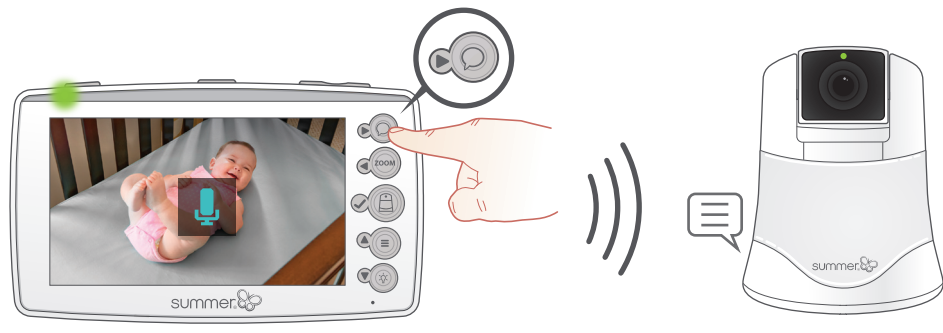

Sound Activated Lights

The LED light bar on the top of the handheld will light up as it picks up noises. Softer sounds will light up the green LEDs. Louder noises will light up the red LEDs.



Video On/Off

Turn off the handheld's video by pressing the VIDEO button. The screen will go dark. This feature allows you to preserve battery life when not plugged into A/C adapter. The audio feature will remain activated allowing you to monitor sounds. Press the button again to resume video monitoring.



Brightness

Adjust the handheld screen brightness by pressing the menu button. Select brightness from the menu and press the camera/enter button. Use the up and down arrow buttons to adjust the brightness.



For understanding additional Menu features including: scan, select camera, delete camera, pair, and exit menu, please refer to the user's guide.

FCC Caution:

Any Changes or modifications not expressly approved by the party responsible for compliance could void the user's authority to operate the equipment.

This device complies with part 15 of the FCC Rules. Operation is subject to the following two conditions: (1) This device may not cause harmful interference, and (2) this device must accept any interference received, including interference that may cause undesired operation.

FCC Radiation Exposure Statement:

This equipment complies with FCC radiation exposure limits set forth for an uncontrolled environment .This equipment should be installed and operated with minimum distance 20cm between the radiator& your body.

This transmitter must not be co-located or operating in conjunction with any other antenna or transmitter.

IC Warning

(1) this device may not cause interference, and

(2) this device must accept any interference, including interference that may cause undesired operation of the device.

Le présent appareil est conforme aux CNR d'Industrie Canada applicables aux appareils radio exempts de licence. L'exploitation est autorisée aux deux conditions suivantes : (1) l'appareil ne doit pas produire de brouillage, et (2) l'utilisateur de l'appareil doit accepter tout brouillage radioélectrique subi, même si le brouillage est susceptible d'en compromettre le fonctionnement

The device is compliance with RF exposure guidelines, users can obtain Canadian information on RF exposure and compliance.The minimum distance from body to use the device is 20cm.

Le présent appareil est conforme

Après examen de ce matériel aux conformité ou aux limites d'intensité de champ RF, les utilisateurs peuvent sur l'exposition aux radiofréquences et la conformité and compliance d'acquérir les informations correspondantes. La distance minimale du corps à utiliser le dispositif est de 20cm.