

PROBLEM SOLVING:

Problem	Solution
No sound coming from speaker	<ul style="list-style-type: none"> • Make sure both Units are "ON." • Set volume to a higher setting.
Static	<ul style="list-style-type: none"> • Make sure both Units are on the same channel (try using the other channel if necessary). • Move the Parent's Unit closer to the Baby's Unit. • Move Parent's Unit away from other monitors, cordless phones, walkie-talkies, etc.
Squealing noise	<ul style="list-style-type: none"> • Parent's Unit and Baby's Unit too close together – move further apart. • Turn down the volume on either or both Units.
Weak reception or no reception	<ul style="list-style-type: none"> • Make sure both Units are turned on. • Make sure both Units are on the same channel (try using the other channel if necessary). • Ensure both Units are upright. • Move Parent's Unit closer to the Baby's Unit. • Make sure the Battery is charged.

If you experience a problem that is not noted in this manual, please do not return the product to the store. Our Customer Relations Department may have a simple solution to your problem. Please contact us at 1-800-268-6237 or e-mail us at customerservice@summerinfant.com.

FCC Information

This device complies with part 15 of the FCC Rules. Operation is subject to the following two conditions: (1) This device may not cause harmful interference, and (2) this device must accept any interference received, including interference that may cause undesired operation. CAUTION: Changes or modifications not expressly approved by Summer Infant, Inc. could void the user's authority to operate the equipment. NOTE: This equipment has been tested and found to comply with the limits for a Class B digital device, pursuant to part 15 of the FCC Rules. These limits are designed to provide reasonable protection against harmful interference in a residential installation. This equipment generates, uses and can radiate radio frequency energy and, if not installed and used in accordance with the instructions, may cause harmful interference to radio communications. However, there is no guarantee that interference will not occur in a particular installation. If this equipment does cause harmful interference to radio or television reception, which can be determined by turning the equipment off and on, the user is encouraged to try to correct the interference by one or more of the following measures:

- Reorient or relocate the receiving antenna.
- Increase the separation between the equipment and the receiver.
- Connect the equipment into an outlet on a circuit different from that to which the receiver is connected.
- Consult the dealer or an experienced radio/TV technician for help.

We at Summer Infant stand behind all of our products. If you are not completely satisfied or have any questions, please contact our Customer Service Department at 1-800-268-6237 or e-mail us at customerservice@summerinfant.com.

Summer Infant, Inc.
© 2004 Summer Infant, Inc.,
6 Blackstone Valley Place Suite 206,
Lincoln, RI 02865 USA
www.summerinfant.com
MADE IN CHINA.

Summer Infant Europe, LTD.
Summer Infant Europe, LTD.,
20 Sparrows Herne, Bushey,
Hertfordshire WD23 1FX UK
44 (0)20 8420 4429
Colors and styles may vary.

9/04



BABY'S UNIT



PARENT'S UNIT

02120

Please read the following instructions and warnings carefully. Keep this instruction manual for future reference.

Tools required (not included): Phillips head and small flathead screwdriver.

In portable mode, parent's unit requires one rechargeable battery (included).

For Technical Support Call 1-800-268-6237 or E-Mail at customerservice@summerinfant.com

WARNING:

This product contains small parts. Adult assembly required. required.

INSTRUCTION MANUAL

BABY'S QUIET SOUNDS™ 900 MHZ RECHARGEABLE MONITOR WITH NIGHTLIGHT

Thank you for buying the Baby's Quiet Sounds™ 900 MHz Rechargeable Monitor with Nightlight from Summer Infant. This audio monitor set is a great addition to any home. It allows parents to monitor baby in the nursery from any part of the home. The parent's unit features volume control, sound lights for added convenience, 2 channels to minimize interference and rechargeable battery. The nursery unit has a built in "soft-touch" nightlight that helps mom or dad check at night without disturbing baby.

QUICK SET UP:

Read the complete instruction manual for more detailed instructions and explanations.

- Place Baby's Unit in nursery and place near the crib (do not place in crib or within child's reach). Plug in AC Adaptor. To turn the Unit on, turn the Power Switch on and turn the Channel Selector to Channel A.
- Place Parent's Unit in another room. Plug in AC Adaptor. Turn on with Power Button. Set Channel Selector to Channel A. Set desired volume level.
- Test for sound pick up from nursery. Have an adult speak from softly to loudly. LEDs will illuminate red with increasing voice volume. Set Parent's Unit to desired volume level.

⚠ WARNING: THIS PRODUCT CANNOT REPLACE RESPONSIBLE ADULT SUPERVISION.

- Prevent cord entanglement – do not place Baby's Unit in crib or within arm's reach of baby. Never use extension cords with AC adapters. Only use the AC Adapters provided.
- When an AC Adapter is plugged into an electrical outlet, do not touch the exposed end.
- Test monitor before first use, periodically, and when changing location of the Baby's Unit or Parent's Unit.
- Do not use monitor near water (such as bathtub, sink, etc.).
- Keep monitor away from heat sources (such as stoves, radiators, etc.) and make sure there is proper ventilation (not on sofas, cushions, beds, etc. which may block ventilation).
- Nursery monitors use public airwaves to transmit and receive signals. This monitor may pick up signals from other monitors or similar devices, and signals broadcast by this monitor may be picked up by other receivers.
- This product is not a toy. Do not allow children to play with it.
- This product contains small parts. Adult assembly required. Exercise care when unpacking and assembling product.

⚠ BATTERY WARNING:

- Use only the original battery pack. Warranty void if other batteries are used. Please contact Summer Infant, Inc. for a replacement battery pack. Contact information can be found on the last page of these instructions.
- Unplug the rechargeable battery pack pig tail when the product is stored for long periods of non-use.
- Dispose of exhausted batteries properly.

⚠ CAUTION:

KEEP SMALL PARTS OUT OF CHILD'S REACH.

FEATURES & COMPONENTS:

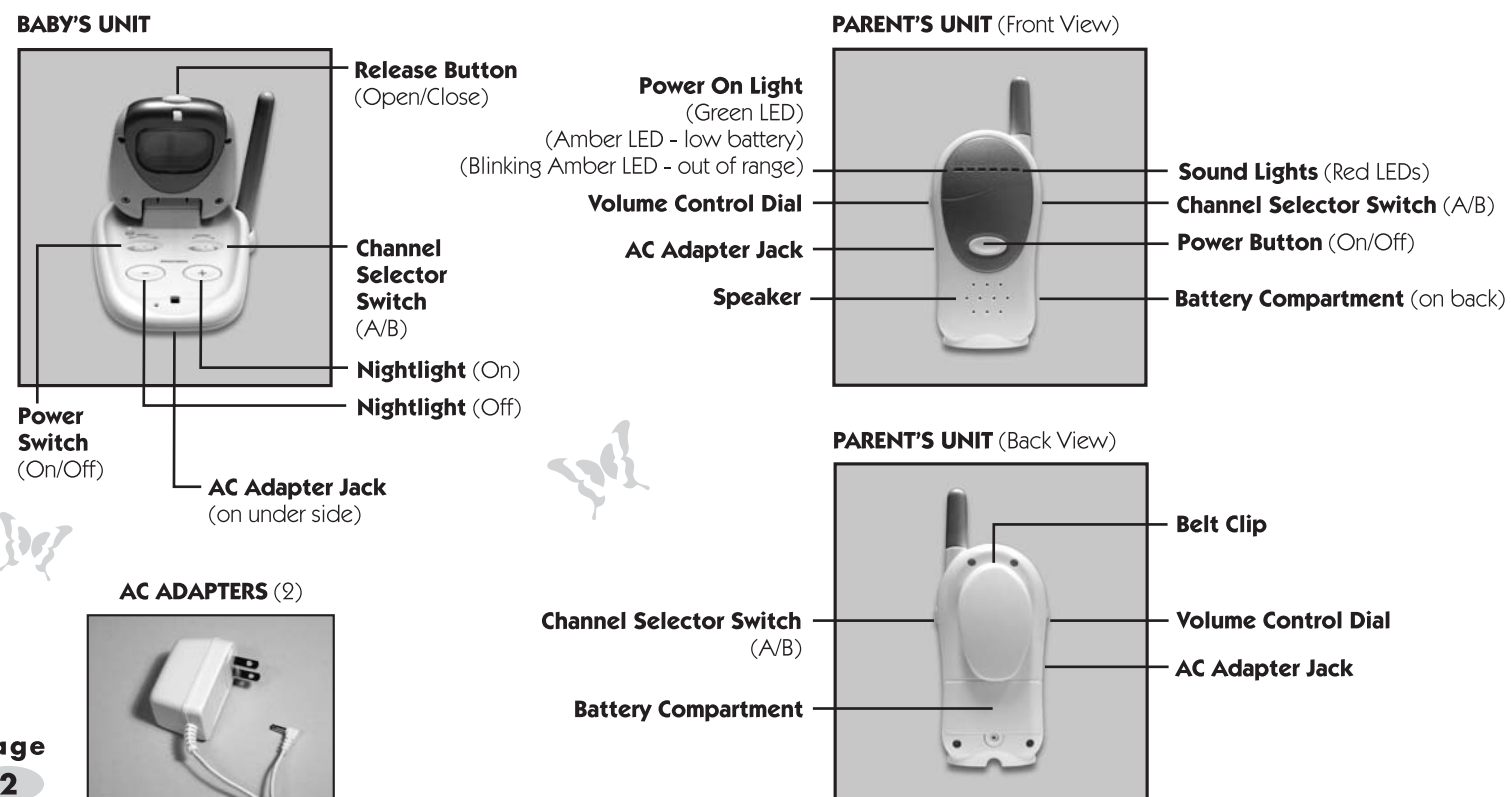

SET UP & USE:

Baby's Unit

1 Place the Baby's Unit in the nursery near the crib on a flat surface, such as a dresser, bureau or shelf (not in the crib or within child's reach). Insert AC Adapter into the AC Adapter Jack on the bottom of the Baby's Unit, as shown in Figure A. Plug the AC Adapter into a standard electrical outlet.

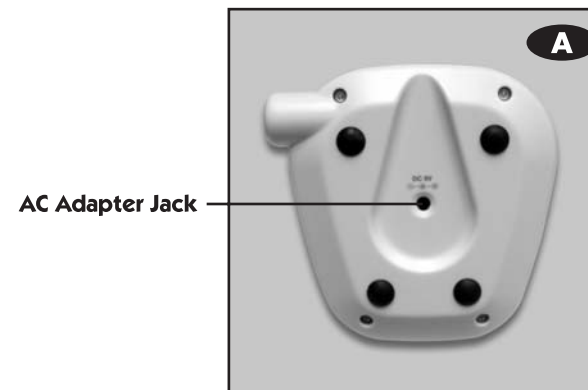

Note: Be Sure to keep all cords out of baby's reach.

2 To turn the Baby's Unit on, turn the Power Switch to On and position the Channel Selector Switch (A/B) to Channel A.

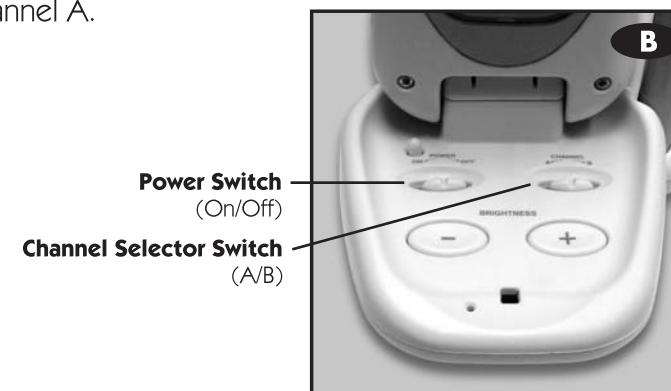

Parent's Unit

1 Place the Parent's Unit in the room from which you want to monitor your baby (ie. bedroom or living room). Plug an AC Adapter into the AC Adapter Jack on the Parent's Unit and the other end into a standard electrical outlet.

2 Position the Channel Selector (A/B) to channel A. Turn the Unit on with the Power Button. The Sound LEDs will glow with increasing voice volume.

3 Set Volume to desired level using Volume Dial.

Testing the Product

You should be able to clearly hear all levels of sound coming from the Baby's Unit through the Speaker on the Parent's Unit. Test both channels for best performance, but ensure that both Units are on the same channel. If no sound comes from the Speaker of the Parent's Unit when you perform these tests, check to make sure all cords are fully plugged in and connected and battery is fresh. Make sure both Units are turned on.

To Use the Parent's Unit in Portable Mode

Installing the battery:

For use in portable mode the Parent's Unit has one rechargeable battery.

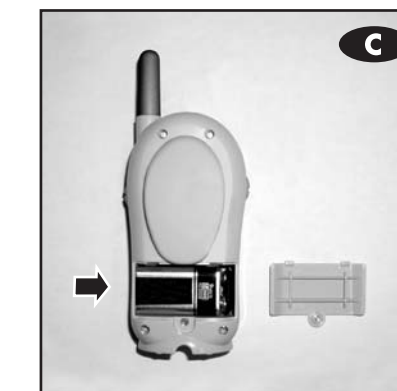

Tips:

- To conserve battery power, use AC Adapter whenever possible.

Belt Clip:

For convenience and portability, you can clip the Parent's Unit to your belt or waistband after a battery has been installed.

