

## ESN – Serial Numbering:

**VVVVVVYYWWDLFSsssss**

VVVVVVV = 0634028 (Fixed)

Y = X is a code for manufacturing year (5=2005, 6=2006, 7=2007, etc.)

WW = XX is a code for manufacturing week (01 - 53)

D = S is a code for manufacturing day of the week (1=Monday, 2=Tuesday... 7=Sunday, etc.)

L = 1 (Fixed)

F = 3 (Fixed)

S = T (Fixed)

S = XXXXX (5 digits) is a running number restarting from "00000" every day

*Datamatrix 5.33 x 5.33mm*

*Quality Level: ECC 200*

*22 Rows, 22 Columns*

*Element Width: 6 dots*

1

2

Copyright©Nokia Corporation. All rights reserved.  
THIS DRAWING IS PROTECTED BY COPYRIGHT AS AN UNPUBLISHED WORK.  
UNAUTHORIZED REPRODUCTION OF THIS DRAWING IS NOT PERMITTED.  
THIS DRAWING CONTAINS PROPRIETARY AND CONFIDENTIAL INFORMATION.  
All dimensions are in millimeters.

## FUNCTIONAL CHARACTERISTICS KEY

- ◇ Process Capability Studies Required.  
(Total \_\_\_\_\_ pcs)
- ◆ Ongoing Statistical Process Control Required.  
(Total \_\_\_\_\_ pcs)

Artwork for laser printing  
1:1

**NOKIA**  
Nokia Corporation  
Model/Modèle: HD-1  
FCC ID: PYAHD-1  
IC: 661V-HD1

MADE IN CHINA  
FABRIQUÉ EN CHINE

**CE 0560** !



"This device complies with part 15 of the FCC Rules. Operation is subject to the following two conditions:  
(1) This device may not cause harmful interference, and (2) this device must accept any interference received,  
including interference that may cause undesired operation."

Lay-out  
1:1

**NOKIA**  
Nokia Corporation  
Model/Modèle: HD-1  
FCC ID: PYAHD-1  
IC: 661V-HD1  
VVVVVVVWDLFSssss  
MADE IN CHINA  
FABRIQUÉ EN CHINE

**CE 0560** !



"This device complies with part 15 of the FCC Rules. Operation is subject to the following two conditions:  
(1) This device may not cause harmful interference, and (2) this device must accept any interference received,  
including interference that may cause undesired operation."

VVVVVV Product code, 7 digits  
Y Year, 1 digit  
ww Week, 2 digits  
D Day, 1 digit  
L Production line, 1 digit  
F Factory code, 1 digit  
S Supplier code  
sssss Running number restarting from "00000" every day,  
5 digits

Datamatrix 5.33 x 5.33mm  
Quality Level: ECC 200  
22 Rows, 22 Columns  
Element Width: 6 dots

Material

Original Designer

**NOKIA**

Sheet 1 of 1

Original Scale 1:1

Original Size A4

Item Classification

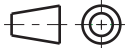

Nokia Corporation code

0.1

AVI 23.Feb.2009

Item Name

P3676

Document Number

040-076874

Doc.  
Vers.

0.2

Part  
Vers.

Name / Date

AVI 11.Mar.2009

Change Ref.

Approved / Date

TYPE LABEL HD-1 USA/CANADA

1

2