

Prepared (also subject responsible if other)

SEM/BMDM Blanche D Johnson 919-472-6790

Approved

Checked

No.

151 86-KRD 104 1025 Uen

Date

Rev

Reference

SEM/BMD/M (Robert Horton)

2004-12-3

**A**

## 1 Scope

This document specifies the marking instructions for the VDC Module, KRD 104 1025.

## 2 Label Material

Material (label) used for marking is defined in the manufacturing specification, 131 32 – KRD 104 1025.

## 3 Label Placement

The type label must be placed across the shield cans on the module according to 151 88 – KRD 104 1025.

## 4 Label Information

Each production label is to be printed with the information below. Prototypes require special marking. See section 4.1 for prototype label format.

For Production labels:

Sony Ericsson Logo	
Model Name	Manufacturing Notice
KRD Number and Revision State	Production Week
IMEI 00000000-000000-0	
IMEI bar code	
S/N TBDXXXXXXXXXXXXXXXXXX	
S/N bar code	
Type Number	
Type Approval Marks 1, 2 and 3	

Line 1: *Sony Ericsson logo* See note 1

Line 2: *Model Name:* "VDC". *Manufacturing notice:* "Made in Mexico".

Line 3: *KRD number and Revision state for the product.* *Production week of module:* yyWww. See note 2

Line 4: *IMEI* 00000000-000000-0 human readable, shall include the "-" (hyphen). See note 3

Line 5: *IMEI bar code* in code 128 format according to Ericsson corporate standard 102 01-109 See note 4

Line 6: *S/N* TBDXXXXXXXXXXXXXXXXXX human readable, **TBD** followed by the IMEI number See note 5

Line 7: *S/N bar code* in code 128 format according to Ericsson corporate standard 102 01-109

Prepared (also subject responsible if other)

SEM/BMDM Blanche D Johnson 919-472-6790

Approved

Checked

No.

151 86-KRD 104 ~~4009~~-1025 Uen

Date

Rev

Reference

SEM/BMD/M (Rick Timmons Robert Horton)

2004-09-24 12-03

HPA1

Line 8: *Type number*: “Type FAF-1031021-BV”.

Line 9: *Type approval marks: 1-3*:

1: “FCC ID: PY7FF031021” Marking – this should appear in a box

2: “IC: 4170B – FF031021” Marking

3: “CE **0682**” Marking according to 1424 – SVF 930 52 .

See note 6

**Notes:**                    **General Placement and Format Notes:**

The text should begin a minimum of 1 mm from the top of the label; type size is **TBD** mm (except for Line 1).

All text should be left justified, unless otherwise noted.

**Specific Notes for Fields:**

Note 1: Sony Ericsson Type size **TBD** mm bold. Sony Ericsson should be centered on the label.

Note 2: Marking with the time for assembly in the format year (yy) and week (ww), for example 04W51

Note 3: The IMEI number has the format: TAC-SNR-CD

For released product with revision Rxx, the IMEI is as follows:

TAC = Eight digit Type Approval Code assigned by the GSM Notified Body = **TBD**

SNR = A serial number from 000000 to 999999

CD = A check digit, from 0-9, calculated according to the Luhn formula (ISO/IEC 7812), GSM 02.16.

Note 4: IMEI bar code containing only digits. The barcode shall **not** include a hyphen (dash).

For unreleased products, with prototype revision Pxx, the test IMEI is as follows:

TAC = Eight digit code assigned by the GSM Notified Body = 00460101

SNR = A serial number from 653000 to 654999

CD = A check digit, from 0-9, calculated according to the Luhn formula (ISO/IEC 7812), GSM 02.16.

Note 5: The serial number prefix for HPDD for Celestica in Monterrey, Mexico, is **TBD**.

Note 6: Type approval mark 3 (CE, notified body number) must be minimum 5mm height. This is a regulatory requirement.

Prepared (also subject responsible if other)

SEM/BMDM Blanche D Johnson 919-472-6790  
Approved Checked

SEM/BMD/M (Rick Timmons Robert Horton)

No.

151 86-KRD 104 ~~4009~~-1025 Uen  
Date Rev Reference

2004-09-24 12- HPA1  
03

#### 4.1 Print layout for prototypes (revisions 'Pxx')

See Note 4 for prototype IMEI numbers.

Lines 8 and Line 9 shall be replaced with the following:

PROTOTYPE  
NOT TYPE APPROVED

See example labels in the following section.

### 5 Sample Labels



Sample Production Label



Prepared (also subject responsible if other)

SEM/BMDM Blanche D Johnson 919-472-6790  
Approved Checked

No.

151 86-KRD 104 ~~4009~~-1025 Uen  
Date Rev Reference

SEM/BMD/M (Rick Timmons Robert Horton)

2004-09-24 12- HPA1  
03



Sample Prototype Label

**REVISION HISTORY:**

Revision:	Date:	Revised by:	Reason for Revision
A	12-03-2004	Robert Horton	Initial Revision

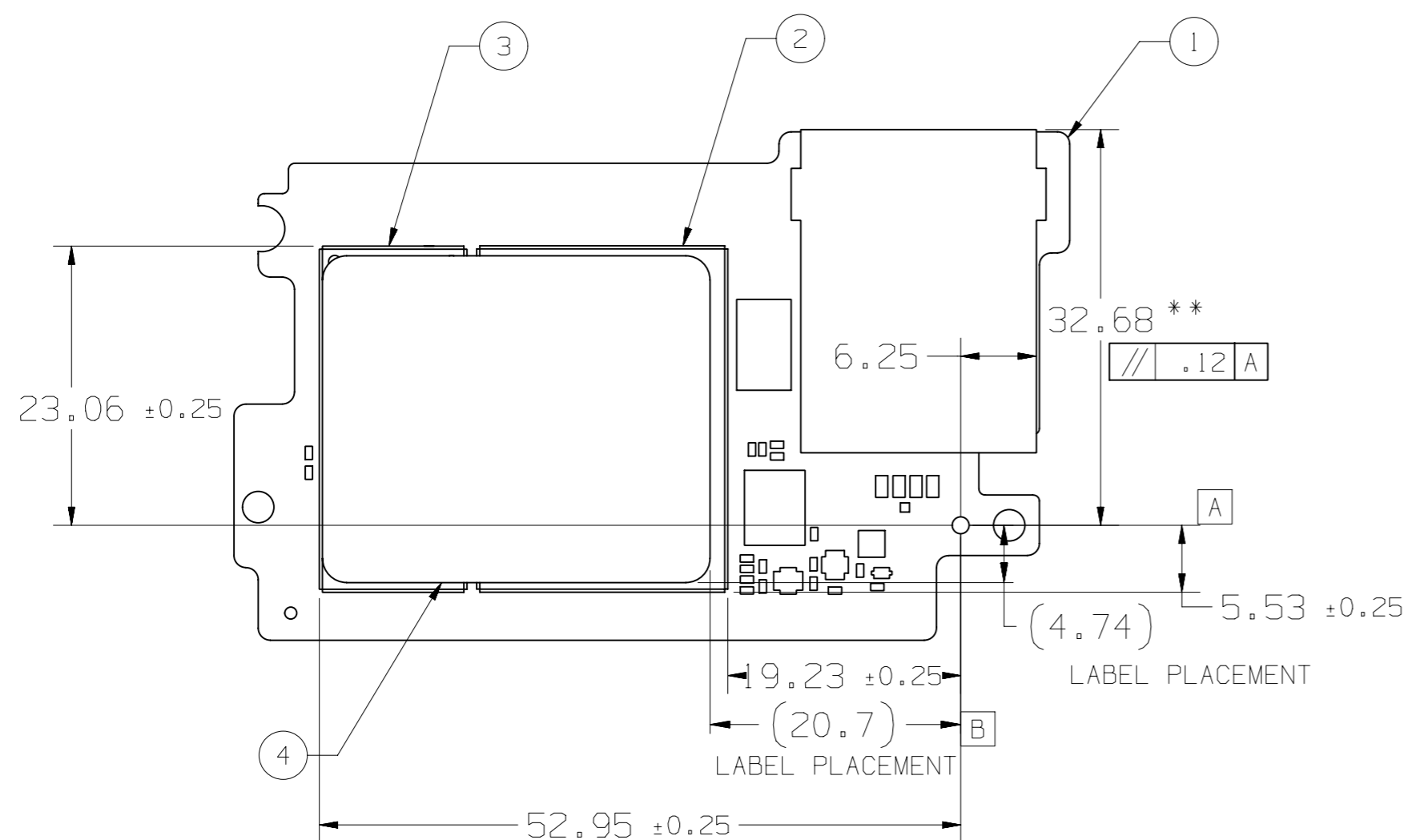
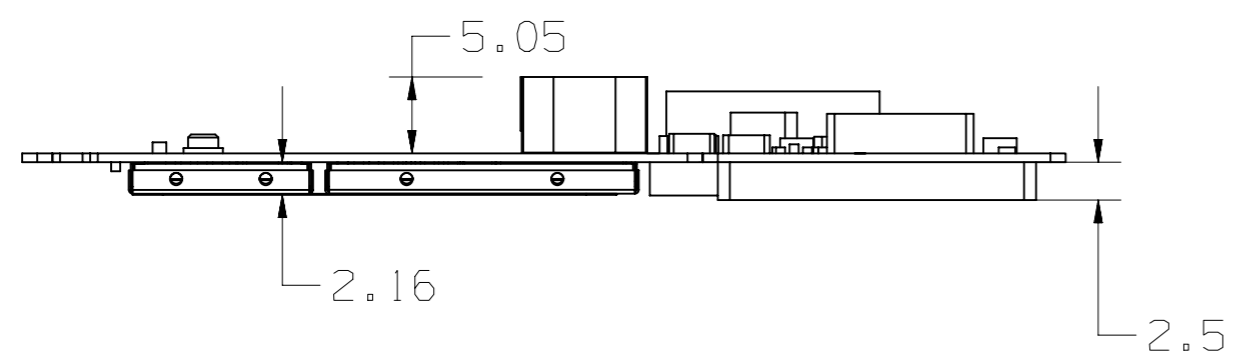

\*\* CRITICAL DIMENSION: MEASURE AT FINAL INSPECTION

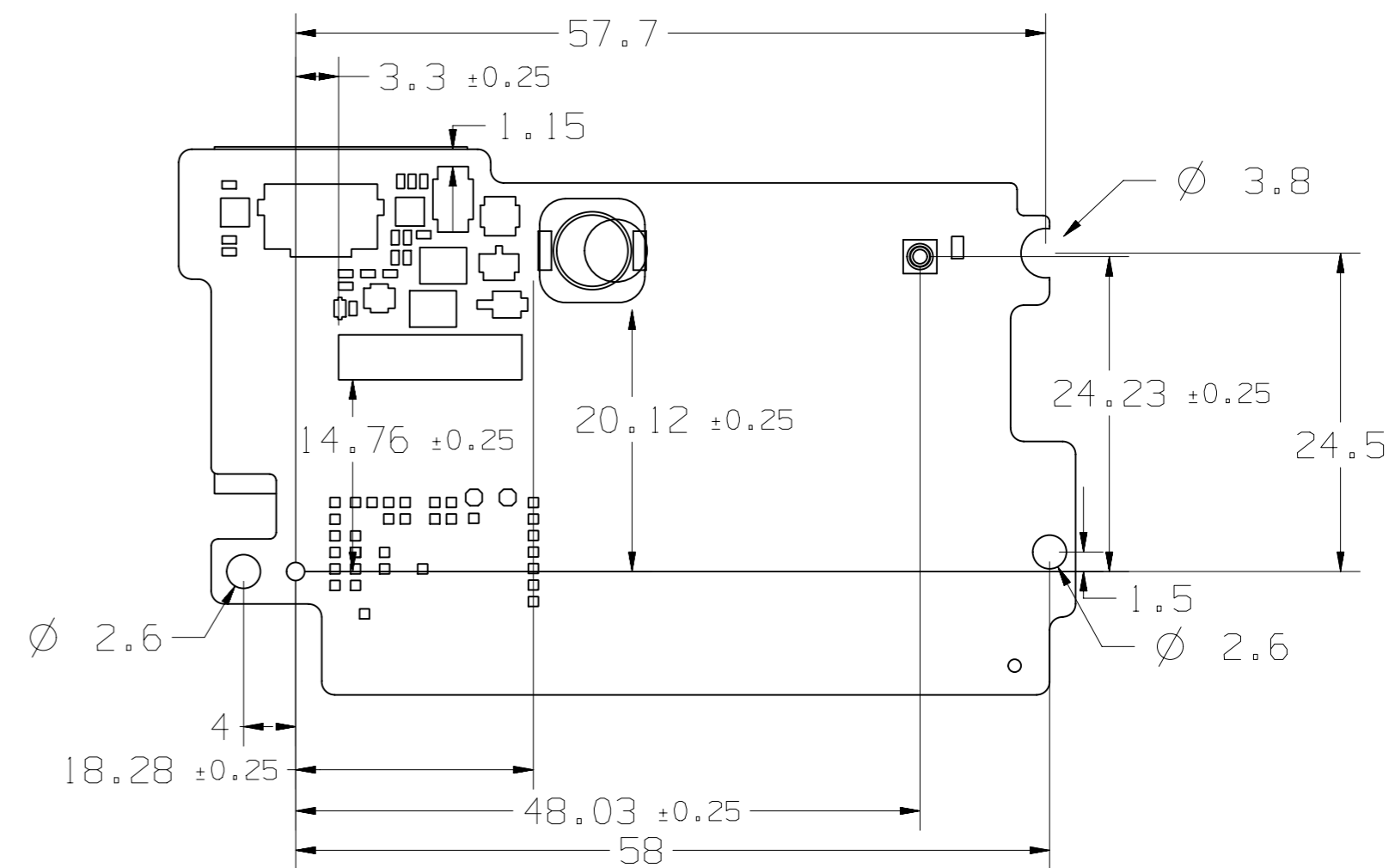
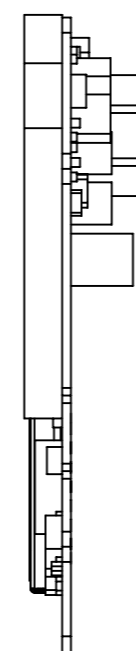

NO.	PART NUMBER	DESCRIPTION	QTY
1	TVK 117 9227	DAUGHTER CARD	1
2	SXA 134 2604	LID, BASEBAND CORE	1
3	SXA 134 2602	LID, RF CORE	1
4	SVF 930 2344	LABEL, 25.4mm X 31.75mm X .09 THK	1
<b>Sony Ericsson</b>		Prepared (Also Subject Responsible if Other) <b>JAMIE SHIFLETT</b>	
Drawing Rules ASME Y14.5M-1994		Doc Responsible/Approved	Date 01-06-05 Rev B
Tolerance X.XX ±.18		Product Name CARD, DAUGHTER, EMBEDDED, EDGE	
Reference sxa1342602.joined		Document No. 15188 - KRD 104 1025/2	Sheet 1 (1)

CONFIDENTIAL