

Company Internal
SPECIFICATION

Prepared (also subject responsible if other)

SEM/BMD/T Blanche Johnson

Approved

SEKI/BMD/TP (Pam Wood)

Checked

No.

1213-8076

Date

2008-07-28

Rev

2

Reference

Marking Drawing MD400g Type FAD-3232023- BV

Marking Drawing MD400 Type FAD-3232022- BV

General information

All bar codes, when applicable, are according to Ericsson corporate standard 102 01–109 Uen. All bar codes shall fulfill minimum print quality C according to ANSI X3.182-1990 as stated in Ericsson corporate standard 102 01–1003 Uen. No bar codes are allowed to be closer to a label edge than 2 mm (quiet zone!).

Label

The label part number: 1213-5948.

Placing

The label shall be placed on the back of the Modem according to MD400 & MD400g USB Modem Assy drawing.

The Core Unit Product Labels should be marked as described below.

Print layout (for illustration purposes only-not to scale)

Lines
1a b
2a,
3a
4a
5a, b
6a, b
7a, b
8a, b
9a, b, c





Company Internal SPECIFICATION

Prepared (also subject responsible if other)

SEM/BMD/T Blanche Johnson

Approved

SEKI/BMD/TP (Pam Wood)

Checked

No.

1213-8076

Date

2008-07-28

Rev

2

Reference

- Lines
- 1a b
- 2a,
- 3a
- 4a
- 5a, b
- 6a, b
- 7a, b
- 8a, b
- 9a, b, c



Prepared (also subject responsible if other)

SEM/BMD/T Blanche Johnson

Approved

SEKI/BMD/TP (Pam Wood)

Checked

**Company Internal
SPECIFICATION**

No.

1213-8076

Date

2008-07-28

Rev

2

Reference

Line	Definition	Format				
1a	Sony Ericsson trademark	Sony Ericsson and the Sony Ericsson trademark shall be according to the corporate standard 190 89-EN/LZT 108 5347. Height min. 2.0 mm.				
1b	Model Name	"MD400" or "MD400g" Text height min.1.5 mm.				
2a	Approval marks (1,2)	1. CE Marking. According to 1424 - SVF 930 52. 2. The Notified Body number. It shall be 0682 . The print size (height) for the notified body number and the corresponding approval marks shall be minimum 5 mm. This is a regulatory requirement.				
3a	Industry Canada marking	Industry Canada approval marking: consists of text: <table style="margin-left: 40px;"> <tr> <td>MD400g</td> <td>IC: 4170B-F3232023</td> </tr> <tr> <td>MD400</td> <td>IC: 4170B-F3232022</td> </tr> </table>	MD400g	IC: 4170B-F3232023	MD400	IC: 4170B-F3232022
MD400g	IC: 4170B-F3232023					
MD400	IC: 4170B-F3232022					
4a	FCC approval marking	FCC approval marking: consists of the text: <table style="margin-left: 40px;"> <tr> <td>MD400g</td> <td>FCC ID: PY7F3232023</td> </tr> <tr> <td>MD400</td> <td>FCC ID: PY7F3232022</td> </tr> </table>	MD400g	FCC ID: PY7F3232023	MD400	FCC ID: PY7F3232022
MD400g	FCC ID: PY7F3232023					
MD400	FCC ID: PY7F3232022					
5a	Serial number as characters	According to Ericsson group standard 0012-101. Sony Ericsson group factory number system according to Sony Ericsson corporate standard 1120-101 Factory codes: Flextronics (Malaysia) = BD3				
5b	Sales Item Number	Actual Sales Item number including Revision state (e.g. 1204-8375.1) and shall be printed. "SI XXXX-XXXX. R"				
6a	Serial number as bar code	According to Ericsson corporate standard 102 01 - 109. Height 3.0 mm				
6b	Trash can logo					

**Company Internal
SPECIFICATION**

Prepared (also subject responsible if other)

SEM/BMD/T Blanche Johnson

Approved

SEKI/BMD/TP (Pam Wood)

Checked

No.

1213-8076

Date

2008-07-28

Rev

2

Reference

Line	Definition	Format
7a	IMEI number as characters	<p>The IMEI number has format: TAC - SNR - CD</p> <p>TAC = First eight digits of the Type Approval code after assignment from the Notified Body: refer to table 1 below.</p> <p>SNR = A serial number from 000 000 to 999 999 according to factory allocation: refer to table 1 below.</p> <p>CD = A check digit, from 0-9, calculated according to the Luhn formula (ISO/IEC 7812), GSM 02.16.</p>
8a	IMEI number as bar code	The bar code shall only contain the digits of the IMEI number (no -). Height 3.0 mm.
8b	Repair year/week/revision re-work code	For service use only.
9a	Modem Core Unit Number	Actual PC Card Assembly Number including Revision state and shall be printed.
9b	Marking of origin	<p>“CU XXXX–XXXX. R”</p> <p>Marking of origin shall be printed “Made in xxxxx”</p> <p>“xxxxx” = Actual country of production in English</p>
9c	Production week	The production week shall be given as yyWww (yy = year, ww = week)

Table 1 To be completed when production numbers available

<u>Product</u>	<u>IMEI TAC code</u>	<u>IMEI SNR</u>	<u>Allocated factory</u>
MD400	00440107	000000-??????????	FSA
MD400g	00440107	000000-??????????	FSA

Company Internal
SPECIFICATION

Prepared (also subject responsible if other)

SEM/BMD/T Blanche Johnson

Approved

SEKI/BMD/TP (Pam Wood)

Checked

No.

1213-8076

Date

2008-07-28

Rev

2

Reference

Printing regulations

Font face:	OCR-B
Type size:	min. 1.3 mm
Line spacing:	min. 0.3 mm
Trade mark height:	min. 2 mm
Approval marks height:	min. 5 mm
Colour:	Black
Margins:	1.0mm clear margin on Left & Right edges 0.5mm clear margin on Top & Bottom edges

Print layout for prototypes

Line 2a is left blank

Line 3a is replaced with alternative text shown below. Type size min. 3 mm.

PROTOTYPE EP1
PROTOTYPE EP2
PROTOTYPE FP1 etc

Note: Refer to build Exemption and/or the Build Entry Request (BER) for the proper naming convention for the prototype Build.

Line 3b is added with text "NOT TYPE APPROVED"

Line 4a is left blank

Line 7a and 8a: IMEI-numbers as characters and IMEI-numbers as barcode shall be filled with the **test** IMEI number.

The test IMEI number is in the following ranges:

MD400	179400	to	182399
MD400g	455850	to	458849



Company Internal SPECIFICATION

Prepared (also subject responsible if other)

SEM/BMD/T Blanche Johnson

Approved

SEKI/BMD/TP (Pam Wood)

Checked

No.

1213-8076

Date

2008-07-28

Rev

2

Reference

Print layout (for illustration purposes only-not to scale)

- Lines
- 1a b
- 2a,
- 3a, b
- 4a
- 5a, b
- 6a, b
- 7a, b
- 8a, b
- 9a, b, c



- Lines
- 1a b
- 2a,
- 3a, b
- 4a
- 5a, b
- 6a, b
- 7a, b
- 8a, b
- 9a, b, c



1 2 3 4 5 6

REVISIONS

REV.#	DATE	DESCRIPTION	ECO #	APPROVED
1	2008/04/25	Preliminary Release		
2	2008/07/18	FPI		
3	2008/08/05	Added Label view		

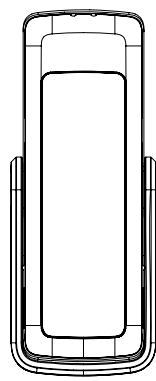
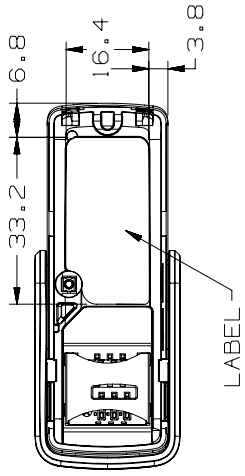
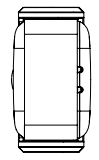
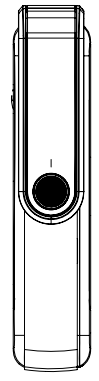
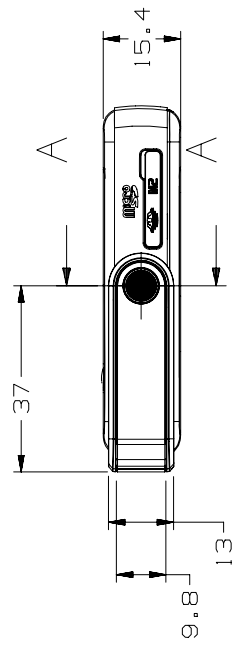
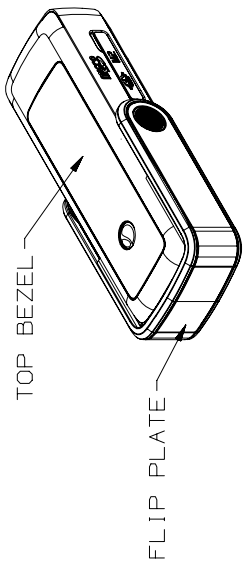
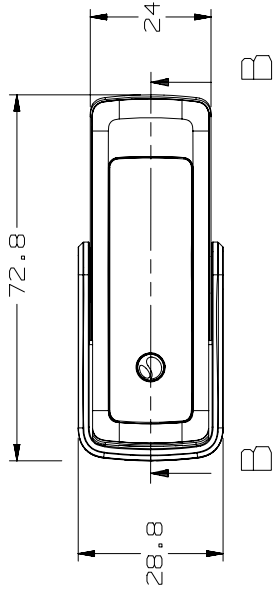

Sony Ericsson		Prepared (Also Subject Responsible if Other): BUSA/G. ANDERTON	Date: 08/04/08
Drawing Rules	ASME Y14.5M-1994	Responsible/Approved	Rev 08/04/08 3
Tolerance		Product Name	
Reference	1210-5072	MD400 Mechanical Assembly	Sheet
Scale	NONE	Document No.	1 (3)
	Units mm	Size A3	

CONFIDENTIAL



10x10 mm

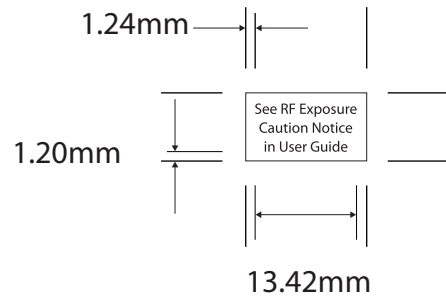

composite view

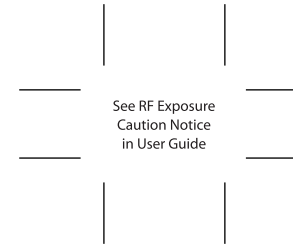

Black ink

CONFIDENTIAL

REVISIONS

REV.	DATE	DESCRIPTION	ECO #	APPROVED
1.0	2008/9/8	Preliminary Release		
1.1	2008/9/9	Added label note.		

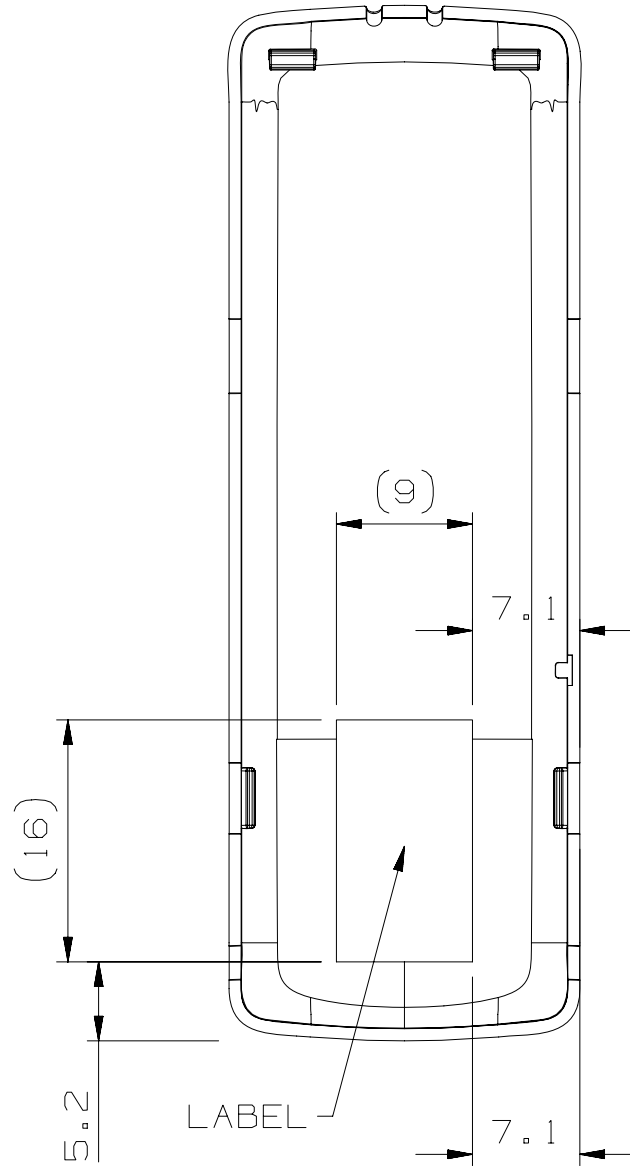

Copyright (c) Sony Ericsson All Rights Reserved

Sony Ericsson

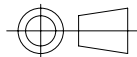

Prepared (Also Subject Responsible if Other)

BMD/H/M B.MELLAGE

Drawing Rules ASME Y14.5M-1994

Doc Responsible/Approved
BMD/H/M B.MELLAGE

Date 09/09/08
Rev 1

Tolerance
 ± 0.5 mm

Product Name
BOTTOM COVER ASSY

Reference

Document No.

Sheet

Scale Units mm Size **A4P**

1219-0594 Uen

1 (1)