

REVISIONS						
REV	ECD #	DATE	BY	DESCRIPTION	APPROVED	
1	604113	01/08/08	V.N	FIRST RELEASE	M. CHAD	
2	604197	03/10/08	V.N	ADDED RECESS SLOT ON BOT METAL, RIDS FOR PCB POSITION & CHAMFER IN SIM AREA; CHNG SIM OPENING; REMOVED ANTENNA RIB	M. CHAD	
3	604278	05/08/08	V.N	SPLIT UP MECH DRAWING & UPDATED TOLS 'S BLOCK	M. CHAD	

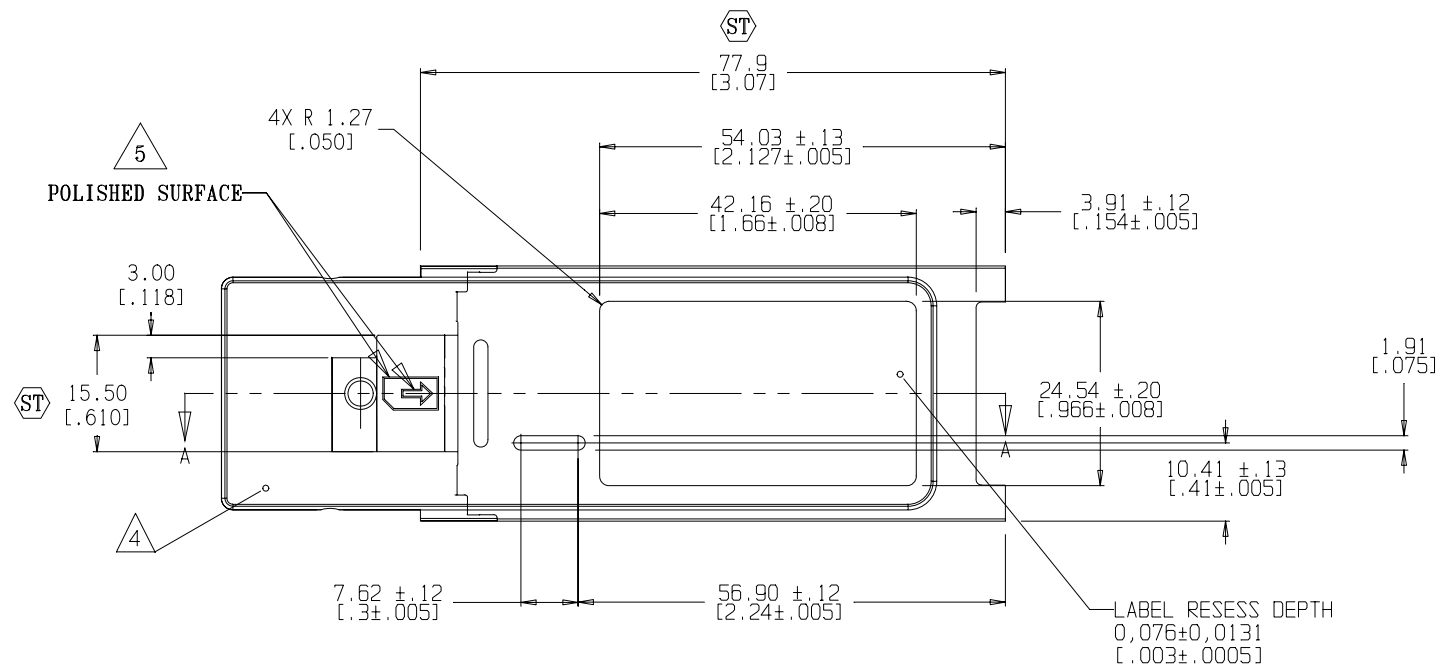

- NOTES:
- ALL DIMENSIONS ARE IN MILLIMETERS. INCHES ARE INDICATED IN PARENTHESIS [ ].
  - MATERIAL:  
 PLASTIC: GE CYCLOYD C1200HF COLOR: BLACK NO. 701  
 METAL: 304 SS FULLY ANNEAL THICKNESS (.008 +/-0.0005) [.20 +/-0.01]  
 S/M#: SMX1SSXCC0346 (BOTTOM)
  - SURFACE TREATMENT METAL: BRUSH FINISH
  - SURFACE TREATMENT: VD1 NO.30
  - SURFACE TREATMENT: VD1 NO.A-3
  - SURFACE TREATMENT: SPI NO. C-3, ALL INSIDE SURFACES.
  - PAD PRINT LETTERING USING ARTWORK XC-15V20X00541. COLOR PANTONE 800C SILVER METALLIC.

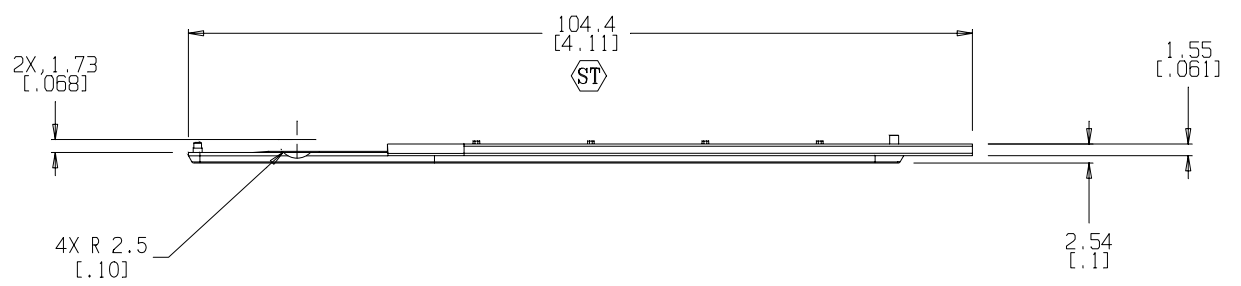
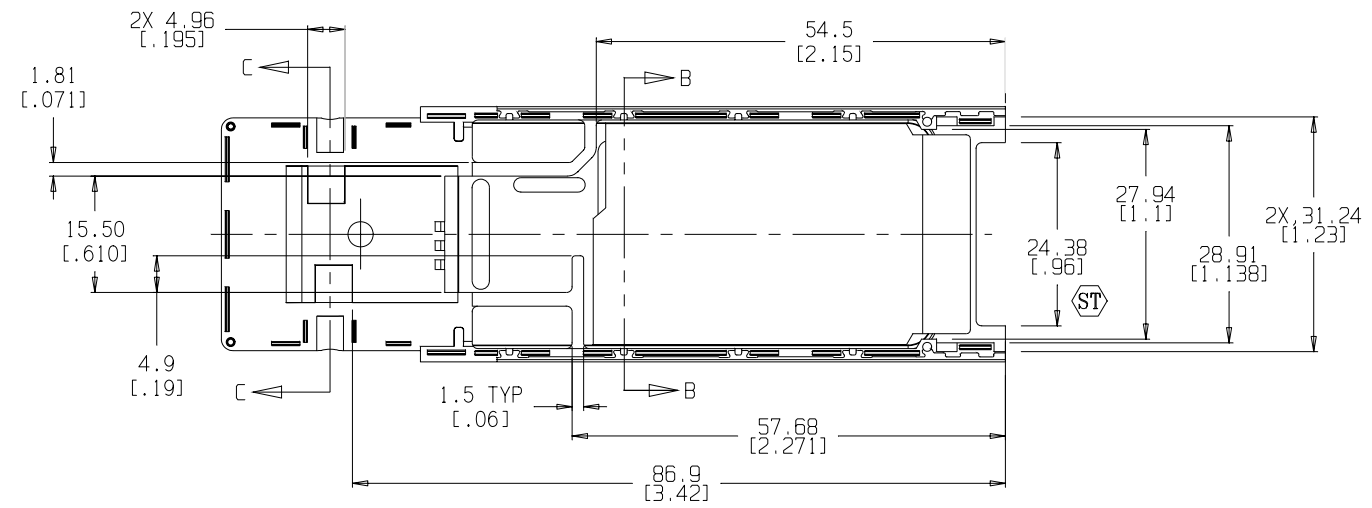

THIS DOCUMENT CONTAINS INFORMATION WHICH IS PROPRIETARY TO DUEL SYSTEMS AND MAY NOT BE REPRODUCED, OR THE CONTENTS DIVULGED WITHOUT WRITTEN CONSENT OF AN OFFICER OF DUEL SYSTEMS	UNLESS OTHERWISE SPECIFIED DIMENSIONS ARE IN MILLIMETERS	THIRD ANGLE PROJECTION	MATERIAL: SEE NOTE #2	DRWN S. BURR	11/19/07	<b>DUEL SYSTEMS</b> 1750 JUNCTION AVE SAN JOSE, CA 95112 408-436-4931 408-436-6063 FAX	TITLE BOTTOM COVER EXPRESSCARD/34 EXTENDED, CLOSED BACK WITH SIM I/O (SONY ERICSSON)	PART NUMBER XCB15V20X00541	
	TOLERANCES: LINEAR .2 [.01] ANGULAR .1 [.004] 0.5°	CORNERS EDGES BROKEN	OUTSIDE: .01 MAX INSIDE: .01 MAX	SURFACE TREATMENT: SEE NOTE #3	DSGN				B SHEET
		SCALE: 1/1	HARDNESS: ---	CHK M. CHAD	05/08/08				

**Company Internal  
SPECIFICATION**

Prepared (also subject responsible if other)

No.

SEKI/BMD/TP Ladan Unsworth

1213-2495

Approved

Checked

Date

Rev

Reference

SEKI/BMD/TP (Pam Wood)

2008-06-04

2

## Marking Drawing EC400g Type FAD-3232013- BV

### General information

All bar codes, when applicable, are according to Ericsson corporate standard 102 01–109 Uen. All bar codes shall fulfill minimum print quality C according to ANSI X3.182-1990 as stated in Ericsson corporate standard 102 01–1003 Uen. No bar codes are allowed to be closer to a label edge than 3 mm (quiet zone!).

#### Label

The label shall be 40.8mm (L) x 23.3mm (H)

#### Placing

The label shall be placed on the back of the PC card according to ExpressCard Assy drawing number 1207-5147.

The Core Unit Product Labels should be marked as described below.

#### Print layout (for illustration purposes only-not to scale)

