

Congratulations on your purchase of the Sony Ericsson Walkman® W888c. Enjoy your music on the go with this ultra-slim music phone. For additional phone content, go to www.sonyericsson.com/fun.

Register now to get a suite of tools, free online storage, special offers, news and competitions at www.sonyericsson.com/myphone.

For product support go to www.sonyericsson.com/cn.

Added dimensions – Accessories from Sony Ericsson

Portable Speakers MPS-60

Small yet powerful speakers that fit in your pocket.



Stereo Bluetooth™ Headset HBH-DS970

Wireless music in stereo quality.
Talk/standby/music: up to 6/300/6 hrs
Weight: 27g



Bluetooth™ Music Receiver MBR-100

Stream music wirelessly from your mobile phone to your hi-fi system.



The full range of accessories may not be available in every market. For more information visit www.sonyericsson.com/accessories.

Contents

Getting started 4

SIM card, battery, turning on, help, calls.

Getting to know the phone 9

Phone overview, icons, menus, entering letters, activity menu, file manager.

Calling 22

Calls, contacts.

Messaging 30

Text messaging, picture messaging, email, My friends.

Imaging 34

Camera, video, pictures.

Entertainment 36

Handsfree, Walkman® player, video player, TrackID™, PlayNow™, ringtones and melodies.

Connectivity 42

Using Internet, RSS, USB cable, update service.

Important information 46

Index 54

www.sonyericsson.com/cn

At Sony Ericsson Product Support there is more information and help to get the most out of your product:

User guide with additional information, troubleshooting, tips and tricks, software, settings for Internet and messaging.

Sony Ericsson

GSM 900/1800/1900

This User guide is published by Sony Ericsson Mobile Communications AB or its local affiliated company, without any warranty. Improvements and changes to this User guide necessitated by typographical errors, inaccuracies of current information, or improvements to programs and/or equipment, may be made by Sony Ericsson Mobile Communications AB or its local affiliated company at any time and without notice. Such changes will, however, be incorporated into new editions of this User guide. All rights reserved.

©Sony Ericsson Mobile Communications AB, 2006

Publication number: EN/LZT 108 9038 R1A

Please note:

Some of the services in this User guide are not supported by all networks. *This also applies to the GSM International Emergency Number 112.*

Please contact your network operator or service provider if you are in doubt whether you can use a particular service or not.

Please read the *Guidelines for safe and efficient use* and the *Limited warranty* chapters before you use your mobile phone.

Your mobile phone has the capability to download, store and forward additional content, e.g. ringtones. The use of such content may be restricted or prohibited by rights of third parties, including but not limited to restriction under applicable copyright laws. You, and not Sony Ericsson, are entirely responsible for additional content that you download to or forward from your mobile phone. Prior to your use of any additional content, please verify that your intended use is properly licensed or is otherwise authorized. Sony Ericsson does not guarantee the accuracy, integrity or quality of any additional content or any other third party content. Under no circumstances will Sony Ericsson be liable in any way for your

improper use of additional content or other third party content.

Bluetooth™ is a trademark or registered trademark of Bluetooth SIG Inc.

TrackID, PlayNow, MusicDJ, PhotoDJ and VideoDJ are trademarks or registered trademarks of Sony Ericsson Mobile Communications AB.

Memory Stick Micro™ (M2™), WALKMAN and the WALKMAN logo are trademarks of Sony Corporation.

Real is a trademark or a registered trademark of RealNetworks, Inc. RealPlayer® for Mobile is included under license from RealNetworks, Inc. Copyright 1995-2004, RealNetworks, Inc. All rights reserved.

Adobe™ Photoshop™ Album Starter Edition is either a trademark or registered trademark of Adobe Systems Incorporated in the United States and/or other countries/regions.

Microsoft®, Windows® is either a registered trademark or trademark of Microsoft Corporation in the United States and/or other countries/regions.

T9™ Text Input is a trademark or a registered trademark of Tegic Communications. T9™ Text Input is licensed under one or more of the following: U.S. Pat. Nos. 5,818,437, 5,953,541, 5,187,480, 5,945,928, and 6,011,554; Canadian Pat. No. 1,331,057, United Kingdom Pat. No. 2238414B; Hong Kong Standard Pat. No. HK0940329; Republic of Singapore Pat. No. 51383; Euro.Pat. No. 0 842 463(96927260.8) DE/DK, FI, FR, IT, NL, PT, ES, SE, GB; and additional patents are pending worldwide.

Smart-Fit Rendering is a trademark or registered trademark of ACCESS CO., LTD. in Japan and other countries/regions.

Java and all Java based trademarks and logos are trademarks or registered trademarks of Sun Microsystems, Inc. in the U.S. and other countries/regions. End-user license agreement for Sun™ Java™ J2ME™.

- 1 **Restrictions:** Software is confidential copyrighted information of Sun and title to all copies is retained by Sun and/or its licensors. Customer shall not modify, decompile, disassemble, decrypt, extract, or otherwise reverse engineer Software. Software may not be leased, assigned, or sublicensed, in whole or in part.
- 2 **Export Regulations:** Software, including technical data, is subject to U.S. export control laws, including the U.S. Export Administration Act and its associated regulations, and may be subject to export or import regulations in other countries/regions. Customer agrees to comply strictly with all such regulations and acknowledges that it has the responsibility to obtain licenses to export, reexport, or import Software. Software may not be downloaded, or otherwise exported or re-exported (i) into, or to a national or resident of, Cuba, Iraq, Iran, North Korea, Libya, Sudan, Syria (as such listing may be revised from time to time) or any country/region to which the U.S. has embargoed goods; or (ii) to anyone on the U.S. Treasury Department's list of Specially Designated Nations or the U.S. Commerce Department's Table of Denial Orders.
- 3 **Restricted Rights:** Use, duplication or disclosure by the United States government is subject to the restrictions as set forth in the Rights in Technical Data and Computer Software Clauses in DFARS 252.227-7013(c) (1) (ii) and FAR 52.227-19(c) (2) as applicable.

Part of the software in this product is copyright © SyncML initiative Ltd. (1999-2002). All rights reserved.

Other product and company names mentioned herein may be the trademarks of their respective owners.

Any rights not expressly granted herein are reserved.

Note: Sony Ericsson advises users to backup their personal data information.
All illustrations are for illustration only and may not accurately depict the actual phone.

Instruction symbols

The following appear in the User guide:



Note



A service or function is network- or subscription-dependent. Contact Orange for details.



See also page...



Use a selection or navigation key to scroll and select
➡ *13 Navigation.*



Press the navigation key centre.



Press the navigation key up.



Press the navigation key down.



Press the navigation key left.



Press the navigation key right.

Getting started

SIM card, battery, turning on, help, calls.

SIM card and battery

To insert SIM card and battery

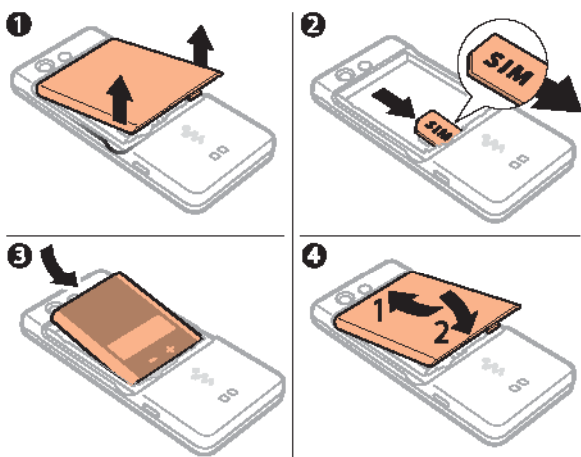

- 1 Remove the battery cover.
- 2 Slide the SIM card into its holder with the contacts facing down.
- 3 Insert the battery with the label side up and the connectors facing each other.
- 4 Slide the battery cover into place.

To charge the battery

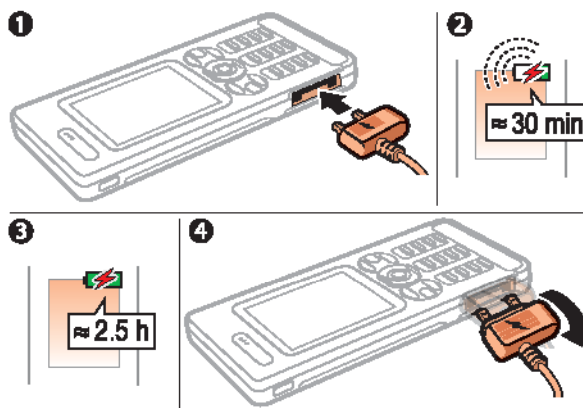

- 1 Connect the charger plug to the phone with the symbol facing upwards.
- 2 It may take up to 30 minutes before the battery icon appears.
- 3 Wait approximately 2.5 hours or until the battery icon indicates a full charge. Press a key to activate the screen.
- 4 Remove the charger by tilting the plug downwards.

To remove the battery

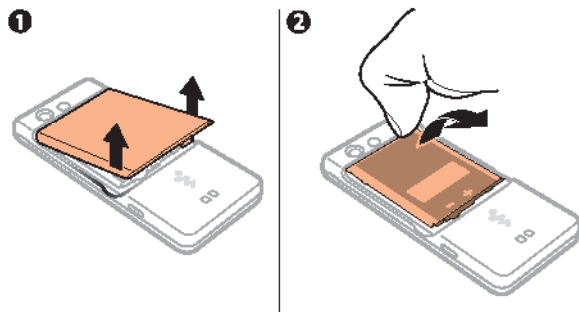

- 1 Remove the battery cover.
- 2 Insert your thumbnail into the groove to remove the battery.

Turning your phone on and off

Make sure the phone is charged and the battery and a SIM card are inserted before you turn on your phone. Use the setup wizard to quickly and easily prepare for use.

To turn on the phone



- 1 Press and hold **C**. The first start-up may take a few minutes.
- 2 Select to use the phone in:
 - **Normal mode** – full functionality or
 - **Flight mode** – limited functionality with network transceivers off.
- 3 Enter your SIM card PIN, if requested.
- 4 At first start-up, select the language for your phone menus.
- 5 ► **Yes** for the setup wizard to help you.
- 6 Follow instructions to complete setup.

 *If predefined settings exist in your phone, you may not need more settings.*

To turn off the phone

In standby press and hold **[C]**.

Standby

After you have turned on the phone and entered your PIN, the name of the network operator will appear on the display. This is called standby mode.

Help in your phone

Help and information is available in your phone at any time.

To use the setup wizard

From standby select **Menu** ► **Settings** ► the **General** tab ► **Setup wizard** and select an option:

- **Basic setup**
- **Tips and tricks.**

To view information about functions

Scroll to a function ► **More** ► **Information**, if available.



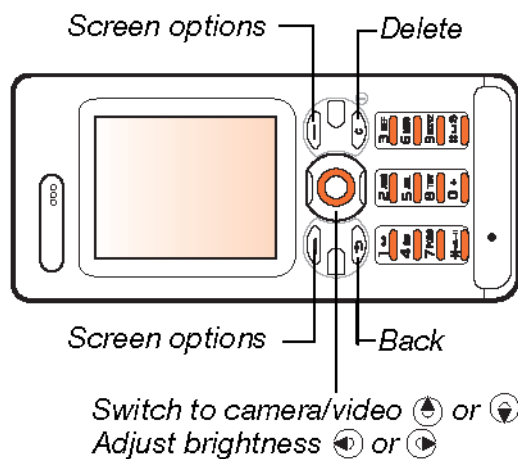
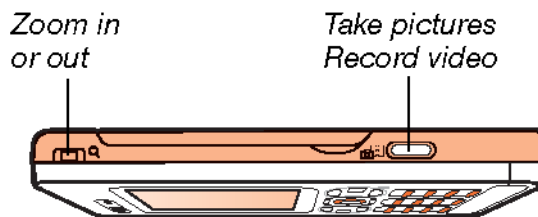

To view the phone demonstration

From standby select **Menu** ► **Entertainment** ► **Demo tour.**

Take pictures and record video clips



To take a picture or record video

- 1 From standby press  to activate the camera.
- 2 Use the navigation key to switch between camera and video camera.
- 3 Camera: Press  to take a picture.
Video: Press  to start recording. To stop recording, press  again.
Your pictures and video clips are automatically saved in **File manager** ► **Camera album**.
- 4 To take another picture or record another video clip, press  to return to the viewfinder.
To stop using the camera or video camera, press and hold .



Making and receiving calls

The phone must be in **Normal mode**. If the phone is in **Flight mode**, restart the phone and select **Normal mode**.

To make a call

Enter a phone number (with international prefix and area code if applicable) ► **Call** to make the call.

To answer or reject a call

When the phone rings ► **Answer** to answer or ► **Busy** to reject the call.

To end a call

► **End call**.

Keypad lock

Lock the keypad to avoid dialling a number by accident.

 *Calls to the international emergency number 112 can still be made, even when the keypad is locked.*

Automatic keylock

Use automatic keylock in standby to lock the keypad soon after the last key was pressed.

To set the automatic keylock

From standby select **Menu** ► **Settings** ► the **General** tab ► **Security** ► **Automatic keylock**.

To lock the keypad manually

From standby press ***#*#0** ► **Lock keys**.

To unlock the keypad

From standby press ***#*#0** ► **Unlock**.

Memory Stick Micro™ (M2™)

Your phone supports Memory Stick Micro™ (M2™) memory card adding more storage space to your phone to save files containing pictures or music, for example. It can also be used as a portable memory card with other compatible devices.

To insert and remove a memory card

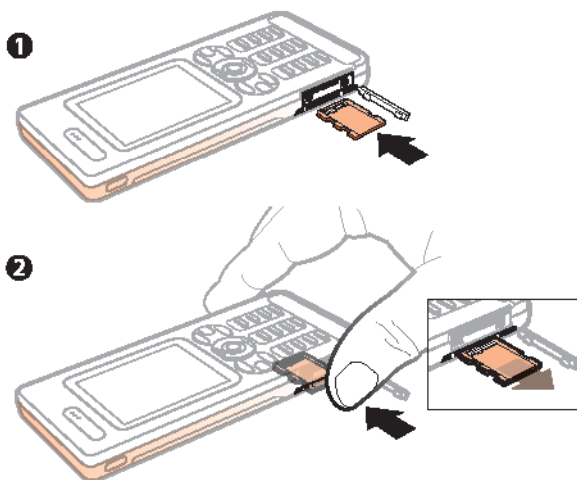



- 1 Open the cover and insert as shown.
- 2 Press the edge to release and remove.





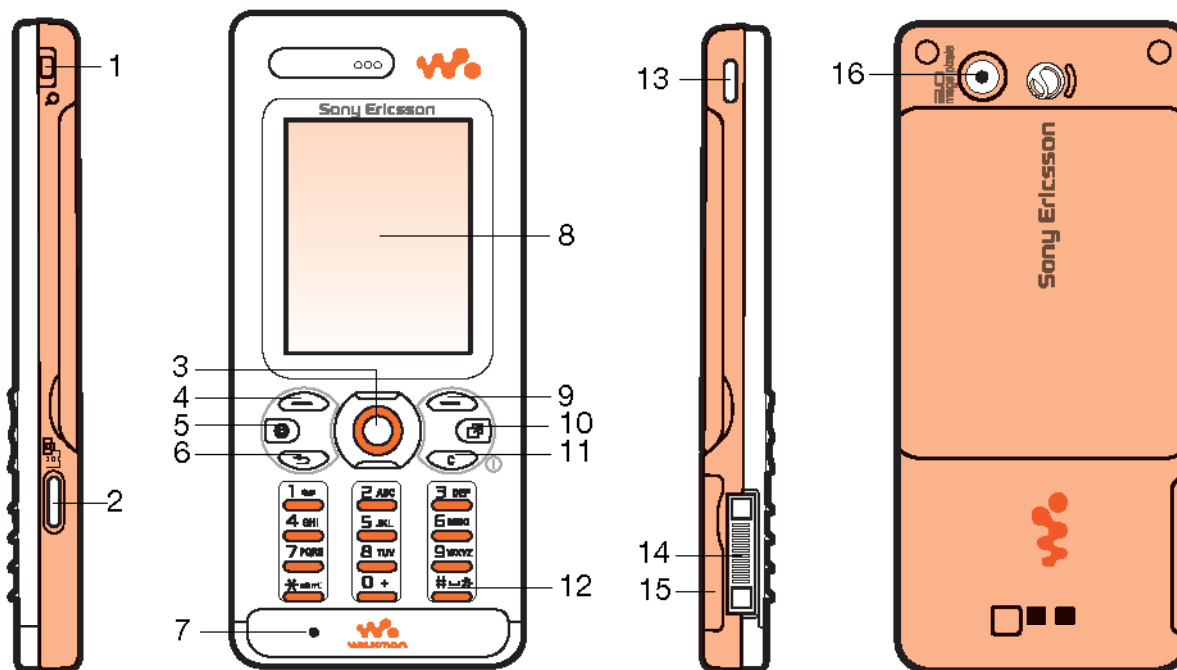



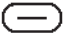

Getting to know the phone

Phone overview, icons, menus, entering letters, activity menu, file manager.

Phone overview



 *Some icons on keys may differ.*

- 1  Volume, camera digital zoom buttons
- 2  Camera button
- 3  Selection key
- 4  Navigation key, Walkman® player control
- 5  Internet key
- 6  Back key
- 7 Microphone
- 8 Screen
- 9  Selection key
- 10  Activity menu key
- 11  C key, Power on/off key (Ⓜ)
- 12  Silent key
- 13  Walkman® key
- 14 Connector for charger, handsfree and USB cable
- 15 Memory Stick Micro™ (M2™) slot
- 16 Main camera

For more information ➔ *13 Navigation.*

Menu overview



PlayNow™*



Monternet*



Entertainment

- Online services*
- Games
- Video player
- VideoDJ™
- PhotoDJ™
- MusicDJ™
- Remote control
- Record sound
- Demo tour



Camera



Messaging

- Write new
- Inbox
- Email
- RSS reader
- Drafts
- Outbox
- Sent messages
- Saved messages
- My friends*
- Call voicemail
- Templates
- Settings



WALKMAN



File manager**

- Camera album
- Music
- Pictures
- Videos
- Themes
- Web pages
- Games
- Applications
- Other



Contacts

New contact



TrackID™*

 **Calls****

All



Answered

Dialled

Missed

 **Organizer**

- Alarms
- Applications
- Calendar
- Tasks
- Notes
- Synchronization
- Timer
- Stopwatch
- Calculator
- Code memo

 **Settings****



General
Profiles
Time & date
Language
Update service
Voice control
New events
Shortcuts
Flight mode
Security
Setup wizard
Phone status
Master reset



Sounds & alerts
Ring volume
Ringtone
Silent mode
Increasing ring
Vibrating alert
Message alert
Key sound



Display
Wallpaper
Themes
Start-up screen
Screen saver
Clock size
Brightness
Sleep mode clock
Edit line names*



Calls
Speed dial
Divert calls
Switch to line 2*
Manage calls
Time & cost*
Show/hide my no.
Handsfree



Connectivity*
Bluetooth
USB
Synchronization
Device management
Mobile networks
Data communication
Internet settings
Streaming settings
Accessories

* Some menus are operator-, network- and subscription-dependent.

** Use the navigation key right and left to move between tabs in submenus. For more information  13 Navigation.

Navigation

The main menu is shown as icons. Some submenus include tabs. Scroll to a tab by pressing the navigation key left or right and select an option.

Navigation keys

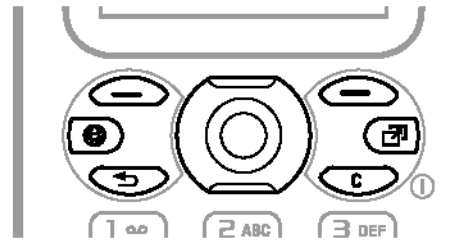

Key

- | | |
|--|--|
| | Go to the main menu from standby or select highlighted items.
Press to start and stop music when using the WALKMAN . |
| | Move left, right, up and down through menus and tabs. |
| | Select options shown immediately above these keys on the screen. |
| | Go back one level in the menus.
Press and hold to return to standby or to end a function. |
| | Press and hold to turn your phone on or off.
Delete items such as pictures, sounds and contacts.
During a call, press and hold to mute the microphone. |
| | Open the browser. |
| | Open the activity menu. |
| | Open or minimize the WALKMAN . |
| | Press to take a picture or record a video clip. |
| | Press and hold to call your voicemail service (if set). |

2 - **9** Press and hold any of these keys to reach a contact beginning with a specific letter.

1 - **9** Press a number key and ► **Call** to speed dial.

- ***** Turn off the ringtone when receiving a call.
Press and hold to set the phone to silent. The alarm signals even if the phone is set to silent.

▲ View status information in standby.
Increase the volume during a call, or when using the **WALKMAN**.
Zoom out when using the camera or viewing pictures.
Press and hold to go back one track.
Press twice to reject a call.
Press once to mute the ringtone when receiving a call.
Press and hold to voice dial, alternatively say your magic word (if set).

▼ Decrease the volume during a call, or when using the **WALKMAN**.
Zoom in when using the camera or viewing pictures.
Press and hold to go forward one track.
Press twice to reject a call.
Press once to mute the ringtone when receiving a call.
Press and hold to voice dial, alternatively say your magic word (if set).

► **Info** Find more information, explanations or tips about selected features, menus or functions available in your phone ► *6 Help in your phone.*

► **More** Enter a list of options. There are different alternatives in the list of options depending on where you are in the menus.

Entering letters

Enter letters in one of the following ways (text input methods), for example, when writing messages:

- Multitap text input
- T9™ Text Input

To change the text input method

Before, or when entering letters, press and hold **[*#0000]** to change the method.

Options when entering letters

► **More** for options when writing a message.

To enter letters using multitap input

- Press **[2]** - **[9]** repeatedly until the desired character appears.
- Press **[*#0000]** to shift between capital and lower-case letters.
- Press and hold **[0+]** - **[9]** to enter numbers.
- Press **[C]** to delete letters or numbers.
- Press **[1=]** repeatedly for the most common punctuation marks.
- Press **[#-#]** to add a space.

 *Multitap input only applies when latin characters are selected as input language.*



T9™ Text Input

The T9™ Text Input method uses a built-in dictionary to recognize the most commonly used word for each sequence of key presses. This way, you press each key only once, even if the letter you want is not the first letter on the key.

To enter letters using T9™ Text Input

- 1 For example, to write the word "Jane", press **[5]**, **[2]**, **[6]**, **[3]**.
- 2 If the word shown is the one you want, press **[#-#]** to accept and add a space. To accept a word without adding a space, press **[↵]**. If the word shown is not the one you want, press **[↑]** or **[↓]** repeatedly to view alternative words. Accept a word and add a space by pressing **[#-#]**.
- 3 Continue writing the message. To enter a punctuation mark, press **[1=]** and then **[↑]** or **[↓]** repeatedly, press **[#-#]** to accept and add a space.

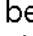
To add words to the T9™ Text Input dictionary

- 1 When entering letters ► **More** ► **Spell word**.
- 2 Edit the word by using multitap input. Use  and  to move the cursor between the letters. To delete a character, press . To delete the entire word, press and hold . When you have edited the word ► **Insert**. The word is added to the T9™ Text Input dictionary. Next time you enter this word using T9™ Text Input, it appears in alternative words.

Next word prediction

When writing a message, you can use T9™ Text Input to predict the next word, if previously used in a sentence.

To turn next word prediction on/off

When entering letters ► **More** ► **Writing options** ► **Next word pred..**

To use next word prediction

When entering letters, press  to accept and continue.

Chinese input

This mobile phone has different input methods for entering Chinese characters:



- Stroke input
 - Pinyin input
- You can use these methods, for example, to enter Chinese names and Chinese short messages.

Switching between Chinese input methods



In the Chinese editing mode, you can select and switch quickly to another input method by pressing and holding .

General instructions

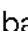
Regardless of which input method you choose, your phone has a function to speed up the entry of Chinese characters. Whenever you enter a stroke or a Pinyin letter, a candidate row of the most frequently used characters containing that stroke or relating to that letter appears at the bottom of the screen.

If the character you want is not displayed in the candidate row, press  to present another candidate row. Continue pressing  until the character you want is displayed. Alternatively, you can enter the next stroke or Pinyin letter, and a new set of characters will immediately be displayed in the candidate row. To go back to the previous row, press . To select a character in the candidate row, press the navigation key or press and hold the key corresponding to the number above the character you want to enter.

Stroke input

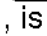
A Chinese character is built up of strokes. There are more than 30 basic strokes, which are grouped into 5 stroke categories. Each category is represented on the keypad by one of the keys  - . The Wild Card key , is used when you are not sure of which stroke to use.

Stroke categories

The 5 stroke categories are defined in the table below:

Number Key	Stroke Category	Basic Stroke	Stroke Name	Character
			Over	王 十 在 七 天
			Lift	海 红 牡 状 习
			Down	中 业 上 门 丑
			Down-Hook	小 水 打 子 承
			Short Slope Down	直 真 质 草
			Long Left Slope	八 九 丹 风 片
			Over Slope	香 千 匕 后 丢
			Short left Slope	而 页 面 学 殿
			Dot	六 学 雷 心 性
			Right Slope	人 火 又 送 林
			Down-Curved-Over	四 西 酉 酸

Number Key	Stroke Category	Basic Stroke	Stroke Name	Character
5	7	㇇	Down-Over	山 巨 屯 母 凶
		㇈	Left Slope-Over	么 去 公 约 能
		㇉	Left Slope-Dot	女 要 好 巡 巢
		㇊	Down-Lift	衣 以 饭 收 长
		㇋	Right Slope-Hook	我 或 民 成 伐
		㇌	Down-Over-Hook	心 必 思 忘
		㇍	Down-Over-Curved-Hook	电 也 毛 兄 孔
		㇎	Down-Over-Left Slope	专 传 转
		㇏	Down-Over-Down-Hook	马 与 张 号 费
		㇐	Down-Over-Down	鼎 竊
		㇑	Over-Hook	写 字 皮 通 兔
		㇒	Over-Down	口 己 户 书 骨
		㇓	Over-Down-Hook	力 习 也 同 水
		㇔	Over-Left Slope	又 之 登 多 社
		㇕	Over-Down-Over-Left Slope	及 极 廷 建

Number Key	Stroke Category	Basic Stroke	Stroke Name	Character
6		㇖	Over-Left Slope-Curved-Hook	阿 队 陈 那 部
		㇗	Over-Down-Over-Hook	乃 透 竊 隼 杨
		㇘	Over-Down-Over-Down	凸
		㇙	Curved-Hook	狗 豹 家 逐 狂
		㇚	Over-Down-Curved-Hook	乙 九 瓦 飞 风
		㇛	Over-Down-Over	投 沿 船 凹
		㇜	Over-Down-Lift	话 计 认 讯
		6	? (Wild card key)	



Components

The basic building units of Chinese characters are components that are made up of strokes. After entering the first two strokes of the desired character, the component and character candidates that started with that stroke are displayed in the candidate row.





Using components is a fast method for entering complex characters.

 *The smaller candidates surrounded by dotted frames are components, and the bigger candidates without dotted frames are characters.*

For example, to enter “信息”

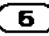
- 1 Enter “丿”, “丨” and “㇇”.
- 2 Move the cursor to “信”, press .
- 3 Move the cursor to “息”, press  again to select “息”.







Example of using the wild card key

The wild card key , is used to supplement unclear strokes in entering characters. If you want to enter “互”, but you only know that “一” is the first and the last stroke of the character and that the total number of strokes is four, enter , , , . The character is displayed in the candidate row.

Pinyin input

Press the keys containing the required Pinyin letters, and the phone will make various proposals on the screen, according to the pronunciation rules of Mandarin.

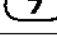
Below is the key mapping of Pinyin letters on the keypad.

Number Key	Pinyin Letter
	a b c
	d e f
	g h i
	j k l
	m n o
	p q r s
	t u ü
	w x y z

 *On the keypad, the letter ü is replaced by v.*

For example, to enter “ 信息 ”

- 1 Press **[9]**, **[4]**, **[6]**.
- 2 When “xin” is highlighted, press **[↩]** or **[▶]** and select “ 信 ”, then press **[○]** (If you want to enter any of the other suggested Pinyin combinations, scroll up or down to the desired combination, then press **[○]**).
- 3 Press **[○]** again to select “ 息 ”, When “ 息 ” is highlighted.

Fuzzy Pinyin

Fuzzy Pinyin is an option for the Pinyin input method, which contains additional spelling alternatives.

When in Pinyin input mode, press **More ▶ Writing option ▶ Fuzzy Pinyin ▶ On**.

Input punctuation, symbols and smilies

Under any Chinese input mode, press **[Punct.]**, to see the table of punctuation marks, symbols and smilies. Use the navigation key to make a selection. Press **[Space]** to enter a space into the text.

Activity menu

You can open the activity menu almost anywhere in the phone to view and handle new events, and access bookmarks and shortcuts.

To open and close the activity menu

Press **[C]**.

Activity menu tabs

- **New events** – such as missed calls and messages. When a new event occurs, the activity menu appears. Press **[C]** to dismiss an event from the event tab. New events can also be set to appear as pop-up text instead, **▶ Settings ▶ the General tab ▶ New events ▶ Pop-up**.
- **Running apps** – applications that are running in the background. Select an application to return to it or press **[C]** to end it.
- **My shortcuts** – add, delete and change the order of shortcuts. When you select a shortcut and the application opens, other programs are closed or minimized.
- **Internet** – your Internet bookmarks. When you select a bookmark and the browser opens, other programs are closed or minimized.

File manager

Use the **File manager** to handle items such as pictures, videos, music, themes, Web pages, games and applications saved in the phone memory or on a memory card.

If all available memory is full, you cannot save any files until content is removed.

Create subfolders to move or copy files to. Games and applications can be moved within the **Games** and **Applications** folders and from the phone memory to a memory card. Unrecognized files are saved in the **Other** folder. When handling files, you can select several or all files in a folder at the same time for all items except **Games** and **Applications**.

File manager menu tabs

The file manager is divided into three tabs, and icons are included to indicate where the files are saved.

- **All files** – all content in the phone memory and on a memory card.
- **On Memory Stick** – all content on a memory card.
- **In phone** – all content in the phone memory.

File information

View file information by highlighting it
▶ **More** ▶ **Information**.

To use a file from the file manager

- 1 From standby select **Menu** ▶ **File manager** and open a folder.
- 2 Scroll to a file ▶ **More**.

To move or copy files to a computer

➤ 44 *Transferring files using the USB cable.*

To create a subfolder

- 1 From standby select **Menu** ▶ **File manager** and open a folder.
- 2 ▶ **More** ▶ **New folder** and enter a name for the folder.
- 3 ▶ **OK** to save the folder.

To select several files

- 1 From standby select **Menu** ▶ **File manager** and open a folder.
- 2 ▶ **More** ▶ **Mark** ▶ **Mark several**.
- 3 Scroll to select files ▶ **Mark** or **Unmark**.

To select all files in a folder

From standby select **Menu** ▶ **File manager** and open a folder ▶ **More** ▶ **Mark** ▶ **Mark all**.

To delete a file or a subfolder from the file manager

- 1 From standby select **Menu** ► **File manager** and open a folder.
- 2 Scroll to a file ► **More** ► **Delete**.

Calling

Calls, contacts.

Making and receiving calls

Before you can make or receive any calls, you must turn on your phone and be within range of a network.

► *5 Turning your phone on and off.*

Networks

When you turn on the phone, it automatically selects your home network if this is within range. If it is not within range, you may use another network, provided your network operator has an agreement that allows you to do so. This is called roaming.

Select the network to use, or you can add a network to your preferred networks. You can also change the order in which networks are selected during an automatic search.

To view available network options

From standby select **Menu** ► **Settings** ► the **Connectivity** tab ► **Mobile networks**.

To make a call

- 1 Enter a phone number (with international country/region code and area code, if applicable).
- 2 ► **Call** to make a call or ► **More** to view options.
- 3 ► **End call** to end the call.

 You can call numbers from your contacts and call list ► 24 Contacts, and ► 29 Call list.

To make international calls

- 1 Press **[+]** until a + sign appears.
- 2 Enter the country/region code, area code (without the first zero) and phone number ► **Call** to make a call.

To re-dial a number

If a call connection fails and **Retry?** appears ► **Yes**.

 Do not hold the phone to your ear when waiting. When the call connects, the phone gives a loud signal, unless muted.

To answer or reject a call

► **Answer** or ► **Busy**.

To turn off the microphone

- 1 Press and hold **[M]**.
- 2 To resume the conversation press and hold **[M]** again.

To turn the loudspeaker on or off during a call

► **More** ► **Turn on speaker** or **Turn off speaker**.

 Do not hold the phone to your ear when using the loudspeaker. This could damage your hearing.

To change the ear speaker volume

Press **[▲]** to increase or **[▼]** to decrease the ear speaker volume during a call.

Missed calls

When the activity menu is set to default missed calls appear in the **New events** tab in standby. If pop-up is set to default **Missed calls**: appears in standby ► 20 Activity menu.

To check missed calls from standby

- If pop-up is set to default: ► **Calls** ► the **Missed** tab. Scroll **[▲]** or **[▼]** to select a number ► **Call** to call.
- If activity menu is set to default: Press **[E]** and use **[▲]** or **[▼]** to scroll to the **New events** tab and use **[▲]** or **[▼]** to select a number ► **Call** to call.

Emergency calls

Your phone supports international emergency numbers, for example, 112, 911. These numbers can normally be used to make emergency calls in any country/region, with or without a SIM card inserted, if a network is within range.

 *In some countries/regions, other emergency numbers may also be promoted. Your network operator may therefore have saved additional local emergency numbers on the SIM card.*

To make an emergency call

Enter 112 (the international emergency number) ► **Call**.

To view your local emergency numbers

From standby select **Menu ► Contacts ► More ► Options ► Special numbers ► Emergency nos..**

Contacts

You can save your contact information in the phone memory or on a SIM card. The following is available:

You can choose which contact information – **Phone contacts** or **SIM contacts** – is shown as default.

For useful information and settings, from standby select **Menu ► Contacts ► More ► Options**.



Default contact

If **Phone contacts** is selected as default, your contacts show all the information saved in **Contacts**. If you select **SIM contacts** as default, your contacts show information depending on the SIM card.

To select default contacts

- 1 From standby select **Menu ► Contacts ► More ► Options ► Advanced ► Default contacts**.
- 2 ► **Phone contacts** or **SIM contacts**.

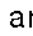
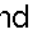
Phone contacts

Save contacts in the phone with names, phone numbers and personal information. You can also add pictures and ringtones to contacts. Use , ,  and  to scroll between tabs and their information fields.

To add a phone contact

- 1 If **Phone contacts** is selected as default, from standby select **Menu** ► **Contacts** ► **New contact** ► **Add**.
- 2 Enter the name ► **OK**.
- 3 Enter the number ► **OK**.
- 4 Select a number option.
- 5 Scroll between tabs and select the fields to add information. To enter symbols such as @, ► **More** ► **Add symbol** and select a symbol ► **Insert**.
- 6 When all information is added ► **Save**.

To automatically save names and phone numbers on the SIM card

From standby select **Menu** ► **Contacts** ► **More** ► **Options** ► **Advanced** ► **Auto save on SIM** and select **On**.

To delete a contact

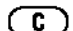
- 1 From standby select **Menu** ► **Contacts** and scroll to a contact.
- 2 Press  and select **Yes**.

To delete all phone contacts

From standby select **Menu** ► **Contacts** ► **More** ► **Options** ► **Advanced** ► **Delete all contacts** ► **Yes** and ► **Yes**. Names and numbers on the SIM card are not deleted.

SIM contacts

Save contacts on your SIM card.

To add a SIM contact

- 1 If **SIM contacts** is selected as default, from standby select **Menu** ► **Contacts** ► **New contact** ► **Add**.
- 2 Enter the name ► **OK**.
- 3 Enter the number ► **OK** and select a number option. Add more information, if available ► **Save**.

Memory status

The number of contacts you can save in the phone or on the SIM card depends on available memory.

To view memory status

From standby select **Menu** ► **Contacts**
► **More** ► **Options** ► **Advanced**
► **Memory status**.

Using contacts

Contacts can be used in many ways. Below you can see how to:

- call phone and SIM contacts.
- send phone contacts to another device.
- copy contacts to phone and SIM card.
- add a picture or a ringtone to a phone contact.
- edit contacts.
- synchronize your contacts.

To call a phone contact

To call a contact written in Chinese characters

- 1 ► **Contacts**. Then enter the entire multi-letter name, pure initial or mixed initial pinyin of Chinese contacts you want to call. For example:



Initial status

Full name search

Pure initial search

Mixed initial search

- 2 When the contact is highlighted, press or to select a number ► **Call**.

To call a contact written in Latin characters

- 1 ► **Contacts**. Scroll to, or enter the first letters or all letters of the contact you want to call (a maximum of 10 letters).

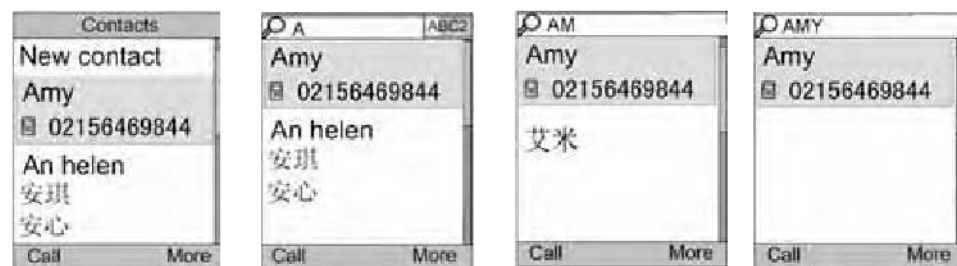

Initial

Input 'A'

input 'AM'

input 'AMY'

- 2 When the contact is highlighted, press or to select a number ► **Call**.

Note: Phone supports Chinese and English contacts mixed search. When a contact is written in Latin character, the entered letter can reach the Latin contact you want to call; When a contact is written in Chinese characters, the entered letter can reach the pinyin of Chinese contact you want to call.

To call a SIM contact

- If **SIM contacts** is default, from standby select **Menu ▶ Contacts** and when the contact is highlighted ▶ **Call**.
- If **Phone contacts** is set as default, from standby select **Menu ▶ Contacts ▶ More ▶ Options ▶ SIM contacts** and select the contact ▶ **Call**.

To send a contact

From standby select **Menu ▶ Contacts** and select a contact ▶ **More ▶ Send contact** and select a transfer method.

To send all contacts

From standby select **Menu ▶ Contacts ▶ More ▶ Options ▶ Advanced ▶ Send all contacts** and select a transfer method.

To copy names and numbers to the SIM card

- 1 From standby select **Menu ▶ Contacts ▶ More ▶ Options ▶ Advanced ▶ Copy to SIM**.
- 2 Select one of the alternatives.

 *When copying all contacts from the phone to the SIM card, all existing SIM card information is replaced.*

To copy names and numbers to phone contacts

- 1 From standby select **Menu ▶ Contacts ▶ More ▶ Options ▶ Advanced ▶ Copy from SIM**.
- 2 Select one of the alternatives.

To add a picture, ringtone or video to a phone contact

- 1 From standby select **Menu ▶ Contacts** and select the contact ▶ **More ▶ Edit contact**.
- 2 Select the relevant tab and then select **Picture or Ringtone ▶ Add**.
- 3 Select an option and an item ▶ **Save**.

 *If your subscription supports Calling Line Identification (CLI) service, you can assign personal ringtones to contacts.*

To edit a phone contact

- 1 From standby select **Menu ▶ Contacts** and select a contact ▶ **More ▶ Edit contact**.
- 2 Scroll to the relevant tab and select the field to edit ▶ **Edit**.
- 3 Edit the information ▶ **Save**.

To edit a SIM contact

- 1 If SIM contacts is default, from standby select **Menu** ► **Contacts** and select the name and number to edit. If phone contacts is default, from standby select **Menu** ► **Contacts** ► **More** ► **Options** ► **SIM contacts** and select the name and number to edit.
- 2 ► **More** ► **Edit contact** and edit the name and number.

To select the sort order for contacts

From standby select **Menu** ► **Contacts** ► **More** ► **Options** ► **Advanced** ► **Sort order**.

Call list

Information about most recent calls.

To call a number from the call list

- 1 From standby select **Calls** and select a tab.
- 2 Scroll to the name or number to call ► **Call**.

To add a call list number to contacts

- 1 From standby select **Calls** and select a tab.
- 2 Scroll to the number to add ► **More** ► **Save number**.
- 3 ► **New contact** to create a new contact, or select an existing contact to add the number to.

To clear the call list

Select **Calls** ► the **All** tab ► **More** ► **Delete all**.

Messaging

Text messaging, picture messaging, email, My friends.

Your phone supports various messaging services. Please contact your service provider about the services you can use, or for more information, visit www.sonyericsson.com/cn.

Text messaging (SMS)

Text messages can contain simple pictures, sound effects, animations, and melodies. You can also create and use templates for your messages.

 *If you send a text message to a group, you will be charged for each member.*

Before you start

The number to your service centre is supplied by your service provider and is usually set on the SIM card. If not, you can enter the number yourself.

To set a service centre number

- 1 From standby select **Menu** ► **Messaging** ► **Settings** ► **Text message** ► **Service centre**. If the service centre number is saved on the SIM card it is shown.

- 2 If there is no number shown ► **Edit** ► **New ServiceCentre** and enter the number, including the international “+” prefix and country/region code ► **Save**.

Sending text messages

For information about entering letters ► **15 Entering letters**.

 *Some language-specific characters use more space. For some languages you can deactivate **National chars.** to save space.*

To write and send a text message

- 1 From standby select **Menu** ► **Messaging** ► **Write new** ► **Text message**.
- 2 Write your message ► **Continue**. (You can save a message for later in **Drafts** by pressing  ► **Save message**.)
- 3 ► **Enter phone no.** and enter a number, or ► **Contacts look-up** to retrieve a number or a group from **Contacts**, or select from last used recipients ► **Send**.

 *To send a message to an email address, you need to set an email gateway number, from standby select **Menu** ► **Messaging** ► **Settings** ► **Text message** ► **Email gateway**. The number is supplied by your service provider.*

To copy and paste text in a message

- 1 When writing your message ► **More** ► **Copy & paste**.
- 2 ► **Copy all** or ► **Mark & copy** and use the navigation key to scroll and mark text in your message.
- 3 ► **More** ► **Copy & paste** ► **Paste**.

To insert an item in a text message

- 1 When writing your message ► **More** ► **Add item**.
- 2 Select an option and then an item, for example, a picture.

 *You can convert your text message to a picture message. When writing your message ► **More** ► **To picture msg** and continue creating a picture message, ► **31 Picture messaging (MMS)**.*

To delete a message

- 1 From standby select **Menu** ► **Messaging** and select a folder.
- 2 Select the message to delete and press **C**.

To set default text message options

From standby select **Menu** ► **Messaging** ► **Settings** ► **Text message** and select the options to change.

Picture messaging (MMS)

Picture messages can contain text, pictures, camera pictures, slides, sound recordings, video clips, signatures and attachments. You can send picture messages to a mobile phone or an email address.



Before you start

Both you and the recipient must have subscriptions that support picture messaging.

If no Internet profile or message server exists, you can receive all the settings for MMS automatically from your network operator or from www.sonyericsson.com/cn.

Before sending a picture message, you can check that the address of your message server and an Internet profile are set, from standby select **Menu** ► **Messaging** ► **Settings** ► **Picture message** ► **MMS profile** and select a profile. ► **More** ► **Edit** ► **Message server** and ► **More** ► **Edit** ► **Internet profile**.

To create and send a picture message

- 1 From standby select **Menu**
▶ **Messaging** ▶ **Write new** ▶ **Picture msg.** Scroll  to use toolbar options. Scroll  or  to select an option.
- 2 When ready to send ▶ **More**
▶ **Continue.**
- 3 ▶ **Enter email addr.** or ▶ **Enter phone no.** or ▶ **Contacts look-up** to retrieve a number or group in **Contacts** or select from last used recipients ▶ **Send.**

 *When writing and editing picture messages you can use the copy and paste functionality ➤ 31 To copy and paste text in a message.*

To set default picture message options

From standby select **Menu**
▶ **Messaging** ▶ **Settings** ▶ **Picture message** and select options to change.



Email

Read your email messages in your phone at any time. The email address that you use on your computer can also be used in your phone. To do this, your phone needs the same email settings as used by your computer for email address. To use your computer email address in your phone, do one of the following:

- **Receive settings automatically**
The easiest way is to have settings sent directly to your phone. Use Internet on your computer to go to www.sonyericsson.com/cn.
- **Enter settings manually**
 - Ask your email provider for settings information. An email provider is the person or company who provided your email address, for example, your IT administrator at work or an Internet provider, or
 - you may have a document at home from your email provider with the settings information, or
 - you may find the information in your computer email program settings.

What information do I need?

The minimum you need is the following:

Setting types	Examples
Connection type	POP3 or IMAP4
Email address	joe.smith@example.com
Incoming server	mail.example.com
Username	jsmith
Password	zX123
Outgoing server	mail.example.com

 *There are many different email providers. Their terminology and required information may differ. Not all service providers allow email access.*

Help in your phone

There are also setup instructions and help information as you enter settings.

To enter email settings

- 1 From standby select **Menu**
▶ **Messaging** ▶ **Email** ▶ **Settings**.
- 2 After settings are entered, ▶ **Inbox**
▶ **More** ▶ **Send & receive** to access your email.

When settings are entered, your phone can connect to an email server to send and receive email messages.

For more information, contact your email provider or see the User guide with additional information at www.sonyericsson.com/cn.

My friends

Connect and log in to the My friends server to communicate online with your favourite friends. If your subscription supports instant messaging and presence services, you can send and receive messages and see contact status if online. If no settings exist in your phone, you need to enter server settings.



Contact your service provider for more information.

Imaging

Camera, video, pictures.

Camera and video camera

Take pictures and record video clips to save, view and send in messages.

► *6 Take pictures and record video clips.*

Camera settings

When you are in the viewfinder

► **Settings** for options to adjust and enhance your pictures and video clips before taking or recording them.

 *If you try to record with a strong light source such as direct sunlight or a lamp in the background, the screen may black out or the picture may be distorted.*

To use the zoom

Use the volume buttons to zoom in and out.

 *When you take a picture, you can only zoom in VGA picture size.*

To adjust brightness

Use the navigation key to increase or decrease brightness.

Camera and video options

When the camera or video is activated

► **Settings** for the following options:

- **Switch to video camera** to record a video clip or **Switch to still camera** to take a picture.
- **Shoot mode (camera):**
 - **Normal** – no frame.
 - **Panorama** – join several pictures into one.
 - **Frames** – add a frame to your picture.
 - **Burst** – take a rapid sequence of pictures.
- **Shoot mode (video):**
 - **For picture message**
 - **High quality video**
- **Picture size (camera)** – select from:
 - **2 MP** (1600x1200 pixels)
 - **1 MP** (1280x960)
 - **VGA** (640x480)
- **Turn on night mode** – adapt to poor lighting conditions.
- **Turn on self-timer (camera)** – take a picture a few seconds after pressing the camera button.
- **Effects** – select from:
 - **Off** – no effect.
 - **Black & white** – no colour.
 - **Negative** – reversed colours.
 - **Sepia** – brown tint.

- **White balance** – adjust colours to lighting conditions. Select from **Auto**, **Daylight**, **Cloudy**, **Fluorescent** or **Incandescent**.
- **Picture quality (camera)**:
 - **Normal**
 - **Fine**
- **Turn off mic. (video)** – set microphone.
- **Shutter sound (camera)** – select different shutter sounds.
- **Turn on time and date (camera)** – add time and date to a picture, it will appear in the lower right corner. View in 1:1 size or use zoom when viewing a picture to see the text.
- **Reset file no.** – reset the file number counter.
- **Save to** – select to save to **Memory Stick** or **Phone memory**.

Camera shortcuts

When using the camera, you can also use keys as shortcuts to common options. Press **[Q+]** for a camera key guide.

Transferring pictures

Transfer to your computer

Using the USB cable, you can drag and drop camera pictures to a computer ➤ *44 Transferring files using the USB cable.*

To further enhance and organize camera pictures on a computer, Microsoft® Windows® users can install Adobe™ Photoshop™ Album Starter Edition, included on the CD that came with the phone or visit www.sonyericsson.com/cn.

Pictures and video clips

View and use pictures and video clips.

To view and use pictures

- 1 From standby select **Menu** ► **File manager** ► **Pictures**.
- 2 Select a picture ► **View** or ► **More** ► **Use as** and select an option.

To send a picture

From standby select **Menu** ► **File manager** ► **Pictures** and scroll to a picture. ► **More** ► **Send** and select a transfer method.

To receive a picture

From standby select **Menu** ► **Settings** ► the **Connectivity** tab and select a transfer method.

 *The file size is limited for a picture message. If it is larger than the maximum message size or it has too high resolution, it will be automatically resized.*

Entertainment

Handsfree, Walkman® player, video player, TrackID™, PlayNow™, ringtones and melodies.

Stereo portable handsfree

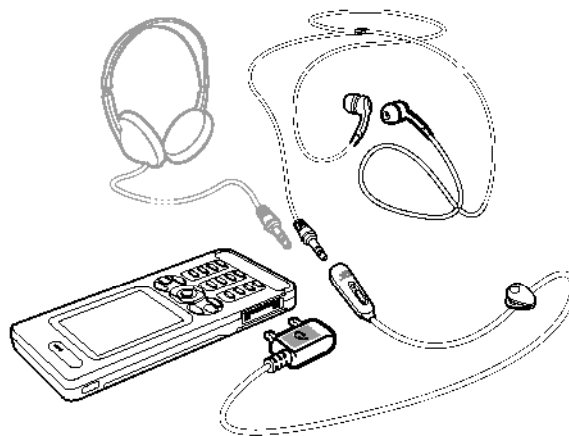

To use the handsfree

Connect the stereo portable handsfree to your phone to use it for calls, listening to music or videos. If you receive a call and are playing music, music stops for you to answer your call. Music resumes when the call is ended or rejected.





Walkman® player and Video player

Your phone supports the following file types: MP3, MP4, M4A, 3GP, AAC, AAC+, Enhanced AAC, AMR, MIDI, IMY, EMY, WAV (16 kHz maximum sample rate) and Real® 8. The phone also supports streamed files that are 3GPP compatible.

To play videos

- 1 From standby select **Menu**
 - ▶ **Entertainment** ▶ **Video player**. A player browser opens.
- 2 Browse for video clips and highlight a title ▶ **Play**.

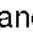



The following options are available:

- Press  to stop the playback. Press again to resume playing.
- Press  to go to the next video clip.
- Press  to go to the previous video clip.
- Press and hold  or  to fast forward or rewind when playing video clips.
- Press **Play** to select a highlighted file.
- When playing a video clip, ▶ **More** for options.
- Press and hold  to exit.

To play music

- 1 From standby select **Menu**
 - ▶ **WALKMAN**. The Walkman® player browser opens.
- 2 ▶ **More** ▶ **My music** to browse by artists, albums, tracks or playlists or ▶ **Play** to listen to all your tracks in a play queue.

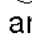
The following options are available:

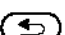
- Press  to stop the playback. Press again to resume playing.
- Press  to go to the next track.
- Press  to go to the previous track.
- Press and hold  or  to fast forward or rewind a track.
- When playing a track, ▶ **More** for options.
- Press and hold  to exit.

Transferring music

Disc2Phone computer software and USB drivers are included on the CD that came with the phone. Use Disc2Phone to transfer music from CDs or your computer to the phone memory or a memory card in your phone.

Before you start

The following are minimum operating system requirements for using Disc2Phone on your computer:

- Windows 2000 SP4 or
- XP Home, or XP Professional SP1.

To install Disc2Phone

- 1 Turn on your computer and insert the CD that came with your phone or visit www.sonyericsson.com/cn to download the Disc2Phone application. The CD starts automatically and the installation window opens.
- 2 Select a language.
- 3 Click *Install Disc2Phone* and follow the instructions.

To use Disc2Phone

- 1 Connect the phone to a computer with the USB cable that came with your phone and select **File transfer**. The phone turns off and prepares to transfer files. For more information  **44 Transferring files using the USB cable**.
- 2 **Computer:**
Start/Programs/Disc2Phone. For details on transferring music, please refer to Disc2Phone Help.

- 3 Click  in the top right corner of the Disc2Phone window.

 *Do not remove the USB cable from the phone or computer during transfer, as this may corrupt a memory card or the phone memory. You cannot view the transferred files in your phone until you have removed the USB cable from the phone.*

You can obtain CD information (artist, track, etc.) via Disc2Phone if you are connected to the Internet and extracting music from a CD.

 *For safe disconnection of the USB cable in file transfer mode, right-click the removable disk icon in Windows Explorer and select Eject.*

More information about moving files to your phone is available at www.sonyericsson.com/cn.

To transfer files with the USB cable provided

 **44 Transferring files using the USB cable**.

Browsing files

Browse music files:

- **Artists** – lists music files by artist.
- **Albums** – lists music files by album.
- **Tracks** – lists all music files (not ringtones) in your phone and on a memory card.
- **Playlists** – create or play your own lists of music files.

Playlists

To organize the media files saved in **File manager**, you can create playlists. You can add a file to more than one playlist.

When you delete a playlist or a file from the playlist, the actual music or video file is not deleted from the memory, just the playlist reference to it. You can still add the file to another playlist.

To create a playlist

- 1 From standby select **Menu**
 - ▶ **WALKMAN** ▶ **More** ▶ **My music**
 - ▶ **Playlists** ▶ **New playlist** ▶ **Add**.
 Enter a name ▶ **OK**.
- 2 Select from the files that are available in **File manager**. You can add several files at a time and you can also add folders. All files in the selected folders will be added to the playlist.

To add files to a playlist

- 1 From standby select **Menu**
 - ▶ **WALKMAN** ▶ **More** ▶ **My music**
 - ▶ **Playlists** select a playlist ▶ **Open**
 - ▶ **More** ▶ **Add media**.
- 2 Select from the files that are available in **File manager**.

To remove files from a playlist

- 1 From standby select **Menu**
 - ▶ **WALKMAN** ▶ **More** ▶ **My music**
 - ▶ **Playlists** select a playlist ▶ **Open**.
- 2 Select the file and press **G**.

To delete a playlist

From standby select **Menu**

- ▶ **WALKMAN** ▶ **More** ▶ **My music**
- ▶ **Playlists** select a playlist and press **G**.

WALKMAN options

- ▶ **More** for options:
- ▶ **My music** – browse music files.
- ▶ **Settings** for the following:
 - **Play mode** – change the playback order of tracks. Select **Shuffle** to play the playlist in random order, or **Loop** to restart the playlist when the last track has been played.
 - **Equalizer** – change treble and bass settings.

- **Stereo widening** – change the output sound.
 - **Visualizations** – change visualizations to accompany the music.
 - **Skins** – change the background colour.
- ▶ **File** for the following:
- **Send** – send a music file or video clip.
 - **Information** – view information about the current file.
 - **Delete** – remove a file. In user-created playlists only the reference to the file is removed. In the **Tracks** list, the file is permanently deleted from the memory.
- ▶ **Save playlist** – create your own playlists.
- ▶ **Minimize** – minimize the Walkman® player and return to standby with the music still playing.

Online music and videos

View videos and listen to music by streaming them to your phone from the Internet. For more information, contact your network operator or visit www.sonyericsson.com/cn.

To select a data account for streaming

From standby select **Menu** ▶ **Settings** ▶ the **Connectivity** tab ▶ **Streaming settings** and select the data account to use.

To stream video and audio

- 1 From standby select **Menu** ▶ **Monternet** ▶ **More** ▶ **Go to** ▶ **Enter address** or **Bookmarks**.
- 2 Enter or choose the address or bookmark of a Web page and select a link to stream from. A player opens automatically when a link is selected.

TrackID™

TrackID™ is a free music recognition service. You can automatically search for title, artist and album names about a song you hear playing through a loudspeaker.

To search for song information

From standby select **Menu** ▶ **TrackID™** when you hear a song.



For cost information contact your service provider.

PlayNow™

Listen to music before you purchase and download it to your phone.



This function is network- or operator-dependent. Contact your network operator for information about your subscription and PlayNow™. In some countries/regions you may be able to purchase music tones from some of the world's top musical artists.



This service is not available in all countries/regions.

To listen to PlayNow™ music

From standby select **Menu** ► **PlayNow™** and select music from a list.

Downloading from PlayNow™

The price appears when you select to download and save a music file. Your phone bill or prepay card is debited when a purchase is accepted. Terms and conditions are also provided in the phone kit.

To download a music file

- 1 When you have listened to a music file preview, you can agree to accept the conditions ► **Yes** if you agree.
- 2 A text message is sent to confirm payment and the file is made available to download. Music is saved in **File manager** ► **Music**.

Ringtones and melodies

You can exchange music and sounds, for example, using one of the available transfer methods.



You are not allowed to exchange some copyright-protected material. A protected file has a key symbol.

To select a ringtone

From standby select **Menu** ► **Settings** ► the **Sounds & alerts** tab ► **Ringtone**.

To turn the ringtone on or off

Press and hold **#-*** from standby. All signals except the alarm signal are affected.

To set ringtone volume

- 1 From standby select **Menu** ► **Settings** ► the **Sounds & alerts** tab ► **Ring volume** and press **▲** or **▼** to decrease or increase the volume.
- 2 ► **Save**.

To set the vibrating alert

From standby select **Menu** ► **Settings** ► the **Sounds & alerts** tab ► **Vibrating alert** and select an option.

Sounds and alerts options

From **Settings** ► the **Sounds & alerts** tab, you can also set:

- **Message alert** – select how to be notified of an incoming message.
- **Key sound** – select what sound to hear when you press the keys.

Connectivity

Using Internet, RSS, USB cable, update service.

Using Internet

Use Internet to access online services for example, news and banking, search and browse the Web.

To start browsing

From standby select **Menu** ► **Monternet** and select a service such as ► **More** ► **Go to** ► **Search Internet** or **Enter address** to any Web page.

To view options

From standby select **Menu** ► **Monternet** ► **More**.

To stop browsing

► **More** ► **Exit browser**.



For more information contact your network operator or visit www.sonyericsson.com/cn.

To use Internet keypad shortcuts or access keys

- 1 When browsing, press and hold **#-*** to select **Shortcuts** or **Access keys**.
- 2 If you select **Shortcuts**, you can press a key for a function as follows:

Key	Shortcut
1	Bookmarks
2	Enter address
3	Search Internet
4	History
5	Refresh page
6	Forward
7	Page up
8	Not used
9	Page down - one at the time
*A=0	Fullscreen or Landscape or Normal screen.
0+	Zoom
#-*	Shortcuts or Access keys

RSS reader

When browsing, you can receive frequently updated content, such as news headlines, as feeds via a Web site. You can browse to a Web page to add new feeds, if available. Really Simple Syndication (RSS) options are set via the RSS reader and shown in the Internet browser.

To add new feeds for a Web page

When browsing ► **More** ► **RSS feeds**.

To create a new feed

- 1 From standby select **Menu** ► **Messaging** ► **RSS reader** ► **More** ► **New feed**.
- 2 Enter the address.

To set and use RSS reader options

From standby select **Menu** ► **Messaging** ► **RSS reader** ► **More** and select an option.

Transferring files using the USB cable

Connect your phone to a computer, via the USB cable, to transfer files and synchronize. Select either **File transfer** or **Phone mode**. To transfer files use **File transfer** and to synchronize use **Phone mode**.

 *USB drivers are installed automatically with the PC Suite software.*

To start using the PC Suite

- 1 Computer:** Install the Sony Ericsson PC Suite from the CD that came with your phone or download it from www.sonyericsson.com/cn.
- 2 Computer:** Start PC Suite from *Start/Programs/Sony Ericsson/PC Suite*.
- 3** Connect the USB cable to the phone and the computer.
- 4 Phone:** Select **Phone mode** or **File transfer**.
- 5 Computer:** Wait while Windows installs the required drivers.

- 6 Computer:** When PC Suite has found your phone you are notified.

Applications that you can use with your connected phone are found in the Sony Ericsson PC Suite. Applications that need to be installed can be found on the CD that came with your phone or can be downloaded from www.sonyericsson.com/cn.

File transfer

Transfer files, music or pictures when in **File transfer**. Applications supported in file transfer mode include: Disc2Phone, Adobe Photoshop Album Starter Edition and QuickTime™ player.

 *Only use the USB cable that came with the phone, and connect the USB cable directly to your computer. Do not remove the USB cable from the phone or computer during file transfer as this may corrupt the phone memory or a memory card.*

To use file transfer mode

- 1 Connect the USB cable to the phone and the computer.

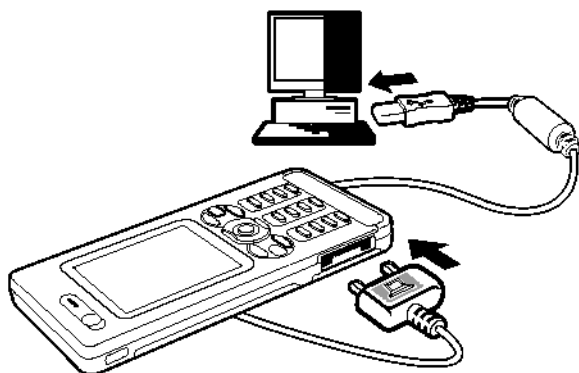

- 2 **Phone:** Select **File transfer**, the phone shuts down.
- 3 Wait until your phone memory and memory card, if inserted, appear as external disks in Windows Explorer.

To disconnect the USB cable safely

- 1 When using file transfer mode, right-click the removable disk icon in Windows Explorer and select **Eject**.
- 2 Remove the USB cable from your phone.

Phone mode

You can synchronize contacts and calendar, transfer files and use the phone as modem with your computer. Applications supported in phone mode include: Synchronization, File manager, Mobile Networking Wizard, Image Editor and MMS Home Studio.

 *Your computer needs to have one of the following operating systems to be able to use this feature: Windows 2000 with SP3/SP4, Windows XP (Pro and Home) with SP1/SP2.*

Update service

Always keep your phone updated with the latest software to improve performance. You do not lose personal or phone information, for example messages or settings during an update.

There are two ways to update your phone:

- over the air via your phone
- via the provided USB cable and an Internet-connected computer.

 *The update service requires data access (GPRS). Your operator will provide you with a subscription with data access and price information.*

To use Update service over the air

- 1 From standby select **Menu** ► **Settings** ► the **General** tab ► **Update service**.
- 2 ► **Search for update** to search for the latest available software. Start the update process by following the installation instructions, or ► **Software version** to show the current software in your phone, or ► **Reminder** to set when to search for new software.

To use Update service via a computer

- 1 Visit www.sonyericsson.com/updateservice.
- 2 Select a region and country/region.
- 3 Read and follow the Installation instructions.
- 4 After the installation start Update service on your computer.
- 5 Follow the instructions to update the phone software.

Important information

Sony Ericsson Consumer Web site

On www.sonyericsson.com/cn is a support section where help and tips are only a few clicks away. Here you find the latest computer software updates and tips on how to use your product more efficiently.

Guidelines for Safe and Efficient Use

Please read this information before using your mobile phone.

These instructions are intended for your safety. Please follow these guidelines. If the product has been subject to any of the conditions listed below or you have any doubt of the proper function make sure to have the product checked by certified service partner before charging or using it. Failure to do so might lead to risk for product malfunction or even a potential hazard to your health.



Recommendations for safe use of product (mobile phone, battery, charger and other accessories)

- Always treat your product with care and keep it in a clean and dust-free place.
- **Warning!** May explode if disposed of in fire.
- Do not expose your product to liquid or moisture or humidity.
- Do not expose your product to extreme high or low temperatures. Do not expose the battery to temperature above +60°C (+140°F).





- Do not expose your product to open flames or lit tobacco products.
- Do not drop, throw or try to bend your product.
- Do not paint your product.
- Do not attempt to disassemble or modify your product. Only Sony Ericsson authorized personnel should perform service.
- Do not close your product with an object inserted between keypad and display; this may damage your product. <only for products with a clamshell design>.
- Do not use your product near medical equipment or in hospitals without requesting permission from your treating physician or authorized medical staff.
- Do not use your product when in, or around aircraft, or areas showing the sign "turn off two-way radio".
- Do not use your product in an area where a potentially explosive atmosphere exists, for example, at a petrol station, oil depot or chemical plant.

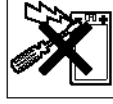

Power supply (Charger)

Connect the AC power adapter only to designated power sources as marked on the product. Make sure the cord is positioned so that it will not be subjected to damage or stress. To reduce risk of electric shock, unplug the unit from any power source before attempting to clean it. The AC power adapter must not be used outdoors or in damp areas. Never alter the cord or plug. If the plug will not fit in to the outlet, have a proper outlet installed by a qualified electrician.

Use only Sony Ericsson branded original chargers intended for use with your mobile phone. Other chargers may not be designed to the same safety and performance standards.

Battery

We recommend that you fully charge the battery before you use your mobile phone for the first time. A new battery or one that has not been used for a long time could have reduced capacity the first few times it is used. The battery should only be charged in temperatures between +5°C (+41°F) and +45°C (+113°F).



CHILDREN

KEEP OUT OF CHILDRENS REACH.
DO NOT ALLOW CHILDREN TO PLAY WITH YOUR MOBILE PHONE OR ITS ACCESSORIES. THEY COULD HURT THEMSELVES OR OTHERS, OR COULD ACCIDENTALLY DAMAGE THE MOBILE PHONE OR ACCESSORY. YOUR MOBILE PHONE OR ITS ACCESSORY MAY CONTAIN SMALL PARTS THAT COULD BE DETACHED AND CREATE A CHOKING HAZARD.

Use only Sony Ericsson branded original batteries intended for use with your mobile phone. Using other batteries and chargers could be dangerous. Talk and standby times depend on several different conditions such as signal strength, operating temperature, application usage patterns, features selected and voice or data transmissions when the mobile phone is being used. Under normal conditions, the stand-by time for this battery is up to xxx hours.

Turn off your mobile phone before removing the battery. Do not put the battery into your mouth. Battery electrolytes may be toxic if swallowed. Do not let the metal contacts on the battery touch another metal object. Doing this could short-circuit and damage the battery. Use the battery for the intended purpose only.

Personal medical devices

Mobile phones may affect the operation of cardiac pacemakers and other implanted equipment. Please avoid placing the mobile phone over the pacemaker, e.g. in your breast pocket. When using the mobile phone, use it at the ear opposite side of the body to the pacemaker. If a minimum distance of 15 cm (6 inches) is kept between the mobile phone and the pacemaker, the risk of interference is limited. If you have any reason to suspect that interference is taking place, immediately turn off your mobile phone. Contact your cardiologist for more information.

For other medical devices, please consult your physician and the manufacturer of the device.

Driving

Please check if local laws and regulations restrict the use of mobile phones while driving or require drivers to use handsfree solutions. We recommend that you use only Sony Ericsson handsfree solutions intended for use with your product.

Please note that because of possible interference to electronic equipment, some vehicle manufacturers forbid the use of mobile phones in their vehicles unless a handsfree kit with an external antenna supports the installation.

Always give full attention to driving and pull off the road and park before making or answering a call if driving conditions so require.

Emergency calls

Mobile phones operate using radio signals, which cannot guarantee connection in all conditions. You should therefore never rely solely upon any mobile phone for essential communications (e.g. medical emergencies).

Emergency calls may not be possible in all areas, on all cellular networks, or when certain network services and/or mobile phone features are in use. Check with your local service provider.

Antenna

This phone contains a built in antenna. Use of antenna devices not marketed by Sony Ericsson specifically for this model could damage your mobile phone, reduce performance, and produce SAR levels above the established limits (see below).

Efficient use

Hold your mobile phone as you would any other phone. Do not cover the top of the phone when in use, as this affects call quality and may cause the phone to operate at a higher power level than needed, thus shortening talk and standby times.

Radio frequency (RF) exposure and SAR

Your mobile phone is a low-power radio transmitter and receiver. When it is turned on, it emits low levels of radio frequency energy (also known as radio waves or radio frequency fields).

Governments around the world have adopted comprehensive international safety guidelines, developed by scientific organizations, e.g. ICNIRP (International Commission on Non-Ionizing Radiation Protection) and IEEE (The Institute of Electrical and Electronics Engineers Inc.), through periodic and thorough evaluation of scientific studies. These guidelines establish permitted levels of radio wave exposure for the general population. The levels include a safety margin designed to assure the safety of all persons, regardless of age and health, and to account for any variations in measurements.

Specific Absorption Rate (SAR) is the unit of measurement for the amount of radio frequency energy absorbed by the body when using a mobile phone. The SAR value is determined at the highest certified power level in laboratory conditions, but the actual SAR level of the mobile phone while operating can be well below this value. This is

because the mobile phone is designed to use the minimum power required to reach the network. Variations in SAR below the radio frequency exposure guidelines do not mean that there are variations in safety. While there may be differences in SAR levels among mobile phones, all Sony Ericsson mobile phone models are designed to meet radio frequency exposure guidelines.

For phones sold in the U.S., before a phone model is available for sale to the public, it must be tested and certified by the Federal Communications Commission (FCC) that it does not exceed the limit established by the government-adopted requirement for safe exposure. The tests are performed in positions and locations (that is, at the ear and worn on the body) as required by the FCC for each model. For body-worn operation, this phone has been tested and meets FCC RF exposure guidelines when the handset is positioned a minimum of 15 mm from the body without any metal parts in the vicinity of the phone or when used with the original Sony Ericsson accessory intended for this phone and worn on the body. Use of other accessories may not ensure compliance with FCC RF exposure guidelines.

A separate leaflet with SAR information for this mobile phone model is included with the material that comes with this mobile phone. This information can also be found, together with more information on radio frequency exposure and SAR, on: www.sonyericsson.com/hcn.

Accessible Solutions/Special Needs

For phones sold in the U.S., you can use your TTY terminal with your Sony Ericsson mobile phone (with the necessary accessory). For information on Accessible Solutions for individuals with special needs call the Sony Ericsson Special Needs Center at 877 878 1996 (TTY) or 877 207 2056 (voice), or visit the Sony Ericsson Special Needs Center at www.sonyericsson-snc.com.

Disposal of old electrical & electronic equipment

This symbol indicates that all electrical and electronic equipment included shall not be treated as household waste. Instead it shall be left at the appropriate collection point for the recycling of electrical and electronic equipment. By ensuring this product is disposed of correctly, you will help prevent potential negative consequences for the environment and human health, which could otherwise be caused by inappropriate waste handling of this product. The recycling of materials will help to conserve natural resources. For more detailed information about recycling of this product, please contact your local city office or your household waste disposal service.



Disposing of the battery

Please check local regulations for disposal of batteries or call your local Sony Ericsson Call Center for information.

The battery should never be placed in municipal waste. Use a battery disposal facility if available.



Memory Card

Your product comes complete with a removable memory card. It is generally compatible with the handset purchased but may not be compatible with other devices or the capabilities of their memory cards. Check other devices for compatibility before purchase or use.

The memory card is formatted prior to shipping. To reformat the memory card, use a compatible device. Do not use the standard operating system format when formatting the memory card on a PC. For details, refer to the operating instructions of the device or contact customer support.

WARNING:

If your device requires an adapter for insertion into the handset or another device, do not insert the card directly without the required adapter.

Precautions on Memory Card Use

- Do not expose the memory card to moisture.
- Do not touch terminal connections with your hand or any metal object.
- Do not strike, bend, or drop the memory card.
- Do not attempt to disassemble or modify the memory card.
- Do not use or store the memory card in humid or corrosive locations or in excessive heat such as a closed car in summer, in direct sunlight or near a heater, etc.
- Do not press or bend the end of the memory card adapter with excessive force.
- Do not let dirt, dust, or foreign objects get into the insert port of any memory card adapter.
- Check you have inserted the memory card correctly.
- Insert the memory card as far as it will go into any memory card adapter needed. The memory card may not operate properly unless fully inserted.
- We recommend that you make a backup copy of important data. We are not responsible for any loss or damage to content you store on the memory card.
- Recorded data may be damaged or lost when you remove the memory card or memory card adapter, turn off the power while formatting, reading or writing data, or use the memory card in locations subject to static electricity or high electrical field emissions.

Accessories

Sony Ericsson recommends use of Sony Ericsson original accessories for safe and efficient use of its products. Use of third-party accessories may decrease performance or pose a risk to your health or safety.

LOUDNESS WARNING:

Please adjust the audio volume cautiously when using third-party audio accessories to avoid volume levels that may be harmful to your hearing. Sony Ericsson does not test use of third-party audio accessories with this mobile phone. Sony Ericsson recommends using only Sony Ericsson original audio accessories.

End User Licence Agreement

This wireless device, including without limitation any media delivered with the device, ("Device") contains software owned by Sony Ericsson Mobile Communications AB and its affiliated companies ("Sony Ericsson") and its third party suppliers and licensors ("Software").

As user of this Device, Sony Ericsson grants you a non-exclusive, non-transferable, non-assignable license to use the Software solely in conjunction with the Device on which it is installed. Nothing herein shall be construed as a sale of the Software to a user of this Device.

You shall not reproduce, modify, distribute, reverse engineer, decompile, otherwise alter or use any other means to discover the source code of the Software or any component of the Software. For avoidance of doubt, you are at all times entitled to transfer all rights and obligations to the Software to a third party, solely together with the Device with which you received the Software, provided always that such third party agrees in writing to be bound by these rules.

You are granted this license for a term of the useful life of this Device. You can terminate this license by transferring all your rights to the Device on which you have received the Software to a third party in writing. If you fail to comply with any of the terms and conditions set out in this license, it will terminate with immediate effect.

Sony Ericsson and its third party suppliers and licensors are the sole and exclusive owner of and retain all rights, title and interest in and to the Software. Sony Ericsson, and, to the extent that the Software contains material or code of a third party, such third party, shall be entitled third party beneficiaries of these terms.

The validity, construction and performance of this license shall be governed by the laws of Sweden. The foregoing shall apply to the full extent permitted by, when applicable, statutory consumer rights.

Limited Warranty

Communications AB, SE-221 88 Lund, Sweden, (Sony Ericsson) or its local affiliated company provides this Limited Warranty for your mobile phone and original accessory delivered with your mobile phone (hereinafter referred to as "Product"). Should your Product need warranty service, please return it to the dealer from whom it was purchased, or contact your local Sony Ericsson Call Center (national rates may apply) or visit www.sonyericsson.com/cn to get further information.

WHAT WE WILL DO

If, during the warranty period, this Product fails to operate under normal use and service, due to defects in design, materials or workmanship, Sony Ericsson authorised distributors or service partners, in the country/region* where you purchased the Product, will, at their option, either repair or replace the Product in accordance with the terms and conditions stipulated herein.

Sony Ericsson and its service partners reserve the right to charge a handling fee if a returned Product is found not to be under warranty according to the conditions below.

Please note that some of your personal settings, downloads or other information may be lost when your Sony Ericsson Product is repaired or replaced. At present Sony Ericsson may be prevented by applicable law, other regulation or technical restrictions from making a backup copy of certain downloads. Sony Ericsson does not take any responsibility for any lost information of any kind and will not reimburse you for any such loss. You should always make backup copies of all the information stored on your Sony Ericsson Product such as downloads, calendar and contacts before handing in your Sony Ericsson Product for repair or replacement.

CONDITIONS

- 1 The warranty is valid only if the original proof of purchase issued to the original purchaser by a Sony Ericsson authorised dealer, specifying the date of purchase and serial number**, for this Product, is presented with the Product to be repaired or replaced. Sony Ericsson reserves the right to refuse warranty service if this information has been removed or changed after the original purchase of the Product from the dealer.
- 2 If Sony Ericsson repairs or replaces the Product, the repaired or replaced Product shall be warranted for the remaining time of the original warranty period or for thirty (30) days from the date of repair, whichever is longer. Repair or replacement may involve the use of functionally equivalent reconditioned units. Replaced parts or components will become the property of Sony Ericsson.
- 3 This warranty does not cover any failure of the Product due to normal wear and tear, or due to misuse, including but not limited to use in other than the normal and customary manner, in accordance with the Sony Ericsson instructions for use and maintenance of the Product. Nor does this warranty cover any failure of the Product due to accident, software or hardware modification or adjustment, acts of God or damage resulting from liquid.

A rechargeable battery can be charged and discharged hundreds of times. However, it will eventually wear out - this is not a defect. When the talk-time or standby time is noticeably shorter, it is time to replace your battery. Sony Ericsson recommends that you use only batteries and chargers approved by Sony Ericsson.

Minor variations in display brightness and color may occur between phones. There may be tiny bright or dark dots on the display. These are called defective pixels and occur when individual dots have malfunctioned and can not be adjusted. Two defective pixels are deemed acceptable.

Minor variations in the appearance of the camera image may occur between phones. This is not uncommon in digital cameras and does not mean that the camera is defective in any way.

- 4 Since the cellular system on which the Product is to operate is provided by a carrier independent from Sony Ericsson, Sony Ericsson will not be responsible for the operation, availability, coverage, services or range of that system.
- 5 This warranty does not cover Product failures caused by installations, modifications, or repair or opening of the Product performed by a non-Sony Ericsson authorised person.
- 6 The warranty does not cover Product failures which have been caused by use of accessories or other peripheral devices which are not Sony Ericsson branded original accessories intended for use with the Product.
- 7 Tampering with any of the seals on the Product will void the warranty.

- 8 THERE ARE NO EXPRESS WARRANTIES, WHETHER WRITTEN OR ORAL, OTHER THAN THIS PRINTED LIMITED WARRANTY. ALL IMPLIED WARRANTIES, INCLUDING WITHOUT LIMITATION THE IMPLIED WARRANTIES OF MERCHANTABILITY OR FITNESS FOR A PARTICULAR PURPOSE, ARE LIMITED TO THE DURATION OF THIS LIMITED WARRANTY. IN NO EVENT SHALL SONY ERICSSON OR ITS LICENSORS BE LIABLE FOR INCIDENTAL OR CONSEQUENTIAL DAMAGES OF ANY NATURE WHATSOEVER, INCLUDING BUT NOT LIMITED TO LOST PROFITS OR COMMERCIAL LOSS; TO THE FULL EXTENT THOSE DAMAGES CAN BE DISCLAIMED BY LAW.

Some countries/states do not allow the exclusion or limitation of incidental or consequential damages, or limitation of the duration of implied warranties, so the preceding limitations or exclusions may not apply to you.

The warranty provided does not affect the consumer's statutory rights under applicable legislation in force, nor the consumer's rights against the dealer arising from their sales / purchase contract.

** In some countries/regions additional information is requested. If so, this is clearly shown on the valid proof of purchase.

FCC Statement

This device complies with Part 15 of the FCC rules. Operation is subject to the following two conditions:

- (1) This device may not cause harmful interference, and
- (2) This device must accept any interference received, including interference that may cause undesired operation.



Declaration of Conformity

We, Sony Ericsson Mobile Communications AB of
Nya Vattentornet

SE-221 88 Lund, Sweden

declare under our sole responsibility that our
product

Sony Ericsson type AAB-1022071-BV

and in combination with our accessories, to which
this declaration relates is in conformity with the
appropriate standards 3GPP TS 51.010-1,
EN 301489-7, EN 300328, EN 301489-17 and
EN 60950, following the provisions of, Radio
Equipment and Telecommunication Terminal
Equipment directive 99/5/EC with requirements
covering EMC directive 89/336/EEC, and Low
Voltage directive 73/23/EEC.

Lund, December 2006

CE 0682



Shoji Nemoto,

Head of Product Business Group GSM/UMTS

We fulfil the requirements of the R&TTE Directive
(99/5/EC).

Index

- A**
 activity menu 20
 automatic redialling 23
- B**
 battery
 inserting and charging 4
 use and care 47
 buttons 9, 13
- C**
 call list 29
 caller-specific ringtones 28
 calls
 answering and rejecting 23
 emergency 24
 international 23
 making and receiving 7, 23
 missed 23
 camera 6, 34
 contacts
 adding phone contacts 25
 default contacts 24
- D**
 declaration of conformity 53
 Disc2Phone 37
- E**
 email 32
 entering letters 15
- F**
 file manager 21
- H**
 handsfree 10, 36
 help 6
- K**
 keypad lock 8
 keys 9, 13
- L**
 lock
 keypad 8
- M**
 memory status 26
 Memory Stick Micro™ (M2™) 8
 menu overview 11
 menus 13
 messages
 email 32
 picture 31
 text 30

microphone	23	SIM card	
MMS See picture messages	31	contact numbers	25
music		copying to/from	28
transferring	38	SMS See text messages	30
video files	37	SOS See emergency numbers	24
My friends	33	standby	6
N		streaming media	40
navigating menus	13	Stroke input	17
networks	22	submenus	13
P		T	
phone overview	9	T9™ Text Input	15
picture messages	31	text messages	30
picture sizes	34	TrackID™	40
pictures	36	transfer method	
Pinyin input	19	USB	44
playlists	39	transferring	
PlayNow™	41	camera pictures	35
		files	44
		music	38
R		U	
ringtones	41–42	update service	45
RSS reader	43	V	
S		video camera	34
safety guidelines	46	video player	40
sending		volume	
pictures	36	ear speaker	23
setup wizard	5	ringtone	41

W
Walkman™ player 40

Z
zoom
camera 34

