

## Device basics

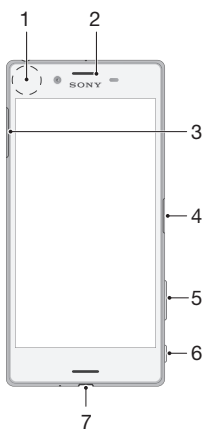

- |   |                              |
|---|------------------------------|
| 1 | NFC                          |
| 2 | Charging/Notification light  |
| 3 | Nano SIM/Memory card slot    |
| 4 | Power key/Fingerprint sensor |
| 5 | Volume/Zoom key              |
| 6 | Camera key                   |
| 7 | Charger/USB cable port       |

! In addition to using a single SIM card, the combined SIM/Memory card holder allows you to use either an additional SIM card or an additional memory card. It is not possible to use two SIM cards and a memory card at the same time.

### To insert one or two nano SIM cards

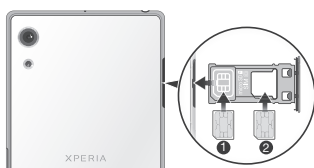

- 1 Using your fingernail, drag out the SIM/Memory card holder.
- 2 Firmly place the primary SIM card (SIM 1) in the correct horizontal orientation in position (1) as shown in the illustration.
- 3 Firmly place the additional SIM card (SIM 2) in the correct horizontal orientation in position (2) as shown in the illustration.
- 4 Gently push the holder into the slot until it fits into place.

## To insert one nano SIM card and one memory card

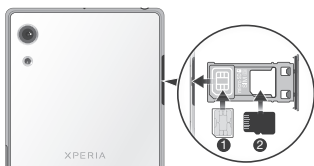

- 1 Using your fingernail, drag out the SIM/Memory card holder.
- 2 Firmly place the SIM card in the correct horizontal orientation in position (1) as shown in the illustration.
- 3 Firmly place the memory card in the correct horizontal orientation in position (2) as shown in the illustration.
- 4 Gently push the holder into the slot until it fits into place.

## To turn on the device

- ! Make sure that the battery is charged for at least 30 minutes before you turn on the device for the first time.
- 1 Press and hold down the power key (⏻) until the device vibrates.
  - 2 Wait a moment for the device to start.

## To activate the screen

- Briefly press the power key (⏻).

## Screen protection

- ! Before using your device, remove the protection film by pulling up on the protruding tab.

It is recommended to protect your device with a Sony branded screen cover or a protector intended for your Xperia™ model. The use of third party screen protection accessories may prevent your device from working correctly by covering sensors, lenses, speakers, or microphones and can invalidate the warranty.

## Support for you

Access our support website directly on your device or visit [support.sonymobile.com](http://support.sonymobile.com) with any supported browser. Support options include User guides, downloadable content, troubleshooting tips and contact information.

- ! Even if you don't have a network connection, you can access support contact information on your device. Depending on the country or region where you purchased your device, you can find this information directly in the Support application.

## To access the Support application

- 1 From your Home screen, tap (⋮).
  - 2 Find and tap (?).
- ! For the best support available, we recommend connecting to the Internet when using the Support application.

## Warranty, SAR and usage guidelines

For information about warranty, SAR (Specific Absorption Rate) and safety guidelines, please read the **Important information** provided under **Settings > About phone > Legal information** on your device.

## Dust and water protection

Your device is waterproof and protected against dust; all ports and attached covers should be firmly closed. You should not put the device completely under water or expose it to sea water; salt water; chlorinated water; or liquids such as drinks. Improper use will invalidate the warranty. Your device has the Ingress Protection ratings IP65 and IP68. For more information about IP ratings, visit [www.sonymobile.com/waterproof](http://www.sonymobile.com/waterproof).

- ! Your capless USB port must be completely dry before a cable can be connected. If your USB port gets wet, wipe it dry with a microfibre cloth and shake it several times with the USB port facing downwards. Repeat until no moisture is visible in the USB port.

## Transferring contacts and content

If you need help to transfer contacts, messages, photos or other data from an old device to your new device, we recommend that you use the Xperia™ Transfer application. Visit [www.sonymobile.com/xperiatransfer](http://www.sonymobile.com/xperiatransfer) for more information.

## To view the CE mark



- 1 Using your fingernail, drag out the nano SIM/Memory card holder.
- 2 Drag out the label tray in the same way.  
The CE mark and FCC ID are displayed on the label tray.

## To view the regulatory compliance mark

- Open the phone dialer, then enter **\*#07#**.

## Legal information

Publication number: 1301-1424.1

This Startup guide is published by Sony Mobile Communications Inc. or its local affiliated company, without any warranty. Improvements and changes to this Startup guide necessitated by typographical errors, inaccuracies of current information, or improvements to programs and/or equipment, may be made by Sony Mobile Communications Inc. at any time and without notice. Such changes will, however, be incorporated into new editions of this Startup guide. All illustrations are for illustration only and may not accurately depict the actual device.

See regulatory information such as the device CE mark in the relevant label tray in the device.

All product and company names mentioned herein are the trademarks or registered trademarks of their respective owners. Any rights not expressly granted herein are reserved. Visit [www.sonymobile.com/global-en/legal/](http://www.sonymobile.com/global-en/legal/) for more information.

Product compliance: This product has been manufactured by or on behalf of Sony Mobile Communications Inc., 4-12-3 Higashi-Shinagawa, Shinagawa-ku, Tokyo, 140-0002 Japan. Inquiries related to product compliance based on national legislation shall be addressed to Sony Mobile Quality Office, Sony Mobile Communications Inc., 4-12-3 Higashi-Shinagawa, Shinagawa-ku, Tokyo, 140-0002 Japan. Should your device need warranty service, please return it to the dealer from whom it was purchased or visit [support.sonymobile.com/contact](http://support.sonymobile.com/contact) to contact your local Sony Mobile repair partner (national rates may apply).

© 2016 Sony Mobile Communications Inc. All rights reserved.

## Supported frequency bands

Some frequency bands might be turned off in certain markets or by certain operators.

**F8132**

UMTS HSPA+ 800 (Band VI), 800 (Band XIX), 850 (Band V), 900 (Band VIII), 1700 (Band IV), 1900 (Band II),  
2100 (Band I) MHz GSM GPRS/EDGE 850, 900, 1800, 1900 MHz LTE (Bands 1, 2, 3, 4, 5, 7, 8, 12, 13,  
17,19, 20, 26, 28, 29, 38, 39, 40, 41)

**SONY**<sup>®</sup>

## Startup guide

Xperia™ X Performance  
F8132

XPERIA

Sony Mobile Communications Inc.  
4-12-3 Higashi-Shinagawa, Shinagawa-ku, Tokyo, 140-0002 Japan

**CE 0682** 

1301-1424.1