

## Appendix D.

### < Product photo >

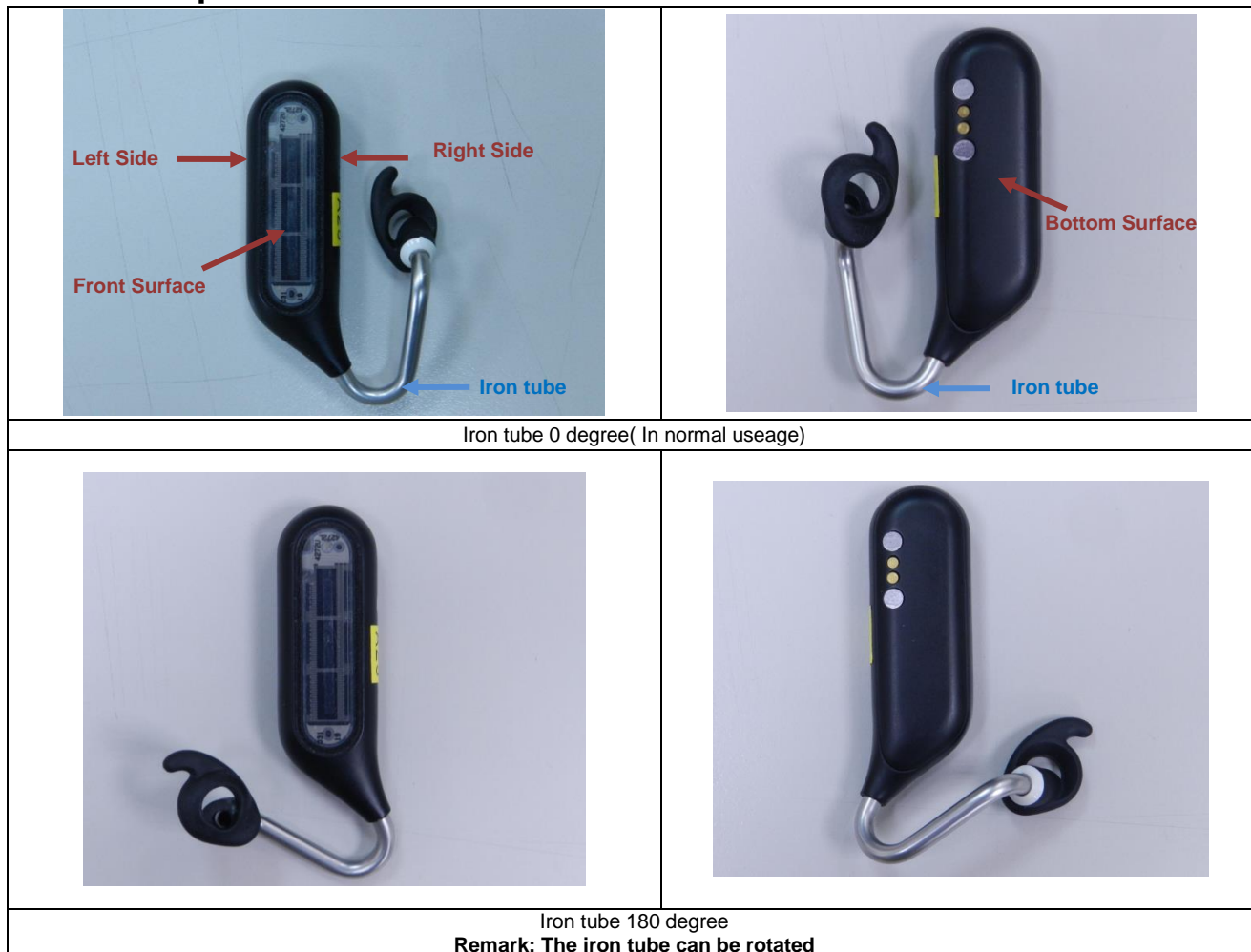

### <Antenna Location>

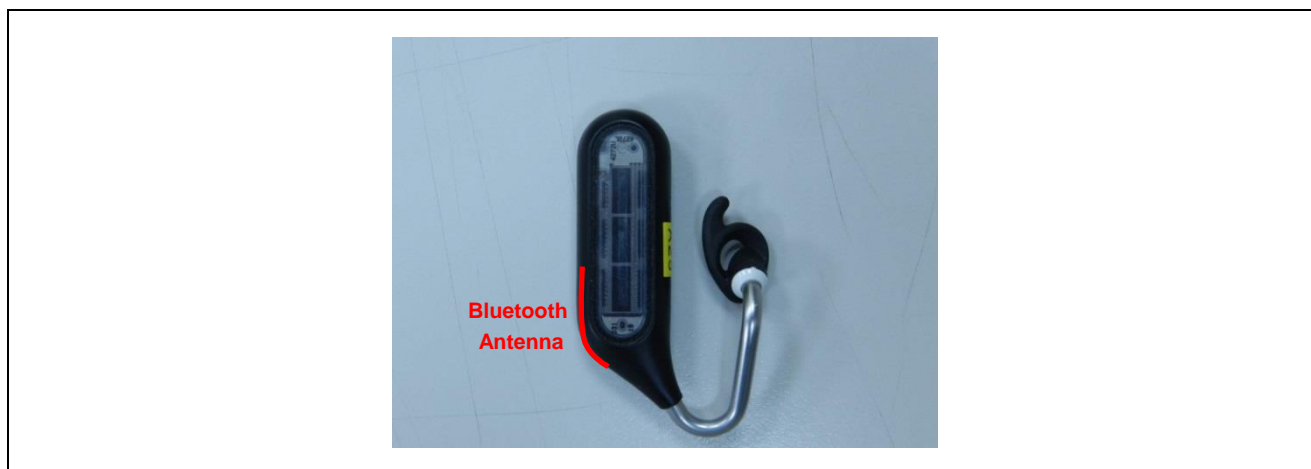

## Appendix D. SAR Test Setup Photos

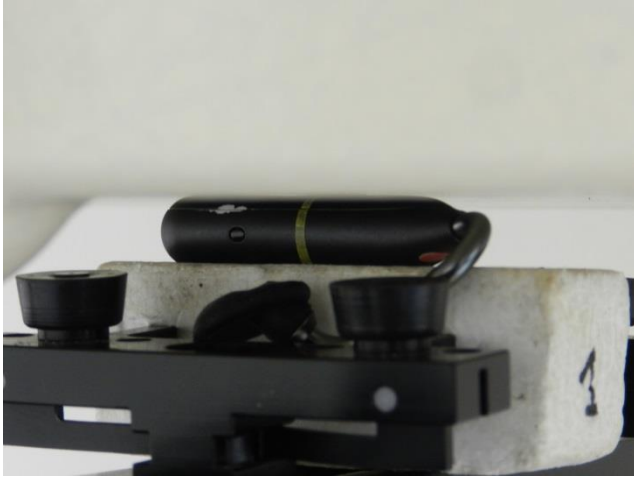

Bottom Face, Test Separation 0 mm



Front Face, Test Separation 0 mm



Right Side, Test Separation 0 mm

**Note:** Since the devices with form factors that do not conform to a flat phantom, and iron tube gets in the way of Right Side positioning, therefore the whole Right Side of Bluetooth headset was slant and touch the flat phantom for the SAR testing, additional separation introduced by the SAR peak location against to flat phantom is <5 mm and 1g reported SAR is relative low and <1.2W/kg, therefore, the back SAR test position is compliance with RF exposure requirement.



Right side (Flat phantom), additional separation introduced by the contour against a surface of the Flat phantom is 3 mm