



arlo™

Arlo Baby  
Quick Start Guide



# Welcome

Thank you for choosing Arlo Baby.  
Getting started is easy.

## What's Included



Arlo Baby  
camera



USB power  
cable



USB power  
adapter



Quick Start Guide



Wall-mount  
plate



Mounting  
screws

## Plug In Your Camera

Connect one end of the USB power cable to the port on the camera.

Plug the other end of the USB cable into the power adapter.

Plug the USB power adapter into a wall socket and wait for the camera LED to blink amber.

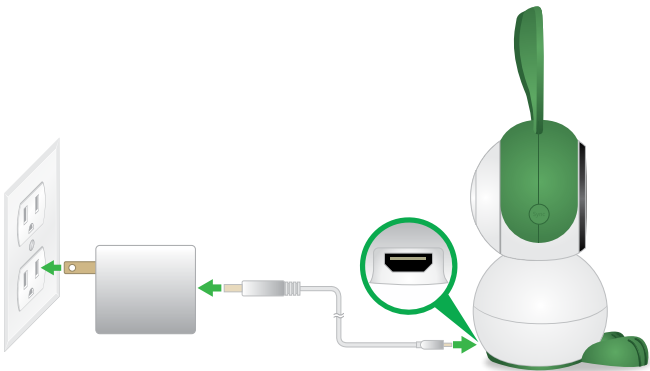

## Get the App

For the best experience, download the Arlo app for your smartphone by scanning this QR code or searching for Arlo in the app store.



[arlo.netgear.com](http://arlo.netgear.com)



**Note:** If you already use the Arlo app, make sure that you are using the latest version. To find out if an update is available, go to the app store and search for Arlo.

## Get a New Account or Log In

### ➤ To create a new Arlo account:

1. Launch the Arlo app from your smartphone, tap **New to Arlo?**, and select **Arlo Baby**.

If you are using a computer, visit [arlo.netgear.com](http://arlo.netgear.com).

2. Follow the onscreen instructions.

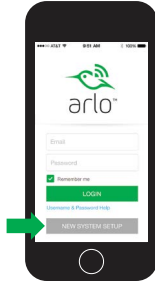

### ➤ To add an Arlo Baby camera to an existing Arlo account:

1. If you already set up an Arlo account, log in and click or tap **Add Device**.
2. Follow the onscreen instructions.

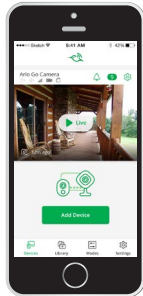

## Connect Your Camera

Follow the onscreen instructions either in the Arlo app or from a computer to connect your camera to your router.

**Note:** If you own an Arlo Wire-Free system, do not connect your Arlo Baby camera to the Arlo base station.

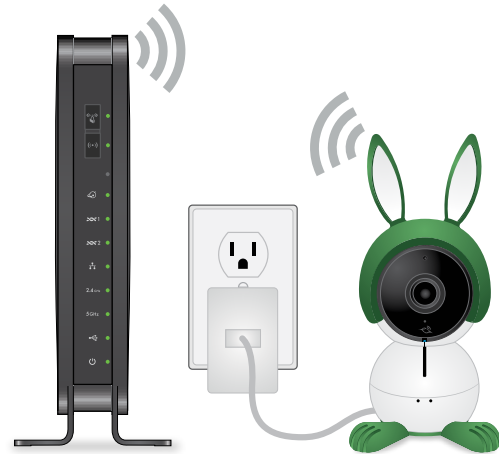

## Place Your Camera

You can place your camera on a shelf or other flat surface, or you can mount it on the wall.

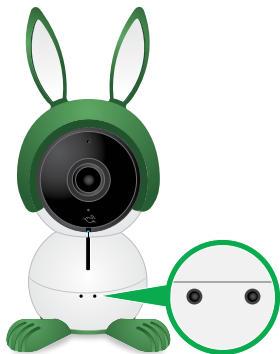

**Note:** Do not cover or obstruct the inlet holes for the sensors.

If you are mounting the camera on a wall, place the wall plate and secure it with the included screws.

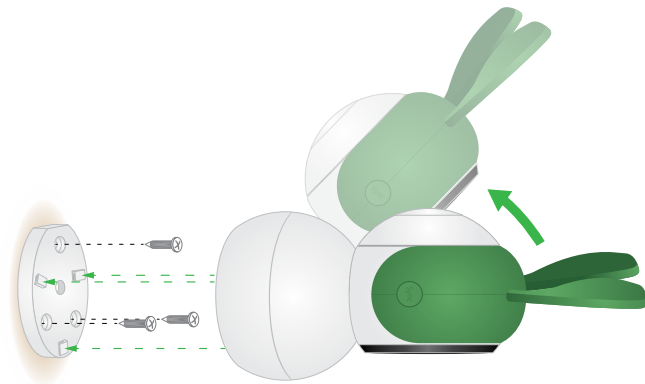

Align the wall plate with the holes on the base of the camera and rotate the base until it snaps into place.

Use Arlo Baby's tilt and swivel functions to position the camera so that it captures the area that you want to monitor.

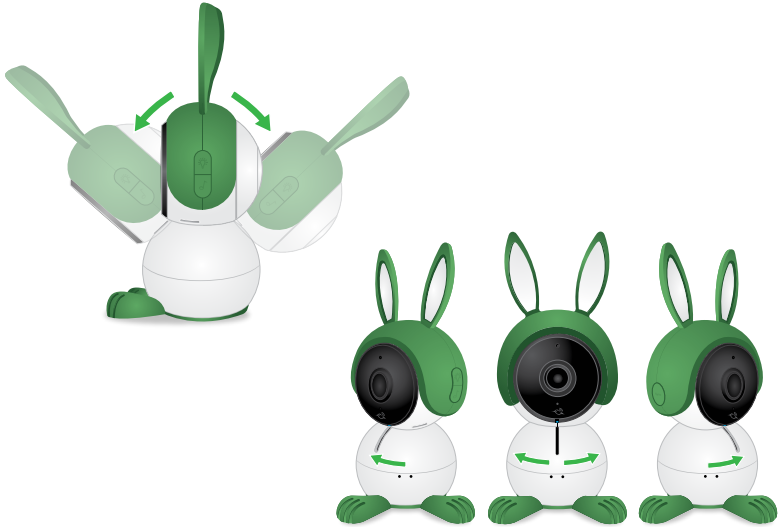

## You're Done!

Congratulations! Your Arlo Baby camera is set up and ready to go.

To view useful tutorial videos, find troubleshooting tips, or get support, visit [support.arlo.com](https://support.arlo.com).

# Arlo Baby Features

## ➤ Rechargeable Battery

Your Arlo Baby camera includes a built-in rechargeable battery and can work for several hours at a time without being plugged in. You can place the camera in locations where you cannot connect it to a power outlet.

Use the switch on the bottom of the camera to power the Arlo Baby camera's battery off. The camera's battery is on when the green color is visible.

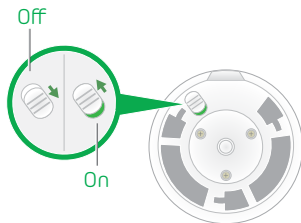

If the camera is unplugged and you don't want the battery to lose its charge, set the switch to off.

## ➤ Night Light

Use the app or the top button on the right side of the camera to turn the night light on and off.

## ➤ Music

Use the app or the bottom button on the right side of the camera to play and pause music.



## Arlo Baby Characters

Arlo Baby cameras come with a bunny character set. You can remove the bunny character set and replace it with other Arlo Baby characters.

- Pull the character ears up to remove them.
- To install character ears, align the ears with the camera lens and press them onto the camera.
- Rotate the character feet and pull them off to remove them.
- To install character feet, align the foot plate with the holes on the bottom of the camera and rotate the foot plate until it clicks into place.

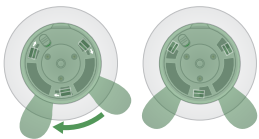

## Camera LED Guide



- Solid blue**  
The camera is powered on and is connected to the Internet.
- Solid purple**  
The camera is connected to a WiFi network. However, it is not connected to the Internet.
- Solid amber**  
The camera is booting.
- Fast blinking blue**  
The camera is connecting to the Internet.
- Blinking purple**  
The camera is too far away from the router.
- Double blink amber every 15 seconds**  
The camera battery charge is low.
- Fast blinking blue for three seconds**  
The camera was connected to a charger.
- Blinking blue and amber**  
A firmware update is in progress. DO NOT TURN OFF THE CAMERA.
- Fast blinking amber**  
The camera is not connected to a WiFi network.
- Off**  
The camera is powered off.



©NETGEAR, Inc., NETGEAR, the NETGEAR Logo, and Arlo are trademarks of NETGEAR, Inc.

## Compliance

For the current EU Declaration of Conformity, visit  
[kb.netgear.com/app/answers/detail/a\\_id/11621/](http://kb.netgear.com/app/answers/detail/a_id/11621/).

For regulatory compliance information, visit  
[netgear.com/about/regulatory/](http://netgear.com/about/regulatory/).

**NETGEAR®**

350 East Plumeria Drive  
San Jose, CA 95134, USA



201-21289-01



**NETGEAR INTL LTD**

Building 3, University Technology Centre  
Curraheen Road, Cork, Ireland

March 2017

## **Federal Communication Commission Interference Statement**

This device complies with Part 15 of the FCC Rules. Operation is subject to the following two conditions: (1) This device may not cause harmful interference, and (2) this device must accept any interference received, including interference that may cause undesired operation.

This equipment has been tested and found to comply with the limits for a Class B digital device, pursuant to Part 15 of the FCC Rules. These limits are designed to provide reasonable protection against harmful interference in a residential installation. This equipment generates, uses and can radiate radio frequency energy and, if not installed and used in accordance with the instructions, may cause harmful interference to radio communications. However, there is no guarantee that interference will not occur in a particular installation. If this equipment does cause harmful interference to radio or television reception, which can be determined by turning the equipment off and on, the user is encouraged to try to correct the interference by one of the following measures:

- Reorient or relocate the receiving antenna.
- Increase the separation between the equipment and receiver.
- Connect the equipment into an outlet on a circuit different from that to which the receiver is connected.
- Consult the dealer or an experienced radio/TV technician for help.

FCC Caution: Any changes or modifications not expressly approved by the party responsible for compliance could void the user's authority to operate this equipment.

This transmitter must not be co-located or operating in conjunction with any other antenna or transmitter.

### **Radiation Exposure Statement:**

This equipment complies with FCC radiation exposure limits set forth for an uncontrolled environment. This equipment should be installed and operated with minimum distance 20cm between the radiator & your body.

**Industry Canada statement:**

This device complies with ISED's licence-exempt RSSs. Operation is subject to the following two conditions: (1) This device may not cause harmful interference, and (2) this device must accept any interference received, including interference that may cause undesired operation.

Le présent appareil est conforme aux CNR d'ISED applicables aux appareils radio exempts de licence. L'exploitation est autorisée aux deux conditions suivantes : (1) le dispositif ne doit pas produire de brouillage préjudiciable, et (2) ce dispositif doit accepter tout brouillage reçu, y compris un brouillage susceptible de provoquer un fonctionnement indésirable.

**Caution :**

- (i) the device for operation in the band 5150-5250 MHz is only for indoor use to reduce the potential for harmful interference to co-channel mobile satellite systems;
- (ii) the maximum antenna gain permitted for devices in the bands 5250-5350 MHz and 5470-5725 MHz shall be such that the equipment still complies with the e.i.r.p. limit;
- (iii) the maximum antenna gain permitted for devices in the band 5725-5850 MHz shall be such that the equipment still complies with the e.i.r.p. limits specified for point-to-point and non-point-to-point operation as appropriate; and
- (iv) the worst-case tilt angle(s) necessary to remain compliant with the e.i.r.p. elevation mask requirement set forth in Section 6.2.2(3) shall be clearly indicated.
- (v) Users should also be advised that high-power radars are allocated as primary users (i.e. priority users) of the bands 5250-5350 MHz and 5650-5850 MHz and that these radars could cause interference and/or damage to LE-LAN devices.

**Avertissement:**

Le guide d'utilisation des dispositifs pour réseaux locaux doit inclure des instructions précises sur les restrictions susmentionnées, notamment :

- (i) les dispositifs fonctionnant dans la bande 5150-5250 MHz sont réservés uniquement pour une utilisation à l'intérieur afin de réduire les risques de brouillage préjudiciable aux systèmes de satellites mobiles utilisant les mêmes canaux;
- (ii) le gain maximal d'antenne permis pour les dispositifs utilisant les bandes de 5250 à 5350 MHz et de 5470 à 5725 MHz doit être conforme à la limite de la p.i.r.e.;
- (iii) le gain maximal d'antenne permis (pour les dispositifs utilisant la bande de 5725 à 5850 MHz) doit être conforme à la limite de la p.i.r.e. spécifiée pour l'exploitation point à point et l'exploitation non point à point, selon le cas;
- (iv) les pires angles d'inclinaison nécessaires pour rester conforme à l'exigence de la p.i.r.e. applicable au masque d'élévation, et énoncée à la section 6.2.2 3), doivent être clairement indiqués.
- (v) De plus, les utilisateurs devraient aussi être avisés que les utilisateurs de radars de haute puissance sont désignés utilisateurs principaux (c.-à-d., qu'ils ont la priorité) pour les bandes 5250-5350 MHz et 5650-5850 MHz et que ces radars pourraient causer du brouillage et/ou des dommages aux dispositifs LAN-EL.

**Radiation Exposure Statement:**

This equipment complies with ISED radiation exposure limits set forth for an uncontrolled environment. This equipment should be installed and operated with minimum distance 20cm between the radiator & your body.

**Déclaration d'exposition aux radiations:**

Cet équipement est conforme aux limites d'exposition aux rayonnements ISED établies pour un environnement non contrôlé. Cet équipement doit être installé et utilisé avec un minimum de 20 cm de distance entre la source de rayonnement et votre corps.