



arlo™

Quick Start Guide





Welcome

Thank you for choosing Arlo.
Getting started is easy.

What's Included



Arlo Q camera



USB cable



USB power adapter



Wall-mount plate



4 Mounting screws

1 Plug In Your Camera

Connect one end of the USB cable to the port on the camera.

Plug the other end of the USB cable into the adapter.

Plug the USB adapter into a wall socket and wait for the camera LED to blink amber.

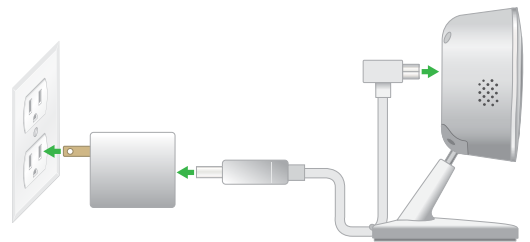

2 Get the App

For the best experience, download the Arlo app for your smartphone by scanning the QR code below or searching for "Arlo" in the app store.



<https://arlo.netgear.com>

3 Get a New Account

Already have an account? See [Add Devices to an Existing Account](#) on page 8.

Launch the app from your smartphone and tap the **New System Setup** button. Follow the onscreen instructions.

Or from a computer, visit <https://arlo.netgear.com/#/login> and click the **New System Setup** button. Select **Arlo Q**.



Add Devices to an Existing Account

Launch the Arlo app and log in to your account.

Tap the **Add Device** button, select **Arlo Q**, and follow the onscreen instructions.



4 Connect Your Camera

Follow the onscreen instructions from either the Arlo app or from a computer to connect your camera directly to your WiFi router.

Note: If you own an Arlo wire-free system, do not connect your Arlo Q camera to the Arlo base station.



5 Place or Mount Your Camera

You can place your camera on a shelf or other flat surface, or you can mount it on the wall.



Note: The camera base includes a magnet that can help position a camera on a metal surface.

If you are mounting the camera on a wall, place the wall plate and secure it in place with four screws.

Slide the camera into the wall plate.

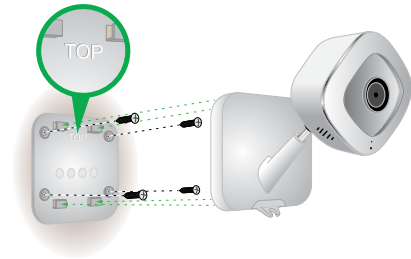

You're Done!

Congratulations! Your Arlo camera is set up and ready to go.

To view useful tutorial videos, find troubleshooting tips, or get support, visit <http://support.arlo.com>.

Camera LED Guide



- Solid amber**
The camera is booting up.
- Slow blinking amber**
The camera is powered on and is ready for setup.
- Fast blinking amber**
The camera is not connected to a WiFi network yet.
- Solid blue**
The camera is powered on and is connected to Arlo servers.
- Slow blinking blue**
The camera is connecting to a WiFi network.
- Fast blinking blue**
The camera is connecting to Arlo servers.
- Solid purple**
The camera is connected to a WiFi network however it is not connected to the internet.
- Blinking purple**
The camera is too far away from the router.
- Blinking blue/amber**
A firmware update is in progress. DO NOT TURN OFF THE CAMERA.
- Off**
The camera is powered off.

Notes

Notes



©NETGEAR, Inc., NETGEAR, the NETGEAR Logo, and Arlo are trademarks of NETGEAR, Inc.

Compliance

For the current EU Declaration of Conformity, visit
http://kb.netgear.com/app/answers/detail/a_id/11621/.
For regulatory compliance information, visit
<http://www.netgear.com/about/regulatory/>.

NETGEAR®

350 East Plumeria Drive
San Jose, CA 95134, USA

September 2015



201-19255-01



Federal Communication Commission Interference Statement

This device complies with Part 15 of the FCC Rules. Operation is subject to the following two conditions: (1) This device may not cause harmful interference, and (2) this device must accept any interference received, including interference that may cause undesired operation.

This equipment has been tested and found to comply with the limits for a Class B digital device, pursuant to Part 15 of the FCC Rules. These limits are designed to provide reasonable protection against harmful interference in a residential installation. This equipment generates, uses and can radiate radio frequency energy and, if not installed and used in accordance with the instructions, may cause harmful interference to radio communications. However, there is no guarantee that interference will not occur in a particular installation. If this equipment does cause harmful interference to radio or television reception, which can be determined by turning the equipment off and on, the user is encouraged to try to correct the interference by one of the following measures:

- Reorient or relocate the receiving antenna.
- Increase the separation between the equipment and receiver.
- Connect the equipment into an outlet on a circuit different from that to which the receiver is connected.
- Consult the dealer or an experienced radio/TV technician for help.

FCC Caution: Any changes or modifications not expressly approved by the party responsible for compliance could void the user's authority to operate this equipment.

This transmitter must not be co-located or operating in conjunction with any other antenna or transmitter.

Radiation Exposure Statement:

This equipment complies with FCC radiation exposure limits set forth for an uncontrolled environment. This equipment should be installed and operated with minimum distance 20cm between the radiator & your body.

Industry Canada statement:

This device complies with RSS-247 of the Industry Canada Rules. Operation is subject to the following two conditions: (1) This device may not cause harmful interference, and (2) this device must accept any interference received, including interference that may cause undesired operation.

Ce dispositif est conforme à la norme CNR-247 d'Industrie Canada applicable aux appareils radio exempts de licence. Son fonctionnement est sujet aux deux conditions suivantes: (1) le dispositif ne doit pas produire de brouillage préjudiciable, et (2) ce dispositif doit accepter tout brouillage reçu, y compris un brouillage susceptible de provoquer un fonctionnement indésirable.

Caution :

(i) the device for operation in the band 5150-5250 MHz is only for indoor use to reduce the potential for harmful interference to co-channel mobile satellite systems;

(ii) high-power radars are allocated as primary users (i.e. priority users) of the bands 5250-5350 MHz and 5650-5850 MHz and that these radars could cause interference and/or damage to LE-LAN devices.

Avertissement:

les dispositifs fonctionnant dans la bande 5 150-5 250 MHz sont réservés uniquement pour une utilisation à l'intérieur afin de réduire les risques de brouillage préjudiciable aux systèmes de satellites mobiles utilisant les mêmes canaux;

(ii) De plus, les utilisateurs devraient aussi être avisés que les utilisateurs de radars de haute puissance sont désignés utilisateurs principaux (c.-à-d., qu'ils ont la priorité) pour les bandes 5 250-5 350 MHz et 5 650-5 850 MHz et que ces radars pourraient causer du brouillage et/ou des dommages aux dispositifs LAN-EL.

Radiation Exposure Statement:

This equipment complies with IC radiation exposure limits set forth for an uncontrolled environment. This equipment should be installed and operated with minimum distance 20cm between the radiator & your body.

Déclaration d'exposition aux radiations:

Cet équipement est conforme aux limites d'exposition aux rayonnements IC établies pour un environnement non contrôlé. Cet équipement doit être installé et utilisé avec un minimum de 20 cm de distance entre la source de rayonnement et votre corps.