

Thank you for buying a Siemens mobile phone.

This user guide is designed to familiarize you with all the functions of your new phone. While reviewing this guide, please pay particular attention to the safety (p. 3) and PIN/Security precautions (p. 17).

The wireless phone described in this guide is approved for use in GSM 1900.

The front and back covers of the casing (CLIPit™ Covers, my-CLIPit™: p. 19 and p. 95) can be changed in a matter of seconds - no tools required:

To attach

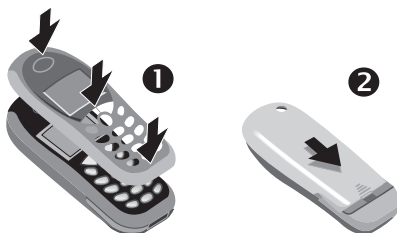

To remove

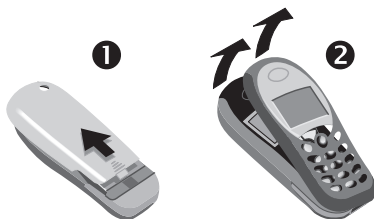

Note

Your phone's display and the display cover of the upper shell are delivered with a protective film. **Remove this film before getting started.**

In rare cases the static discharge may cause discolouration at the edges of the display. However this will disappear within 10 minutes.

Contents

1

Safety precautions	3	Message (SMS)	31
Safety Information	4	Read messages	31
Antenna care	4	Archive	32
Phone operation	4	Compose a message	33
Electronic devices	5	SMS to group	34
SAR (Specific Absorption Rate) ..	9	Surf & fun	39
Overview phone	11	Internet (WAP)	39
General instructions	12	Bitmap viewer	44
User guide	12	Select bitmap style	45
Soft keys	12	Own greeting	45
Getting started	14	Voice message/Mailbox	49
Insert SIM card/battery	14	Cell broadcast	50
Switch on, off/PIN entry	16	Duration/charges	51
Security	17	Display	51
Codes	17	Charge settings	51
My phone	19	Divert	52
Making a phone call	20	Groups	54
Dialling with number keys	20	SMS to group	54
End call	20	Organiser	57
Set volume	20	Diary	57
Reject call	21	Greetings	58
Call waiting/Swap	22	Notes	59
Records	24	Missed alarms	60
Phonebook	26	Alarm clock	60
<New entry>	26	Clock	61
Call/search for an entry	26	Time zones	61
Assign picture	30	Time/Date	61
		Format time	61
		Format date	61
		Auto display	61
		Auto off	61

See also Index at the end of this user guide

Profiles	62	LIMITED WARRANTY	97
Car Kit	63	U.S. FDA	99
Headset	63	FCC/Industry Canada Notice ...	105
My menu	64	Ten Driving Safety Tips	107
Fast access key	65	Intellectual Property	109
Audio	67	Index	110
Ringer setting	67		
Volume	67		
Call screening	67		
Silent alert	67		
Key tones	67		
Minute beep	68		
Information tones	68		
Melody manager	68		
Ringer tones	68		
Setup	69		
User group	74		
Clock	75		
Fax/data mode using a PC	80		
Notes A-Z	81		
Display symbols (selection)	87		
Troubleshooting	89		
Siemens Service	92		
Specifications	93		
Exposure to radiofrequency sig- nals	93		
Technical data	93		
Maintenance	94		
Accessories	95		
Basics	95		
Car Solutions	95		

See also Index at the end of this user guide

Safety precautions

3



Switch off in hospitals or in the vicinity of medical devices, e.g. pacemakers or hearing aids. Mobile phones can interfere with the function of these devices.



Always use the handsfree kit for calls while driving (p. 78)!



Mobile phones must be switched off at all times in an aircraft.



Switch off near petrol stations, fuel depots, chemical plants or blasting operations. Mobile phones can interfere with the operation of technical installations.



The ring tone is reproduced through the earpiece. To avoid damage to hearing, first accept the call, then hold the phone to the ear.



SIM card may be removed. Caution! Small parts could be swallowed by children.



The mains voltage specified on the power supply unit must not be exceeded.



We recommend you use only original Siemens batteries (100% mercury-free) and charging devices. Otherwise considerable health risks and damage to the product cannot be excluded.



Neither the phone nor the battery (100% mercury-free) may be opened under any circumstances (except when exchanging the battery, SIM card or top shell). Any other changes to this device are strictly prohibited, as they will invalidate the type approval criteria required for operation of the unit.

Please note:



Dispose of used batteries and phones according to the legal regulations.



Mobile phones can interfere with the operation of nearby TVs, radios or PCs.



We recommend you use only original Siemens accessories to avoid possible damage and to comply with the existing regulations.

Improper use invalidates the warranty!

Important

Read this information before using your wireless handheld phone.

As this mobile phone is equipped with a fixed (non-retractable) antenna, some paragraphs in the below text may not be applicable.

Antenna care

Use only the supplied or an approved replacement antenna. Unauthorized antennas, modifications, or attachments could damage the phone and may violate FCC regulations.

Phone operation

Normal position

Hold the phone as you would any other telephone with the antenna pointed up and over your shoulder.

Tips on efficient operation

For your phone to operate most efficiently:

- Extend your antenna fully (if applicable).
- Do not touch the antenna unnecessarily when the phone is in use. Contact with the antenna affects call quality and may cause the phone to operate at a higher power level than otherwise needed.

Driving

Laws pertaining to the use of mobile phones while driving vary significantly from state-to-state and sometimes even from locality-to-locality within states. For example, some areas may allow persons to use their mobile phones only if they employ a hands-free device, and some areas may prohibit the use of mobile phones entirely. Accordingly, Siemens recommends that persons check the laws for the areas in which they drive or will be driving. For areas where the use of mobile phones while driving is permitted, Siemens encourages persons to use their phones responsibly and to employ hands-free devices. Also, if using your phone while driving, please:

- Give full attention to driving — driving safely is your first responsibility;
- Use hands-free operation, if available;
- Pull off the road and park before making or answering a call, if driving conditions so require.

Safety Information

5

For vehicles equipped with Air Bags

An air bag inflates with great force. DO NOT place objects, including either installed or portable wireless equipment, in the area over the air bag or in the air bag deployment area. If in-vehicle wireless equipment is improperly installed and the air bag inflates, serious injury could result.

Electronic devices

Most modern electronic equipment is shielded from radiofrequency (RF) signals. However, certain electronic equipment may not be shielded against the RF signals from your wireless phone.

Pacemakers

The Health Industry Manufacturer's Association recommends that a minimum separation of six inches (6") be maintained between a handheld wireless phone and a pacemaker to avoid potential interference with the pacemaker. These recommendations are consistent with the independent research by and recommendations of Wireless Technology Research.

Persons with pacemakers:

- should ALWAYS keep the phone more than six inches from their pacemaker when the phone is turned ON;
- should not carry the phone in a breast pocket;
- should use the ear opposite the pacemaker to minimize the potential for interference;
- should turn the phone OFF immediately if there is any reason to suspect that interference is taking place.

Hearing Aids

Some digital wireless phones may interfere with some hearing aids. In the event of such interference, you may want to consult your service provider or your hearing aid manufacturer to discuss alternatives.

Other Medical Devices

If you use any other personal medical devices, consult the manufacturers of your devices to determine if they are adequately shielded from external RF energy. Your physician may be able to assist you in obtaining this information.

Turn your phone OFF in health care facilities when any regulations posted in these areas instruct you to do so. Hospitals or health care facilities may be using equipment that could be sensitive to external RF energy.

Vehicles

RF signals may affect improperly installed or inadequately shielded electronic systems in motor vehicles. Check with the manufacturer or its representative regarding your vehicle. You should also consult the manufacturer of any equipment that has been added to your vehicle.

Posted Facilities

Turn your phone OFF in any facility where posted notices so require.

Airplanes

FCC and Airline Regulations prohibit using your phone while in the air. Turn your phone OFF before boarding an airplane.

Check and comply with the policy of your airline regarding the use of your phone while the airplane is on the ground.

Blasting areas

To avoid interfering with blasting operations, turn your phone OFF when in a "blasting area" or in areas posted: "Turn off two-way radio." Obey all signs and instructions.

Potentially explosive atmospheres

Turn your phone OFF when in any area with a potentially explosive atmosphere and obey all signs and instructions. Sparks in such areas

could cause an explosion or fire resulting in bodily injury or even death.

Areas with a potentially explosive atmosphere are often but not always clearly marked. They include: fueling areas such as gasoline stations; below deck on boats; fuel or chemical transfer or storage facilities; vehicles using liquefied petroleum gas (such as propane or butane); areas where the air contains chemicals or particles, such as grain, dust or metal powders; and any other area where you would normally be advised to turn off your vehicle engine.

Emergency calls (SOS)

Your wireless phone can be used to make emergency calls. You can make an emergency call from the main display screen. Enter the local emergency number such as 911 and then press the  key

This phone, like any wireless phone, operates using radio signals, wireless and landline networks, and user-programmed functions. Because of this, connections in all conditions cannot be guaranteed. Therefore, you should never rely solely on any wireless phone for essential communications (for example, medical emergencies). Remember - to make or receive any calls, the phone must be switched on and be used in a service area that has adequate signal strength. Emergency calls might not

Safety Information

be possible on all wireless phone networks or when certain network services or phone features are in use. Check with local service providers regarding their network features.

Always make certain that your phone is properly charged before attempting any emergency calls. If you allow your battery to discharge, you will be unable to receive or make calls, including emergency calls. You must then wait a few minutes after the charging begins to place any emergency calls.

When making an emergency call, remember to give all of the necessary information as accurately as possible. Remember that your wireless phone might be the only means of communication at the scene of an accident, therefore you should not terminate the call until given permission to do so.

SAR (Specific Absorption Rate)

9

THIS SIEMENS M46 PHONE MEETS THE GOVERNMENT'S REQUIREMENTS FOR EXPOSURE TO RADIO WAVES.

Your wireless Siemens M46 phone is a radio transmitter and receiver. It is designed and manufactured not to exceed the emission limits for exposure to radiofrequency (RF) energy set by the Federal Communications Commission of the U.S. Government. These limits are part of comprehensive guidelines and establish permitted levels of RF energy for the general population. The guidelines are based on standards that were developed by independent scientific organizations through periodic and thorough evaluation of scientific studies. The standards include a substantial safety margin designed to assure the safety of all persons, regardless of age and health.

The exposure standard for wireless mobile phones employs a unit of measurement known as the Specific Absorption Rate, or SAR. The SAR limit set by the FCC is 1.6 W/kg.* Tests for SAR are conducted using standard operating positions specified by the FCC with the phone transmitting at its highest certified power level in all tested frequency bands. Although the SAR is determined at the highest certified power level, the actual SAR level of the phone while operating can be well below the maximum value. This is because the phone is designed to operate at mul-

tiply power levels so as to use only the power required to reach the network. In general, the closer you are to a wireless base station antenna, the lower the power output.

Before a phone model is available for sale to the public, it must be tested and certified to the FCC that it does not exceed the limit established by the government-adopted requirement for safe exposure. The tests are performed in positions and locations (for example, at the ear and worn on the body) as required by the FCC for each model. The highest SAR value for this Siemens M46 phone when tested for use at the ear is 0.71 W/kg, and when worn on the body, as described in this user guide, is 0.29 W/kg. (Body-worn measurements differ among phone models, depending upon available accessories and FCC requirements.) While there may be differences between the SAR levels of various phones and at various positions, they all meet the government requirement for safe exposure.

The FCC has granted an Equipment Authorization for this Siemens M46 phone with all reported SAR levels evaluated as in compliance with the FCC RF emission guidelines. SAR information on this Siemens M46 phone is on file with the FCC and can be found under the Display Grant section of

<http://www.fcc.gov/oet/fccid>
after searching on FCC ID **PWX-S46**.

For body worn operation, to maintain compliance with FCC RF exposure guidelines, use only Siemens approved accessories. When carrying the phone while it is on, use the specific Siemens belt clip that has been tested for compliance.

Use of non-Siemens-approved accessories may violate FCC RF exposure guidelines and should be avoided.

* In the United States and Canada, the SAR limit for mobile phones used by the public is 1.6 watts/kg (W/kg) averaged over one gram of tissue. The standard incorporates a substantial margin of safety to give additional protection for the public and to account for any variations in measurements.

Additional information on Specific Absorption Rates (SAR) can be found on the Cellular Telecommunications Industry

Association (CTIA) web-site at:

<http://www.wow-com.com>

For SAR information in other regions please look under product information at:

www.icm.siemens.com

Overview phone

11

Loudspeaker

Display indicators

Signal strength/
battery level.

Call key

Select displayed phone
number or name, accept
calls. Display last calls in
standby mode.

Phonebook key

Press once for Phonebook
Press twice for Groups

* Hold down

In standby mode:

Switch signal tones on and
off.

Microphone

Device interface

Connection for charger,
headset etc.

Integrated antenna



Do not interfere with the
phone above the battery
cover unnecessarily. This
reduces the signal strength.

On/Off/End key

Press briefly:
End call/function and return
to standby mode. In menus:
one menu level back.

Hold down:

Switch phone on/off.

From menus: return to
standby mode.

Hold down

In standby mode:
Switch key lock on and off.

Soft keys

The current functions of these
keys are displayed in the grey
fields as text or icons.

These keys display the quick
selection and menu in stand-
by mode. Factory default:

New SMS or e.g.

(SIM service) and
Menu (main menu).

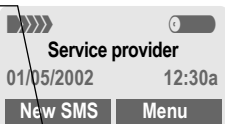

To call up a function dis-
played, press the soft key un-
derneath the function.

Example: Press the **right**
soft key on the **right** to call
up the menu.

Press the soft keys on the **in-
side** to scroll through menus
and lists.

General instructions

12

User guide

The following symbols are used to explain operation:



Enter numbers or letters.



On/Off/End key.



Phonebook key.



Call key.



Press on the inside to scroll up and down.



Press on the outside to call a function (soft key).

Menu

Displays a soft key function.



Function depends on the service provider, special registration may be necessary.

This corresponds to:

1

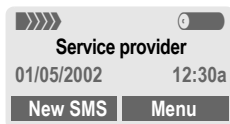

Menu

Open menu.

From standby mode:
Press **right** soft key on the **right**.

2

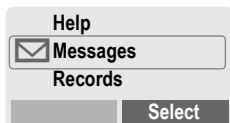

Scroll to **Records**.

Press **right** soft key on the **left** to scroll downwards.

Soft keys

Steps for calling a function are shown in a **condensed form** in this user guide, e.g.: to display the call list for missed calls:

Menu → **Records**
→ **Missed calls**

3



Select

Press.

Press **right** soft key on the **right** to open the **Records** sub-menu.

4

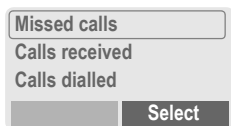

Select

Press.

Press **right** soft key on the **right** to open the list of **Missed** calls.

5



Scroll to the required entry.

Press **right** soft key on the **left** to scroll downwards.

6



View

Press.

Press **left** soft key on the **left** to display the phone number with date and time.

7



Getting started

14

Insert SIM card/battery

The service provider supplies you with a SIM card on which all the important data for your line is stored. If the SIM card has been delivered in credit card size, snap the smaller segment out and remove any rough edges.

- Press grooved area **1**, then lift cover **2**.

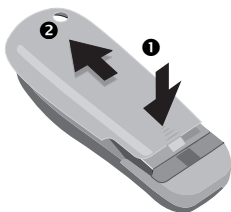

- Press latch in the direction indicated by the arrow **3**, lift battery at the cutout on side of the phone, then tilt upwards and remove **4**.



- Insert SIM card in the opening (contacts pointing downwards) and push gently until it engages (make sure the angled corner is in the correct position **5**).

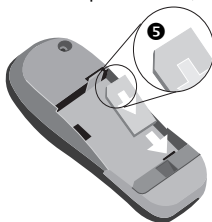

- Insert battery into the phone sideways **6**, then press downwards **7**, until it engages.

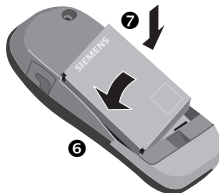

- Replace cover and press downwards until it engages.

Note

Always switch off phone before removing the battery!

Only 3-Volt SIM cards are supported. Please contact your service provider, if you have an older card.

Functions without SIM card p. 86

Charging

The battery is not fully charged when delivered, so:

- Plug in charger cable at the bottom of the phone, plug in the power supply unit to the mains power socket and charge for at least two hours.
- Push the sides of the charger cable plug together and pull to remove it.

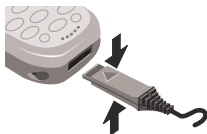

Display when charging is in progress

When charging is in progress.



End of charging.

Charging time

An empty battery is fully charged after about 2 hours. Charging is only possible in an ambient temperature of 41°F to 104°F (the charge icon flashes as a warning when the temperature is 41°F above/below this range). The voltage specified on the power supply must not be exceeded.

Charge icon not visible

If the battery is totally discharged no charge icon is displayed when the charger is plugged in. It will appear after two hours at most. In this case the battery is fully charged after 3-4 hours.

Only use the charger provided!

Display while in service

Charge level display during operation (full-empty):



A beep sounds when the battery is nearly empty.

Note

The charger heats up when used for long periods. This is normal and not dangerous.

Operating Times.....p. 93

Battery care (only NiMH)p. 70

Switch on, off/PIN entry

16

Switch on, off



Hold **down** On/Off/End key to switch on or off.

Enter PIN

The SIM card can be protected with a 4-8 digit PIN.



Enter your PIN code using the number keys (the display shows a series of asterisks, if you make a mistake press **Clear**).

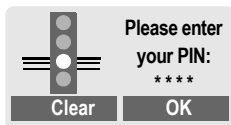

OK

Confirm input with the right key (press on the outside).

Logging on to the network will take a few seconds.

Standby mode

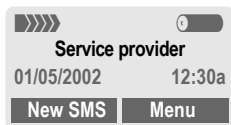

When the name of the service provider appears on the display, the phone is **in standby mode** and **ready for use**.

Note

Signal strength	p. 83
New SMS	p. 33
SOS	p. 81
Change PIN.....	p. 17
SIM card problems	p. 84
Clear SIM card barring	p. 18
Other network.....	p. 72
Set time	p. 61

The phone and SIM card are protected against misuse by several security codes.

Keep these confidential numbers in a safe place where you can access them again if required.

PIN	Protects your SIM card (personal identification number).
PIN2	This is needed to set the charge detail display and to access additional functions on special SIM cards.
PUK PUK2	Key code. Used to unlock SIM cards after the wrong PIN has been entered.
Phone code	Protects your phone. Must be entered at the first security setting.

Menu → **Setup** → **Security**
→ then select a function

Codes

PIN control

The PIN is usually requested each time the phone is switched on. You can deactivate this feature but you risk unauthorised use of the phone.

Select



Press.

OK

Enter PIN.

Change

Confirm input.

OK

Press.

Confirm.

Some service providers do not permit this function.

Change PIN

You can change the PIN to any 4-8 digit number you may find easier to remember.



Enter **old** PIN.

OK

Press.



OK

Enter **new** PIN.



OK

Repeat **new** PIN.

Change PIN2

(display only if PIN 2 is available).
Proceed as with **Change PIN**.

Change phonecode

You define and enter the phone code (4-8 digits) when calling up a phone code protected function (e.g. Babysitter, p. 24) for the first time. It is then valid for all functions. If you have forgotten it, please call Siemens Service (p. 92).

Clear SIM card barring

If the PIN is entered incorrectly three times, the SIM card is barred. Enter the PUK (MASTER PIN) provided by your service provider together with the SIM card according to instructions. If PUK (MASTER PIN) has been lost, please contact your service provider.

Note

Screensaver	p. 45
Auto key lock	p. 69
Further security settings	p. 71

Your phone offers a number of functions so that you can adapt it to meet your personal requirements.

Ringer tones

Assign individual ring tones to caller groups or anniversaries (p. 48).

The melody manager is available for managing the ring tones (p. 46).

Logos, screensavers, animations

Adjust your phone according to your own wishes in the following areas to give it a personal touch:

To switch on

Select a bitmap style (p. 45) and a greeting (p. 45) that you create yourself.

Screensaver (p. 45)

You can set an analogue clock or an individual picture as screensaver.

(Provider) logo (p. 44)

Select an individual picture from the bitmap viewer.

Where do I get what?

You can order additional ring tones, logos and screensavers on the Internet and receive them via SMS:

www.icm.siemens.com

Or you can directly download them via WAP:

wap.my-siemens.com

Siemens City Portal

Further services for your mobile phone (e.g. a Photo Logo Composer to create personal pictures for your Phonebook (p. 30)) can be found at:

www.icm.siemens.com

The Siemens City Portal also offers a list of countries in which these services are available.

CLIPit™ Covers

Select different colours for the top and bottom covers from the Siemens City Portal. Or use a personal photo to make your phone unique (p. 95):

www.icm.siemens.com

My menu

Create your own menu with frequently used functions, phone numbers or WAP pages (p. 64).

Making a phone call

20

Dialling with number keys

The phone must be switched on (standby mode).



Enter the number (always with prefix, if necessary with the international dialling code).

Clear A **short** press clears the last digit, a **long** press clears the entire number.



Press the Call key. The phone number displayed is dialled.

End call



Press the End key **briefly**. Call is ended. Press this key even if the person on the other end of the line has hung up first.

Set volume



You can adjust the handset volume with the scroll keys (only during the call).

If a Car Kit is used, its volume setting does not affect the usual setting on the phone.

Redial previous numbers

To redial the phone number **last** called:



Press the Call key twice.

To redial other numbers that were dialled previously:



Press the Call key once.



Pick out the required phone number from the list, then press ...



... to dial.

Note

Store number	p. 26
Options Call lists	p. 24
Hold	p. 22
menu Call menu	p. 23
Divert Divert set	p. 81
International dialling codes	p. 82
Auto key lock	p. 69
Phone number memo	p. 83
Microphone off	p. 23
Phone number transmission off/on (Hide ID)	p. 75
Control codes (DTMF)	p. 81

When a number is busy

If the called number is busy or cannot be reached because of network problems several options are available (depending on the service provider). An incoming call or any other use of the phone interrupts these functions.

Either

Auto redial previous numbers

Auto dial Press. The number is automatically dialed for up to 15 minutes at increasing intervals. End with:



End key.

or

Call back



Call back Press. Your phone rings when the busy number is free. Press the Call key to dial the number.

Reminder

Prompt Press. A beep reminds you to redial the displayed phone number after 15 minutes.

Accept call

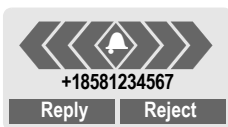

The phone must be switched on (standby mode). An incoming call will interrupt any other use of the phone.

Reply Press.

or



Press.

If the phone number has been transmitted by the network, it is displayed. If it is stored in the Phonebook, the corresponding name is displayed instead.

Reject call

Reject Press.

or



Press.

If **Divert** is set, the caller will be forwarded to voicemail or another number you have entered.

Note



Missed calls p. 25
Accept call using any key p. 69

Making a phone call

22

Hold call

You can call another number during a call.

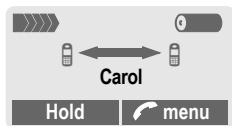

Hold The current call is put on hold. Now dial the new phone number.

When the connection is established press...

Swap ... to swap back and forth between both calls.

Note

menu Call menu p. 23

Call waiting/Swap

You may need to register for this service with your service provider and set your phone accordingly (p. 75).

During a call, you may be advised that there is another call waiting. You will hear a special tone during the call. You have the following options:

Accept the waiting call

Swap Accept the waiting call and place the current call on hold.
To swap between the two calls, press **Swap** each time.

End the current call:



Press. The following query is displayed: "Return to the call on hold?"

Yes Return to the held call.

or

No The held call is ended.

Reject waiting call

Reject Reject the waiting call, the caller will hear the busy tone.

or

Divert If this is set, the waiting call will be diverted, to the mailbox for example.

End current call



End the current call.

Reply Accept the new call.

Conference



Call up to 5 parties one by one and link them together in a phone conference. Some of the functions described may not be supported by your service provider or must be enabled specifically.

You have established a connection:

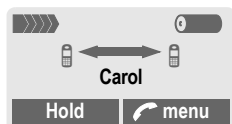

Hold

The current call is put on hold. Now dial a new number. When the new connection is established...

menu

... open menu and select **Conference**. The held call is joined.

Repeat procedure until all participants are linked together (up to 5 participants).

End



All calls in the conference are ended simultaneously when the End key is pressed.

Call menu

The following functions are only available during a call:

menu Open menu.

Microphone on

Switch microphone on/off. If switched off, the person on the other end of the line cannot hear you (muting).

Alternatively:

 Hold down.

However, numbers being entered are audible when **Send DTMF tones** is active.

Volume

Adjust handset volume.

Conference

(see left)

Duration/charges

While the connection continues, the call duration and (if set, p. 51) the charge details are displayed.

Send DTMF tones

(p. 81)

Call transfer



The original call is joined to the second one. For you, both calls are now ended.

Main menu

Access to the main menu.

Call status

List all held and active calls (e.g. participants in a conference).

Making a phone call

24

Babysitter

Only one phone number can be dialled. Hold **down** the **right** soft key on the **right**.



Switch on

Menu → Setup
→ Security → Babysitter

Select Press.



Enter phone code:

When first prompted, you define and enter the phone code (4-8 digits). **Please do not forget this code!**

OK Confirm input.

Change Press.



Select phone number from the Phonebook (p. 26), or enter a new one (with name).

OK The babysitter is now active.

Switch off



Hold **down**.



Enter phone code.

Change Press.

OK Confirm input.

Note

Change phone code p. 18

Records

Your phone stores the phone numbers of calls for convenient redialling.

Menu → Records

Select Press.



Choose call list.

Select Press.



Select phone number.



Dial phone number

or

View Display information on the phone number.

Making a phone call

- Menu** → Records
→ Select function

The following call lists are available:

Missed calls



The phone numbers of calls that you have received but not answered can be recorded for call back purposes.

When you have missed a call, the following icon appears in the display above the left soft key in standby mode:



If you press the left soft key, the phone number is displayed.

Requirement:

The network supports the "Caller Identity" feature.

Calls received



All accepted calls are listed.

Requirement:

The network supports the "Caller Identity" feature.

Calls dialled

Access to the last ten numbers you dialled.



Fast access in standby mode.

Erase records

The contents of all call lists are deleted.

Records menu

The call list menu can be called up if an entry is highlighted.

Options Open list menu.

View	View entry.
Correct no.	Load number into display and correct it there if necessary.
Save no. to 	Store entry in the Phonebook.
Delete	Delete entry after confirmation.
Delete all	Delete all entries of the call list after confirmation.

Note



Press the **right** soft key on the **left** in standby mode for easy access to call lists.

Enter frequently used phone numbers in the Phonebook with a special name. To dial them, simply highlight the name. If a phone number is stored with a name, it appears on the display when you are called. Entries that belong together can be combined to form a **group**.

<New entry>



Open Phonebook.

<Own numbers>

<New entry>

<Groups>

Select

<New entry>

Select.



Activate input fields.



Make the following entries:

Phone Number

Enter phone number (with prefix).

Name

Enter (Text entry, p. 27).

Group

The entry can be assigned to a group, for example:

VIP, Leisure, Office, Family

(p. 28 and p. 54).

Location

Select a storage location such as **SIM card, SIM protected or mobile phone** (p. 29).

Record no.

(storage location number)

Each entry is automatically assigned a number under which it can also be selected (p. 30).

Save

Press.

Call/search for an entry



Open Phonebook.



Select a name with the first letter and/or scroll.



Dial number.

Note

+List International dialling code p. 82

Own numbers p. 83

Store control codes p. 81

Text entry

Press number key repeatedly until the required letter is displayed. The cursor advances after a short delay.



Press **once** for **a**, twice for **b** etc. The first letter in each name is automatically written in UPPERCASE.



Umlauts and numbers are displayed after the relevant letters.



Press briefly to delete the letter before the cursor, hold down to erase the whole name.



Move the cursor (forward/back).

**Press briefly:**

Switch between uppercase, lowercase and digits.

Hold down:

Set input language and text mode.



Activate/deactivate T9 (p. 70).



Write: . , ? ! 0 + - :



Space.



Enter special characters, see p. 84.

Phonebook menu

Options Open menu.

View	Display entry.
Edit	Display phone number and name for changes.
New entry	Create a new Phonebook entry.
Delete	Delete entry from the Phonebook.
Delete all	Delete all entries after confirmation.
Send SMS...	<p>as entry: Send Phonebook entry to recipient.</p> <p>as text: Send entry as text of an SMS message.</p>
Picture	Assign an individual picture to the phone number (p. 30).
Capacity	Display the maximum and available capacity.

Group

If there are many Phonebook entries it is best to assign them to a group, e.g.:

VIP, Leisure, Office, Family

A special melody can sound (p. 48) and/or a symbol can be displayed (p. 29) if the phone number of a call is registered in a group.

Select group



Two short presses **or** one long press on Phonebook (in standby mode).



Select group. The number of entries is displayed in brackets after the group name.

	VIP	(17)
	Leisure	(9)
	Office	(7)
View		Options

View

Press. All entries of the selected group are displayed.

Group menu

Options	Open menu.
View members	Display all entries assigned to the group.
Rename group	Change the current name of the group.
Group symbol	Assign a symbol to a group (p. 29).
Call to group 	Call up to 5 members of a group one by one and link them together in a conference (p. 54).
SMS to group	Send an SMS to all members of a group (p. 54).

Change group assignment

You can assign a Phonebook entry to a group when you enter it (p. 26). To change the group assignment or to assign to a group later:

When the Phonebook is open:



Select entry.

View

Press.

Change

Press.



Scroll to Group.

Change

Press and select a new Group.

Save

Confirm assignment.

Group entry menu

Options	Open menu.
View	Display entry.
Edit	Display the entry for changes.
New entry	Open Phonebook and add an entry to the current group.
Remove entry	Remove entry only from the group.
Remove entries	Remove all members from the selected group.
Send SMS...	as entry: Send a Phonebook entry to recipient. as text: Send entry as text of an SMS message.
Picture	Assign a picture/symbol to phone number.

Group symbol

You can assign one of many standard symbols to a group. Three symbols are displayed at one time. The centre symbol is the current selection.



Choose symbol.



Add symbol to the group entry.

Location

An entry can be moved from the Phonebook to the other storage locations.



Open Phonebook.



Select entry.



Open menu and select **Edit**.



Go to the input field **Location**.

SIM (standard)

Entries that are stored in the Phonebook on the SIM card can also be used on a different GSM Phone.

Protected SIM



Phone numbers can be stored in protected locations on a special SIM card. A PIN 2 is needed for editing (p. 17).

Mobile (phone memory)

Phonebook entries are stored here if the memory of the SIM card is full.

Record no.

A record number (storage location number) is automatically assigned to every new entry in the Phonebook.

Call



Enter record number.



Press.



Press.

Edit

Select entry in the Phonebook.

Options Press and select **Edit**.



Go to **Record no.**

Change Press repeatedly until the required (available) number is displayed.

Save Press.

Assign picture

Assign an individual picture to phone numbers. This picture will appear in the display when there is a call from this number.

Assign picture



Open Phonebook.



Select entry.

Options Open menu and select **Picture**.

The list with your **Own pictures** is displayed.



Select entry.

Load

The bitmap viewer (p. 44) is opened and the picture is displayed.

Select

The picture is assigned to the phone number.

It appears with a symbol in the Phonebook.

Delete/change picture

If a picture is assigned to a phone number, it can be deleted or replaced.



Select entry with picture in the Phonebook.

Options

Press



Select Picture

Delete

The assignment is cleared.

or

Select

The picture list is displayed for new selection.

Note

A picture can be assigned to several phone numbers.

Add pictures to the picture list p. 44

Siemens City Portal p. 19

Message (SMS)

31

You may transmit and receive very long text messages (up to 760 characters) on your phone, which are automatically composed from several "normal" SMS messages (note the accruing charges).

Depending on the service provider, e-mails and faxes can also be sent via SMS (change setting if necessary, p. 37).

Read messages



Display indicates a new message.

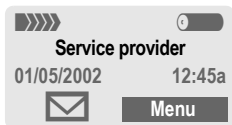

Press the soft key underneath the letter symbol to read the message.

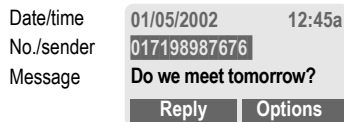

Scroll through the message line by line.

Reply Reply menu shown below.

Options Inbox/outbox menu (p. 32).

Pictures and sounds in SMS

Pictures or **sounds** can be part of messages you receive.

Pictures are shown in the message, sounds are indicated as notes. If a note is reached when scrolling through the message, the corresponding sound is played. For sending pictures and sounds see p. 37.

Note



Message store fullp. 82

Use **highlighted** phone numberp. 83

Reply menu

Reply Open reply menu.

Write message	Create a new reply text (p. 33).
Edit	Edit message received or assign a new text to it.
Answer is YES	Add YES to the message.
Answer is NO	Add NO to the message.
Call back	Append a standard text to the message as a reply.
Delay	
Thanks	

When the message has been edited in the editor, it can be stored or sent with **Options**.

Inbox/outbox

Menu → Messages
→ Inbox or Outbox

The list of saved messages is shown.

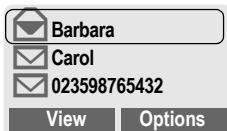

Options See below.

Symbol	Inbox	Outbox
	Read	Not sent
	Unread	Sent

Inbox/outbox menu

Different functions are available depending on the context:

Options Open menu.

View	Read entry.
Reply	Directly answer incoming SMS messages.
Send	Dial number or select from the Phonebook, then send.
Edit	Open editor for changes.
Delete	Delete selected message.
Delete all	Delete all entries after confirmation.

Picture & Sound	List pictures and sounds included in the message.
Capacity	Display maximum and available capacity.
Status report	(Outbox list only) Request delivery confirmation for messages sent.
Mark as unread	Mark the message as unread.
Save no. to	Copy a selected phone number to the Phonebook.
Move to archive	Move message to the archive.

Archive

Menu → Messages → Archive

The list of messages recorded on the phone is shown. Different functions are available depending on the context:

Message (SMS)

33

Archive menu

Options Open menu.

View	Read entry.
Mark text	Highlight text to be edited.
Delete	Delete selected message.
Delete all	Delete all saved messages after confirmation.
Rename	Rename the entry.
Sort	Set sort criteria (alphabetical, time).
Attributes	Display name, size and date.
Capacity	Display maximum and available capacity for SMS archive, special graphics etc.

Compose a message

Menu → Messages → New SMS



Text input using "T9" (p. 35) allows you to quickly create long SMS messages using just a few key entries.

Clear Press **briefly** to delete letter by letter, hold **down** to delete the entire word.



Press.



Dial number or pick out from the Phonebook.

OK

Confirm. The message is sent to the service centre for transmission.

OK

Return to the editor.

Options

Open menu and select **Save** to store the message.

Display in the uppermost line:

T9 Abc SMS 1 748
We start at 8 a.m.

T9

T9 active.

abc/Abc/
ABC/123

Lowercase/uppercase letters or digits.

SMS

Display title.

1

Number of the required SMS messages.

748

Number of characters still available.

Note

Insert pictures & sounds into text p. 37
If **Message type**, **Validity period**,
Service centre: are requested p. 37
Send melodies p. 47
Send graphics p. 44
Enter special characters p. 84
SMS status report p. 84

Message (SMS)

Text menu

Options Open the text menu.

Send	Dial the number or select from the Phonebook, then send.
Save	Save the composed message in the outbox list.
Picture & Sound	Add pictures and sounds to message (p. 37).
Format	Line feed Small font, Medium font, Large font Underline Left, Right, Center (align) Mark text (highlight text with the scroll key)
Clear text	Delete the whole text.
Insert text	Insert predefined text fragment.
Insert from 	Open Phonebook and copy phone number into the message.
Bookmark	Insert URL from the WAP bookmarks into the text.
T9 input (p. 35)	T9 preferred: Activate/deactivate T9 input. Input language: Select the language in which the message is to be composed.

Predefined text

Standard text fragments which can be added to messages are stored in the phone. You can also create five additional text fragments yourself.

Write text fragments

Menu → Messages → Predefined text
<New entry>

Select.



Write text fragment.

Save

Press.

Use text fragments



Compose message (p. 33).

Options Open the text menu.

Insert text Select.



Select text fragment from the list.

Select Confirm. The text fragment is inserted in the message at the cursor position.

SMS to group

You can send messages (SMS) as "circulars" to all members of a group (p. 54).

Message (SMS)

35

Text entry with "T9"

"T9" deduces the correct word from the individual key entires by making comparisons with an extensive dictionary.

Activate, deactivate T9

Options Open text menu.

T9 input Select.

T9 preferred
Select.

 **Activate T9.**

Select Confirm.
To activate or deactivate T9 temporarily: 

Select Input language

Select the language in which you want to compose your message.

Options Open text menu.

T9 input Select.

Input language
Select.

Select Confirm, the new language is set.
Languages with T9 support are marked by the T9 symbol.

Create a word using T9

Since the display changes as you proceed it is **best if you finish a word without looking at the display.**

You simply press the keys where the relevant letter is located **once only**. For "hotel", for example, type:

 Press. A blank ends a word.

 Press repeatedly before the word for lowercase letters/uppercase letters, digits or special characters.

Do not use special characters such as Å but write the standard character, e.g. A, T9 will do the rest for you.

Note

Enter special characters.....p. 84

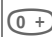
 Full stop. Ends a word when a blank follows. Acts as a wildcard character for an apostrophe/hyphen in the word:

e.g. **provider.s** = provider's.
Go to the right. Ends a word.

 **Press briefly:**

Switch between uppercase, lowercase letters and digits.

Hold down:

Set input language and text mode.

T9 dictionaries for other languages can be found at: www.my-siemens.com/t9

Message (SMS)

T9 word suggestions

If several options are found in the dictionary for a key sequence (a word), the most probable is displayed first. If the word you want has not been recognised, the next suggestion from T9 may be correct.

The word must be **highlighted**. Then press



The displayed word is replaced with a different word. If this word is also incorrect,



press again. Repeat until the correct word is displayed.

If the word you want is not in the dictionary, it may be written without T9.

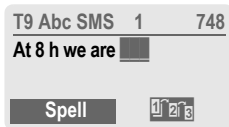

To add a word to the dictionary:

Spell Select.

The last suggestion is deleted and the word may now be entered without T9 support. Press **Save** to add it automatically to the dictionary.

Correct a word

Words created **using** T9:



Move word by word to the left/right until the required word is highlighted.



Scroll through the T9 word suggestions again.



Deletes the letter to the left of the cursor **and** displays a new possible word!

Words **not** created using T9:



Move character by character to the left/right.



Deletes the letter to the left of the cursor.



Characters are inserted at the cursor position.

Note

Within a "T9 word", individual letters may not be edited without cancelling T9 first. In most cases it is better to rewrite the complete word.

T9® Text Input is licensed under one or more of the following: U.S. Pat. Nos. 5, 818, 437, 5, 953, 541, 5, 187, 480, 5, 945, 928, and 6, 011, 554; Canadian Pat. No. 1,331,057; United Kingdom Pat. No. 2238414B; Hong Kong Standard Pat. No. HK0940329; Republic of Singapore Pat. No. 51383; Euro.Pat. No. 0 842 463 (96927260.8) DE/DK, FI, FR, IT, NL, PT, ES, SE, GB; and additional patents are pending worldwide.

Message (SMS)

37

Picture & Sound

Insert pictures and sounds in the message.



Compose the message as usual.

Options Open the text menu at the end of a word.

Picture & Sound

Select.

The Pictures&Sound menu opens:

Fix animations

Fix sounds

Own animat.

Own pictures

Own sounds



Select range.

Select Confirm.

The first entry of the selected range is displayed.



Scroll in the list to the required entry.

Select The picture/animation is "inserted" in the text and shown there as a wildcard.

Note

Playback only occurs on phones that support this function.

In input mode a wildcard is shown instead of the picture/sound.

Add pictures/sounds: SMS (p. 32), WAP (p. 40), Bitmap viewer (p. 44).

Message setup

An SMS profile (maximum 5) defines the transmission characteristics of an SMS. The presetting depends on the SIM card inserted.

Menu → Messages → Message setup

You can select a profile from the list of available profiles. To activate it:

Activate Press.

SMS setup menu

Options Open menu.

Activate Use the selected profile.

Change settings Change settings, see options below.

Rename Rename the profile.

Service centre

Enter or change the phone numbers of the service centre as supplied by the service provider.

Recipient

Enter the standard recipient for this transmission profile or select from the Phonebook.

Message type

Manual	The message type is requested for each message.
Standard text	Normal SMS message.
Fax	Transmission via SMS.
E-mail	Transmission via SMS.
New	You may need to obtain the required code number from your service provider.

SMS via GPRS



When this function is activated, SMS messages are automatically sent via GPRS (if available).

Requirement: GPRS is activated (p. 75). Ensure that your service provider offers this function.

Validity period

Select the period in which the service centre tries to deliver the message:

Manual, 1 hour, 12 hours, 1 day, 1 week, Maximum *, New

*) Maximum period that the service provider permits.

Status report



You are given confirmation of the successful or unsuccessful delivery of a sent message. This service may be subject to a charge.

Direct reply



The reply to your message is handled via your service centre when **Direct Answer** is activated (for information please contact your service provider).

Internet (WAP)

Get the latest WAP information from the Internet that is specifically adapted to the display options of your phone. In addition, you can download games and applications to your mobile phone via WAP. Internet access may require registration with the service provider.

Internet access



Menu → Surf & fun → Internet

The browser is activated as soon as you call up the function. If necessary, set how the Internet access should be made (see **Start with...**, p. 85).

The start menu appears, e.g.:



Select the required function.

Select

Confirm.

You can now surf the Internet.
For further instructions see p. 85.

Start menu

Homepage	The connection to the Internet provider's portal is established (may be set/preset by the service provider).
Bookmarks	Display up to 12 URLs stored in the phone for fast access (p. 85).
Resume	Call up recently visited pages that are still in the memory.
WAP Profiles	Set up to 5 access profiles (p. 76).
Inbox	Inbox for messages from the WAP server.
Exit browser	Close the browser and clear down the connection.

End connection



Hold **down** to end the connection.

Browser menu

If the browser is active, the menu can be activated as follows:



Press

or



Select **@** and confirm.

Homepage	The first WAP Internet page that is displayed after connection is established (may have been set/preset by the service provider).
Bookmarks	Display up to 12 URLs stored in the phone for fast access (p. 85).
Resume	Call up recently visited pages that are still in the memory.
Go to URL	Enter URL for directly accessing an Internet address, e.g. wap.my-siemens.com
Show URL	Show the Internet address of the current page.
Reload	The page is reloaded.
Disconnect	End connection.
More ...	See below.
Exit browser	Close the browser and clear down the connection.

More ...

WAP Profiles	Set up to 5 access profiles (p. 76).
Reset	Delete the pages last visited (cache).
Setup	Font size Protocol parameters <ul style="list-style-type: none"> • Push • Push can force online • Timeout for unanswered network requests • GPRS linger time Security <ul style="list-style-type: none"> • Connection prompt • Secure prompt • Current certificate • CA certificates • Private Key PINs • Encryption Start with... <ul style="list-style-type: none"> • Start menu • Browser menu • Homepage • Resume • Bookmarks
Inbox	Inbox for messages from the WAP server.
Save bitmap	Bitmap viewer opens for editing the picture.
About Openwave	Display the browser version.

Notes

Homepage: The soft keys may be assigned functions that are controlled online from the homepage of your service provider such as "link" or "menu". The contents of the option menus are also variable.

Displays:

	Browser menu
	Offline
	Online
	GPRS Online
	No network

Enter special characters:

	Press 3 times for /
	Press 3 times for @
	Press once for . (full stop)
	Press repeatedly for :
	Press repeatedly for ~

WAP profiles

Preparation of the phone for Internet access depends on the service provider currently used:

- If the settings have already been made by your service provider you may begin immediately.
- If access profiles have been assigned by your service provider select a profile and activate it.
- The access profile must be set manually (p. 76).

If necessary, check with your service provider for details.

Activate WAP profile

You can change the current profile each time before accessing the Internet.

Menu → Surf & fun → Internet
→ WAP Profiles



Select a profile.

Select

Press to activate. The current profile is selected.

Your Internet browser is licensed by:



OPENWAVE™



Games & more

Load games and other applications via WAP. You are advised on relevant applications on the Internet.

Download can start after a game/an application has been selected. You can now use the application/play the game.

Most applications include instructions.

Note

The ISP access for Java™ must be configured to download applications p. 77
Activate a Java™ profile p. 44

Applications and games can be found at:

wap.my-siemens.com

or on the Internet at:

www.icm.siemens.com/city

Games and applications

Applications and links that are already stored on your phone are found under:

Menu → Surf & fun → Games & more

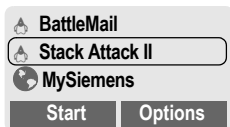

Different functions are available depending on which entry is highlighted:

Carry out game/application offline

Start

Executable application

 can be started directly.

Load game/application online

Load

README only (p. 82);
Application still has to be downloaded.

Go to a link, surf online

Internet

The selected Internet page is loaded.

Receive information

If information, which is required e.g. by an application that has already been installed, is received via **SMS**, the  symbol appears above the left soft key.

By pressing this key, the relevant application is started and the information is processed.

Note

The following key control is used for many games (virtual joystick):

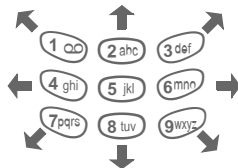

Games & more menu

All functions required for managing your files are found in the Options menu:

Options Open menu.

Download	An application is downloaded from the Internet and installed.
Start	Start application.
Delete	Delete selected application.
Rename	Rename selected applications.
Java Profiles	Select access profile.
Details	Show details on the application (name, version, size, path, producer, date).
Sort	Set sort criteria (alphabetical, time).
More Info	Download further instructions via Internet (WAP), if available.
Reinstall	Reinstall an application (update).
Capacity	Display maximum and available capacity.

WAP can be used to download applications from the internet. Downloading or running applications will not affect or change the software already installed on your Java™-enabled mobile phone. Siemens excludes all warranty and liability claims in respect of or in connection with any applications subsequently installed by the customer and any software not included in the original delivery package. The same applies to functions enabled subsequently at the customer's instigation. The purchaser bears sole risk for the loss of, damage to, and any defects arising in this device or the applications or software and for any direct damage or consequential damage of whatever nature resulting from the use of these applications or software. For technical reasons, such applications or software and subsequent enabling of certain functions are lost in the event of the device being replaced/re-supplied and may be lost if it is repaired. In these cases the purchaser will need to download the application again or re-enable it. Siemens does not warranty or guarantee or accept any liability for the customer's ability to download or enable applications again or to do so free of charge.

Java™ profiles

Preparation of the phone depends on the service provider currently used:

- If the settings have already been made by your service provider you may begin immediately.
- If access profiles have been assigned by your service provider select and activate profile.
- The access profile must be set manually (p. 77).

If necessary, check with your service provider for details.

Activate Java™ profile

Menu → Surf & fun → Games & more
→ Java Profiles



Select the required profile.

Select Press to activate.

Bitmap viewer

Set animations, logos and screensavers on your phone according to your wishes.

Pictures and links that are already stored on your phone are found under:

Start bitmap viewer

Menu → Surf & fun → Bitmap viewer



Select storage location, folder or link:

Own animat.

Own pictures

Screensaver

Logo

URL

Different functions are available depending on which entry is highlighted:

Own animat./Own pictures

Select folder.

Select Press.



Select picture.

Load The picture is displayed.

Screensaver/Logo

Load The picture is displayed.

Go to a link, surf online

Internet The selected Internet page is loaded.

Store pictures

Store pictures currently displayed in the bitmap viewer on a new storage location e.g. to create a new screen-saver:



Select storage location.

Save Press.

Send pictures via SMS

Open bitmap viewer and activate the required picture then:

Options Open menu.

Send Enter recipient or use Phonebook .

OK Confirm.

Receive pictures

If a picture (graphic/screensaver) has been received via **SMS** the  symbol appears above the left soft key.

By pressing this key, the bitmap viewer is started and the picture is displayed.

When downloading via **WAP**, the bitmap viewer opens automatically. Internet addresses see p. 19.

Note

If a received picture has not been copied to the bitmap viewer, it will be overwritten when the next picture is received.

Bitmap viewer menu

Options Open menu.

Save as...	Store the current picture on one of the storage locations.
Send	Send picture via SMS.
Load	Load new picture to the bitmap viewer.
Discard	Delete current picture from the buffer.
Delete	Delete selected picture.

Select bitmap style

Menu → Setup → Device
→ Display → Bitmap style

You can select between two animations which are shown in different situations, for example when entering a PIN. Animations available on the phone are:

Racing

Windsurfing

Own greeting

Menu → Setup → Device
→ Display → Own greeting

The greeting is displayed instead of an animation when you switch on the phone.

Change Switch on/off.



Delete old message and create new message.

OK Confirm changes.

Screensaver

Menu → Setup → Device
→ Display → Screensaver

The screensaver shows a picture on the display once a user-definable time has elapsed. An incoming call and any key press ends the function. You can also receive and save a screensaver via SMS/WAP.

Screensaver menu

Options Open menu.

Enable	Activate screensaver.
Style	Analog clock or Bitmap.
Preview	Display the style set.
Timeout	Set period after which the screensaver starts.
Security	Enter phone code to end screensaver (as security setting).

Melody manager

page is loaded.

You can use the melody manager to manage your additional ring tones and a folder with more of your own ring tones and links.

Start melody manager

Menu → Surf & fun → Melody manager



Select folder, storage location or link:

Own sounds

Individual 1

Individual 2

Individual 3

Individual 4

URL

Different functions are available depending on which entry is highlighted:

Own sounds



Select folder.

Select

Press.



Select ring tone.

Load

Load ring tone to the melody manager.

Play

Play ring tone.

Individual 1 To Individual 4

Load

Load ring tone to the melody manager.

Play

Play ring tone.

Go to a link, surf online

Internet

The selected Internet

Store ring tone

Save ring tone currently loaded in the melody manager on a new storage location e.g. on **Individual 1**:

Options Open menu.

Save as... Select.

Select Confirm.



Select storage location.

Save Store ring tone.

The ring tones stored under **Individual 1** to **Individual 4** can be assigned to different functions/anniversaries if you use the **Ring tones** (p. 48) function.

Send ring tones via SMS

Start melody manager and load required ring tone, then:

Options Open menu.

Send Enter recipient or use Phonebook .

OK Confirm.

Receive ring tone

If a ring tone has been received via **SMS** a note  appears above the left soft key. Press this key to start the melody manager.

The melody manager automatically opens after a melody has been loaded via **WAP**. Internet addresses see p. 19.

Melody manager menu

Options Open menu.

Play	Play the ring tones currently loaded.
Save as...	Store ring tone at Individual 1 to 4 or Own sounds.
Load...	Load ring tone from Individual 1 to 4 or Own sounds.
Discard	Delete loaded ring tone from the buffer.
Delete	Delete ring tone from Individual 1 to 4 or Own sounds.
Send	Send ring tone via SMS.

Ringer tones

For the ranges/functions listed below you can choose from 20 ring tones already stored in the phone and from four own (p. 46) ring tones (Individual 1 to 4).

Menu → Audio → Ringer tones



Select range
(except **Melody manager**):

All calls

 Calls

Group calls

Appointments

Messages

Cell broadcast services

(**Melody manager**)



Choose ring tone.

OK

Confirm.

Note

Special ring tones can be sent to you via SMS (p. 46) or you can load them via WAP (p. 39).

Voice message/Mailbox

49

Most service providers offer you an external answering service. In this mailbox, a caller may leave a voice message for you

- if your phone is switched off or not ready to receive,
- if you do not want to answer,
- if you are making a phone call (and if **Call waiting** is not active p. 22).

If the voice mail service is not part of your service provider's user package, you will need to register and the settings must be made manually. The following description may vary slightly depending on the service provider.

Setup



The service provider supplies you with two phone numbers:

Mailbox number

You call this phone number to listen to the voice mails left for you. To set it up:

Menu → **Messages**
→ **Voice message**

Select phone number from Phonebook or dial it/change it and confirm with **OK**.

Forwarding number

Calls are diverted to this phone number. To set it up:

Menu → **Divert**
→ e.g. **Unanswered** → **Set**

Dial the number of the mailbox.

OK Registration at the network will be confirmed after some seconds.

For further information on call divert see p. 52.

Listen to



A new voice mail can be displayed as follows:



Icon plus beep.

or



a text message announces a new voice mail.

or

you receive a call with an automatic announcement.

Call your mailbox and play the message(s) back.



Hold **down** (if necessary enter mailbox number once only).

Confirm with **OK** or **Mailbox** depending on service provider.

Outside your home network, you may need to dial a different mailbox number and enter a password to access your mailbox.

Some service providers offer information services (info channels). If reception is activated, you receive messages on the active topics in your "Topic list".

Menu → Messages → Cell broadcast

Receive CB



You can activate and deactivate the CB service. If the CB service is activated, the standby time of the phone will be reduced.

Read new CB

All unread CB messages are displayed.

Topic list

Add an unrestricted number of topics to this personal list from the topic index (see **Topic index**). You can pre-set 10 entries with their channel number (ID) and, if necessary, name.

New topic

New topic Select.

- If no topic index is available (**Topic index**) enter a topic with its channel number and confirm with **OK**.
- If the topic index has already been transmitted, select a topic and confirm with **OK**.

Selection from a list

Options Open list menu.

If a topic is selected in the list you can have a look at it, activate it, deactivate it, edit it or delete it.

Auto display

CB messages are displayed in standby mode, longer messages are automatically scrolled. This display can be activated/deactivated for all or only new messages.

To switch to "full page view":

, then press **View CB**.

Topic index



The list of topics is displayed for you to choose from. If none are displayed you must enter the channel numbers (ID) manually (see **Topic list**).

Please contact your service provider for details.

CB languages

Receive Cell Broadcast messages only in a specific language or in all languages.

Displays



Topic activated/deactivated.

New messages received on the topic.

Messages already read.

Duration/charges

51

You can display the charge details and the duration of calls as you speak as well as setting a unit limit for outgoing calls.

Display

Menu → **Records** → **Duration/charges**

After you have made the charge detail settings, you can display the call duration/charges for the various call types or you can display the credit balance.

Select a call type (see setting for **All calls** and **Incoming calls**)

Select Display the data.

When displayed, you can:

Reset Clear display.

OK End display.

Charge settings

Menu → **Records** → **Charge settings**

Conv. 
(PIN 2 query)

Enter the currency in which the charge details are to be shown.

Personal rate 
(PIN 2 query)

Enter the charges per unit/period.

Account limit 
(PIN 2 query)

Special SIM cards allow you or the service provider to define a credit/period after which the phone is blocked for outgoing calls.

Change Enter the number of units and confirm with **OK**.

Then confirm the credit or reset the counter. The display of Prepaid cards may vary depending on the service provider.

All calls 
Activate to display the following call types:

Last call

Any call

Remain. units

Incoming calls 
Activate to display the following call types:

Last call

All outgoing calls

All incom. calls

Remain. units

Auto display
Call duration/charges are automatically displayed for each call.

You can set the conditions for which calls are diverted to your mailbox or other numbers.

Menu → Divert

Set divert:

The most common condition for divert is:

Unanswered



Menu → Divert



Select **Unanswered**.

(covers the **Not reachable**, **No reply**, **Busy** conditions, see right)

Select

Press.

Set



Select.

Enter the phone number to which the caller will be diverted (if not done already)

or



select this phone number from the Phonebook or via **Mailbox**.

OK

After a short pause, the setting is confirmed by the network.

All calls



All calls are diverted.



Symbol in the top line of the display in standby mode.

Spec. divert



Not reachable

Divert if the phone is switched off or out of range.

No reply

A call is only diverted after a delay (depends on the network). The period can be set by the user to a maximum of 30 seconds in 5 second intervals.

Busy

Divert if a call is in progress. If **Call waiting** is activated (p. 75), you will hear the call waiting tone during a call (p. 22).

Receiving fax



Fax calls are diverted to a number with a fax connection.

Receiving data





Data calls are diverted to a phone number with a PC connection.

- Menu** → Divert
→ Select a function.

Status check

You can check the current divert status for all conditions.

After a short pause, the current situation is transmitted by the network and displayed.

-  Condition set.
-  Not set.
-  Display if status is unknown (on a new SIM card for example).

Clear all

All set diversions are cleared.



Note

Note that the divert is stored in the network and not in the phone (when the SIM card is changed for example).

Check condition or delete it

First select the condition.

Select Press.

Check status

Select

or

Delete Select.

Reactivate divert

The last divert has been stored.

Proceed as with Set divert.

The stored phone number is displayed. Confirm the number.

Edit phone number

Proceed as with "Set divert". When the stored number is displayed:

Delete Delete the phone number.

Enter new number and confirm.

Groups

54

If there are many Phonebook entries it is best to assign them to a group (p. 29), e.g.: **VIP, Leisure, Office, Family**

Menu → **Get in touch** → **Groups**
→ Select a function:

SMS to group

A memo (SMS) can be sent as a "circular" to all members of a group.



Select a group.



Select

Press. The group is confirmed and the editor is opened.



Compose message (p. 33).



Press and confirm the displayed group with **OK**.



Press. The first recipient is displayed.



Press. The SMS is sent.

Each send operation must be confirmed. It is possible to skip individual recipients.

Call to group



You can call up to 5 members of a group one by one and link them together in a conference (function may need to be enabled).



Select a group.

Select

Press. The members of the group are listed.



Select the entries you want to call.

Change

Press. Mark entry/unmark entry.

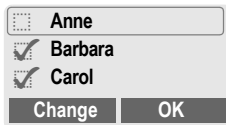

OK

Confirm selection.

The first entry is dialled. When the connection has been established, the call is put on hold.



Proceed with calling the next entry until all marked entries have been called (up to 5, depending on the service provider).

Options

Open the menu e.g. to link the calls on hold in a conference.

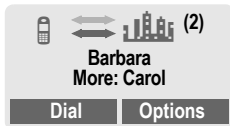

Send DTMF tones (p. 81)

Call transfer (p. 23)

Main menu Direct access to the main menu.

Call status List all held and active calls (e.g. participants in a conference).

Call to group menu**Options**

Open menu.

Dial	Dial current entry.
Skip	Skip next number.
Conference	Link all calls on hold in a conference (p. 23).
Swap	Accept the waiting call and put the current call on hold.
Microphone on	<p>Switch the microphone on or off. If it is switched off, the person on the other end of the line cannot hear you (muting).</p> <p>Alternatively:</p> <p> Hold down.</p> <p>However, numbers being entered are audible when Send DTMF tones is active.</p>
Volume	Adjust handset volume.
Time/charge	While the connection continues, the call duration and (if set, p. 51) the call time/cost are displayed.

Groups

56

Group setup

Menu → Get in touch → Groups



Select a group.

Select Press. The group is displayed for editing.

The following functions are applied to the group or all entries of a group:

Group menu

Options Open menu.

View members	Display all entries assigned to the selected group.
Rename group	Change the current name of the group.
Group symbol	Assign a symbol to a group (p. 29).

Change group assignment

Normally a group is assigned to a Phonebook entry when it is entered (p. 26).

To change the group assignment or to assign a group later, the following steps are necessary:

When the Phonebook is open:



Select entry.

View Press.

Edit Press.



Scroll to group.

Edit Press and select new group.

Save Save assignment.

Note



Phonebook key:

Press once to open Phonebook

Press twice to display groups

Press three times to display 1st group entries

Organiser

57

Menu → Get in touch → Organiser
→ Diary

Diary

Up to 50 appointments can be entered.



If an alarm is missed it appears in the list of missed appointments (p. 60).

New appointment

<New entry>

Select.



Make the entries field by field.

Type:



Memo. A text with up to 20 letters may be added.

Call. Enter phone number. Shown with alarm.



Meeting

Description: A short description can be entered.

Reoccurrence: Period for repeating.

Date: Enter start date.

Time: Enter start time.

Save Store the appointment.

Appointments menu

Options Open menu.

View	Display entry.
Activate/Deactivate	Activate or deactivate appointment.
Edit	Display the entry for changes.
New entry	See left.
Delete	Delete entry.
Delete all	Delete all appointments after confirmation.
Send SMS...	as entry: Send entry to recipient. as text: Send entry as SMS message.
Capacity	Display number of entries.

Note

An alarm sounds even when the phone is switched off (the phone does not switch to the standby mode). To deactivate it press any key.

Deactivate all alarms p. 63

Ringer setting p. 67

Clock p. 61



Display when alarm is activated.

Pause Repeats the alarm after 5 mins.

Menu → Get in touch → Organiser
→ Greetings

Greetings

Your phone will remind you of special events so you do not forget them any more.

New event

<New entry>



Select.

Make the entries field by field.

Type:

Birthday

Anniversary

Special event

Name: Enter name. E.g. copy the name from the Phonebook .

Date: Enter start date.

Time: Enter start time.

Events menu

Options Open menu.

View	Display entry.
Activate/ Deactivate	Activate/deactivate alarm.
Edit	Display the entry for changes.
New entry	Enter a new event.

Delete	Delete entry.
Delete all	Delete all events after confirmation.
Send SMS...	as entry: Send congratulations to recipient. as text: Send congratulations as SMS message.
Capacity	Display number of entries.

Reminder

An alarm will remind you of the event twice:

- 24 hours before the date of the event as entered.
- Directly on the date of the event with the following options:

Options Open the menu.

SMS	Send an SMS with standard (changeable) text.
Call	Dial the number.
Pause	Repeat the alarm after 5 minutes.
Off	Stop the alarm.

If an alarm is missed (e.g. because you are making a phone call) it appears in the list of missed appointments (p. 60) with the same options as described above.

Menu → Get in touch → Organiser
→ Notes

Notes

T9 support (p. 35) makes writing notes such as shopping lists easier for you.

New entry

<New entry>
Select.



Enter the text.

Options Open menu.

Save Store the entry.

Text menu

Options Open menu.

Save	Store the entry.
T9 input (p. 35)	T9 preferred: Activate intelligent text entry or deactivate it. Input language: Select the language in which the note is to be composed.
Line feed	Enter line break.
Clear text	Delete the note.
Send	Send note as text of an SMS message.

Display entry



Select entry.

View Open note.

Notes menu

Options Open the menu.

View	Display the entry.
Edit	Display the entry for changes.
New entry	Enter a new note.
Delete	Delete entry.
Delete all	Delete all notes after confirmation.
Confidential	Protect entry with phone code (p. 17).
Send	Send entry as text of an SMS message.
Capacity	Display number of entries.

Note

Protect confidential data with the phone code (p. 17).

We recommend that you do not store any passwords (PIN, TAN etc.) as notes.

Menu → Get in touch → Organiser
→ Missed alarms

Missed alarms

Events with alarm which you have missed are listed and can be displayed.

Menu → Get in touch → Alarm clock

Alarm clock

Use this function to set a **single** time for the alarm call. The alarm sounds even when the phone is switched off.

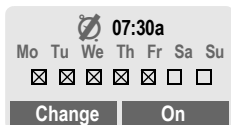

On / Off

Switch the alarm on and off.

Setting

Change

Display the set time and date for the alarm call.

Set the time for the alarm call (hh:mm a/p).



Navigate to the days.

Change

Set the days for the alarm call.

OK

Confirm settings.

Note



Alarm clock switched on.

Alarm clock switched off.

Alarm clock active (display in standby mode).

Menu → Office → Clock

Time zones

Set the time zone for your area.



Select the appropriate time zone from the list.

Options Open menu.**Set** Set the time zone.

Time zone menu

Options Open menu.

View	Display the time zone selected with name and date.
Set	Set the time zone.
Rename	Assign a new name to the time zone.
Auto time-zone	The time zone is switched to local time automatically by the network.
DST	Activate/deactivate daylight savings time.

Time/Date

Menu → Setup → Time/Date

The clock must be set correctly once at start-up.

Change Select soft key.

Enter date, then time.

Format time

Set the time format to either 24-h Mode or 12-h Mode (for example, 18:00 or 6:00 p.m.).

Format date

Set the date format to:
DD.MM.YYYY or MM/DD/YYYY

Auto display

The time display can be switched on and off.

Auto off

The phone may be programmed to turn off at a set time each day.

Activate:

Time

Select soft key.

Enter time.

OK

Confirm.

Deactivate:

Manual

Select soft key.

If the battery is removed for more than 30 seconds, the clock will be reset.

If a profile is used, several settings are made with **one** function.

- Five profiles are standard with default settings, they can be changed however:

Normal envi.

Quiet environ.

Noisy environ.

Car Kit

Headset

- You can set two personal profiles individually (<No Title>).
- The special profile **Aircraft mode** is fixed and cannot be changed (p. 63).

If the phone is used by several people, they can each activate their own settings by selecting their individual profile.

Activate

Menu → Profiles



Select default profile or personal profile.

Activate Activate the profile.

☐ Normal envi.

☒ Quiet environ.

☐ Noisy environ.

Activate

Options

☒ Active profile.

Setup

Edit a default profile or create a new personal profile:



Select profile.

Options Open menu.

Change settings
Select.

The list of available functions is displayed:

Ringer settingpage 67

Volumepage 67

Ringer tonespage 48

Call screening.....page 67

Silent alertpage 67

Key tonespage 67

Information tones.....page 68

Illuminationpage 69

Big letterspage 69

Bitmap style.....page 45

When you have finished setting a function, you return to the profile menu where you can change a further setting.

Profiles Menu

Options Open menu.

Activate	Activate profile.
Change settings	Change profile settings.
Copy from	Copy settings from another profile.
Rename	Rename personal profile.

Menu → Profiles
→ Select a function:

Car Kit

If an original Siemens Car Kit is used (p. 95) the profile is activated automatically as soon as the phone is inserted into the cradle (p. 78).

Headset

If an original Siemens headset is used (p. 95), the profile is activated automatically as soon as the headset is plugged in (p. 79).

Aircraft mode

All alarms (appointments, alarm clock) are deactivated. It is **not possible** to modify this profile.

- The phone must be switched off when you select a profile.
- In this status, alarms are **not** indicated by the ringer or silent alert.

Activate

Menu Profiles



Scroll to **Aircraft mode**.

Activate Activate the profile.

A security prompt must be confirmed.

The phone switches itself off automatically.

Normal operation

The next time you switch on the phone and return to normal operation the default profile **Normal envi.** will be activated.

Menu → My menu

Create your own menu with frequently used functions, phone numbers or WAP pages.

The list of the 10 entries available is preset. However you can change it according to your wishes.

Note

For fast access from standby mode:



Press, then ...



... press twice **on the left**.

Activate

Select the required entry.

Select

Press.

or

Options

Press.

Activate

Select.

Select

Press.

or



If the selected entry is a phone number, you can also call it with the Call key.

Change settings

You can replace each preset entry (1-10) with another entry from the selection list of **My menu**.



Select the required entry.

Options

Press.

Change settings

Select.

Set

Press.



Select the **new** entry in the selection list.

Set

Press.

If you have selected a phone number or a WAP favourite as a new entry, the relevant application opens to choose from.

Reset all

After confirmation and after entering the phone code, the default entries are set.

The left soft key and the keys 2 to 9 (speed dialling numbers) can each be assigned an important phone number or a function. The phone number can then be dialled or the function can be started at the touch of a button.

Notes

A function may already have been programmed on the left soft key by your service provider (e.g. access to "SIM Services"). It may not be possible to modify this key assignment.

The soft key may sometimes be replaced automatically by  or  to access a new message for example.

Available key assignments :

Internet (WAP)	p. 39
Games & more	p. 42
Phone number	p. 26
Alarm clock	p. 60
New SMS	p. 33
Illumination	p. 69
Hide ID	p. 75
Missed calls	p. 25
Calls received	p. 25
Inbox (SMS)	p. 32
Outbox (SMS)	p. 32
My menu	p. 64
Call screening	p. 67

Left soft key

A function/phone number may be assigned to the **left** soft key for fast access.

Change

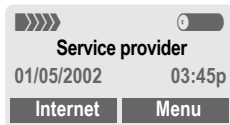

Internet. Press **briefly**.

Change Pick out the application from the list.

- Assign the new function (e.g. **New SMS**) to the soft key.
- Special case **Phone number**. Pick out a name from the Phone-book (e.g. "Carol") to assign to the soft key.

Select Confirm setting.

Apply

The setting "Carol" is used here only as an example.

Carol Hold **down**.

Speed dialling keys

Number keys 2 to 9 can be used as speed dialling numbers for fast access. For available key assignments see p. 65. Number key 1 is reserved for the mailbox number (p. 49).

Edit

In standby mode:



Press number key (2-9).
If the key is not assigned:

Set

Press.

or

New SMS

Press **briefly** (if "New SMS" is assigned, for example).

Change

Scroll to application in the list.

Special case **phone number**.
Pick out a name from the Phonebook for assignment to the key.

Special case **bookmark**.
Scroll to a URL in the bookmark list for assignment to the key.

Select

Confirm setting.

Apply

Select a stored phone number or start a stored application (e.g. **New SMS**).

In standby mode:

2 abc Press.

The assignment of the number key 2 is displayed instead of the left soft key e.g.:

New SMS Hold **down**.

or simply

2 abc hold **down**.

You can set the tones that sound in specific situations to suit your particular tastes.

Menu → **Audio**
→ Select a function:

Ringer setting

Activate/deactivate the ringer or reduce it to a short beep.



Hold down in standby mode (p. 84).

Note



Display: Beep.



Display: Ringer off.

Volume

You can set the volume for each area.



Select the type:

All calls

Calls

Group calls

Appointments

Messages

Cell broadcast services



Set volume.

OK

Confirm.

Note



Displays rising volume.

If two independent phone numbers are registered for your phone you can set different volumes for them (p. 72).

Call screening



Only calls from numbers that are in the Phonebook or in a predefined group are signalled audibly or by silent alert. Other calls are merely displayed.

If you do not accept these calls, they are diverted to your mailbox (if set, p. 49).

Note



Displayed when filter is activated.

Silent alert

To avoid being disturbed by the ringer, you can activate the silent alert of the phone instead. The silent alert can also be activated in addition to the ringer (e.g. in noisy environments). This function is deactivated when the battery is being charged.

Key tones

You can set the acoustic key tone:

Click or Tone or Silent

- Menu** → Audio
→ Select a function:

Minute beep

During the call, you hear a beep after every minute as a reminder of the time elapsed.

Information tones

Set service and alarm tones:

Select On/Off.

Change If activated, service tones are reproduced for an extended range of functions.

Melody manager

(p. 46)

Ringer tones

(p. 48)

Device

Menu → Setup → Device
→ Select a function.

Language

Set the language of the display text. When "automatic" is set, the language of your service provider is used. If a language that you do not understand happens to be set, the phone can be reset to the language of your service provider with the following input:

*#0000# 

Display

Own greeting
(p. 45)

Bitmap viewer
(p. 44)

Screensaver
(p. 45)

Illumination

Can be switched on and off (switching it off increases the standby time).

Big letters

You can choose between two font sizes for the display.

Contrast

You can set the display contrast.

Bitmap style
(p. 45)

Keys

Any key to answer

You can press any key to accept an incoming call (except .

Auto key lock

If **Auto key lock** is activated, the keypad is locked automatically if no key has been pressed for one minute in standby mode. This prevents the phone from being used accidentally. However, you can still be called and you can still make an emergency call.

The keypad can also be directly locked and unlocked as follows:

 Hold **down**.

Key tones

You can set the type of acoustic key tone:

Click or Tone or Silent

Menu → Setup → Device
→ Select a function.

Status

Fact. settings

The phone is reset to the default values (factory setting) (does not apply to SIM card and network settings):

*#9999# 

Phone identity

The phone ID (IMEI) is displayed. This information may be useful for customer service.

Fast search

When this function is active, network connection is speeded up (standby time is reduced).

T9 input

T9 preferred

Activate intelligent text entry or deactivate it.

Input language

Select language in which the message is to be composed.

Languages with T9 support are marked by the T9 symbol.

Menu → Setup → Device
→ Select a function.

Battery care

(only if a NiMH battery is used)

This function allows the NiMH battery to be regenerated when the operating time drops (eliminating the memory effect).

Connect the phone as for charging (p. 15) and then call up this function.

The battery is now fully discharged and recharged. Depending on the state of the battery, this can take up to 5 hours.

Note

No phone calls can be made during this process. The clock setting is retained.

Security

The phone and SIM card are protected against misuse by several security codes.

Menu → Setup → Security
→ Select a function:

Codes

PIN control, Change PIN, Change PIN2, Change phonecode, see p. 17.

Babysitter

(Phone code protected)

Only **one** number can be dialled. Hold **down** the right soft key on the the outside **right** (p. 24).

Allow only



(PIN 2/phone code protected)

Dialling is restricted to the numbers in the Phonebook, new entries are not possible. If only area codes are entered, the relevant phone numbers can be added to these manually before dialling.

Depending on whether the Phonebook is stored on the SIM card or in the phone, the PIN 2 or phone code are requested before changes can be made.

Menu → Setup → Security
→ Select a function:

Only



(PIN 2 protected)

The dialling options are restricted to SIM protected numbers in the Phonebook. If only area codes are entered, the relevant phone numbers can be added to these manually before dialling.

Last 10 only



(Phone code protected)

Calls are limited to the call list (p. 25) of "dialled numbers". This list can be filled with phone numbers specifically for this purpose:

First delete the call list, then create "new entries" by dialling phone numbers and cancelling before the connection is established.

This SIM only



(Phone code protected)

Your phone is prevented from being used with a **different** SIM card.

Network

Menu → Setup → Network
→ Select a function:

Line



This function is only displayed if it is supported by the service provider.

Two independent phone numbers must be registered on the phone.

Select

Select the currently used phone number.

1 → Display the active phone number.

Block line

(Phone code protected)

You may limit usage to one phone number.

Configuration

Network info

The list of GSM networks currently available is displayed.



Indicates forbidden service providers (depending on SIM card).

Menu → Setup → Network
→ Configuration
→ Select a function:

Choose network

The network search is restarted. This is useful if you are **not** on your home network or want to register on a **different** network. The network info list is rebuilt when **Auto network** is set.

Auto network

Activate or deactivate, see also "**Choose network**" above.

If "Automatic network" is activated, the next network is dialled in the order of your "preferred service providers". Otherwise a different network can be selected manually from the list of available GSM networks.

Net operator

A list of all known GSM networks worldwide is displayed with the current codes.

Menu → Setup → Network
 → Configuration
 → Select a function:

Pref. network

The service providers you prefer after your home network are displayed here (e.g. if there are several networks that differ in price).

Note

If the signal strength of your preferred network is not strong enough when you switch the phone on, the phone may log on to another network. This can change when the telephone is next switched on or if you manually select another network (p. 72).

Your service provider is displayed:

List Display list of preferred networks.

Create new entry:

- Select empty line, press **Entry**, then select another entry from the list of service providers and confirm.

Change/delete entry:

- Select entry, press **Change**, then select another entry from the list of service providers and confirm it or press **Delete**.

Menu → Setup → Network
 → Barrings
 → Select a function:

Barrings



Barring restricts the use of your SIM card (not supported by all service providers). You need a 4 digit password that your service provider will give you. You may need to be registered separately for each barring.

Outgo. access

All outgoing calls (except 911 and 112 emergency numbers) are barred.

Outgo internet

Only national calls can be made.

Out.int.x home

International calls are not permitted. However you can make calls to your home country when abroad.

All incoming

The phone is barred for all incoming calls (the forwarding of all calls to the mailbox offers a similar effect).

When roaming

You do not receive calls when you are outside your home network. This means that no charges are incurred for incoming calls.

- Menu** → Setup → Network
 → Barrings
 → Select a function:

Status check

The following information can be displayed after a status check:

- ☒ Barring set.
- ☐ Barring not set.
- ? Status unknown (e.g. new SIM card).

Clear all

All barrings are cleared. A password which the service provider will give you is needed for this function.

User group



- Menu** → Setup
 → User group
 → Select a function:

If offered by the service provider, this service enables groups to be formed. These have access for example to internal (company) information or special tariffs apply to them. Check with your service provider for details.

User group

Activate or deactivate the function. "User group" must be deactivated for normal phone use (phone code, p. 17).

Select group

You may select or add groups other than the preferred groups (see below). The service provider supplies you with code numbers for the groups.

All outgoing

In addition to network control for a user group, it is possible to set whether outgoing calls outside the group are permitted. If the function is deactivated, only calls within the group are permitted.

Preferred grp

If activated, only calls within this standard user group can be made (depending on the network configuration).

During a call

Menu → Setup → During a call
→ Select a function:

Call waiting



If you are registered for this service, you can check whether it is set and you can activate/deactivate it (p. 22).

Hide ID



When you make a call, your phone number may be displayed on the recipient's display (depending on the service providers).

To suppress this display, you may activate the "Hide ID" mode for the next call or for all subsequent calls. You may need to register separately with your service provider for these functions.

Clock

(p. 61)

Connectivity

Menu → Setup
→ Connectivity
→ Select a function:

GPRS



(General Packet Radio Service)

GPRS is a new method for transmitting data in the mobile network faster. If you use GPRS, you can be connected to the Internet permanently if the network capacities suffice.

Some service providers do not yet support this service.

Edit

Activate or deactivate GPRS function.

Shown in the display:



GPRS activated.



GPRS available.

GPRS info

Display of information on the connectivity status.



Fast access in standby mode.

- Menu**
- Setup
 - Connectivity
 - Select a function:

WAP profile settings

You can set or change up to 5 WAP profiles (may be barred by the service provider). The entries may vary depending on your service provider. To set a new profile:



Select a profile.

- Options** Open menu.

Change settings

Select and confirm.



Select profile range and make your settings/entries field by field.

- Edit** The entry card is displayed.

If necessary, check with your service provider for details:

WAP parameters



IP address: * Enter IP address.

Port: * Enter port number.

Homepage: Enter homepage (p. 39), if not set by the service provider.

Linger time: Enter time in seconds after which a connection should be terminated if no input or data exchange takes place.

*) depends on your service provider, if necessary enter 2nd IP address and 2nd port

CSD settings (Circuit Switched Data)

Dial-up no.: Enter ISP number.

Call type: Select ISDN or Analogue.

Login name: Enter login name.

Password: Enter password (shown as a series of asterisks).

GPRS settings (General Packet Radio Service)

activated/deactivated: Activate/deactivate

APN: Enter the address of your service provider.

Login name: Enter login name.

Password: Enter password (shown as a series of asterisks)

Save

The settings are stored and the profile list is shown.

Activate the set WAP profile (p. 41).

Note

As an alternative method to set/change a new profile, you can use the browser menu:



Call up the menu.

More ... Select.

WAP Profiles

Select.

- Menu** → Setup
 → Connectivity
 → Select a function:

Set Java™ profiles

Up to 5 profiles can be defined. The settings have normally been carried out by the service provider in advance. To set a new profile:



Select profile.

- Options** Open menu.

Change settings

Select and confirm.



Select profile range and make you settings/entries field by field.

- Edit** The entry card is displayed.

If necessary, check with your service provider for details:

CSD settings (Circuit Switched Data)
Dial-up no.: Enter ISP number.
Call type: Select ISDN or Analogue.
Login name: Enter login name.
Password: Enter password (shown as a series of asterisks).
Linger time: Enter time in seconds after which a connection should be terminated if no input or data transfer takes place.

GPRS settings (General Packet Radio Service)

APN: Enter the address of your service provider.

Login name: Enter login name.

Password: Enter password (shown as a series of asterisks).

DNS1/DNS 2: (optional)

Save

The settings are stored and the profile list is shown.

Activate set Java™ profile (p. 44).

Note

As an alternative method to set/change a new profile you can use Surf & fun:

- Menu** → Surf & fun → Games & more
 → Java Profiles

Options Select.

Java Profiles Select.

- Menu** → Setup
 → Connectivity
 → Select a function:

Fax/data mod.

(p. 80).

Authentication

- Change** Activate encrypted WAP dial-up (CHAP Challenge Authentication Procedure) or deactivate (PAP Personal Authentication Procedure).

Accessories

- Menu** → Setup → Accessories
 → Select a function:

Car Kit

If an original Siemens Car Kit is used (p. 95) the profile is activated automatically as soon as the phone is inserted into the cradle.

User-defineable settings

Auto answer

(factory default: off)

Calls are accepted automatically after a few seconds. Eavesdropping is possible!



Indication on the display.



Switch between the phone and Car Kit Portable during a call.

Auto off

(factory default: 2 hours)

The phone is powered by the car's power supply. The time between switching off the ignition and deactivation of the phone can be adjusted.

Automatic settings:

- Permanent illumination: switched on.
- Auto key lock: switched off.
- Charge the phone battery.
- Automatically activate Car Kit, when the phone is inserted (p. 63).

Menu → Setup → Accessories
→ Select a function:

Headset

If an original Siemens Headset is used (p. 95) the profile is activated automatically as soon as the headset is plugged in.

User-defineable settings**Auto answer**

(factory default: off)

Calls are accepted automatically after a few seconds (except where the ringer is switched off or set to beep). You should therefore be wearing the headset.

Eavesdropping is possible!

Automatic setting

Accept call with the Call key or PTT key (Push To Talk) when the key lock is activated.

Auto answer

If you fail to notice an incoming call there is a risk that it may be overheard by others.

Menu → Setup → Connectivity
→ Fax/data mod.

With the phone and a connected PC, you can transmit and receive faxes and data. Appropriate software for data communication/fax communication must be available on your PC and there must be a connection to the phone.

Fax and data services must be enabled by the service provider. Different networks support different types of fax/data reception, please contact your service provider for details.

Change Set the required mode.

Fax/data mod.



Your service provider has given you a number for telephoning and a fax/data number.

Send

Start your PC communication program and enter the required destination phone number in the program.

Receiving

The call is signalled by a special ring-er and the type of call (fax or data) is displayed.

Now start the communication program in your PC to receive the fax/data.

Send vce/fax



Set this function on the phone **before** transmission so that you can switch from voice mode to fax mode.

While the connection is being set up, the following soft key is available for two seconds:

Voice/fx Switch to **Send vce/fax** mode; you may now send a fax.

Voice/fax rec

(**Only** if a special fax or data number is not available).

Start the required communication program in your PC and switch on the function at the phone **during** the call (the PC accepts the connection).

End transmission

End transmission with PC software and/or press .

Control codes (DTMF)

Send DTMF tones

You can enter control codes (digits) during a call so that an answering machine can be controlled remotely. These digits are directly transmitted as DTMF tones (control codes). Also allows for credit card number entry and calling card number entry.

 **menu** Open call menu.

Send DTMF Select.

Use the Phonebook

Store phone numbers **and** control codes (DTMF tones) in the Phonebook like a normal entry.



Enter phone number.



Press until a "+" appears on the display (pause for connection setup).



Enter DTMF signals (digits).



If necessary, enter further pauses of three seconds each to ensure correct processing at the destination.



Enter a name.

Save

Press.

You can also store the DTMF tones (digits) without a phone number and send them during a call.

Divert set

Divert

Diverts the caller to the mailbox, for example, if **Busy** (p. 52) is set and the **Call waiting** function (p. 22) is activated.

Emergency calls (SOS)

Your wireless phone can be used to make emergency calls. You can make an emergency call from the main display screen. Enter the local emergency number such as 911 and then press the  key.

This phone, like any wireless phone, operates using radio signals, wireless and landline networks, and user-programmed functions. Because of this, connections in all conditions cannot be guaranteed. Therefore, you should never rely solely on any wireless phone for essential communications (for example, medical emergencies). Remember - to make or receive any calls, the phone must be switched on and be used in a service area that has adequate signal strength. Emergency calls might not be possible on all wireless phone networks or when certain network services or phone features are in use. Check with local service providers regarding their network features.

Always make certain that your phone is properly charged before attempting any emergency calls. If you allow your battery to discharge, you will be unable to receive or make

calls, including emergency calls. You must then wait a few minutes after the charging begins to place any emergency calls.

When making an emergency call, remember to give all of the necessary information as accurately as possible. Remember that your wireless phone might be the only means of communication at the scene of an accident, therefore you should not terminate the call until given permission to do so.

International dialling codes

Many international dialling codes are stored in your phone.

In standby mode () not necessary when dialling from the Phonebook):

 Hold **down** until a "+" is displayed. This replaces the first two digits of the international dialling code.

+List Press.

Select the required country. The international dialling code is displayed. Now add the national number (in many countries without the first digit) and press the Call key.

Java™

Java™ represents the best method to use numerous games and applications on your mobile phone. You can download these applications from the Internet and install them on your

mobile phone. The application can be started after installation. Please refer to the operating instructions for each application.

JAD and JAR

Three file types occur when using Java™:

The JAD file (Java Descriptor)

These files contain information on the application (JAR file) and its address for download. When a JAD file is activated, the connection to the Internet is established and the executable application is loaded.

The JAR file (Java archive)

These files include the executable applications. When a JAR file is activated, the application is started.

Combined files

These files result from JAR files being loaded via JAD files. In this case the JAD file is added to the JAR file. The display icon is the same as for JAR files.

The following icons appear when using Java™:



JAD file



JAR file

Message store full

The SIM memory is full when the message symbol flashes. **No** more SMS messages can be received. Delete or save messages (p. 32).

Own numbers

You can enter your "own numbers" in the Phonebook (e.g. fax) for information. These numbers can be changed or deleted and also be sent as SMS.

Phone number memo

You can enter a number with the keypad during a call. It can be stored or dialled after the current call has ended.

Phone number/URL in SMS

Numbers **highlighted** in the message can be dialled or they can be stored in the Phonebook (p. 26). URLs (Internet addresses) can be accessed directly.

Quick menu selection

All menu functions are numbered internally. The current numerical order is shown in the upper right-hand corner of the display.

By entering these numbers one after the other the function may be started at once.

For example, to compose a new SMS:

Menu

Press.



for **Messages**



for **New SMS**

If your service provider offers additional functions (SIM services) in the menu system, the numerical order may change.

Signal strength



Strong signal.



A weak signal reduces the call quality and may lead to loss of the connection. Change your location.

SIM card problems

You have inserted your SIM card, but the following message appears:

Please insert SIM card

Please ensure that the card is **correctly** inserted and the contacts are clean; if necessary, clean them with a dry cloth. If the card is damaged, please contact your service provider.

See also "Questions&Answers" (p. 89).

SMS Push

This function allows you to call up an Internet address (URL) directly from an SMS. After selecting it, the URL is highlighted. By pressing the Call key, the WAP browser is automatically started and the highlighted Internet address is called up.

SMS status report

If the phone was unable to send the message to the service centre a retry option is available. If this attempt also fails, contact your service provider.

The **Message sent!** text only indicates that the message has been transmitted to the service centre which now tries to deliver the message within a certain period.

See also "Validity" (p. 38).

Special characters

Press key repeatedly until the character is displayed:

	Blank	1	€	£	\$	¥	¤		
	.	,	?	!	0	+	-	:	;
	i	"	'	;	_				
	*	/	()	<	=	>	%	~
	#	@	\	&	\$	Γ	Δ	Θ	Λ
	≡	Π	Σ	Φ	Ψ	Ω			

To write special characters after numbers (e.g. 5 £), switch to the letter mode first:

Press.

Switch off ringer

Switch off the ringer only for the **current** call/alarm (not if "Any key answer", p. 69, is active):

Hold **down**.

The call is still displayed. When you accept or reject the call or the next time you switch the phone off or on, this function is ended.

WAP

(Wireless Application Protocol)

A technical standard that is the basis of the connection between mobile radio networks and the Internet.

WAP enables mobile surfing using the mobile phone in the Internet, downloading of games and applications and the use of WAP services such as news, stock exchanges or information.

WAP usage

Start with...

You can set which functions are to be displayed after Internet access:



Open the browser menu.

More ... Select.

Start with...

Select, then select from the list:

Start menu (p. 39)

Browser menu (p. 40)

Homepage (p. 40)

Resume (p. 39)

Bookmarks (p. 40)

Enter the Internet address (URL)

A WAP page must be shown on the display (online or offline). Then:



Open the browser menu.

Go to URL Select.



Enter URL and confirm.
The connection is established.

Special characters for WAP usage:



Press 3 times for /



Press 3 times for @



Press for . (full stop)



Press repeatedly for :



Press repeatedly for ~

Bookmarks (URL)

You can store a list of your favourite Internet addresses (URLs) in the phone (offline and online available, depending on the service provider):

Save:

Open the browser menu.

Bookmarks Select.**Online (save):****Add bookmark**

The current WAP address is added as a bookmark.

Offline (save):**(Empty)**

Select.

Menu

Open menu.

Change

Select, enter name/head-er and URL and confirm.

Save

Press.

Apply:

Open the browser menu.

Bookmarks Select.

Select entry.

Go

The selected call is set up.

Fast access:

To open the bookmark list when the browser has been started:



Press.

Changing the home page

The address of the home page is set in the (access) profile (p. 76).

You can change it in standby mode (if permitted by the service provider!):

Menu → Surf & fun → Internet
→ Profiles

Select the profile, for example:

e-Commerce

Select.

Change

The entry card is displayed.

Select **WAP parameters/Homepage**.



Enter new address. Go to the end of the entry card.

Save

Press.

Without SIM card

If you switch on the phone **without** SIM card, you can use some functions of the phone.

Menu

Press soft key. The functions are displayed.

SOS

Emergency number, SOS.

Display symbols (selection)

87

Displays



Signal strength.



Charging completed.



Battery indicator.



All calls are diverted.



Ringer off.



Short ringer (beep) only.



Ringer only, if caller is stored in the Phonebook.



Alarm is set.

Alarm clock active.



Key lock active.

Phone numbers/names:



On the SIM card

On the SIM card
(PIN 2 protected).

In the phone memory.



No network access.



Function active.



Phonebook.

ABC/
abc/AbcIndicates whether upper or lower-
case letters are active.

T9

Text input **with** T9.

GPRS activated.



GPRS available.



WAP Online.



WAP via GPRS Online.



WAP No network.



Headset mode.



Loudspeaker Car Kit.



Additional handset mode.



Car Kit active.



Auto answer feature on.

Diary icons



Memo.



Meeting.



Call.

Soft keys



Message received.



Voice mail received.



Unanswered call.



Receiving a picture.



Receiving a melody/ring tone.



SIM memory full.



Store in Phonebook.



Retrieve from Phonebook.



SIM services.



Switch Car Kit Portable.





T9 word selection.

Troubleshooting

89

If you have any questions about using your phone, visit us at **www.icm.siemens.com** anytime.
In addition we have listed some frequently asked questions and answers below.

Question	Possible causes	Possible solution
Phone cannot be switched on.	On/Off key not pressed long enough.	 Press On/Off key for at least two seconds.
	Flat battery.	Charge battery. Check charging indicator in the display.
	Battery contacts dirty.	Clean contacts.
	See also below under: "Charging error"	
Standby time is too short.	Frequent use of the organiser and games.	Restrict use if necessary.
	Speed search active.	Deactivate speed search (p. 70).
	Display illumination on.	Switch off display illumination (p. 69).
	Unintentional keystrokes (illumination!).	Activate key lock (p. 69).
	Memory effect (only NiMH battery).	Run battery care function (p. 70).
Charging error (charge icon not displayed).	Battery totally discharged.	1) Plug in charger cable. 2) Wait up to 2 hours until the charge icon is displayed. 3) Charge battery as usual.
	Temperature out of range: 41 °F to 104 °F.	Make sure the ambient temperature is right, wait a while, then recharge.
	Contact problem.	Check power supply and connection to the phone. Check battery contacts and device interface, clean them if necessary, then insert battery again.
	No mains voltage.	Use different mains power socket, check mains voltage.
	Wrong charger.	Only use original Siemens accessories.
	Battery faulty.	Replace battery.
SIM error.	SIM card not correctly inserted.	Make sure that the SIM card is correctly inserted (p. 14).
	SIM card contacts dirty.	Clean the SIM card with a dry cloth.
	SIM card with wrong voltage.	Use 3 V SIM cards only.
	SIM card damaged (e.g. broken).	Inspect the damage. Return the SIM card to service provider.

Question	Causes available	Possible solution
No connection to network.	Signal weak.	Move higher, to a window or open space.
	Outside GSM range.	Check service provider coverage map.
	SIM card not valid.	Reclaim at the service provider.
	New network not authorised.	Try manual selection or select a different network (p. 72).
	Network barring is set.	Check barrings (p. 73).
	Network overloaded.	Try again later.
Phone loses network.	Signal too weak.	Reconnection to another service provider is automatic (p. 72). Switching the phone off and on may speed this up.
Calls not possible.	2nd line set.	Set line 1  » (p. 72).
	New SIM card inserted.	Check for new restrictions.
	Charge limit reached.	Reset limit with PIN 2 (p. 51).
	Credit used up.	Load credit.
Certain uses of the phone not possible.	Call restrictions are set.	Barrings may be set by your service provider. Check barrings (p. 73).
No entries possible in Phonebook.	Phonebook is full.	Delete entries in Phonebook (p. 27).
Voice mail does not work.	Call divert to the mailbox not set.	Set call divert to the mailbox (p. 52).
SMS (text message)  flashes.	SMS memory full.	Delete (p. 32) or store messages (SMS) in the archive (p. 32) to make room.
Function cannot be set.	Not supported by service provider or registration required.	Contact your service provider.
Memory problems with Games & More, ring tones, pictures, SMS archive.	Phone memory full.	Delete files where necessary.

Troubleshooting

91

Question	Possible causes	Possible solution
Message cannot be sent.	Some service providers do not support this service. Phone number of the service centre is not set or is wrong. SIM card contract does not support this service. Service centre overloaded. Addressee does not have a compatible phone.	Check with your service provider. Set service centre (p. 37). Contact your service provider. Repeat message. Check.
EMS pictures & sounds are not displayed at the addressee.	The addressee's phone does not support the EMS standard.	
No Internet access possible.	Wrong WAP profile set or settings wrong, incomplete.	Check settings, if necessary consult your service provider.
PIN error/PIN2 error.	Three wrong entries.	Enter the PUK (MASTER PIN) provided with the SIM card according to the instructions. If the PUK (MASTER PIN) has been lost, contact your service provider.
Phone code error.	Three wrong entries.	Contact Siemens Service (p. 92).
Service provider code error.	No authorisation for this service.	Contact your service provider.
Too few/too many menu entries.	Functions may have been added or removed by your service provider via the SIM card.	Check with your service provider.
No fax possible.	Incorrect settings in the PC. No authorisation for this service.	Check settings (p. 80). Contact your service provider.
Charge counter does not work.	Charge pulse not transmitted.	Contact your service provider.
Damage		
Severe shock.	Remove battery and SIM and insert them again. Do not dismantle phone!	
Phone became wet.	Remove battery and SIM card. Dry immediately with cloth, do not heat. Dry connector contacts thoroughly. Stand unit upright in an air current. Do not dismantle phone!	

Reset settings to the factory default (p. 70): * # 9 9 9 9 # 

Siemens Service

92

Simple, straightforward support for technical and operational queries is available from our online support service on the Internet: **www.icm.siemens.com**
or in the "Questions&Answers" section, p. 89, of this user guide.

If repair work is necessary please contact one of our service centres:

Abu Dhabi	0 26 42 38 00	Luxembourg.....	43 84 33 99
Argentina	0 80 08 88 98 78	Macedonia.....	02 13 14 84
Australia	18 00 62 24 14	Malaysia	0 21 63 11 18
Austria.....	05 17 07 50 04	Malta	00 35 32 14 94 06 32
Bahrain.....	40 42 34	Mauritius	2 11 62 13
Bangladesh	0 17 52 74 47	Morocco.....	22 66 92 32
Belgium	0 78 15 22 21	Netherlands.....	0 90 03 33 31 00
Brunei.....	02 43 08 01	Norway	22 70 84 00
Bulgaria.....	02 73 94 88	Oman	79 10 12
Cambodia.....	12 80 05 00	Pakistan	02 15 66 22 00
Canada.....	1 88 87 77 02 11	Philippines.....	0 27 57 11 18
China.....	0 21 50 31 81 49	Poland	08 01 30 00 30
Croatia.....	0 16 10 53 81	Portugal	8 00 85 32 04
Czech Republic	02 33 03 27 27	Qatar.....	04 32 20 10
Denmark.....	35 25 86 00	Romania.....	0 12 04 60 00
Dubai.....	0 43 96 64 33	Russia	09 57 37 29 52
Egypt.....	0 23 33 41 11	Saudi Arabia	0 22 26 00 43
Estonia	6 30 47 35	Sharjah	0 65 33 66 42
Finland.....	09 22 94 37 00	Singapore	62 27 11 18
France	01 56 38 42 00	Slovak Republic	02 59 68 22 66
Germany *	0 18 05 33 32 26	Slovenia	0 14 74 63 36
Greece.....	01 06 86 43 89	South Africa.....	08 60 10 11 57
Hong Kong	28 61 11 18	Spain.....	9 02 11 50 61
Hungary.....	06 14 71 24 44	Sweden.....	0 87 50 99 11
Iceland.....	5 11 30 00	Switzerland	0 12 12 00 90
India	01 13 73 85 89 - 98	Taiwan	02 25 18 65 04
Indonesia	0 21 46 82 60 81	Thailand	0 22 68 11 18
Ireland	18 50 77 72 77	Tunisia	0 71 86 19 02
Italy	02 66 76 44 00	Turkey	0 21 65 71 89 89
Ivory Coast	80 00 03 33	United Arab Emirates	0 43 31 95 78
Jordan.....	0 64 39 86 42	United Kingdom	0 87 05 33 44 11
Kenya.....	72 37 17	USA.....	1 88 87 77 02 11
Kuwait.....	2 45 41 78	Vietnam	45 63 22 44
Latvia.....	7 50 11 14	Zimbabwe.....	04 36 94 24
Lebanon	01 44 30 43		
Libya.....	02 13 50 28 82		
Lithuania	2 39 77 79		

Note

When calling customer service, please have your receipt and the phone identity number (IMEI, p. 70) ready.

*0.12 Euro/Minute

Exposure to radiofrequency signals

Your wireless handheld portable telephone is a low power radio transmitter and receiver. When it is ON, it receives and also sends out radiofrequency (RF) signals.

In August 1996, The Federal Communications Commission (FCC) adopted RF exposure guidelines with safety levels for hand-held wireless phones. Those guidelines are consistent with the safety standards previously set by both U.S. and international standards bodies:

- American National Standards Institute (ANSI) C95.1 (1992)
- National Council of Radiation Protection and Measurement (NCRP) Report 86 (1986)
- International Commission of Non-Ionizing Radiation Protection (IC-NIRP) 1996
- Ministry of Health (Canada) Safety Code 6

Those standards were based on comprehensive and periodic evaluations of the relevant scientific literature. For example, over 120 scientists, engineers, and physicians from universities, government health agencies, and industry reviewed the available body of research to develop the ANSI standard (C95.1).

The design of your phone complies with the FCC guidelines (and those standards). For additional information concerning exposure to radio frequency signal, see the statement by the FDA at the end of this user guide.

Technical data

GSM class:	1 (30 dBm)
Frequency range:	1.850 - 1.990 MHz
Weight:	97 g / 3.63 oz.
Dimensions:	109x46x23 mm (82 ccm)
NiMH battery:	550 mAh
Operating temperature:	14 °F to 131 °F
SIM card:	3.0 V
Standby Time:	up to 200 hours
Talk Time:	up to 3 hours

Maintenance tips

- The SIM card should be treated with the same care as a cheque guarantee card. Do not bend or scratch it or expose it to static electricity.
- Clean the card with a damp cloth or an anti-static wipe without chemical cleaning agents.
- Protect the phone from moisture and shocks. Do not expose your phone to direct sunlight.
- Remove the battery if you are not going to use the phone for extended periods of time (more than one month).
- Battery care (p. 70).

Phone ID

You will need the following details if you lose your phone or SIM card.

Please enter here

the number of the SIM card (on the card):

.....

15-digit serial number of the phone
(under the battery):

.....

Customer Service number of the service
provider:

.....

Lost phone

If you lose your phone or SIM card contact your service provider immediately to prevent misuse.

Use only original Siemens accessories to avoid possible damage and to comply with the existing regulations.

Basics

NiMH Battery (550mAh)

Travel Charger

Desk Top Charger

Enables simultaneous charging of the phone battery and a spare battery.

Headset PTT

Car Charger

Mobile Holder

Belt Clip

Leather Case

CLIPit™ Covers

Siemens Original exchangeable top and bottom covers can be obtained in specialist shops.

Data/Applications

Data Cable

Car Solutions

Car Charger / Headset Adapter

Car Kit Portable

Handsfree kit with integrated loudspeaker and microphone and auto answer feature. Simply plug into the cigarette lighter socket. Ideal for mobility between vehicles.

Innovations

MP3 player USB

Stereo headset for handsfree talking and superior sound quality when playing MP3 audio files. The 32MB Multimedia Card saves 30 minutes of music in premium quality. The package includes the software for downloading and USB connecting cables.

Visit our online shop under:



Original Siemens Accessories

www.icm.siemens.com

LIMITED WARRANTY

97

This limited, non-transferable warranty is provided to the original buyer/end-consumer ("Customer") for handsets and accessories ("Product") sold by Siemens Information and Communication Mobile LLC ("Siemens").

WARRANTY PERIOD

The Product warranty period provided by Siemens is one (1) year from the original date of purchase.

WARRANTY COVERAGE

If the Product is defective in materials or workmanship during the warranty period and is returned at Customer's expense at the original place of purchase, the Product will be repaired or replaced, at Siemens' option, at no charge. Customer will be required to show valid "proof-of-purchase" (proof of date of sale, lease, or rental). Reconditioned replacement components, parts or materials may be used in the replacement or repair. Data in the memory of the phone or SIM Card may be lost during repair.

THIS LIMITED WARRANTY DOES NOT COVER AND IS VOID WITH RESPECT TO THE FOLLOWING:

- Cosmetic damage.
- Products which have been repaired, maintained or modified (including the antenna) by anyone other than Siemens or a Siemens-approved repair facility, or that have been improperly installed.
- Cost of installation, removal or re-installation.
- Equipment and components not manufactured, supplied or authorized by Siemens.
- Failures or defects caused by misuse, abuse, accidents, physical damage, abnormal operation, improper handling or storage, neglect, alterations, unauthorized installation, removal or repairs, failure to follow instructions, problems caused by your carrier's network coverage, exposure to fire, water or excessive moisture or dampness, floods, or extreme changes in climate or temperature, acts of God, riots, acts of terrorism, spills of food or liquids, viruses or other software flaws introduced into the Product, or other acts which are not the fault of Siemens and which the Product is not specified to tolerate, including damage caused by mishandling or blown fuses.
- Products which have had warranty stickers, electronic serial number and/or serial number label removed, altered, rendered illegible or fraudulently applied to their equipment.
- Signal reception problems (unless caused by defect in material or workmanship).

- Products operated outside published maximum ratings.
- Performance of the Products when used in combination with other products or equipment not manufactured, supplied or authorized by Siemens.
- Consumables (such as fuses).
- Payments for labor or service to representatives or service centers not authorized to perform product maintenance by Siemens. This warranty does not cover customer education, instruction, installation or removal, set up adjustments, or signal reception problems. This warranty is valid only in the United States.

USE WITH ACCESSORIES NOT SUPPLIED BY SIEMENS OR NOT OTHERWISE EXPRESSLY AUTHORIZED BY SIEMENS MAY VOID WARRANTY.



The U.S. Food and Drug Administration's (FDA) Center for Devices and Radiological Health Consumer Update on Mobile Phones

FDA has been receiving inquiries about the safety of mobile phones, including cellular phones and PCS phones. The following summarizes what is known — and what remains unknown — about whether these products can pose a hazard to health, and what can be done to minimize any potential risk. This information may be used to respond to questions.

Why the concern?

Mobile phones emit low levels of radio frequency energy (i.e., radio frequency radiation) in the microwave range while being used. They also emit very low levels of radio frequency energy (RF), considered non-significant, when in the stand-by mode. It is well known that high levels of RF can produce biological damage through heating effects (this is how your microwave oven is able to cook food). However, it is not known whether, to what extent, or through what mechanism, lower levels of RF might cause adverse health effects as well. Although some research has

been done to address these questions, no clear picture of the biological effects of this type of radiation has emerged to date. Thus, the available science does not allow us to conclude that mobile phones are absolutely safe, or that they are unsafe. However, the available scientific evidence does not demonstrate adverse health effects associated with the use of mobile phones.

What kinds of phones are in question?

Questions have been raised about hand-held mobile phones, the kind that have a built-in antenna that is positioned close to the user's head during normal telephone conversation. These types of mobile phones are of concern because of the short distance between the phone's antenna — the primary source of the RF — and the person's head. The exposure to RF from mobile phones in which the antenna is located at greater distances from the user (on the outside of a car, for example) is drastically lower than that from hand-held phones, because a person's RF exposure decreases rapidly with distance from the source. The safety of so-called "cordless phones," which have a base unit connected to the telephone wiring in a house and which operate at far lower power levels and frequencies, has not been questioned.

How much evidence is there that handheld mobile phones might be harmful?

Briefly, there is not enough evidence to know for sure, either way; however, research efforts are on-going. The existing scientific evidence is conflicting and many of the studies that have been done to date have suffered from flaws in their research methods. Animal experiments investigating the effects of RF exposures characteristic of mobile phones have yielded conflicting results. A few animal studies, however, have suggested that low levels of RF could accelerate the development of cancer in laboratory animals. In one study, mice genetically altered to be predisposed to developing one type of cancer developed more than twice as many such cancers when they were exposed to RF energy compared to controls. There is much uncertainty among scientists about whether results obtained from animal studies apply to the use of mobile phones. First, it is uncertain how to apply the results obtained in rats and mice to humans. Second, many of the studies showed increased tumor development used animals that had already been treated with cancer-causing chemicals, and other studies exposed the animals to the RF virtually continuously — up to 22 hours per day.

For the past five years in the United States, the mobile phone industry has supported research into the safe-

ty of mobile phones. This research has resulted in two findings in particular that merit additional study:

1. In a hospital-based, case-control study, researchers looked for an association between mobile phone use and either glioma (a type of brain cancer) or acoustic neuroma (a benign tumor of the nerve sheath). No statistically significant association was found between mobile phone use and acoustic neuroma. There was also no association between mobile phone use and gliomas when all types of gliomas were considered together. It should be noted that the average length of mobile phone exposure in this study was less than three years.

When 20 types of glioma were considered separately, however, an association was found between mobile phone use and one rare type of glioma, neuroepitheliomatous tumors. It is possible with multiple comparisons of the same sample that this association occurred by chance. Moreover, the risk did not increase with how often the mobile phone was used, or the length of the calls. In fact, the risk actually decreased with cumulative hours of mobile phone use. Most cancer causing agents increase risk with increased exposure. An ongoing study of brain cancers by the National Cancer Institute is expected to bear on the accuracy and repeatability of these results.¹

2. Researchers conducted a large battery of laboratory tests to assess the effects of exposure to mobile phone RF on genetic material. These included tests for several kinds of abnormalities, including mutations, chromosomal aberrations, DNA strand breaks, and structural changes in the genetic material of blood cells called lymphocytes. None of the tests showed any effect of the RF except for the micronucleus assay, which detects structural effects on the genetic material. The cells in this assay showed changes after exposure to simulated cell phone radiation, but only after 24 hours of exposure. It is possible that exposing the test cells to radiation for this long resulted in heating. Since this assay is known to be sensitive to heating, heat alone could have caused the abnormalities to occur. The data already in the literature on the response of the micronucleus assay to RF are conflicting. Thus follow-up research is necessary.²

FDA is currently working with government, industry, and academic groups to ensure the proper follow-up to these industry-funded research findings. Collaboration with the Cellular Telecommunications Industry Association (CTIA) in particular is expected to lead to FDA providing research recommendations and scientific oversight of new CTIA-funded research based on such

recommendations.

Two other studies of interest have been reported recently in the literature:

- Two groups of 18 people were exposed to simulated mobile phone signals under laboratory conditions while they performed cognitive function tests. There were no changes in the subjects' ability to recall words, numbers, or pictures, or in their spatial memory, but they were able to make choices more quickly in one visual test when they were exposed to simulated mobile phone signals. This was the only change noted among more than 20 variables compared.³
- In a study of 209 brain tumor cases and 425 matched controls, there was no increased risk of brain tumors associated with mobile phone use. When tumors did exist in certain locations, however, they were more likely to be on the side of the head where the mobile phone was used. Because this occurred in only a small number of cases, the increased likelihood was too small to be statistically significant.⁴

In summary, we do not have enough information at this point to assure the public that there are, or are not, any low incident health problems associated with use of mobile phones. FDA continues to work with all par-

ties, including other federal agencies and industry, to assure that research is undertaken to provide the necessary answers to the outstanding questions about the safety of mobile phones.

What is known about cases of human cancer that have been reported in users of hand-held mobile phones?

Some people who have used mobile phones have been diagnosed with brain cancer. But it is important to understand that this type of cancer also occurs among people who have not used mobile phones. In fact, brain cancer occurs in the U.S. population at a rate of about 6 new cases per 100,000 people each year. At that rate, assuming 80 million users of mobile phones (a number increasing at a rate of about 1 million per month), about 4800 cases of brain cancer would be expected each year among those 80 million people, whether or not they used their phones. Thus it is not possible to tell whether any individual's cancer arose because of the phone, or whether it would have happened anyway. A key question is whether the risk of getting a particular form of cancer is greater among people who use mobile phones than among the rest of the population. One way to answer that question is to compare the usage of mobile phones among people with brain cancer with the use of mobile phones among appropriately matched people

without brain cancer. This is called a case-control study. The current case-control study of brain cancers by the National Cancer Institute, as well as the follow-up research to be sponsored by industry, will begin to generate this type of information.

What is FDA's role concerning the safety of mobile phones?

Under the law, FDA does not review the safety of radiation emitting consumer products such as mobile phones before marketing, as it does with new drugs or medical devices. However, the agency has authority to take action if mobile phones are shown to emit radiation at a level that is hazardous to the user. In such a case, FDA could require the manufacturers of mobile phones to notify users of the health hazard and to repair, replace or recall the phones so that the hazard no longer exists.

Although the existing scientific data do not justify FDA regulatory actions at this time, FDA has urged the mobile phone industry to take a number of steps to assure public safety. The agency has recommended that the industry:

- Support needed research into possible biological effects of RF of the type emitted by mobile phones;
- Design mobile phones in a way that minimizes any RF exposure to the user that is not necessary for device function; and

- Cooperate in providing mobile phone users with the best possible information on what is known about possible effects of mobile phone use on human health.

At the same time, FDA belongs to an interagency working group of the federal agencies that have responsibility for different aspects of mobile phone safety to ensure a coordinated effort at the federal level. These agencies are:

- National Institute for Occupational Safety and Health
- Environmental Protection Agency
- Federal Communications Commission
- Occupational Health and Safety Administration
- National Telecommunications and Information Administration

The National Institutes of Health also participates in this group.

In the absence of conclusive information about any possible risk, what can concerned individuals do?

If there is a risk from these products — and at this point we do not know that there is — it is probably very small. But if people are concerned about avoiding even potential risks, there are simple steps they can take to do so. For example, time is a key factor in how much exposure a person receives. Those persons who spend long periods of time on their

hand-held mobile phones could consider holding lengthy conversations on conventional phones and reserving the hand-held models for shorter conversations or for situations when other types of phones are not available.

People who must conduct extended conversations in their cars every day could switch to a type of mobile phone that places more distance between their bodies and the source of the RF, since the exposure level drops off dramatically with distance. For example, they could switch to:

- a mobile phone in which the antenna is located outside the vehicle,
- a hand-held phone with a built-in antenna connected to a different antenna mounted on the outside of the car or built into a separate package, or
- a headset with a remote antenna to a mobile phone carried at the waist.

Where can I find additional information?

For additional information, see the following websites:

- Federal Communications Commission (FCC) RF Safety Program (select "Information on Human Exposure to RF Fields from Cellular and PCS Radio Transmitters"): <http://www.fcc.gov/oet/rfsafety>.

- World Health Organization (WHO) International Commission on Non-Ionizing Radiation Protection (select Qs & As):
<http://www.who.int/emf>
- United Kingdom, National Radiological Protection Board:
<http://www.nrpb.org.uk>
- Cellular Telecommunications Industry Association (CTIA):
<http://www.wow-com.com>
- U.S. Food and Drug Administration (FDA) Center for devices and Radiological Health:
<http://www.fda.gov/cdhr/consumer/>

¹ Muscat et al. Epidemiological Study of Cellular Telephone Use and Malignant Brain Tumors. In: State of the Science Symposium; 1999 June 20; Long Beach, California.

² Tice et al. Tests of mobile phone signals for activity in genotoxicity and other laboratory assays. In: Annual Meeting of the Environmental Mutagen Society; March 29, 1999, Washington, DC; and personal communication, unpublished results.

³ Preece, AW, Iwi, G, Davies-Smith, A, Wesnes, K, Butler, S, Lim, E, and Varey, A. Effect of a 915- MHz simulated mobile phone signal on cognitive function in man. *Int. J. Radiat. Biol.*, April 8, 1999.

⁴ Hardell, L, Nasman, A, Pahlson, A, Hallquist, A and Mild, KH. Use of cellular telephones and the risk for brain tumors; a case-control study. *Int. J. Oncol*, 15: 113-116, 1999.

FCC/Industry Canada Notice

105

Your phone may cause TV or radio interference (for example, when using a telephone in close proximity to receiving equipment). The FCC or Industry Canada can require you to stop using your telephone if such interference cannot be eliminated. If you require assistance, please contact your local service facility.

This device complies with part 15 of the FCC rules. Operation is subject to the condition that this device does not cause harmful interference.

Ten Driving Safety Tips

107



Your Siemens wireless phone gives you the power to communicate by voice — almost anywhere, anytime. But an important responsibility accompanies the benefits of wireless phones, one that every user must uphold.

When driving a car, driving is your first responsibility. When using your wireless phone behind the wheel of a car, practice good common sense and remember the following tips:

Get to know your phone and its features such as speed dial and redial.

Carefully read your instruction manual and learn to take advantage of valuable features most phones offer including, automatic redial and memory dial — most phones can store up to 99 numbers in memory dial. Also, work to memorize the phone keypad so you can use the speed dial function without taking your attention off the road.

When available, use a hands-free device.

A number of hands-free wireless phone accessories are readily available today. Whether you choose an installed mounted device for your phone or a speaker phone accessory, take advantage of these devices if they are available to you.

Position your phone within easy reach.

Make sure you place your wireless phone within easy reach and where you can grab it without removing your eyes from the road. If you get an incoming call at an inconvenient time, let your voice mail answer it for you.

Suspend conversations during hazardous driving conditions or situations.

Let the person you are speaking to know you are driving; if necessary, suspend the call in heavy traffic or hazardous weather conditions. Rain, sleet, snow and ice can be hazardous, but so is heavy traffic. As a driver, your first responsibility is to pay attention to the road.

Do not take notes or look up phone numbers while driving.

If you are reading an address book or business card while driving a car, or writing a “to do” list, then you are not watching where you are going. It’s common sense. Don’t get caught in a dangerous situation because you are reading or writing and not paying attention to the road or nearby vehicles.

Ten Driving Safety Tips

Dial sensibly and assess the traffic.

If possible, place calls when you are not moving or before pulling into traffic. Try to plan your calls before you begin your trip, or attempt to coincide your calls with times you may be stopped at a stop sign, red light or otherwise stationary. But if you need to dial while driving, follow this simple tip — dial only a few numbers, check the road and your mirrors, then continue.

Do not engage in stressful or emotional conversations that may be distracting.

Stressful or emotional conversations and driving do not mix — they are distracting and even dangerous when you are behind the wheel. Make people you are talking with aware you are driving and if necessary, suspend phone conversations that have the potential to divert your attention from the road.

Use your phone to call for help.

Your wireless phone is one of the greatest tools you can own to protect yourself and your family in dangerous situations — with your phone at your side, help is only three numbers away. Dial 9-1-1 in the case of fire, traffic accident, road hazard, or medical emergency. Remember, it is a free call on your wireless phone.

Use your phone to help others in emergencies.

Your wireless phone provides you a perfect opportunity to be a “good Samaritan” in your community. If you see an auto accident, crime in progress or other serious emergencies where lives are in danger, call 9-1-1, as you would want others to do for you.

Call roadside assistance or a special wireless non-emergency assistance number when necessary.

Certain situations you encounter while driving may require attention, but are not urgent enough to merit a call to 9-1-1. But you can still use your wireless phone to lend a hand. If you see a broken-down vehicle posing no serious hazard, a broken traffic signal, a minor traffic accident where no one appears injured, or a vehicle you know to be stolen, call roadside assistance or other special non-emergency wireless numbers.

“The wireless industry reminds you to use your phone safely when driving.”

For more information, please call 1 (888) 901-SAFE, or visit our Web site at: www.wow-com.com

Provided by the Cellular Telecommunications Industry Association (CTIA)

Intellectual Property Restrictions

All Intellectual Property, as defined below, which is owned by or otherwise the property of Siemens Information and Communications Mobile, LLC ("Siemens"), its affiliates, partners or suppliers, relating to the Phone, including but not limited to accessories, parts or software relating thereto (the "Phone System"), is proprietary under federal laws, state laws and International treaty provisions. Intellectual Property includes, but is not limited to, inventions (patentable or unpatentable), patents, trade secrets, copyrights, software, computer programs, and related documentation and other works of authorship. You may not infringe or otherwise violate the rights secured by the Intellectual Property. Moreover, you agree that you will not (and will not attempt to) disassemble, decompile, reverse engineer, prepare derivative works from, modify or make any other effort to create source code from the software. No title to ownership in the Intellectual Property is transferred to you through purchase or possession of the Phone or its components. All applicable rights of the Intellectual Property shall remain with Siemens, its affiliates, partners or suppliers.

Siemens will have no liability with respect to any claim of patent infringement which is based upon the combination of the Product or parts furnished hereunder with software,

apparatus or devices not furnished by Siemens, nor will Siemens have any liability for the use of ancillary equipment or software not furnished by Siemens which is attached to or used in connection with the Product. The foregoing states the entire liability of Siemens with respect to infringement of patents by the Product or any parts thereof.

Laws in the United States and other countries preserve for Siemens certain exclusive rights for copyrighted Siemens software, such as the exclusive rights to reproduce and distribute copies of such Siemens software. Siemens software may be used only in the Product in which the software was originally embodied when purchased, and such software in such Product may not be replaced, copied, distributed, modified in any way, or used to produce any derivative thereof. No other use including, without limitation, alteration, modification, reproduction, distribution, or reverse engineering of such Siemens software or exercise of rights in such Siemens software is permitted. No license is granted by implication, estoppel or otherwise under Siemens patent rights or copyrights.

A

Accessories	78, 95
Account limit	51
Activate	
phone profile	62
WAP profile	41
Aircraft mode	63
Alarm clock	60
Alarm tones	68
Alarms	
alarm clock	60
anniversaries	58
appointment	57
All calls	51
divert	52
duration/charges	51
All incoming	
duration/charge	51
network barring	73
All outgoing	
duration/charge	51
network barring	73
Allow only 	71
Anniversaries	58
Answering service (external)	49
Any key to answer	69
Application	
download	42
start	42
Appointments	57
Archive, SMS	32
Audio	67
Authentication	78
Auto answer, Car Kit	78
Auto display	
CB	50
duration/charge	51
Auto network	72
Auto network search	72

Auto off	61
Auto redial previous numbers	21

B

Babysitter	24
Battery	
care	70
charge	15
insert	14
quality declaration	83
Big letters	69
Birthday	58
Bitmap style	45, 69
Bitmap viewer	44
Bookmarks	64
Bottom cover, my-CLIPit™	19, 95
Browser, WAP	40

C

Call	
accept/end	21
barrings	73
charges	51
conference	23
divert	52
end	20
hold	22
menu	23
reject	21
several simultaneously	22
swap (togglng)	22
to group	54
Call back	21
Call lists	24
Call status	23
Call transfer	23
Call waiting	75
Car Kit	
accessories	78
profile	63

Car solutions	95	During a call, setup.....	75
CB languages	50	E	
CB services	50	E-mail via SMS.....	38
Cell Broadcast	50	Emergency call.....	81
Charge display	51	EMS	37
Charge settings	51	F	
Charges/units.....	51	Factory settings	70
Charging the battery	15	Fast access.....	65
Clear all, divert	53	Fast search.....	70
CLIPit™ Cover.....	19, 95	Favourites.....	64
Clock	61	Favourites, WAP.....	39
Codes	71	Fax	
Conference	23	receive, divert	52
Confidential numbers.....	17	Fax via SMS	38
Configuration, network.....	72	Fax/data mode with PC	80
Congratulations.....	58	Filter for calls.....	67
Connectivity.....	75	G	
Contrast, display	69	Games & More	42
Control codes (DTMF).....	81	Games, download.....	42
Covers, my-CLIPit™	19, 95	Getting started.....	14
D		GPRS	
Data		activate/deactivate	75
receive, divert.....	52	set.....	76
Date set	61	Greeting.....	45, 69
Default values.....	70	Group	
Dialled calls, call list.....	25	call to group	54
Dialling with number keys	20	settings.....	56
Dictionary (T9).....	36	SMS to group	54
Direct reply	38	H	
Display.....	69	Handset volume.....	20
big letters.....	69	Headset.....	79
contrast.....	69	accessories	79
illumination	69	profile	63
Display of call duration/charges	51	Hide ID on/off	75
Display symbols.....	87	Hold call	22
Divert	52	Home network	72
Driving safety	107	Home page	39
DTMF tones (control codes)	81		
Duration/charges.....	51		

Hotline.....	92	Minute beep.....	68
I		Missed appointments.....	60
Illumination, display	69	Missed calls, call list	25
IMEI number	70	Muting	23
Inbox, SMS	32	My menu.....	64
Information tones	68	my-CLIPit™	19
Input language, SMS	35	N	
Input language, T9.....	70	Network	72
International dialling codes	84	barrings.....	73
J		choose	72
JAD file	82	connection	72
JAR file	82	network info	72
K		provider	72
Key lock	69	status check	74
Key tones	69	New appointment	57
Keys	69	New message	
L		SMS	31
Language, phone	69	Noisy environm., profiles	62
Last call, duration/charges	51	Norm. environm., profiles	62
Limit, duration/charges	51	Notes.....	59
Line (2nd phone number).....	72	Number is busy	21
Load picture, Bitmap viewer	44	O	
Lost phone, SIM card	94	Only 	71
M		Only last 10	71
Mailbox.....	49	Organiser	57
Maintenance tips	94	Out.int.o.home, network barring. 73	
Melodies, ring tones	48	Outbox, SMS	32
Melody manager	46	Outgo. internat., network barring 73	
Menu		Own (call) numbers.....	83
control.....	12	P	
My menu.....	64	Phone code.....	17
Message (CB)	50	Phone identity no. (IMEI).....	70
Message (SMS)	31	Phone memory	29
Message store	82	Phonebook	
Message, SMS.....	31	assign picture.....	30
Microphone off	55	call	26
Microphone on/off.....	23	call to group	28
		new entry	26

store control codes (DTMF)	81	Ringer setting	67
text entry	27	Roaming, network barring	73
Pictures		S	
receive	44	Safety precautions	3
Pictures & Sounds (EMS)	37	Screensaver	45, 69
Pictures in SMS	31	receive	45, 69
PIN		Second line	72
change	17	Security	17, 71
enter	16	Security codes	71
error	91	Select line, connection	72
PIN 2	17	Send/receive ring tones	47
PIN control	17	Service centre, service provider ...	37
Preferred network	73	Service tones	68
Prefix	20	Settings	
Profiles	62	group	56
Java	43, 77	Setup	
phone	62	accessories	78
SMS	37	connectivity	75
PUK, PUK2	17	during a call	75
Q		network	72
Quick menu selection	83	phone	69
Quiet environm., profiles	62	security	71
R		SMS profile	37
Read new CB message	50	user group	74
Read new SMS	31	user profile	62
Receive/send picture	44	Short message (SMS)	31
Received calls	25	Show URL, WAP	40
Record No.	30	Siemens City Portal	19
Records	24	Signal strength	83
Redial previous numbers	20	Signal tone, ringer	67
Remaining units, duration/charges...	51	Silent alert	67
Reminder	21	SIM card	
Ring melodies, ring tones	47	clear barrings	18
Ring tone		error	89
choose	68	insert	14
send	47	problems	84
Ring tone setting	67	protect	17
		SIM protected	29
		SMS	

archive.....	32
capacity	32, 43
compose message	33
delete message	32
delivery confirmation	32
inbox/outbox	32
insert pictures/sounds	37
read message	31
setup.....	37
status report	38
text entry with T9	35
to group	28, 54
via GPRS	38
Soft keys	
control.....	12
explanation.....	11
SOS	6, 81
Sounds in SMS.....	31
Spec divert	52
Special characters	84
Specifications	93
Speed dialling keys	66
Speed dialling number	66
Standard text fragments	34
Standby mode	16
Start menu	39
Status check	
divert	53
network barring	74
Status report, SMS	32
Storage location	29
Storage location number	30
Surf & Fun	39
Swap	22
Switch off phone	
manually	16
Switch on phone	16
Symbols.....	87

T**T9**

activate/deactivate	34
preferred.....	70
text entry	35
word suggestions	36
Technical data	93
Text entry	27
Text entry with T9	35
Text message, SMS.....	31
This SIM only.....	71
Time zones	61
Time/date.....	61
Top cover, my-CLIPit™	19, 95
Topic index, CB	50
Topic list, CB	50
Transfer (call)	23

U

Unanswered calls.....	52
Upper-, lowercase.....	27, 35
User group	
all outgoing.....	74
preferred group	74
select group	74
User guide, symbols	12

V

Validity, SMS	38
Voice message (Mailbox).....	49
Voice/fax	80
Volume ringer	67
Volume, handset volume	20

W

Waiting call.....	22
WAP	
browser.....	40
exit browser	40
explanation	85

options	76
Writing letters.....	27