

**MPE EVALUATION REPORT**

**FOR THE**

**DUAL BAND BI-DIRECTIONAL AMPLIFIER, 801201-A**

**FCC OET BULLETIN 65, EDITION 97-01, ANSI / IEEE C95.1-1992,  
AND ANSI / IEEE C95.3-1992**

**RF EXPOSURE COMPLIANCE**

**DATE OF ISSUE: MARCH 9, 2006**

**PREPARED FOR:**

Wilson Electronics  
3301 East Deseret Drive  
St. George, UT 84790

W.O. No.: 84511

**PREPARED BY:**

Randy Clark  
CKC Laboratories, Inc.  
5046 Sierra Pines Dr  
Mariposa, CA 95338

Date of test: December 14, 2005

**Report No.: FC06-012R**

This report contains a total of 19 pages and may be reproduced in full only. Partial reproduction may only be done with the written consent of CKC Laboratories, Inc. The results in this report apply only to the items tested, as identified herein.

## TABLE OF CONTENTS

Administrative Information .....	3
Summary of Results .....	3
Approvals .....	4
Equipment Under Test .....	5
Peripheral Devices .....	5
Specifications and Requirements .....	6
Summary of RF Exposure Conditions .....	7
Report of Measurements .....	8
Test Configuration .....	10
Test Procedure .....	10
Reference Documents .....	15
Appendix A: Photographs of the Test Setup Used .....	16
Appendix B: Test Equipment List .....	17

## ADMINISTRATIVE INFORMATION

### **PURPOSE OF TEST:**

To demonstrate the compliance of the Dual Band Bi-Directional Amplifier, 801201-A with the RF Exposure Requirements for mobile devices.

### **REPRESENTATIVE:**

Riki Kline

## SUMMARY OF RESULTS

### *VEHICLE MOUNTED ANTENNA*

For General Population / Uncontrolled Exposure, the Maximum Permissible Exposure (MPE) limit for the operating frequency range 1 (824-849 MHz) is  $0.55 \text{ mW/cm}^2$  and for operating frequency range 2 (1850-1910 MHz) is  $1.0 \text{ mW/cm}^2$ . The data in this report demonstrates that this device complies with the Maximum Permissible Exposure (MPE) requirements set forth in 47 CFR §2.1091, §1.1310, and OET Bulletin 65, Edition 97-01 for General Population / Uncontrolled Exposure environment at a minimum distance of 10 cm through a ground plane from the vehicle mounted antenna (operator requirement), and for General Population / Uncontrolled Exposure environment at a minimum distance of 50 cm laterally from the vehicle mounted antenna (bystander requirement).

**APPROVALS**

Steve Behm, Director of Engineering Services

**QUALITY ASSURANCE:**



---

Joyce Walker, Quality Assurance Administrative  
Manager

**TEST PERSONNEL:**



---

Randy Clark, EMC Engineer

## **EQUIPMENT UNDER TEST**

### **Dual Band Bi-Directional Amplifier**

Manuf: Wilson Electronics  
Model: 801201-A  
Serial: 8012010112702  
FCC ID: pending

### **Vehicle Mounted Antenna**

Manuf: Wilson Electronics  
Model: 301103  
Serial: NA  
FCC ID: NA

## **PERIPHERAL DEVICES**

The EUT was tested with the following peripheral device(s):

### **Signal Generator**

Manuf: HP  
Model: E4432B  
Serial: US40052968  
FCC ID: DoC

### **Signal Generator**

Manuf: HP  
Model: E4432B  
Serial: US400053750  
FCC ID: DoC

### **DC Power Supply**

Manuf: Topward  
Model: TPS-2000  
Serial: 920035  
FCC ID: DoC

## SPECIFICATIONS AND REQUIREMENTS

The following summarizes the specifications and requirements for Maximum Permissible Exposure for mobile devices applied during RF exposure evaluation.

### Excerpt from 47 CFR §1.1310 Radio Frequency radiation exposure limits

**Table 1. - Limits for Maximum Permissible Exposure (MPE)**

(A) Limits for Occupational/Controlled Exposures

Frequency Range (MHz)	Electric Field Strength (V/m)	Magnetic Field Strength (A/m)	Power Density (mW/cm <sup>2</sup> )	Averaging Time (Minutes)
0.3-3.0	614	1.63	*(100)	6
3.0-30	1842/f	4.89/f	*(900/f <sup>2</sup> )	6
30-300	61.4	0.163	1	6
300-1500	---	---	f/300	6
1500-100,000	---	---	5	6

(B) Limits for General Population/Uncontrolled Exposure

Frequency Range (MHz)	Electric Field Strength (V/m)	Magnetic Field Strength (A/m)	Power Density (mW/cm <sup>2</sup> )	Averaging Time (Minutes)
0.3-1.34	614	1.63	*(100)	30
1.34-30	824/f	2.19/f	*(180/f <sup>2</sup> )	30
30-300	27.5	0.073	0.2	30
300-1500	---	---	f/1500	30
1500-100,000	---	---	1	30

f = frequency in MHz

\* = Plane-wave equivalent power density

NOTE 1 to Table 1: Occupational/controlled limits apply in situations in which persons are exposed as a consequence of their employment provided those persons are fully aware of the potential for exposure and can exercise control over their exposure. Limits for occupational/controlled exposure also apply in situations when an individual is transient through a location where occupational/controlled limits apply provided he or she is made aware of the potential for exposure.

NOTE 2 to Table 1: General population/uncontrolled exposures apply in situations in which the general public may be exposed, or in which persons that are exposed as a consequence of their employment may not be fully aware of the potential for exposure or can not exercise control over their exposure.

## SUMMARY OF RF EXPOSURE CONDITIONS

### Range 1

Operating Frequency Range (MHz)	824-849 (uplink)
Rated Power Output (Watts)	3 (conducted)
MPE Limit =	f/1500 (mW/cm <sup>2</sup> )
=	0.549 (mW/cm <sup>2</sup> )

### Range 2

Operating Frequency Range (MHz)	1850-1910 (uplink)
Rated Power Output (Watts)	3 (conducted)
MPE Limit =	1 (mW/cm <sup>2</sup> )

### All Frequency Ranges

#### *Operator Exposure Condition*

	Occupational / Controlled Exposure
X	General Population / Uncontrolled Exposure

#### *Bystander Exposure Condition*

	Occupational / Controlled Exposure
X	General Population / Uncontrolled Exposure

### *Device and Antenna Operating Configuration*

#### *Vehicle Mounted Antenna*

Antenna used for test is a magnetically mounted vehicle antenna with gain of 5.12dBi in the frequency range of 824-849 MHz and 6.12dBi in the frequency range of 1850-1910 MHz. Input CDMA signal (representative of worst case) is provided via support signal generator. Signal generator output is fed to the input of the EUT through a preamplifier when necessary to obtain the maximum output.

## REPORT OF MEASUREMENTS

### *VEHICLE MOUNTED ANTENNA*

The following tables show the measurements performed to determine conformity with the applicable limits for RF exposure. Measurements are performed at the center of the equipment's operating band; this allows the maximum power output through the device.

#### **Range 1**

Frequency investigated: 836.5MHz

#### *Operator Exposure Measurements*

Measurement of the operator made directly under the ground plane at a separation of 10cm beneath the base of the transmitting antenna

d (m)	mW/cm <sup>2</sup>	Limit	Result
0.1	<b>0.00051</b>	0.55	Pass

#### *Bystander Exposure Measurements*

Measurements on point grid in mW/cm<sup>2</sup>.

	A	B	C	Height
1	0.005	0.005	0.003	1.75
2	0.215	0.265	0.220	1.00
3	0.007	0.002	0.013	0.50

The spatially averaged power density is

X (m)	mW/cm <sup>2</sup>	Limit	Result
0.5	<b>0.08166</b>	0.55	Pass

Evaluation was performed at the following measurement distances: 0.50m, 0.60m and 0.70m. The maximum power density measurements were obtained at 0.50m representing the edge of the conductive plane simulating vehicular installation.



**Range 2**

Frequency investigated: 1880MHz

***Operator Exposure Measurements***

Measurement of the operator made directly under the ground plane at a separation of 10cm beneath and 10cm forward of the base of the transmitting antenna

d (m)	mW/cm <sup>2</sup>	Limit	Result
0.1	0	1	Pass

***Bystander Exposure Measurements***

Measurements on point grid in mW/cm<sup>2</sup>.

	A	B	C	Height
1	0.000	0.000	0.000	1.75
2	0.166	0.196	0.161	1.00
3	0.000	0.000	0.000	0.50

The spatially averaged power density is

X (m)	mW/cm <sup>2</sup>	Limit	Result
0.5	0.05812	1	Pass

Evaluation was performed at the following measurement distances: 0.50m, 0.60m and 0.70m. The maximum power density measurements were obtained at 0.50m.

## **TEST CONFIGURATION**

The EUT antenna is placed in a configuration typical of normal installation. Where antenna mounting is required, non-conductive materials are used for support structures. In the special case of magnetically mounted vehicle antennas, a reference ground plane is used to simulate actual installation. In order to limit external interference effects, the test is performed in a semi-anechoic chamber. The EUT equipment is setup in a configuration representative of normal use. Support equipment for the measurement instruments are located outside of the chamber.

## **TEST PROCEDURE**

The method for performing spatially averaged measurements is as follows:

1. Determine the location of the maximum field.
2. Establish around the location of the maximum field a grid of points within approximately 0.35 m (width) x 1.25 m (height) surface area, at a reasonable distance (e.g., 0.5 m) above the floor or ground and perpendicular to it. These points should be uniformly spaced within the grid with the point of the maximum field included.
3. Measure the field strength in all points of the grid.
4. Calculate the average field.

To determine the location of the maximum field, the detector is moved throughout the RF field generated by the transmit antenna. The detector is positioned at a minimum of 12 radials and at varying distances from the antenna along each radial. The area of maximum RF energy determined during preliminary investigation shall be used for the remainder of the tests. In the case where a transmitter may have multiple frequency bands, the preliminary investigation shall be repeated for each band.

To determine the spatially averaged value, local values including the maximum value are measured over a surface area of 0.35 m (width) x 1.25 m (height) perpendicular to the ground beginning at 0.50m from the ground reference plane. Preliminary investigation is performed in order to determine the orientation and height which yields the highest power density or field strength measurements. The height of the center row of local points is determined during preliminary investigation and corresponds to a location at which a local maximum exists. Where the field is reasonably uniform (within +20%), e.g., in the far-field, measurements will suffice in one location, representative of the space that is occupied by a person. Where the field is not uniform, measurements are made at a series of locations. The measurement points are uniformly spaced within the sampling area. Local values are measured at nine points within the sampling grid.

Since the applicable limits exist in several different measurement units, the following outlines the most common calculations used for determining the spatially averaged field.

Case 1: Where limits are applied in electric field strength (V/m), the spatially averaged electric field strength along a grid of  $n$  points is calculated using:

$$E = \left[ \frac{1}{n} \sum_{i=1}^n E_i^2 \right]^{\frac{1}{2}}$$

Case 2: Where limits are applied in units of power density ( $\text{mW}/\text{cm}^2$ ), assuming measurements are made in the far field, where the E and H vectors are mutually orthogonal, power density is first calculated using:

$$S = \frac{E^2}{377}$$

And the spatially averaged power density along a grid of  $n$  points is calculated using:

$$S = \frac{1}{n} \sum_{i=1}^n S_i$$

The following diagram is an example of the grid used to perform local measurements for RF exposure evaluation over a whole-body spatial average.

**Example Grid used for  
 RF Exposure Measurements**

- Represents local points used for whole-body spatial averaging

Note: Rows and Columns are defined from the perspective of the bystander looking toward the transmit antenna.

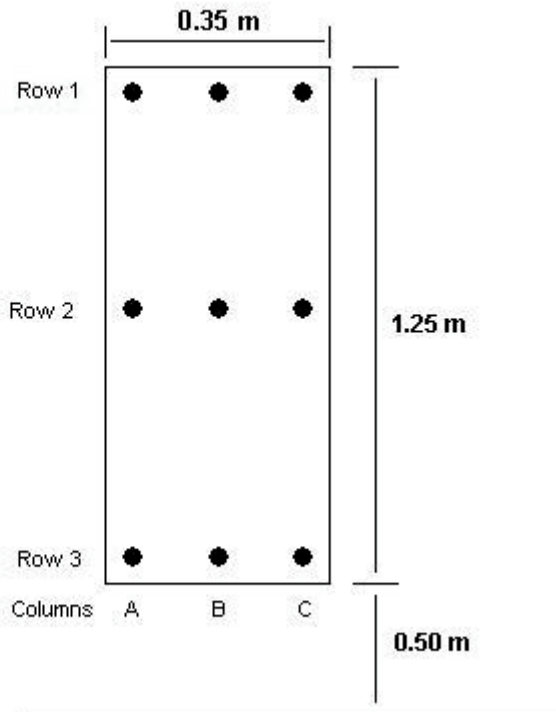

The following diagram is an example of the setup used for most tests, excluding magnetically mounted vehicle antennas.

**Setup Used for RF Evaluation Measurements**  
(excluding magnetically mounted vehicle antennas)

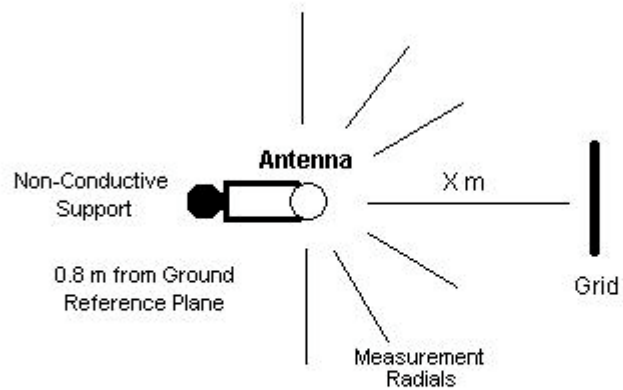

**Top View**

The following diagram is an example of the setup used for vehicle-mounted antennas. In the case where vehicle glass mounted antennas are used, this setup shall not apply. The letter X represents the test distance used for RF exposure measurements. The distance X is measured from the phase center of the transmitting antenna to the volumetric center of the measurement instrument. In order to more accurately simulate normal installation, the antenna ground plane is not bonded to the ground reference plane. The transmitting antenna is placed in the center of the antenna ground plane.

**Setup Used for Vehicle-Mounted Antennas**

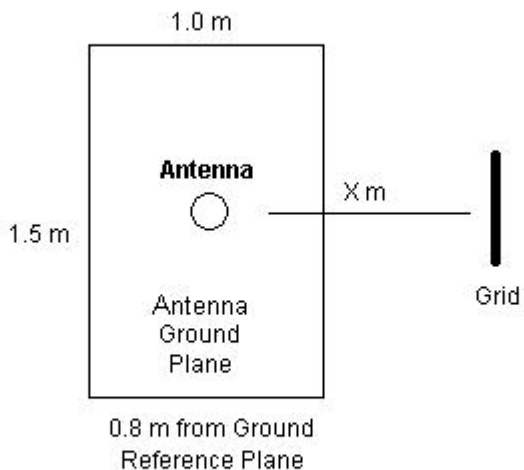

**Top View**

## **REFERENCE DOCUMENTS**

ANSI IEEE C95.1-1991. IEE Standard for Safety Levels with Respect to Human Exposure to Radio Frequency Electromagnetic Fields, 3kHz to 300GHz.

ANSI IEEE C95.3-1991. IEEE Recommended Practice for the Measurement of Potentially Hazardous Electromagnetic Fields – RF and Microwave

FCC OET Bulletin 65 Supplement C. Evaluating Compliance with FCC Guidelines for Human Exposure to Radio Frequency Electromagnetic Fields

Health Canada Safety Code 6. Limits of Human Exposure to Radio Frequency Electromagnetic Fields in the Frequency Range from 3 kHz to 300 GHz.

**APPENDIX A**  
**PHOTOGRAPH OF THE TEST SETUP USED**

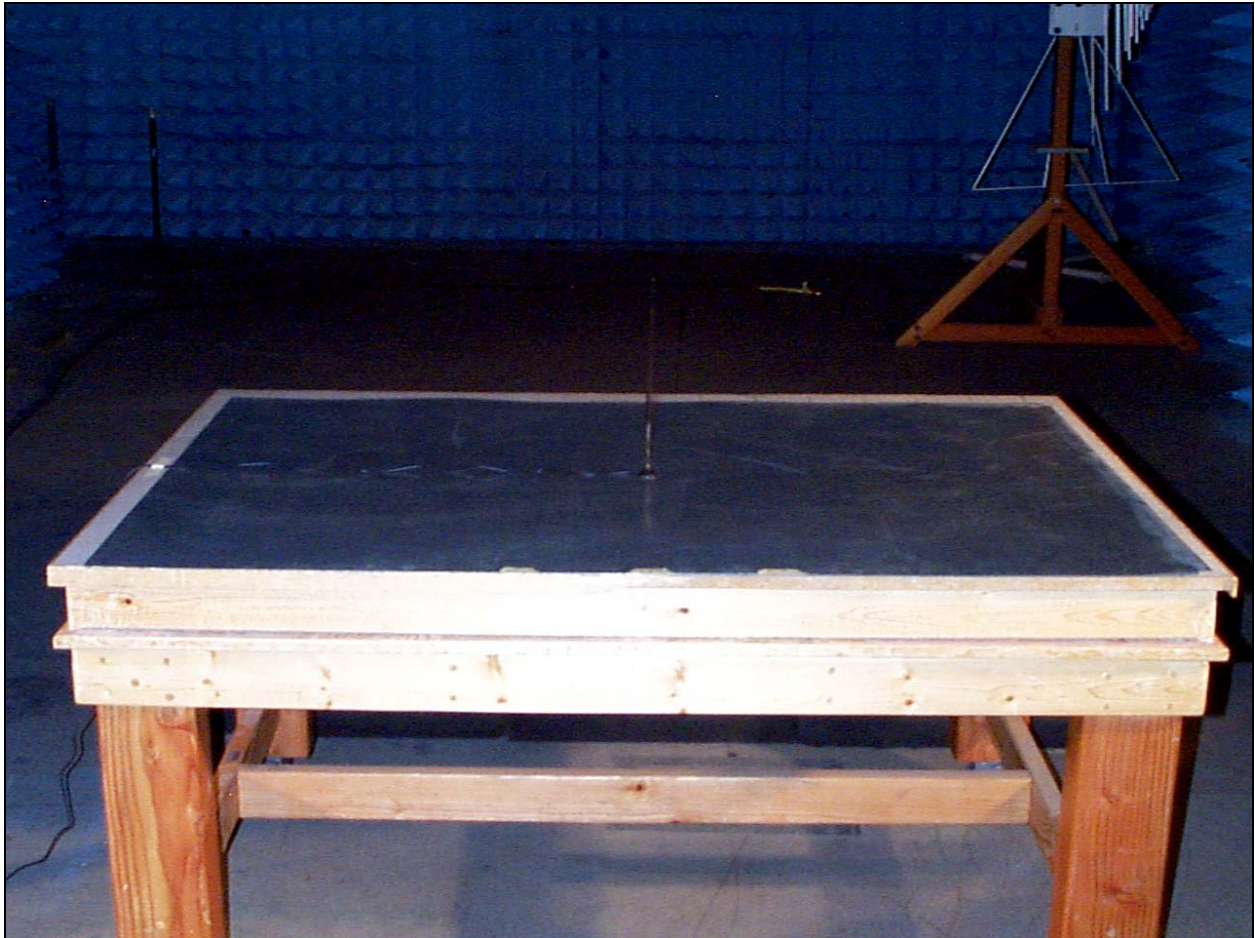

Vehicle Mounted Antenna



**APPENDIX B**

**TEST EQUIPMENT LIST**

<i>Description</i>	<i>Asset #</i>	<i>Manufacturer</i>	<i>Model #</i>	<i>Serial #</i>	<i>Cal Date</i>	<i>Cal Due</i>
Field Probe	02043	AR	FP2080	16770	12/23/04	12/23/06
Field Monitor	02007	AR	FM1000	11757	10/6/04	10/6/06
Field Probe	02024	AR	FP1000	11836	10/6/04	10/6/06