



GE
Lighting
A SAVANT COMPANY

GRAPHICS APPR OVAL
Approvals designate all items on checklist have been reviewed & are correct in addition to other organizational responsibilities.

REVIEWED DATE	SIGNATURE	PACKAGING GRAPHICS
_____	_____	_____

Proof Reading - Spelling Website
 Proof against TDS request Graphics Printability

SKU LISTING INFO:	93129828 NPI OD Battery Camera 6520976
REVISION (DATE) PA:	4 (09-15-21) CN
BAR CODE SPEC:	<input type="checkbox"/> 100% No BWR <input type="checkbox"/> 80% No BWR <input checked="" type="checkbox"/> N/A
INSERT (IF SHARED):	NONE
SUPPLIER PROJECT:	N/A
PRINT METHOD:	<input type="checkbox"/> Offset/Litho <input type="checkbox"/> Flexo (direct)
GE DIE:	NOT CONTROLLED
PK (VERSION):	PK-00107466-1

PC93129828 ING

**THIS ART IS SUPPLIED AT 100% SCALE
DO NOT RESIZE, RESHAPE OR ALTER**

4.500"



Outdoor Battery
Smart Camera
Installation Guide

4.500"



GE
Lighting
A SAVANT COMPANY

GRAPHICS APPR OVAL
Approvals designate all items on checklist have been reviewed & are correct in addition to other organizational responsibilities.

REVIEWED DATE	SIGNATURE	PACKAGING GRAPHICS
<input type="checkbox"/> Proof Reading – Spelling	<input type="checkbox"/> Website	<input type="checkbox"/> Graphics Printability
<input type="checkbox"/> Proof against TDS request	<input type="checkbox"/> Graphics Printability	

SKU LISTING INFO:	93129828 NPI OD Battery Camera 6520976
REVISION (DATE) PA:	4 (09-15-21) CN
BAR CODE SPEC:	<input type="checkbox"/> 100% No BWR <input type="checkbox"/> 80% No BWR <input checked="" type="checkbox"/> N/A
INSERT (IF SHARED):	NONE
SUPPLIER PROJECT:	N/A
PRINT METHOD:	<input type="checkbox"/> Offset/Litho <input type="checkbox"/> Flexo (direct)
GE DIE:	NOT CONTROLLED
PK (VERSION):	PK-00107466-1

PC93129828 ING

THIS ART IS SUPPLIED AT 100% SCALE
DO NOT RESIZE, RESHAPE OR ALTER

4.500"

Simple DIY Set Up

- STEP 1**
Charge your CYNCTM Outdoor Smart Camera by plugging in the USB cable into the battery and USB port
- STEP 2**
Download the Cync App, powered by Savant, on your smartphone
- STEP 3**
Add your Outdoor Smart Camera to the Cync App
- STEP 4**
Install your Outdoor Smart Camera

For set up help, visit cyncsupport.gelighting.com
or call 1-844-302-2943

4.500"



GE
Lighting
A SAVANT COMPANY

GRAPHICS APPR OVAL
Approvals designate all items on checklist have been reviewed & are correct in addition to other organizational responsibilities.

REVIEWED DATE	SIGNATURE	PACKAGING GRAPHICS
<input type="checkbox"/> Proof Reading – Spelling	<input type="checkbox"/> Website	<input type="checkbox"/> Graphics Printability
<input type="checkbox"/> Proof against TDS request	<input type="checkbox"/> Graphics Printability	

SKU LISTING INFO:	93129828 NPI OD Battery Camera 6520976
REVISION (DATE) PA:	4 (09-15-21) CN
BAR CODE SPEC:	<input type="checkbox"/> 100% No BWR <input type="checkbox"/> 80% No BWR <input checked="" type="checkbox"/> N/A
INSERT (IF SHARED):	NONE
SUPPLIER PROJECT:	N/A
PRINT METHOD:	<input type="checkbox"/> Offset/Litho <input type="checkbox"/> Flexo (direct)
GE DIE:	NOT CONTROLLED
PK (VERSION):	PK-00107466-1

PC93129828 ING

THIS ART IS SUPPLIED AT 100% SCALE
DO NOT RESIZE, RESHAPE OR ALTER

4.500"

Let's Do It

INCLUDED

- Camera
- Mounting Bracket
- Masonry/Drywall Anchors (Used When Applicable)
- Phillips Mounting Screws
- Battery Pack and Charging Cord

YOU'LL NEED

- Phillips Screwdriver
- 1/4" Drill Bit
- Ladder

4.500"



GE
Lighting
A SAVANT COMPANY

GRAPHICS APPR OVAL
Approvals designate all items on checklist have been reviewed & are correct in addition to other organizational responsibilities.

REVIEWED DATE	SIGNATURE	PACKAGING GRAPHICS
<input type="checkbox"/> Proof Reading – Spelling	<input type="checkbox"/> Website	<input type="checkbox"/> Graphics Printability
<input type="checkbox"/> Proof against TDS request	<input type="checkbox"/> Graphics Printability	

SKU LISTING INFO:	93129828 NPI OD Battery Camera 6520976
REVISION (DATE) PA:	4 (09-15-21) CN
BAR CODE SPEC:	<input type="checkbox"/> 100% No BWR <input type="checkbox"/> 80% No BWR <input checked="" type="checkbox"/> N/A
INSERT (IF SHARED):	NONE
SUPPLIER PROJECT:	N/A
PRINT METHOD:	<input type="checkbox"/> Offset/Litho <input type="checkbox"/> Flexo (direct)
GE DIE:	NOT CONTROLLED
PK (VERSION):	PK-00107466-1

PC93129828 ING

THIS ART IS SUPPLIED AT 100% SCALE
DO NOT RESIZE, RESHAPE OR ALTER

4.500"

You Got This!

And we're here to help.

For in-depth instructional videos and a guided tour through the installation, go to cyncsupport.gelighting.com or call 1-844-302-2943.

NOTE: Please make sure your system is up-to-date, and you update the firmware when prompted for the best experience.

4.500"



GE
Lighting
A SAVANT COMPANY

GRAPHICS APPR OVAL
Approvals designate all items on checklist have been reviewed & are correct in addition to other organizational responsibilities.

REVIEWED DATE	SIGNATURE	PACKAGING GRAPHICS
<input type="checkbox"/> Proof Reading – Spelling	<input type="checkbox"/> Website	<input type="checkbox"/> Graphics Printability
<input type="checkbox"/> Proof against TDS request	<input type="checkbox"/> Graphics Printability	

SKU LISTING INFO:	93129828 NPI OD Battery Camera 6520976
REVISION (DATE) PA:	4 (09-15-21) CN
BAR CODE SPEC:	<input type="checkbox"/> 100% No BWR <input type="checkbox"/> 80% No BWR <input checked="" type="checkbox"/> N/A
INSERT (IF SHARED):	NONE
SUPPLIER PROJECT:	N/A
PRINT METHOD:	<input type="checkbox"/> Offset/Litho <input type="checkbox"/> Flexo (direct)
GE DIE:	NOT CONTROLLED
PK (VERSION):	PK-00107466-1

PC93129828 ING

THIS ART IS SUPPLIED AT 100% SCALE
DO NOT RESIZE, RESHAPE OR ALTER

4.500"

Choosing a Location



Avoid direct sunlight



Stay within 33' of router



Do not obstruct

TIP: Hold the camera where you want it. Check that your view in the app is unobstructed and you are still in range of your home Wi-Fi.

4.500"



GE
Lighting
A SAVANT COMPANY

GRAPHICS APPR OVAL
Approvals designate all items on checklist have been reviewed & are correct in addition to other organizational responsibilities.

REVIEWED DATE	SIGNATURE	PACKAGING GRAPHICS
<input type="checkbox"/> Proof Reading – Spelling	<input type="checkbox"/> Website	<input type="checkbox"/> Graphics Printability
<input type="checkbox"/> Proof against TDS request	<input type="checkbox"/> Graphics Printability	

SKU LISTING INFO:	93129828 NPI OD Battery Camera 6520976
REVISION (DATE) PA:	4 (09-15-21) CN
BAR CODE SPEC:	<input type="checkbox"/> 100% No BWR <input type="checkbox"/> 80% No BWR <input checked="" type="checkbox"/> N/A
INSERT (IF SHARED):	NONE
SUPPLIER PROJECT:	N/A
PRINT METHOD:	<input type="checkbox"/> Offset/Litho <input type="checkbox"/> Flexo (direct)
GE DIE:	NOT CONTROLLED
PK (VERSION):	PK-00107466-1

PC93129828 ING

THIS ART IS SUPPLIED AT 100% SCALE
DO NOT RESIZE, RESHAPE OR ALTER

4.500"

Mount the Base

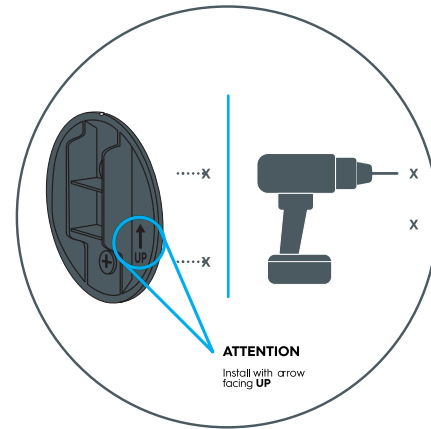

- STEP 1**
Choose the location where you wish to install your camera and verify your camera is connected to Wi-Fi by checking the signal strength under settings in the Cync App
- STEP 2**
Place the bracket where you wish to install the camera
- STEP 3**
Use the bracket to mark the holes
- STEP 4**
Drill holes with a 1/4" drill bit
- STEP 5**
Screw in the mounting plate

6

4.500"



GE
Lighting
A SAVANT COMPANY

GRAPHICS APPR OVAL
Approvals designate all items on checklist have been reviewed & are correct in addition to other organizational responsibilities.

REVIEWED DATE	SIGNATURE	PACKAGING GRAPHICS
<input type="checkbox"/> Proof Reading – Spelling	<input type="checkbox"/> Website	<input type="checkbox"/> Graphics Printability
<input type="checkbox"/> Proof against TDS request	<input type="checkbox"/> Graphics Printability	

SKU LISTING INFO:	93129828 NPI OD Battery Camera 6520976
REVISION (DATE) PA:	4 (09-15-21) CN
BAR CODE SPEC:	<input type="checkbox"/> 100% No BWR <input type="checkbox"/> 80% No BWR <input checked="" type="checkbox"/> N/A
INSERT (IF SHARED):	NONE
SUPPLIER PROJECT:	N/A
PRINT METHOD:	<input type="checkbox"/> Offset/Litho <input type="checkbox"/> Flexo (direct)
GE DIE:	NOT CONTROLLED
PK (VERSION):	PK-00107466-1

PC93129828 ING

THIS ART IS SUPPLIED AT 100% SCALE
DO NOT RESIZE, RESHAPE OR ALTER

4.500"

Attach the Camera & Adjust the Position

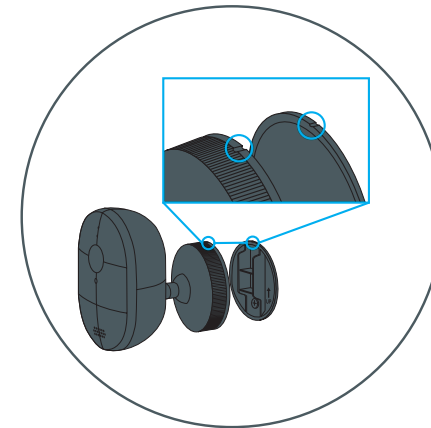

- STEP 1**
Align the the red notch on the base of your camera with the red notch on the mounting plate
- STEP 2**
Slide the base of the camera onto the mounting plate
- STEP 3**
Adjust the camera to your desired angle (use the camera view in the Cync App to verify your view before locking the ball joint)
- STEP 4**
Turn the neck of the camera clockwise to tighten the ball joint and lock your camera in place

You're all set!
Use the Cync App to check your camera's live feed and select your motion settings and zones under your camera's setting.

7

4.500"



GE
Lighting
A SAVANT COMPANY

GRAPHICS APPR OVAL
Approvals designate all items on checklist have been reviewed & are correct in addition to other organizational responsibilities.

REVIEWED DATE	SIGNATURE	PACKAGING GRAPHICS
<input type="checkbox"/> Proof Reading – Spelling	<input type="checkbox"/> Website	<input type="checkbox"/> Graphics Printability
<input type="checkbox"/> Proof against TDS request	<input type="checkbox"/> Graphics Printability	

SKU LISTING INFO:	93129828 NPI OD Battery Camera 6520976
REVISION (DATE) PA:	4 (09-15-21) CN
BAR CODE SPEC:	<input type="checkbox"/> 100% No BWR <input type="checkbox"/> 80% No BWR <input checked="" type="checkbox"/> N/A
INSERT (IF SHARED):	NONE
SUPPLIER PROJECT:	N/A
PRINT METHOD:	<input type="checkbox"/> Offset/Litho <input type="checkbox"/> Flexo (direct)
GE DIE:	NOT CONTROLLED
PK (VERSION):	PK-00107466-1

PC93129828 ING

THIS ART IS SUPPLIED AT 100% SCALE
DO NOT RESIZE, RESHAPE OR ALTER

4.500"

How to Recharge the Battery

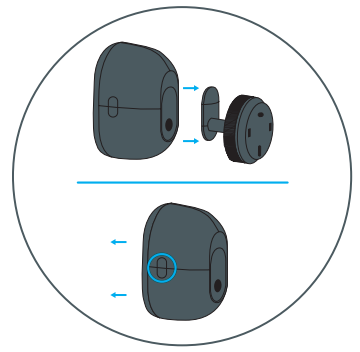

- STEP 1**
Gently pull on the camera to detach the magnet from the neck of the mount
- STEP 2**
Squeeze the buttons on both sides of the camera to release the camera face
- STEP 3**
Slide the battery pack up to remove it from the camera
- STEP 4**
Plug the USB cable into the camera pack and plug into the wall to begin charging

4.500"



GE
Lighting
A SAVANT COMPANY

GRAPHICS APPR OVAL
Approvals designate all items on checklist have been reviewed & are correct in addition to other organizational responsibilities.

REVIEWED DATE	SIGNATURE	PACKAGING GRAPHICS
<input type="checkbox"/> Proof Reading – Spelling	<input type="checkbox"/> Website	<input type="checkbox"/> Graphics Printability
<input type="checkbox"/> Proof against TDS request	<input type="checkbox"/> Graphics Printability	

SKU LISTING INFO:	93129828 NPI OD Battery Camera 6520976
REVISION (DATE) PA:	4 (09-15-21) CN
BAR CODE SPEC:	<input type="checkbox"/> 100% No BWR <input type="checkbox"/> 80% No BWR <input checked="" type="checkbox"/> N/A
INSERT (IF SHARED):	NONE
SUPPLIER PROJECT:	N/A
PRINT METHOD:	<input type="checkbox"/> Offset/Litho <input type="checkbox"/> Flexo (direct)
GE DIE:	NOT CONTROLLED
PK (VERSION):	PK-00107466-1

PC93129828 ING

THIS ART IS SUPPLIED AT 100% SCALE
DO NOT RESIZE, RESHAPE OR ALTER

4.500"

Additional Information and Warnings

CAUTION
Suitable for use only with the CYNC outdoor battery operated camera.

Do not disassemble, open, crush, bend, deform, puncture, or shred the battery.

Do not modify or remanufacture the battery, attempt to insert foreign objects into the battery, or immerse or expose it to water or other liquids, expose to fire, explosion or other hazard.

Do not short-circuit the battery or allow metallic conductive objects to come into contact with battery terminals.

Avoid dropping the battery. If the battery is dropped and the user suspects damage, discontinue use immediately. Do not attempt to repair.

Keep batteries out of reach of children.

Dispose of all batteries in accordance with applicable laws and regulations.

4.500"



GE
Lighting
A SAVANT COMPANY

GRAPHICS APPR OVAL
Approvals designate all items on checklist have been reviewed & are correct in addition to other organizational responsibilities.

REVIEWED DATE	SIGNATURE	PACKAGING GRAPHICS
<input type="checkbox"/> Proof Reading – Spelling	<input type="checkbox"/> Website	<input type="checkbox"/> Graphics Printability
<input type="checkbox"/> Proof against TDS request	<input type="checkbox"/> Graphics Printability	

SKU LISTING INFO:	93129828 NPI OD Battery Camera 6520976
REVISION (DATE) PA:	4 (09-15-21) CN
BAR CODE SPEC:	<input type="checkbox"/> 100% No BWR <input type="checkbox"/> 80% No BWR <input checked="" type="checkbox"/> N/A
INSERT (IF SHARED):	NONE
SUPPLIER PROJECT:	N/A
PRINT METHOD:	<input type="checkbox"/> Offset/Litho <input type="checkbox"/> Flexo (direct)
GE DIE:	NOT CONTROLLED
PK (VERSION):	PK-00107466-1

PC93129828 ING

THIS ART IS SUPPLIED AT 100% SCALE
DO NOT RESIZE, RESHAPE OR ALTER

4.500"

FCC Statement

⚠ WARNING: Changes or modifications to this unit not expressly approved by the party responsible for compliance could void the user's authority to operate the equipment.

NOTE: This equipment has been tested and found to comply with the limits for a Class B digital device, pursuant to Part 15 of the FCC Rules. These limits are designed to provide reasonable protection against harmful interference in a residential installation. This equipment generates, uses and can radiate radio frequency energy and, if not installed and used in accordance with the instructions, may cause harmful interference to radio communications.

However, there is no guarantee that interference will not occur in a particular installation. If this equipment does cause harmful interference to radio or television reception, which can be determined by turning the equipment off and on, the user is encouraged to try to correct the interference by one or more of the following measures:

- Reorient or relocate the receiving antenna.
- Increase the separation between the equipment and receiver.
- Connect the equipment into an outlet on a circuit different from that to which the receiver is connected.
- Consult the dealer or an experienced radio/TV technician for help

10

The device must not be co-located or operating in conjunction with any other antenna or transmitter. This device complies with Part 15 of the FCC Rules. Operation is subject to the following two conditions :

- (1) this device may not cause harmful interference, and
- (2) this device must accept any interference received, including interference that may cause undesired operation.

FCC RF Radiation Exposure Statement Caution: To maintain compliance with the FCC's RF exposure guidelines, place the product at least 20cm from nearby persons.

IC Statement

This device complies with RSS247 of Industry Canada. Cet appareil se conforme à RSS247 de Canada d'Industrie. This device complies with Industry Canada license-exempt RSS standard(s). Operation is subject to the following two conditions: (1) this device may not cause interference, and (2) this device must accept any interference, including interference that may cause undesired operation of the device. appareils radio exempts de licence. Son fonctionnement est sujet aux deux conditions suivantes: (1) le dispositif ne doit pas produire de brouillage préjudiciable, et (2) ce dispositif doit accepter tout brouillage reçu, y compris un brouillage susceptible de provoquer un fonctionnement indésirable. The device must not be co-located or operating in conjunction with any other antenna or transmitter.

11

4.500"



GE
Lighting
A SAVANT COMPANY

GRAPHICS APPR OVAL
Approvals designate all items on checklist have been reviewed & are correct in addition to other organizational responsibilities.

REVIEWED DATE	SIGNATURE	PACKAGING GRAPHICS
<input type="checkbox"/> Proof Reading – Spelling	<input type="checkbox"/> Website	<input type="checkbox"/> Graphics Printability
<input type="checkbox"/> Proof against TDS request	<input type="checkbox"/> Graphics Printability	

SKU LISTING INFO:	93129828 NPI OD Battery Camera 6520976
REVISION (DATE) PA:	4 (09-15-21) CN
BAR CODE SPEC:	<input type="checkbox"/> 100% No BWR <input type="checkbox"/> 80% No BWR <input checked="" type="checkbox"/> N/A
INSERT (IF SHARED):	NONE
SUPPLIER PROJECT:	N/A
PRINT METHOD:	<input type="checkbox"/> Offset/Litho <input type="checkbox"/> Flexo (direct)
GE DIE:	NOT CONTROLLED
PK (VERSION):	PK-00107466-1

PC93129828 ING

THIS ART IS SUPPLIED AT 100% SCALE
DO NOT RESIZE, RESHAPE OR ALTER

4.500"

4.500"



GE Lighting A SAVANT COMPANY			GRAPHICS APPR OVAL Approvals designate all items on checklist have been reviewed & are correct in addition to other organizational responsibilities.	SKU LISTING INFO: 93129828 NPI OD Battery Camera 6520976
REVIEWED DATE	SIGNATURE	PACKAGING GRAPHICS		REVISION (DATE) PA: 4 (09-15-21) CN
<input type="checkbox"/> Proof Reading - Spelling <input type="checkbox"/> Website <input type="checkbox"/> Proof against TDS request <input type="checkbox"/> Graphics Printability				BAR CODE SPEC: <input type="checkbox"/> 100% No BWR <input type="checkbox"/> 80% No BWR <input checked="" type="checkbox"/> N/A
				INSERT (IF SHARED): NONE
				SUPPLIER PROJECT: N/A
				PRINT METHOD: <input type="checkbox"/> Offset/Litho <input type="checkbox"/> Flexo (direct)
				GE DIE: NOT CONTROLLED
				PK (VERSION): PK-00107466-1

PC93129828 ING

THIS ART IS SUPPLIED AT 100% SCALE
DO NOT RESIZE, RESHAPE OR ALTER

4.500"



Like your new Outdoor Battery Smart Camera? Share your experience!
Leave a review where you purchased the product.

★ ★ ★ ★ ★

PK-00107466-1

4.500"