

**RIVA**  

---

**TURBO X**

We truly appreciate that you have chosen the RIVA Turbo X for your listening experience. Many days and months have gone into designing this product in the hope that you will have as much pleasure listening to it as we had creating it!

**The RIVA Team**

Fountain Valley, California

# CONTENTS

## TAKE CONTROL

Controls .....6-7

## HOOK UPS

Input / Outputs .....8-9

## THE MINERALS

Technical Specifications .....10

## IN THE BOX

Whats Included .....12

## REGISTER YOUR TURBO

Warranty Coverage Registration .....14

## RIVA GROUND CONTROL

TURBO Mobile App .....15

## TURBO CHARGED

Power On/Off .....16

## CONNECTION

Blue Tooth Pairing .....18

## TURN IT UP TO 11

TURBO Mode .....19

## CALL ME

Speakerphone .....20

## CHARGE OUT

Charge Your Phone/Tablet .....21

## DOUBLE UP

Stereo/Repeater .....22

## Q & A

Troubleshooting .....24-25

## ADDITIONAL SUPPORT

Online Resources/Reference .....26

## COMPLIANCE

FCC and IC (USA & Canada Only) .....28

EU Countries .....29

## PLAY SAFE

Safety Guidelines .....30

## LEGAL

Disclaimers .....31



S O U N D M A C H I N E

[support.rivaaudio.com/Turbo-X](https://support.rivaaudio.com/Turbo-X)

# TAKE CONTROL

## Controls



### Power On/Off

Power On: Tap the Power button  
Power Off: Hold the Power button down



### Bluetooth®

Pairing: The Bluetooth® icon will pulse blue while pairing  
Paired: The Bluetooth® icon will remain solid blue when paired



### Input

You may cycle through the input source by tapping the input button. The input icon changes color based on the input you select.

Auxiliary 3.5: Green light  
USB: Magenta light



### Mute

Tap to mute. The Mute icon light will pulse while muted.  
Tap again to unmute.

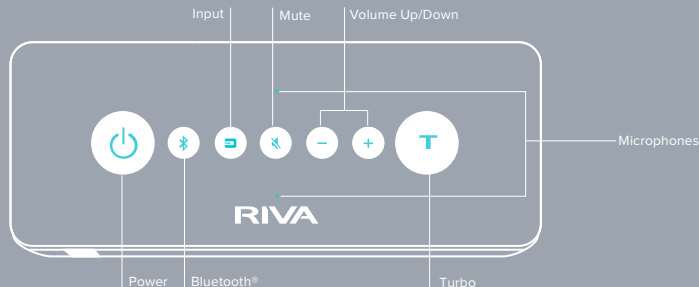

# TAKE CONTROL

## Controls



### Volume Down/Up

Control the volume + or —. Volume level will affect your battery life.

Our laboratory tests have measured approximate battery life for the following:

\* 6 hours @ TURBO Mode

\* 16 hours @ medium level

\* 20+ hours @ low level

We do not recommend running the battery to end of life. Please follow the voice prompts for recharging.



### TURBO

TURBO mode gives your music that extra BOOST! Tap the TURBO button to engage, increasing both volume and EQ for unique audio output. Add a few more revs to your TURBO by tapping the Volume + button. Tap the TURBO button again to go back to normal listening levels. Note: TURBO mode will reduce your battery life.



### Microphones For Teleconferencing

Pair your phone or other Bluetooth® devices to the Turbo X to enjoy the crystal clear teleconferencing delivered by the dual noise and echo canceling microphones. Please do not cover or stick anything (toothpicks, q-tips, spaghetti sauce, etc.) in the two microphone openings. Doing so will void your warranty.

# HOOK UPS

## Inputs / Outputs

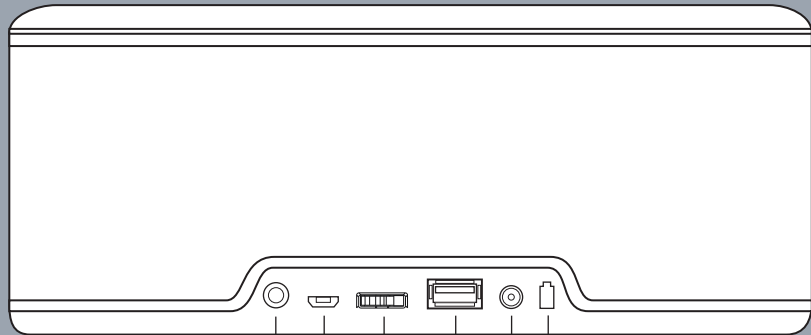

AUXILLARY

USB / DATA

BATTERY  
ON/OFF

CHARGE OUT

19V DC

BATTERY INDEX

Use the I/O cover, located on the bottom of your Turbo X, to protect the I/Os from the elements and moisture when enjoying your Turbo outdoors.



**I/O COVER**



# HOOK UPS

## Inputs / Outputs



### Auxiliary 3.5 Input

A 3.5 mm cable is included to connect your non-Bluetooth® playing devices.



### USB Data Input

For highest quality audio input, use this for digital audio signals directly from your computer or other USB source.



### Battery On/Off Switch

Control battery power functions. Switch OFF to conserve battery, especially when you will be separated from your Turbo for an extended period of time. When OFF, proximity sensing and charge out are disabled.



### Charge Out

Plug your phone or tablet in using a compatible cord to give an extra boost from the Turbo X's powerful battery. The Battery On/Off switch must be ON to charge out.



### 19V DC Power Adapter Input

Use this with the provided external power supply to charge the RIVA Turbo. Use of any other non-approved power adapter may damage the electronics and will void the warranty.



### Battery Icon

Green: 60 - 100% charge  
Orange: 30 - 60% charge  
Red: 0 - 30% charge







S T A R T M E U P !

[support.rivaaudio.com/Turbo-X](https://support.rivaaudio.com/Turbo-X)

# TURBO CHARGE

## Power On / Off

1. Switch the Battery On/Off switch to On
2. Turbo X is partially charged out of the box so use the provided power adapter to charge to 100% before using. The Battery icon LED will appear green and a voice prompt will announce when the battery is fully charged.
3. Power On: Tap the Power button to turn ON
4. Power Off: Hold the Power button to turn OFF

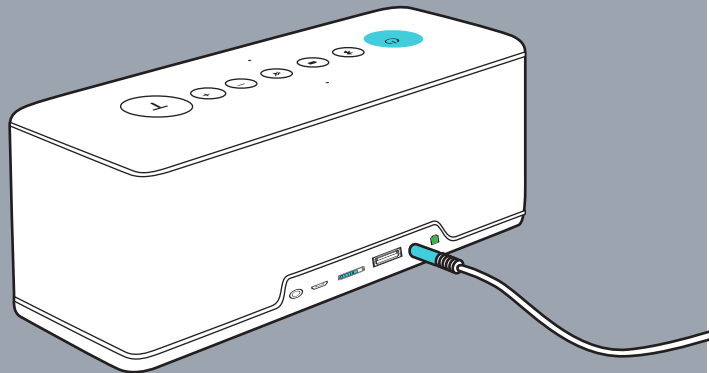

# CONNECTION

## Blue Tooth Pairing

- When you first turn your Turbo on, it will automatically go into discovery/pairing mode to connect to a Bluetooth® device.
- The unit will appear on your device as RIVA Turbo X. Once paired, you can begin playing.
- To pair a new device, hold down the Bluetooth® button to discover your device. The Bluetooth® icon will pulse blue when pairing and stay solid once paired.

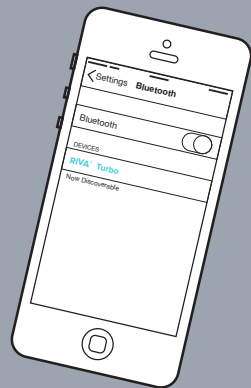
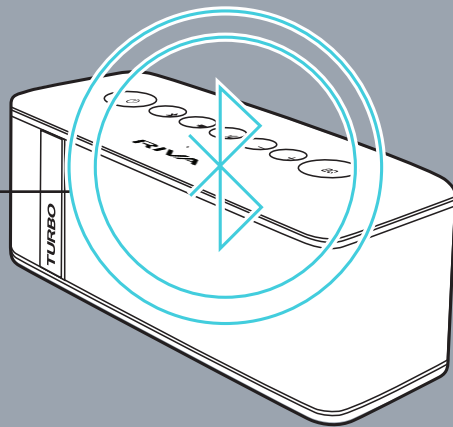

# RIVA GROUND CONTROL

Turbo Mobile App.



**Download the RIVA Ground Control App for free from the App Store<sup>SM</sup> or Google Play<sup>TM</sup>.**

- Control all of the features on your Turbo X right on your phone or tablet for iOS or Android<sup>TM</sup>!
- Select a black or white app skin.
- Select male or female voice prompts or disable voice prompts. If you choose to disable the male/female voice prompts, these will be replaced with audible beep prompts.
- RIVA is constantly developing software with the latest technologies to improve your Turbo experience. Download the latest firmware updates for your Turbo X directly from the RIVA Ground Control App.



P L A Y M E

[support.rivaaudio.com/Turbo-X](https://support.rivaaudio.com/Turbo-X)



# TURN IT UP TO 11

## TURBO Mode

Tap the **T** to engage TURBO, increasing both volume and EQ for a unique audio output!\*

Add a few more revs to your TURBO by tapping the **+**

Tap **T** again to return to normal listening levels.

**Note:** TURBO mode will reduce your battery life to 1/3 of normal usage, approximately 6 hours from full charge.

\* The maximum volume levels achievable with Riva speakers may exceed safe levels for extended listening. Please see the Play Safe page for more information.

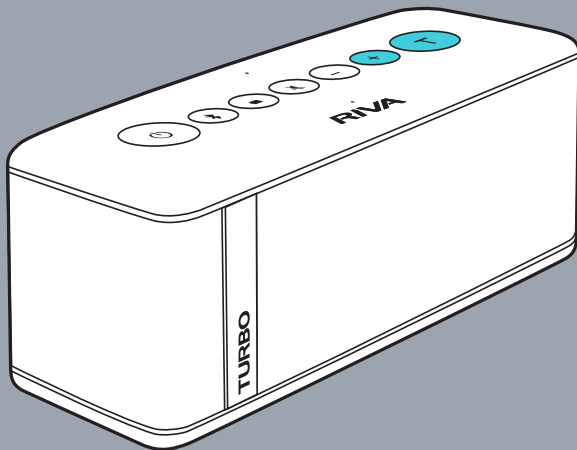



## CHARGE OUT

Charge your Phone / Tablet

- Charge your phone or tablet by connecting your USB cable into the Turbo X.
- Make sure that the Battery On/Off switch is in the ON position.
- Turbo X can charge your device when it has over 30% battery power, the battery icon LED will be green or orange.

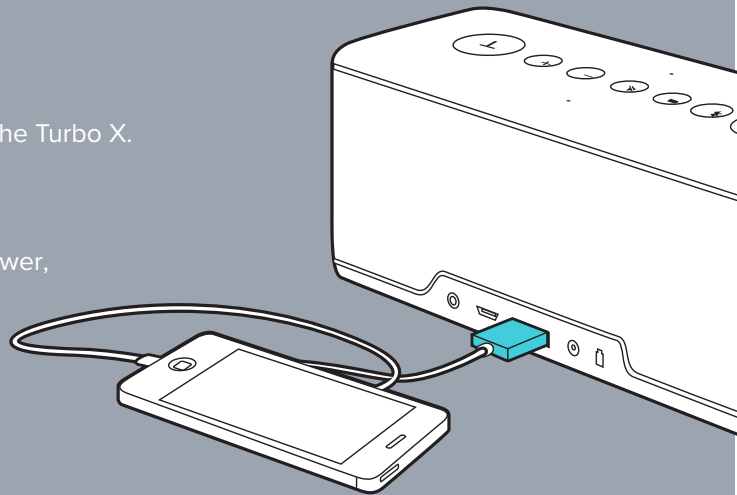

## DOUBLE UP

Stereo / Repeater

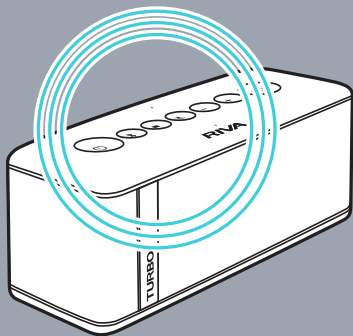

Want more out of your Turbo X listening experience? In the Settings section of the Ground Control App select stereo or repeater mode to pair up two Turbo X units.

### **Stereo**

Plays left and right channel so you can expand the listening field.

### **Repeater**

Each speaker will play both left and right channels simultaneously.

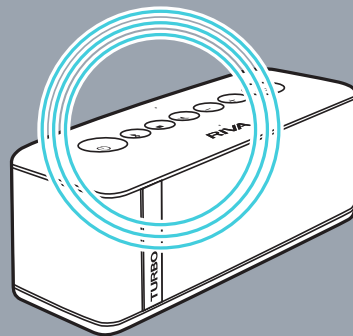

Turbo works within published Bluetooth® range.

H E L P , H E L P M E , R I V A !

[support.rivaaudio.com/Turbo-X](https://support.rivaaudio.com/Turbo-X)













# COMPLIANCE

## EU Countries

-  This product is compliant with the CE directive. All returns must be made to the original place of purchase.

- **WEEE Notice**

The Directive on Waste Electrical and Electronic equipment (WEEE), which entered into force as European law on 13th February 2003, resulted in a major change in the treatment of electrical equipment at end-of-life.

The purpose of this Directive is, as a first priority, the prevention of WEEE, and in addition, to promote the reuse, recycling and other forms of recovery of such wastes so as to reduce disposal.

The WEEE logo on the product or on its box indicating collection for electrical or electronic equipment consists of the crossed-out wheeled bin, as shown below.



This product must not be disposed of or dumped with your other household waste. You are liable to dispose of all your electronic or electrical waste equipment by relocating over to the specified collection point for recycling of such hazardous waste. Isolated collection and proper recovery of your electronic and electrical waste equipment at the time of disposal will allow us to help conserve natural resources. Moreover, proper recycling of the electronic and electrical waste equipment will ensure safety of human health and environment. For more information about electronic and electrical waste equipment disposal, recovery, and collection points, please contact your local city center, household waste disposal service, shop from where you purchased the equipment, or the manufacturer of the equipment.

- **ROHS COMPLIANCE**

This product is in compliance with Directive 2011/65/EU of the European Parliament and of the Council of 8 June 2011 of the restriction of the use of certain hazardous substances in electrical and electronic equipment.

- **EU Batteries Directive 2006/66/EC**

A new battery directive 2006/66/EC on Battery and Accumulator replacing directive entered into force on the 26th September 2008. The directive applies to all types of batteries and accumulators (AA, AAA, button cells, lead acid, rechargeable packs) including those incorporated into appliances except for military, medical and power tool applications.

The directive sets out rules for collection, treatment, recycling and disposal of batteries, and aims to prohibit certain hazardous substances and to improve environmental performance of batteries and all operations in the supply chain.

- **Instructions for Users on Removal, Recycling and Disposal of Used Batteries**

For products with a built-in battery that last for the lifetime of the product, removal may not be possible for the user. In this case, recycling or recovery centers handle the dismantling of the product and the removal of the battery. If, for any reason, it becomes necessary to replace such a battery, this procedure must be performed by authorized service centers.

In the European Union and other locations, it is illegal to dispose of any battery with household trash. All batteries must be disposed of in an environmentally sound manner. Contact your local waste-management officials for information regarding environmentally sound collection, recycling and disposal of used batteries.

**WARNING:** Danger of explosion if battery is incorrectly replaced. To reduce risk of fire or burns, don't disassemble, crush, puncture, short external contacts, expose to temperature above 60°C (140°F), or dispose of in fire or water. Replace only with specified batteries. The symbol indicating "separate collection" for all batteries and accumulators shall be the crossed-out wheeled bin shown below.

- **For All Products with Wireless Operation**

Audio Design Experts, Inc. hereby declares that this equipment is in compliance with the essential requirements and other relevant provisions of Directive 1999/5/EC, ErP 2009/125/EC Directive and RoHS 2011/65/EU Directive. The declaration of conformity may be viewed at [support.rivaaudio.com](http://support.rivaaudio.com).





BEAUTIFUL SOUND ANYWHERE

Turbo Series by RIVA™  
[www.rivaudio.com](http://www.rivaudio.com)