

### SAR Peak Location Separation Distance

Figure (1)

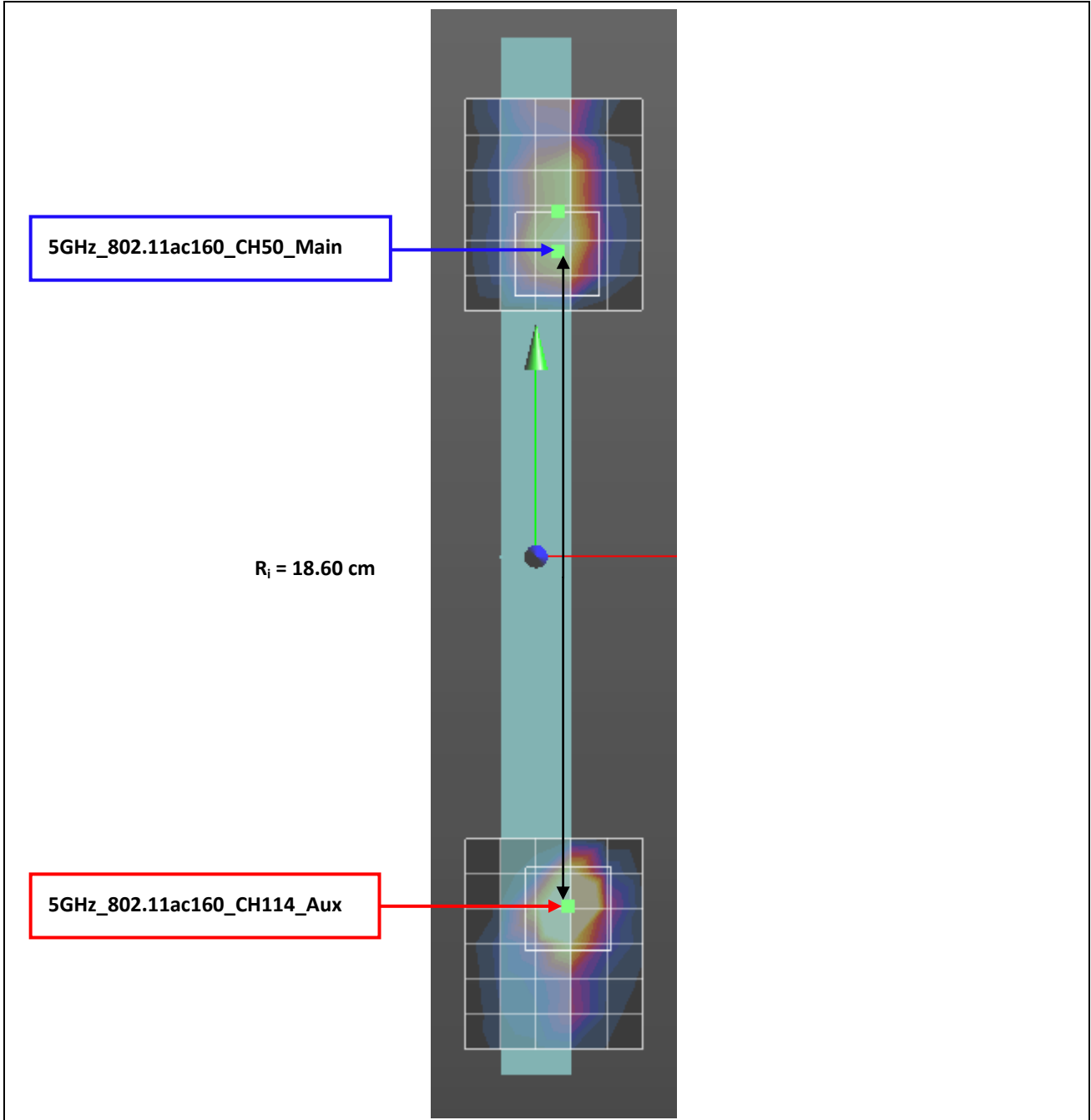

Mode	Peak SAR mW/g	X m	Y m	Z m
5GHz_802.11ac160_CH50_Main	0.624	0.006	0.086	-0.176
5GHz_802.11ac160_CH114_Aux	1.085	0.009	-0.100	-0.176
Separation distance (cm)	18.60			
SPLSR	0.01			

Figure (2)

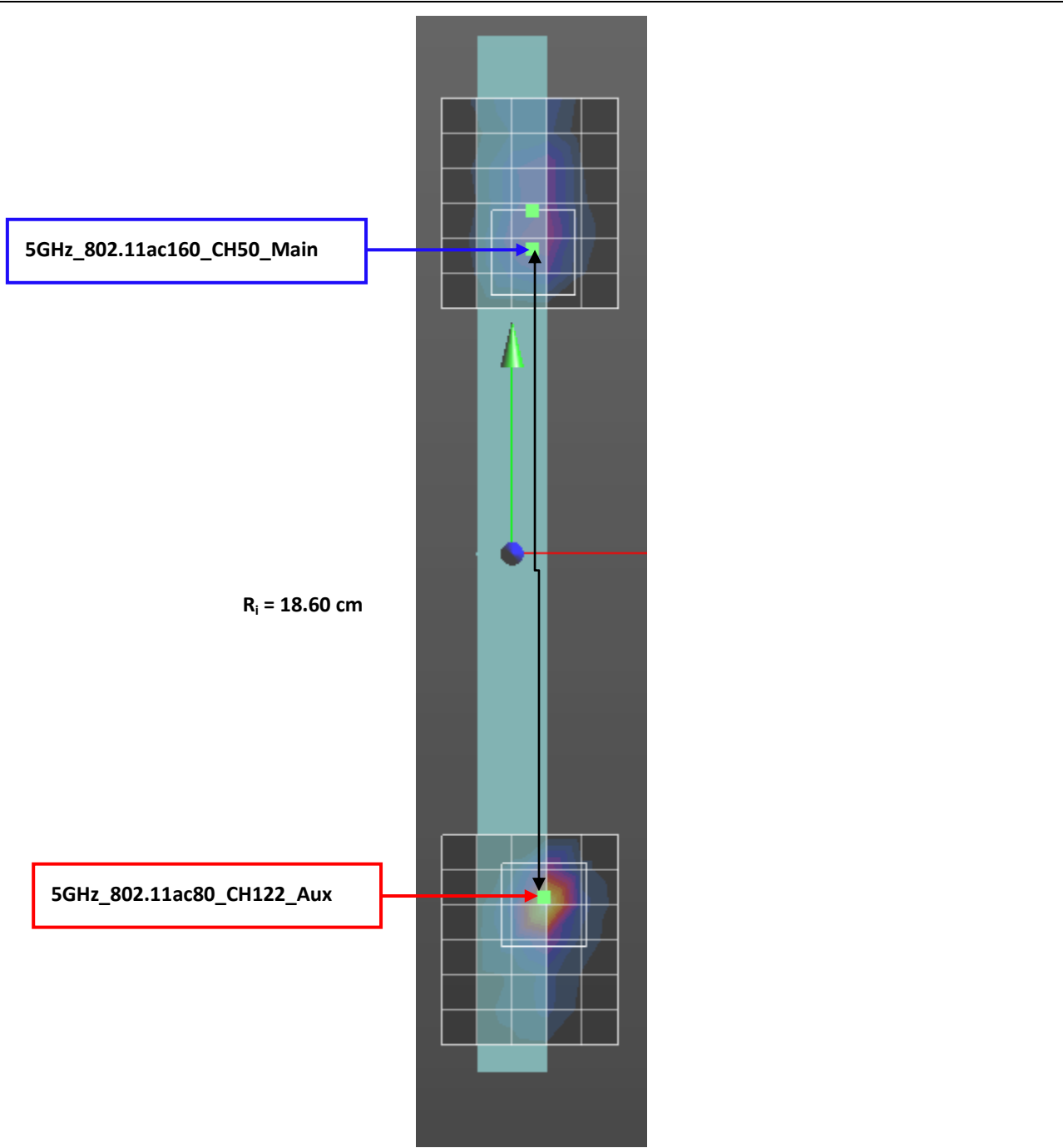

Mode	Peak SAR	X	Y	Z
	mW/g	m	m	m
5GHz_802.11ac160_CH50_Main	0.624	0.006	0.086	-0.176
5GHz_802.11ac80_CH122_Aux	1.036	0.009	-0.100	-0.176
Separation distance (cm)	18.60			
SPLSR	0.01			

Figure (3)

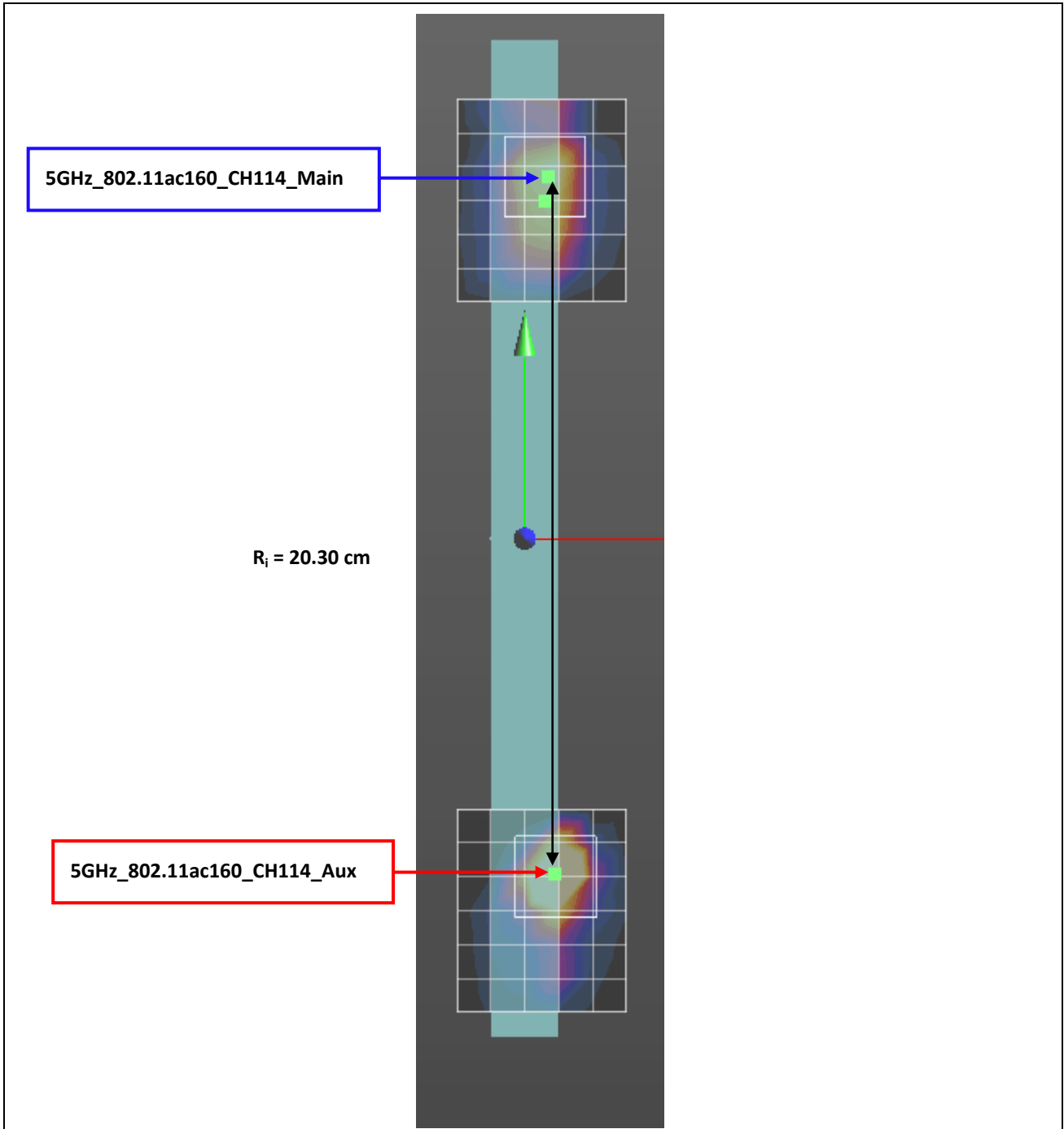

Mode	Peak SAR	X	Y	Z
	mW/g	m	m	m
5GHz_802.11ac160_CH114_Main	0.635	0.006	0.103	-0.176
5GHz_802.11ac160_CH114_Aux	1.085	0.009	-0.100	-0.176
Separation distance (cm)	20.30			
SPLSR	0.01			

Figure (4)

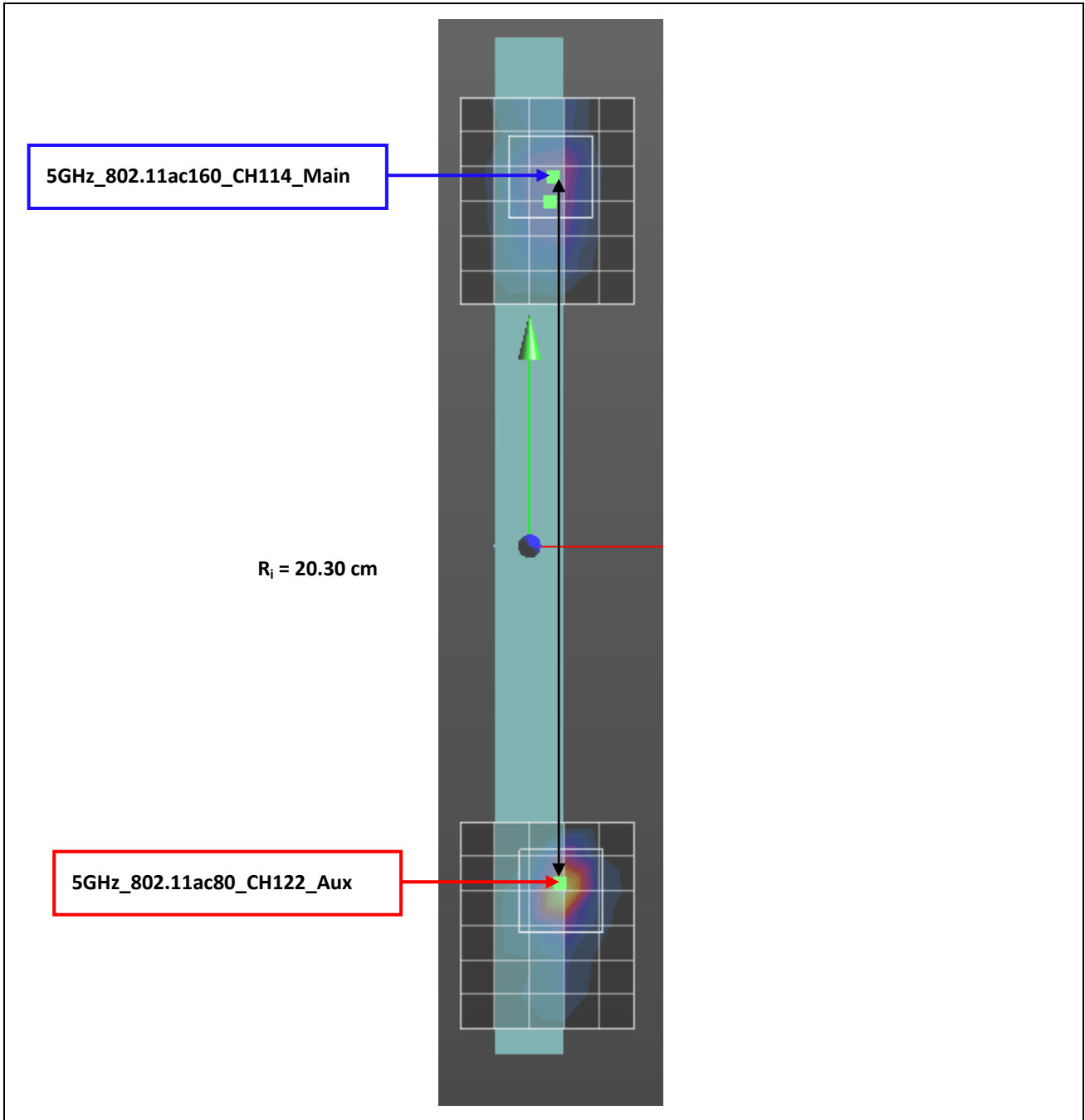

Mode	Peak SAR	X	Y	Z
	mW/g	m	m	m
5GHz_802.11ac160_CH114_Main	0.635	0.006	0.103	-0.176
5GHz_802.11ac80_CH122_Aux	1.036	0.009	-0.100	-0.176
Separation distance (cm)	20.30			
SPLSR	0.01			

Figure (5)

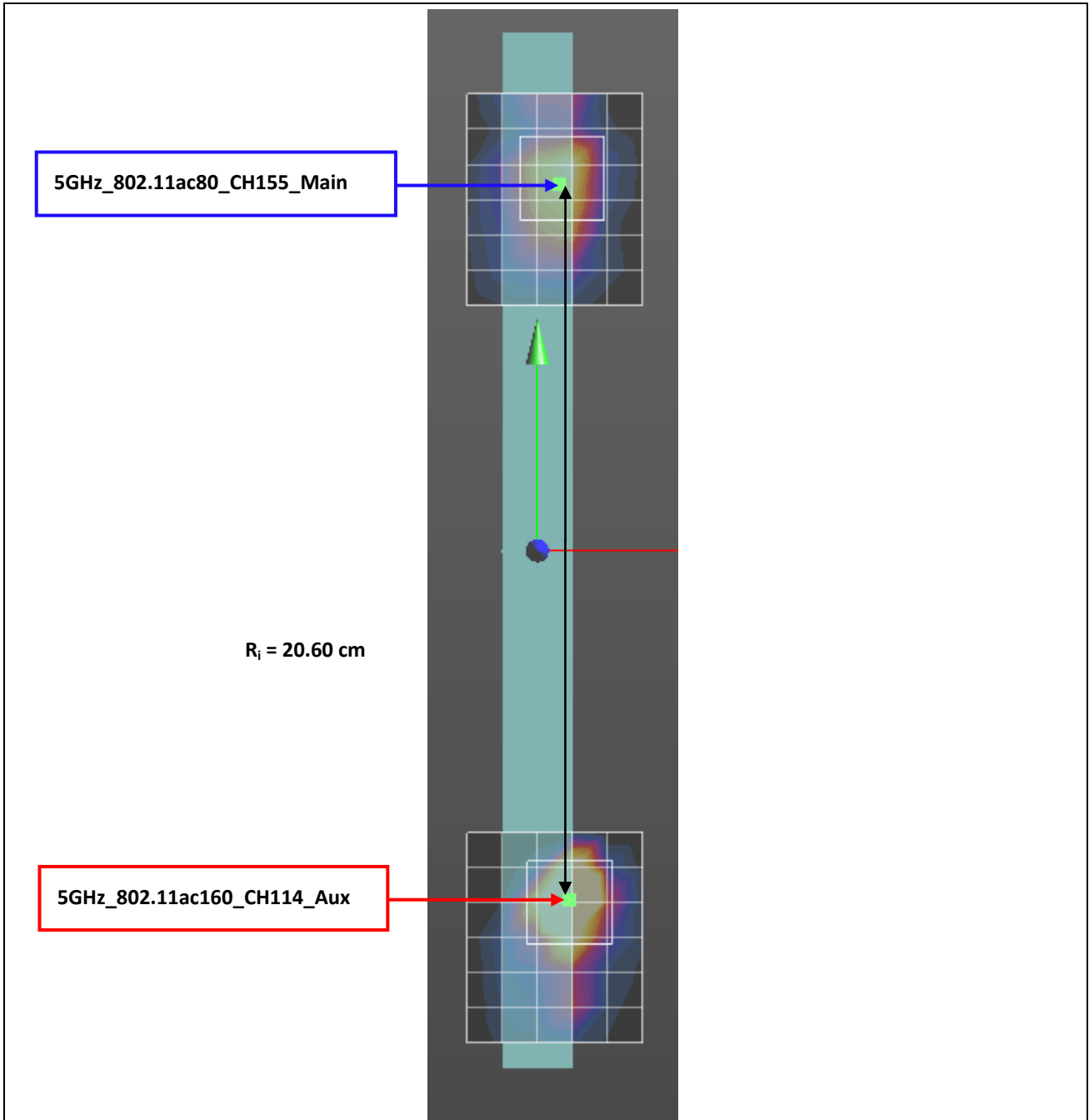

Mode	Peak SAR	X	Y	Z
	mW/g	m	m	m
5GHz_802.11ac80_CH155_Main	0.524	0.007	0.106	-0.176
5GHz_802.11ac160_CH114_Aux	1.085	0.009	-0.100	-0.176
Separation distance (cm)	20.60			
SPLSR	0.01			