



WARNING!



The use of this or any warning device does not insure that all drivers can or will observe or react to an emergency warning signal. Never take the right-of-way for granted. It is your responsibility to be sure you can proceed safely before entering an intersection, driving against traffic, responding at a high rate of speed, or walking on or around traffic lanes. The effectiveness of this warning device is highly dependent upon correct mounting and wiring. Read and follow the manufacturer's instructions before installing or using this device. The vehicle operator should insure daily that all features of the device operate correctly. In use, the vehicle operator should insure the projection of the warning signal is not blocked by vehicle components (i.e.: open trunks or compartment doors), people, vehicles, or other obstructions. This equipment is intended for use by authorized personnel only. It is the user's responsibility to understand and obey all laws regarding emergency warning devices. The user should check all applicable city, state and federal laws and regulations. Code 3, assumes no liability for any loss resulting from the use of this warning device.

Introduction

The NightProbe[®], NP 130, product is a remote control spotlight that delivers more signal power and versatility than any other spotlight product.

Its low profile aerodynamic lines reduce air drag, which results in fuel savings and stability at high speeds. This product is made of shock-resistant high-temperature engineering thermoplastics and provides a warning signal that exceeds SAE standards.

The NightProbe[®] and its mounting system is designed to operate in many different locations including on the driver side, passenger side or center of the automobile hood rear lip.

Unpacking & Pre-installation

Remove the spotlight from the box and examine the unit for transit damage. Refer to parts list to insure that all parts are present for installation.

Installation & Mounting

1. Attach suction cup to bottom of mounting bracket with the #10 self tapping screw, do not over tighten.
2. Route the cables from the bottom of the spotlight through the mounting bracket as shown in Figure 1.
3. Attach bracket to spotlight with four round hd phillips 6-20 x 3/8" SS as shown in Figure 1.
4. Choose a location where the spotlight is to be mounted.
5. Lay out the cable to insure that there is an adequate amount to reach the area in which the controller is to be mounted.
6. Fold wires into pocket of bracket in between the two mounting screws
7. Push bracket over lip of the hood and push down on suction cup
8. Tighten screws under hood until bracket is snug.

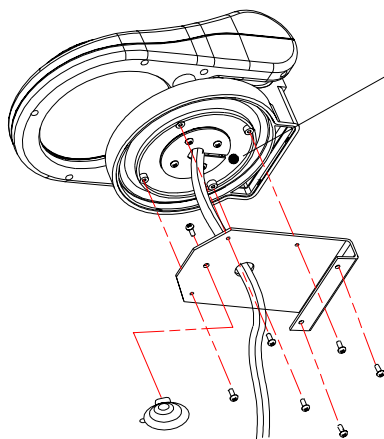

For proper bracket alignment make sure that the mark is to rear of NightProbe[®] as shown.

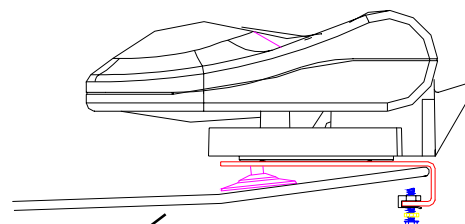

Vehicle

Figure 1