

Getting Started

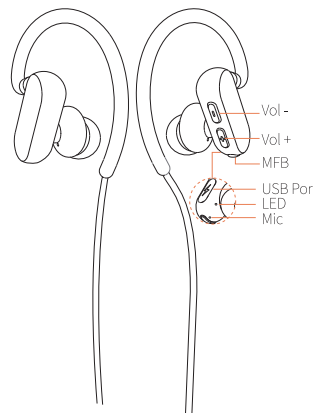

How to Connect

To activate pairing mode:
 1. OFF mode: Press and hold MFB to start pairing mode (LED blinks red and blue promptly)
 2. ON mode: press MFB twice to start pairing mode (LED blinks red and blue promptly)
 Once successfully paired, press the MFB once to automatically pair up again if Bluetooth gets disconnected through long distance.

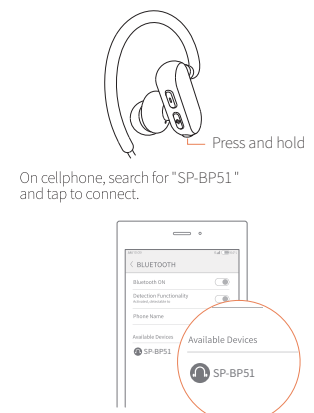

How to Charge

Low battery is indicated by red blinking LED and voice prompt. LED will be solid red when charging, and turn blue once fully charged.

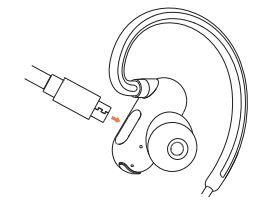

Default setting

Hold and press MFB until LED blinks red and blue when charging.

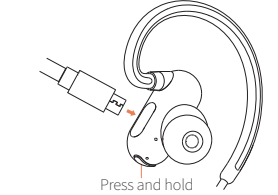

Functions

Answer Call
 Press MFB to answer incoming call(LED blinks blue promptly).

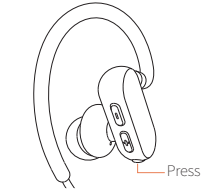

Ignore Call

Press and hold MFB for 1sec. to ignore incoming call(LED blinks blue promptly).

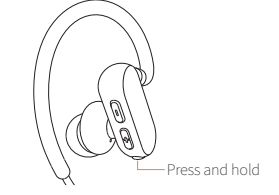

Last Number Redial

Double press MFB when standby
 Notes: last number dialing out may vary with different cellphones.

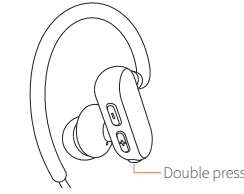

Mute on/off

Double press MFB to activate mute on/off when calling.

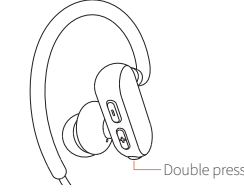

Skip Track

When playing music, Press and hold Vol+/- to skip track forward/backward.

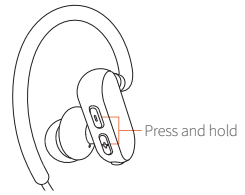

Volume Control

When playing music or calling, press Vol+/-.

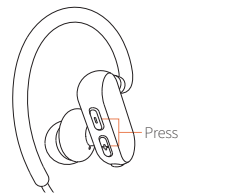

Play/Pause

When standby, press MFB to play/pause music

Voice Assistant
 Press and hold MFB for 1 sec. to activate Voice Assistant(like Siri)

Switch Audio Output Between Earphone and Cellphone
 Press MFB and hold for 1 sec when calling

Multi-point Connection

1. Please refer to "How to Connect" and pair it with phone1, then turn off the Bluetooth earphone.
2. Press and hold MFB until LED blinks red and blue. On phone2, search for SP-BP51 and press to connect.

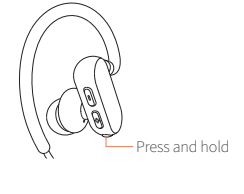

Three-Way Calling and Switch Between Two Calls

3. Back to phone1, search for SP-BP51 and press to reconfirm connection. Now you've finished Multi-point Connection.

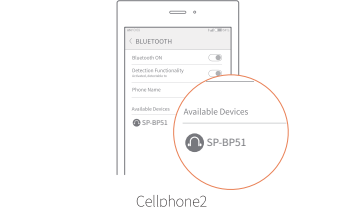

Three-Way Calling and Switch Between Two Calls

Press MFB to answer incoming call on phone1. Meanwhile, if there is another incoming call on phone2, press MFB to activate call on phone2 while putting the first call on hold. Double press MFB to switch between active and held calls.

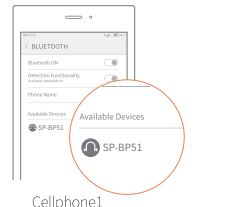

Functions

- Lightweight of 13g to deliver the comfortable wearing experience.
- Back-in-neck style to keep it secure and fit for sports and exercise.
- Ø10mm audible unit to provide better treble and bass boost.
- Built-in aptX helps to reproduce the sound quality in CD level.

Specifications

Model: Blast Plug BP51
 Music Time: approx. 6hr
 Bluetooth Version: V4.1
 Operation Range: 10m
 Bluetooth Profile: HFP/A2DP/HSP/AVRCP
 Weight: 13g
 Size: 33 X 49 X 27mm
 Charging Time: up to 2hr
 Standby Time: approx. 160hr
 Input Parameter: 5V 100mA
 Battery Capacity: 3.7V 90mAh
 Battery Type: Li-ion

Hazardous substances and their contents in the item

| Part Name | Hazardous Substances | | | | | |
|----------------|----------------------|------|------|----------|-------|--------|
| | (Pb) | (Hg) | (Cd) | (Cr(VI)) | (PBB) | (PBDE) |
| Main body | X | O | O | O | O | O |
| Battery | O | O | O | O | O | O |
| Ear tips | O | O | O | O | O | O |
| Accessories | O | O | O | O | O | O |
| Charging cable | X | O | O | O | O | O |

This form is made by SJ/T 11364 regulation. O means that hazardous substance content in the homogeneous materials of this part is within the limits of GB/T 26572 regulation. X: means that hazardous substance content in at least one certain homogeneous material of this part is beyond the limits of GB/T 26572 regulation.

For any after service, please contact:
 UStech@silicon-power.com



FCC Statement

This equipment has been tested and found to comply with the limits for a Class B digital device, pursuant to Part 15 of the FCC Rules. These limits are designed to provide reasonable protection against harmful interference in a residential installation. This equipment generates uses and can radiate radio frequency energy and, if not installed and used in accordance with the instructions, may cause harmful interference to radio communications. However, there is no guarantee that interference will not occur in a particular installation. If this equipment does cause harmful interference to radio or television reception, which can be determined by turning the equipment off and on, the user is encouraged to try to correct the interference by one or more of the following measures:
 - Reorient or relocate the receiving antenna.
 - Increase the separation between the equipment and receiver.
 - Connect the equipment into an outlet on a circuit different from that to which the receiver is connected.
 - Consult the dealer or an experienced radio/TV technician for help.

This device complies with part 15 of the FCC Rules. Operation is subject to the following two conditions:
 (1) This device may not cause harmful interference, and
 (2) this device must accept any interference received, including interference that may cause undesired operation.
 Changes or modifications not expressly approved by the party responsible for compliance could void the user's authority to operate the equipment.

Tips

1. Please read this manual carefully prior to using the device and keep the manual properly.
2. For first time use, please fully charge both cell phone and earphone. The LED will indicate a solid red if the earphone has low battery and cannot be powered on.
3. Please be sure that your Bluetooth earphone is in "pairing mode" if it cannot be spotted on your cell phone. The device will exit "pairing mode" if unpaired or unconnected for a long time. Then you may need to set it to "pairing mode" again. If any error occurs in cell phone or this device, please restart your cell phone or earphone, or reset earphone to its default setting.
4. Low battery is indicated by red blinking LED and voice prompt. LED will be solid red when charging, and turn blue once fully charged. The charging time is around 2 hours. Please note: Bad contact caused by improper operation or other reasons may switch off the LED light even when charging, which will result in incomplete charge. So please plug in the USB charger properly and keep the device stable while charging until it is fully charged.
5. This earphone cannot connect via Bluetooth while charging.

Warnings

1. Never disassemble or modify your Bluetooth earphones for any reasons to avoid any damage and danger.
2. Do not store the Bluetooth earphones in extreme temperatures (under 0°C or over 45°C).
3. Avoid using the indicator close to the eyes of children or animals.
4. Do not use this Bluetooth earphone during a thunderstorm to avoid irregular function and increased risk of electric shock.
5. Do not use harsh chemicals or strong detergents to clean the Bluetooth earphone.
6. Keep the Bluetooth earphone dry. Caution: Please arrange usage time properly, as long time use can damage hearing.
7. If the cap is not closed completely, the water resistant performance may deteriorate and cause a malfunction.