



AmazonBasics 5-Button  
2.4GHz Wireless  
Quiet Mouse - Black &  
AmazonBasics 5-Button  
2.4GHz Wireless  
Quiet Mouse with Water  
Transfer Printing - Black

Model: G6Y-B01 / G75 / B08P6P1CMD /  
G6Y-H01 / B08P6RG5CS

**PRODUCT GUIDE**

**FCC COMPLIANCE STATEMENT:**

This device complies with part 15 of the FCC Rules. Operation is subject to the following two conditions:  
(1) This device may not cause harmful interference, and  
(2) this device must accept any interference received, including interference that may cause undesired operation.

**Note:** This equipment has been tested and found to comply with the limits for a Class B digital device, pursuant to Part 15 of the FCC Rules. These limits are designed to provide reasonable protection against harmful interference in a residential installation. This equipment generates, uses and can radiate radio frequency energy and, if not installed and used in accordance with the instructions, may cause harmful interference to radio communications. However, there is no guarantee that interference will not occur in a particular installation. If this equipment does cause harmful interference to radio or television reception, which can be determined by turning the equipment off and on, the user is encouraged to try to correct the interference by one or more of the following measures: Reorient or relocate the receiving antenna. Increase the separation between the equipment and receiver. Connect the equipment into an outlet on a circuit different from that to which the receiver is connected.

Consult the dealer or an experienced radio/TV technician for help.

**Warning:** Changes or modifications to this unit not expressly approved by the part responsible for compliance could void the user's authority to operate the equipment.

**FCC Radiation Exposure Statement**

The product complies with the FCC portable RF exposure limit set forth for an uncontrolled environment and is safe for intended operation as described in this manual. The further RF exposure reduction can be achieved if the product can be kept as far as possible from the user's body or set the device to lower output power if such function is available.

**IC Notice:**

This device complies with Canada Industry licence-exempt RSS standard(s). Operation is subject to the following two conditions:

- (1) this device may not cause interference, and
  - (2) this device must accept any interference, including interference that may cause undesired operation of the device.
- CAN ICES-3 (B)

Le présent appareil est conforme aux CNR d'Industrie Canada applicables aux appareils radio exempts de licence. L'exploitation est autorisée aux deux conditions suivantes :

- (1) l'appareil ne doit pas produire de brouillage; (2) l'utilisateur de l'appareil doit accepter tout brouillage radioélectrique subi, même si le brouillage est susceptible d'en compromettre le fonctionnement.
- NMB-3 (B)

**Functional Introduction**

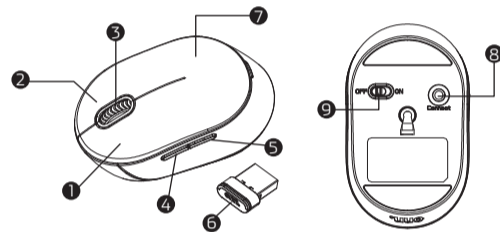

- |                    |                  |                   |
|--------------------|------------------|-------------------|
| 1. Left button     | 4. Forward       | 7. Battery cover  |
| 2. Right button    | 5. Backward      | 8. Connect button |
| 3. Scrolling wheel | 6. Nano receiver | 9. OFF/ON switch  |

**Forward**  
Press this button to view the next page in your Internet browser.

**Backward**  
Press this button to view the previous page in your Internet browser.

**Technical Data**

- Operation voltage 3V
- Operating Systems: Microsoft Windows 7/8/10, Mac OS 10.5 or newer version
- 1600 DPI sensitivity
- 5 Clickable buttons
- USB plug and play
- Working distance : 8~10 meter in open space
- Battery life :4 month (Battery life may vary depending on user and computing conditions) To prolong battery life, turn off when not in use.

**Installing the batteries**

Insert the battery with the correct position according to the instruction labeled on the mouse.

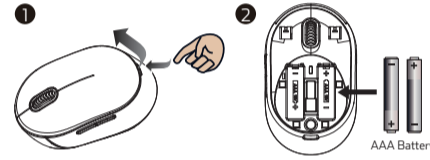

**Instruction**

Plug Nano receiver into USB port on your computer

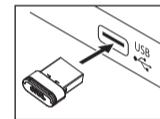

**Help with set up**

- When not working, pair mouse and receiver
1. Re-plug receiver into USB port on computer
  2. Press the connect button on mouse (Keep mouse close to receiver)
  3. If it does not work after 10 seconds, repeat steps 1 and 2



- Red LED is on for 10 Sec. Power On
- Red LED Blinking for 10 Sec. Low Battery Warning
- Red LED Blinking Pairing (LED OFF when paired or failed after 10 sec.)