

折線

折線

折線

折線

折線

onn.™

Wireless Ergonomic Mouse

Model: 100122465

PRODUCT GUIDE

October 01, 2022\_V1

**Federal Communication Commission Interference Statement**

This equipment has been tested and found to comply with the limits for a Class B digital device, pursuant to Part 15 of the FCC Rules. These limits are designed to provide reasonable protection against harmful interference in a residential installation. This equipment generates, uses and can radiate radio frequency energy and, if not installed and used in accordance with the instructions, may cause harmful interference to radio communications. However, there is no guarantee that interference will not occur in a particular installation. If this equipment does cause harmful interference to radio or television reception, which can be determined by turning the equipment off and on, the user is encouraged to try to correct the interference by one of the following measures:

- Reorient or relocate the receiving antenna.
- Increase the separation between the equipment and receiver.
- Connect the equipment into an outlet on a circuit different from that to which the receiver is connected.
- Consult the dealer or an experienced radio/TV technician for help.

This device complies with the FCC portable RF exposure limit set forth for an uncontrolled environment and are safe for intended operation as described in this manual. The further RF exposure reduction can be achieved if the product can be kept as far as possible from the user body or set the device to lower output power if such function is available.

**Radiation Exposure Statement:**  
The product complies with the FCC portable RF exposure limit set forth for an uncontrolled environment and are safe for intended operation as described in this manual. The further RF exposure reduction can be achieved if the product can be kept as far as possible from the user body or set the device to lower output power if such function is available.

FCC Caution: Any changes or modifications not expressly approved by the party responsible for compliance could void the user's authority to operate this equipment.

Walmart Inc.,  
Bentonville, AR 72716

**Before Use**

**Notes:**  
All parts have to be unpacked and the packaging material has to be removed completely. Before use, verify the package contents are complete and undamaged.

**BATTERY WARNING STATEMENT**

Do not mix old and new batteries.  
Do not mix alkaline, standard (carbon-zinc), or rechargeable (ni-cad, ni-mh, etc.) batteries.

**System Requirements**

- \* Windows® 7/8/10/11 or later, macOS® 10.5 or later, Android™ Chrome OS™
- \* Available USB port or Bluetooth® on your laptop or computer

**What's in the Box**

- 1 Wireless Mouse
- 1 USB nano receiver
- 1 AA battery

**Specification**

- 5 clickable buttons, scroll wheel, on/off switch and connection switch
- 5 adjustable DPI sensitivity levels: 600/1000/1600/2400/3600 DPI
- Connect to up to 3 devices simultaneously with Bluetooth® wireless technology or a USB nano receiver
- 2 Bluetooth® wireless connection channels
- 2.4GHz USB nano receiver (stores in battery compartment when not in use)
- USB plug and play
- Windows, MacOS, ChromeOS, Android, iOS compatible
- 4.85 in L x 3.14 in W x 1.74 in H (12.3 cm x 8 cm x 4.4 cm)

1

**Features**

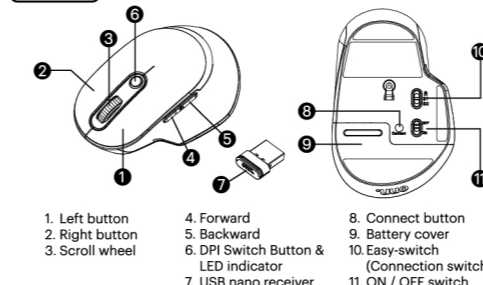

**Forward**  
Press this button to view the next page in your Internet browser

**Backward**  
Press this button to view the previous page in your Internet browser

**DPI Switch Key**

a) 5 adjustable sensitivity levels

DPI
600 dpi
1000 dpi
1600 dpi
2400 dpi
3600 dpi

b) Default is 1600 DPI

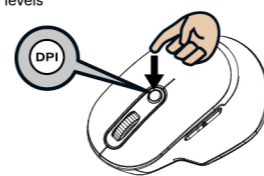

2

**Switch Connection Channel**

This mouse can connect up to 3 different devices. Use "Easy-switch" to change connection channels between USB nano receiver and 2 other Bluetooth channels.

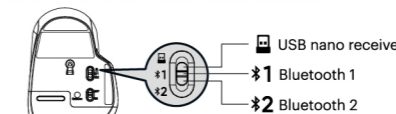

**Switch between different devices**

For example, you can set USB nano receiver (🔌) on laptop A Bluetooth (1) on desktop B Bluetooth (2) on tablet C then use "Easy-switch" to switch connection between these 3 computers.

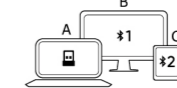

**Connect button**

Press and hold this button to set the mouse in Bluetooth pairing mode or to reconnect to a paired device.

**Installing Battery**

Insert the battery with the correct position according to the instructions labeled on the mouse.

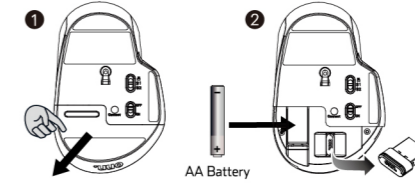

3

Need help?  
We're here for you every day from 7 a.m. – 9 p.m. CST.  
Give us a call at 1-888-516-2630



We'd love to hear from you. Scan with your smartphone camera and let us know what you think.

正面

反面

**Connection Setup**

**Connect via USB nano receiver**

This is plug and play with USB nano receiver. Make sure to turn on power and set connection channel to USB nano receiver (🔌). Plug USB nano receiver into an available USB A port on your computer and start surfing onn.

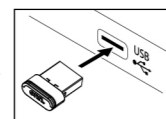

**Connect via Bluetooth in Windows**

Turn on the mouse and setting it on either Bluetooth (1) or Bluetooth (2). Click on "Start" (bottom left corner on your screen). Go to Settings

-> Device -> Bluetooth & other devices -> Turn on Bluetooth

-> Add Bluetooth or other device -> Add a device (Bluetooth)

**Press and HOLD** "Connect" button to set mouse in pairing mode (LED will start flashing) Click on "onn.BTMouse" in the list on your computer to setup pairing. LED will stop flashing and light up for 3 seconds when the pairing is completed.

Note: After successful pairing, the mouse name shown on your computer will become "onn. Wireless Ergonomic Mouse".

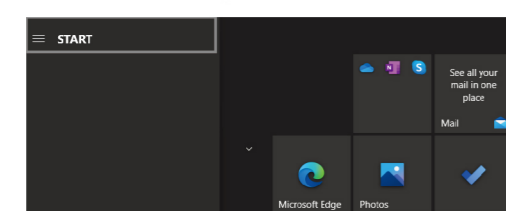

4

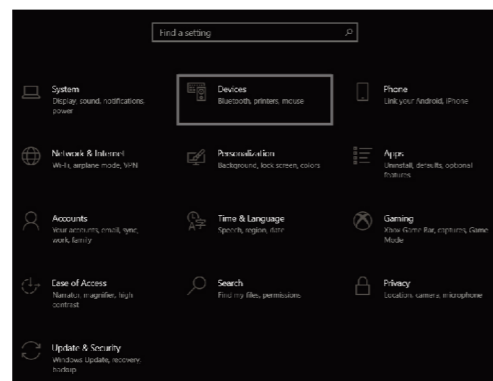
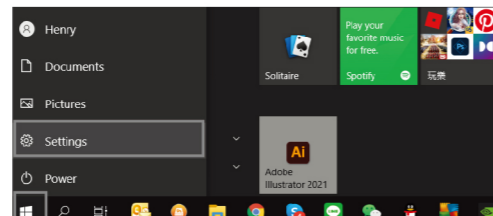

5

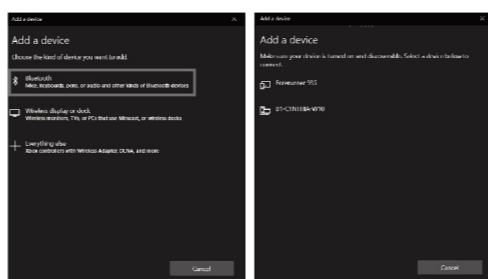
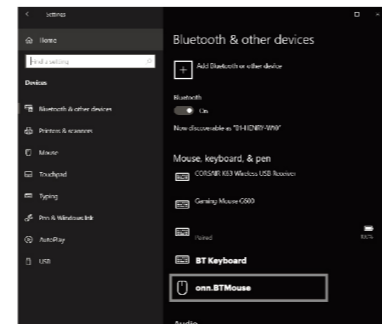

6

**Connect via Bluetooth in Mac**

Turn on the mouse and setting it on either Bluetooth (1) or Bluetooth (2). Click on "Apple menu" (top left corner of your screen). Go to System Preferences

-> Bluetooth

-> Turn Bluetooth on to set up Bluetooth device

Follow same steps as **Connect via Bluetooth in Windows** to set mouse in pairing mode and complete Bluetooth pairing.

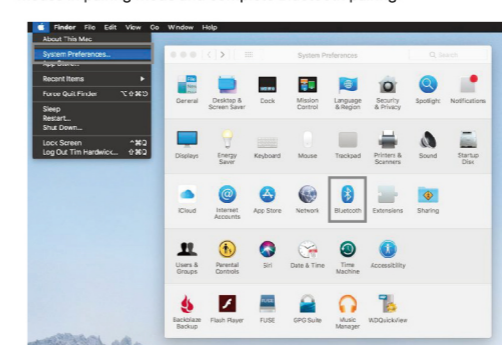

7

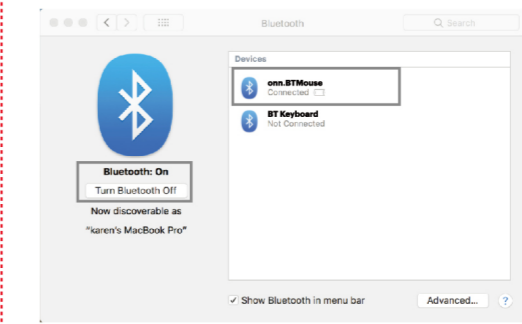

**Low Battery**

If this LED starts blinking, you need to change battery.



**Help with Setup**

**USB nano receiver**

- Mouse is not working?
1. Is the mouse powered on? Make sure channel is set to (🔌).
  2. Is the USB nano receiver securely plugged into a USB port? Try changing USB ports.

8

3. If the USB nano receiver is plugged into a USB hub, try plugging it directly into a USB port on your computer.
4. Check the orientation of the battery inside the mouse.
5. Try a different surface. Remove metallic objects between the mouse and the USB nano receiver.

If it is still not working, try steps below to re-pair mouse and receiver.

- A. Re-plug USB nano receiver into USB port on computer, make sure channel is set to (🔌).
- B. Press the connect button on mouse (keep mouse close to receiver).
- C. If it does not work after 10 seconds, repeat steps A and B.



**Bluetooth®**

- Is the mouse powered on?
1. Is the mouse powered on? Make sure channel is set to (1) or (2). Make sure to turn on Bluetooth function on your computer.
  2. Check the orientation of the battery inside the mouse.
  3. Try a different surface. Remove metallic objects between the mouse and the computer.
  4. Set mouse in pairing mode. Make sure it is discoverable on your computer and then complete pairing.
  5. If it does not work after 10 seconds, repeat step 1 to 3.

**Reconnection**

Under Bluetooth connection (either Bluetooth 1 or 2) mouse can automatically reconnect to its last connected computer. If it fails, you can always re-pair again.

**Note**

The primary use case of the mouse is for computers, (desktop, laptop and tablet computers), connecting to a smartphone is not recommended.

9

折線

折線

折線

折線

折線

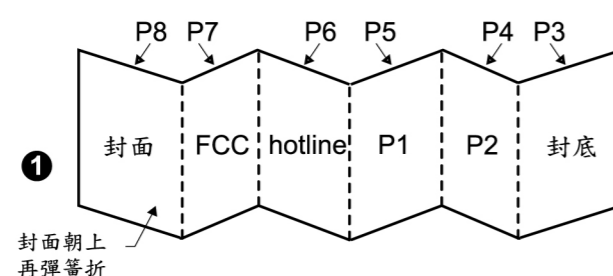

封面朝上  
再彈簧折



說明書折合完成  
封面朝前折合後

**Project Name: 100122465(B2J-2.4G-BT Wireless Ergonomic Mouse) Walmart USA-onn Manual(QR code)-BK\_Outline\_20221109.ai**

**REV. A** 印刷順序：印單色，\*雙面印刷再彈簧折

**DATE: 2022.11.09** 紙質：雙交紙，60磅

比例1:1  
—— 裁切線  
- - - - 折線

尺寸：  
未折合前-寬445.5 mm x 長105mm  
折合後-寬37.125mm x 長52.5mm

PROCESS COLORS  
K

簽核： 製作者：Megan