

3-in-1 Professional Presenter Mouse

OWNER'S GUIDE

Ver.1.0



Please **DO NOT** direct the laser beam at anyone's eye.

CAUTION: To use this product properly, please read the user's guide before installation

Federal Communications Commission (FCC) Notice

This device complies with Part 15 of the FCC rules. Operation is subject to the following two conditions

- (1) This device may not cause harmful interference, and
- (2) This device must accept any interference received, including interference that may cause undesired operation.

This equipment has been tested and found to comply with the limits of a Class B digital device, pursuant to Part 15 of the FCC Rules. These limits are designed to provide reasonable protection against harmful interference in a residential installation. This equipment generates, uses and can radiate radio frequency energy and, if not installed and used in accordance with the instructions, may cause harmful interference to radio communications. However, there is no guarantee that interference will not occur in particular installations. If this equipment does cause harmful interference to radio or television reception, which can be determined by turning the equipment off and on, the user is encouraged to try to correct the interference by one or more of the following measures :

1. Reorient / Relocate the receiving antenna.
2. Increase the distance between the mouse and receiver.
3. Connect the equipment into an outlet on a circuit different from that the receiver is connected.
4. Consult the dealer or an experienced radio /TV technician for help

CAUTION:

Change or modifications not expressly approved by the manufacturer responsible for compliance could void the user's authority to operate the equipment

Welcome

Thank you for choosing 3-in-1 Professional Presenter Mouse. This device can offer 3-in-1 solution including a RF laser presenter, a handy trackball and a cordless laser mouse. It gives you remote control of your onscreen presentation with up to a range of 10 meters. Never worry about dead batteries with a rechargeable cradle. It's an ideal solution for making wireless presentations in professionalizing!

Package Contents

- Presenter Mouse
- Rapid Charge Base Station
- Two AA Rechargeable Batteries
- User's Guide

Minimum System Requirements

- IBM or PC Compatible
- Windows 98, 2000, ME, XP

Functional Introduction

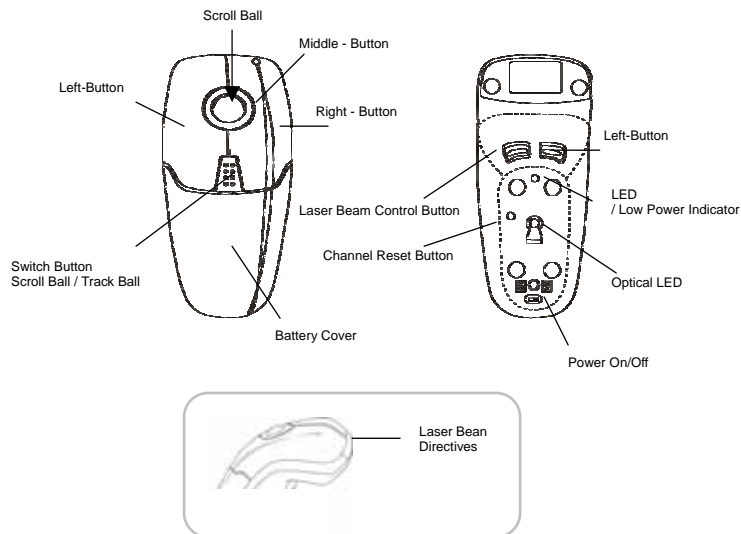

Receiver

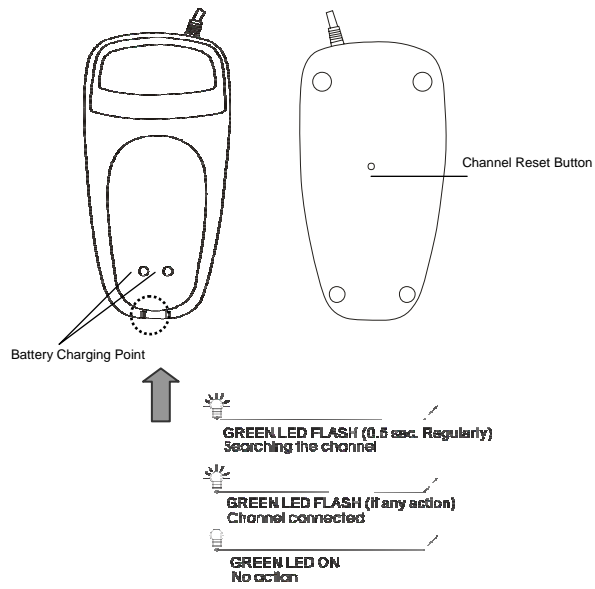

Hardware Installation

Installing the Batteries

Open the batter cover and insert the 2 *AA batteries following the polarity instructions as shown in the battery chamber.

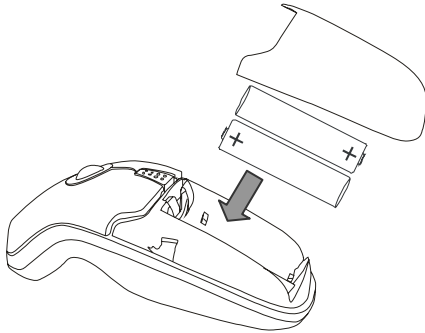

Installing the Charger and the Receiver

The receiver (charger) is connected to your computer via a cable. It needs to plug into your computer by a USB port or a mouse port.

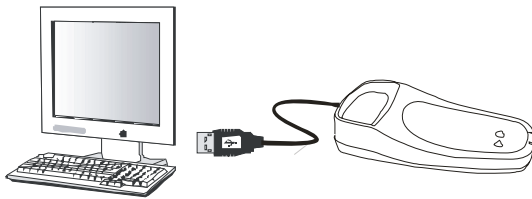

Connect to the USB or Mouse port of your computer

For USB port installation

Windows 98 (or higher) is required for USB port on the computer. For Windows, you may be the driver's CD into the computer's CD-ROM driver



installation. Connect the receiver cable to the USB port. When prompted to insert the Windows software CD, insert when asked to do so. Follow the instructions steps.

This RF Presenter Mouse is a plug-and-play device. Normally, it's not necessary to setup the RF Channel. But if some interference happens, then you must setup the connection RF Channel.

Setup the connection RF Channel between the Mouse and the Receiver

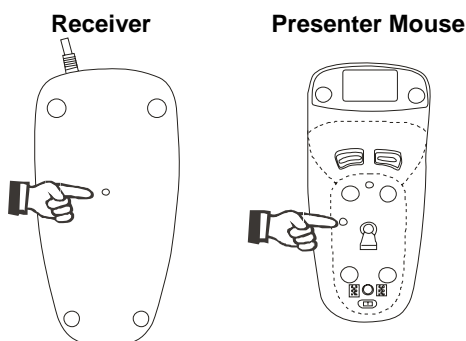

Push the channel reset button on the mouse. Push the channel reset button on the receiver. If the cursor does not move after 30 seconds, please do the steps above.

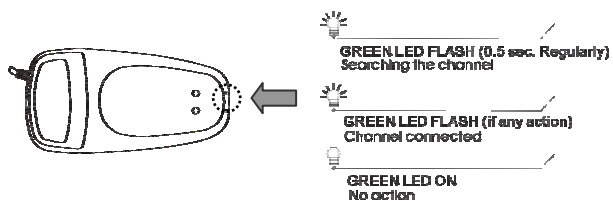

Using the Presenter Mouse

Laser Pointer

Press/Not Press the Laser Bean Control Button to control Laser Bean On/Off. The operation range is up to 10 meters.

How to use the 8D Scroll Ball

You can control the Windows Scroll Bar horizontally and vertically through scroll the roll the Scroll Ball toward the direction you want directly. And simply click (press down) the Scroll Ball like you would wish a standard mouse button. There is no need to move your mouse. It is especially convenient for making presentation or viewing websites. In order to use this function properly, please make sure your presenter mouse is on 8D Scroll Ball mode. The operation range is up to 5 meters.

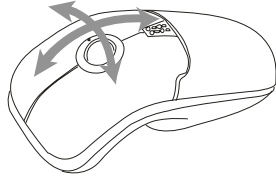

To Scroll, you can scroll the scroll ball
toward the direction you want directly

To use the scroll ball like a standard mouse
Button, click (press down) the ball.

Switching between 8D Scroll Ball and Track Ball

You can switch the Scroll Ball to Track Ball via Switch Button. Please click the Switch Button to switch between 8D Scroll Ball and Track Ball. When your presenter mouse is on the Track Ball mode, the Optical LED is on. It can help you to quickly check what mode of your presenter mouse is on.

Recharging

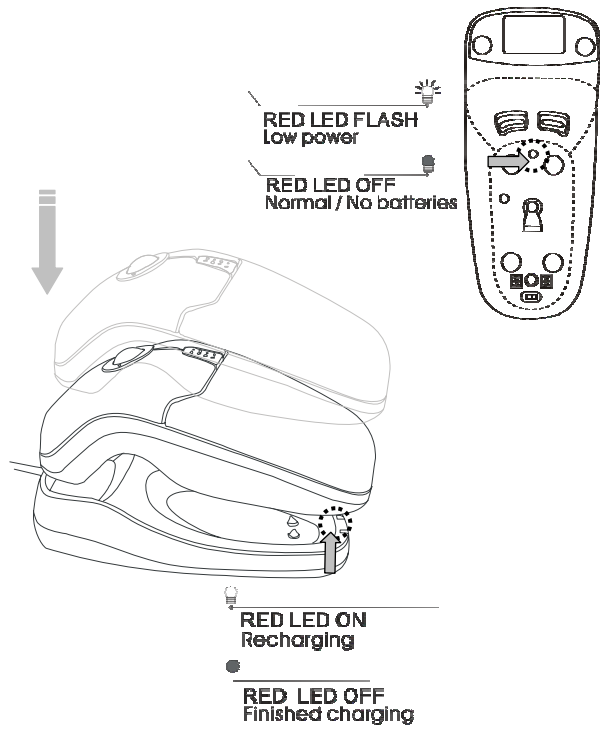

Troubleshooting

A. Presenter Mouse does not work upon installation.

Try one or more of the following:

- For optimal performance, place adjust the angle of the receiver to find the best performance.
- Make sure you have installed the batteries correctly.
- Press the "Channel Reset" button on the receiver, and then press the "Channel Reset" button on the mouse.
- Make sure you have installed the Driver correctly.
- Make sure the receiver cable is plugged in the right mouse port or USB port.
- Unplug the receiver and then plug in the receiver again. Make sure that it had been detected by the Operating Systems properly.
- Make sure your mouse port has the proper configuration. Refer to your computer documentation for the correct port configuration.

B. Presenter Mouse not detected.

When using the mouse, it may not be detected by the computer or receiver. To remedy this problem, try the following

- Make sure the receiver is plugged in the right mouse port or USB port.
- Make sure your mouse port has the proper configuration. Refer to your computer documentation for the correct port configuration.
- You may re-setup the connection RF Channel between the Mouse and the Receiver (Please refer the procedure on Page 7), especially, when you have been changed or recharged your batteries.

C. The Screen Cursors Does Not Move Properly.

- Change the angle of your radio receiver. Try adjusting the receiver and/or mouse to improve reception.
- Make sure that the battery low indicator is NOT lit on. Replace batteries if the low battery indicator is lit on.
- You may also need to change the RF Channel for the mouse, Press the "Channel Reset" button on the receiver, then press the "Channel Reset" button on the mouse.