

Wireless Multimedia Keyboard & Mouse w/Nano Receiver

USER'S GUIDE

Ver.:1.00

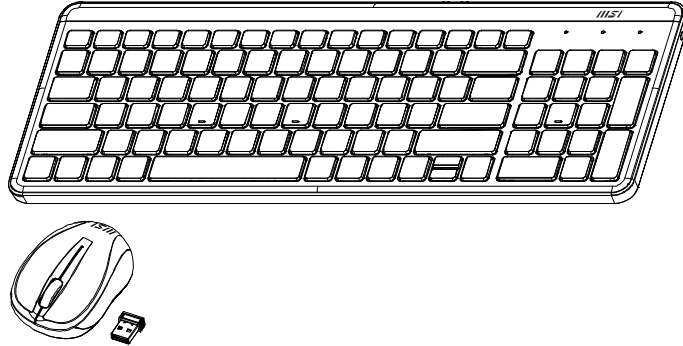

CAUTION: To use this product properly, please read the user's guide before installation

Federal Communication Commission Interference Statement

This equipment has been tested and found to comply with the limits for a Class B digital device, pursuant to Part 15 of the FCC Rules. These limits are designed to provide reasonable protection against harmful interference in a residential installation. This equipment generates, uses and can radiate radio frequency energy and, if not installed and used in accordance with the instructions, may cause harmful interference to radio communications. However, there is no guarantee that interference will not occur in a particular installation. If this equipment does cause harmful interference to radio or television reception, which can be determined by turning the equipment off and on, the user is encouraged to try to correct the interference by one of the following measures:

- Reorient or relocate the receiving antenna.
- Increase the separation between the equipment and receiver.
- Connect the equipment into an outlet on a circuit different from that to which the receiver is connected.
- Consult the dealer or an experienced radio/TV technician for help.

FCC Caution: Any changes or modifications not expressly approved by the party responsible for compliance could void the user's authority to operate this equipment.

This device complies with Part 15 of the FCC Rules. Operation is subject to the following two conditions: (1) This device may not cause harmful interference, and (2) this device must accept any interference received, including interference that may cause undesired operation.

Radiation Exposure Statement:

The product comply with the FCC portable RF exposure limit set forth for an uncontrolled environment and are safe for intended operation as described in this manual. The further RF exposure reduction can be achieved if the product can be kept as far as possible from the user body or set the device to lower output power if such function is available.

Functional Introduction

Mouse Buttons

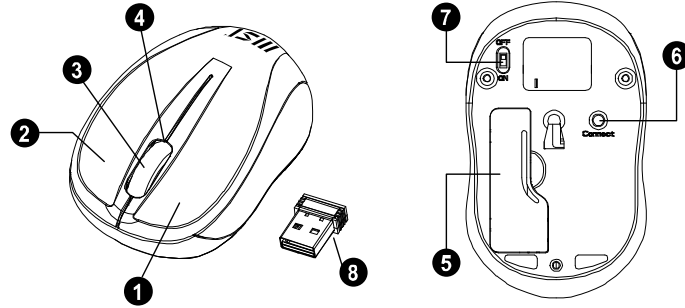

1. Left Button

2. Right Button

3. Scrolling Wheel

4. LED Indicator

5. Battery Cover

6. Connect Button







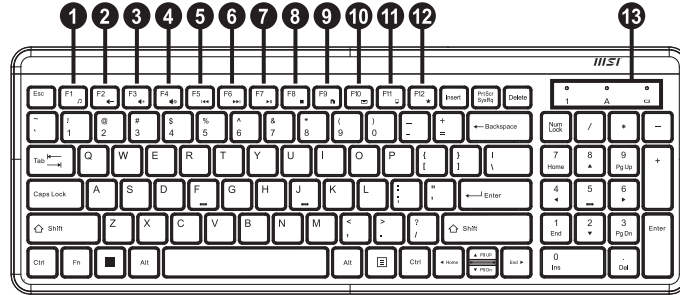

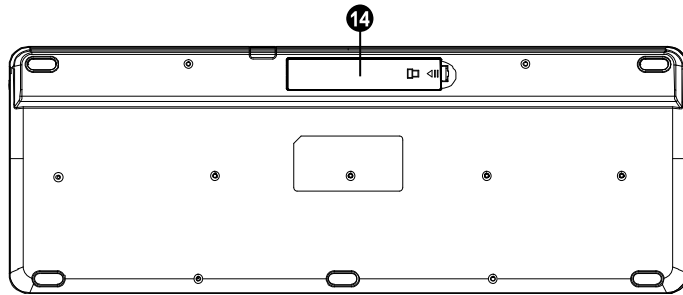



7. ON/OFF Switch

8. Nano Receiver





Keyboard Buttons





Key Function (* compound key, Press with Fn key)			
1.		Media Player On	Turn on the Media player program
2.		Volume down (Voice-)	Decrease the computer's sound volume.
3.		Volume up (Voice+)	Increase the computer's sound volume.
4.		Mute	Mute (turns off) the computer's sound
5.		Previous	Switch to the previous media track
6.		Next	Switch to the next media track
7.		Play/Pause	Switch between playing and pausing media
8.		Stop(Media)	Stop playing the media in the media player
9.		Homepage(www/e)	Start the default Web browser and loads the home Web page
10.		Outlook(E-mail)→Default	Start the default e-mail program
11.		My Computer	Open My Computer/This PC folder.
12.		My Favorites	Open My Favorites folder within Internet browser application

13.	1	Number Lock Indicator
	A	Caps Lock Indicator
		Low Battery & Pairing Indicator
14.	Battery Cover	

Fn + 	HOME
Fn + 	END
Fn + 	Pg UP
Fn + 	Pg DN

Installing the batteries

Step 1: Take the battery cover off.

Step 2: Insert the battery as shown inside the battery compartment.

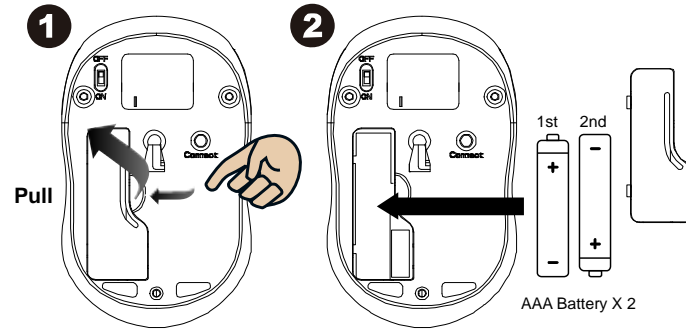

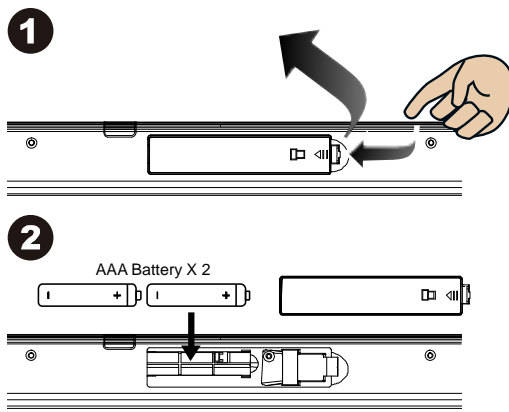

Step 3: Replace the cover.

Step 4: Turn on power switch.

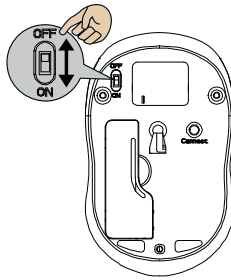

****Warning:**

*Please insert the battery with the correct position according to the instruction labeled on the mouse & Keyboard.

Setup the Connection between the Receiver and the Mouse & Keyboard

1. Remove the cover under the mouse & keyboard to access the battery and nano receiver compartment.
2. Insert batteries into the mouse & keyboard, and remove the nano receiver from the compartment. Place the covers back onto the devices.

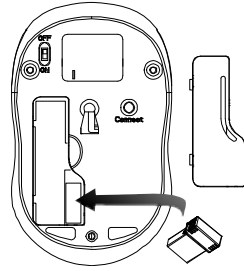

3. Plug the nano receiver into a USB port on your computer.

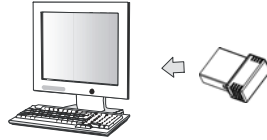

4. If the device does not work, please turn it into pairing mode.
5. Pairing: Re-plug the receiver into the USB port on your computer, then press connect button of the mouse, and press they key combination "ESC + K " on the keyboard. If the mouse or keyboard does not work

after 10 seconds, pair them again.
(The receiver has auto pairing functionality).

6. The LED indicator on the mouse & Keyboard flashes steadily when it is in pairing mode and stops blinking when it is successfully paired with the receiver.

7. When the device has low battery, the battery indicator on the keyboard or the mouse will start to blink.

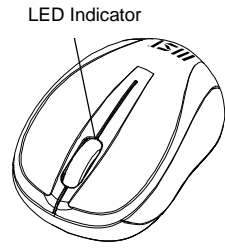

***Mouse Indicator**

- LED is on for 10 sec. Power ON
- LED Blinking During Pairing (LED OFF when paired or failed after 10 sec.)
- LED Blinks for 10 sec. Low Battery Warning

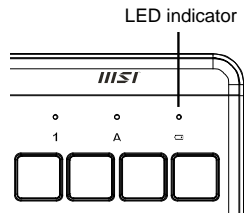

***Keyboard Indicator**

- LED is on for 10 sec. Power ON
- LED Blinking During Pairing (LED OFF when paired or failed after 10 sec.)
- LED Blinks for 10 sec. Low Battery Warning