

chapter 2:Production Introduction

Front Panel Function Header

The mainboard PANEL header has a standard set of switch and indicator connectors that are commonly found on ATX system cases. Use the illustration below to make the correct connections to the case switches and indicators. Front Panel Function Header include connections the following features:

Function	Connector Pin-Out Label
System Reset	RESET
Power LED	PW-LED
Hard Drive Activity LED	HD-LED
Soft-Touch Button Power On/Off	PW-BN
External Speaker	Speaker

A845E Front Panel:

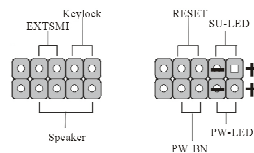

A845DD/A845SD/P845SD Front Panel:

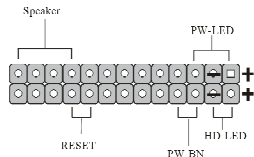

P845GL/P845GLP Front Panel:

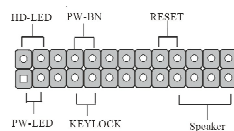

Audio Front Panel Header

It provides the earphone output and microphone input in the Front panel of computer box.

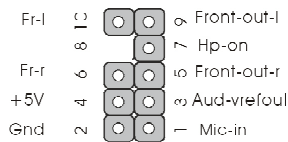

chapter 2:Product Introduction

The header pin-out is as follows

Pin	Signal Name
1	mic-in
2	Gnd
3	Audio Vref-out
4	+5V
5	right channel output
6	right channel return
7	Hp-on
9	left channel output
10	left channel return

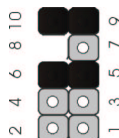

Please add two jumper in 5-6 & 9-10 according to the picture when you don't need install Front Audio panel.

CPU&System FAN

Mainboard supply three FAN header with measure FAN speed function, which can be watched in BIOS.

Caution • Assure CPU FAN run in work state, or CPU will damage for overheat.

CNR(Communication Audio Modem Riser)

Support the CNR card with Audio/Modem/Lan function.

Only for A845E / A845DD / A845SD / P845SD

CD Audio connector

It's connected to CD-ROM by a CD cable.

AUX-IN Audio header

It receive audio output from CD-ROM, TV or MPEG card.

chapter 3:Setup Quickly

Before you use this M/B,Please check chapter follow as below!

3.1 How to identify then product's mode?

There is a bar-code that had adhibited on our product's box and mainboard.The bar-code follow as below(include serial number, production date ,classific -code,product's name and model).

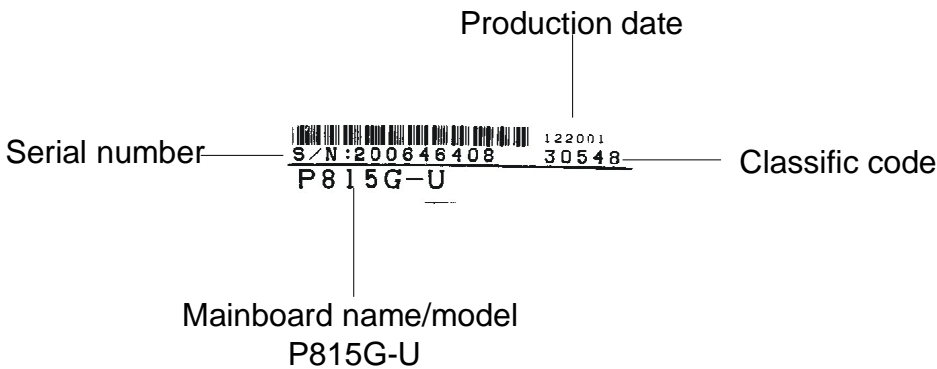

Setup Quickly

chapter 3:Setup Quickly

3.2 Set the jumper

A845E } A845DD } A845SD jumper setting

Notice: You must turn off the power of computer before you set the jumper or install hardware.

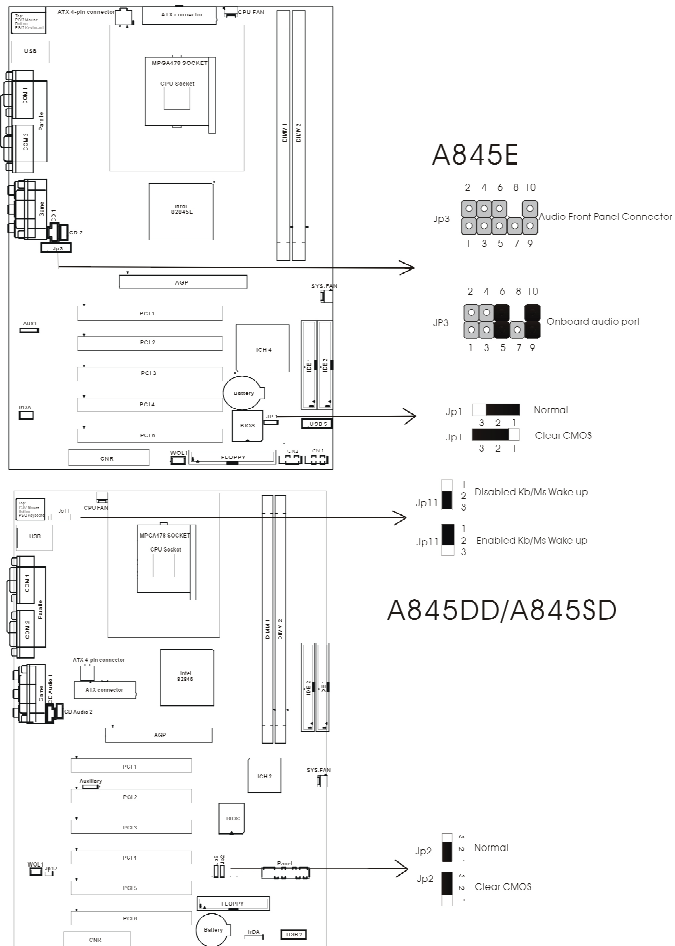

chapter 3: Setup Quickly

P845SD } P845GL } P845GLP jumper setting

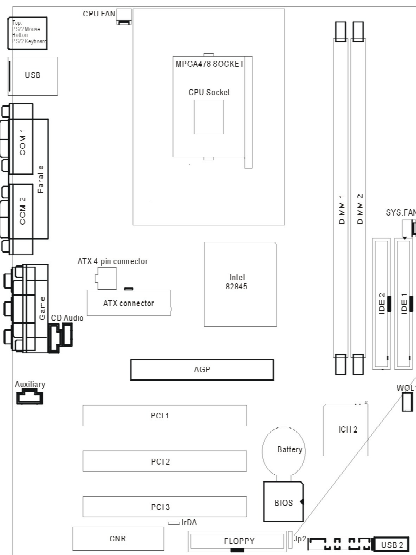

P845SD

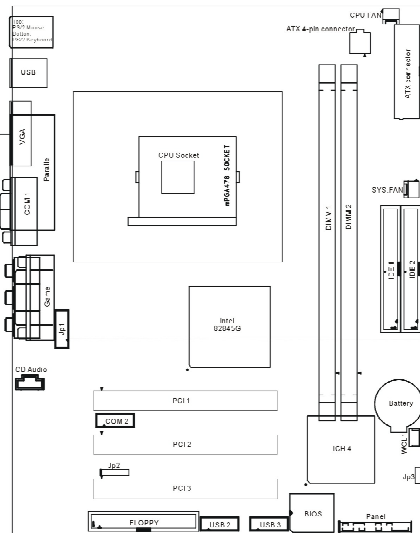
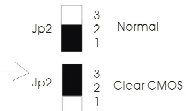

P845GL/P845GLP

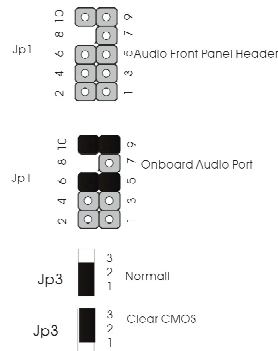

Setup Quickly

chapter 3:Setup Quickly

3.3 How to setup BIOS quickly?

- 1.Press "DEL" key inter BIOS setup when boot-start.
- 2.Select "Load Optimized Defaults", press "Y",then "enter".
- 3.Enter "Advanced BIOS Feature""First Boot Device" to setup start-up order.
- 4.Enter "Save&Exit Setup",select "Y",then reboot.



3.4 How to install mainboard driver ↘

Our driver CD supports Windows 98/98SE/ME/NT4.0/2000/XP OS.It's support Autoseup and Manualsetup model.

A:Place the driver CD in your CD-ROM when you have installed the OS.
And the CD will load device information ,the opening screen of CD appears.



chapter 3:Setup Quickly

After a while, appear following menu. (According to different mainboard, the menu is different) etc: M/B: P845GL, with onboard sound (CMI9738, Four channel Audio).

Click highlight item and complete the driver install with the prompt



Notice: If window appear introduction "You need not install this drive in Winxx" that means the OS has included the device driver and you don't need to install it.

B: When you need to Manualsetup, please follow the list:

First: You need to select the type of M/B which you purchased. We provide 3 types in our CD: ATX, MICRO-ATX, BABY-AT

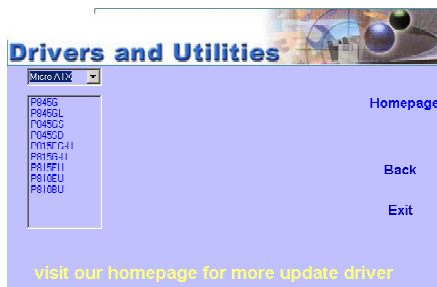

Setup Quickly