

# chapter 2:Product Introduction

## P845GL mainboard

- \* Support Intel 478pin Pentium4 FC-PGA2 (Willamette/Northwood)
- \* Support 400MHz Bus
- \* Intel 845GL + ICH4 Chipset
- \* Two DIMM slots support up to 2G Memory Capacity
- \* Support PC1600 and PC2100 DDR DIMM(DDR200/DDR266)
- \* Jumperless for CPU Frequency setting
- \* 3x PCI slots
- \* 6x USB2.0 ports (4xUSB2.0 in the Front panel,2xUSB2.0 in the rear panel) , 1x IrDA port header
- \* 1 x FDD port, 1 x Parallel port with ESD/EMI protection, 2 x COM ports
- \* Dual IDE Channels support Four Ultra-DMA33/66/100 IDE Devices
- \* WAKEUP-LINK Header to Support Wake-On-LAN
- \* Integrated 2D&3D Graphic Accelerate Port
- \* Integrated AC97 Audio Onboard(Select 2ch,4ch,5.1ch)(optional)
- \* AC97 2.1(or AC97 2.2) Compliant Codec with 3D Stereo Enhancement
- \* 1 xSpeaker(Front speaker), 1 x Mic-in(Center and Sub-woofer), 1 x Line-in(Rear-speaker)
- \* 1 x CD-in, 1 x Game Port
- \* 1xstandard Audio Front Panel Header
- \* Overcurrent protection over Keyboard & Mouse
- \* Coloured Connectors : FDD, IDE, COMs etc.
- \* Phoenix BIOS PC99/ACPI/DMI Compliant
- \* ATX Power Supply Interface
- \* Micro ATX form factor 245mm x 190mm

# chapter 2:Product Introduction

## P845GL mainboard diagram

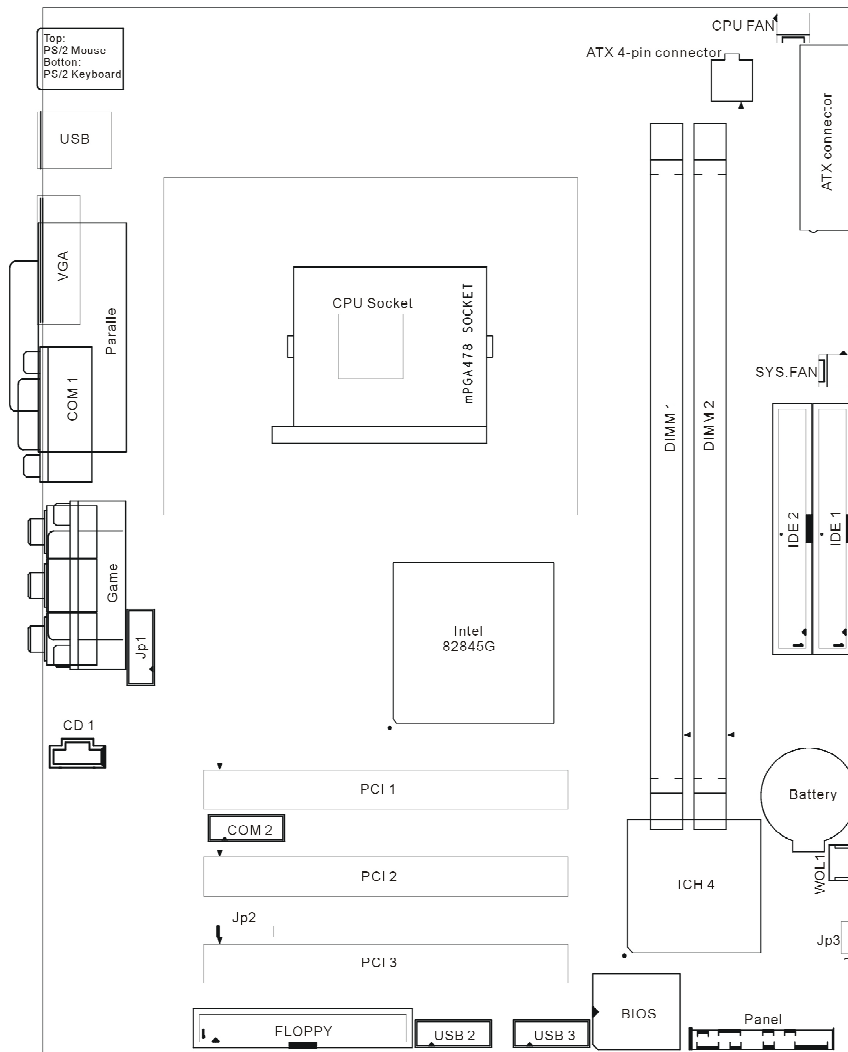

Product Introduction

# chapter 2:Product Introduction

## P845GLP mainboard

- \* Support Intel 478pin Pentium4 FC-PGA2 (Willamette/Northwood)
- \* Support 400MHz Bus
- \* Intel 845GL + ICH4 Chipset
- \* Two DIMM slots support up to 2G Memory Capacity
- \* Support PC1600 and PC2100 DDR DIMM(DDR200/DDR266)
- \* Jumperless for CPU Frequency setting
- \* 3x PCI slots
- \* 6x USB2.0 ports (4xUSB2.0 in the Front panel,2xUSB2.0 in the rear panel) , 1x IrDA port header
- \* 1 x FDD port, 1 x Parallel port with ESD/EMI protection, 2 x COM ports
- \* Dual IDE Channels support Four Ultra-DMA33/66/100 IDE Devices
- \* WAKEUP-LINK Header to Support Wake-On-LAN
- \* Integrated 2D&3D Graphic Accelerate Port
- \* Integrated AC97 Audio Onboard(Select 2ch,4ch,5.1ch)(optional)
- \* AC97 2.1(or AC97 2.2) Compliant Codec with 3D Stereo Enhancement
- \* 1 xSpeaker(Front speaker), 1 x Mic-in(Center and Sub-woofer), 1 x Line-in(Rear-speaker)
- \* 1 x CD-in, 1 x Game Port
- \* 1xstandard Audio Front Panel Header
- \* Overcurrent protection over Keyboard & Mouse
- \* Coloured Connectors : FDD, IDE, COMs etc.
- \* Phoenix BIOS PC99/ACPI/DMI Compliant
- \* ATX Power Supply Interface
- \* DIP mPGA 478 CPU Socket
- \* Micro ATX form factor 245mm x 190mm

# chapter 2:Product Introduction

## P845GLP mainboard diagram

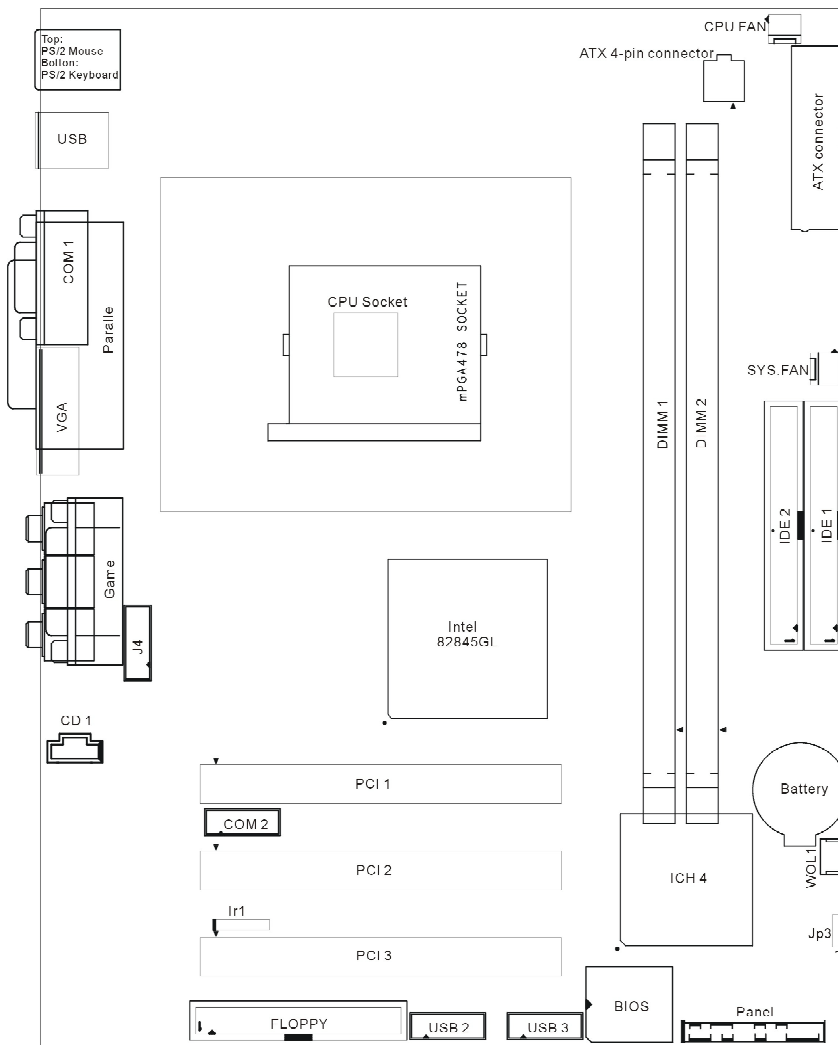

Product Introduction

# chapter 2:Product Introduction

## 2.1 Connection Configuration

### PS/2 Keyboard and Mouse connector

The Connector for the PS/2 Mouse & PS/2 Keyboard

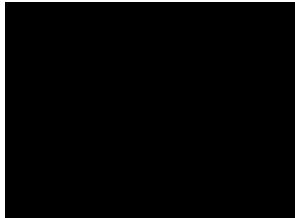

### USB Bus Connector

A845E,P845GL,P845GS mainboard provide usb connector,support pnp function accord with spec of 2.0. Its data transmission rate support up to 480Mb/s.

A845DD,A845SD,P845SD mainboard provide usb connector,support pnp function accord with spec of 1.1. Its data transmission rate support up to 12Mb/s.



### COM 1& COM 2 Connector

The COM Connector for the COM Devices.

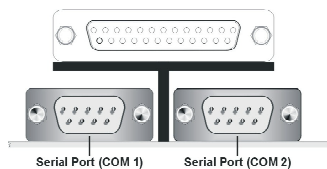

**Caution :** COM2 in P845GL and P845GLP is a 9pin header.

# chapter 2:Product Introduction

## Parallel Port

The port mainly use for Printer.

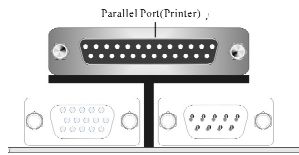

## Line-in, Microphone-in, Speaker-out MIDI/Joystick

### Line-in(Rear-speaker):

It is the input that the audio port of tape or small recorder replay or record in 2ch stereo;but it is the output of rear-speaker(surround-out )when 4ch or 5.1ch Audio format is adopted on mainboard.

### Microphone-in(center and sub-woofer):

It is the input of microphone in 2ch stereo;but it's the output of Bass sound box ( or Center-out) when 5.1ch Audio format is adopted on mainboard.

### Speaker(Front-speaker):

It is the output of Two channel Audio.When 4ch or 5.1ch Audio format is adopted on mainboard,it's the output of Front speaker.

### MIDI/Joystick :

It's connected a joystick or a MIDI device.

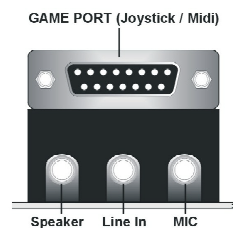

Note: CS4299/ALC201 support 2ch audio format;

CMI9738 support 4ch audio format;

CMI9739 support 5.1ch audio format.

# Chapter 2:Product Introduction

## P4 Power Connector

This is a simply diagram of P4 Power connector,which supply 5V and 12V standard Voltage and so on.

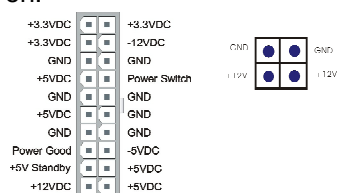

## COM2 header

COM cable to connect with it. The red line of cable correspond with pin1 of the header.

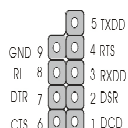

## USB header

use cable to connect with it. It support two usb port. The red line of cable correspond with pin1 of the header.

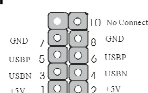

## IRDA connector

The header pin-out is as follows

Pin Signal Name

- | Pin | Signal Name              |
|-----|--------------------------|
| 1   | VCC, power source        |
| 2   | No Connection            |
| 3   | IRRX, infra-red receive  |
| 4   | Ground                   |
| 5   | IRTX, infra-red transmit |

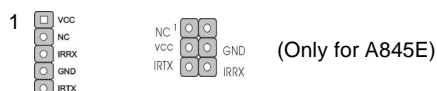

## WOL Header

The Wakeup-Link header used to connect an add-in NIC(Network Interface card) which has Wake-on-Lan capability.