

TROUBLESHOOTING cont'd...		
PROBLEM	CAUSE	SOLUTION
Plane is flying too low.	Needs more power. Battery power is drained.	Push the throttle UP. Charge plane for a complete charge cycle or, if batteries are completely drained, replace batteries in controller/charger.
Plane is flying too high.	Need to decrease power.	Full the throttle DOWN.
Motors don't stop when controller/charger is turned OFF.	Plane is still set to full throttle.	Turn controller/charger ON, reduce throttle to 0 and turn OFF.
Video is not being recorded.	Memory is full. Both red and green Light indicators on controller are flashing together. Video and picture buttons were pressed at the same time. The plane is turned off or is not fully charged during the video recording period, so the video clip cannot be saved.	Ensure there is sufficient memory left in the Hawk Eye™ Blue Sky™ by removing older videos and pictures. Refer to "Accessing your video(s) and picture(s)". Press only the video button. Make sure to stop video recording by pressing the video button. Do not turn off the plane during video recording or the video clip will not be saved into memory.
Picture is not being taken.	Memory is full. The light indicators on the controller are flashing red and green simultaneously. Picture button is being repeatedly pressed too fast.	Ensure there is sufficient memory left in the Hawk Eye™ Blue Sky™ by removing older videos and pictures. Refer to "Accessing your video(s) and picture(s)". Wait approximately 1.5 second or until the red indicator light turns off before taking the next picture.
Videos/pictures are blurry.	Video/picture viewing software set to higher than 100% zoom. Pictures are being taken while the plane is turning/spinning.	Consult your videopicture viewing software manual or online help section to ensure you are viewing the pictures/videos at 100% zoom. Resolution: Pictures – USA (640 x 480 pixels), Video – OVI (320 x 240 pixels). Ensure your plane is properly trimmed. Try taking pictures when the plane is flying straight.
I can't see the Air Hogs™ drive under My Computer (in Windows) or Finder (Apple OS X™).	Computer is not turned on. The plane and/or USB cable is not properly connected. Your computer's USB port is not working. The drive is hidden because of too many USB devices connected to your computer.	Ensure your computer is turned on. If on, try a different USB port on your computer. Check that both ends of the USB cord are plugged in properly. Try a different USB port on your computer. With your computer turned off, remove the other USB devices connected to your computer except for your keyboard and mouse. Turn your computer on. Repeat Steps 1 through 7 under "HOW TO CHARGE, ACCESS YOUR VIDEO(S) AND ACCESS YOUR PICTURE(S)".
The plane is not charging.	The plane is not set to the "CHARGE" position. There is radio frequency interference.	Ensure your plane is set to "CHARGE". Avoid playing in areas where there is potential for radio frequency (RF) interference, move to a new location.
The plane takes pictures and/or video recordings on its own.	There is radio frequency interference or another high-powered device is close by.	Fly the plane in a large wide-open area free of buildings or overhead wires or cables or move to another location and try again.
The plane is losing control within 100 feet of controller.	Computer does not have the proper software.	The Hawk Eye™ Blue Sky™ takes pictures in standard JPEG format and takes videos in standard AVI format. Your computer should have built-in software to view these. Ensure your computer is using at least Windows XP™ and/or Apple OS X™.
I can't view the images and/or movies.	Computer does not have the proper software.	does not resume, move the product to another location and try again. To ensure normal performance, change the batteries, as low batteries may not allow full function.

**NOTE:** If normal function of the product is disturbed or interrupted, strong electro-magnetic interference or electrostatic discharge may be causing the issue. The product may malfunction and memory may be lost. To reset the product, turn it completely off, unplug and re-plug the parts, then turn it back on. If normal operation does not resume, move the product to another location and try again. To ensure normal performance, change the batteries, as low batteries may not allow full function.

For further questions and problems, please visit our website [www.airhogs.com](http://www.airhogs.com).

**Safety Precautions:**  
- Keep hands, feet and loose clothing away from the propellers when power switch is turned ON.  
- Turn off controller/charger and plane when not in use. - Remove battery from controller/charger when not in use. - Parental guidance is recommended for flight. - Do not fly the plane in your sight so that you can supervise it at all times. - New alkaline batteries are recommended for use in controller to obtain maximum performance. - You are advised to replace with new batteries in soon as the flight becomes impaired. - Users should keep and retain this information for future reference.  
- Users should keep strict accordance with the instruction manual while operating the product.  
- Your controller/charger is labor-made for the Li-Poly rechargeable battery used in your Hawk Eye™ Blue Sky™. Do not use it to charge any battery other than that in the plane.

**CANADIAN Class B Statement:** This Class B digital apparatus complies with Canadian ICES-003. This device complies with Industry Canada license exempt RSS-210 standards. Operation is subject to the following two conditions: (1) This device may not cause interference, and (2) This device must accept any interference, including interference that may cause undesired operation of the device.

**Care and Maintenance:**  
- Always remove batteries from the toy when it is not being used for a long period of time (controller only).  
- Wipe the toy gently with a clean damp cloth.  
- Keep the toy away from direct heat.  
- Recommended are to be used.  
- DO NOT incinerate used batteries.  
- DO NOT dispose of batteries in fire, as batteries may explode or leak.  
- DO NOT mix old and new batteries or types of batteries (i.e. alkaline/standard).  
- DO NOT use rechargeable batteries.  
- DO NOT recharge non-rechargeable batteries.  
- DO NOT short-circuit the supply terminals.  
- Do not allow the batteries or connectors to get wet.  
- Only charge the batteries with the specified Spin Master™ battery charger.  
- Only use the batteries in the device specified by Spin Master™.  
- Only use the USB cable specified by Spin Master™.  
- Do not use any other cables with this product.  
- Only use the cable which is provided with this product.  
- Carefully read the instruction guide and use the batteries correctly.  
- In the unlikely event of leakage or explosion use sand or a chemical fire extinguisher for the battery.  
- Batteries must be recycled or disposed of properly.

**BATTERY SAFETY INFORMATION:**  
- Requires 6 x 1.5 V AA alkaline batteries (not included).  
- Batteries are small objects.  
- Replacement of batteries must be done by adults.  
- Follow the polarity (+/-) diagram in the battery compartment.  
- Promptly remove dead batteries from the toy.  
- Dispose of used batteries properly.  
- Remove batteries for prolonged storage  
- Only batteries of the same or equivalent type as your Hawk Eye™ Blue Sky™ is equipped with a Lithium Polymer Battery.  
**SPECIAL LIPO BATTERY INSTRUCTIONS:**  
- Never charge battery unattended.  
- Charge battery in isolated area. Keep away from flammable materials.  
- Do not expose to direct sunlight. There is a risk of the batteries exploding, overheating, or igniting.  
- Do not disassemble, modify, heat, or short circuit the batteries. Do not place them in fires or leave them in hot places.  
- Do not drop or subject to strong impacts.

**Special Note to Adults:**  
- Regularly examine for damage to the plug, enclosure and other parts. In the event of any damage, the toy must not be used with the controller until the damage has been repaired.  
- This toy is not intended for children under 3 years old.  
- This toy must only be used with the recommended controller.  
- Do not try to charge other batteries with the controller.

**Battery requirement for Hawk Eye™ Blue Sky™:**  
Power Supply: ———  
USB Rating: ——— Input/Output rating: DC 5 V, 1A  
Requires 1 x 3.7 V Li-Poly Rechargeable Battery Pack (included)  
Requires 1 x 3.7 V Li-Poly Rechargeable Battery Pack (included)

**Battery requirement for Controller:**  
Power Supply: ———  
Rating: ——— DO 9 V, 0.45 W  
Requires 6 x 1.5 V AA size batteries (not included)

**PRODUCT BATTERY REMOVAL INSTRUCTIONS:** Internal battery is factory installed, product disassembly and battery removal must be performed by an adult. Do not use any tools for disassembly. Pulling, tearing, and deforming of the product during disassembly, while necessary, should be as limited as possible. Do not compress the product at any time. Ensure product is turned off. Find a point where the two body halves meet; the nose of the aircraft or where the wing meets the body. Start to peel the halves apart, separating them where they are glued together; remove any tape as necessary. Separate product body halves to expose internal electronics. To separate battery from product use scissors to cut a single battery wire, immediately wrap the cut wire end with tape to isolate it, repeat until all battery wires are cut and isolated. Dispose of battery in accordance with your local battery recycling or disposal laws.

**NOTE:** Opening of product and/or removal of battery will render product inoperative and voids manufacturer warranties, dispose of remaining product components in accordance with local laws.

**CAUTION:** In an environment with electrostatic discharge, the toy may malfunction. This requires the user to reset the toy by unplugging then re-plugging the USB Cable.

**CAUTION:** It is rare but possible for a seizure to be triggered by light flashes or patterns such as those on the computer screen. To reduce exposure to this potential hazard, sit in a well-lit room, sit at appropriate distance from the screen and take 10 to 15 minute breaks every hour.

**Warning: CHOKING HAZARD - Small Parts.**

**WARNING: CHOKING HAZARD - Small parts. Not for children under 3 years. STRANGULATION HAZARD - USB cable can be a strangulation hazard.**

**CAUTION: ELECTRIC TOY.** Not recommended for children under 12 years of age. As with all electrical products, precaution should be observed during the handling and use to prevent electrical shock.

**Contains 1x3.7V LiPo battery pack. Batteries or battery packs must be recycled or disposed of properly. When this product has reached the end of its useful life it should not be disposed of with other household waste. The Waste Electrical and Electronic Equipment Regulations require it to be separately collected so that it can be treated using the best available recovery and recycling techniques. This will minimize the impact on the environment and human health from soil and water contamination by any hazardous substances, decrease the resources required to make new products and avoid using up landfill space. Please do your part by keeping this product out of the municipal waste stream. The "waste bin" symbol means that it should be collected as "waste electrical and electronic equipment". You can return an old product to your retailer when you buy a similar new one. For other options, please contact your local council.**

Hereby, Spin Master Ltd., declares that this Hawk Eye Blue Sky™ is in compliance with the essential requirements and other relevant provisions of Directive 1999/5/EC. <http://www.airhogs.com>

Air Hogs®, related trademarks & © 2011 Spin Master Ltd. All rights reserved. This product conforms to safety requirements of ASTM F-963, EN-71 & CPFA. Please retain this information for future reference. • Please remove all packaging materials before giving to children. • An adult should periodically check this toy to ensure no damage or hazards exist. If so, remove from use. • Children should be supervised during play. • Keep addresses and phone numbers for future reference. • The item inside this package may vary from the photographs and/or illustrations. MADE IN CHINA.

SPIN MASTER LTD., 450 FRONT STREET WEST, TORONTO, ON M5V 1B6 CANADA  
Customer Care: 1-800-622-8339 Fax: 416-364-8005  
Email: [customerservice@spinmaster.com](mailto:customerservice@spinmaster.com)  
Spin Master Inc., PMB #10053, 300 International Drive, Suite 100, Williamsport, NY 14221, USA  
Spin Master Toys Far East Limited, Rm #1113, 11/F, Chinachem Golden Plaza, 77 Mody Rd., Tsimshatsui E., Kowloon, HK

Imported into EU by: SPIN MASTER INTERNATIONAL, S.A.R.L., 16 AVENUE PASTEUR, L-2310, LUXEMBOURG  
[www.spinmaster.com](http://www.spinmaster.com)

20049082 REV 0  
144425\_0001\_20049082\_GEN\_IS\_R2  
4

**Access the FREE Air Hogs® Video Editor!**  
Easily add cool images, sounds and words to your videos and pictures and share them with your friends.  
Visit [www.airhogs.com](http://www.airhogs.com) to register and access the Video Editor.

**12+ YRS EXPERT**

**CONTENTS LIST AND PARTS IDENTIFICATION**

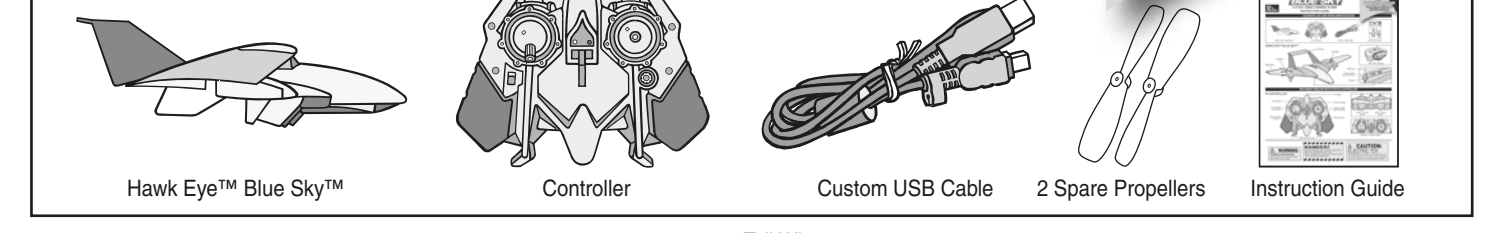

**HAWK EYE™ BLUE SKY™**

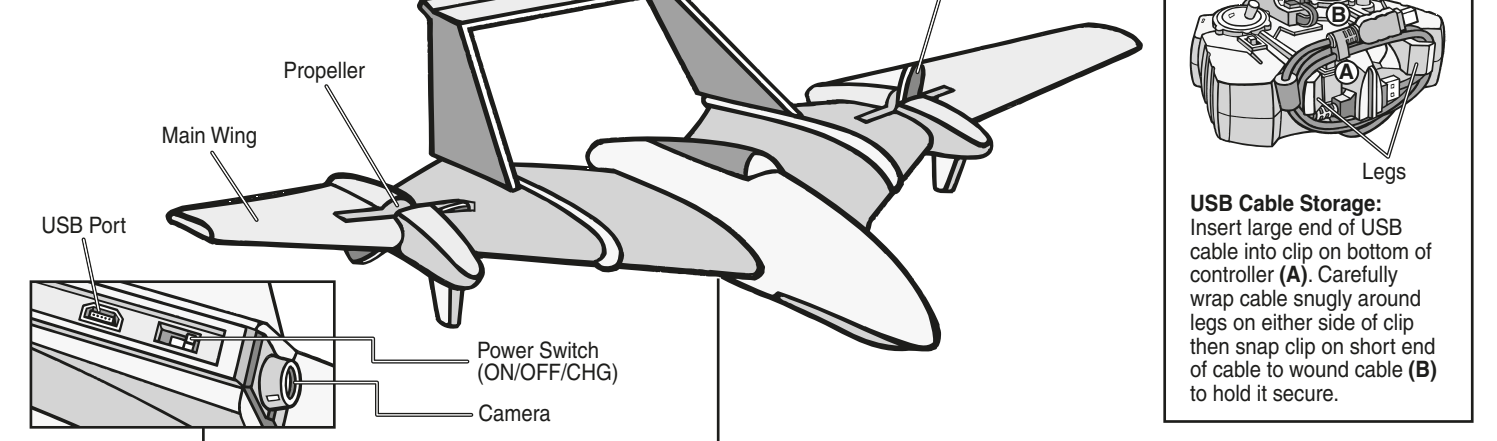

**BECOMING FAMILIAR WITH YOUR CONTROLLER/CHARGER**

**CONTROLLER/CHARGER**

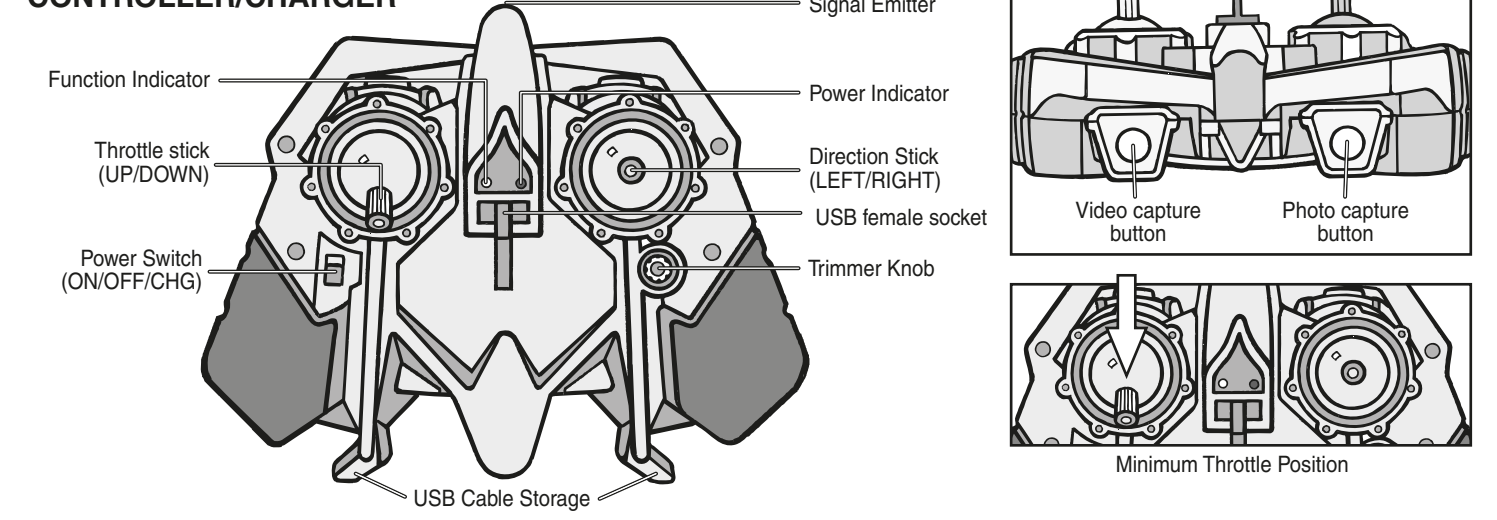

**WARNING: CHOKING HAZARD - Small parts. Not for children under 3 years. STRANGULATION HAZARD - USB cable can be a strangulation hazard.**

**DANGER! NEVER INSERT ANY SHARP OBJECTS, PINS OR SCREWS INTO THE PLANE AS THIS MAY PUNCTURE THE INTERNAL BATTERY!**

**CAUTION: ELECTRIC TOY.** Not recommended for children under 12 years of age. As with all electrical products, precaution should be observed during the handling and use to prevent electrical shock.

**HOW TO INSTALL YOUR BATTERIES**

1. Open the battery door with a screwdriver (pic.1). 2. If used batteries are present, remove these batteries from the unit by pulling up on one end of each battery. 3. Install new batteries as shown in the polarity diagram (+/-) inside the battery compartment (pic.2). 4. Replace battery door securely (pic.3).

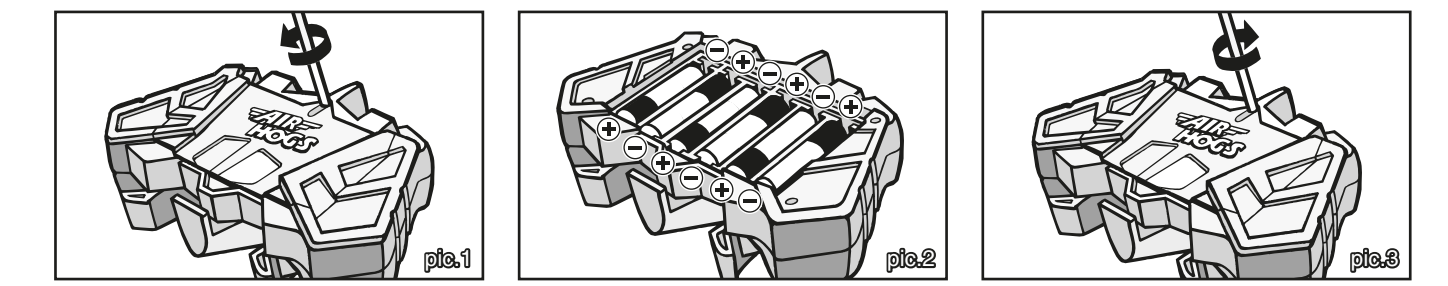

**HOW TO CHARGE YOUR PLANE USING THE CONTROLLER/CHARGER**

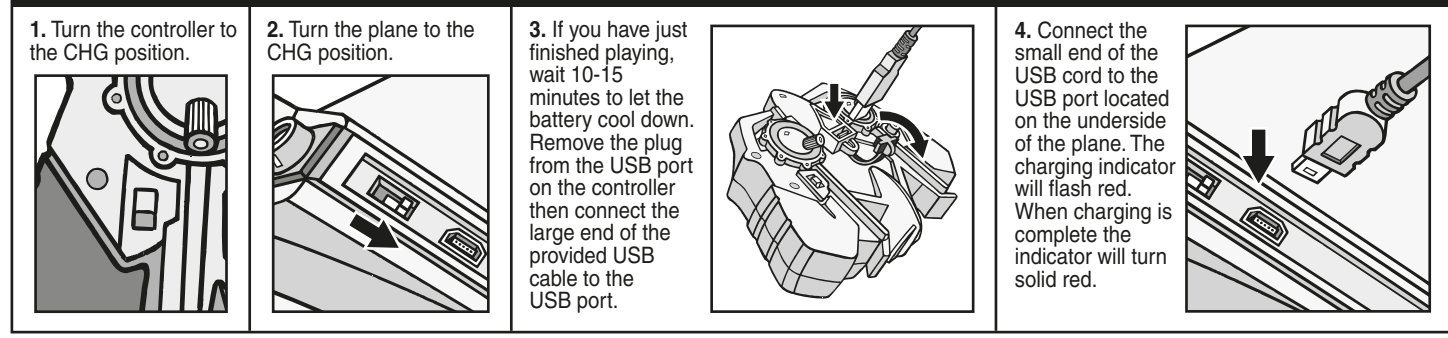

**HOW TO CHARGE, ACCESS YOUR VIDEO(S) AND ACCESS YOUR PICTURE(S) ON YOUR COMPUTER**

Ask your parents or legal guardian to help you with these steps. Once the plane has finished charging, the indicator will turn solid red. (A full charge may take 35-55 minutes). Ensure your computer is ON.  
**NOTE:** To extend the life of your controller batteries, charge your Hawk Eye™ Blue Sky™ from your computer whenever possible.  
If you have taken pictures or videos, you can now access the files on your Air Hogs® Hawk Eye™ Blue Sky™ even while your plane is charging.  
**NOTE:** The Hawk Eye™ Blue Sky™, when connected to the computer, is the same as a flash drive or MP3 player and will act the same when plugged in. The indicator will flash red when connected to the computer to show it is charging.  
**IF USING A PC:** If using Windows XP® or greater, click on the Start button and then select My Computer.  
**IF USING A MAC:** Open Finder. The drive is called "Air Hogs". You can look at your pictures and/or movies using your preferred software. If you want to save your pictures and/or movies simply copy them to your computer. Remember to delete them afterwards from the Air Hogs™ drive.  
Once you have downloaded your pictures and/or movies DO NOT simply un-plug the USB cable. In Windows XP® use the "Safely Remove Hardware" tool. On Windows Vista®, Windows 7® and Apple OS X™ use the Eject function.

**TAKING VIDEOS OR PICTURES**

• Turn on your Hawk Eye™ Blue Sky™ plane and wait for a successful pairing. The red indicator will flash to show it's searching for the controller. Turn on your controller and wait for a successful pairing. The green indicator will flash to show it's searching for the plane. After a successful pairing, the green indicator on the controller will turn solid green and the red indicator on the plane will turn solid red. You are now able to take videos or photos, whether you're on the ground or in the air.  
• To take a picture, press the picture button (right) (pic.1). The Hawk Eye™ Blue Sky™ will automatically adjust focus, ISO setting and shutter speed to take your image. This takes about 1.5 seconds, during which time the red indicator will light up on the controller (pic.2). Release the picture button and the red indicator turns off, now you are ready to take your next picture.  
**NOTE:** If the picture button is pressed while a video is recording, the video is stopped and a picture is taken. You can start the video recording again by pressing the video button.  
• To take videos, press the video button (left) once (pic.3). The red indicator on controller will turn solid red indicating that video is recording (pic.2). To stop video recording, press the video button again. The red indicator on controller will turn off.  
**NOTE:** Do not turn off the plane while the red light is on for video recording or else the video cannot be saved.  
• For best picture quality try to keep the plane flying straight and steady.  
• Video quality is also best during straight flight. Keeps turns to a minimum.  
• Please respect the privacy of others. Refrain from taking videos and/or photos of other people without proper consent.  
• DO NOT fly too close to any obstacles or buildings for taking videos or pictures.  
• Obstacles nearby may affect the airflow and the control of the plane. DO NOT fly the plane farther than 100 ft when taking videos. The plane will be out of range and drop off too far. It may be difficult to find. The green indicator on controller will be flashing when the plane is too far away. Please keep an eye on the indicator during flight, and move forward to fly it back when you see it flashing.

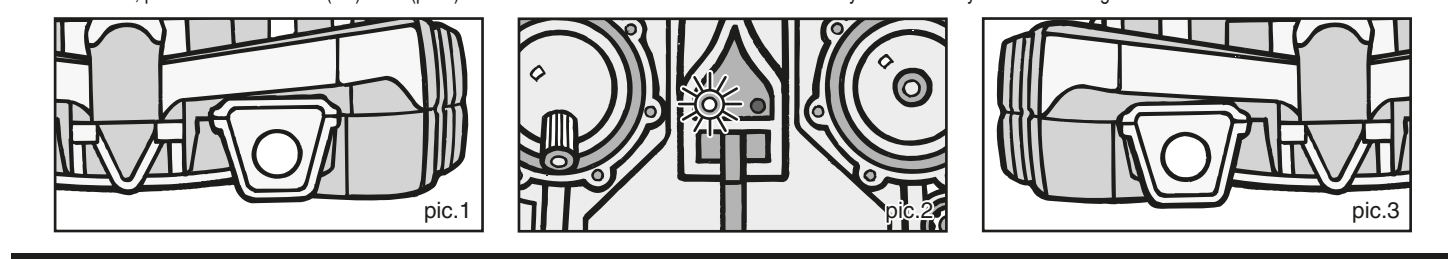

**INDICATION LIGHTS**

**Hawk Eye™ Blue Sky™ Controller:**  
• Off – Indicator light off  
• On – Indicator light solid green  
• Initial connection to plane – Indicator light flashing green until connected  
• No signal from plane after 5 minutes – Indicator light off  
• Plane out of controller range (100 ft) – Indicator light flashing green  
• Video recording mode – Indicator light solid red  
• Picture recording mode – Indicator light red for approximately 1.5 seconds  
• Memory full – Indicator light flashing red and green together  
• Low Hawk Eye Blue Sky battery – indicator light flashing alternately between red and green quickly  
• Low controller battery – indicator light flashing alternately between red and green slowly  
**Plane:**  
• Off mode – indicator light off  
• Charge mode – indicator light off when no device is connected to the plane  
• Charging – Indicator light will be flashing red  
• Fully charged – Indicator light will turn solid red when connected to computer or controller until sleep mode  
• On – Indicator light will be solid red  
• Initial connection to controller – Indicator light flashing red until connected  
• Controller out of range – Indicator light flashing red

**PRE-FLIGHT ENVIRONMENT CHECK**

1. **Location** – Fly in a large wide-open, grassy location that is free of buildings, trees, overhead wires, and other obstructions. Do not fly near people or animals.  
2. **Weather** – Fly on mild, sunny days. Do not fly in electrical storms, rain, sleet, snow or other adverse weather conditions. Do not fly if the temperature is below 7°C. In very cold temperatures, the plane will become fragile and the engine performance will decrease.  
3. **Wind Conditions** – Do not fly in strong wind. Strong winds may overpower the plane and make it difficult to control. In windy conditions, it may appear as though you have no control over the plane.  
4. To avoid losing the plane, please move forward to the plane to stop the flight or return it immediately when you see the green indicator light flashing on the controller, to show the plane is out of range.

**FLYING INSTRUCTIONS**

1. Turn the controller to the ON position. The green indicator light will flash while searching for the plane.  
2. Turn the plane to the ON position. The red indicator light will flash while searching for the controller. Once they are connected, both indicator lights will turn solid.  
3. When launching the plane, use partial throttle. Refrain from using the directional stick at initial launch. Launch the plane into the wind and parallel to the ground. When preparing for take off, check the direction of the wind. Always launch your plane into the best take off and flight results.  
**NOTE:** If you have crashed or lost contact with your plane, and the green light on the controller is either flashing, or off, you will need to re-link the plane and the controller as above.

**CONTROLLING PLANE FLIGHT**

1. To make the plane climb, move the Throttle stick forward. Too much throttle can cause a stall. To ACCELERATE upwards, move the throttle stick further UP.  
2. To FLY LEFT, move the direction stick left.  
3. To FLY RIGHT, move the direction stick right.  
4. To LAND, select a soft grassy area and pull the throttle stick back slowly.

**TRIMMING YOUR PLANE**

If the plane turns right involuntarily, turn the trim knob to the left until the plane flies straight.  
If the plane turns left involuntarily, turn the trim knob to the right until the plane flies straight.

**REPLACING THE PROPELLERS**

1. Remove the broken propeller as shown in photo.  
2. Check the direction of the propeller before attaching a new one.  
**CAUTION:** Sharp point on the motor shaft. The propeller must be replaced by an adult!

**TROUBLESHOOTING**

PROBLEM	CAUSE	SOLUTION
Plane will not start or has low power.	Plane not charged. Battery power is drained. Plane was not set to CHG during charging. Controller/charger is not ON. It's a windy day.	Charge plane for a complete charge cycle. Replace the controller/charger batteries after approximately 6 to 8 flights. The plane won't accept a charge in the ON position. Set plane switch to CHARGE position. Set controller/charger to ON. Do not fly in strong winds. Strong windy conditions will limit and prevent your ability to control the plane.
Plane will not turn.		